



Rogers

Assessment Property Record Card for Tax Year 2026

Data provided by LISA DELOZIER County Assessor

Date 04/17/2026
 Time 03:33:39
 Page 1

Assessment Data					Primary Image																																																																																																																				
Account 660005653 Parcel ID 000000-00-0-00813-001-0007 Cadastral ID 06-21-17-00160 Property Type REAL - Real Property Property Class RRP VI Area 3 Tax Area 93 - JUSTUS/TRI-DISTRICT FIRE Name ID 259304 BEAUREGARD, KAREN J TRUSTEE 16865 THOMAS DR CLAREMORE OK 74017-0000 Parcel Location Situs 16865 E THOMAS DR Subdivision THOMAS HEIGHTS Lot/Block 0007 / 0001 Parcel Size 1 - Lots Sec/Twn/Rng 6 / 21 / 17 / 5 Neighborhood 1070 - R-V03-SE JUSTUS-SEQUOYAH School District S009 - JUSTUS-TIAWAH SCHOOLS					<p>660005653_001.JPG 9/3/2025</p>																																																																																																																				
Legal Description Lot/Long: 36.33365368 -95.52774700																																																																																																																									
Building Permits <table border="1"> <thead> <tr> <th>Number</th> <th>Description</th> <th>Opened</th> <th>Closed</th> <th>Amount</th> </tr> </thead> <tbody> <tr> <td colspan="5"> </td> </tr> </tbody> </table>					Number	Description	Opened	Closed	Amount																																																																																																																
Number	Description	Opened	Closed	Amount																																																																																																																					
Exemptions <table border="1"> <thead> <tr> <th>Code</th> <th>Type</th> <th>Active</th> <th>Maximum</th> <th>Exemption</th> </tr> </thead> <tbody> <tr> <td>H</td> <td>Homestead</td> <td>Yes</td> <td>1,000</td> <td>1,000</td> </tr> <tr> <td>PD</td> <td>Add-Homestead</td> <td>Yes</td> <td>1,000</td> <td>1,000</td> </tr> </tbody> </table>					Code	Type	Active	Maximum	Exemption	H	Homestead	Yes	1,000	1,000	PD	Add-Homestead	Yes	1,000	1,000	Sale History <table border="1"> <thead> <tr> <th>Bk/Pg</th> <th>Grantor</th> <th>Date</th> <th>Price</th> <th>Code</th> </tr> </thead> <tbody> <tr> <td>1239/857</td> <td>OZBUN, MICHAEL A &</td> <td>07/31/2000</td> <td>164,500</td> <td>Yes</td> </tr> <tr> <td>1018/858</td> <td>SUTHERLAND, LINDA</td> <td>03/06/1996</td> <td>12,000</td> <td>Yes</td> </tr> <tr> <td>908/449</td> <td>SELLER</td> <td>03/15/1993</td> <td>0</td> <td>No</td> </tr> </tbody> </table>					Bk/Pg	Grantor	Date	Price	Code	1239/857	OZBUN, MICHAEL A &	07/31/2000	164,500	Yes	1018/858	SUTHERLAND, LINDA	03/06/1996	12,000	Yes	908/449	SELLER	03/15/1993	0	No																																																																													
Code	Type	Active	Maximum	Exemption																																																																																																																					
H	Homestead	Yes	1,000	1,000																																																																																																																					
PD	Add-Homestead	Yes	1,000	1,000																																																																																																																					
Bk/Pg	Grantor	Date	Price	Code																																																																																																																					
1239/857	OZBUN, MICHAEL A &	07/31/2000	164,500	Yes																																																																																																																					
1018/858	SUTHERLAND, LINDA	03/06/1996	12,000	Yes																																																																																																																					
908/449	SELLER	03/15/1993	0	No																																																																																																																					
Parcel Valuation <table border="1"> <thead> <tr> <th>Source</th> <th>REAL</th> <th>Fair Cash</th> <th>Capped</th> <th>Asmnt Level</th> <th>Assessed</th> <th>Levy Rate</th> <th>93.050</th> <th>Current Tax</th> </tr> </thead> <tbody> <tr> <td>Remove Cap</td> <td>2001</td> <td>Land Value 93,862</td> <td>57,216</td> <td>11%</td> <td>6,294</td> <td>Assessed</td> <td>22,108</td> <td>2,057.15</td> </tr> <tr> <td>Year Frozen</td> <td>2012</td> <td>Improvements 235,838</td> <td>143,762</td> <td></td> <td>15,814</td> <td>Penalty</td> <td>0</td> <td></td> </tr> <tr> <td>Uncapped Value</td> <td>0</td> <td>Mobile Home 0</td> <td>0</td> <td></td> <td>0</td> <td>Exemption</td> <td>2,000</td> <td>-166.00</td> </tr> <tr> <td>TIF Project ID</td> <td>0</td> <td>Total Value 329,700</td> <td>200,978</td> <td></td> <td>22,108</td> <td>Total Taxable</td> <td>20,108</td> <td>1,891.00</td> </tr> </tbody> </table>										Source	REAL	Fair Cash	Capped	Asmnt Level	Assessed	Levy Rate	93.050	Current Tax	Remove Cap	2001	Land Value 93,862	57,216	11%	6,294	Assessed	22,108	2,057.15	Year Frozen	2012	Improvements 235,838	143,762		15,814	Penalty	0		Uncapped Value	0	Mobile Home 0	0		0	Exemption	2,000	-166.00	TIF Project ID	0	Total Value 329,700	200,978		22,108	Total Taxable	20,108	1,891.00																																																																			
Source	REAL	Fair Cash	Capped	Asmnt Level	Assessed	Levy Rate	93.050	Current Tax																																																																																																																	
Remove Cap	2001	Land Value 93,862	57,216	11%	6,294	Assessed	22,108	2,057.15																																																																																																																	
Year Frozen	2012	Improvements 235,838	143,762		15,814	Penalty	0																																																																																																																		
Uncapped Value	0	Mobile Home 0	0		0	Exemption	2,000	-166.00																																																																																																																	
TIF Project ID	0	Total Value 329,700	200,978		22,108	Total Taxable	20,108	1,891.00																																																																																																																	
Assessment History <table border="1"> <thead> <tr> <th>Tax Year</th> <th>Statement Number</th> <th>Billed Owner</th> <th>Tax Area</th> <th>Total Value</th> <th>Exemptions</th> <th>Taxable Value</th> <th>Billed Tax</th> </tr> </thead> <tbody> <tr><td>2025</td><td>2025-660005653</td><td>BEAUREGARD, KAREN J</td><td>93</td><td>326,942</td><td>2000</td><td>20,108</td><td>1,891.00</td></tr> <tr><td>2024</td><td>2024-660005653</td><td>BEAUREGARD, KAREN J</td><td>93</td><td>358,283</td><td>2000</td><td>20,108</td><td>2,032.00</td></tr> <tr><td>2023</td><td>2023-660005653</td><td>BEAUREGARD, KAREN J</td><td>93</td><td>259,769</td><td>2000</td><td>20,107</td><td>2,028.00</td></tr> <tr><td>2022</td><td>2022-660005653</td><td>BEAUREGARD, KAREN J</td><td>93</td><td>262,332</td><td>2000</td><td>20,108</td><td>2,027.00</td></tr> <tr><td>2021</td><td>2021-660005653</td><td>BEAUREGARD, KAREN J</td><td>93</td><td>247,021</td><td>2000</td><td>20,107</td><td>2,060.00</td></tr> <tr><td>2020</td><td>2020-660005653</td><td>BEAUREGARD, KAREN J</td><td>93</td><td>242,915</td><td>2000</td><td>20,107</td><td>1,989.00</td></tr> <tr><td>2019</td><td>2019-660005653</td><td>BEAUREGARD, KAREN J</td><td>93</td><td>232,900</td><td>2000</td><td>20,108</td><td>2,028.00</td></tr> <tr><td>2018</td><td>2018-660005653</td><td>BEAUREGARD, KAREN J</td><td>93</td><td>239,328</td><td>2000</td><td>20,108</td><td>2,030.00</td></tr> <tr><td>2017</td><td>2017-660005653</td><td>BEAUREGARD, KAREN J</td><td>93</td><td>233,954</td><td>2000</td><td>20,107</td><td>1,927.00</td></tr> <tr><td>2016</td><td>2016-660005653</td><td>BEAUREGARD, KAREN J</td><td>93</td><td>227,766</td><td>2000</td><td>20,108</td><td>2,002.00</td></tr> <tr><td>2015</td><td>2015-660005653</td><td>BEAUREGARD, KAREN J</td><td>93</td><td>222,479</td><td>2000</td><td>20,107</td><td>1,986.00</td></tr> <tr><td>2014</td><td>2014-660005653</td><td>BEAUREGARD, KAREN J</td><td>93</td><td>224,328</td><td>2000</td><td>20,107</td><td>1,947.00</td></tr> <tr><td>2013</td><td>2013-660005653</td><td>BEAUREGARD, KAREN J</td><td>93</td><td>211,141</td><td>2000</td><td>20,107</td><td>1,973.00</td></tr> </tbody> </table>										Tax Year	Statement Number	Billed Owner	Tax Area	Total Value	Exemptions	Taxable Value	Billed Tax	2025	2025-660005653	BEAUREGARD, KAREN J	93	326,942	2000	20,108	1,891.00	2024	2024-660005653	BEAUREGARD, KAREN J	93	358,283	2000	20,108	2,032.00	2023	2023-660005653	BEAUREGARD, KAREN J	93	259,769	2000	20,107	2,028.00	2022	2022-660005653	BEAUREGARD, KAREN J	93	262,332	2000	20,108	2,027.00	2021	2021-660005653	BEAUREGARD, KAREN J	93	247,021	2000	20,107	2,060.00	2020	2020-660005653	BEAUREGARD, KAREN J	93	242,915	2000	20,107	1,989.00	2019	2019-660005653	BEAUREGARD, KAREN J	93	232,900	2000	20,108	2,028.00	2018	2018-660005653	BEAUREGARD, KAREN J	93	239,328	2000	20,108	2,030.00	2017	2017-660005653	BEAUREGARD, KAREN J	93	233,954	2000	20,107	1,927.00	2016	2016-660005653	BEAUREGARD, KAREN J	93	227,766	2000	20,108	2,002.00	2015	2015-660005653	BEAUREGARD, KAREN J	93	222,479	2000	20,107	1,986.00	2014	2014-660005653	BEAUREGARD, KAREN J	93	224,328	2000	20,107	1,947.00	2013	2013-660005653	BEAUREGARD, KAREN J	93	211,141	2000	20,107	1,973.00
Tax Year	Statement Number	Billed Owner	Tax Area	Total Value	Exemptions	Taxable Value	Billed Tax																																																																																																																		
2025	2025-660005653	BEAUREGARD, KAREN J	93	326,942	2000	20,108	1,891.00																																																																																																																		
2024	2024-660005653	BEAUREGARD, KAREN J	93	358,283	2000	20,108	2,032.00																																																																																																																		
2023	2023-660005653	BEAUREGARD, KAREN J	93	259,769	2000	20,107	2,028.00																																																																																																																		
2022	2022-660005653	BEAUREGARD, KAREN J	93	262,332	2000	20,108	2,027.00																																																																																																																		
2021	2021-660005653	BEAUREGARD, KAREN J	93	247,021	2000	20,107	2,060.00																																																																																																																		
2020	2020-660005653	BEAUREGARD, KAREN J	93	242,915	2000	20,107	1,989.00																																																																																																																		
2019	2019-660005653	BEAUREGARD, KAREN J	93	232,900	2000	20,108	2,028.00																																																																																																																		
2018	2018-660005653	BEAUREGARD, KAREN J	93	239,328	2000	20,108	2,030.00																																																																																																																		
2017	2017-660005653	BEAUREGARD, KAREN J	93	233,954	2000	20,107	1,927.00																																																																																																																		
2016	2016-660005653	BEAUREGARD, KAREN J	93	227,766	2000	20,108	2,002.00																																																																																																																		
2015	2015-660005653	BEAUREGARD, KAREN J	93	222,479	2000	20,107	1,986.00																																																																																																																		
2014	2014-660005653	BEAUREGARD, KAREN J	93	224,328	2000	20,107	1,947.00																																																																																																																		
2013	2013-660005653	BEAUREGARD, KAREN J	93	211,141	2000	20,107	1,973.00																																																																																																																		



Rogers

Assessment Property Record Card for Tax Year 2026

Data provided by LISA DELOZIER County Assessor

Date 04/17/2026
 Time 03:33:39
 Page 2

Lot Data	Square-Foot - NBHD 1070 #1	Primary Image
Lot Size Lot Count Units Buildable 2.72 Non-Ag Acres 2.5478 Topography Street Access Utilities Amenities LAND QUALITY 0 0 Method Square-Foot Base Lot Value 110,983.00 x .85 = 93,862 Factor Value Adjustments 1.0000 Lot Value 93,862		

Residential Data	
Type	1 Single Family Residence
Condition	3 - Average
Quality	3 - Average
Architecture	
Style	100% 1 1/2 Story Finished
Exterior Wall	20% Veneer, Masonry 80% Frame, Siding, Vinyl
Base/Total Area	1,513 / 2,377
Style	100% 1 1/2 Story Finished
HVAC	100% Warmed & Cooled Air
Roof Cover	1 Composition Shingle
Area on Slab	1,513
Fixture/RghIn	14 /
Bed/F/H Bath	4 / 3.0 /
Basement Area	
Garage Type	638 Attached Garage - Unfinished
Remodel	
Year/Eff Age	1997 / 22

GRM Approach
GRM Code Gross Rent 0.00 Indicated Value

Multiple Regression
MRA Code 1 Test Adusted R 0.8445 Indicated Value 276,725 116.42 Per SqFt

Direct Comparables
Selection Model A Adam Test Adjustment Model 1 2022 Residential Comparables 1 Indicated Value 93,000 Per SqFt

Cost Approach				Manual : 01/2025			
Base Cost	88.89	Total Misc Impr	+ 17,463	Roofing Adj	+ 3.16	Garage Cost	+ 19,338
Subfloor Adj	+ -1.47	Total RCN	= 301,694	Heat/Cool Adj	+ 12.64	Depreciation (26%)	- 78,440
Plumbing Adj	+ 8.22	Lump Sums	+ 12,584	Basement Adj	+ 0.00	RCNLD	= 235,838
Adj Base Cost	= 111.44	Lot Value	+ 93,862	Total Area	x 2,377	Indicated Value	= 329,700
		Value Per SqFt	138.70	Adjusted Cost	= 264,893		

Value Reconciliation
Selected Approach Cost Approach Improvements 235,838 Lot Value 93,862 Indicated Value 329,700 138.70 Per SqFt Agland Value Site Improvements Total Value 329,700 138.70 Total Value Per SqFt

Miscellaneous Improvements								
Code	Description	Sketch ID	Size	Year	Units	Unit Cost	Depr	Value
FPR1	FIREPLACE - RESIDENTIAL 1 STORY	0		1	1	5,615.40		5,615
EPSW	ENCLOSED PORCH - SOLID WALL	13510	12x12		144	69.62		10,025
WODC	WOOD DECK - COVERED	13511	424		424	29.68		12,584
PATO	SLAB PORCH - OPEN	13512	14x12		168	10.85		1,823



Rogers

Assessment Property Record Card for Tax Year 2026

Data provided by LISA DELOZIER County Assessor

Date 04/17/2026
 Time 03:33:39
 Page 3

Sketch Image

660005653

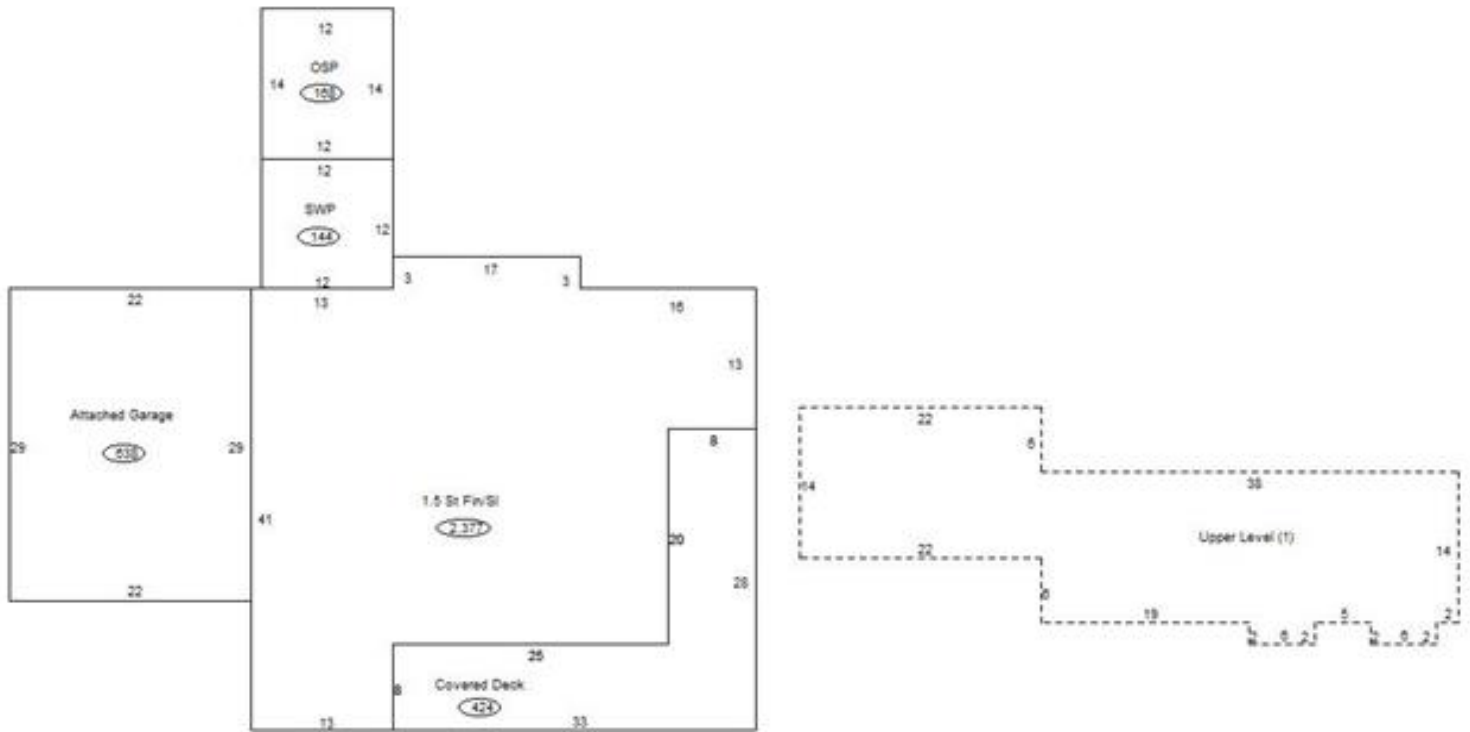

Sketch Vector Information

Sequence	Code	Type	Built Over	Scale	Section Label	Base Area	Multiplier	Total Area
1	R	5	Slab	13	1.5 St Fin/SI	1,513	1.571	2,377
2	G	1		13	Attached Garage	638	1.000	638
3	M	EPSW		13	EPSW	144	1.000	144
4	M	WODC		13	WODC	424	1.000	424
5	M	PATO		13	Open Slab	168	1.000	168
6	U	^UL		13	Upper Level (1)	864	1.000	864
Total Building Area						1,513		2,377