



Rogers

Assessment Property Record Card for Tax Year 2026

Data provided by LISA DELOZIER County Assessor

Date 04/17/2026
Time 02:23:27
Page 1

Assessment Data					Primary Image																																																																																																																				
Account 660005745 Parcel ID 000000-00-0-00615-003-0007 Cadastral ID 06-22-16-02190 Property Type REAL - Real Property Property Class RRP VI Area 1 Tax Area 11 - SEQUOYAH/NW FIRE Name ID 345312 MAY, LESLIE S 13167 S CEDAR ST CLAREMORE OK 74017-0000 Parcel Location Situs 13167 S CEDAR ST Subdivision PONDEROSA EXTENDED 2 Lot/Block 0007 / 0003 Parcel Size 3 - Lots Sec/Twn/Rng 6 / 22 / 16 / 5 Neighborhood 1085 - R-V04-NW SEQUOYAH School District S006 - SEQUOYAH SCHOOLS					<p>\\tsclient\T\LOGAN\LOGAN RESIDENTIAL VI\2022-11-8\IMG_001: 11/8/2022</p>																																																																																																																				
Legal Description Lat/Long: 36.41847111 -95.65028732 LOTS 7 & 8 & 9 BLOCK 3 PONDEROSA EXT. 2.																																																																																																																									
Exemptions <table border="1"> <thead> <tr> <th>Code</th> <th>Type</th> <th>Active</th> <th>Maximum</th> <th>Exemption</th> </tr> </thead> <tbody> <tr> <td>H</td> <td>Homestead</td> <td>Yes</td> <td>1,000</td> <td>1,000</td> </tr> <tr> <td>H</td> <td>Homestead</td> <td>No</td> <td>1,000</td> <td></td> </tr> <tr> <td>H</td> <td>Homestead</td> <td>No</td> <td>1,000</td> <td></td> </tr> </tbody> </table>					Code	Type	Active	Maximum	Exemption	H	Homestead	Yes	1,000	1,000	H	Homestead	No	1,000		H	Homestead	No	1,000		Building Permits <table border="1"> <thead> <tr> <th>Number</th> <th>Description</th> <th>Opened</th> <th>Closed</th> <th>Amount</th> </tr> </thead> <tbody> <tr> <td></td> <td></td> <td></td> <td></td> <td></td> </tr> </tbody> </table>					Number	Description	Opened	Closed	Amount																																																																																							
Code	Type	Active	Maximum	Exemption																																																																																																																					
H	Homestead	Yes	1,000	1,000																																																																																																																					
H	Homestead	No	1,000																																																																																																																						
H	Homestead	No	1,000																																																																																																																						
Number	Description	Opened	Closed	Amount																																																																																																																					
Parcel Valuation <table border="1"> <thead> <tr> <th>Source</th> <th>REAL</th> <th>Fair Cash</th> <th>Capped</th> <th>Asmnt Level</th> <th>Assessed</th> <th>Levy Rate</th> <th>102.332</th> <th>Current Tax</th> </tr> </thead> <tbody> <tr> <td>Remove Cap</td> <td>2025</td> <td>Land Value</td> <td>120,460</td> <td>120,460</td> <td>11%</td> <td>13,251</td> <td>Assessed</td> <td>32,564 3,332.32</td> </tr> <tr> <td>Year Frozen</td> <td>0</td> <td>Improvements</td> <td>175,690</td> <td>175,570</td> <td></td> <td>19,313</td> <td>Penalty</td> <td>0</td> </tr> <tr> <td>Uncapped Value</td> <td>0</td> <td>Mobile Home</td> <td>0</td> <td>0</td> <td></td> <td>0</td> <td>Exemption</td> <td>1,000 -88.00</td> </tr> <tr> <td>TIF Project ID</td> <td>0</td> <td>Total Value</td> <td>296,150</td> <td>296,030</td> <td></td> <td>32,564</td> <td>Total Taxable</td> <td>31,564 3,244.00</td> </tr> </tbody> </table>					Source	REAL	Fair Cash	Capped	Asmnt Level	Assessed	Levy Rate	102.332	Current Tax	Remove Cap	2025	Land Value	120,460	120,460	11%	13,251	Assessed	32,564 3,332.32	Year Frozen	0	Improvements	175,690	175,570		19,313	Penalty	0	Uncapped Value	0	Mobile Home	0	0		0	Exemption	1,000 -88.00	TIF Project ID	0	Total Value	296,150	296,030		32,564	Total Taxable	31,564 3,244.00	Sale History <table border="1"> <thead> <tr> <th>Bk/Pg</th> <th>Grantor</th> <th>Date</th> <th>Price</th> <th>Code</th> </tr> </thead> <tbody> <tr> <td>/</td> <td>JOHNSON, JERRY & TERRI</td> <td>09/11/2024</td> <td>305,000</td> <td>WG</td> </tr> <tr> <td>2330/231</td> <td>NATIONAL RES NOMINEE SERV</td> <td>05/13/2013</td> <td>175,000</td> <td>WG</td> </tr> <tr> <td>2330/229</td> <td>BARRETTO, SAVIO J & RACHEL E</td> <td>04/29/2013</td> <td>175,000</td> <td>WG</td> </tr> <tr> <td>2251/888</td> <td>O'CONNER, MICHAEL S & SUSAN G</td> <td>06/18/2012</td> <td>160,000</td> <td>WG</td> </tr> <tr> <td>1071/223</td> <td>MOSS, TIMOTHY D</td> <td>06/26/1997</td> <td>100,000</td> <td>No</td> </tr> </tbody> </table>					Bk/Pg	Grantor	Date	Price	Code	/	JOHNSON, JERRY & TERRI	09/11/2024	305,000	WG	2330/231	NATIONAL RES NOMINEE SERV	05/13/2013	175,000	WG	2330/229	BARRETTO, SAVIO J & RACHEL E	04/29/2013	175,000	WG	2251/888	O'CONNER, MICHAEL S & SUSAN G	06/18/2012	160,000	WG	1071/223	MOSS, TIMOTHY D	06/26/1997	100,000	No																																					
Source	REAL	Fair Cash	Capped	Asmnt Level	Assessed	Levy Rate	102.332	Current Tax																																																																																																																	
Remove Cap	2025	Land Value	120,460	120,460	11%	13,251	Assessed	32,564 3,332.32																																																																																																																	
Year Frozen	0	Improvements	175,690	175,570		19,313	Penalty	0																																																																																																																	
Uncapped Value	0	Mobile Home	0	0		0	Exemption	1,000 -88.00																																																																																																																	
TIF Project ID	0	Total Value	296,150	296,030		32,564	Total Taxable	31,564 3,244.00																																																																																																																	
Bk/Pg	Grantor	Date	Price	Code																																																																																																																					
/	JOHNSON, JERRY & TERRI	09/11/2024	305,000	WG																																																																																																																					
2330/231	NATIONAL RES NOMINEE SERV	05/13/2013	175,000	WG																																																																																																																					
2330/229	BARRETTO, SAVIO J & RACHEL E	04/29/2013	175,000	WG																																																																																																																					
2251/888	O'CONNER, MICHAEL S & SUSAN G	06/18/2012	160,000	WG																																																																																																																					
1071/223	MOSS, TIMOTHY D	06/26/1997	100,000	No																																																																																																																					
Assessment History <table border="1"> <thead> <tr> <th>Tax Year</th> <th>Statement Number</th> <th>Billed Owner</th> <th>Tax Area</th> <th>Total Value</th> <th>Exemptions</th> <th>Taxable Value</th> <th>Billed Tax</th> </tr> </thead> <tbody> <tr><td>2025</td><td>2025-660005745</td><td>MAY, LESLIE S</td><td>11</td><td>287,408</td><td>1000</td><td>30,615</td><td>3,147.00</td></tr> <tr><td>2024</td><td>2024-660005745</td><td>MAY, LESLIE S</td><td>11</td><td>303,410</td><td>1000</td><td>23,016</td><td>2,378.00</td></tr> <tr><td>2023</td><td>2023-660005745</td><td>JOHNSON, JERRY W JR & TERRI D</td><td>11</td><td>211,974</td><td>1000</td><td>22,317</td><td>2,353.00</td></tr> <tr><td>2022</td><td>2022-660005745</td><td>JOHNSON, JERRY W JR & TERRI D</td><td>11</td><td>210,718</td><td>1000</td><td>22,179</td><td>2,353.00</td></tr> <tr><td>2021</td><td>2021-660005745</td><td>JOHNSON, JERRY W JR & TERRI D</td><td>11</td><td>207,354</td><td>1000</td><td>21,809</td><td>2,233.00</td></tr> <tr><td>2020</td><td>2020-660005745</td><td>JOHNSON, JERRY W JR & TERRI D</td><td>11</td><td>206,279</td><td>1000</td><td>21,348</td><td>2,258.00</td></tr> <tr><td>2019</td><td>2019-660005745</td><td>JOHNSON, JERRY W JR & TERRI D</td><td>11</td><td>197,247</td><td>1000</td><td>20,697</td><td>2,160.00</td></tr> <tr><td>2018</td><td>2018-660005745</td><td>JOHNSON, JERRY W JR & TERRI D</td><td>11</td><td>204,237</td><td>1000</td><td>21,466</td><td>2,263.00</td></tr> <tr><td>2017</td><td>2017-660005745</td><td>JOHNSON, JERRY W JR & TERRI D</td><td>11</td><td>202,694</td><td>1000</td><td>21,296</td><td>2,193.00</td></tr> <tr><td>2016</td><td>2016-660005745</td><td>JOHNSON, JERRY W JR & TERRI D</td><td>11</td><td>198,236</td><td>1000</td><td>20,806</td><td>2,156.00</td></tr> <tr><td>2015</td><td>2015-660005745</td><td>JOHNSON, JERRY W JR & TERRI D</td><td>11</td><td>193,025</td><td>1000</td><td>20,233</td><td>2,115.00</td></tr> <tr><td>2014</td><td>2014-660005745</td><td>JOHNSON, JERRY W JR & TERRI D</td><td>11</td><td>157,096</td><td>0</td><td>17,281</td><td>1,797.00</td></tr> <tr><td>2013</td><td>2013-660005745</td><td>JOHNSON, JERRY W JR & TERRI D</td><td>11</td><td>154,117</td><td>1000</td><td>15,953</td><td>1,643.00</td></tr> </tbody> </table>										Tax Year	Statement Number	Billed Owner	Tax Area	Total Value	Exemptions	Taxable Value	Billed Tax	2025	2025-660005745	MAY, LESLIE S	11	287,408	1000	30,615	3,147.00	2024	2024-660005745	MAY, LESLIE S	11	303,410	1000	23,016	2,378.00	2023	2023-660005745	JOHNSON, JERRY W JR & TERRI D	11	211,974	1000	22,317	2,353.00	2022	2022-660005745	JOHNSON, JERRY W JR & TERRI D	11	210,718	1000	22,179	2,353.00	2021	2021-660005745	JOHNSON, JERRY W JR & TERRI D	11	207,354	1000	21,809	2,233.00	2020	2020-660005745	JOHNSON, JERRY W JR & TERRI D	11	206,279	1000	21,348	2,258.00	2019	2019-660005745	JOHNSON, JERRY W JR & TERRI D	11	197,247	1000	20,697	2,160.00	2018	2018-660005745	JOHNSON, JERRY W JR & TERRI D	11	204,237	1000	21,466	2,263.00	2017	2017-660005745	JOHNSON, JERRY W JR & TERRI D	11	202,694	1000	21,296	2,193.00	2016	2016-660005745	JOHNSON, JERRY W JR & TERRI D	11	198,236	1000	20,806	2,156.00	2015	2015-660005745	JOHNSON, JERRY W JR & TERRI D	11	193,025	1000	20,233	2,115.00	2014	2014-660005745	JOHNSON, JERRY W JR & TERRI D	11	157,096	0	17,281	1,797.00	2013	2013-660005745	JOHNSON, JERRY W JR & TERRI D	11	154,117	1000	15,953	1,643.00
Tax Year	Statement Number	Billed Owner	Tax Area	Total Value	Exemptions	Taxable Value	Billed Tax																																																																																																																		
2025	2025-660005745	MAY, LESLIE S	11	287,408	1000	30,615	3,147.00																																																																																																																		
2024	2024-660005745	MAY, LESLIE S	11	303,410	1000	23,016	2,378.00																																																																																																																		
2023	2023-660005745	JOHNSON, JERRY W JR & TERRI D	11	211,974	1000	22,317	2,353.00																																																																																																																		
2022	2022-660005745	JOHNSON, JERRY W JR & TERRI D	11	210,718	1000	22,179	2,353.00																																																																																																																		
2021	2021-660005745	JOHNSON, JERRY W JR & TERRI D	11	207,354	1000	21,809	2,233.00																																																																																																																		
2020	2020-660005745	JOHNSON, JERRY W JR & TERRI D	11	206,279	1000	21,348	2,258.00																																																																																																																		
2019	2019-660005745	JOHNSON, JERRY W JR & TERRI D	11	197,247	1000	20,697	2,160.00																																																																																																																		
2018	2018-660005745	JOHNSON, JERRY W JR & TERRI D	11	204,237	1000	21,466	2,263.00																																																																																																																		
2017	2017-660005745	JOHNSON, JERRY W JR & TERRI D	11	202,694	1000	21,296	2,193.00																																																																																																																		
2016	2016-660005745	JOHNSON, JERRY W JR & TERRI D	11	198,236	1000	20,806	2,156.00																																																																																																																		
2015	2015-660005745	JOHNSON, JERRY W JR & TERRI D	11	193,025	1000	20,233	2,115.00																																																																																																																		
2014	2014-660005745	JOHNSON, JERRY W JR & TERRI D	11	157,096	0	17,281	1,797.00																																																																																																																		
2013	2013-660005745	JOHNSON, JERRY W JR & TERRI D	11	154,117	1000	15,953	1,643.00																																																																																																																		



Rogers

Assessment Property Record Card for Tax Year 2026

Data provided by LISA DELOZIER County Assessor

Date 04/17/2026
 Time 02:23:27
 Page 2

Lot Data		Square-Foot - NBHD 1085 #1	
Lot Size			
Lot Count			
Units Buildable			
Non-Ag Acres	0.9357		
Topography			
Street Access			
Utilities			
Amenities	LAND QUALITY	0	
		0	
Method	Square-Foot		
Base Lot Value	40,758.00 x 3.15 = 128,388		
Factor Value			
Adjustments	0.9383		
Lot Value	120,460		



\\tsclient\T\LOGAN\LOGAN RESIDENTIAL VI\2022-11-8\IMG_001; 11/8/2022

Residential Data	
Type	1 Single Family Residence
Condition	3 - Average
Quality	2.5 - Fair
Architecture	
Style	100% One Story
Exterior Wall	90% Veneer, Masonry 10% Frame, Siding, Wood
Base/Total Area	1,770 / 1,770
Style	100% One Story
HVAC	100% Warmed & Cooled Air
Roof Cover	1 Composition Shingle
Area on Slab	1,770
Fixture/RghIn	14 /
Bed/F/H Bath	3 / 2.5 /
Basement Area	
Garage Type	729 Attached Garage - Unfinished
Remodel	
Year/Eff Age	1984 / 32

GRM Approach	
GRM Code	
Gross Rent	0.00
Indicated Value	

Multiple Regression			
MRA Code	1	Test	
Adjusted R	0.8445		
Indicated Value	228,493	129.09	Per SqFt

Direct Comparables	
Selection Model	A Adam Test
Adjustment Model	1 2022 Residential
Comparables	
Indicated Value	

Cost Approach				Manual : 01/2025			
Base Cost	102.44	Total Misc Impr	+ 17,538				
Roofing Adj	+ 4.37	Garage Cost	+ 18,706				
Subfloor Adj	+ -1.15	Total RCN	= 261,282				
Heat/Cool Adj	+ 11.47	Depreciation (42%)	- 109,738				
Plumbing Adj	+ 10.01	Lump Sums	+ 0				
Basement Adj	+ 0.00	RCNLD	= 151,544				
Adj Base Cost	= 127.14	Lot Value	+ 120,460				
Total Area	x 1,770	Indicated Value	= 272,004				
Adjusted Cost	= 225,038	Value Per SqFt	153.67				

Value Reconciliation			
Selected Approach	Cost Approach		
Improvements	151,544		
Lot Value	120,460		
Indicated Value	272,004	153.67	Per SqFt
Agland Value			
Site Improvements	24,146		
Total Value	296,150	167.32	Total Value Per SqFt

Miscellaneous Improvements								
Code	Description	Sketch ID	Size	Year	Units	Unit Cost	Depr	Value
FPR1	FIREPLACE - RESIDENTIAL 1 STORY	0		1	1	5,095.98		5,096
PRCH	SLAB PORCH - COVERED	13654	366		366	23.12		8,462
PRCH	SLAB PORCH - COVERED	13655	168		168	23.69		3,980



Rogers
Assessment Property Record Card for Tax Year 2026

Data provided by LISA DELOZIER County Assessor

Date 04/17/2026
 Time 02:23:27
 Page 3

Sketch Image

660005745

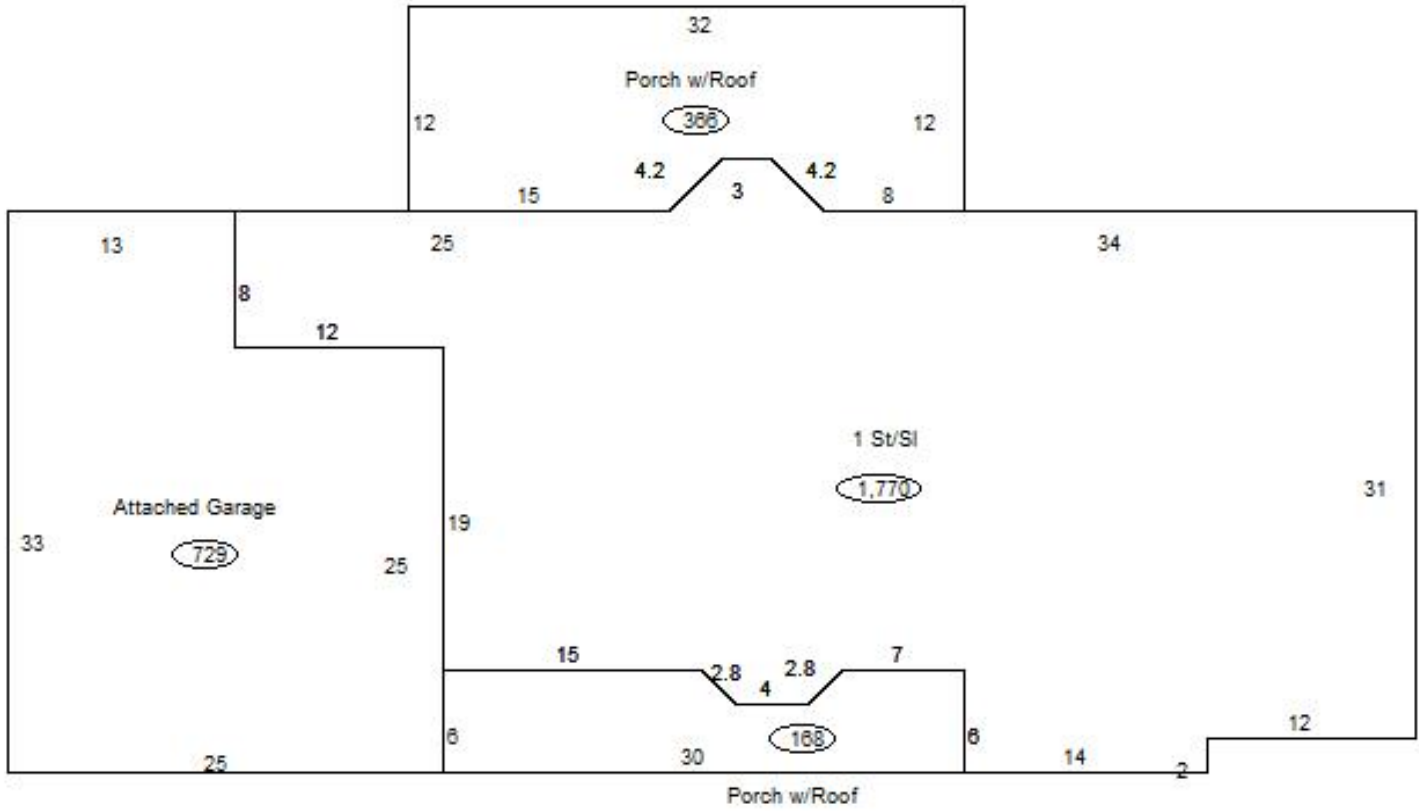

Sketch Vector Information

Sequence	Code	Type	Built Over	Scale	Section Label	Base Area	Multiplier	Total Area
1	R	1	Slab	13	1 St/Sl	1,770	1.000	1,770
2	G	1		13	Attached Garage	729	1.000	729
3	M	PRCH		13	SLBC	366	1.000	366
4	M	PRCH		13	SLBC	168	1.000	168
Total Building Area						1,770		1,770



Rogers



Assessment Property Record Card for Tax Year 2026

Data provided by LISA DELOZIER County Assessor

Date 04/17/2026
 Time 02:23:27
 Page 4

660005745

Outbuildings/Site Improvements

Building Image	Code	Description	Dimensions	Floor	Roofing	Total Units	
	UTIL	SHOP BUILDING	0x0x0			720	
	Qual	2	Cond 3	Year	Eff Age		
	Valuation Summary		Modifier Total		RCN	Depr (10% Phys/ % Func)	RCNLD
	Base Cost (31.28 x 720)		22,522		22,522	2,252	20,270
	LT	LEAN-TO	0x0x0			288	
	Qual	3	Cond 3	Year	Eff Age		
	Valuation Summary		Modifier Total		RCN	Depr (10% Phys/ % Func)	RCNLD
	Base Cost (2.92 x 288)		841		841	84	757
	LT	LEAN-TO	0x0x0			420	
	Qual	3	Cond 3	Year	Eff Age		
	Valuation Summary		Modifier Total		RCN	Depr (10% Phys/ % Func)	RCNLD
	Base Cost (2.92 x 420)		1,226		1,226	123	1,103
	CP	CARPORT DIRT	0x0x0			640	
	Qual	3	Cond 3	Year	Eff Age		
	Valuation Summary		Modifier Total		RCN	Depr (10% Phys/ % Func)	RCNLD
	Base Cost (3.50 x 640)		2,240		2,240	224	2,016