



Rogers

Assessment Property Record Card for Tax Year 2026

Data provided by LISA DELOZIER County Assessor

Date 04/17/2026
 Time 02:23:30
 Page 1

Assessment Data					Primary Image																																																																																																															
Account	660005749																																																																																																																			
Parcel ID	000000-00-0-00615-004-0001																																																																																																																			
Cadastral ID	06-22-16-02240																																																																																																																			
Property Type	REAL - Real Property																																																																																																																			
Property Class	RRP VI Area 1																																																																																																																			
Tax Area	11 - SEQUOYAH/NW FIRE																																																																																																																			
Name ID	260430																																																																																																																			
LEE, JOHN																																																																																																																				
9986 E WALNUT RD CLAREMORE OK 74017-0000																																																																																																																				
Parcel Location Situs 09986 S WALNUT RD Subdivision PONDEROSA EXTENDED 2 Lot/Block 0001 / 0004 Parcel Size 1 - Lots Sec/Twn/Rng 6 / 22 / 16 / 5 Neighborhood 1085 - R-V04-NW SEQUOYAH School District S006 - SEQUOYAH SCHOOLS																																																																																																																				
Legal Description Lat/Long: 36.41801975 -95.64876298																																																																																																																				
Building Permits <table border="1"> <thead> <tr> <th>Number</th> <th>Description</th> <th>Opened</th> <th>Closed</th> <th>Amount</th> </tr> </thead> <tbody> <tr> <td colspan="5"> </td> </tr> </tbody> </table>					Number	Description	Opened	Closed	Amount																																																																																																											
Number	Description	Opened	Closed	Amount																																																																																																																
Exemptions <table border="1"> <thead> <tr> <th>Code</th> <th>Type</th> <th>Active</th> <th>Maximum</th> <th>Exemption</th> </tr> </thead> <tbody> <tr> <td>H</td> <td>Homestead</td> <td>Yes</td> <td>1,000</td> <td>1,000</td> </tr> </tbody> </table>					Code	Type	Active	Maximum	Exemption	H	Homestead	Yes	1,000	1,000																																																																																																						
Code	Type	Active	Maximum	Exemption																																																																																																																
H	Homestead	Yes	1,000	1,000																																																																																																																
Sale History <table border="1"> <thead> <tr> <th>Bk/Pg</th> <th>Grantor</th> <th>Date</th> <th>Price</th> <th>Code</th> </tr> </thead> <tbody> <tr> <td>983/867</td> <td>HALE, BEVERLY J</td> <td>03/06/1995</td> <td>8,000</td> <td>No</td> </tr> <tr> <td>892/138</td> <td>BELL, JOHN PAUL</td> <td>08/27/1992</td> <td>0</td> <td>No</td> </tr> </tbody> </table>					Bk/Pg	Grantor	Date	Price	Code	983/867	HALE, BEVERLY J	03/06/1995	8,000	No	892/138	BELL, JOHN PAUL	08/27/1992	0	No																																																																																																	
Bk/Pg	Grantor	Date	Price	Code																																																																																																																
983/867	HALE, BEVERLY J	03/06/1995	8,000	No																																																																																																																
892/138	BELL, JOHN PAUL	08/27/1992	0	No																																																																																																																
Parcel Valuation <table border="1"> <thead> <tr> <th>Source</th> <th>REAL</th> <th>Fair Cash</th> <th>Capped</th> <th>Asmnt Level</th> <th>Assessed</th> <th>Levy Rate</th> <th>102.332</th> <th>Current Tax</th> </tr> </thead> <tbody> <tr> <td>Remove Cap</td> <td>0</td> <td>Land Value 39,687</td> <td>30,064</td> <td>11%</td> <td>3,307</td> <td>Assessed</td> <td>13,639</td> <td>1,395.70</td> </tr> <tr> <td>Year Frozen</td> <td>2023</td> <td>Improvements 123,989</td> <td>93,927</td> <td></td> <td>10,332</td> <td>Penalty</td> <td>0</td> <td></td> </tr> <tr> <td>Uncapped Value</td> <td>0</td> <td>Mobile Home 0</td> <td>0</td> <td></td> <td>0</td> <td>Exemption</td> <td>1,000</td> <td>-89.00</td> </tr> <tr> <td>TIF Project ID</td> <td>0</td> <td>Total Value 163,676</td> <td>123,991</td> <td></td> <td>13,639</td> <td>Total Taxable</td> <td>12,639</td> <td>1,307.00</td> </tr> </tbody> </table>					Source	REAL	Fair Cash	Capped	Asmnt Level	Assessed	Levy Rate	102.332	Current Tax	Remove Cap	0	Land Value 39,687	30,064	11%	3,307	Assessed	13,639	1,395.70	Year Frozen	2023	Improvements 123,989	93,927		10,332	Penalty	0		Uncapped Value	0	Mobile Home 0	0		0	Exemption	1,000	-89.00	TIF Project ID	0	Total Value 163,676	123,991		13,639	Total Taxable	12,639	1,307.00																																																																			
Source	REAL	Fair Cash	Capped	Asmnt Level	Assessed	Levy Rate	102.332	Current Tax																																																																																																												
Remove Cap	0	Land Value 39,687	30,064	11%	3,307	Assessed	13,639	1,395.70																																																																																																												
Year Frozen	2023	Improvements 123,989	93,927		10,332	Penalty	0																																																																																																													
Uncapped Value	0	Mobile Home 0	0		0	Exemption	1,000	-89.00																																																																																																												
TIF Project ID	0	Total Value 163,676	123,991		13,639	Total Taxable	12,639	1,307.00																																																																																																												
Assessment History <table border="1"> <thead> <tr> <th>Tax Year</th> <th>Statement Number</th> <th>Billed Owner</th> <th>Tax Area</th> <th>Total Value</th> <th>Exemptions</th> <th>Taxable Value</th> <th>Billed Tax</th> </tr> </thead> <tbody> <tr><td>2025</td><td>2025-660005749</td><td>LEE, JOHN</td><td>11</td><td>160,844</td><td>1000</td><td>12,639</td><td>1,307.00</td></tr> <tr><td>2024</td><td>2024-660005749</td><td>LEE, JOHN</td><td>11</td><td>169,220</td><td>1000</td><td>12,639</td><td>1,312.00</td></tr> <tr><td>2023</td><td>2023-660005749</td><td>LEE, JOHN</td><td>11</td><td>151,690</td><td>1000</td><td>12,639</td><td>1,338.00</td></tr> <tr><td>2022</td><td>2022-660005749</td><td>LEE, JOHN</td><td>11</td><td>153,372</td><td>1000</td><td>12,242</td><td>1,305.00</td></tr> <tr><td>2021</td><td>2021-660005749</td><td>LEE, JOHN</td><td>11</td><td>141,455</td><td>1000</td><td>11,856</td><td>1,221.00</td></tr> <tr><td>2020</td><td>2020-660005749</td><td>LEE, JOHN</td><td>11</td><td>140,389</td><td>1000</td><td>11,482</td><td>1,220.00</td></tr> <tr><td>2019</td><td>2019-660005749</td><td>LEE, JOHN</td><td>11</td><td>129,645</td><td>1000</td><td>11,118</td><td>1,167.00</td></tr> <tr><td>2018</td><td>2018-660005749</td><td>LEE, JOHN</td><td>11</td><td>133,334</td><td>1000</td><td>10,765</td><td>1,142.00</td></tr> <tr><td>2017</td><td>2017-660005749</td><td>LEE, JOHN</td><td>11</td><td>132,172</td><td>1000</td><td>10,423</td><td>1,079.00</td></tr> <tr><td>2016</td><td>2016-660005749</td><td>LEE, JOHN</td><td>11</td><td>128,614</td><td>1000</td><td>10,091</td><td>1,053.00</td></tr> <tr><td>2015</td><td>2015-660005749</td><td>LEE, JOHN</td><td>11</td><td>125,246</td><td>1000</td><td>9,767</td><td>1,028.00</td></tr> <tr><td>2014</td><td>2014-660005749</td><td>LEE, JOHN</td><td>11</td><td>127,456</td><td>1000</td><td>9,453</td><td>995.00</td></tr> <tr><td>2013</td><td>2013-660005749</td><td>LEE, JOHN</td><td>11</td><td>119,616</td><td>1000</td><td>9,149</td><td>947.00</td></tr> </tbody> </table>					Tax Year	Statement Number	Billed Owner	Tax Area	Total Value	Exemptions	Taxable Value	Billed Tax	2025	2025-660005749	LEE, JOHN	11	160,844	1000	12,639	1,307.00	2024	2024-660005749	LEE, JOHN	11	169,220	1000	12,639	1,312.00	2023	2023-660005749	LEE, JOHN	11	151,690	1000	12,639	1,338.00	2022	2022-660005749	LEE, JOHN	11	153,372	1000	12,242	1,305.00	2021	2021-660005749	LEE, JOHN	11	141,455	1000	11,856	1,221.00	2020	2020-660005749	LEE, JOHN	11	140,389	1000	11,482	1,220.00	2019	2019-660005749	LEE, JOHN	11	129,645	1000	11,118	1,167.00	2018	2018-660005749	LEE, JOHN	11	133,334	1000	10,765	1,142.00	2017	2017-660005749	LEE, JOHN	11	132,172	1000	10,423	1,079.00	2016	2016-660005749	LEE, JOHN	11	128,614	1000	10,091	1,053.00	2015	2015-660005749	LEE, JOHN	11	125,246	1000	9,767	1,028.00	2014	2014-660005749	LEE, JOHN	11	127,456	1000	9,453	995.00	2013	2013-660005749	LEE, JOHN	11	119,616	1000	9,149	947.00
Tax Year	Statement Number	Billed Owner	Tax Area	Total Value	Exemptions	Taxable Value	Billed Tax																																																																																																													
2025	2025-660005749	LEE, JOHN	11	160,844	1000	12,639	1,307.00																																																																																																													
2024	2024-660005749	LEE, JOHN	11	169,220	1000	12,639	1,312.00																																																																																																													
2023	2023-660005749	LEE, JOHN	11	151,690	1000	12,639	1,338.00																																																																																																													
2022	2022-660005749	LEE, JOHN	11	153,372	1000	12,242	1,305.00																																																																																																													
2021	2021-660005749	LEE, JOHN	11	141,455	1000	11,856	1,221.00																																																																																																													
2020	2020-660005749	LEE, JOHN	11	140,389	1000	11,482	1,220.00																																																																																																													
2019	2019-660005749	LEE, JOHN	11	129,645	1000	11,118	1,167.00																																																																																																													
2018	2018-660005749	LEE, JOHN	11	133,334	1000	10,765	1,142.00																																																																																																													
2017	2017-660005749	LEE, JOHN	11	132,172	1000	10,423	1,079.00																																																																																																													
2016	2016-660005749	LEE, JOHN	11	128,614	1000	10,091	1,053.00																																																																																																													
2015	2015-660005749	LEE, JOHN	11	125,246	1000	9,767	1,028.00																																																																																																													
2014	2014-660005749	LEE, JOHN	11	127,456	1000	9,453	995.00																																																																																																													
2013	2013-660005749	LEE, JOHN	11	119,616	1000	9,149	947.00																																																																																																													



Rogers

Assessment Property Record Card for Tax Year 2026

Data provided by LISA DELOZIER County Assessor

Date 04/17/2026
Time 02:23:31
Page 2

Lot Data	Square-Foot - NBHD 1085 #1	Primary Image
Lot Size Lot Count Units Buildable 9020 Non-Ag Acres 0.2892 Topography Street Access Utilities Amenities LAND QUALITY 0 0 Method Square-Foot Base Lot Value 12,599.00 x 3.15 = 39,687 Factor Value Adjustments 1.0000 Lot Value 39,687		

Residential Data	
Type	1 Single Family Residence
Condition	3 - Average
Quality	2 - Fair
Architecture	
Style	100% One Story
Exterior Wall	40% Veneer, Masonry 60% Frame, Siding, Vinyl
Base/Total Area	1,316 / 1,316
Style	100% One Story
HVAC	100% Warmed & Cooled Air
Roof Cover	1 Composition Shingle
Area on Slab	1,316
Fixture/RghIn	11 /
Bed/F/H Bath	3 / 2.0 /
Basement Area	
Garage Type	462 Attached Garage - Unfinished
Remodel	
Year/Eff Age	1994 / 24

\\tsclient\T\LOGAN\LOGAN RESIDENTIAL VI\2022-11-8\IMG_001: 11/8/2022

GRM Approach	
GRM Code	
Gross Rent	0.00
Indicated Value	

Multiple Regression			
MRA Code	1	Test	
Adusted R	0.8445		
Indicated Value	147,098	111.78	Per SqFt

Direct Comparables	
Selection Model	A Adam Test
Adjustment Model	1 2022 Residential
Comparables	
Indicated Value	

Cost Approach				Manual : 01/2025	
Base Cost	96.05	Total Misc Impr	+	2,222	
Roofing Adj	+ 4.17	Garage Cost	+	10,991	
Subfloor Adj	+ 0.00	Total RCN	=	171,304	
Heat/Cool Adj	+ 10.30	Depreciation (35%)	-	59,956	
Plumbing Adj	+ 9.61	Lump Sums	+	12,641	
Basement Adj	+ 0.00	RCNLD	=	123,989	
Adj Base Cost	= 120.13	Lot Value	+	39,687	
Total Area	x 1,316	Indicated Value	=	163,676	
Adjusted Cost	= 158,091	Value Per SqFt		124.37	

Value Reconciliation			
Selected Approach	Cost Approach		
Improvements	123,989		
Lot Value	39,687		
Indicated Value	163,676	124.37	Per SqFt
Agland Value			
Site Improvements			
Total Value	163,676	124.37	Total Value Per SqFt

Miscellaneous Improvements								
Code	Description	Sketch ID	Size	Year	Units	Unit Cost	Depr	Value
PRCH	SLAB PORCH - COVERED	13662	106		106	20.96		2,222
WODO	WOOD DECK - OPEN	13663	203		203	19.53	6%	3,727
WODC	WOOD DECK - COVERED	13664	358		358	26.49	6%	8,914



Rogers

Assessment Property Record Card for Tax Year 2026

Data provided by LISA DELOZIER County Assessor

Date 04/17/2026
 Time 02:23:31
 Page 3

Sketch Image

660005749

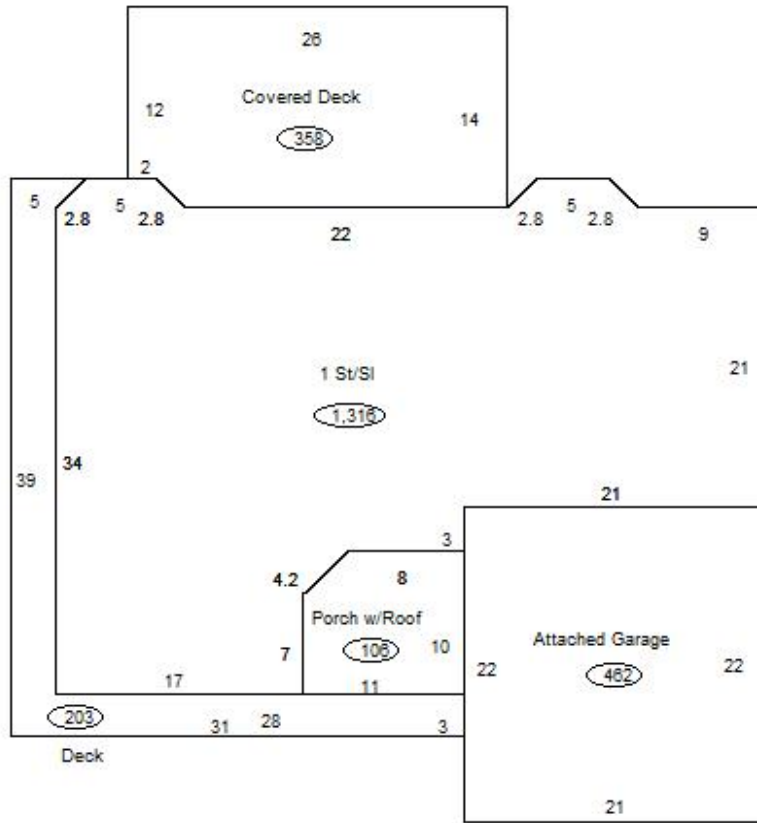

Sketch Vector Information

Sequence	Code	Type	Built Over	Scale	Section Label	Base Area	Multiplier	Total Area
1	R	1	Slab	13	1 St/Sl	1,316	1.000	1,316
2	G	1		13	Attached Garage	462	1.000	462
3	M	PRCH		13	SLBC	106	1.000	106
4	M	WODO		13	WODO	203	1.000	203
5	M	WODC		13	WODC	358	1.000	358
Total Building Area						1,316		1,316