



Rogers

Assessment Property Record Card for Tax Year 2026

Data provided by LISA DELOZIER County Assessor

Date 04/17/2026
 Time 04:17:14
 Page 1

Assessment Data					Primary Image																																																																																																																				
Account 660005995 Parcel ID 000000-00-0-00705-004-0001 Cadastral ID 07-21-15-01570 Property Type REAL - Real Property Property Class RRP VI Area 4 Tax Area 7 - OWASSO/LIMESTONE FIRE Name ID 331561 BAKER, PAUL & JULIE 6795 LAKE RD PONCA CITY OK 74604-0000 Parcel Location Situs 04898 E 486 RD Subdivision ROLLING MEADOWS EXT Lot/Block 0001 / 0004 Parcel Size 1 - Lots Sec/Twn/Rng 7 / 21 / 15 / 5 Neighborhood 1106 - R-V01,4-SW CLAREMORE School District S021 - OWASSO SCHOOLS																																																																																																																									
Legal Description Lot/Long: 36.31244220 -95.74148713 LOT 1 BLOCK 4 ROLLING MEADOWS EXT																																																																																																																									
Exemptions <table border="1"> <thead> <tr> <th>Code</th> <th>Type</th> <th>Active</th> <th>Maximum</th> <th>Exemption</th> </tr> </thead> <tbody> <tr> <td>H</td> <td>Homestead</td> <td>No</td> <td>1,000</td> <td></td> </tr> </tbody> </table>					Code	Type	Active	Maximum	Exemption	H	Homestead	No	1,000		Building Permits <table border="1"> <thead> <tr> <th>Number</th> <th>Description</th> <th>Opened</th> <th>Closed</th> <th>Amount</th> </tr> </thead> <tbody> <tr> <td>R25 022</td> <td>NEW DTCH ACC BLDG 30X40</td> <td>01/2026</td> <td></td> <td>55,350</td> </tr> <tr> <td>R2015 12 12</td> <td>R17-REMODEL OLD HOUSE INTO GAF</td> <td>12/2015</td> <td>09/2016</td> <td>5,000</td> </tr> <tr> <td>R2015 12 11</td> <td>R17-NEW 30X50 1500 SQ FT SFR</td> <td>12/2015</td> <td>09/2016</td> <td>60,000</td> </tr> </tbody> </table>					Number	Description	Opened	Closed	Amount	R25 022	NEW DTCH ACC BLDG 30X40	01/2026		55,350	R2015 12 12	R17-REMODEL OLD HOUSE INTO GAF	12/2015	09/2016	5,000	R2015 12 11	R17-NEW 30X50 1500 SQ FT SFR	12/2015	09/2016	60,000																																																																																		
Code	Type	Active	Maximum	Exemption																																																																																																																					
H	Homestead	No	1,000																																																																																																																						
Number	Description	Opened	Closed	Amount																																																																																																																					
R25 022	NEW DTCH ACC BLDG 30X40	01/2026		55,350																																																																																																																					
R2015 12 12	R17-REMODEL OLD HOUSE INTO GAF	12/2015	09/2016	5,000																																																																																																																					
R2015 12 11	R17-NEW 30X50 1500 SQ FT SFR	12/2015	09/2016	60,000																																																																																																																					
Parcel Valuation <table border="1"> <thead> <tr> <th>Source</th> <th>REAL</th> <th>Fair Cash</th> <th>Capped</th> <th>Asmnt Level</th> <th>Assessed</th> <th>Levy Rate</th> <th>108.538</th> <th>Current Tax</th> </tr> </thead> <tbody> <tr> <td>Remove Cap</td> <td>2021</td> <td>Land Value</td> <td>131,424</td> <td>53,187</td> <td>11%</td> <td>5,851</td> <td>Assessed</td> <td>25,889 2,809.94</td> </tr> <tr> <td>Year Frozen</td> <td>0</td> <td>Improvements</td> <td>221,343</td> <td>182,164</td> <td></td> <td>20,038</td> <td>Penalty</td> <td>0</td> </tr> <tr> <td>Uncapped Value</td> <td>0</td> <td>Mobile Home</td> <td>0</td> <td>0</td> <td></td> <td>0</td> <td>Exemption</td> <td>0 0.00</td> </tr> <tr> <td>TIF Project ID</td> <td>0</td> <td>Total Value</td> <td>352,767</td> <td>235,351</td> <td></td> <td>25,889</td> <td>Total Taxable</td> <td>25,889 2,810.00</td> </tr> </tbody> </table>					Source	REAL	Fair Cash	Capped	Asmnt Level	Assessed	Levy Rate	108.538	Current Tax	Remove Cap	2021	Land Value	131,424	53,187	11%	5,851	Assessed	25,889 2,809.94	Year Frozen	0	Improvements	221,343	182,164		20,038	Penalty	0	Uncapped Value	0	Mobile Home	0	0		0	Exemption	0 0.00	TIF Project ID	0	Total Value	352,767	235,351		25,889	Total Taxable	25,889 2,810.00	Sale History <table border="1"> <thead> <tr> <th>Bk/Pg</th> <th>Grantor</th> <th>Date</th> <th>Price</th> <th>Code</th> </tr> </thead> <tbody> <tr> <td>/</td> <td>EVANS, DILLON & BROOKE</td> <td>08/06/2020</td> <td>180,000</td> <td>YES</td> </tr> <tr> <td>2627/769</td> <td>EVANS, BILLY GENE JR &</td> <td>04/13/2017</td> <td>150,000</td> <td>YES</td> </tr> <tr> <td>2418/321</td> <td>JONES, JOHNNY HEATH &</td> <td>08/07/2014</td> <td>69,500</td> <td>YES</td> </tr> <tr> <td>1156/708</td> <td>SCHMIDT, ALBERT B &</td> <td>02/08/1999</td> <td>30,000</td> <td>No</td> </tr> <tr> <td>878/826</td> <td></td> <td>03/12/1992</td> <td>0</td> <td>No</td> </tr> <tr> <td>854/528</td> <td></td> <td></td> <td>25,500</td> <td>No</td> </tr> </tbody> </table>					Bk/Pg	Grantor	Date	Price	Code	/	EVANS, DILLON & BROOKE	08/06/2020	180,000	YES	2627/769	EVANS, BILLY GENE JR &	04/13/2017	150,000	YES	2418/321	JONES, JOHNNY HEATH &	08/07/2014	69,500	YES	1156/708	SCHMIDT, ALBERT B &	02/08/1999	30,000	No	878/826		03/12/1992	0	No	854/528			25,500	No																																
Source	REAL	Fair Cash	Capped	Asmnt Level	Assessed	Levy Rate	108.538	Current Tax																																																																																																																	
Remove Cap	2021	Land Value	131,424	53,187	11%	5,851	Assessed	25,889 2,809.94																																																																																																																	
Year Frozen	0	Improvements	221,343	182,164		20,038	Penalty	0																																																																																																																	
Uncapped Value	0	Mobile Home	0	0		0	Exemption	0 0.00																																																																																																																	
TIF Project ID	0	Total Value	352,767	235,351		25,889	Total Taxable	25,889 2,810.00																																																																																																																	
Bk/Pg	Grantor	Date	Price	Code																																																																																																																					
/	EVANS, DILLON & BROOKE	08/06/2020	180,000	YES																																																																																																																					
2627/769	EVANS, BILLY GENE JR &	04/13/2017	150,000	YES																																																																																																																					
2418/321	JONES, JOHNNY HEATH &	08/07/2014	69,500	YES																																																																																																																					
1156/708	SCHMIDT, ALBERT B &	02/08/1999	30,000	No																																																																																																																					
878/826		03/12/1992	0	No																																																																																																																					
854/528			25,500	No																																																																																																																					
Assessment History <table border="1"> <thead> <tr> <th>Tax Year</th> <th>Statement Number</th> <th>Billed Owner</th> <th>Tax Area</th> <th>Total Value</th> <th>Exemptions</th> <th>Taxable Value</th> <th>Billed Tax</th> </tr> </thead> <tbody> <tr><td>2025</td><td>2025-660005995</td><td>BAKER, PAUL & JULIE</td><td>7</td><td>335,368</td><td>0</td><td>24,656</td><td>2,676.00</td></tr> <tr><td>2024</td><td>2024-660005995</td><td>BAKER, PAUL & JULIE</td><td>7</td><td>341,754</td><td>0</td><td>23,482</td><td>2,591.00</td></tr> <tr><td>2023</td><td>2023-660005995</td><td>BAKER, PAUL & JULIE</td><td>7</td><td>222,943</td><td>0</td><td>22,364</td><td>2,415.00</td></tr> <tr><td>2022</td><td>2022-660005995</td><td>BAKER, PAUL & JULIE</td><td>7</td><td>214,161</td><td>0</td><td>21,299</td><td>2,391.00</td></tr> <tr><td>2021</td><td>2021-660005995</td><td>BAKER, PAUL & JULIE</td><td>7</td><td>187,986</td><td>0</td><td>20,678</td><td>2,295.00</td></tr> <tr><td>2020</td><td>2020-660005995</td><td>BAKER, PAUL & JULIE</td><td>7</td><td>155,904</td><td>1000</td><td>15,653</td><td>1,750.00</td></tr> <tr><td>2019</td><td>2019-660005995</td><td>EVANS, DILLON & BROOKE</td><td>7</td><td>146,977</td><td>1000</td><td>15,168</td><td>1,697.00</td></tr> <tr><td>2018</td><td>2018-660005995</td><td>EVANS, DILLON & BROOKE</td><td>7</td><td>151,944</td><td>1000</td><td>15,714</td><td>1,702.00</td></tr> <tr><td>2017</td><td>2017-660005995</td><td>EVANS, DILLON & BROOKE</td><td>7</td><td>187,429</td><td>0</td><td>20,617</td><td>2,233.00</td></tr> <tr><td>2016</td><td>2016-660005995</td><td>EVANS, BILLY GENE JR &</td><td>7</td><td>60,811</td><td>0</td><td>6,689</td><td>726.00</td></tr> <tr><td>2015</td><td>2015-660005995</td><td>EVANS, BILLY GENE JR &</td><td>7</td><td>71,407</td><td>0</td><td>7,855</td><td>857.00</td></tr> <tr><td>2014</td><td>2014-660005995</td><td>EVANS, BILLY GENE JR &</td><td>7</td><td>74,592</td><td>0</td><td>4,797</td><td>528.00</td></tr> <tr><td>2013</td><td>2013-660005995</td><td>JONES, JOHNNY HEATH &</td><td>7</td><td>74,270</td><td>0</td><td>4,568</td><td>493.00</td></tr> </tbody> </table>										Tax Year	Statement Number	Billed Owner	Tax Area	Total Value	Exemptions	Taxable Value	Billed Tax	2025	2025-660005995	BAKER, PAUL & JULIE	7	335,368	0	24,656	2,676.00	2024	2024-660005995	BAKER, PAUL & JULIE	7	341,754	0	23,482	2,591.00	2023	2023-660005995	BAKER, PAUL & JULIE	7	222,943	0	22,364	2,415.00	2022	2022-660005995	BAKER, PAUL & JULIE	7	214,161	0	21,299	2,391.00	2021	2021-660005995	BAKER, PAUL & JULIE	7	187,986	0	20,678	2,295.00	2020	2020-660005995	BAKER, PAUL & JULIE	7	155,904	1000	15,653	1,750.00	2019	2019-660005995	EVANS, DILLON & BROOKE	7	146,977	1000	15,168	1,697.00	2018	2018-660005995	EVANS, DILLON & BROOKE	7	151,944	1000	15,714	1,702.00	2017	2017-660005995	EVANS, DILLON & BROOKE	7	187,429	0	20,617	2,233.00	2016	2016-660005995	EVANS, BILLY GENE JR &	7	60,811	0	6,689	726.00	2015	2015-660005995	EVANS, BILLY GENE JR &	7	71,407	0	7,855	857.00	2014	2014-660005995	EVANS, BILLY GENE JR &	7	74,592	0	4,797	528.00	2013	2013-660005995	JONES, JOHNNY HEATH &	7	74,270	0	4,568	493.00
Tax Year	Statement Number	Billed Owner	Tax Area	Total Value	Exemptions	Taxable Value	Billed Tax																																																																																																																		
2025	2025-660005995	BAKER, PAUL & JULIE	7	335,368	0	24,656	2,676.00																																																																																																																		
2024	2024-660005995	BAKER, PAUL & JULIE	7	341,754	0	23,482	2,591.00																																																																																																																		
2023	2023-660005995	BAKER, PAUL & JULIE	7	222,943	0	22,364	2,415.00																																																																																																																		
2022	2022-660005995	BAKER, PAUL & JULIE	7	214,161	0	21,299	2,391.00																																																																																																																		
2021	2021-660005995	BAKER, PAUL & JULIE	7	187,986	0	20,678	2,295.00																																																																																																																		
2020	2020-660005995	BAKER, PAUL & JULIE	7	155,904	1000	15,653	1,750.00																																																																																																																		
2019	2019-660005995	EVANS, DILLON & BROOKE	7	146,977	1000	15,168	1,697.00																																																																																																																		
2018	2018-660005995	EVANS, DILLON & BROOKE	7	151,944	1000	15,714	1,702.00																																																																																																																		
2017	2017-660005995	EVANS, DILLON & BROOKE	7	187,429	0	20,617	2,233.00																																																																																																																		
2016	2016-660005995	EVANS, BILLY GENE JR &	7	60,811	0	6,689	726.00																																																																																																																		
2015	2015-660005995	EVANS, BILLY GENE JR &	7	71,407	0	7,855	857.00																																																																																																																		
2014	2014-660005995	EVANS, BILLY GENE JR &	7	74,592	0	4,797	528.00																																																																																																																		
2013	2013-660005995	JONES, JOHNNY HEATH &	7	74,270	0	4,568	493.00																																																																																																																		



Rogers

Assessment Property Record Card for Tax Year 2026

Data provided by LISA DELOZIER County Assessor

Date 04/17/2026
Time 04:17:14
Page 2

Lot Data		Square-Foot - NBHD 1106 #1	
Lot Size			
Lot Count			
Units Buildable	1		
Non-Ag Acres	4.5631		
Topography			
Street Access			
Utilities			
Amenities		0	
		0	
Method	Square-Foot		
Base Lot Value	198,768.00 x .66 =	131,424	
Factor Value			
Adjustments	1.0000		
Lot Value		131,424	



\\tsclient\C\Users\Randy Necessary\Pictures\101_0503\IMG_0064. 5/4/2022

Residential Data	
Type	1 Single Family Residence
Condition	3 - Average
Quality	2.5 - Fair
Architecture	
Style	100% One Story
Exterior Wall	100% Frame, Siding, Metal
Base/Total Area	1,500 / 1,500
Style	100% One Story
HVAC	100% Warmed & Cooled Air
Roof Cover	1 Composition Shingle
Area on Slab	1,500
Fixture/RghIn	11 /
Bed/F/H Bath	3 / 2.0 /
Basement Area	
Garage Type	
Remodel	
Year/Eff Age	2016 / 8

GRM Approach	
GRM Code	
Gross Rent	0.00
Indicated Value	

Multiple Regression			
MRA Code	1	Test	
Adusted R	0.8445		
Indicated Value	212,713	141.81	Per SqFt

Direct Comparables	
Selection Model	A Adam Test
Adjustment Model	1 2022 Residential
Comparables	
Indicated Value	

Cost Approach				Manual : 01/2025			
Base Cost	91.49	Total Misc Impr	+ 18,020				
Roofing Adj	+ 4.21	Garage Cost	+ 0				
Subfloor Adj	+ -1.09	Total RCN	= 191,210				
Heat/Cool Adj	+ 11.47	Depreciation (9%)	- 17,209				
Plumbing Adj	+ 9.38	Lump Sums	+ 0				
Basement Adj	+ 0.00	RCNLD	= 174,001				
Adj Base Cost	= 115.46	Lot Value	+ 131,424				
Total Area	x 1,500	Indicated Value	= 305,425				
Adjusted Cost	= 173,190	Value Per SqFt	203.62				

Value Reconciliation			
Selected Approach	Cost Approach		
Improvements	174,001		
Lot Value	131,424		
Indicated Value	305,425	203.62	Per SqFt
Agland Value			
Site Improvements	47,342		
Total Value	352,767	235.18	Total Value Per SqFt

Miscellaneous Improvements								
Code	Description	Sketch ID	Size	Year	Units	Unit Cost	Depr	Value
PRCH	SLAB PORCH - COVERED	129327	50x10		500	22.86		11,430
PATO	Slab Porch - Open	129328	32x16		512	8.13		4,163
PATO	Slab Porch - Open	153426	277		277	8.76		2,427



Rogers
Assessment Property Record Card for Tax Year 2026

Data provided by LISA DELOZIER County Assessor

Date 04/17/2026
 Time 04:17:14
 Page 3

Sketch Image

660005995

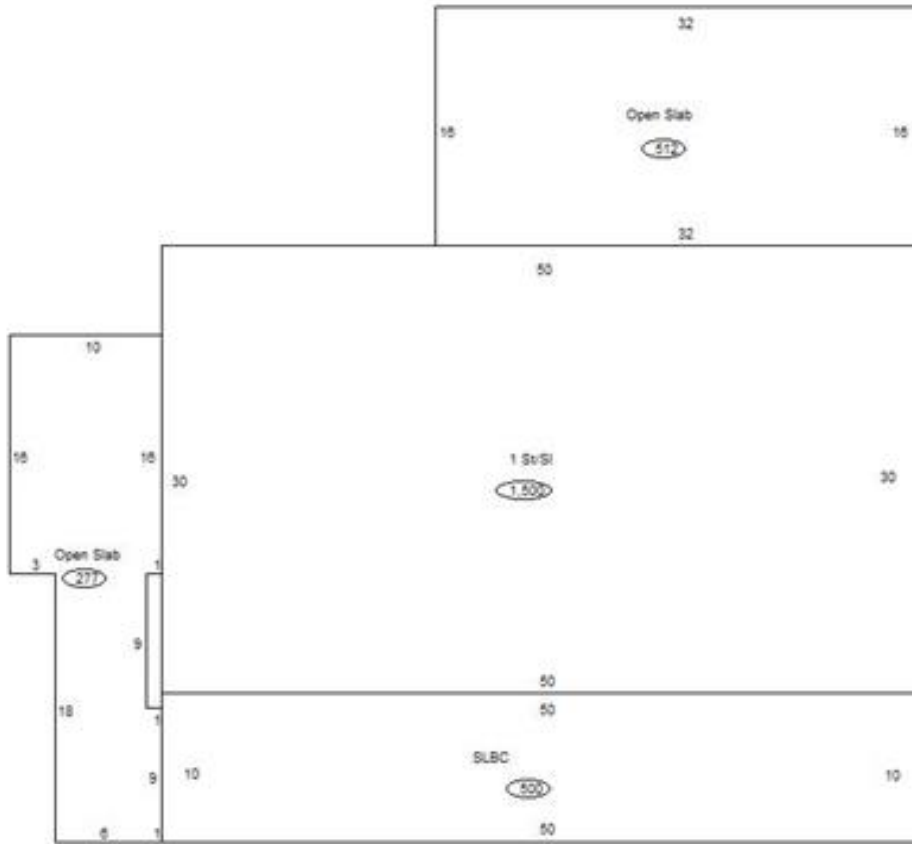

Sketch Vector Information

Sequence	Code	Type	Built Over	Scale	Section Label	Base Area	Multiplier	Total Area
1	R	1	Slab	10	1 St/SI	1,500	1.000	1,500
2	M	PRCH		10	SLBC	500	1.000	500
3	M	PATO		10	Open Slab	512	1.000	512
4	M	PATO		10	Open Slab	277	1.000	277
Total Building Area						1,500		1,500



Rogers



Assessment Property Record Card for Tax Year 2026

Data provided by LISA DELOZIER County Assessor

Date 04/17/2026
 Time 04:17:14
 Page 4

660005995

Outbuildings/Site Improvements

Building Image	Code	Description	Dimensions	Floor	Roofing	Total Units
	UTIL	SHOP BUILDING	50x30x0			1,500
	Qual	Cond	Year	2017	Eff Age	
	Valuation Summary		Modifier Total		RCN	Depr (0% Phys/ % Func)
Base Cost (31.48 x 1,500)		47,220			47,220	47,220
	STF	STG FAIR	0x0x0			
	Qual	Cond	Year		Eff Age	
	Valuation Summary		Modifier Total		RCN	Depr (100% Phys/ % Func)
Base Cost (4.68 x)						
	LF	LOAFING SHED	6x8x0			48
	Qual	Cond	Year		Eff Age	
	Valuation Summary		Modifier Total		RCN	Depr (40% Phys/ % Func)
Base Cost (4.26 x 48)		204			204	82
						122