



Rogers

Assessment Property Record Card for Tax Year 2026

Data provided by LISA DELOZIER County Assessor

Date 04/17/2026
Time 02:04:46
Page 1

Assessment Data					Primary Image																																																																																																																				
Account 660006017 Parcel ID 000000-00-0-00705-005-0005 Cadastral ID 07-21-15-01800 Property Type REAL - Real Property Property Class RRP VI Area 4 Tax Area 7 - OWASSO/LIMESTONE FIRE Name ID 113134 MEEKS, CHARLES R 4843 E 486 RD CLAREMORE OK 74019-5725 Parcel Location Situs 04843 E 486 RD Subdivision ROLLING MEADOWS EXT Lot/Block 0005 / 0005 Parcel Size 1 - Lots Sec/Twn/Rng 7 / 21 / 15 / 5 Neighborhood 1106 - R-V01,4-SW CLAREMORE School District S021 - OWASSO SCHOOLS																																																																																																																									
Legal Description Lot/Long: 36.31386601 -95.74313057																																																																																																																									
Legal Description LOT 5 BLOCK 5 ROLLING MEADOWS EXT					Building Permits <table border="1"> <thead> <tr> <th>Number</th> <th>Description</th> <th>Opened</th> <th>Closed</th> <th>Amount</th> </tr> </thead> <tbody> <tr> <td>9900</td> <td>R8-NEW 1500 SQ FT MH</td> <td>01/2006</td> <td>06/2007</td> <td>3,000</td> </tr> </tbody> </table>					Number	Description	Opened	Closed	Amount	9900	R8-NEW 1500 SQ FT MH	01/2006	06/2007	3,000																																																																																																						
Number	Description	Opened	Closed	Amount																																																																																																																					
9900	R8-NEW 1500 SQ FT MH	01/2006	06/2007	3,000																																																																																																																					
Exemptions <table border="1"> <thead> <tr> <th>Code</th> <th>Type</th> <th>Active</th> <th>Maximum</th> <th>Exemption</th> </tr> </thead> <tbody> <tr> <td>H</td> <td>Homestead</td> <td>Yes</td> <td>1,000</td> <td>1,000</td> </tr> <tr> <td>PD</td> <td>Add-Homestead</td> <td>Yes</td> <td>1,000</td> <td>1,000</td> </tr> </tbody> </table>					Code	Type	Active	Maximum	Exemption	H	Homestead	Yes	1,000	1,000	PD	Add-Homestead	Yes	1,000	1,000	Sale History <table border="1"> <thead> <tr> <th>Bk/Pg</th> <th>Grantor</th> <th>Date</th> <th>Price</th> <th>Code</th> </tr> </thead> <tbody> </tbody> </table>					Bk/Pg	Grantor	Date	Price	Code																																																																																												
Code	Type	Active	Maximum	Exemption																																																																																																																					
H	Homestead	Yes	1,000	1,000																																																																																																																					
PD	Add-Homestead	Yes	1,000	1,000																																																																																																																					
Bk/Pg	Grantor	Date	Price	Code																																																																																																																					
Parcel Valuation <table border="1"> <thead> <tr> <th>Source</th> <th>REAL</th> <th>Fair Cash</th> <th>Capped</th> <th>Asmnt Level</th> <th>Assessed</th> <th>Levy Rate</th> <th>108.538</th> <th>Current Tax</th> </tr> </thead> <tbody> <tr> <td>Remove Cap</td> <td>0</td> <td>Land Value 135,530</td> <td>41,209</td> <td>11%</td> <td>4,533</td> <td>Assessed</td> <td>10,442</td> <td>1,133.35</td> </tr> <tr> <td>Year Frozen</td> <td>2009</td> <td>Improvements 176,687</td> <td>53,723</td> <td></td> <td>5,909</td> <td>Penalty</td> <td>0</td> <td></td> </tr> <tr> <td>Uncapped Value</td> <td>0</td> <td>Mobile Home 0</td> <td>0</td> <td></td> <td>0</td> <td>Exemption</td> <td>2,000</td> <td>-196.00</td> </tr> <tr> <td>TIF Project ID</td> <td>0</td> <td>Total Value 312,217</td> <td>94,932</td> <td></td> <td>10,442</td> <td>Total Taxable</td> <td>8,442</td> <td>937.00</td> </tr> </tbody> </table>										Source	REAL	Fair Cash	Capped	Asmnt Level	Assessed	Levy Rate	108.538	Current Tax	Remove Cap	0	Land Value 135,530	41,209	11%	4,533	Assessed	10,442	1,133.35	Year Frozen	2009	Improvements 176,687	53,723		5,909	Penalty	0		Uncapped Value	0	Mobile Home 0	0		0	Exemption	2,000	-196.00	TIF Project ID	0	Total Value 312,217	94,932		10,442	Total Taxable	8,442	937.00																																																																			
Source	REAL	Fair Cash	Capped	Asmnt Level	Assessed	Levy Rate	108.538	Current Tax																																																																																																																	
Remove Cap	0	Land Value 135,530	41,209	11%	4,533	Assessed	10,442	1,133.35																																																																																																																	
Year Frozen	2009	Improvements 176,687	53,723		5,909	Penalty	0																																																																																																																		
Uncapped Value	0	Mobile Home 0	0		0	Exemption	2,000	-196.00																																																																																																																	
TIF Project ID	0	Total Value 312,217	94,932		10,442	Total Taxable	8,442	937.00																																																																																																																	
Assessment History <table border="1"> <thead> <tr> <th>Tax Year</th> <th>Statement Number</th> <th>Billed Owner</th> <th>Tax Area</th> <th>Total Value</th> <th>Exemptions</th> <th>Taxable Value</th> <th>Billed Tax</th> </tr> </thead> <tbody> <tr><td>2025</td><td>2025-660006017</td><td>MEEKS, CHARLES R</td><td>7</td><td>297,796</td><td>2000</td><td>8,443</td><td>937.00</td></tr> <tr><td>2024</td><td>2024-660006017</td><td>MEEKS, CHARLES R</td><td>7</td><td>307,038</td><td>2000</td><td>8,442</td><td>960.00</td></tr> <tr><td>2023</td><td>2023-660006017</td><td>MEEKS, CHARLES R</td><td>7</td><td>214,512</td><td>2000</td><td>8,443</td><td>940.00</td></tr> <tr><td>2022</td><td>2022-660006017</td><td>MEEKS, CHARLES R</td><td>7</td><td>199,929</td><td>2000</td><td>8,443</td><td>976.00</td></tr> <tr><td>2021</td><td>2021-660006017</td><td>MEEKS, CHARLES R</td><td>7</td><td>198,186</td><td>2000</td><td>8,442</td><td>966.00</td></tr> <tr><td>2020</td><td>2020-660006017</td><td>MEEKS, CHARLES R</td><td>7</td><td>195,753</td><td>2000</td><td>8,443</td><td>965.00</td></tr> <tr><td>2019</td><td>2019-660006017</td><td>MEEKS, CHARLES R</td><td>7</td><td>192,193</td><td>2000</td><td>8,443</td><td>965.00</td></tr> <tr><td>2018</td><td>2018-660006017</td><td>MEEKS, CHARLES R</td><td>7</td><td>201,070</td><td>2000</td><td>8,442</td><td>935.00</td></tr> <tr><td>2017</td><td>2017-660006017</td><td>MEEKS, CHARLES R</td><td>7</td><td>199,752</td><td>2000</td><td>8,443</td><td>943.00</td></tr> <tr><td>2016</td><td>2016-660006017</td><td>MEEKS, CHARLES R</td><td>7</td><td>195,915</td><td>2000</td><td>8,442</td><td>944.00</td></tr> <tr><td>2015</td><td>2015-660006017</td><td>MEEKS, CHARLES R</td><td>7</td><td>194,609</td><td>2000</td><td>8,443</td><td>950.00</td></tr> <tr><td>2014</td><td>2014-660006017</td><td>MEEKS, CHARLES R</td><td>7</td><td>194,924</td><td>2000</td><td>8,442</td><td>957.00</td></tr> <tr><td>2013</td><td>2013-660006017</td><td>MEEKS, CHARLES R</td><td>7</td><td>188,771</td><td>2000</td><td>8,442</td><td>940.00</td></tr> </tbody> </table>										Tax Year	Statement Number	Billed Owner	Tax Area	Total Value	Exemptions	Taxable Value	Billed Tax	2025	2025-660006017	MEEKS, CHARLES R	7	297,796	2000	8,443	937.00	2024	2024-660006017	MEEKS, CHARLES R	7	307,038	2000	8,442	960.00	2023	2023-660006017	MEEKS, CHARLES R	7	214,512	2000	8,443	940.00	2022	2022-660006017	MEEKS, CHARLES R	7	199,929	2000	8,443	976.00	2021	2021-660006017	MEEKS, CHARLES R	7	198,186	2000	8,442	966.00	2020	2020-660006017	MEEKS, CHARLES R	7	195,753	2000	8,443	965.00	2019	2019-660006017	MEEKS, CHARLES R	7	192,193	2000	8,443	965.00	2018	2018-660006017	MEEKS, CHARLES R	7	201,070	2000	8,442	935.00	2017	2017-660006017	MEEKS, CHARLES R	7	199,752	2000	8,443	943.00	2016	2016-660006017	MEEKS, CHARLES R	7	195,915	2000	8,442	944.00	2015	2015-660006017	MEEKS, CHARLES R	7	194,609	2000	8,443	950.00	2014	2014-660006017	MEEKS, CHARLES R	7	194,924	2000	8,442	957.00	2013	2013-660006017	MEEKS, CHARLES R	7	188,771	2000	8,442	940.00
Tax Year	Statement Number	Billed Owner	Tax Area	Total Value	Exemptions	Taxable Value	Billed Tax																																																																																																																		
2025	2025-660006017	MEEKS, CHARLES R	7	297,796	2000	8,443	937.00																																																																																																																		
2024	2024-660006017	MEEKS, CHARLES R	7	307,038	2000	8,442	960.00																																																																																																																		
2023	2023-660006017	MEEKS, CHARLES R	7	214,512	2000	8,443	940.00																																																																																																																		
2022	2022-660006017	MEEKS, CHARLES R	7	199,929	2000	8,443	976.00																																																																																																																		
2021	2021-660006017	MEEKS, CHARLES R	7	198,186	2000	8,442	966.00																																																																																																																		
2020	2020-660006017	MEEKS, CHARLES R	7	195,753	2000	8,443	965.00																																																																																																																		
2019	2019-660006017	MEEKS, CHARLES R	7	192,193	2000	8,443	965.00																																																																																																																		
2018	2018-660006017	MEEKS, CHARLES R	7	201,070	2000	8,442	935.00																																																																																																																		
2017	2017-660006017	MEEKS, CHARLES R	7	199,752	2000	8,443	943.00																																																																																																																		
2016	2016-660006017	MEEKS, CHARLES R	7	195,915	2000	8,442	944.00																																																																																																																		
2015	2015-660006017	MEEKS, CHARLES R	7	194,609	2000	8,443	950.00																																																																																																																		
2014	2014-660006017	MEEKS, CHARLES R	7	194,924	2000	8,442	957.00																																																																																																																		
2013	2013-660006017	MEEKS, CHARLES R	7	188,771	2000	8,442	940.00																																																																																																																		



Rogers

Assessment Property Record Card for Tax Year 2026

Data provided by LISA DELOZIER County Assessor

Date 04/17/2026
Time 02:04:46
Page 2

Lot Data	Square-Foot - NBHD 1106 #1	Primary Image
Lot Size		
Lot Count		
Units Buildable	1	
Non-Ag Acres	4.8324	
Topography		
Street Access		
Utilities		
Amenities	0	
	0	
Method	Square-Foot	
Base Lot Value	210,500.00 x .64 = 135,530	
Factor Value		
Adjustments	1.0000	
Lot Value	135,530	

Residential Data	
Type	1 Single Family Residence
Condition	3 - Average
Quality	2.5 - Fair
Architecture	
Style	100% One Story
Exterior Wall	100% Veneer, Stone
Base/Total Area	2,100 / 2,100
Style	100% One Story
HVAC	100% Warmed & Cooled Air
Roof Cover	1 Composition Shingle
Area on Slab	0
Fixture/RghIn	8 /
Bed/F/H Bath	3 / 2.0 /
Basement Area	
Garage Type	960 Attached Garage - Unfinished
Remodel	
Year/Eff Age	1967 / 44

\\tsclient\C\Users\Randy Necessary\Pictures\101_0506\IMG_0105. 5/9/2022

GRM Approach	
GRM Code	
Gross Rent	0.00
Indicated Value	

Multiple Regression			
MRA Code	1	Test	
Adusted R	0.8445		
Indicated Value	265,547	126.45	Per SqFt

Direct Comparables			
Selection Model	A	Adam Test	
Adjustment Model	1	2022 Residential	
Comparables	3		
Indicated Value	438,730		Per SqFt

Cost Approach				Manual : 01/2025			
Base Cost	102.02	Total Misc Impr	+	8,937			
Roofing Adj	+ 4.14	Garage Cost	+	24,634			
Subfloor Adj	+ 1.21	Total RCN	=	293,572			
Heat/Cool Adj	+ 11.47	Depreciation (52%)	-	152,657			
Plumbing Adj	+ 4.97	Lump Sums	+	0			
Basement Adj	+ 0.00	RCNLD	=	140,915			
Adj Base Cost	= 123.81	Lot Value	+	135,530			
Total Area	x 2,100	Indicated Value	=	276,445			
Adjusted Cost	= 260,001	Value Per SqFt		131.64			

Value Reconciliation			
Selected Approach	Cost Approach		
Improvements	140,915		
Lot Value	135,530		
Indicated Value	276,445	131.64	Per SqFt
Agland Value			
Site Improvements	35,772		
Total Value	312,217	148.67	Total Value Per SqFt

Miscellaneous Improvements								
Code	Description	Sketch ID	Size	Year	Units	Unit Cost	Depr	Value
FPR1	FIREPLACE - RESIDENTIAL 1 STORY	0		1	1	5,095.98		5,096
PRCH	SLAB PORCH - COVERED	14140	27x6		162	23.71		3,841



Rogers

Assessment Property Record Card for Tax Year 2026

Data provided by LISA DELOZIER County Assessor

Date 04/17/2026
 Time 02:04:46
 Page 3

Sketch Image

660006017

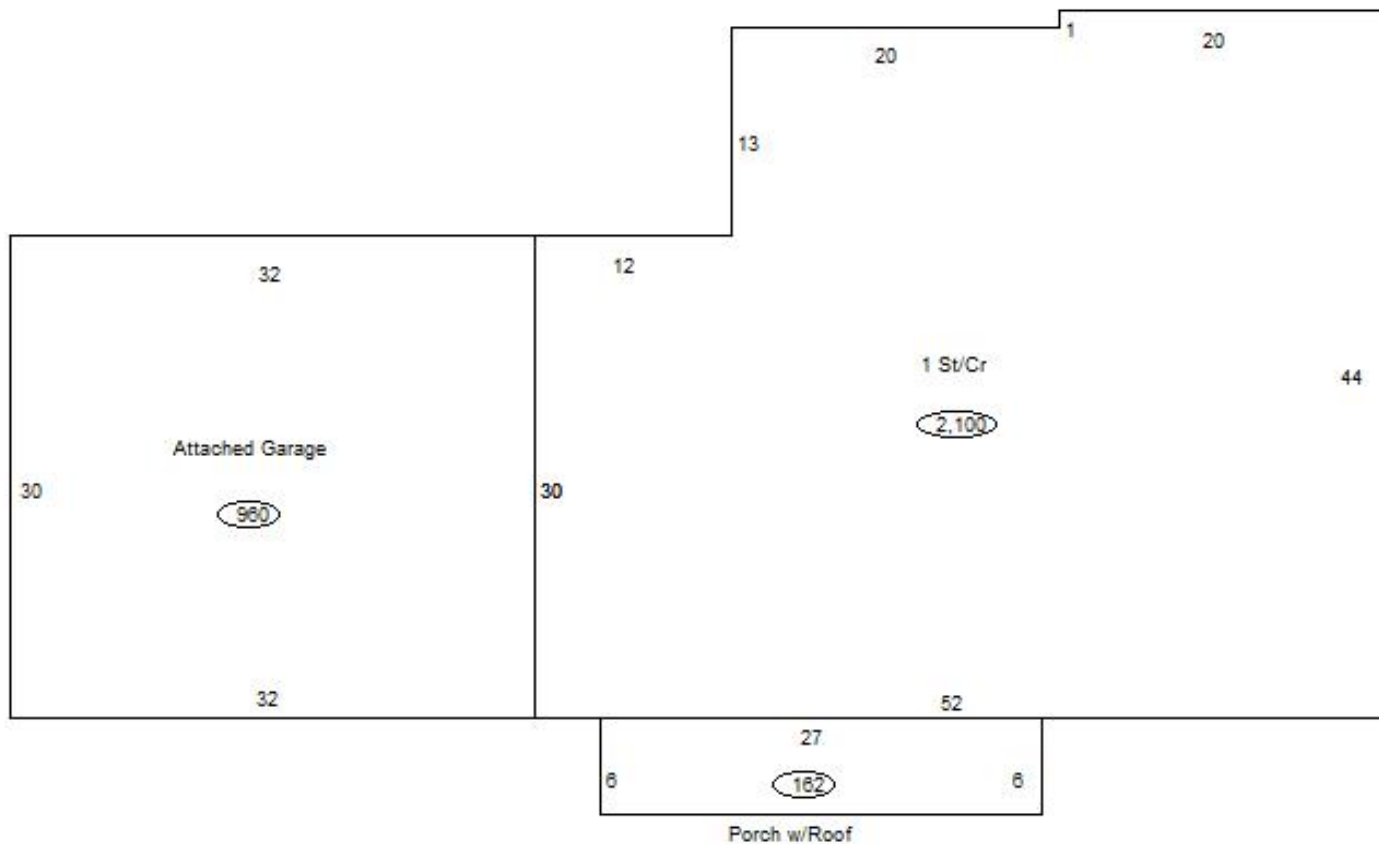

Sketch Vector Information

Sequence	Code	Type	Built Over	Scale	Section Label	Base Area	Multiplier	Total Area
1	G	1		13	Attached Garage	960	1.000	960
2	M	PRCH		13	SLBC	162	1.000	162
3	R	1	Crawl	13	1 St/Cr	2,100	1.000	2,100
Total Building Area						2,100		2,100



Rogers



Assessment Property Record Card for Tax Year 2026

Data provided by LISA DELOZIER County Assessor

Date 04/17/2026
 Time 02:04:46
 Page 4

660006017

Outbuildings/Site Improvements

Building Image	Code	Description	Dimensions	Floor	Roofing	Total Units
	UTIL	SHOP BUILDING	0x0x0			1,600
	Qual 2	Cond 3	Year	Eff Age		
	Valuation Summary Base Cost (28.35 x 1,600) 45,360		Modifier Total	RCN	Depr (25% Phys/ % Func)	RCNLD
				45,360	11,340	34,020
	STF	STG FAIR	18x26x0			468
	Qual 2	Cond 3	Year	Eff Age 1520		
	Valuation Summary Base Cost (4.68 x 468) 2,190		Modifier Total	RCN	Depr (20% Phys/ % Func)	RCNLD
				2,190	438	1,752
	LF	LOAFING SHED	0x0x0			
	Qual 2	Cond 2	Year	Eff Age		
	Valuation Summary Base Cost (4.26 x)		Modifier Total	RCN	Depr (100% Phys/ % Func)	RCNLD