



# Rogers

## Assessment Property Record Card for Tax Year 2026

Data provided by LISA DELOZIER County Assessor

Date 04/17/2026  
 Time 06:33:25  
 Page 1

Assessment Data				Primary Image																																																																																																																					
<b>Account</b> 660006038 <b>Parcel ID</b> 000000-00-0-00702-001-0008 <b>Cadastral ID</b> 07-21-15-02010 <b>Property Type</b> REAL - Real Property <b>Property Class</b> RRP VI Area 4 <b>Tax Area</b> 7 - OWASSO/LIMESTONE FIRE <b>Name ID</b> 284185 SMITH, MARK A  4164 E HWY 20 COLLINSVILLE OK 74021-0000  <b>Parcel Location</b> <b>Situs</b> 04164 E HWY 20 <b>Subdivision</b> ROLLING MEADOWS EXT 2 <b>Lot/Block</b> 0008 / 0001 <b>Parcel Size</b> .9 - Lots <b>Sec/Twn/Rng</b> 7 / 21 / 15 / 5 <b>Neighborhood</b> 1106 - R-V01,4-SW CLAREMORE <b>School District</b> S021 - OWASSO SCHOOLS				<p>\\tsclient\C\Users\Randy Necessary\Pictures\101_0509\IMG_0030. 5/9/2022</p>																																																																																																																					
<b>Legal Description</b> Lat/Long: 36.32089860 -95.75572835 LOT 8 BLOCK 1 ROLLING MEADOWS EXT 2 LESS STRIP DEEDED TO ODOT FOR HWY 20 DESC AS BEG AR NW/C THEREOF; TH N88-0532E 213.10'; TH S01-4725E 57.20'; TH S82-2210W 184.16' S88.0448W 29.90'; TH N01-4725W 75.57' TO POB.				<b>Building Permits</b> <table border="1"> <thead> <tr> <th>Number</th> <th>Description</th> <th>Opened</th> <th>Closed</th> <th>Amount</th> </tr> </thead> <tbody> <tr> <td>R2011 08 2</td> <td>R13-NEW 18X40 720 SQ FT ADDITION</td> <td>08/2011</td> <td>09/2012</td> <td>10,000</td> </tr> </tbody> </table>						Number	Description	Opened	Closed	Amount	R2011 08 2	R13-NEW 18X40 720 SQ FT ADDITION	08/2011	09/2012	10,000																																																																																																						
Number	Description	Opened	Closed	Amount																																																																																																																					
R2011 08 2	R13-NEW 18X40 720 SQ FT ADDITION	08/2011	09/2012	10,000																																																																																																																					
<b>Exemptions</b> <table border="1"> <thead> <tr> <th>Code</th> <th>Type</th> <th>Active</th> <th>Maximum</th> <th>Exemption</th> </tr> </thead> <tbody> <tr> <td></td> <td></td> <td></td> <td></td> <td></td> </tr> </tbody> </table>				Code	Type	Active	Maximum	Exemption						<b>Sale History</b> <table border="1"> <thead> <tr> <th>Bk/Pg</th> <th>Grantor</th> <th>Date</th> <th>Price</th> <th>Code</th> </tr> </thead> <tbody> <tr> <td>1553/778</td> <td>SMOTHERS, WAYNE EDWARD &amp;</td> <td>12/24/2003</td> <td>150,500</td> <td>YES</td> </tr> <tr> <td>1295/545</td> <td>POWELL, DANNIE L &amp;</td> <td>06/01/2001</td> <td>115,000</td> <td>YES</td> </tr> <tr> <td>960/734</td> <td>SELLER</td> <td>06/16/1994</td> <td>0</td> <td>No</td> </tr> <tr> <td>846/890</td> <td></td> <td></td> <td>8,000</td> <td>No</td> </tr> <tr> <td>849/809</td> <td></td> <td></td> <td>67,500</td> <td>No</td> </tr> </tbody> </table>						Bk/Pg	Grantor	Date	Price	Code	1553/778	SMOTHERS, WAYNE EDWARD &	12/24/2003	150,500	YES	1295/545	POWELL, DANNIE L &	06/01/2001	115,000	YES	960/734	SELLER	06/16/1994	0	No	846/890			8,000	No	849/809			67,500	No																																																																								
Code	Type	Active	Maximum	Exemption																																																																																																																					
Bk/Pg	Grantor	Date	Price	Code																																																																																																																					
1553/778	SMOTHERS, WAYNE EDWARD &	12/24/2003	150,500	YES																																																																																																																					
1295/545	POWELL, DANNIE L &	06/01/2001	115,000	YES																																																																																																																					
960/734	SELLER	06/16/1994	0	No																																																																																																																					
846/890			8,000	No																																																																																																																					
849/809			67,500	No																																																																																																																					
<b>Parcel Valuation</b> <table border="1"> <thead> <tr> <th>Source</th> <th>REAL</th> <th>Fair Cash</th> <th>Capped</th> <th>Asmnt Level</th> <th>Assessed</th> <th>Levy Rate</th> <th>108.538</th> <th>Current Tax</th> </tr> </thead> <tbody> <tr> <td>Remove Cap</td> <td>2004</td> <td>Land Value 115,027</td> <td>87,104</td> <td>11%</td> <td>9,581</td> <td>Assessed</td> <td>26,453</td> <td>2,871.16</td> </tr> <tr> <td>Year Frozen</td> <td>0</td> <td>Improvements 191,293</td> <td>153,384</td> <td></td> <td>16,872</td> <td>Penalty</td> <td>0</td> <td></td> </tr> <tr> <td>Uncapped Value</td> <td>0</td> <td>Mobile Home 0</td> <td>0</td> <td></td> <td>0</td> <td>Exemption</td> <td>0</td> <td>0.00</td> </tr> <tr> <td>TIF Project ID</td> <td>0</td> <td>Total Value 306,320</td> <td>240,488</td> <td></td> <td>26,453</td> <td>Total Taxable</td> <td>26,453</td> <td>2,871.00</td> </tr> </tbody> </table>										Source	REAL	Fair Cash	Capped	Asmnt Level	Assessed	Levy Rate	108.538	Current Tax	Remove Cap	2004	Land Value 115,027	87,104	11%	9,581	Assessed	26,453	2,871.16	Year Frozen	0	Improvements 191,293	153,384		16,872	Penalty	0		Uncapped Value	0	Mobile Home 0	0		0	Exemption	0	0.00	TIF Project ID	0	Total Value 306,320	240,488		26,453	Total Taxable	26,453	2,871.00																																																																			
Source	REAL	Fair Cash	Capped	Asmnt Level	Assessed	Levy Rate	108.538	Current Tax																																																																																																																	
Remove Cap	2004	Land Value 115,027	87,104	11%	9,581	Assessed	26,453	2,871.16																																																																																																																	
Year Frozen	0	Improvements 191,293	153,384		16,872	Penalty	0																																																																																																																		
Uncapped Value	0	Mobile Home 0	0		0	Exemption	0	0.00																																																																																																																	
TIF Project ID	0	Total Value 306,320	240,488		26,453	Total Taxable	26,453	2,871.00																																																																																																																	
<b>Assessment History</b> <table border="1"> <thead> <tr> <th>Tax Year</th> <th>Statement Number</th> <th>Billed Owner</th> <th>Tax Area</th> <th>Total Value</th> <th>Exemptions</th> <th>Taxable Value</th> <th>Billed Tax</th> </tr> </thead> <tbody> <tr><td>2025</td><td>2025-660006038</td><td>SMITH, MARK A</td><td>7</td><td>282,597</td><td>0</td><td>25,194</td><td>2,735.00</td></tr> <tr><td>2024</td><td>2024-660006038</td><td>SMITH, MARK A</td><td>7</td><td>289,394</td><td>0</td><td>23,994</td><td>2,648.00</td></tr> <tr><td>2023</td><td>2023-660006038</td><td>SMITH, MARK A</td><td>7</td><td>207,744</td><td>0</td><td>22,852</td><td>2,467.00</td></tr> <tr><td>2022</td><td>2022-660006038</td><td>SMITH, MARK A</td><td>7</td><td>209,091</td><td>0</td><td>22,526</td><td>2,529.00</td></tr> <tr><td>2021</td><td>2021-660006038</td><td>SMITH, MARK A</td><td>7</td><td>195,027</td><td>0</td><td>21,453</td><td>2,381.00</td></tr> <tr><td>2020</td><td>2020-660006038</td><td>SMITH, MARK A</td><td>7</td><td>192,916</td><td>0</td><td>21,221</td><td>2,353.00</td></tr> <tr><td>2019</td><td>2019-660006038</td><td>SMITH, MARK A</td><td>7</td><td>187,604</td><td>0</td><td>20,636</td><td>2,290.00</td></tr> <tr><td>2018</td><td>2018-660006038</td><td>SMITH, MARK A</td><td>7</td><td>188,990</td><td>0</td><td>20,789</td><td>2,232.00</td></tr> <tr><td>2017</td><td>2017-660006038</td><td>SMITH, MARK A</td><td>7</td><td>187,763</td><td>0</td><td>20,654</td><td>2,238.00</td></tr> <tr><td>2016</td><td>2016-660006038</td><td>SMITH, MARK A</td><td>7</td><td>184,736</td><td>0</td><td>20,321</td><td>2,203.00</td></tr> <tr><td>2015</td><td>2015-660006038</td><td>SMITH, MARK A</td><td>7</td><td>182,189</td><td>0</td><td>20,041</td><td>2,186.00</td></tr> <tr><td>2014</td><td>2014-660006038</td><td>SMITH, MARK A</td><td>7</td><td>184,097</td><td>0</td><td>20,251</td><td>2,227.00</td></tr> <tr><td>2013</td><td>2013-660006038</td><td>SMITH, MARK A</td><td>7</td><td>177,542</td><td>0</td><td>19,530</td><td>2,109.00</td></tr> </tbody> </table>										Tax Year	Statement Number	Billed Owner	Tax Area	Total Value	Exemptions	Taxable Value	Billed Tax	2025	2025-660006038	SMITH, MARK A	7	282,597	0	25,194	2,735.00	2024	2024-660006038	SMITH, MARK A	7	289,394	0	23,994	2,648.00	2023	2023-660006038	SMITH, MARK A	7	207,744	0	22,852	2,467.00	2022	2022-660006038	SMITH, MARK A	7	209,091	0	22,526	2,529.00	2021	2021-660006038	SMITH, MARK A	7	195,027	0	21,453	2,381.00	2020	2020-660006038	SMITH, MARK A	7	192,916	0	21,221	2,353.00	2019	2019-660006038	SMITH, MARK A	7	187,604	0	20,636	2,290.00	2018	2018-660006038	SMITH, MARK A	7	188,990	0	20,789	2,232.00	2017	2017-660006038	SMITH, MARK A	7	187,763	0	20,654	2,238.00	2016	2016-660006038	SMITH, MARK A	7	184,736	0	20,321	2,203.00	2015	2015-660006038	SMITH, MARK A	7	182,189	0	20,041	2,186.00	2014	2014-660006038	SMITH, MARK A	7	184,097	0	20,251	2,227.00	2013	2013-660006038	SMITH, MARK A	7	177,542	0	19,530	2,109.00
Tax Year	Statement Number	Billed Owner	Tax Area	Total Value	Exemptions	Taxable Value	Billed Tax																																																																																																																		
2025	2025-660006038	SMITH, MARK A	7	282,597	0	25,194	2,735.00																																																																																																																		
2024	2024-660006038	SMITH, MARK A	7	289,394	0	23,994	2,648.00																																																																																																																		
2023	2023-660006038	SMITH, MARK A	7	207,744	0	22,852	2,467.00																																																																																																																		
2022	2022-660006038	SMITH, MARK A	7	209,091	0	22,526	2,529.00																																																																																																																		
2021	2021-660006038	SMITH, MARK A	7	195,027	0	21,453	2,381.00																																																																																																																		
2020	2020-660006038	SMITH, MARK A	7	192,916	0	21,221	2,353.00																																																																																																																		
2019	2019-660006038	SMITH, MARK A	7	187,604	0	20,636	2,290.00																																																																																																																		
2018	2018-660006038	SMITH, MARK A	7	188,990	0	20,789	2,232.00																																																																																																																		
2017	2017-660006038	SMITH, MARK A	7	187,763	0	20,654	2,238.00																																																																																																																		
2016	2016-660006038	SMITH, MARK A	7	184,736	0	20,321	2,203.00																																																																																																																		
2015	2015-660006038	SMITH, MARK A	7	182,189	0	20,041	2,186.00																																																																																																																		
2014	2014-660006038	SMITH, MARK A	7	184,097	0	20,251	2,227.00																																																																																																																		
2013	2013-660006038	SMITH, MARK A	7	177,542	0	19,530	2,109.00																																																																																																																		



# Rogers

## Assessment Property Record Card for Tax Year 2026

Data provided by LISA DELOZIER County Assessor

Date 04/17/2026  
 Time 06:33:26  
 Page 2

Lot Data		Square-Foot - NBHD 1106 #1
Lot Size		
Lot Count		
Units Buildable	0.9	
Non-Ag Acres	3.4876	
Topography		
Street Access		
Utilities		
Amenities		0
		0
Method	Square-Foot	
Base Lot Value	151,918.00 x .76 = 115,027	
Factor Value		
Adjustments	1.0000	
Lot Value	115,027	



\\tsclient\C\Users\Randy Necessary\Pictures\101\_0509\IMG\_0030. 5/9/2022

Residential Data	
Type	1 Single Family Residence
Condition	3 - Average
Quality	2.5 - Fair
Architecture	
Style	100% One Story
Exterior Wall	30% Veneer, Masonry 70% Frame, Siding, Vinyl
Base/Total Area	1,108 / 1,108
Style	100% One Story
HVAC	100% Warmed & Cooled Air
Roof Cover	1 Composition Shingle
Area on Slab	1,108
Fixture/RghIn	11 /
Bed/F/H Bath	3 / 2.0 /
Basement Area	
Garage Type	420 Attached Garage - Unfinished
Remodel	
Year/Eff Age	1991 / 26

GRM Approach	
GRM Code	
Gross Rent	0.00
Indicated Value	

Multiple Regression			
MRA Code	1	Test	
Adusted R	0.8445		
Indicated Value	217,942	196.70	Per SqFt

Direct Comparables	
Selection Model	A Adam Test
Adjustment Model	1 2022 Residential
Comparables	
Indicated Value	

Cost Approach				Manual : 01/2025	
Base Cost	105.98	Total Misc Impr	+	717	
Roofing Adj	+ 4.79	Garage Cost	+	12,100	
Subfloor Adj	+ -1.27	Total RCN	=	160,934	
Heat/Cool Adj	+ 11.47	Depreciation ( 35%)	-	56,327	
Plumbing Adj	+ 12.71	Lump Sums	+	12,137	
Basement Adj	+ 0.00	RCNLD	=	116,744	
Adj Base Cost	= 133.68	Lot Value	+	115,027	
Total Area	x 1,108	Indicated Value	=	231,771	
Adjusted Cost	= 148,117	Value Per SqFt		209.18	

Value Reconciliation			
Selected Approach	Cost Approach		
Improvements	116,744		
Lot Value	115,027		
Indicated Value	231,771	209.18	Per SqFt
Agland Value			
Site Improvements	74,549		
Total Value	306,320	276.46	Total Value Per SqFt

Miscellaneous Improvements								
Code	Description	Sketch ID	Size	Year	Units	Unit Cost	Depr	Value
WODC	WOOD DECK - COVERED	14184	23x20		460	28.07	6%	12,137
PATO	SLAB PORCH - OPEN	14185	11x6		66	10.86		717



# Rogers

## Assessment Property Record Card for Tax Year 2026

Data provided by LISA DELOZIER County Assessor

Date 04/17/2026

Time 06:33:26

Page 3

### Sketch Image

660006038

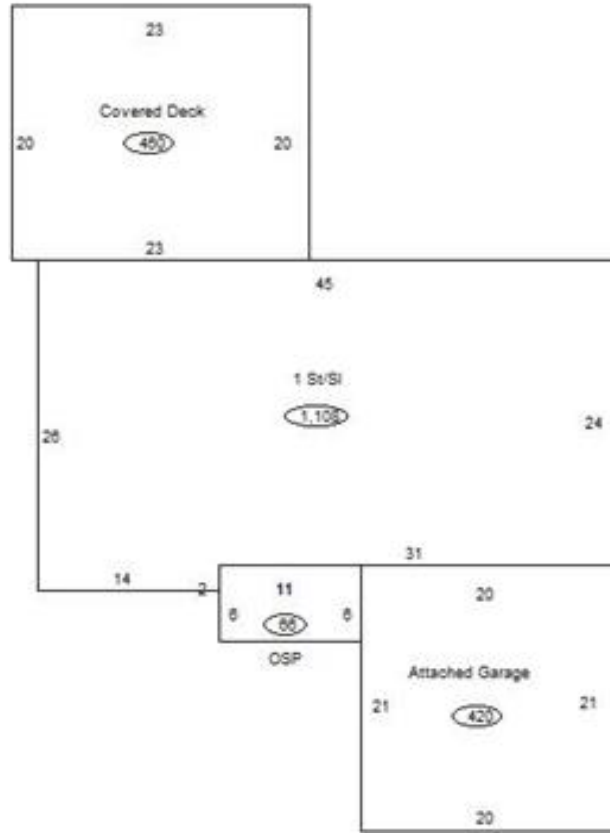

### Sketch Vector Information

Sequence	Code	Type	Built Over	Scale	Section Label	Base Area	Multiplier	Total Area
1	R	1	Slab	13	1 St/SI	1,108	1.000	1,108
2	G	1		13	Attached Garage	420	1.000	420
3	M	WODC		13	WODC	460	1.000	460
4	M	PATO		13	Open Slab	66	1.000	66
<b>Total Building Area</b>						<b>1,108</b>		<b>1,108</b>



# Rogers

## Assessment Property Record Card for Tax Year 2026

Data provided by LISA DELOZIER County Assessor

Date 04/17/2026  
 Time 06:33:26  
 Page 4

660006038

### Outbuildings/Site Improvements

Building Image	Code	Description	Dimensions	Floor	Roofing	Total Units	
	UTIL	SHOP BUILDING	25x18x0			450	
	Qual 2	Cond 3	Year 2012	Eff Age	11		
	<b>Valuation Summary</b>		<b>Modifier Total</b>	<b>RCN</b>	<b>Depr (22% Phys/ % Func)</b>	<b>RCNLD</b>	
	Base Cost (31.28 x 450)		14,076		14,076	3,097	10,979
	CPDT	CARPORT - DETACHED	18x15x0			270	
	Qual	Cond	Year 2012	Eff Age			
	<b>Valuation Summary</b>		<b>Modifier Total</b>	<b>RCN</b>	<b>Depr (0% Phys/ % Func)</b>	<b>RCNLD</b>	
	Base Cost (11.36 x 270)		3,067		3,067		3,067
	UTIL	SHOP BUILDING	0x0x0			3,150	
	Qual 2	Cond 3	Year	Eff Age			
	<b>Valuation Summary</b>		<b>Modifier Total</b>	<b>RCN</b>	<b>Depr (25% Phys/ % Func)</b>	<b>RCNLD</b>	
	Base Cost (24.34 x 3,150)		76,671		76,671	19,168	57,503
	SG	SWIM-GUNITE	0x0x0			1	
	Qual 3	Cond 3	Year	Eff Age			
	<b>Valuation Summary</b>		<b>Modifier Total</b>	<b>RCN</b>	<b>Depr (90% Phys/ % Func)</b>	<b>RCNLD</b>	
	Base Cost (30,000.00 x 1)		30,000		30,000	27,000	3,000
	STF	STG FAIR	0x0x0				
	Qual 2	Cond 3	Year	Eff Age	1520		
	<b>Valuation Summary</b>		<b>Modifier Total</b>	<b>RCN</b>	<b>Depr (100% Phys/ % Func)</b>	<b>RCNLD</b>	
	Base Cost (4.68 x )						
	STF	STG FAIR	0x0x0				
	Qual	Cond	Year	Eff Age			
	<b>Valuation Summary</b>		<b>Modifier Total</b>	<b>RCN</b>	<b>Depr (100% Phys/ % Func)</b>	<b>RCNLD</b>	
	Base Cost (4.68 x )						