



Rogers

Assessment Property Record Card for Tax Year 2026

Data provided by LISA DELOZIER County Assessor

Date 04/17/2026
Time 00:13:43
Page 1

Assessment Data					Primary Image																																																	
Account 660006061 Parcel ID 000000-00-0-10060-001-0008 Cadastral ID 07-21-16-00230 Property Type REAL - Real Property Property Class URP VI Area 1 Tax Area 17 - CLAREMORE OT Name ID 289313 SANTOS, GREGORY R & CONNIE J 15711 E MEADOW CIRCLE RD CLAREMORE OK 74019-0000 Parcel Location Situs 02002 CHARLESTOWN CIR Subdivision CHARLES TOWN LANDING Lot/Block 0008 / 0001 Parcel Size 1 - Lots Sec/Twn/Rng 7 / 21 / 16 / 5 Neighborhood 1180 - R-V01-SW CLAREMORE School District S001 - CLAREMORE SCHOOLS					<p>\\tsclient\T\TOMMY DUNLAP\New folder (188)\IMG_0031.JPG 5/9/2023</p>																																																	
Legal Description Lot/Long: 36.30907587 -95.63547035																																																						
LOT 8 CHARLES TOWN LANDING					Building Permits <table border="1"> <thead> <tr> <th>Number</th> <th>Description</th> <th>Opened</th> <th>Closed</th> <th>Amount</th> </tr> </thead> <tbody> <tr> <td> </td> <td> </td> <td> </td> <td> </td> <td> </td> </tr> </tbody> </table>					Number	Description	Opened	Closed	Amount																																								
Number	Description	Opened	Closed	Amount																																																		
Exemptions					Sale History																																																	
Code	Type	Active	Maximum	Exemption	Bk/Pg	Grantor	Date	Price	Code																																													
					1835/42	BOSTICK, KENNETH R & FAITH-A	12/22/2006	68,000	YES																																													
					1112/701	WARD, GREGORY R	12/15/1997	60,000	Yes																																													
					931/136	HOLLOMON, THOMAS E &	10/01/1993	57,000	Yes																																													
					843/615			48,500	No																																													
Parcel Valuation					<table border="1"> <thead> <tr> <th>Source</th> <th>REAL</th> <th>Fair Cash</th> <th>Capped</th> <th>Asmnt Level</th> <th>Assessed</th> <th>Levy Rate</th> <th>92.430</th> <th>Current Tax</th> </tr> </thead> <tbody> <tr> <td>Remove Cap</td> <td>2007</td> <td>Land Value</td> <td>26,942</td> <td>24,386</td> <td>11%</td> <td>2,682</td> <td>Assessed</td> <td>10,021 926.24</td> </tr> <tr> <td>Year Frozen</td> <td>0</td> <td>Improvements</td> <td>66,716</td> <td>66,716</td> <td> </td> <td>7,339</td> <td>Penalty</td> <td>0</td> </tr> <tr> <td>Uncapped Value</td> <td>0</td> <td>Mobile Home</td> <td>0</td> <td>0</td> <td> </td> <td>0</td> <td>Exemption</td> <td>0 0.00</td> </tr> <tr> <td>TIF Project ID</td> <td>0</td> <td>Total Value</td> <td>93,658</td> <td>91,102</td> <td> </td> <td>10,021</td> <td>Total Taxable</td> <td>10,021 926.00</td> </tr> </tbody> </table>					Source	REAL	Fair Cash	Capped	Asmnt Level	Assessed	Levy Rate	92.430	Current Tax	Remove Cap	2007	Land Value	26,942	24,386	11%	2,682	Assessed	10,021 926.24	Year Frozen	0	Improvements	66,716	66,716		7,339	Penalty	0	Uncapped Value	0	Mobile Home	0	0		0	Exemption	0 0.00	TIF Project ID	0	Total Value	93,658	91,102		10,021	Total Taxable	10,021 926.00
Source	REAL	Fair Cash	Capped	Asmnt Level	Assessed	Levy Rate	92.430	Current Tax																																														
Remove Cap	2007	Land Value	26,942	24,386	11%	2,682	Assessed	10,021 926.24																																														
Year Frozen	0	Improvements	66,716	66,716		7,339	Penalty	0																																														
Uncapped Value	0	Mobile Home	0	0		0	Exemption	0 0.00																																														
TIF Project ID	0	Total Value	93,658	91,102		10,021	Total Taxable	10,021 926.00																																														
Assessment History																																																						
Tax Year	Statement Number	Billed Owner	Tax Area	Total Value	Exemptions	Taxable Value	Billed Tax																																															
2025	2025-660006061	SANTOS, GREGORY R & CONNIE J	17	93,050	0	9,544	882.00																																															
2024	2024-660006061	SANTOS, GREGORY R & CONNIE J	17	97,752	0	9,089	840.00																																															
2023	2023-660006061	SANTOS, GREGORY R & CONNIE J	17	104,953	0	8,657	793.00																																															
2022	2022-660006061	SANTOS, GREGORY R & CONNIE J	17	74,952	0	8,245	763.00																																															
2021	2021-660006061	SANTOS, GREGORY R & CONNIE J	17	83,504	0	9,185	811.00																																															
2020	2020-660006061	SANTOS, GREGORY R & CONNIE J	17	84,185	0	9,260	848.00																																															
2019	2019-660006061	SANTOS, GREGORY R & CONNIE J	17	82,044	0	9,025	836.00																																															
2018	2018-660006061	SANTOS, GREGORY R & CONNIE J	17	85,525	0	9,408	869.00																																															
2017	2017-660006061	SANTOS, GREGORY R & CONNIE J	17	84,869	0	9,336	857.00																																															
2016	2016-660006061	SANTOS, GREGORY R & CONNIE J	17	82,770	0	9,105	855.00																																															
2015	2015-660006061	SANTOS, GREGORY R & CONNIE J	17	81,618	0	8,978	810.00																																															
2014	2014-660006061	SANTOS, GREGORY R & CONNIE J	17	83,145	0	8,848	820.00																																															
2013	2013-660006061	SANTOS, GREGORY R & CONNIE J	17	79,386	0	8,426	771.00																																															



Rogers

Assessment Property Record Card for Tax Year 2026

Data provided by LISA DELOZIER County Assessor

Date 04/17/2026
Time 00:13:43
Page 2

Lot Data		Square-Foot - NBHD 1180 #1	
Lot Size			
Lot Count	1		
Units Buildable	10000		
Non-Ag Acres	0.149		
Topography			
Street Access			
Utilities			
Amenities		0	
		0	
Method	Square-Foot		
Base Lot Value	6,492.00 x 4.15 = 26,942		
Factor Value			
Adjustments	1.0000		
Lot Value	26,942		



\\tsclient\T\TOMMY DUNLAP\New folder (188)\IMG_0031.JPG 5/9/2023

Residential Data	
Type	1 Single Family Residence
Condition	2 - Fair
Quality	2 - Fair
Architecture	R3 Res Nbhd 3
Style	100% 1 1/2 Story Finished
Exterior Wall	10% Veneer, Masonry 90% Frame, Siding, Wood
Base/Total Area	682 / 1,210
Style	100% 1 1/2 Story Finished
HVAC	100% Warmed & Cooled Air
Roof Cover	1 Composition Shingle
Area on Slab	682
Fixture/RghIn	11 /
Bed/F/H Bath	3 / 2.0 /
Basement Area	
Garage Type	456 Attached Garage - Unfinished
Remodel	
Year/Eff Age	1983 / 43

GRM Approach

GRM Code	
Gross Rent	0.00
Indicated Value	

Multiple Regression

MRA Code	1 Test
Adusted R	0.8445
Indicated Value	129,762 107.24 Per SqFt

Direct Comparables

Selection Model	A Adam Test
Adjustment Model	1 2022 Residential
Comparables	8
Indicated Value	138,250 Per SqFt

Value Reconciliation

Selected Approach	Cost Approach
Improvements	66,716
Lot Value	26,942
Indicated Value	93,658 77.40 Per SqFt
Agland Value	
Site Improvements	
Total Value	93,658 77.40 Total Value Per SqFt

Cost Approach		Manual : 01/2025	
Base Cost	80.46	Total Misc Impr	+ 1,683
Roofing Adj	+ 2.67	Garage Cost	+ 10,889
Subfloor Adj	+ 0.00	Total RCN	= 138,267
Heat/Cool Adj	+ 10.30	Depreciation (53%)	- 73,282
Plumbing Adj	+ 10.45	Lump Sums	+ 1,731
Basement Adj	+ 0.00	RCNLD	= 66,716
Adj Base Cost	= 103.88	Lot Value	+ 26,942
Total Area	x 1,210	Indicated Value	= 93,658
Adjusted Cost	= 125,695	Value Per SqFt	77.40

Miscellaneous Improvements

Code	Description	Sketch ID	Size	Year	Units	Unit Cost	Depr	Value
PRCH	SLAB PORCH - COVERED	14283	16x5		80	21.04		1,683
WODO	WOOD DECK - OPEN	14284	18x9		162	21.37	50%	1,731



Rogers

Assessment Property Record Card for Tax Year 2026

Data provided by LISA DELOZIER County Assessor

Date 04/17/2026
 Time 00:13:43
 Page 3

Sketch Image

660006061

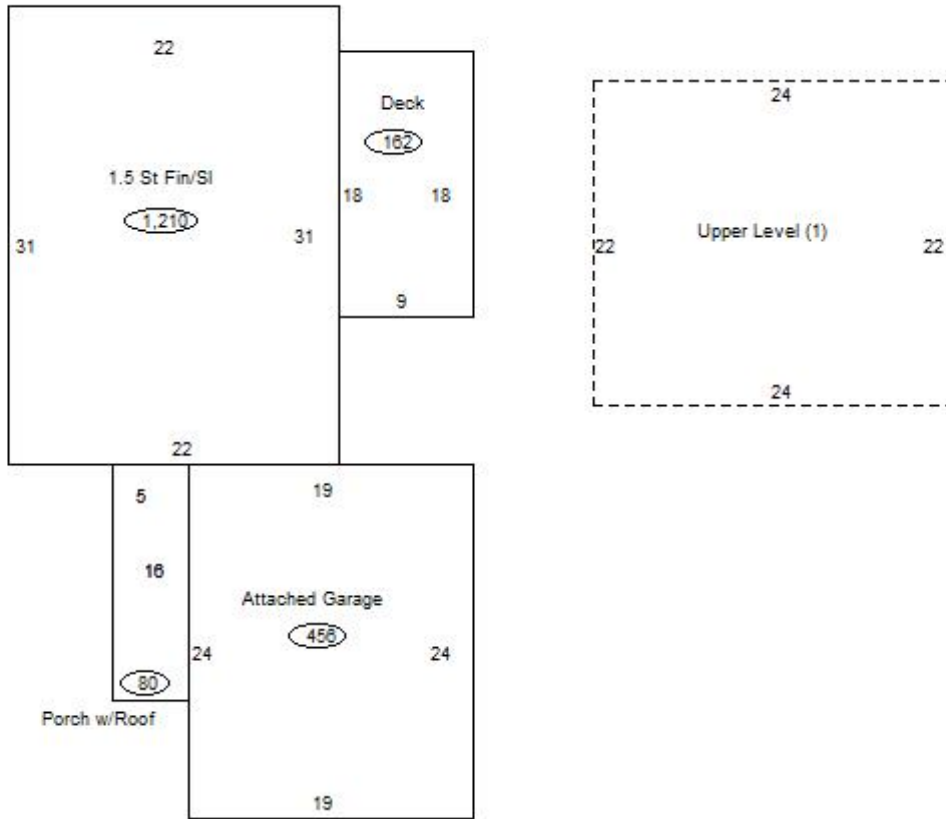

Sketch Vector Information

Sequence	Code	Type	Built Over	Scale	Section Label	Base Area	Multiplier	Total Area
1	R	5	Slab	13	1.5 St Fin/Sl	682	1.774	1,210
2	G	1		13	Attached Garage	456	1.000	456
3	M	PRCH		13	SLBC	80	1.000	80
4	M	WODO		13	WODO	162	1.000	162
5	U	^UL		13	Upper Level (1)	528	1.000	528
Total Building Area						682		1,210