



# Rogers

## Assessment Property Record Card for Tax Year 2026

Data provided by LISA DELOZIER County Assessor

Date 04/17/2026  
Time 03:34:38  
Page 1

Assessment Data					Primary Image																																																																																																																				
<b>Account</b> 660006078 <b>Parcel ID</b> 000000-00-0-10100-002-0003 <b>Cadastral ID</b> 07-21-16-00400 <b>Property Type</b> REAL - Real Property <b>Property Class</b> URP VI Area 1 <b>Tax Area</b> 17 - CLAREMORE OT <b>Name ID</b> 323849 BENVENUTI FAMILY 2000 TRUST  106 LINDA ISLE NEWPORT BEACH CA 92660-0000  <b>Parcel Location</b> <b>Situs</b> 00634 EARTHSTIDE CIR <b>Subdivision</b> EARTHSTIDE II <b>Lot/Block</b> 0003 / 0002 Parcel Size 1 - Lots <b>Sec/Twn/Rng</b> 7 / 21 / 16 / 5 <b>Neighborhood</b> 1180 - R-V01-SW CLAREMORE <b>School District</b> S001 - CLAREMORE SCHOOLS																																																																																																																									
<b>Legal Description</b> Lot/Long: 36.31045016 -95.63628128																																																																																																																									
<b>Legal Description</b> LOT 3 BLOCK 2 EARTHSTIDE II					<b>Building Permits</b> <table border="1"> <thead> <tr> <th>Number</th> <th>Description</th> <th>Opened</th> <th>Closed</th> <th>Amount</th> </tr> </thead> <tbody> <tr> <td>2210</td> <td></td> <td>01/2001</td> <td>11/2001</td> <td></td> </tr> </tbody> </table>					Number	Description	Opened	Closed	Amount	2210		01/2001	11/2001																																																																																																							
Number	Description	Opened	Closed	Amount																																																																																																																					
2210		01/2001	11/2001																																																																																																																						
<b>Exemptions</b> <table border="1"> <thead> <tr> <th>Code</th> <th>Type</th> <th>Active</th> <th>Maximum</th> <th>Exemption</th> </tr> </thead> <tbody> <tr> <td></td> <td></td> <td></td> <td></td> <td></td> </tr> </tbody> </table>					Code	Type	Active	Maximum	Exemption						<b>Sale History</b> <table border="1"> <thead> <tr> <th>Bk/Pg</th> <th>Grantor</th> <th>Date</th> <th>Price</th> <th>Code</th> </tr> </thead> <tbody> <tr> <td>2693/319</td> <td>BEACON HILL REAL ESTATE</td> <td>02/16/2018</td> <td>2,700,000</td> <td>WG</td> </tr> <tr> <td>2591/96</td> <td>BACK &amp; THE MOON LLC</td> <td>10/25/2016</td> <td>0</td> <td>3</td> </tr> <tr> <td>2421/534</td> <td>SALTY DOG PROPERTIES LLC</td> <td>08/20/2014</td> <td>100,000</td> <td>YES</td> </tr> <tr> <td>2421/526</td> <td>ANDREWS, TERRANCE A &amp;</td> <td>08/20/2014</td> <td>2,200,000</td> <td>WG</td> </tr> <tr> <td>1225/571</td> <td>CLAREMORE ASSOCIATES AN-OKLA</td> <td>04/05/2000</td> <td>1,750,000</td> <td>No</td> </tr> <tr> <td>1180/360</td> <td>ERC PROPERTIES, INC</td> <td>09/30/1998</td> <td>0</td> <td>No</td> </tr> </tbody> </table>					Bk/Pg	Grantor	Date	Price	Code	2693/319	BEACON HILL REAL ESTATE	02/16/2018	2,700,000	WG	2591/96	BACK & THE MOON LLC	10/25/2016	0	3	2421/534	SALTY DOG PROPERTIES LLC	08/20/2014	100,000	YES	2421/526	ANDREWS, TERRANCE A &	08/20/2014	2,200,000	WG	1225/571	CLAREMORE ASSOCIATES AN-OKLA	04/05/2000	1,750,000	No	1180/360	ERC PROPERTIES, INC	09/30/1998	0	No																																																																			
Code	Type	Active	Maximum	Exemption																																																																																																																					
Bk/Pg	Grantor	Date	Price	Code																																																																																																																					
2693/319	BEACON HILL REAL ESTATE	02/16/2018	2,700,000	WG																																																																																																																					
2591/96	BACK & THE MOON LLC	10/25/2016	0	3																																																																																																																					
2421/534	SALTY DOG PROPERTIES LLC	08/20/2014	100,000	YES																																																																																																																					
2421/526	ANDREWS, TERRANCE A &	08/20/2014	2,200,000	WG																																																																																																																					
1225/571	CLAREMORE ASSOCIATES AN-OKLA	04/05/2000	1,750,000	No																																																																																																																					
1180/360	ERC PROPERTIES, INC	09/30/1998	0	No																																																																																																																					
<b>Parcel Valuation</b> <table border="1"> <thead> <tr> <th>Source</th> <th>REAL</th> <th>Fair Cash</th> <th>Capped</th> <th>Asmnt Level</th> <th>Assessed</th> <th>Levy Rate</th> <th>92.430</th> <th>Current Tax</th> </tr> </thead> <tbody> <tr> <td>Remove Cap</td> <td>2019</td> <td>Land Value 52,161</td> <td>52,161</td> <td>11%</td> <td>5,738</td> <td>Assessed</td> <td>20,968</td> <td>1,938.07</td> </tr> <tr> <td>Year Frozen</td> <td>0</td> <td>Improvements 138,455</td> <td>138,455</td> <td></td> <td>15,230</td> <td>Penalty</td> <td>0</td> <td></td> </tr> <tr> <td>Uncapped Value</td> <td>0</td> <td>Mobile Home 0</td> <td>0</td> <td></td> <td>0</td> <td>Exemption</td> <td>0</td> <td>0.00</td> </tr> <tr> <td>TIF Project ID</td> <td>0</td> <td>Total Value 190,616</td> <td>190,616</td> <td></td> <td>20,968</td> <td>Total Taxable</td> <td>20,968</td> <td>1,938.00</td> </tr> </tbody> </table>										Source	REAL	Fair Cash	Capped	Asmnt Level	Assessed	Levy Rate	92.430	Current Tax	Remove Cap	2019	Land Value 52,161	52,161	11%	5,738	Assessed	20,968	1,938.07	Year Frozen	0	Improvements 138,455	138,455		15,230	Penalty	0		Uncapped Value	0	Mobile Home 0	0		0	Exemption	0	0.00	TIF Project ID	0	Total Value 190,616	190,616		20,968	Total Taxable	20,968	1,938.00																																																																			
Source	REAL	Fair Cash	Capped	Asmnt Level	Assessed	Levy Rate	92.430	Current Tax																																																																																																																	
Remove Cap	2019	Land Value 52,161	52,161	11%	5,738	Assessed	20,968	1,938.07																																																																																																																	
Year Frozen	0	Improvements 138,455	138,455		15,230	Penalty	0																																																																																																																		
Uncapped Value	0	Mobile Home 0	0		0	Exemption	0	0.00																																																																																																																	
TIF Project ID	0	Total Value 190,616	190,616		20,968	Total Taxable	20,968	1,938.00																																																																																																																	
<b>Assessment History</b> <table border="1"> <thead> <tr> <th>Tax Year</th> <th>Statement Number</th> <th>Billed Owner</th> <th>Tax Area</th> <th>Total Value</th> <th>Exemptions</th> <th>Taxable Value</th> <th>Billed Tax</th> </tr> </thead> <tbody> <tr><td>2025</td><td>2025-660006078</td><td>BENVENUTI FAMILY 2000 TRUST</td><td>17</td><td>186,764</td><td>0</td><td>20,000</td><td>1,849.00</td></tr> <tr><td>2024</td><td>2024-660006078</td><td>BENVENUTI FAMILY 2000 TRUST</td><td>17</td><td>197,100</td><td>0</td><td>19,048</td><td>1,760.00</td></tr> <tr><td>2023</td><td>2023-660006078</td><td>BENVENUTI FAMILY 2000 TRUST</td><td>17</td><td>181,765</td><td>0</td><td>18,141</td><td>1,662.00</td></tr> <tr><td>2022</td><td>2022-660006078</td><td>BENVENUTI FAMILY 2000 TRUST</td><td>17</td><td>157,066</td><td>0</td><td>17,277</td><td>1,599.00</td></tr> <tr><td>2021</td><td>2021-660006078</td><td>BENVENUTI FAMILY 2000 TRUST</td><td>17</td><td>169,578</td><td>0</td><td>18,654</td><td>1,647.00</td></tr> <tr><td>2020</td><td>2020-660006078</td><td>BENVENUTI FAMILY 2000 TRUST</td><td>17</td><td>168,768</td><td>0</td><td>18,564</td><td>1,700.00</td></tr> <tr><td>2019</td><td>2019-660006078</td><td>BENVENUTI FAMILY 2000 TRUST</td><td>17</td><td>160,816</td><td>0</td><td>17,690</td><td>1,638.00</td></tr> <tr><td>2018</td><td>2018-660006078</td><td>BENVENUTI FAMILY 2000 TRUST</td><td>17</td><td>126,423</td><td>0</td><td>13,907</td><td>1,285.00</td></tr> <tr><td>2017</td><td>2017-660006078</td><td>BEACON HILL REAL ESTATE</td><td>17</td><td>125,351</td><td>0</td><td>13,789</td><td>1,266.00</td></tr> <tr><td>2016</td><td>2016-660006078</td><td>BACK &amp; THE MOON LLC</td><td>17</td><td>119,790</td><td>0</td><td>13,177</td><td>1,237.00</td></tr> <tr><td>2015</td><td>2015-660006078</td><td>BACK &amp; THE MOON LLC</td><td>17</td><td>118,869</td><td>0</td><td>13,076</td><td>1,179.00</td></tr> <tr><td>2014</td><td>2014-660006078</td><td>BACK &amp; THE MOON LLC</td><td>17</td><td>121,425</td><td>0</td><td>12,435</td><td>1,153.00</td></tr> <tr><td>2013</td><td>2013-660006078</td><td>ANDREWS, TERRANCE A &amp;</td><td>17</td><td>116,217</td><td>0</td><td>11,843</td><td>1,084.00</td></tr> </tbody> </table>										Tax Year	Statement Number	Billed Owner	Tax Area	Total Value	Exemptions	Taxable Value	Billed Tax	2025	2025-660006078	BENVENUTI FAMILY 2000 TRUST	17	186,764	0	20,000	1,849.00	2024	2024-660006078	BENVENUTI FAMILY 2000 TRUST	17	197,100	0	19,048	1,760.00	2023	2023-660006078	BENVENUTI FAMILY 2000 TRUST	17	181,765	0	18,141	1,662.00	2022	2022-660006078	BENVENUTI FAMILY 2000 TRUST	17	157,066	0	17,277	1,599.00	2021	2021-660006078	BENVENUTI FAMILY 2000 TRUST	17	169,578	0	18,654	1,647.00	2020	2020-660006078	BENVENUTI FAMILY 2000 TRUST	17	168,768	0	18,564	1,700.00	2019	2019-660006078	BENVENUTI FAMILY 2000 TRUST	17	160,816	0	17,690	1,638.00	2018	2018-660006078	BENVENUTI FAMILY 2000 TRUST	17	126,423	0	13,907	1,285.00	2017	2017-660006078	BEACON HILL REAL ESTATE	17	125,351	0	13,789	1,266.00	2016	2016-660006078	BACK & THE MOON LLC	17	119,790	0	13,177	1,237.00	2015	2015-660006078	BACK & THE MOON LLC	17	118,869	0	13,076	1,179.00	2014	2014-660006078	BACK & THE MOON LLC	17	121,425	0	12,435	1,153.00	2013	2013-660006078	ANDREWS, TERRANCE A &	17	116,217	0	11,843	1,084.00
Tax Year	Statement Number	Billed Owner	Tax Area	Total Value	Exemptions	Taxable Value	Billed Tax																																																																																																																		
2025	2025-660006078	BENVENUTI FAMILY 2000 TRUST	17	186,764	0	20,000	1,849.00																																																																																																																		
2024	2024-660006078	BENVENUTI FAMILY 2000 TRUST	17	197,100	0	19,048	1,760.00																																																																																																																		
2023	2023-660006078	BENVENUTI FAMILY 2000 TRUST	17	181,765	0	18,141	1,662.00																																																																																																																		
2022	2022-660006078	BENVENUTI FAMILY 2000 TRUST	17	157,066	0	17,277	1,599.00																																																																																																																		
2021	2021-660006078	BENVENUTI FAMILY 2000 TRUST	17	169,578	0	18,654	1,647.00																																																																																																																		
2020	2020-660006078	BENVENUTI FAMILY 2000 TRUST	17	168,768	0	18,564	1,700.00																																																																																																																		
2019	2019-660006078	BENVENUTI FAMILY 2000 TRUST	17	160,816	0	17,690	1,638.00																																																																																																																		
2018	2018-660006078	BENVENUTI FAMILY 2000 TRUST	17	126,423	0	13,907	1,285.00																																																																																																																		
2017	2017-660006078	BEACON HILL REAL ESTATE	17	125,351	0	13,789	1,266.00																																																																																																																		
2016	2016-660006078	BACK & THE MOON LLC	17	119,790	0	13,177	1,237.00																																																																																																																		
2015	2015-660006078	BACK & THE MOON LLC	17	118,869	0	13,076	1,179.00																																																																																																																		
2014	2014-660006078	BACK & THE MOON LLC	17	121,425	0	12,435	1,153.00																																																																																																																		
2013	2013-660006078	ANDREWS, TERRANCE A &	17	116,217	0	11,843	1,084.00																																																																																																																		



# Rogers

## Assessment Property Record Card for Tax Year 2026

Data provided by LISA DELOZIER County Assessor

Date 04/17/2026  
Time 03:34:39  
Page 2

Lot Data	Square-Foot - NBHD 1180 #1	Primary Image
<b>Lot Size</b> <b>Lot Count</b> 1 <b>Units Buildable</b> 10000 <b>Non-Ag Acres</b> 0.2886 <b>Topography</b> <b>Street Access</b> <b>Utilities</b> <b>Amenities</b> 0  <b>Method</b> Square-Foot <b>Base Lot Value</b> 12,569.00 x 4.15 = 52,161 <b>Factor Value</b> <b>Adjustments</b> 1.0000 <b>Lot Value</b> 52,161		<p>\\tsclient\T\TOMMY DUNLAP\New folder (188)\IMG_0064.JPG 5/10/2023</p>

Residential Data	
<b>Type</b>	5 Duplex
<b>Condition</b>	2.5 - Fair
<b>Quality</b>	2.5 - Fair
<b>Architecture</b>	R3 Res Nbhd 3
<b>Style</b>	100% 1 1/2 Story Finished
<b>Exterior Wall</b>	100% Frame, Siding, Vinyl
<b>Base/Total Area</b>	1,770 / 2,188
<b>Style</b>	100% 1 1/2 Story Finished
<b>HVAC</b>	100% Warmed & Cooled Air
<b>Roof Cover</b>	1 Composition Shingle
<b>Area on Slab</b>	1,770
<b>Fixture/RghIn</b>	20 /
<b>Bed/F/H Bath</b>	4 / 3.0 /
<b>Basement Area</b>	
<b>Garage Type</b>	648 Attached Garage - Unfinished 2 Stalls
<b>Remodel</b>	
<b>Year/Eff Age</b>	1980 / 41

Cost Approach		Manual : 01/2025	
<b>Base Cost</b>	94.32	<b>Total Misc Impr</b>	+ 11,272
<b>Roofing Adj</b>	+ 3.15	<b>Garage Cost</b>	+ 21,760
<b>Subfloor Adj</b>	+ -0.32	<b>Total RCN</b>	= 294,586
<b>Heat/Cool Adj</b>	+ 11.22	<b>Depreciation ( 53%)</b>	- 156,131
<b>Plumbing Adj</b>	+ 11.17	<b>Lump Sums</b>	+ 0
<b>Basement Adj</b>	+ 0.00	<b>RCNLD</b>	= 138,455
<b>Adj Base Cost</b>	= 119.54	<b>Lot Value</b>	+ 52,161
<b>Total Area</b>	x 2,188	<b>Indicated Value</b>	= 190,616
<b>Adjusted Cost</b>	= 261,554	<b>Value Per SqFt</b>	87.12

GRM Approach	
<b>GRM Code</b>	
<b>Gross Rent</b>	0.00
<b>Indicated Value</b>	

Multiple Regression			
<b>MRA Code</b>	1	Test	
<b>Adusted R</b>	0.8445		
<b>Indicated Value</b>	218,866	100.03	Per SqFt

Direct Comparables	
<b>Selection Model</b>	A Adam Test
<b>Adjustment Model</b>	1 2022 Residential
<b>Comparables</b>	1
<b>Indicated Value</b>	69,900 Per SqFt

Value Reconciliation			
<b>Selected Approach</b>	Cost Approach		
<b>Improvements</b>	138,455		
<b>Lot Value</b>	52,161		
<b>Indicated Value</b>	190,616	87.12	Per SqFt
<b>Agland Value</b>			
<b>Site Improvements</b>			
<b>Total Value</b>	190,616	87.12	Total Value Per SqFt

Miscellaneous Improvements								
Code	Description	Sketch ID	Size	Year	Units	Unit Cost	Depr	Value
FPR1	FIREPLACE - RESIDENTIAL 1 STORY	0		1	1	4,983.67		4,984
FPR1	FIREPLACE - RESIDENTIAL 1 STORY	0		1	1	4,983.67		4,984
PATO	SLAB PORCH - OPEN	14378	12x5		60	10.86		652
PATO	SLAB PORCH - OPEN	14379	12x5		60	10.86		652



# Rogers

## Assessment Property Record Card for Tax Year 2026

Data provided by LISA DELOZIER County Assessor

Date 04/17/2026

Time 03:34:39

Page 3

### Sketch Image

660006078

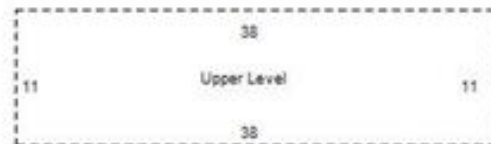
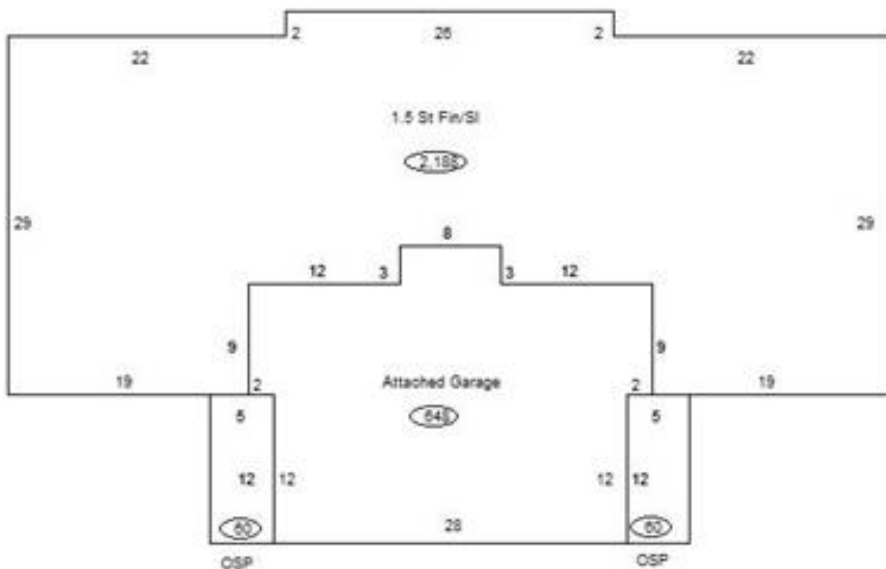

### Sketch Vector Information

Sequence	Code	Type	Built Over	Scale	Section Label	Base Area	Multiplier	Total Area
1	R	5	Slab	13	1.5 St Fin/SI	1,770	1.236	2,188
2	U	^UL	Overhang	13	Upper Level	418	1.000	418
3	G	1		13	Attached Garage	648	1.000	648
4	M	PATO		13	Open Slab	60	1.000	60
5	M	PATO		13	Open Slab	60	1.000	60
<b>Total Building Area</b>						<b>1,770</b>		<b>2,188</b>