



# Rogers

## Assessment Property Record Card for Tax Year 2026

Data provided by LISA DELOZIER County Assessor

Date 04/17/2026  
 Time 03:36:00  
 Page 1

Assessment Data					Primary Image																																																																																																																				
<b>Account</b> 660006160 <b>Parcel ID</b> 000000-00-0-10505-019-0032 <b>Cadastral ID</b> 07-21-16-04030 <b>Property Type</b> REAL - Real Property <b>Property Class</b> URP VI Area 1 <b>Tax Area</b> 17 - CLAREMORE OT <b>Name ID</b> 318356 MCNAMARA, MICHAEL J & CHRISTOPHER M MCNAMARA & KEVIN P MCNAMARA & KATHLEEN M MCNAMARA 2007 W 5TH ST S CLAREMORE OK 74017-0000																																																																																																																									
<b>Parcel Location</b> <b>Situs</b> 00502 S PINE ST <b>Subdivision</b> WESTSIDE <b>Lot/Block</b> 0032 / 0019 <b>Parcel Size</b> 4 - Lots <b>Sec/Twn/Rng</b> 7 / 21 / 16 / 5 <b>Neighborhood</b> 1180 - R-V01-SW CLAREMORE <b>School District</b> S001 - CLAREMORE SCHOOLS																																																																																																																									
<b>Legal Description</b> Lat/Long: 36.31318690 -95.63417411					<b>Building Permits</b> <table border="1"> <thead> <tr> <th>Number</th> <th>Description</th> <th>Opened</th> <th>Closed</th> <th>Amount</th> </tr> </thead> <tbody> <tr> <td> </td> <td> </td> <td> </td> <td> </td> <td> </td> </tr> </tbody> </table>					Number	Description	Opened	Closed	Amount																																																																																																											
Number	Description	Opened	Closed	Amount																																																																																																																					
<b>Exemptions</b> <table border="1"> <thead> <tr> <th>Code</th> <th>Type</th> <th>Active</th> <th>Maximum</th> <th>Exemption</th> </tr> </thead> <tbody> <tr> <td> </td> <td> </td> <td> </td> <td> </td> <td> </td> </tr> </tbody> </table>					Code	Type	Active	Maximum	Exemption						<b>Sale History</b> <table border="1"> <thead> <tr> <th>Bk/Pg</th> <th>Grantor</th> <th>Date</th> <th>Price</th> <th>Code</th> </tr> </thead> <tbody> <tr> <td>2583/358</td> <td>MCNAMARA, MICHAEL J</td> <td>10/11/2016</td> <td>0</td> <td>4</td> </tr> </tbody> </table>					Bk/Pg	Grantor	Date	Price	Code	2583/358	MCNAMARA, MICHAEL J	10/11/2016	0	4																																																																																												
Code	Type	Active	Maximum	Exemption																																																																																																																					
Bk/Pg	Grantor	Date	Price	Code																																																																																																																					
2583/358	MCNAMARA, MICHAEL J	10/11/2016	0	4																																																																																																																					
<b>Parcel Valuation</b> <table border="1"> <thead> <tr> <th>Source</th> <th>REAL</th> <th>Fair Cash</th> <th>Capped</th> <th>Asmnt Level</th> <th>Assessed</th> <th>Levy Rate</th> <th>92.430</th> <th>Current Tax</th> </tr> </thead> <tbody> <tr> <td>Remove Cap</td> <td>0</td> <td>Land Value 76,472</td> <td>19,619</td> <td>11%</td> <td>2,158</td> <td>Assessed</td> <td>4,016</td> <td>371.20</td> </tr> <tr> <td>Year Frozen</td> <td>0</td> <td>Improvements 21,343</td> <td>16,888</td> <td></td> <td>1,858</td> <td>Penalty</td> <td>0</td> <td></td> </tr> <tr> <td>Uncapped Value</td> <td>0</td> <td>Mobile Home 0</td> <td>0</td> <td></td> <td>0</td> <td>Exemption</td> <td>0</td> <td>0.00</td> </tr> <tr> <td>TIF Project ID</td> <td>0</td> <td>Total Value 97,815</td> <td>36,507</td> <td></td> <td>4,016</td> <td>Total Taxable</td> <td>4,016</td> <td>371.00</td> </tr> </tbody> </table>										Source	REAL	Fair Cash	Capped	Asmnt Level	Assessed	Levy Rate	92.430	Current Tax	Remove Cap	0	Land Value 76,472	19,619	11%	2,158	Assessed	4,016	371.20	Year Frozen	0	Improvements 21,343	16,888		1,858	Penalty	0		Uncapped Value	0	Mobile Home 0	0		0	Exemption	0	0.00	TIF Project ID	0	Total Value 97,815	36,507		4,016	Total Taxable	4,016	371.00																																																																			
Source	REAL	Fair Cash	Capped	Asmnt Level	Assessed	Levy Rate	92.430	Current Tax																																																																																																																	
Remove Cap	0	Land Value 76,472	19,619	11%	2,158	Assessed	4,016	371.20																																																																																																																	
Year Frozen	0	Improvements 21,343	16,888		1,858	Penalty	0																																																																																																																		
Uncapped Value	0	Mobile Home 0	0		0	Exemption	0	0.00																																																																																																																	
TIF Project ID	0	Total Value 97,815	36,507		4,016	Total Taxable	4,016	371.00																																																																																																																	
<b>Assessment History</b> <table border="1"> <thead> <tr> <th>Tax Year</th> <th>Statement Number</th> <th>Billed Owner</th> <th>Tax Area</th> <th>Total Value</th> <th>Exemptions</th> <th>Taxable Value</th> <th>Billed Tax</th> </tr> </thead> <tbody> <tr><td>2025</td><td>2025-660006160</td><td>MCNAMARA, MICHAEL J &amp; CHRISTOPHER M</td><td>17</td><td>97,510</td><td>0</td><td>3,824</td><td>353.00</td></tr> <tr><td>2024</td><td>2024-660006160</td><td>MCNAMARA, MICHAEL J &amp; CHRISTOPHER M</td><td>17</td><td>97,616</td><td>0</td><td>3,642</td><td>337.00</td></tr> <tr><td>2023</td><td>2023-660006160</td><td>MCNAMARA, MICHAEL J &amp; CHRISTOPHER M</td><td>17</td><td>63,125</td><td>0</td><td>3,469</td><td>318.00</td></tr> <tr><td>2022</td><td>2022-660006160</td><td>MCNAMARA, MICHAEL J &amp; CHRISTOPHER M</td><td>17</td><td>33,851</td><td>0</td><td>3,304</td><td>306.00</td></tr> <tr><td>2021</td><td>2021-660006160</td><td>MCNAMARA, MICHAEL J &amp; CHRISTOPHER M</td><td>17</td><td>28,607</td><td>0</td><td>3,147</td><td>278.00</td></tr> <tr><td>2020</td><td>2020-660006160</td><td>MCNAMARA, MICHAEL J &amp; CHRISTOPHER M</td><td>17</td><td>28,986</td><td>0</td><td>3,188</td><td>292.00</td></tr> <tr><td>2019</td><td>2019-660006160</td><td>MCNAMARA, MICHAEL J &amp; CHRISTOPHER M</td><td>17</td><td>28,179</td><td>0</td><td>3,100</td><td>287.00</td></tr> <tr><td>2018</td><td>2018-660006160</td><td>MCNAMARA, MICHAEL J &amp; CHRISTOPHER M</td><td>17</td><td>29,557</td><td>0</td><td>3,251</td><td>300.00</td></tr> <tr><td>2017</td><td>2017-660006160</td><td>MCNAMARA, MICHAEL J &amp; CHRISTOPHER M</td><td>17</td><td>29,417</td><td>0</td><td>3,236</td><td>297.00</td></tr> <tr><td>2016</td><td>2016-660006160</td><td>MCNAMARA, MICHAEL J</td><td>17</td><td>28,944</td><td>0</td><td>3,184</td><td>299.00</td></tr> <tr><td>2015</td><td>2015-660006160</td><td>MCNAMARA, MICHAEL J</td><td>17</td><td>28,735</td><td>0</td><td>3,161</td><td>285.00</td></tr> <tr><td>2014</td><td>2014-660006160</td><td>MCNAMARA, MICHAEL J</td><td>17</td><td>30,169</td><td>0</td><td>3,301</td><td>306.00</td></tr> <tr><td>2013</td><td>2013-660006160</td><td>MCNAMARA, MICHAEL J</td><td>17</td><td>31,932</td><td>0</td><td>3,143</td><td>288.00</td></tr> </tbody> </table>										Tax Year	Statement Number	Billed Owner	Tax Area	Total Value	Exemptions	Taxable Value	Billed Tax	2025	2025-660006160	MCNAMARA, MICHAEL J & CHRISTOPHER M	17	97,510	0	3,824	353.00	2024	2024-660006160	MCNAMARA, MICHAEL J & CHRISTOPHER M	17	97,616	0	3,642	337.00	2023	2023-660006160	MCNAMARA, MICHAEL J & CHRISTOPHER M	17	63,125	0	3,469	318.00	2022	2022-660006160	MCNAMARA, MICHAEL J & CHRISTOPHER M	17	33,851	0	3,304	306.00	2021	2021-660006160	MCNAMARA, MICHAEL J & CHRISTOPHER M	17	28,607	0	3,147	278.00	2020	2020-660006160	MCNAMARA, MICHAEL J & CHRISTOPHER M	17	28,986	0	3,188	292.00	2019	2019-660006160	MCNAMARA, MICHAEL J & CHRISTOPHER M	17	28,179	0	3,100	287.00	2018	2018-660006160	MCNAMARA, MICHAEL J & CHRISTOPHER M	17	29,557	0	3,251	300.00	2017	2017-660006160	MCNAMARA, MICHAEL J & CHRISTOPHER M	17	29,417	0	3,236	297.00	2016	2016-660006160	MCNAMARA, MICHAEL J	17	28,944	0	3,184	299.00	2015	2015-660006160	MCNAMARA, MICHAEL J	17	28,735	0	3,161	285.00	2014	2014-660006160	MCNAMARA, MICHAEL J	17	30,169	0	3,301	306.00	2013	2013-660006160	MCNAMARA, MICHAEL J	17	31,932	0	3,143	288.00
Tax Year	Statement Number	Billed Owner	Tax Area	Total Value	Exemptions	Taxable Value	Billed Tax																																																																																																																		
2025	2025-660006160	MCNAMARA, MICHAEL J & CHRISTOPHER M	17	97,510	0	3,824	353.00																																																																																																																		
2024	2024-660006160	MCNAMARA, MICHAEL J & CHRISTOPHER M	17	97,616	0	3,642	337.00																																																																																																																		
2023	2023-660006160	MCNAMARA, MICHAEL J & CHRISTOPHER M	17	63,125	0	3,469	318.00																																																																																																																		
2022	2022-660006160	MCNAMARA, MICHAEL J & CHRISTOPHER M	17	33,851	0	3,304	306.00																																																																																																																		
2021	2021-660006160	MCNAMARA, MICHAEL J & CHRISTOPHER M	17	28,607	0	3,147	278.00																																																																																																																		
2020	2020-660006160	MCNAMARA, MICHAEL J & CHRISTOPHER M	17	28,986	0	3,188	292.00																																																																																																																		
2019	2019-660006160	MCNAMARA, MICHAEL J & CHRISTOPHER M	17	28,179	0	3,100	287.00																																																																																																																		
2018	2018-660006160	MCNAMARA, MICHAEL J & CHRISTOPHER M	17	29,557	0	3,251	300.00																																																																																																																		
2017	2017-660006160	MCNAMARA, MICHAEL J & CHRISTOPHER M	17	29,417	0	3,236	297.00																																																																																																																		
2016	2016-660006160	MCNAMARA, MICHAEL J	17	28,944	0	3,184	299.00																																																																																																																		
2015	2015-660006160	MCNAMARA, MICHAEL J	17	28,735	0	3,161	285.00																																																																																																																		
2014	2014-660006160	MCNAMARA, MICHAEL J	17	30,169	0	3,301	306.00																																																																																																																		
2013	2013-660006160	MCNAMARA, MICHAEL J	17	31,932	0	3,143	288.00																																																																																																																		



# Rogers

## Assessment Property Record Card for Tax Year 2026

Data provided by LISA DELOZIER County Assessor

Date 04/17/2026  
Time 03:36:00  
Page 2

Lot Data		Square-Foot - NBHD 1180 #1	
Lot Size			
Lot Count	1		
Units Buildable	9373		
Non-Ag Acres	0.423		
Topography			
Street Access			
Utilities			
Amenities		0	
		0	
Method	Square-Foot		
Base Lot Value	18,427.00 x 4.15 =	76,472	
Factor Value			
Adjustments	1.0000		
Lot Value		76,472	



\\tsclient\T\TOMMY DUNLAP\New folder (187)\IMG\_0027.JPG 5/9/2023

Residential Data	
Type	1 Single Family Residence
Condition	3 - Average
Quality	1.5 - Low
Architecture	R3 Res Nbhd 3
Style	100% 1 1/2 Story Finished
Exterior Wall	100% Frame, Siding, Wood
Base/Total Area	729 / 891
Style	100% 1 1/2 Story Finished
HVAC	100% Wall Furnace 200% Forced Air Furnace
Roof Cover	1 Composition Shingle
Area on Slab	0
Fixture/RghIn	4 /
Bed/F/H Bath	3 / 1.0 /
Basement Area	
Garage Type	
Remodel	
Year/Eff Age	1930 / 72

### GRM Approach

GRM Code	
Gross Rent	0.00
Indicated Value	

### Multiple Regression

MRA Code	1 Test
Adusted R	0.8445
Indicated Value	20,688 23.22 Per SqFt

### Direct Comparables

Selection Model	A Adam Test
Adjustment Model	1 2022 Residential
Comparables	
Indicated Value	

### Value Reconciliation

Selected Approach	Cost Approach
Improvements	21,343
Lot Value	76,472
Indicated Value	97,815 109.78 Per SqFt
Agland Value	
Site Improvements	
Total Value	97,815 109.78 Total Value Per SqFt

Cost Approach		Manual : 01/2025	
Base Cost	84.31	Total Misc Impr	+ 2,662
Roofing Adj	+ 3.68	Garage Cost	+ 0
Subfloor Adj	+ 2.23	Total RCN	= 92,796
Heat/Cool Adj	+ 5.53	Depreciation ( 77%)	- 71,453
Plumbing Adj	+ 5.41	Lump Sums	+ 0
Basement Adj	+ 0.00	RCNLD	= 21,343
Adj Base Cost	= 101.16	Lot Value	+ 76,472
Total Area	x 891	Indicated Value	= 97,815
Adjusted Cost	= 90,134	Value Per SqFt	109.78

### Miscellaneous Improvements

Code	Description	Sketch ID	Size	Year	Units	Unit Cost	Depr	Value
PRCH	SLAB PORCH - COVERED	14768	22x6		132	20.17		2,662



# Rogers

## Assessment Property Record Card for Tax Year 2026

Data provided by LISA DELOZIER County Assessor

Date 04/17/2026

Time 03:36:00

Page 3

Sketch Image

660006160

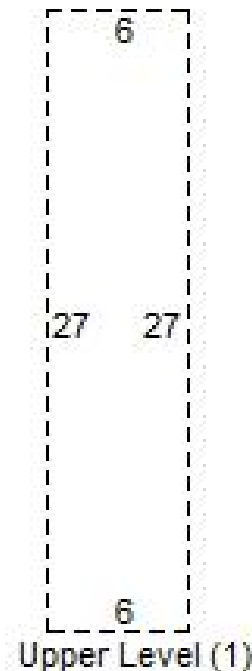
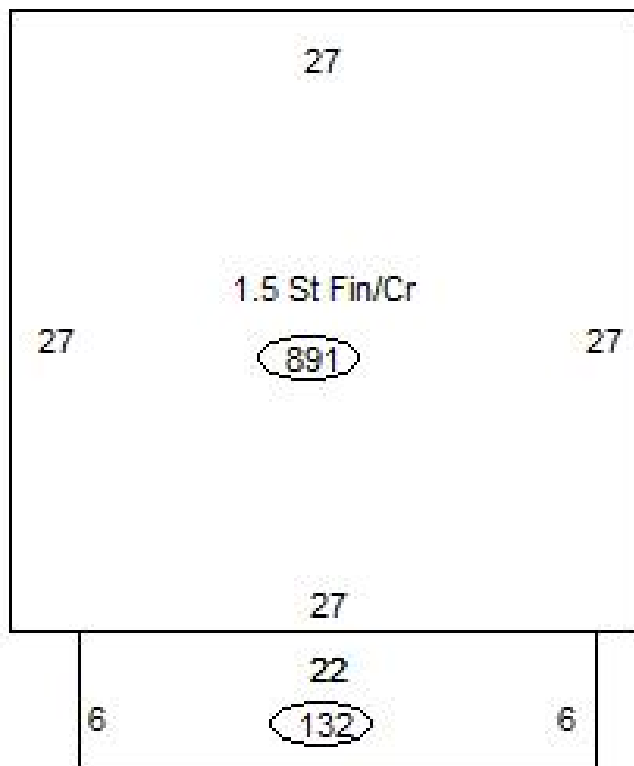

### Sketch Vector Information

Sequence	Code	Type	Built Over	Scale	Section Label	Base Area	Multiplier	Total Area
1	R	5	Crawl	13	1.5 St Fin/Cr	729	1.222	891
2	M	PRCH		13	SLBC	132	1.000	132
3	U	^UL		13	Upper Level (1)	162	1.000	162
<b>Total Building Area</b>						729		891