



# Rogers

## Assessment Property Record Card for Tax Year 2026

Data provided by LISA DELOZIER County Assessor

Date 04/17/2026  
Time 02:08:51  
Page 1

Assessment Data					Primary Image				
Account	660006193								
Parcel ID	000000-00-0-10470-001-0022								
Cadastral ID	07-21-16-05280								
Property Type	REAL - Real Property								
Property Class	URP	VI Area	1						
Tax Area	17 - CLAREMORE OT								
Name ID	308538								
ROGERS, LESLIE K									
2417 W DRIFTWOOD DR CLAREMORE OK 74017-0000									
Parcel Location									
Situs	00627 S MAYWOOD DR								
Subdivision	WESTWOOD ESTATES I								
Lot/Block	0022 / 0001	Parcel Size	1 - Lots						
Sec/Twn/Rng	7 / 21 / 16 / 5								
Neighborhood	1180 - R-V01-SW CLAREMORE								
School District	S001 - CLAREMORE SCHOOLS								
Legal Description Lat/Long: 36.30889949 -95.63814284									
Building Permits									
LOT 22 BLOCK 1 WESTWOOD ESTATES I									
Exemptions									
Code	Type	Active	Maximum	Exemption	Sale History				
H	Homestead	No	1,000		Bk/Pg	Grantor	Date	Price	Code
					/	PETERSON, LAURA A &	04/21/2025	72,500	4
					2515/514	DOWLER, CONNIE M	12/04/2015	0	4
					2515/511	DOWLER, FORREST W	12/04/2015	0	4
Parcel Valuation									
Source	REAL	Fair Cash	Capped	Asmnt Level	Assessed	Levy Rate	92.430	Current Tax	
Remove Cap	0	Land Value	37,080	17,454	11%	1,920	Assessed	6,774 626.12	
Year Frozen	1998	Improvements	96,826	44,130	4,854	Penalty	0		
Uncapped Value	0	Mobile Home	0	0	0	Exemption	0	0.00	
TIF Project ID	0	Total Value	133,906	61,584	6,774	Total Taxable	6,774	626.00	
Assessment History									
Tax Year	Statement Number	Billed Owner	Tax Area	Total Value	Exemptions	Taxable Value	Billed Tax		
2025	2025-660006193	ROGERS, LESLIE K	17	130,829	1000	5,452	504.00		
2024	2024-660006193	DOWLER, CONNIE M &	17	137,551	1000	5,452	504.00		
2023	2023-660006193	DOWLER, CONNIE M &	17	129,568	1000	5,452	499.00		
2022	2022-660006193	DOWLER, CONNIE M &	17	103,077	1000	5,452	505.00		
2021	2021-660006193	DOWLER, CONNIE M &	17	106,262	1000	5,451	481.00		
2020	2020-660006193	DOWLER, CONNIE M &	17	107,090	1000	5,452	499.00		
2019	2019-660006193	DOWLER, CONNIE M &	17	102,328	1000	5,452	505.00		
2018	2018-660006193	DOWLER, CONNIE M &	17	106,575	1000	5,452	504.00		
2017	2017-660006193	DOWLER, CONNIE M &	17	105,744	1000	5,451	501.00		
2016	2016-660006193	DOWLER, CONNIE M &	17	103,200	1000	5,451	512.00		
2015	2015-660006193	DOWLER, FORREST W	17	102,321	1000	5,452	492.00		
2014	2014-660006193	DOWLER, FORREST W	17	104,197	1000	5,451	505.00		
2013	2013-660006193	DOWLER, FORREST W	17	98,569	1000	5,452	499.00		



# Rogers

## Assessment Property Record Card for Tax Year 2026

Data provided by LISA DELOZIER County Assessor

Date 04/17/2026  
Time 02:08:51  
Page 2

Lot Data	Square-Foot - NBHD 1180 #1	Primary Image
Lot Size		
Lot Count	1	
Units Buildable	10500	
Non-Ag Acres	0.2051	
Topography		
Street Access		
Utilities		
Amenities	0	
	0	
Method	Square-Foot	
Base Lot Value	8,935.00 x 4.15 = 37,080	
Factor Value		
Adjustments	1.0000	
Lot Value	37,080	

Residential Data	
Type	1 Single Family Residence
Condition	3 - Average
Quality	2.5 - Fair
Architecture	R3 Res Nbhd 3
Style	100% One Story
Exterior Wall	100% Veneer, Masonry
Base/Total Area	1,270 / 1,270
Style	100% One Story
HVAC	100% Warmed & Cooled Air
Roof Cover	1 Composition Shingle
Area on Slab	1,270
Fixture/RghIn	7 /
Bed/F/H Bath	3 / 1.5 /
Basement Area	
Garage Type	440 Attached Garage - Unfinished 2 Stalls
Remodel	
Year/Eff Age	1974 / 39

\\tsclient\T\LOGAN\LOGAN RESIDENTIAL VI\2023-5-9\IMG\_0025. 5/9/2023

GRM Approach	
GRM Code	
Gross Rent	0.00
Indicated Value	

Multiple Regression			
MRA Code	1	Test	
Adusted R	0.8445		
Indicated Value	138,440	109.01	Per SqFt

Direct Comparables			
Selection Model	A	Adam Test	
Adjustment Model	1	2022 Residential	
Comparables	8		
Indicated Value	171,270		Per SqFt

Cost Approach				Manual : 01/2025			
Base Cost	108.76	Total Misc Impr	+	7,474			
Roofing Adj	+ 4.58	Garage Cost	+	12,487			
Subfloor Adj	+ -1.17	Total RCN	=	186,204			
Heat/Cool Adj	+ 11.47	Depreciation ( 48%)	-	89,378			
Plumbing Adj	+ 7.26	Lump Sums	+	0			
Basement Adj	+ 0.00	RCNLD	=	96,826			
Adj Base Cost	= 130.90	Lot Value	+	37,080			
Total Area	x 1,270	Indicated Value	=	133,906			
Adjusted Cost	= 166,243	Value Per SqFt		105.44			

Value Reconciliation			
Selected Approach	Cost Approach		
Improvements	96,826		
Lot Value	37,080		
Indicated Value	133,906	105.44	Per SqFt
Agland Value			
Site Improvements			
Total Value	133,906	105.44	Total Value Per SqFt

Miscellaneous Improvements								
Code	Description	Sketch ID	Size	Year	Units	Unit Cost	Depr	Value
FPR1	FIREPLACE - RESIDENTIAL 1 STORY	0		1	1	5,095.98		5,096
PRCH	SLAB PORCH - COVERED	14889		30	30	24.17		725
PATO	SLAB PORCH - OPEN	14890	16x10		160	10.33		1,653



**Rogers**  
**Assessment Property Record Card for Tax Year 2026**

Data provided by LISA DELOZIER County Assessor

Date 04/17/2026  
 Time 02:08:51  
 Page 3

Sketch Image

660006193

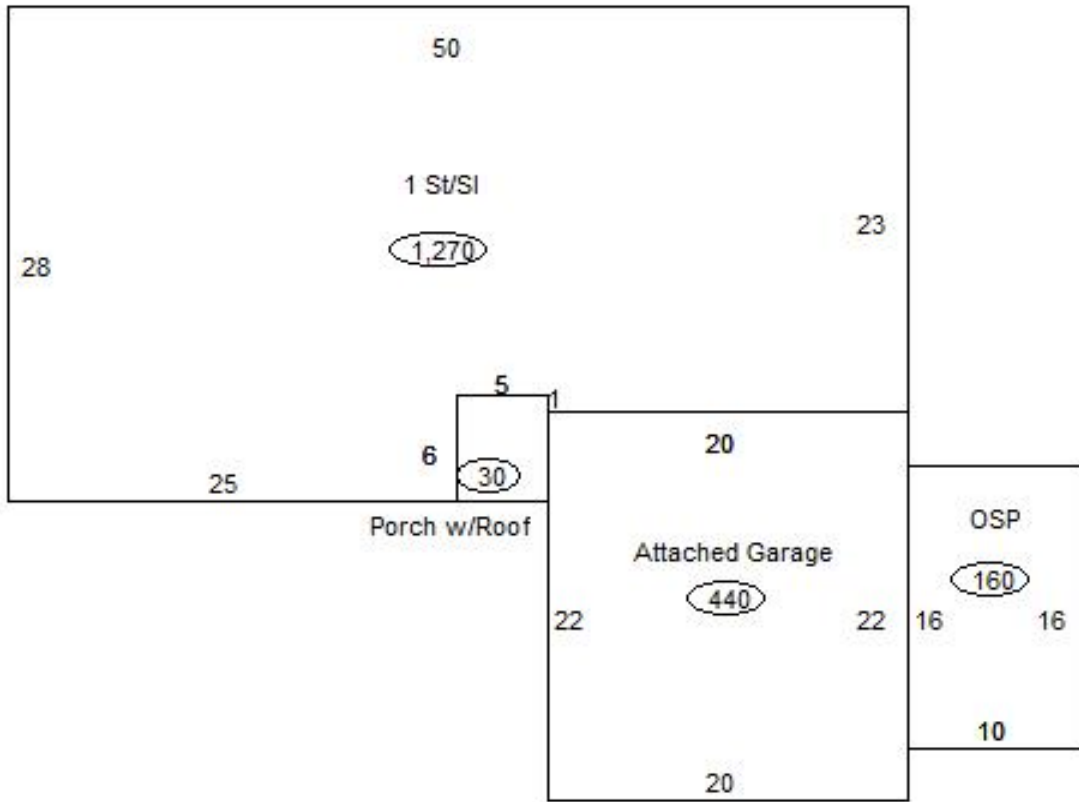

**Sketch Vector Information**

Sequence	Code	Type	Built Over	Scale	Section Label	Base Area	Multiplier	Total Area
1	R	1	Slab	13	1 St/Sl	1,270	1.000	1,270
2	G	1		13	Attached Garage	440	1.000	440
3	M	PRCH		13	SLBC	30	1.000	30
4	M	PATO		13	Open Slab	160	1.000	160
<b>Total Building Area</b>						1,270		1,270



# Rogers

## Assessment Property Record Card for Tax Year 2026

Data provided by LISA DELOZIER County Assessor

Date 04/17/2026  
Time 02:08:51  
Page 4

660006193

### Outbuildings/Site Improvements

Building Image	Code	Description	Dimensions	Floor	Roofing	Total Units
	STF	STG FAIR	0x0x0			
	Qual	2	Cond	Year	Eff Age	
<b>Valuation Summary</b>			<b>Modifier Total</b>	<b>RCN</b>	<b>Depr (0% Phys/ % Func)</b>	<b>RCNLD</b>
		Base Cost (4.68 x )				