



# Rogers

## Assessment Property Record Card for Tax Year 2026

Data provided by LISA DELOZIER County Assessor

Date 04/17/2026  
Time 02:58:26  
Page 1

Assessment Data	Primary Image
<b>Account</b> 660006197 <b>Parcel ID</b> 000000-00-0-10470-001-0026 <b>Cadastral ID</b> 07-21-16-05320 <b>Property Type</b> REAL - Real Property <b>Property Class</b> URP VI Area 1 <b>Tax Area</b> 17 - CLAREMORE OT <b>Name ID</b> 338771 WELCOME TO YOUR HOME LLC	

PO BOX 2872  
CLAREMORE OK 74018-0000

### Parcel Location

**Situs** 00643 S MAYWOOD DR  
**Subdivision** WESTWOOD ESTATES I  
**Lot/Block** 0026 / 0001 **Parcel Size** 1 - Lots  
**Sec/Twn/Rng** 7 / 21 / 16 / 5  
**Neighborhood** 1180 - R-V01-SW CLAREMORE  
**School District** S001 - CLAREMORE SCHOOLS

\\tsclient\T\LOGAN\LOGAN RESIDENTIAL VI\2023-5-9\IMG\_0029. 5/9/2023

Legal Description	Lat/Long: 36.30824690 -95.63804889	Building Permits
-------------------	------------------------------------	------------------

LOT 26 BLOCK 1 WESTWOOD ESTATES I

Number	Description	Opened	Closed	Amount
R11	R11 REMOVING ADDITION IN BACK AI	04/2008	09/2010	

Exemptions	Sale History
------------	--------------

Code	Type	Active	Maximum	Exemption

Bk/Pg	Grantor	Date	Price	Code
/	WILSON, KIT T &	08/22/2025	155,000	YES
2675/675	WILSON, LESTER H	11/20/2017	0	4
1962/504	WILSON, ERIC S & KIT	06/25/2008	0	4
1941/934	ESPARZA, CRESCENCIO &	03/25/2008	89,000	YES
1211/860	CRAIG, MYRNA ELIA	01/20/2000	92,000	No
1004/476	MALOY, DEWAYNE &	10/06/1995	66,500	Yes

Parcel Valuation
------------------

Source	REAL	Fair Cash	Capped	Asmnt Level	Assessed	Levy Rate	92.430	Current Tax
Remove Cap	2026	Land Value 37,234	37,234	11%	4,096	Assessed	17,417	1,609.85
Year Frozen	0	Improvements 121,098	121,098		13,321	Penalty	0	
Uncapped Value	0	Mobile Home 0	0		0	Exemption	0	0.00
TIF Project ID	0	Total Value 158,332	158,332		17,417	Total Taxable	17,417	1,610.00

Assessment History
--------------------

Tax Year	Statement Number	Billed Owner	Tax Area	Total Value	Exemptions	Taxable Value	Billed Tax
2025	2025-660006197	WELCOME TO YOUR HOME LLC	17	129,978	0	13,002	1,202.00
2024	2024-660006197	WILSON, KIT T &	17	135,763	0	12,383	1,144.00
2023	2023-660006197	WILSON, KIT T &	17	129,000	0	11,793	1,080.00
2022	2022-660006197	WILSON, KIT T &	17	102,102	0	11,231	1,040.00
2021	2021-660006197	WILSON, KIT T &	17	103,063	0	11,337	1,001.00
2020	2020-660006197	WILSON, KIT T &	17	101,499	0	11,165	1,022.00
2019	2019-660006197	WILSON, KIT T &	17	97,581	0	10,734	994.00
2018	2018-660006197	WILSON, KIT T &	17	107,976	0	11,877	1,097.00
2017	2017-660006197	WILSON, LESTER H	17	107,096	0	11,781	1,082.00
2016	2016-660006197	WILSON, LESTER H	17	104,534	0	11,499	1,079.00
2015	2015-660006197	WILSON, LESTER H	17	105,418	0	11,596	1,046.00
2014	2014-660006197	WILSON, LESTER H	17	106,221	0	11,333	1,051.00
2013	2013-660006197	WILSON, LESTER H	17	128,853	0	10,793	988.00



# Rogers

## Assessment Property Record Card for Tax Year 2026

Data provided by LISA DELOZIER County Assessor

Date 04/17/2026  
 Time 02:58:26  
 Page 2

Lot Data	Square-Foot - NBHD 1180 #1	Primary Image
<b>Lot Size</b> <b>Lot Count</b> 1 <b>Units Buildable</b> 10500 <b>Non-Ag Acres</b> 0.206 <b>Topography</b> <b>Street Access</b> <b>Utilities</b> <b>Amenities</b> 0  <b>Method</b> Square-Foot <b>Base Lot Value</b> 8,972.00 x 4.15 = 37,234 <b>Factor Value</b> <b>Adjustments</b> 1.0000 <b>Lot Value</b> 37,234		 <p>\\tsclient\T\LOGAN\LOGAN RESIDENTIAL VI\2023-5-9\IMG_0029. 5/9/2023</p>

Residential Data	
<b>Type</b>	1 Single Family Residence
<b>Condition</b>	3 - Average
<b>Quality</b>	2.5 - Fair
<b>Architecture</b>	R3 Res Nbhd 3
<b>Style</b>	100% One Story
<b>Exterior Wall</b>	90% Veneer, Stone 10% Frame, Siding, Vinyl
<b>Base/Total Area</b>	1,539 / 1,539
<b>Style</b>	100% One Story
<b>HVAC</b>	100% Warmed & Cooled Air
<b>Roof Cover</b>	1 Composition Shingle
<b>Area on Slab</b>	1,539
<b>Fixture/RghIn</b>	8 /
<b>Bed/F/H Bath</b>	3 / 2.0 /
<b>Basement Area</b>	
<b>Garage Type</b>	550 Attached Garage - Unfinished 2 Stalls
<b>Remodel</b>	
<b>Year/Eff Age</b>	1973 / 40



GRM Approach	
<b>GRM Code</b>	
<b>Gross Rent</b>	0.00
<b>Indicated Value</b>	

Multiple Regression			
<b>MRA Code</b>	1	Test	
<b>Adusted R</b>	0.8445		
<b>Indicated Value</b>	163,884	106.49	Per SqFt

Direct Comparables			
<b>Selection Model</b>	A	Adam Test	
<b>Adjustment Model</b>	1	2022 Residential	
<b>Comparables</b>	8		
<b>Indicated Value</b>	194,390		Per SqFt

Cost Approach				Manual : 01/2025			
<b>Base Cost</b>	110.67	<b>Total Misc Impr</b>	+	14,548			
<b>Roofing Adj</b>	+ 4.49	<b>Garage Cost</b>	+	14,784			
<b>Subfloor Adj</b>	+ -1.15	<b>Total RCN</b>	=	232,880			
<b>Heat/Cool Adj</b>	+ 11.47	<b>Depreciation ( 48%)</b>	-	111,782			
<b>Plumbing Adj</b>	+ 6.78	<b>Lump Sums</b>	+	0			
<b>Basement Adj</b>	+ 0.00	<b>RCNLD</b>	=	121,098			
<b>Adj Base Cost</b>	= 132.26	<b>Lot Value</b>	+	37,234			
<b>Total Area</b>	x 1,539	<b>Indicated Value</b>	=	158,332			
<b>Adjusted Cost</b>	= 203,548	<b>Value Per SqFt</b>		102.88			

Value Reconciliation			
<b>Selected Approach</b>	Cost Approach		
<b>Improvements</b>	121,098		
<b>Lot Value</b>	37,234		
<b>Indicated Value</b>	158,332	102.88	Per SqFt
<b>Agland Value</b>			
<b>Site Improvements</b>			
<b>Total Value</b>	158,332	102.88	Total Value Per SqFt

Miscellaneous Improvements								
Code	Description	Sketch ID	Size	Year	Units	Unit Cost	Depr	Value
FPR1	FIREPLACE - RESIDENTIAL 1 STORY	0		1	1	5,095.98		5,096
PRCH	SLAB PORCH - COVERED	14904	11x5		55	24.09		1,325
PATO	SLAB PORCH - OPEN	14905	14x11		154	10.39		1,600
PRCH	SLAB PORCH - COVERED	145002	20x14		280	23.31		6,527



**Rogers**  
**Assessment Property Record Card for Tax Year 2026**  
 Data provided by LISA DELOZIER County Assessor

Date 04/17/2026  
 Time 02:58:26  
 Page 3

Sketch Image

660006197

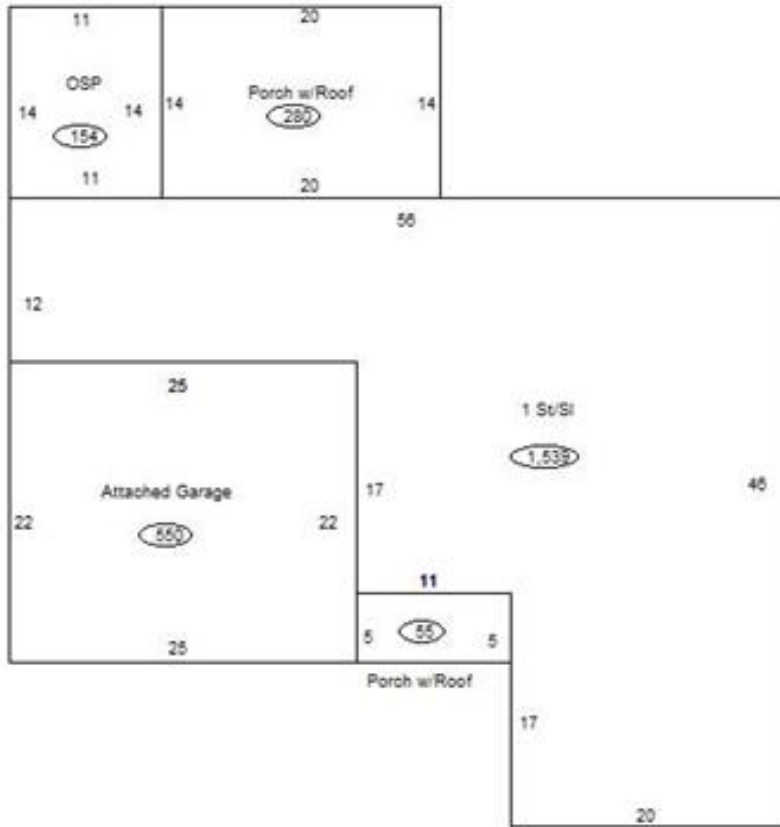

**Sketch Vector Information**

Sequence	Code	Type	Built Over	Scale	Section Label	Base Area	Multiplier	Total Area
1	R	1	Slab	13	1 St/SI	1,539	1.000	1,539
2	G	1		13	Attached Garage	550	1.000	550
3	M	PRCH		13	SLBC	55	1.000	55
4	M	PATO		13	Open Slab	154	1.000	154
5	M	PRCH		13	SLBC	280	1.000	280
<b>Total Building Area</b>						<b>1,539</b>		<b>1,539</b>



# Rogers

## Assessment Property Record Card for Tax Year 2026

Data provided by LISA DELOZIER County Assessor

Date 04/17/2026  
Time 02:58:26  
Page 4

660006197

### Outbuildings/Site Improvements

Building Image	Code	Description	Dimensions	Floor	Roofing	Total Units
	STF	STG FAIR	0x0x0			
	Qual	2	Cond	Year	Eff Age	
<b>Valuation Summary</b>		<b>Modifier Total</b>	<b>RCN</b>	<b>Depr (0% Phys/ % Func)</b>	<b>RCNLD</b>	
Base Cost (4.68 x )						