



Rogers

Assessment Property Record Card for Tax Year 2026

Data provided by LISA DELOZIER County Assessor

Date 04/18/2026
Time 05:32:02
Page 1

Assessment Data					Primary Image																																																																																																																				
Account 660006210 Parcel ID 000000-00-0-10470-002-0011 Cadastral ID 07-21-16-05450 Property Type REAL - Real Property Property Class URP VI Area 1 Tax Area 17 - CLAREMORE OT Name ID 302890 SKELTON, TRACY REVOCABLE TRUST 2303 W DRIFTWOOD CLAREMORE OK 74017-0000 Parcel Location Situs 02303 W DRIFTWOOD DR Subdivision WESTWOOD ESTATES I Lot/Block 0011 / 0002 Parcel Size 1 - Lots Sec/Twn/Rng 7 / 21 / 16 / 5 Neighborhood 1180 - R-V01-SW CLAREMORE School District S001 - CLAREMORE SCHOOLS																																																																																																																									
Legal Description Lot/Long: 36.31083521 -95.63744704																																																																																																																									
Legal Description LOT 11 BLOCK 2 WESTWOOD ESTATES I					Building Permits <table border="1"> <thead> <tr> <th>Number</th> <th>Description</th> <th>Opened</th> <th>Closed</th> <th>Amount</th> </tr> </thead> <tbody> <tr> <td></td> <td></td> <td></td> <td></td> <td></td> </tr> </tbody> </table>					Number	Description	Opened	Closed	Amount																																																																																																											
Number	Description	Opened	Closed	Amount																																																																																																																					
Exemptions <table border="1"> <thead> <tr> <th>Code</th> <th>Type</th> <th>Active</th> <th>Maximum</th> <th>Exemption</th> </tr> </thead> <tbody> <tr> <td>H</td> <td>Homestead</td> <td>Yes</td> <td>1,000</td> <td>1,000</td> </tr> </tbody> </table>					Code	Type	Active	Maximum	Exemption	H	Homestead	Yes	1,000	1,000	Sale History <table border="1"> <thead> <tr> <th>Bk/Pg</th> <th>Grantor</th> <th>Date</th> <th>Price</th> <th>Code</th> </tr> </thead> <tbody> <tr> <td>2105/409</td> <td>RADER, TADD L &</td> <td>05/26/2010</td> <td>135,000</td> <td>YES</td> </tr> <tr> <td>1860/133</td> <td>SCHMIDT, NICHOLAS J &</td> <td>04/16/2007</td> <td>154,000</td> <td>YES</td> </tr> <tr> <td>1791/162</td> <td>SEC OF HUD</td> <td>07/14/2006</td> <td>0</td> <td>YES</td> </tr> <tr> <td>1763/562</td> <td>EADS, RICKY & JENNIFER</td> <td>02/23/2006</td> <td>0</td> <td>10</td> </tr> <tr> <td>1228/246</td> <td>MANLEY, CLESTA</td> <td>05/05/2000</td> <td>118,000</td> <td>Yes</td> </tr> <tr> <td>1007/901</td> <td>STREETER, RICHARD H &</td> <td>11/14/1995</td> <td>123,500</td> <td>Yes</td> </tr> </tbody> </table>					Bk/Pg	Grantor	Date	Price	Code	2105/409	RADER, TADD L &	05/26/2010	135,000	YES	1860/133	SCHMIDT, NICHOLAS J &	04/16/2007	154,000	YES	1791/162	SEC OF HUD	07/14/2006	0	YES	1763/562	EADS, RICKY & JENNIFER	02/23/2006	0	10	1228/246	MANLEY, CLESTA	05/05/2000	118,000	Yes	1007/901	STREETER, RICHARD H &	11/14/1995	123,500	Yes																																																																			
Code	Type	Active	Maximum	Exemption																																																																																																																					
H	Homestead	Yes	1,000	1,000																																																																																																																					
Bk/Pg	Grantor	Date	Price	Code																																																																																																																					
2105/409	RADER, TADD L &	05/26/2010	135,000	YES																																																																																																																					
1860/133	SCHMIDT, NICHOLAS J &	04/16/2007	154,000	YES																																																																																																																					
1791/162	SEC OF HUD	07/14/2006	0	YES																																																																																																																					
1763/562	EADS, RICKY & JENNIFER	02/23/2006	0	10																																																																																																																					
1228/246	MANLEY, CLESTA	05/05/2000	118,000	Yes																																																																																																																					
1007/901	STREETER, RICHARD H &	11/14/1995	123,500	Yes																																																																																																																					
Parcel Valuation <table border="1"> <thead> <tr> <th>Source</th> <th>REAL</th> <th>Fair Cash</th> <th>Capped</th> <th>Asmnt Level</th> <th>Assessed</th> <th>Levy Rate</th> <th>92.430</th> <th>Current Tax</th> </tr> </thead> <tbody> <tr> <td>Remove Cap</td> <td>2011</td> <td>Land Value 67,313</td> <td>32,930</td> <td>11%</td> <td>3,622</td> <td>Assessed</td> <td>21,661</td> <td>2,002.13</td> </tr> <tr> <td>Year Frozen</td> <td>0</td> <td>Improvements 174,716</td> <td>163,989</td> <td></td> <td>18,039</td> <td>Penalty</td> <td>0</td> <td></td> </tr> <tr> <td>Uncapped Value</td> <td>0</td> <td>Mobile Home 0</td> <td>0</td> <td></td> <td>0</td> <td>Exemption</td> <td>1,000</td> <td>-92.00</td> </tr> <tr> <td>TIF Project ID</td> <td>0</td> <td>Total Value 242,029</td> <td>196,919</td> <td></td> <td>21,661</td> <td>Total Taxable</td> <td>20,661</td> <td>1,910.00</td> </tr> </tbody> </table>										Source	REAL	Fair Cash	Capped	Asmnt Level	Assessed	Levy Rate	92.430	Current Tax	Remove Cap	2011	Land Value 67,313	32,930	11%	3,622	Assessed	21,661	2,002.13	Year Frozen	0	Improvements 174,716	163,989		18,039	Penalty	0		Uncapped Value	0	Mobile Home 0	0		0	Exemption	1,000	-92.00	TIF Project ID	0	Total Value 242,029	196,919		21,661	Total Taxable	20,661	1,910.00																																																																			
Source	REAL	Fair Cash	Capped	Asmnt Level	Assessed	Levy Rate	92.430	Current Tax																																																																																																																	
Remove Cap	2011	Land Value 67,313	32,930	11%	3,622	Assessed	21,661	2,002.13																																																																																																																	
Year Frozen	0	Improvements 174,716	163,989		18,039	Penalty	0																																																																																																																		
Uncapped Value	0	Mobile Home 0	0		0	Exemption	1,000	-92.00																																																																																																																	
TIF Project ID	0	Total Value 242,029	196,919		21,661	Total Taxable	20,661	1,910.00																																																																																																																	
Assessment History <table border="1"> <thead> <tr> <th>Tax Year</th> <th>Statement Number</th> <th>Billed Owner</th> <th>Tax Area</th> <th>Total Value</th> <th>Exemptions</th> <th>Taxable Value</th> <th>Billed Tax</th> </tr> </thead> <tbody> <tr><td>2025</td><td>2025-660006210</td><td>SKELTON, TRACY</td><td>17</td><td>236,317</td><td>1000</td><td>20,030</td><td>1,851.00</td></tr> <tr><td>2024</td><td>2024-660006210</td><td>SKELTON, TRACY</td><td>17</td><td>248,578</td><td>1000</td><td>19,417</td><td>1,795.00</td></tr> <tr><td>2023</td><td>2023-660006210</td><td>SKELTON, TRACY</td><td>17</td><td>197,284</td><td>1000</td><td>18,823</td><td>1,724.00</td></tr> <tr><td>2022</td><td>2022-660006210</td><td>SKELTON, TRACY</td><td>17</td><td>174,962</td><td>1000</td><td>18,246</td><td>1,689.00</td></tr> <tr><td>2021</td><td>2021-660006210</td><td>SKELTON, TRACY</td><td>17</td><td>179,260</td><td>1000</td><td>18,375</td><td>1,623.00</td></tr> <tr><td>2020</td><td>2020-660006210</td><td>REVOCABLE TRUST OF</td><td>17</td><td>180,464</td><td>1000</td><td>17,811</td><td>1,631.00</td></tr> <tr><td>2019</td><td>2019-660006210</td><td>REVOCABLE TRUST OF</td><td>17</td><td>172,191</td><td>1000</td><td>17,263</td><td>1,599.00</td></tr> <tr><td>2018</td><td>2018-660006210</td><td>REVOCABLE TRUST OF</td><td>17</td><td>177,720</td><td>1000</td><td>16,731</td><td>1,546.00</td></tr> <tr><td>2017</td><td>2017-660006210</td><td>REVOCABLE TRUST OF</td><td>17</td><td>176,223</td><td>1000</td><td>16,215</td><td>1,489.00</td></tr> <tr><td>2016</td><td>2016-660006210</td><td>REVOCABLE TRUST OF</td><td>17</td><td>171,546</td><td>1000</td><td>15,714</td><td>1,475.00</td></tr> <tr><td>2015</td><td>2015-660006210</td><td>REVOCABLE TRUST OF</td><td>17</td><td>165,981</td><td>1000</td><td>15,227</td><td>1,373.00</td></tr> <tr><td>2014</td><td>2014-660006210</td><td>REVOCABLE TRUST OF</td><td>17</td><td>169,236</td><td>1000</td><td>14,754</td><td>1,368.00</td></tr> <tr><td>2013</td><td>2013-660006210</td><td>REVOCABLE TRUST OF</td><td>17</td><td>159,143</td><td>1000</td><td>14,296</td><td>1,308.00</td></tr> </tbody> </table>										Tax Year	Statement Number	Billed Owner	Tax Area	Total Value	Exemptions	Taxable Value	Billed Tax	2025	2025-660006210	SKELTON, TRACY	17	236,317	1000	20,030	1,851.00	2024	2024-660006210	SKELTON, TRACY	17	248,578	1000	19,417	1,795.00	2023	2023-660006210	SKELTON, TRACY	17	197,284	1000	18,823	1,724.00	2022	2022-660006210	SKELTON, TRACY	17	174,962	1000	18,246	1,689.00	2021	2021-660006210	SKELTON, TRACY	17	179,260	1000	18,375	1,623.00	2020	2020-660006210	REVOCABLE TRUST OF	17	180,464	1000	17,811	1,631.00	2019	2019-660006210	REVOCABLE TRUST OF	17	172,191	1000	17,263	1,599.00	2018	2018-660006210	REVOCABLE TRUST OF	17	177,720	1000	16,731	1,546.00	2017	2017-660006210	REVOCABLE TRUST OF	17	176,223	1000	16,215	1,489.00	2016	2016-660006210	REVOCABLE TRUST OF	17	171,546	1000	15,714	1,475.00	2015	2015-660006210	REVOCABLE TRUST OF	17	165,981	1000	15,227	1,373.00	2014	2014-660006210	REVOCABLE TRUST OF	17	169,236	1000	14,754	1,368.00	2013	2013-660006210	REVOCABLE TRUST OF	17	159,143	1000	14,296	1,308.00
Tax Year	Statement Number	Billed Owner	Tax Area	Total Value	Exemptions	Taxable Value	Billed Tax																																																																																																																		
2025	2025-660006210	SKELTON, TRACY	17	236,317	1000	20,030	1,851.00																																																																																																																		
2024	2024-660006210	SKELTON, TRACY	17	248,578	1000	19,417	1,795.00																																																																																																																		
2023	2023-660006210	SKELTON, TRACY	17	197,284	1000	18,823	1,724.00																																																																																																																		
2022	2022-660006210	SKELTON, TRACY	17	174,962	1000	18,246	1,689.00																																																																																																																		
2021	2021-660006210	SKELTON, TRACY	17	179,260	1000	18,375	1,623.00																																																																																																																		
2020	2020-660006210	REVOCABLE TRUST OF	17	180,464	1000	17,811	1,631.00																																																																																																																		
2019	2019-660006210	REVOCABLE TRUST OF	17	172,191	1000	17,263	1,599.00																																																																																																																		
2018	2018-660006210	REVOCABLE TRUST OF	17	177,720	1000	16,731	1,546.00																																																																																																																		
2017	2017-660006210	REVOCABLE TRUST OF	17	176,223	1000	16,215	1,489.00																																																																																																																		
2016	2016-660006210	REVOCABLE TRUST OF	17	171,546	1000	15,714	1,475.00																																																																																																																		
2015	2015-660006210	REVOCABLE TRUST OF	17	165,981	1000	15,227	1,373.00																																																																																																																		
2014	2014-660006210	REVOCABLE TRUST OF	17	169,236	1000	14,754	1,368.00																																																																																																																		
2013	2013-660006210	REVOCABLE TRUST OF	17	159,143	1000	14,296	1,308.00																																																																																																																		



Rogers

Assessment Property Record Card for Tax Year 2026

Data provided by LISA DELOZIER County Assessor

Date 04/18/2026
Time 05:32:02
Page 2

Lot Data	Square-Foot - NBHD 1180 #1	Primary Image
Lot Size		
Lot Count	1	
Units Buildable	10500	
Non-Ag Acres	0.3724	
Topography		
Street Access		
Utilities		
Amenities	0	
	0	
Method	Square-Foot	
Base Lot Value	16,220.00 x 4.15 = 67,313	
Factor Value		
Adjustments	1.0000	
Lot Value	67,313	

Residential Data	
Type	1 Single Family Residence
Condition	3 - Average
Quality	3 - Average
Architecture	R3 Res Nbhd 3
Style	100% One Story
Exterior Wall	100% Veneer, Stone
Base/Total Area	2,235 / 2,235
Style	100% One Story
HVAC	100% Warmed & Cooled Air
Roof Cover	1 Composition Shingle
Area on Slab	2,235
Fixture/RghIn	10 /
Bed/F/H Bath	3 / 2.5 /
Basement Area	
Garage Type	571 Attached Garage - Unfinished 2 Stalls
Remodel	
Year/Eff Age	1974 / 39



\\tsclient\T\LOGAN\LOGAN RESIDENTIAL VI\2023-5-9\IMG_0048. 5/9/2023

GRM Approach	
GRM Code	
Gross Rent	0.00
Indicated Value	

Multiple Regression			
MRA Code	1	Test	
Adusted R	0.8445		
Indicated Value	236,768	105.94	Per SqFt

Direct Comparables			
Selection Model	A	Adam Test	
Adjustment Model	1	2022 Residential	
Comparables	8		
Indicated Value	264,450		Per SqFt

Value Reconciliation			
Selected Approach	Cost Approach		
Improvements	174,716		
Lot Value	67,313		
Indicated Value	242,029	108.29	Per SqFt
Agland Value			
Site Improvements			
Total Value	242,029	108.29	Total Value Per SqFt

Cost Approach				Manual : 01/2025			
Base Cost	110.36	Total Misc Impr	+	6,900			
Roofing Adj	+ 4.58	Garage Cost	+	17,661			
Subfloor Adj	+ -2.19	Total RCN	=	319,000			
Heat/Cool Adj	+ 12.64	Depreciation (46%)	-	146,740			
Plumbing Adj	+ 6.35	Lump Sums	+	2,456			
Basement Adj	+ 0.00	RCNLD	=	174,716			
Adj Base Cost	= 131.74	Lot Value	+	67,313			
Total Area	x 2,235	Indicated Value	=	242,029			
Adjusted Cost	= 294,439	Value Per SqFt		108.29			

Miscellaneous Improvements								
Code	Description	Sketch ID	Size	Year	Units	Unit Cost	Depr	Value
FPR1	FIREPLACE - RESIDENTIAL 1 STORY	0		1	1	5,615.40		5,615
PRCH	SLAB PORCH - COVERED	14961	12x4		48	26.78		1,285
WODO	WOOD DECK - OPEN	14962	176		176	23.26	40%	2,456



Rogers

Assessment Property Record Card for Tax Year 2026

Data provided by LISA DELOZIER County Assessor

Date 04/18/2026
 Time 05:32:02
 Page 3

Sketch Image

660006210

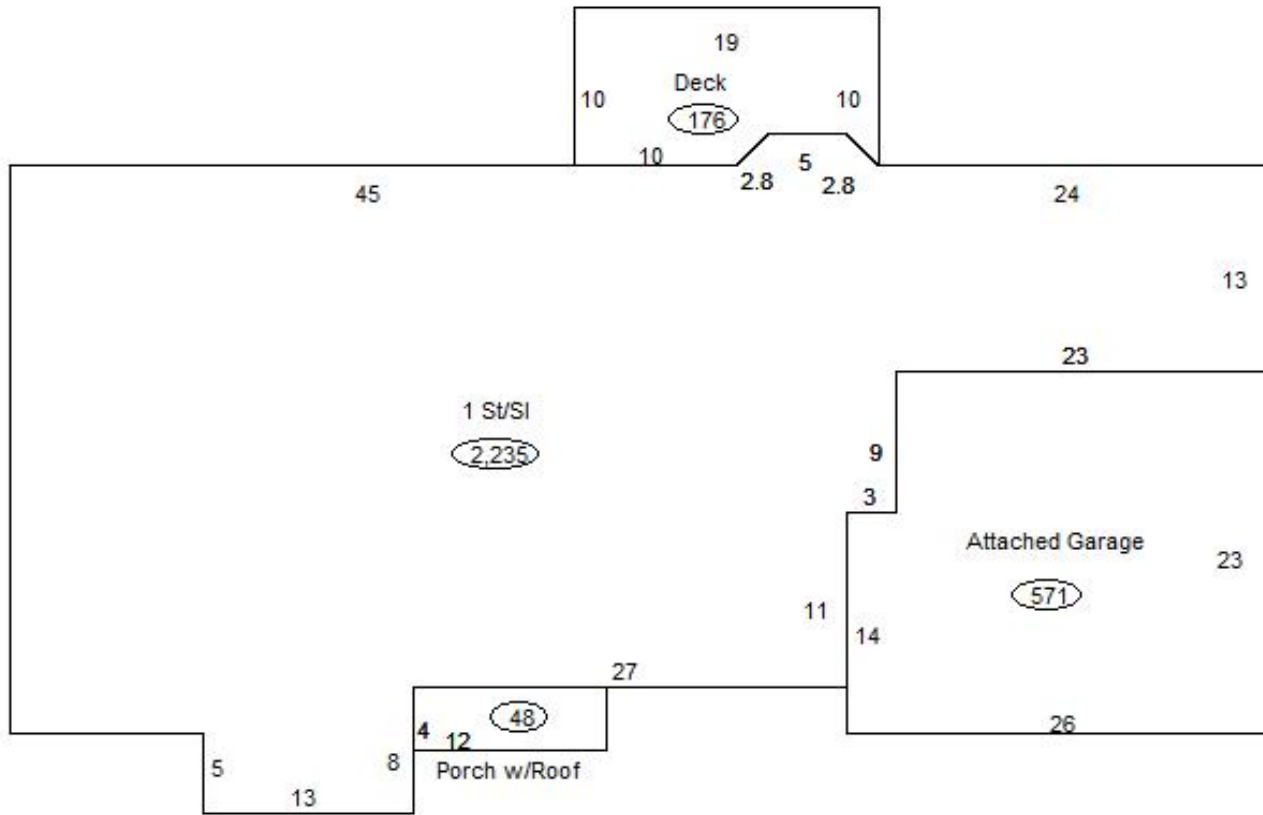

Sketch Vector Information

Sequence	Code	Type	Built Over	Scale	Section Label	Base Area	Multiplier	Total Area
1	R	1	Slab	13	1 St/Sl	2,235	1.000	2,235
2	G	1		13	Attached Garage	571	1.000	571
3	M	PRCH		13	SLBC	48	1.000	48
4	M	WODO		13	WODO	176	1.000	176
Total Building Area						2,235		2,235



Rogers

Assessment Property Record Card for Tax Year 2026

Data provided by LISA DELOZIER County Assessor

Date 04/18/2026
Time 05:32:02
Page 4

660006210

Outbuildings/Site Improvements

Building Image	Code	Description	Dimensions	Floor	Roofing	Total Units
	STF	STG FAIR	0x0x0			
	Qual	2	Cond	Year	Eff Age	
Valuation Summary			Modifier Total	RCN	Depr (0% Phys/ % Func)	RCNLD
		Base Cost (4.68 x)				