



Rogers

Assessment Property Record Card for Tax Year 2026

Data provided by LISA DELOZIER County Assessor

Date 04/17/2026
 Time 03:09:00
 Page 1

Assessment Data					Primary Image																																																																																																																				
Account 660006223 Parcel ID 000000-00-0-10470-004-0002 Cadastral ID 07-21-16-05580 Property Type REAL - Real Property Property Class URP VI Area 1 Tax Area 17 - CLAREMORE OT Name ID 344733 NOTTINGHAM STATION LLC 25622 S 4120 RD CLAREMORE OK 74019-0000 Parcel Location Situs 00507 RIDGEVIEW DR Subdivision WESTWOOD ESTATES I Lot/Block 0002 / 0004 Parcel Size 1 - Lots Sec/Twn/Rng 7 / 21 / 16 / 5 Neighborhood 1180 - R-V01-SW CLAREMORE School District S001 - CLAREMORE SCHOOLS																																																																																																																									
Legal Description Lot/Long: 36.31031728 -95.63917511										\\tsclient\T\LOGAN\LOGAN RESIDENTIAL VI\2023-5-9\IMG_0068. 5/9/2023																																																																																																															
Legal Description LOT 2 BLOCK 4 WESTWOOD ESTATES I					Building Permits <table border="1"> <thead> <tr> <th>Number</th> <th>Description</th> <th>Opened</th> <th>Closed</th> <th>Amount</th> </tr> </thead> <tbody> <tr> <td> </td> <td> </td> <td> </td> <td> </td> <td> </td> </tr> </tbody> </table>					Number	Description	Opened	Closed	Amount																																																																																																											
Number	Description	Opened	Closed	Amount																																																																																																																					
Exemptions <table border="1"> <thead> <tr> <th>Code</th> <th>Type</th> <th>Active</th> <th>Maximum</th> <th>Exemption</th> </tr> </thead> <tbody> <tr> <td>H</td> <td>Homestead</td> <td>No</td> <td>1,000</td> <td> </td> </tr> <tr> <td>H</td> <td>Homestead</td> <td>No</td> <td>1,000</td> <td> </td> </tr> </tbody> </table>					Code	Type	Active	Maximum	Exemption	H	Homestead	No	1,000		H	Homestead	No	1,000		Sale History <table border="1"> <thead> <tr> <th>Bk/Pg</th> <th>Grantor</th> <th>Date</th> <th>Price</th> <th>Code</th> </tr> </thead> <tbody> <tr> <td>/</td> <td>FIRST UNITED BANK & TRUST CO</td> <td>08/06/2025</td> <td>165,500</td> <td>3</td> </tr> <tr> <td>/</td> <td>JOHNSON, ROBERTA L</td> <td>05/15/2025</td> <td>0</td> <td>10</td> </tr> <tr> <td>/</td> <td>ROBINSON, LOU ETTA</td> <td>08/14/2020</td> <td>160,000</td> <td>YES</td> </tr> <tr> <td>2264/315</td> <td>LYNCH, ONITA C</td> <td>08/13/2012</td> <td>125,000</td> <td>YES</td> </tr> <tr> <td>1142/559</td> <td>BICKEL, RUSSELL W</td> <td>10/19/1998</td> <td>94,000</td> <td>Yes</td> </tr> <tr> <td>956/46</td> <td>SELLER</td> <td>05/05/1994</td> <td>0</td> <td>No</td> </tr> </tbody> </table>					Bk/Pg	Grantor	Date	Price	Code	/	FIRST UNITED BANK & TRUST CO	08/06/2025	165,500	3	/	JOHNSON, ROBERTA L	05/15/2025	0	10	/	ROBINSON, LOU ETTA	08/14/2020	160,000	YES	2264/315	LYNCH, ONITA C	08/13/2012	125,000	YES	1142/559	BICKEL, RUSSELL W	10/19/1998	94,000	Yes	956/46	SELLER	05/05/1994	0	No																																																														
Code	Type	Active	Maximum	Exemption																																																																																																																					
H	Homestead	No	1,000																																																																																																																						
H	Homestead	No	1,000																																																																																																																						
Bk/Pg	Grantor	Date	Price	Code																																																																																																																					
/	FIRST UNITED BANK & TRUST CO	08/06/2025	165,500	3																																																																																																																					
/	JOHNSON, ROBERTA L	05/15/2025	0	10																																																																																																																					
/	ROBINSON, LOU ETTA	08/14/2020	160,000	YES																																																																																																																					
2264/315	LYNCH, ONITA C	08/13/2012	125,000	YES																																																																																																																					
1142/559	BICKEL, RUSSELL W	10/19/1998	94,000	Yes																																																																																																																					
956/46	SELLER	05/05/1994	0	No																																																																																																																					
Parcel Valuation <table border="1"> <thead> <tr> <th>Source</th> <th>REAL</th> <th>Fair Cash</th> <th>Capped</th> <th>Asmnt Level</th> <th>Assessed</th> <th>Levy Rate</th> <th>92.430</th> <th>Current Tax</th> </tr> </thead> <tbody> <tr> <td>Remove Cap</td> <td>2026</td> <td>Land Value 51,427</td> <td>51,427</td> <td>11%</td> <td>5,657</td> <td>Assessed</td> <td>21,633</td> <td>1,999.54</td> </tr> <tr> <td>Year Frozen</td> <td>2015</td> <td>Improvements 145,234</td> <td>145,234</td> <td> </td> <td>15,976</td> <td>Penalty</td> <td>0</td> <td> </td> </tr> <tr> <td>Uncapped Value</td> <td>0</td> <td>Mobile Home 0</td> <td>0</td> <td> </td> <td>0</td> <td>Exemption</td> <td>0</td> <td>0.00</td> </tr> <tr> <td>TIF Project ID</td> <td>0</td> <td>Total Value 196,661</td> <td>196,661</td> <td> </td> <td>21,633</td> <td>Total Taxable</td> <td>21,633</td> <td>2,000.00</td> </tr> </tbody> </table>										Source	REAL	Fair Cash	Capped	Asmnt Level	Assessed	Levy Rate	92.430	Current Tax	Remove Cap	2026	Land Value 51,427	51,427	11%	5,657	Assessed	21,633	1,999.54	Year Frozen	2015	Improvements 145,234	145,234		15,976	Penalty	0		Uncapped Value	0	Mobile Home 0	0		0	Exemption	0	0.00	TIF Project ID	0	Total Value 196,661	196,661		21,633	Total Taxable	21,633	2,000.00																																																																			
Source	REAL	Fair Cash	Capped	Asmnt Level	Assessed	Levy Rate	92.430	Current Tax																																																																																																																	
Remove Cap	2026	Land Value 51,427	51,427	11%	5,657	Assessed	21,633	1,999.54																																																																																																																	
Year Frozen	2015	Improvements 145,234	145,234		15,976	Penalty	0																																																																																																																		
Uncapped Value	0	Mobile Home 0	0		0	Exemption	0	0.00																																																																																																																	
TIF Project ID	0	Total Value 196,661	196,661		21,633	Total Taxable	21,633	2,000.00																																																																																																																	
Assessment History <table border="1"> <thead> <tr> <th>Tax Year</th> <th>Statement Number</th> <th>Billed Owner</th> <th>Tax Area</th> <th>Total Value</th> <th>Exemptions</th> <th>Taxable Value</th> <th>Billed Tax</th> </tr> </thead> <tbody> <tr> <td>2025</td> <td>2025-660006223</td> <td>NOTTINGHAM STATION LLC</td> <td>17</td> <td>191,826</td> <td>1000</td> <td>18,760</td> <td>1,734.00</td> </tr> <tr> <td>2024</td> <td>2024-660006223</td> <td>JOHNSON, ROBERTA L</td> <td>17</td> <td>201,406</td> <td>1000</td> <td>18,185</td> <td>1,681.00</td> </tr> <tr> <td>2023</td> <td>2023-660006223</td> <td>JOHNSON, ROBERTA L</td> <td>17</td> <td>187,198</td> <td>1000</td> <td>17,626</td> <td>1,615.00</td> </tr> <tr> <td>2022</td> <td>2022-660006223</td> <td>JOHNSON, ROBERTA L &</td> <td>17</td> <td>164,392</td> <td>1000</td> <td>17,083</td> <td>1,581.00</td> </tr> <tr> <td>2021</td> <td>2021-660006223</td> <td>JOHNSON, ROBERTA L &</td> <td>17</td> <td>165,060</td> <td>1000</td> <td>17,157</td> <td>1,515.00</td> </tr> <tr> <td>2020</td> <td>2020-660006223</td> <td>JOHNSON, ROBERTA L &</td> <td>17</td> <td>136,519</td> <td>1000</td> <td>13,450</td> <td>1,232.00</td> </tr> <tr> <td>2019</td> <td>2019-660006223</td> <td>ROBINSON, LOU ETTA</td> <td>17</td> <td>131,363</td> <td>1000</td> <td>13,450</td> <td>1,246.00</td> </tr> <tr> <td>2018</td> <td>2018-660006223</td> <td>ROBINSON, LOU ETTA</td> <td>17</td> <td>137,059</td> <td>1000</td> <td>13,513</td> <td>1,249.00</td> </tr> <tr> <td>2017</td> <td>2017-660006223</td> <td>ROBINSON, LOU ETTA</td> <td>17</td> <td>135,893</td> <td>1000</td> <td>13,512</td> <td>1,241.00</td> </tr> <tr> <td>2016</td> <td>2016-660006223</td> <td>ROBINSON, LOU ETTA</td> <td>17</td> <td>132,469</td> <td>1000</td> <td>13,512</td> <td>1,268.00</td> </tr> <tr> <td>2015</td> <td>2015-660006223</td> <td>ROBINSON, LOU ETTA</td> <td>17</td> <td>131,930</td> <td>1000</td> <td>13,512</td> <td>1,219.00</td> </tr> <tr> <td>2014</td> <td>2014-660006223</td> <td>ROBINSON, LOU ETTA</td> <td>17</td> <td>133,054</td> <td>1000</td> <td>13,277</td> <td>1,231.00</td> </tr> <tr> <td>2013</td> <td>2013-660006223</td> <td>ROBINSON, LOU ETTA</td> <td>17</td> <td>126,015</td> <td>1000</td> <td>12,862</td> <td>1,177.00</td> </tr> </tbody> </table>										Tax Year	Statement Number	Billed Owner	Tax Area	Total Value	Exemptions	Taxable Value	Billed Tax	2025	2025-660006223	NOTTINGHAM STATION LLC	17	191,826	1000	18,760	1,734.00	2024	2024-660006223	JOHNSON, ROBERTA L	17	201,406	1000	18,185	1,681.00	2023	2023-660006223	JOHNSON, ROBERTA L	17	187,198	1000	17,626	1,615.00	2022	2022-660006223	JOHNSON, ROBERTA L &	17	164,392	1000	17,083	1,581.00	2021	2021-660006223	JOHNSON, ROBERTA L &	17	165,060	1000	17,157	1,515.00	2020	2020-660006223	JOHNSON, ROBERTA L &	17	136,519	1000	13,450	1,232.00	2019	2019-660006223	ROBINSON, LOU ETTA	17	131,363	1000	13,450	1,246.00	2018	2018-660006223	ROBINSON, LOU ETTA	17	137,059	1000	13,513	1,249.00	2017	2017-660006223	ROBINSON, LOU ETTA	17	135,893	1000	13,512	1,241.00	2016	2016-660006223	ROBINSON, LOU ETTA	17	132,469	1000	13,512	1,268.00	2015	2015-660006223	ROBINSON, LOU ETTA	17	131,930	1000	13,512	1,219.00	2014	2014-660006223	ROBINSON, LOU ETTA	17	133,054	1000	13,277	1,231.00	2013	2013-660006223	ROBINSON, LOU ETTA	17	126,015	1000	12,862	1,177.00
Tax Year	Statement Number	Billed Owner	Tax Area	Total Value	Exemptions	Taxable Value	Billed Tax																																																																																																																		
2025	2025-660006223	NOTTINGHAM STATION LLC	17	191,826	1000	18,760	1,734.00																																																																																																																		
2024	2024-660006223	JOHNSON, ROBERTA L	17	201,406	1000	18,185	1,681.00																																																																																																																		
2023	2023-660006223	JOHNSON, ROBERTA L	17	187,198	1000	17,626	1,615.00																																																																																																																		
2022	2022-660006223	JOHNSON, ROBERTA L &	17	164,392	1000	17,083	1,581.00																																																																																																																		
2021	2021-660006223	JOHNSON, ROBERTA L &	17	165,060	1000	17,157	1,515.00																																																																																																																		
2020	2020-660006223	JOHNSON, ROBERTA L &	17	136,519	1000	13,450	1,232.00																																																																																																																		
2019	2019-660006223	ROBINSON, LOU ETTA	17	131,363	1000	13,450	1,246.00																																																																																																																		
2018	2018-660006223	ROBINSON, LOU ETTA	17	137,059	1000	13,513	1,249.00																																																																																																																		
2017	2017-660006223	ROBINSON, LOU ETTA	17	135,893	1000	13,512	1,241.00																																																																																																																		
2016	2016-660006223	ROBINSON, LOU ETTA	17	132,469	1000	13,512	1,268.00																																																																																																																		
2015	2015-660006223	ROBINSON, LOU ETTA	17	131,930	1000	13,512	1,219.00																																																																																																																		
2014	2014-660006223	ROBINSON, LOU ETTA	17	133,054	1000	13,277	1,231.00																																																																																																																		
2013	2013-660006223	ROBINSON, LOU ETTA	17	126,015	1000	12,862	1,177.00																																																																																																																		



Rogers

Assessment Property Record Card for Tax Year 2026

Data provided by LISA DELOZIER County Assessor

Date 04/17/2026
Time 03:09:01
Page 2

Lot Data	Square-Foot - NBHD 1180 #1	Primary Image
Lot Size Lot Count 1 Units Buildable 10500 Non-Ag Acres 0.2845 Topography Street Access Utilities Amenities 0 Method Square-Foot Base Lot Value 12,392.00 x 4.15 = 51,427 Factor Value Adjustments 1.0000 Lot Value 51,427		

Residential Data	
Type	1 Single Family Residence
Condition	3 - Average
Quality	3 - Average
Architecture	
Style	100% One Story
Exterior Wall	50% Veneer, Masonry 50% Frame, Siding, Wood
Base/Total Area	1,764 / 1,764
Style	100% One Story
HVAC	100% Warmed & Cooled Air
Roof Cover	1 Composition Shingle
Area on Slab	1,764
Fixture/RghIn	8 /
Bed/F/H Bath	3 / 2.0 /
Basement Area	
Garage Type	472 Attached Garage - Unfinished 2 Stalls
Remodel	
Year/Eff Age	1975 / 38

\\tsclient\T\LOGAN\LOGAN RESIDENTIAL VI\2023-5-9\IMG_0068. 5/9/2023

GRM Approach	
GRM Code	
Gross Rent	0.00
Indicated Value	

Multiple Regression			
MRA Code	1	Test	
Adusted R	0.8445		
Indicated Value	195,508	110.83	Per SqFt

Direct Comparables	
Selection Model	A Adam Test
Adjustment Model	1 2022 Residential
Comparables	8
Indicated Value	214,280 Per SqFt

Value Reconciliation			
Selected Approach	Cost Approach		
Improvements	143,871		
Lot Value	51,427		
Indicated Value	195,298	110.71	Per SqFt
Agland Value			
Site Improvements	1,363		
Total Value	196,661	111.49	Total Value Per SqFt

Cost Approach				Manual : 01/2025			
Base Cost	106.15	Total Misc Impr	+ 20,868				
Roofing Adj	+ 4.82	Garage Cost	+ 15,241				
Subfloor Adj	+ -2.31	Total RCN	= 261,583				
Heat/Cool Adj	+ 12.64	Depreciation (45%)	- 117,712				
Plumbing Adj	+ 6.52	Lump Sums	+ 0				
Basement Adj	+ 0.00	RCNLD	= 143,871				
Adj Base Cost	= 127.82	Lot Value	+ 51,427				
Total Area	x 1,764	Indicated Value	= 195,298				
Adjusted Cost	= 225,474	Value Per SqFt	110.71				

Miscellaneous Improvements							
Code	Description	Sketch ID	Size	Year	Units	Unit Cost	Depr Value
FPR1	FIREPLACE - RESIDENTIAL 1 STORY	0		1	1	5,615.40	5,615
PRCH	SLAB PORCH - COVERED	15023		185	185	26.35	4,875
EPKS	ENCLOSED PORCH - KNEEWALL SCREEN	15024	26x14		364	28.51	10,378



Rogers

Assessment Property Record Card for Tax Year 2026

Data provided by LISA DELOZIER County Assessor

Date 04/17/2026
 Time 03:09:01
 Page 3

Sketch Image

660006223

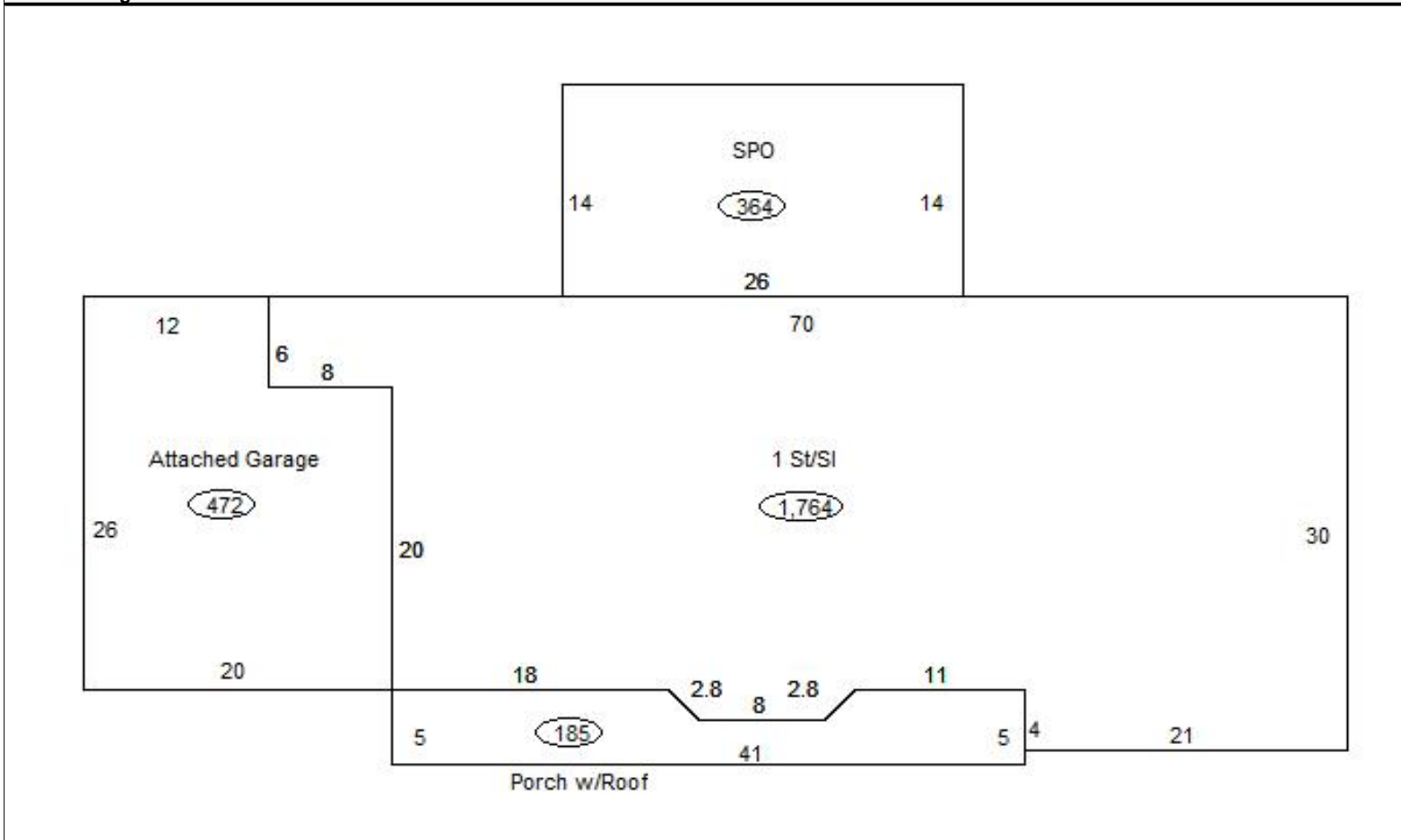

Sketch Vector Information

Sequence	Code	Type	Built Over	Scale	Section Label	Base Area	Multiplier	Total Area
1	R	1	Slab	13	1 St/Sl	1,764	1.000	1,764
2	G	1		13	Attached Garage	472	1.000	472
3	M	PRCH		13	SLBC	185	1.000	185
4	M	EPKS		13	Screen Porch	364	1.000	364
Total Building Area						1,764		1,764



Rogers

Assessment Property Record Card for Tax Year 2026

Data provided by LISA DELOZIER County Assessor

Date 04/17/2026
 Time 03:09:01
 Page 4

660006223

Outbuildings/Site Improvements

Building Image	Code	Description	Dimensions	Floor	Roofing	Total Units
	STF	STG FAIR	0x0x0			364
	Qual	2	Cond 3	Year	Eff Age	
Valuation Summary		Modifier Total		RCN	Depr (20% Phys/ % Func)	RCNLD
Base Cost (4.68 x 364)		1,704		1,704	341	1,363