



Rogers

Assessment Property Record Card for Tax Year 2026

Data provided by LISA DELOZIER County Assessor

Date 04/17/2026
Time 14:36:31
Page 1

Assessment Data					Primary Image																																																																																																																				
Account 660006264 Parcel ID 000000-00-0-10480-004-0011 Cadastral ID 07-21-16-05990 Property Type REAL - Real Property Property Class URP VI Area 1 Tax Area 17 - CLAREMORE OT Name ID 285531 HUGHES, CHARMAYNE L 2415 DRIFTWOOD DR CLAREMORE OK 74017-0000 Parcel Location Situs 02415 W DRIFTWOOD DR Subdivision WESTWOOD ESTATES III Lot/Block 0011 / 0004 Parcel Size 1 - Lots Sec/Twn/Rng 7 / 21 / 16 / 5 Neighborhood 1180 - R-V01-SW CLAREMORE School District S001 - CLAREMORE SCHOOLS																																																																																																																									
Legal Description Lot/Long: 36.31178045 -95.64064701																																																																																																																									
Legal Description LOT 11 BLOCK 4 WESTWOOD ESTATES III					Building Permits <table border="1"> <thead> <tr> <th>Number</th> <th>Description</th> <th>Opened</th> <th>Closed</th> <th>Amount</th> </tr> </thead> <tbody> <tr> <td colspan="5"> </td> </tr> </tbody> </table>					Number	Description	Opened	Closed	Amount																																																																																																											
Number	Description	Opened	Closed	Amount																																																																																																																					
Exemptions <table border="1"> <thead> <tr> <th>Code</th> <th>Type</th> <th>Active</th> <th>Maximum</th> <th>Exemption</th> </tr> </thead> <tbody> <tr> <td colspan="5"> </td> </tr> </tbody> </table>					Code	Type	Active	Maximum	Exemption						Sale History <table border="1"> <thead> <tr> <th>Bk/Pg</th> <th>Grantor</th> <th>Date</th> <th>Price</th> <th>Code</th> </tr> </thead> <tbody> <tr> <td>1872/876</td> <td>PETERS, JARED A &</td> <td>05/31/2007</td> <td>123,000</td> <td>YES</td> </tr> <tr> <td>1623/677</td> <td>CUTSINGER, ROBERT V</td> <td>09/29/2004</td> <td>97,000</td> <td>YES</td> </tr> <tr> <td>1594/573</td> <td>WASHINGTON MUTUAL BANK FA</td> <td>05/12/2004</td> <td>84,000</td> <td>YES</td> </tr> <tr> <td>1582/804</td> <td>NEES, ROGER D JR &</td> <td>04/21/2004</td> <td>0</td> <td>10</td> </tr> <tr> <td>1390/370</td> <td>CLAREMORE PROPERTY DEV LLC</td> <td>07/11/2002</td> <td>130,000</td> <td>YES</td> </tr> <tr> <td>1381/125</td> <td>SECRETARY OF HOUSING &-URBAN I</td> <td>05/02/2002</td> <td>0</td> <td>01</td> </tr> </tbody> </table>					Bk/Pg	Grantor	Date	Price	Code	1872/876	PETERS, JARED A &	05/31/2007	123,000	YES	1623/677	CUTSINGER, ROBERT V	09/29/2004	97,000	YES	1594/573	WASHINGTON MUTUAL BANK FA	05/12/2004	84,000	YES	1582/804	NEES, ROGER D JR &	04/21/2004	0	10	1390/370	CLAREMORE PROPERTY DEV LLC	07/11/2002	130,000	YES	1381/125	SECRETARY OF HOUSING &-URBAN I	05/02/2002	0	01																																																																			
Code	Type	Active	Maximum	Exemption																																																																																																																					
Bk/Pg	Grantor	Date	Price	Code																																																																																																																					
1872/876	PETERS, JARED A &	05/31/2007	123,000	YES																																																																																																																					
1623/677	CUTSINGER, ROBERT V	09/29/2004	97,000	YES																																																																																																																					
1594/573	WASHINGTON MUTUAL BANK FA	05/12/2004	84,000	YES																																																																																																																					
1582/804	NEES, ROGER D JR &	04/21/2004	0	10																																																																																																																					
1390/370	CLAREMORE PROPERTY DEV LLC	07/11/2002	130,000	YES																																																																																																																					
1381/125	SECRETARY OF HOUSING &-URBAN I	05/02/2002	0	01																																																																																																																					
Parcel Valuation <table border="1"> <thead> <tr> <th>Source</th> <th>REAL</th> <th>Fair Cash</th> <th>Capped</th> <th>Asmnt Level</th> <th>Assessed</th> <th>Levy Rate</th> <th>92.430</th> <th>Current Tax</th> </tr> </thead> <tbody> <tr> <td>Remove Cap</td> <td>2008</td> <td>Land Value 48,816</td> <td>32,970</td> <td>11%</td> <td>3,627</td> <td>Assessed</td> <td>19,317</td> <td>1,785.47</td> </tr> <tr> <td>Year Frozen</td> <td>0</td> <td>Improvements 161,990</td> <td>142,637</td> <td></td> <td>15,690</td> <td>Penalty</td> <td>0</td> <td></td> </tr> <tr> <td>Uncapped Value</td> <td>0</td> <td>Mobile Home 0</td> <td>0</td> <td></td> <td>0</td> <td>Exemption</td> <td>0</td> <td>0.00</td> </tr> <tr> <td>TIF Project ID</td> <td>0</td> <td>Total Value 210,806</td> <td>175,607</td> <td></td> <td>19,317</td> <td>Total Taxable</td> <td>19,317</td> <td>1,785.00</td> </tr> </tbody> </table>										Source	REAL	Fair Cash	Capped	Asmnt Level	Assessed	Levy Rate	92.430	Current Tax	Remove Cap	2008	Land Value 48,816	32,970	11%	3,627	Assessed	19,317	1,785.47	Year Frozen	0	Improvements 161,990	142,637		15,690	Penalty	0		Uncapped Value	0	Mobile Home 0	0		0	Exemption	0	0.00	TIF Project ID	0	Total Value 210,806	175,607		19,317	Total Taxable	19,317	1,785.00																																																																			
Source	REAL	Fair Cash	Capped	Asmnt Level	Assessed	Levy Rate	92.430	Current Tax																																																																																																																	
Remove Cap	2008	Land Value 48,816	32,970	11%	3,627	Assessed	19,317	1,785.47																																																																																																																	
Year Frozen	0	Improvements 161,990	142,637		15,690	Penalty	0																																																																																																																		
Uncapped Value	0	Mobile Home 0	0		0	Exemption	0	0.00																																																																																																																	
TIF Project ID	0	Total Value 210,806	175,607		19,317	Total Taxable	19,317	1,785.00																																																																																																																	
Assessment History <table border="1"> <thead> <tr> <th>Tax Year</th> <th>Statement Number</th> <th>Billed Owner</th> <th>Tax Area</th> <th>Total Value</th> <th>Exemptions</th> <th>Taxable Value</th> <th>Billed Tax</th> </tr> </thead> <tbody> <tr><td>2025</td><td>2025-660006264</td><td>HUGHES, CHARMAYNE L</td><td>17</td><td>205,376</td><td>0</td><td>18,397</td><td>1,700.00</td></tr> <tr><td>2024</td><td>2024-660006264</td><td>HUGHES, CHARMAYNE L</td><td>17</td><td>201,357</td><td>0</td><td>17,521</td><td>1,619.00</td></tr> <tr><td>2023</td><td>2023-660006264</td><td>HUGHES, CHARMAYNE L</td><td>17</td><td>172,274</td><td>0</td><td>16,687</td><td>1,529.00</td></tr> <tr><td>2022</td><td>2022-660006264</td><td>HUGHES, CHARMAYNE L</td><td>17</td><td>144,474</td><td>0</td><td>15,892</td><td>1,471.00</td></tr> <tr><td>2021</td><td>2021-660006264</td><td>HUGHES, CHARMAYNE L</td><td>17</td><td>149,007</td><td>0</td><td>16,391</td><td>1,447.00</td></tr> <tr><td>2020</td><td>2020-660006264</td><td>HUGHES, CHARMAYNE L</td><td>17</td><td>146,554</td><td>0</td><td>16,121</td><td>1,476.00</td></tr> <tr><td>2019</td><td>2019-660006264</td><td>HUGHES, CHARMAYNE L</td><td>17</td><td>142,712</td><td>0</td><td>15,698</td><td>1,454.00</td></tr> <tr><td>2018</td><td>2018-660006264</td><td>HUGHES, CHARMAYNE L</td><td>17</td><td>147,107</td><td>0</td><td>16,182</td><td>1,495.00</td></tr> <tr><td>2017</td><td>2017-660006264</td><td>HUGHES, CHARMAYNE L</td><td>17</td><td>145,868</td><td>0</td><td>16,045</td><td>1,474.00</td></tr> <tr><td>2016</td><td>2016-660006264</td><td>HUGHES, CHARMAYNE L</td><td>17</td><td>142,120</td><td>0</td><td>15,633</td><td>1,467.00</td></tr> <tr><td>2015</td><td>2015-660006264</td><td>HUGHES, CHARMAYNE L</td><td>17</td><td>141,496</td><td>0</td><td>15,565</td><td>1,404.00</td></tr> <tr><td>2014</td><td>2014-660006264</td><td>HUGHES, CHARMAYNE L</td><td>17</td><td>142,682</td><td>0</td><td>14,839</td><td>1,376.00</td></tr> <tr><td>2013</td><td>2013-660006264</td><td>HUGHES, CHARMAYNE L</td><td>17</td><td>135,264</td><td>0</td><td>14,133</td><td>1,293.00</td></tr> </tbody> </table>										Tax Year	Statement Number	Billed Owner	Tax Area	Total Value	Exemptions	Taxable Value	Billed Tax	2025	2025-660006264	HUGHES, CHARMAYNE L	17	205,376	0	18,397	1,700.00	2024	2024-660006264	HUGHES, CHARMAYNE L	17	201,357	0	17,521	1,619.00	2023	2023-660006264	HUGHES, CHARMAYNE L	17	172,274	0	16,687	1,529.00	2022	2022-660006264	HUGHES, CHARMAYNE L	17	144,474	0	15,892	1,471.00	2021	2021-660006264	HUGHES, CHARMAYNE L	17	149,007	0	16,391	1,447.00	2020	2020-660006264	HUGHES, CHARMAYNE L	17	146,554	0	16,121	1,476.00	2019	2019-660006264	HUGHES, CHARMAYNE L	17	142,712	0	15,698	1,454.00	2018	2018-660006264	HUGHES, CHARMAYNE L	17	147,107	0	16,182	1,495.00	2017	2017-660006264	HUGHES, CHARMAYNE L	17	145,868	0	16,045	1,474.00	2016	2016-660006264	HUGHES, CHARMAYNE L	17	142,120	0	15,633	1,467.00	2015	2015-660006264	HUGHES, CHARMAYNE L	17	141,496	0	15,565	1,404.00	2014	2014-660006264	HUGHES, CHARMAYNE L	17	142,682	0	14,839	1,376.00	2013	2013-660006264	HUGHES, CHARMAYNE L	17	135,264	0	14,133	1,293.00
Tax Year	Statement Number	Billed Owner	Tax Area	Total Value	Exemptions	Taxable Value	Billed Tax																																																																																																																		
2025	2025-660006264	HUGHES, CHARMAYNE L	17	205,376	0	18,397	1,700.00																																																																																																																		
2024	2024-660006264	HUGHES, CHARMAYNE L	17	201,357	0	17,521	1,619.00																																																																																																																		
2023	2023-660006264	HUGHES, CHARMAYNE L	17	172,274	0	16,687	1,529.00																																																																																																																		
2022	2022-660006264	HUGHES, CHARMAYNE L	17	144,474	0	15,892	1,471.00																																																																																																																		
2021	2021-660006264	HUGHES, CHARMAYNE L	17	149,007	0	16,391	1,447.00																																																																																																																		
2020	2020-660006264	HUGHES, CHARMAYNE L	17	146,554	0	16,121	1,476.00																																																																																																																		
2019	2019-660006264	HUGHES, CHARMAYNE L	17	142,712	0	15,698	1,454.00																																																																																																																		
2018	2018-660006264	HUGHES, CHARMAYNE L	17	147,107	0	16,182	1,495.00																																																																																																																		
2017	2017-660006264	HUGHES, CHARMAYNE L	17	145,868	0	16,045	1,474.00																																																																																																																		
2016	2016-660006264	HUGHES, CHARMAYNE L	17	142,120	0	15,633	1,467.00																																																																																																																		
2015	2015-660006264	HUGHES, CHARMAYNE L	17	141,496	0	15,565	1,404.00																																																																																																																		
2014	2014-660006264	HUGHES, CHARMAYNE L	17	142,682	0	14,839	1,376.00																																																																																																																		
2013	2013-660006264	HUGHES, CHARMAYNE L	17	135,264	0	14,133	1,293.00																																																																																																																		



Rogers

Assessment Property Record Card for Tax Year 2026

Data provided by LISA DELOZIER County Assessor

Date 04/17/2026
Time 14:36:31
Page 2

Lot Data		Square-Foot - NBHD 1180 #1	
Lot Size			
Lot Count	1		
Units Buildable	16558		
Non-Ag Acres	0.27		
Topography			
Street Access			
Utilities			
Amenities		0	
		0	
Method	Square-Foot		
Base Lot Value	11,763.00 x 4.15 = 48,816		
Factor Value			
Adjustments	1.0000		
Lot Value	48,816		



\\tsclient\T\LOGAN\LOGAN RESIDENTIAL VI\2023-5-8\IMG_0002. 5/8/2023

Residential Data	
Type	1 Single Family Residence
Condition	3 - Average
Quality	3 - Average
Architecture	R3 Res Nbhd 3
Style	100% One Story
Exterior Wall	50% Frame, Siding, Wood 50% Veneer, Stone
Base/Total Area	1,986 / 1,986
Style	100% One Story
HVAC	100% Warmed & Cooled Air
Roof Cover	1 Composition Shingle
Area on Slab	1,986
Fixture/RghIn	11 /
Bed/F/H Bath	3 / 2.0 /
Basement Area	
Garage Type	462 Attached Garage - Unfinished 2 Stalls
Remodel	
Year/Eff Age	1977 / 37

GRM Approach	
GRM Code	
Gross Rent	0.00
Indicated Value	

Multiple Regression			
MRA Code	1	Test	
Adusted R	0.8445		
Indicated Value	212,665	107.08	Per SqFt

Direct Comparables			
Selection Model	A	Adam Test	
Adjustment Model	1	2022 Residential	
Comparables	8		
Indicated Value	229,590		Per SqFt

Cost Approach				Manual : 01/2025			
Base Cost	106.30	Total Misc Impr	+	15,310			
Roofing Adj	+ 4.70	Garage Cost	+	15,015			
Subfloor Adj	+ -2.19	Total RCN	=	287,035			
Heat/Cool Adj	+ 12.64	Depreciation (44%)	-	126,295			
Plumbing Adj	+ 7.81	Lump Sums	+	0			
Basement Adj	+ 0.00	RCNLD	=	160,740			
Adj Base Cost	= 129.26	Lot Value	+	48,816			
Total Area	x 1,986	Indicated Value	=	209,556			
Adjusted Cost	= 256,710	Value Per SqFt		105.52			

Value Reconciliation			
Selected Approach	Cost Approach		
Improvements	160,740		
Lot Value	48,816		
Indicated Value	209,556	105.52	Per SqFt
Agland Value			
Site Improvements	1,250		
Total Value	210,806	106.15	Total Value Per SqFt

Miscellaneous Improvements								
Code	Description	Sketch ID	Size	Year	Units	Unit Cost	Depr	Value
FPR1	FIREPLACE - RESIDENTIAL 1 STORY	0		1	1	5,615.40		5,615
PRCH	SLAB PORCH - COVERED	15189	30x11		330	25.90		8,547
PATO	SLAB PORCH - OPEN	15190	10x10		100	11.48		1,148



Rogers

Assessment Property Record Card for Tax Year 2026

Data provided by LISA DELOZIER County Assessor

Date 04/17/2026
 Time 14:36:31
 Page 3

Sketch Image

660006264

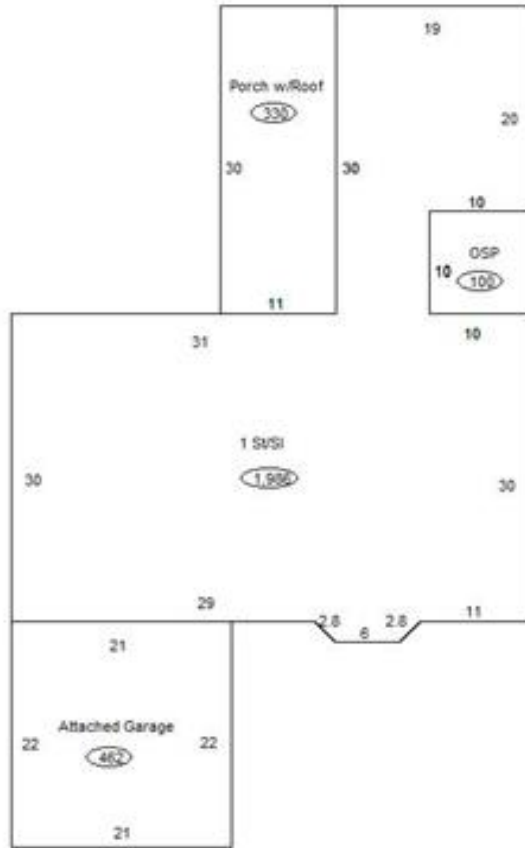

Sketch Vector Information

Sequence	Code	Type	Built Over	Scale	Section Label	Base Area	Multiplier	Total Area
1	R	1	Slab	13	1 St/SI	1,986	1.000	1,986
2	G	1		13	Attached Garage	462	1.000	462
3	M	PRCH		13	SLBC	330	1.000	330
4	M	PATO		13	Open Slab	100	1.000	100
Total Building Area						1,986		1,986



Rogers



Assessment Property Record Card for Tax Year 2026

Data provided by LISA DELOZIER County Assessor

Date 04/17/2026
Time 14:36:31
Page 4

660006264

Outbuildings/Site Improvements

Building Image	Code	Description	Dimensions	Floor	Roofing	Total Units
	SV	SWIM VINYL	0x0x0			1
	Qual	3	Cond 3	Year	Eff Age	
	Valuation Summary		Modifier Total	RCN	Depr (95% Phys/ % Func)	RCNLD
	Base Cost (25,000.00 x 1)		25,000	25,000	23,750	1,250
	STF	STG FAIR	0x0x0			
	Qual	2	Cond	Year	Eff Age	
	Valuation Summary		Modifier Total	RCN	Depr (0% Phys/ % Func)	RCNLD
	Base Cost (4.68 x)					