



Rogers

Assessment Property Record Card for Tax Year 2026

Data provided by LISA DELOZIER County Assessor

Date 04/17/2026
Time 05:03:47
Page 1

Assessment Data					Primary Image																																																																																																																				
Account 660006928 Parcel ID 21N15E-08-1-00000-000-0000 Cadastral ID 08-21-15-00600 Property Type REAL - Real Property Property Class RR VI Area 4 Tax Area 7 - OWASSO/LIMESTONE FIRE Name ID 336148 ALBERT, RANDY & JENNIFER TRUSTEES THE ALBERT FAMILY TRUST 5725 E OLD HWY 20 CLAREMORE OK 74019-0000 Parcel Location Situs 05725 E OLD HWY 20 Subdivision Lot/Block / Parcel Size 3.77 - Acres Sec/Twn/Rng 8 / 21 / 15 / 1 Neighborhood 6060 - UNPLATTED School District S021 - OWASSO SCHOOLS					<p>\\\\tsclient\C\Users\Randy Necessary\Pictures\101_0614\IMG_0054. 6/15/2022</p>																																																																																																																				
Legal Description Lat/Long: 36.32155982 -95.72746968 TRACT 1 A PT N2 NE LYING N & E ST HWY #20 BEG: 1257.87' W NE/C; S 5-37-00 W 494.63' TO A PT SD PT BEING 40' PERP DIST FROM C/L OF HWY #20; N 49-25- 45 W & PARALLEL TO SD HWY 20 398.89' TO A PT; ALG A CIRCLE TO THE LEFT WITH A RAD 1134. 90' & CENTRAL ANGLE OF 25-18- 49 501.41' TO A PT ON THE N/L OF SD SEC;																																																																																																																									
Exemptions <table border="1"> <thead> <tr> <th>Code</th> <th>Type</th> <th>Active</th> <th>Maximum</th> <th>Exemption</th> </tr> </thead> <tbody> <tr> <td>H</td> <td>Homestead</td> <td>Yes</td> <td>1,000</td> <td>1,000</td> </tr> </tbody> </table>					Code	Type	Active	Maximum	Exemption	H	Homestead	Yes	1,000	1,000	Building Permits <table border="1"> <thead> <tr> <th>Number</th> <th>Description</th> <th>Opened</th> <th>Closed</th> <th>Amount</th> </tr> </thead> <tbody> <tr> <td>R18-000130</td> <td>R19- DTCH ACC BLDG 36X48</td> <td>05/2018</td> <td>08/2018</td> <td>25,000</td> </tr> <tr> <td>R19</td> <td>R19- CMLPTE RMDL OF SFR</td> <td>02/2018</td> <td>08/2018</td> <td></td> </tr> </tbody> </table>					Number	Description	Opened	Closed	Amount	R18-000130	R19- DTCH ACC BLDG 36X48	05/2018	08/2018	25,000	R19	R19- CMLPTE RMDL OF SFR	02/2018	08/2018																																																																																								
Code	Type	Active	Maximum	Exemption																																																																																																																					
H	Homestead	Yes	1,000	1,000																																																																																																																					
Number	Description	Opened	Closed	Amount																																																																																																																					
R18-000130	R19- DTCH ACC BLDG 36X48	05/2018	08/2018	25,000																																																																																																																					
R19	R19- CMLPTE RMDL OF SFR	02/2018	08/2018																																																																																																																						
Parcel Valuation <table border="1"> <thead> <tr> <th>Source</th> <th>REAL</th> <th>Fair Cash</th> <th>Capped</th> <th>Asmnt Level</th> <th>Assessed</th> <th>Levy Rate</th> <th>108.538</th> <th>Current Tax</th> </tr> </thead> <tbody> <tr> <td>Remove Cap</td> <td>2022</td> <td>Land Value</td> <td>83,716</td> <td>83,716</td> <td>11%</td> <td>9,209</td> <td>Assessed</td> <td>50,484</td> <td>5,479.43</td> </tr> <tr> <td>Year Frozen</td> <td>0</td> <td>Improvements</td> <td>422,404</td> <td>375,229</td> <td></td> <td>41,275</td> <td>Penalty</td> <td>0</td> <td></td> </tr> <tr> <td>Uncapped Value</td> <td>0</td> <td>Mobile Home</td> <td>0</td> <td>0</td> <td></td> <td>0</td> <td>Exemption</td> <td>1,000</td> <td>-97.00</td> </tr> <tr> <td>TIF Project ID</td> <td>0</td> <td>Total Value</td> <td>506,120</td> <td>458,945</td> <td></td> <td>50,484</td> <td>Total Taxable</td> <td>49,484</td> <td>5,382.00</td> </tr> </tbody> </table>					Source	REAL	Fair Cash	Capped	Asmnt Level	Assessed	Levy Rate	108.538	Current Tax	Remove Cap	2022	Land Value	83,716	83,716	11%	9,209	Assessed	50,484	5,479.43	Year Frozen	0	Improvements	422,404	375,229		41,275	Penalty	0		Uncapped Value	0	Mobile Home	0	0		0	Exemption	1,000	-97.00	TIF Project ID	0	Total Value	506,120	458,945		50,484	Total Taxable	49,484	5,382.00	Sale History <table border="1"> <thead> <tr> <th>Bk/Pg</th> <th>Grantor</th> <th>Date</th> <th>Price</th> <th>Code</th> </tr> </thead> <tbody> <tr> <td>/</td> <td>HALL, ERIC & LACY</td> <td>10/08/2021</td> <td>420,000</td> <td>YES</td> </tr> <tr> <td>2711/440</td> <td>WAHLE HOMES LLC</td> <td>05/10/2018</td> <td>313,500</td> <td>17</td> </tr> <tr> <td>2658/927</td> <td>GIBSON, DWAYNE</td> <td>08/31/2017</td> <td>74,000</td> <td>17</td> </tr> <tr> <td>2406/588</td> <td>SHELTON, WILLA M</td> <td>06/09/2014</td> <td>0</td> <td>1</td> </tr> </tbody> </table>					Bk/Pg	Grantor	Date	Price	Code	/	HALL, ERIC & LACY	10/08/2021	420,000	YES	2711/440	WAHLE HOMES LLC	05/10/2018	313,500	17	2658/927	GIBSON, DWAYNE	08/31/2017	74,000	17	2406/588	SHELTON, WILLA M	06/09/2014	0	1																																						
Source	REAL	Fair Cash	Capped	Asmnt Level	Assessed	Levy Rate	108.538	Current Tax																																																																																																																	
Remove Cap	2022	Land Value	83,716	83,716	11%	9,209	Assessed	50,484	5,479.43																																																																																																																
Year Frozen	0	Improvements	422,404	375,229		41,275	Penalty	0																																																																																																																	
Uncapped Value	0	Mobile Home	0	0		0	Exemption	1,000	-97.00																																																																																																																
TIF Project ID	0	Total Value	506,120	458,945		50,484	Total Taxable	49,484	5,382.00																																																																																																																
Bk/Pg	Grantor	Date	Price	Code																																																																																																																					
/	HALL, ERIC & LACY	10/08/2021	420,000	YES																																																																																																																					
2711/440	WAHLE HOMES LLC	05/10/2018	313,500	17																																																																																																																					
2658/927	GIBSON, DWAYNE	08/31/2017	74,000	17																																																																																																																					
2406/588	SHELTON, WILLA M	06/09/2014	0	1																																																																																																																					
Assessment History <table border="1"> <thead> <tr> <th>Tax Year</th> <th>Statement Number</th> <th>Billed Owner</th> <th>Tax Area</th> <th>Total Value</th> <th>Exemptions</th> <th>Taxable Value</th> <th>Billed Tax</th> </tr> </thead> <tbody> <tr><td>2025</td><td>2025-660006928</td><td>ALBERT, RANDY & JENNIFER</td><td>7</td><td>477,224</td><td>1000</td><td>48,013</td><td>5,221.00</td></tr> <tr><td>2024</td><td>2024-660006928</td><td>ALBERT, RANDY & JENNIFER</td><td>7</td><td>502,494</td><td>1000</td><td>46,587</td><td>5,156.00</td></tr> <tr><td>2023</td><td>2023-660006928</td><td>ALBERT, RANDY & JENNIFER</td><td>7</td><td>420,000</td><td>1000</td><td>45,200</td><td>4,896.00</td></tr> <tr><td>2022</td><td>2022-660006928</td><td>ALBERT, RANDY & JENNIFER</td><td>7</td><td>420,000</td><td>1000</td><td>45,200</td><td>5,088.00</td></tr> <tr><td>2021</td><td>2021-660006928</td><td>HALL, ERIC & LACY</td><td>7</td><td>347,695</td><td>1000</td><td>35,812</td><td>3,990.00</td></tr> <tr><td>2020</td><td>2020-660006928</td><td>HALL, ERIC & LACY</td><td>7</td><td>337,074</td><td>0</td><td>35,740</td><td>3,962.00</td></tr> <tr><td>2019</td><td>2019-660006928</td><td>HALL, ERIC & LACY</td><td>7</td><td>309,435</td><td>0</td><td>34,038</td><td>3,776.00</td></tr> <tr><td>2018</td><td>2018-660006928</td><td>HALL, ERIC & LACY</td><td>7</td><td>123,743</td><td>0</td><td>13,612</td><td>1,461.00</td></tr> <tr><td>2017</td><td>2017-660006928</td><td>WAHLE HOMES LLC</td><td>7</td><td>122,818</td><td>0</td><td>13,510</td><td>1,464.00</td></tr> <tr><td>2016</td><td>2016-660006928</td><td>GIBSON, DWAYNE</td><td>7</td><td>121,093</td><td>0</td><td>13,321</td><td>1,444.00</td></tr> <tr><td>2015</td><td>2015-660006928</td><td>GIBSON, DWAYNE</td><td>7</td><td>123,987</td><td>0</td><td>13,639</td><td>1,488.00</td></tr> <tr><td>2014</td><td>2014-660006928</td><td>GIBSON, DWAYNE</td><td>7</td><td>127,004</td><td>0</td><td>5,561</td><td>611.00</td></tr> <tr><td>2013</td><td>2013-660006928</td><td>SHELTON, WILLA M</td><td>7</td><td>124,322</td><td>0</td><td>5,296</td><td>572.00</td></tr> </tbody> </table>										Tax Year	Statement Number	Billed Owner	Tax Area	Total Value	Exemptions	Taxable Value	Billed Tax	2025	2025-660006928	ALBERT, RANDY & JENNIFER	7	477,224	1000	48,013	5,221.00	2024	2024-660006928	ALBERT, RANDY & JENNIFER	7	502,494	1000	46,587	5,156.00	2023	2023-660006928	ALBERT, RANDY & JENNIFER	7	420,000	1000	45,200	4,896.00	2022	2022-660006928	ALBERT, RANDY & JENNIFER	7	420,000	1000	45,200	5,088.00	2021	2021-660006928	HALL, ERIC & LACY	7	347,695	1000	35,812	3,990.00	2020	2020-660006928	HALL, ERIC & LACY	7	337,074	0	35,740	3,962.00	2019	2019-660006928	HALL, ERIC & LACY	7	309,435	0	34,038	3,776.00	2018	2018-660006928	HALL, ERIC & LACY	7	123,743	0	13,612	1,461.00	2017	2017-660006928	WAHLE HOMES LLC	7	122,818	0	13,510	1,464.00	2016	2016-660006928	GIBSON, DWAYNE	7	121,093	0	13,321	1,444.00	2015	2015-660006928	GIBSON, DWAYNE	7	123,987	0	13,639	1,488.00	2014	2014-660006928	GIBSON, DWAYNE	7	127,004	0	5,561	611.00	2013	2013-660006928	SHELTON, WILLA M	7	124,322	0	5,296	572.00
Tax Year	Statement Number	Billed Owner	Tax Area	Total Value	Exemptions	Taxable Value	Billed Tax																																																																																																																		
2025	2025-660006928	ALBERT, RANDY & JENNIFER	7	477,224	1000	48,013	5,221.00																																																																																																																		
2024	2024-660006928	ALBERT, RANDY & JENNIFER	7	502,494	1000	46,587	5,156.00																																																																																																																		
2023	2023-660006928	ALBERT, RANDY & JENNIFER	7	420,000	1000	45,200	4,896.00																																																																																																																		
2022	2022-660006928	ALBERT, RANDY & JENNIFER	7	420,000	1000	45,200	5,088.00																																																																																																																		
2021	2021-660006928	HALL, ERIC & LACY	7	347,695	1000	35,812	3,990.00																																																																																																																		
2020	2020-660006928	HALL, ERIC & LACY	7	337,074	0	35,740	3,962.00																																																																																																																		
2019	2019-660006928	HALL, ERIC & LACY	7	309,435	0	34,038	3,776.00																																																																																																																		
2018	2018-660006928	HALL, ERIC & LACY	7	123,743	0	13,612	1,461.00																																																																																																																		
2017	2017-660006928	WAHLE HOMES LLC	7	122,818	0	13,510	1,464.00																																																																																																																		
2016	2016-660006928	GIBSON, DWAYNE	7	121,093	0	13,321	1,444.00																																																																																																																		
2015	2015-660006928	GIBSON, DWAYNE	7	123,987	0	13,639	1,488.00																																																																																																																		
2014	2014-660006928	GIBSON, DWAYNE	7	127,004	0	5,561	611.00																																																																																																																		
2013	2013-660006928	SHELTON, WILLA M	7	124,322	0	5,296	572.00																																																																																																																		



Rogers

Assessment Property Record Card for Tax Year 2026

Data provided by LISA DELOZIER County Assessor

Date 04/17/2026
 Time 05:03:47
 Page 2

Lot Data		Square-Foot - NBHD 6060 #1	
Lot Size			
Lot Count			
Units Buildable	3.77		
Non-Ag Acres	3.6874		
Topography			
Street Access			
Utilities			
Amenities	LAND QUALITY	0	0
Method	Square-Foot		
Base Lot Value	160,624.00 x .52 = 83,716		
Factor Value			
Adjustments	1.0000		
Lot Value	83,716		



\\tsclient\C\Users\Randy Necessary\Pictures\101_0614\IMG_0054. 6/15/2022

Residential Data	
Type	1 Single Family Residence
Condition	6 - Excellent
Quality	5 - Very Good
Architecture	
Style	100% 1 1/2 Story Finished
Exterior Wall	50% Veneer, Stone 50% Frame, Siding, Wood
Base/Total Area	1,452 / 2,690
Style	100% 1 1/2 Story Finished
HVAC	100% Warmed & Cooled Air
Roof Cover	1 Composition Shingle
Area on Slab	0
Fixture/RghIn	14 /
Bed/F/H Bath	5 / 3.0 / 1.0
Basement Area	
Garage Type	
Remodel	RMA -
Year/Eff Age	1950 / 13

GRM Approach	
GRM Code	
Gross Rent	0.00
Indicated Value	

Multiple Regression			
MRA Code	1	Test	
Adusted R	0.8445		
Indicated Value	386,518	143.69	Per SqFt

Direct Comparables	
Selection Model	1 Res
Adjustment Model	A2 AO Test
Comparables	
Indicated Value	

Cost Approach				Manual : 01/2025			
Base Cost	108.64	Total Misc Impr	+ 28,772				
Roofing Adj	+ 3.81	Garage Cost	+ 409,407				
Subfloor Adj	+ 0.00	Total RCN	= 53,223				
Heat/Cool Adj	+ 18.45	Depreciation (13%)	- 11,548				
Plumbing Adj	+ 10.60	Lump Sums	+ 367,732				
Basement Adj	+ 0.00	RCNLD	= 83,716				
Adj Base Cost	= 141.50	Lot Value	+ 451,448				
Total Area	x 2,690	Indicated Value	= 380,635				
Adjusted Cost	= 380,635	Value Per SqFt	167.82				

Value Reconciliation			
Selected Approach	Cost Approach		
Improvements	367,732		
Lot Value	83,716		
Indicated Value	451,448	167.82	Per SqFt
Agland Value			
Site Improvements	54,672		
Total Value	506,120	188.15	Total Value Per SqFt

Miscellaneous Improvements								
Code	Description	Sketch ID	Size	Year	Units	Unit Cost	Depr	Value
FPR1	FIREPLACE - RESIDENTIAL 1 STORY	0		1	1	8,198.48		8,198
EPSW	ENCLOSED PORCH - SOLID WALL	16739	18x12		216	95.25		20,574
WODC	Wood Deck - Covered	153880	46x5		230	50.21		11,548



Rogers
Assessment Property Record Card for Tax Year 2026

Data provided by LISA DELOZIER County Assessor

Date 04/17/2026
 Time 05:03:47
 Page 3

Sketch Image

660006928

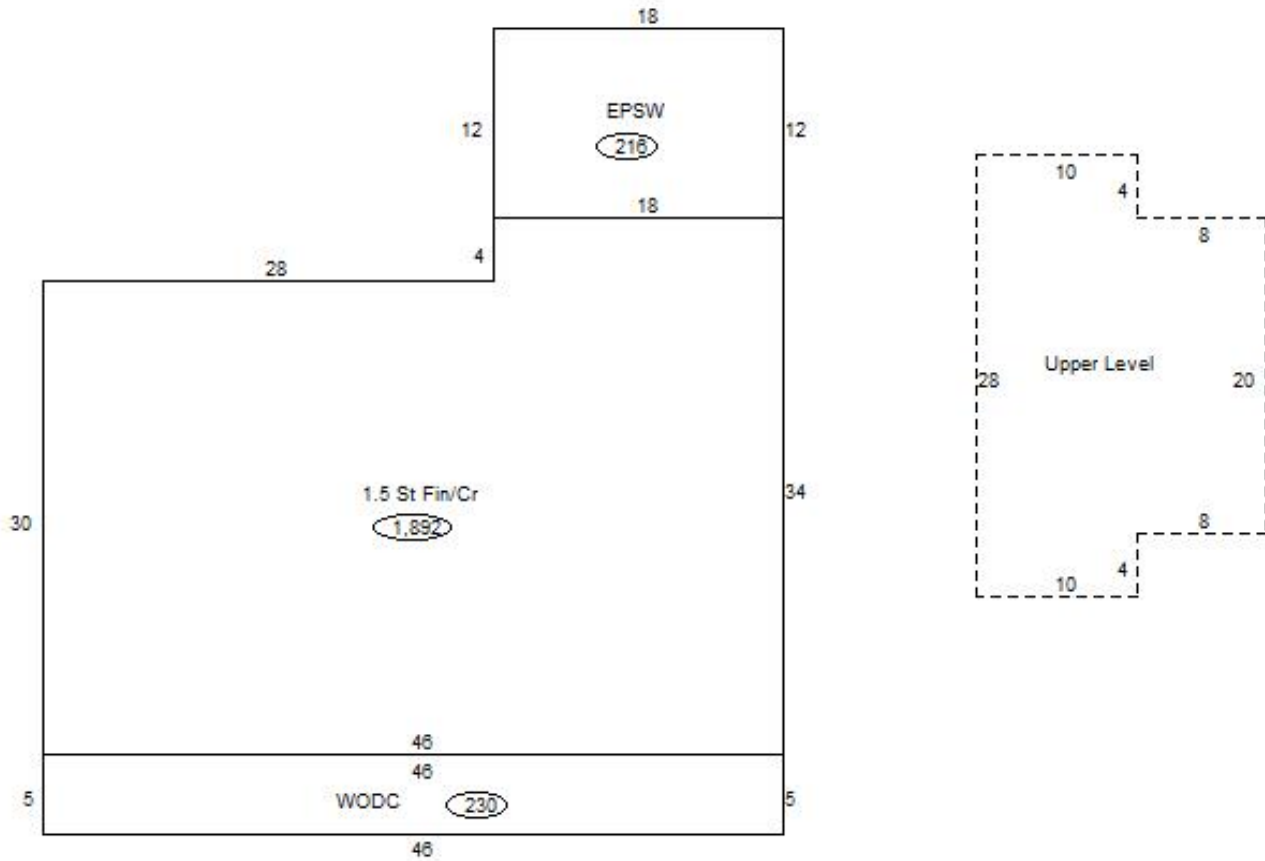

Sketch Vector Information

Sequence	Code	Type	Built Over	Scale	Section Label	Base Area	Multiplier	Total Area
1	R	5	Crawl	13	1.5 St Fin/Cr	1,452	1.303	1,892
2	U	^UL		13	Upper Level	440	1.000	440
3	M	EPSW		13	EPSW	216	1.000	216
4	M	WODC		13	WODC	230	1.000	230
Total Building Area						1,452		1,892



Rogers

Assessment Property Record Card for Tax Year 2026

Data provided by LISA DELOZIER County Assessor

Date 04/17/2026
Time 05:03:47
Page 4

660006928

Outbuildings/Site Improvements

Building Image	Code	Description	Dimensions	Floor	Roofing	Total Units
	UTIL	SHOP BUILDING	36x48x0			1,728
	Qual	Cond	Year	2018	Eff Age	
	Valuation Summary		Modifier Total	RCN	Depr (0% Phys/ % Func)	RCNLD
	Base Cost (30.56 x 1,728)		52,808		52,808	52,808
	STF	STG FAIR	0x0x0			420
	Qual	2	Cond	3	Year	Eff Age
	Valuation Summary		Modifier Total	RCN	Depr (100% Phys/ % Func)	RCNLD
	Base Cost (4.68 x 420)		1,966		1,966	1,966
	STF	STG FAIR	0x0x0			420
	Qual	2	Cond	3	Year	Eff Age
	Valuation Summary		Modifier Total	RCN	Depr (100% Phys/ % Func)	RCNLD
	Base Cost (4.68 x 420)		1,966		1,966	1,966
	DTGF	DETACHED GARAGE FAIR	0x0x0			660
	Qual	2	Cond	3	Year	Eff Age
	Valuation Summary		Modifier Total	RCN	Depr (85% Phys/ % Func)	RCNLD
	Base Cost (16.00 x 660)		10,560		10,560	1,584
	LT	LEAN-TO	20x32x0			640
	Qual	2	Cond	3	Year	Eff Age
	Valuation Summary		Modifier Total	RCN	Depr (85% Phys/ % Func)	RCNLD
	Base Cost (2.92 x 640)		1,869		1,869	280