



Rogers

Assessment Property Record Card for Tax Year 2026

Data provided by LISA DELOZIER County Assessor

Date 04/17/2026
Time 17:18:22
Page 1

Assessment Data					Primary Image																																																																																																																				
Account 660006948 Parcel ID 21N15E-08-4-00000-000-0000 Cadastral ID 08-21-15-02420 Property Type REAL - Real Property Property Class RR VI Area 4 Tax Area 7 - OWASSO/LIMESTONE FIRE Name ID 312346 RIGHT, DAVID WAYNE & LINDA LOUIS 20755 S 4090 RD CLAREMORE OK 74019-0000 Parcel Location Situs 20755 S 4090 RD Subdivision Lot/Block / Parcel Size 3 - Acres Sec/Twn/Rng 8 / 21 / 15 / 4 Neighborhood 6060 - UNPLATTED School District S021 - OWASSO SCHOOLS																																																																																																																									
Legal Description Lat/Long: 36.31087976 -95.72311661 TR DESC 2025-007355 AS BEG SE/C E2 E2 SE; N00.0459W 1084.49' TO POB; N00.0459W 292'; S89.5501W 431'; S13.2708W 66.60'; CURVE LEFT RAD 425' DIST 169.71'; S09.2537E 59.58'; SN89.5501E 443.18' TO POB.																																																																																																																									
Exemptions <table border="1"> <thead> <tr> <th>Code</th> <th>Type</th> <th>Active</th> <th>Maximum</th> <th>Exemption</th> </tr> </thead> <tbody> <tr> <td>H</td> <td>Homestead</td> <td>Yes</td> <td>1,000</td> <td>1,000</td> </tr> </tbody> </table>					Code	Type	Active	Maximum	Exemption	H	Homestead	Yes	1,000	1,000	Building Permits <table border="1"> <thead> <tr> <th>Number</th> <th>Description</th> <th>Opened</th> <th>Closed</th> <th>Amount</th> </tr> </thead> <tbody> <tr> <td>10010</td> <td>R7 FOR ADD-ON TO SFR</td> <td>03/2006</td> <td>02/2007</td> <td>12,000</td> </tr> </tbody> </table>					Number	Description	Opened	Closed	Amount	10010	R7 FOR ADD-ON TO SFR	03/2006	02/2007	12,000																																																																																												
Code	Type	Active	Maximum	Exemption																																																																																																																					
H	Homestead	Yes	1,000	1,000																																																																																																																					
Number	Description	Opened	Closed	Amount																																																																																																																					
10010	R7 FOR ADD-ON TO SFR	03/2006	02/2007	12,000																																																																																																																					
Parcel Valuation <table border="1"> <thead> <tr> <th>Source</th> <th>REAL</th> <th>Fair Cash</th> <th>Capped</th> <th>Asmnt Level</th> <th>Assessed</th> <th>Levy Rate</th> <th>108.538</th> <th>Current Tax</th> </tr> </thead> <tbody> <tr> <td>Remove Cap</td> <td>2015</td> <td>Land Value</td> <td>80,218</td> <td>60,484</td> <td>11%</td> <td>6,653</td> <td>Assessed</td> <td>32,760 3,555.70</td> </tr> <tr> <td>Year Frozen</td> <td>0</td> <td>Improvements</td> <td>267,095</td> <td>237,332</td> <td></td> <td>26,107</td> <td>Penalty</td> <td>0</td> </tr> <tr> <td>Uncapped Value</td> <td>0</td> <td>Mobile Home</td> <td>0</td> <td>0</td> <td></td> <td>0</td> <td>Exemption</td> <td>1,000 -98.00</td> </tr> <tr> <td>TIF Project ID</td> <td>0</td> <td>Total Value</td> <td>347,313</td> <td>297,816</td> <td></td> <td>32,760</td> <td>Total Taxable</td> <td>31,760 3,458.00</td> </tr> </tbody> </table>					Source	REAL	Fair Cash	Capped	Asmnt Level	Assessed	Levy Rate	108.538	Current Tax	Remove Cap	2015	Land Value	80,218	60,484	11%	6,653	Assessed	32,760 3,555.70	Year Frozen	0	Improvements	267,095	237,332		26,107	Penalty	0	Uncapped Value	0	Mobile Home	0	0		0	Exemption	1,000 -98.00	TIF Project ID	0	Total Value	347,313	297,816		32,760	Total Taxable	31,760 3,458.00	Sale History <table border="1"> <thead> <tr> <th>Bk/Pg</th> <th>Grantor</th> <th>Date</th> <th>Price</th> <th>Code</th> </tr> </thead> <tbody> <tr> <td>2402/801</td> <td>SMITH-BRINSON, TINA LEE</td> <td>05/21/2014</td> <td>220,000</td> <td>YES</td> </tr> <tr> <td>1243/870</td> <td>KRULL, WILLIAM J &</td> <td>08/22/2000</td> <td>174,000</td> <td>Yes</td> </tr> <tr> <td>945/809</td> <td>EDDY, RICK D &</td> <td>02/04/1994</td> <td>160,000</td> <td>Yes</td> </tr> <tr> <td>857/89</td> <td></td> <td></td> <td>1,300,000</td> <td>No</td> </tr> </tbody> </table>					Bk/Pg	Grantor	Date	Price	Code	2402/801	SMITH-BRINSON, TINA LEE	05/21/2014	220,000	YES	1243/870	KRULL, WILLIAM J &	08/22/2000	174,000	Yes	945/809	EDDY, RICK D &	02/04/1994	160,000	Yes	857/89			1,300,000	No																																										
Source	REAL	Fair Cash	Capped	Asmnt Level	Assessed	Levy Rate	108.538	Current Tax																																																																																																																	
Remove Cap	2015	Land Value	80,218	60,484	11%	6,653	Assessed	32,760 3,555.70																																																																																																																	
Year Frozen	0	Improvements	267,095	237,332		26,107	Penalty	0																																																																																																																	
Uncapped Value	0	Mobile Home	0	0		0	Exemption	1,000 -98.00																																																																																																																	
TIF Project ID	0	Total Value	347,313	297,816		32,760	Total Taxable	31,760 3,458.00																																																																																																																	
Bk/Pg	Grantor	Date	Price	Code																																																																																																																					
2402/801	SMITH-BRINSON, TINA LEE	05/21/2014	220,000	YES																																																																																																																					
1243/870	KRULL, WILLIAM J &	08/22/2000	174,000	Yes																																																																																																																					
945/809	EDDY, RICK D &	02/04/1994	160,000	Yes																																																																																																																					
857/89			1,300,000	No																																																																																																																					
Assessment History <table border="1"> <thead> <tr> <th>Tax Year</th> <th>Statement Number</th> <th>Billed Owner</th> <th>Tax Area</th> <th>Total Value</th> <th>Exemptions</th> <th>Taxable Value</th> <th>Billed Tax</th> </tr> </thead> <tbody> <tr><td>2025</td><td>2025-660006948</td><td>RIGHT, DAVID WAYNE &</td><td>7</td><td>318,392</td><td>1000</td><td>30,805</td><td>3,354.00</td></tr> <tr><td>2024</td><td>2024-660006948</td><td>SMITH, DAVID W</td><td>7</td><td>330,648</td><td>1000</td><td>29,879</td><td>3,311.00</td></tr> <tr><td>2023</td><td>2023-660006948</td><td>SMITH, DAVID W</td><td>7</td><td>290,845</td><td>1000</td><td>28,980</td><td>3,144.00</td></tr> <tr><td>2022</td><td>2022-660006948</td><td>SMITH, DAVID W</td><td>7</td><td>282,154</td><td>1000</td><td>28,107</td><td>3,170.00</td></tr> <tr><td>2021</td><td>2021-660006948</td><td>SMITH, DAVID W</td><td>7</td><td>268,200</td><td>1000</td><td>27,259</td><td>3,041.00</td></tr> <tr><td>2020</td><td>2020-660006948</td><td>SMITH, DAVID W</td><td>7</td><td>261,081</td><td>1000</td><td>26,436</td><td>2,946.00</td></tr> <tr><td>2019</td><td>2019-660006948</td><td>SMITH, DAVID W</td><td>7</td><td>242,154</td><td>1000</td><td>25,637</td><td>2,858.00</td></tr> <tr><td>2018</td><td>2018-660006948</td><td>SMITH, DAVID W</td><td>7</td><td>239,388</td><td>0</td><td>26,333</td><td>2,827.00</td></tr> <tr><td>2017</td><td>2017-660006948</td><td>SMITH, DAVID W</td><td>7</td><td>237,385</td><td>0</td><td>26,113</td><td>2,829.00</td></tr> <tr><td>2016</td><td>2016-660006948</td><td>SMITH, DAVID W</td><td>7</td><td>231,368</td><td>0</td><td>25,451</td><td>2,759.00</td></tr> <tr><td>2015</td><td>2015-660006948</td><td>SMITH, DAVID W</td><td>7</td><td>225,272</td><td>0</td><td>24,780</td><td>2,704.00</td></tr> <tr><td>2014</td><td>2014-660006948</td><td>SMITH, DAVID W</td><td>7</td><td>245,440</td><td>1000</td><td>24,806</td><td>2,743.00</td></tr> <tr><td>2013</td><td>2013-660006948</td><td>SMITH-BRINSON, TINA LEE</td><td>7</td><td>232,427</td><td>1000</td><td>24,054</td><td>2,611.00</td></tr> </tbody> </table>										Tax Year	Statement Number	Billed Owner	Tax Area	Total Value	Exemptions	Taxable Value	Billed Tax	2025	2025-660006948	RIGHT, DAVID WAYNE &	7	318,392	1000	30,805	3,354.00	2024	2024-660006948	SMITH, DAVID W	7	330,648	1000	29,879	3,311.00	2023	2023-660006948	SMITH, DAVID W	7	290,845	1000	28,980	3,144.00	2022	2022-660006948	SMITH, DAVID W	7	282,154	1000	28,107	3,170.00	2021	2021-660006948	SMITH, DAVID W	7	268,200	1000	27,259	3,041.00	2020	2020-660006948	SMITH, DAVID W	7	261,081	1000	26,436	2,946.00	2019	2019-660006948	SMITH, DAVID W	7	242,154	1000	25,637	2,858.00	2018	2018-660006948	SMITH, DAVID W	7	239,388	0	26,333	2,827.00	2017	2017-660006948	SMITH, DAVID W	7	237,385	0	26,113	2,829.00	2016	2016-660006948	SMITH, DAVID W	7	231,368	0	25,451	2,759.00	2015	2015-660006948	SMITH, DAVID W	7	225,272	0	24,780	2,704.00	2014	2014-660006948	SMITH, DAVID W	7	245,440	1000	24,806	2,743.00	2013	2013-660006948	SMITH-BRINSON, TINA LEE	7	232,427	1000	24,054	2,611.00
Tax Year	Statement Number	Billed Owner	Tax Area	Total Value	Exemptions	Taxable Value	Billed Tax																																																																																																																		
2025	2025-660006948	RIGHT, DAVID WAYNE &	7	318,392	1000	30,805	3,354.00																																																																																																																		
2024	2024-660006948	SMITH, DAVID W	7	330,648	1000	29,879	3,311.00																																																																																																																		
2023	2023-660006948	SMITH, DAVID W	7	290,845	1000	28,980	3,144.00																																																																																																																		
2022	2022-660006948	SMITH, DAVID W	7	282,154	1000	28,107	3,170.00																																																																																																																		
2021	2021-660006948	SMITH, DAVID W	7	268,200	1000	27,259	3,041.00																																																																																																																		
2020	2020-660006948	SMITH, DAVID W	7	261,081	1000	26,436	2,946.00																																																																																																																		
2019	2019-660006948	SMITH, DAVID W	7	242,154	1000	25,637	2,858.00																																																																																																																		
2018	2018-660006948	SMITH, DAVID W	7	239,388	0	26,333	2,827.00																																																																																																																		
2017	2017-660006948	SMITH, DAVID W	7	237,385	0	26,113	2,829.00																																																																																																																		
2016	2016-660006948	SMITH, DAVID W	7	231,368	0	25,451	2,759.00																																																																																																																		
2015	2015-660006948	SMITH, DAVID W	7	225,272	0	24,780	2,704.00																																																																																																																		
2014	2014-660006948	SMITH, DAVID W	7	245,440	1000	24,806	2,743.00																																																																																																																		
2013	2013-660006948	SMITH-BRINSON, TINA LEE	7	232,427	1000	24,054	2,611.00																																																																																																																		



Rogers

Assessment Property Record Card for Tax Year 2026

Data provided by LISA DELOZIER County Assessor

Date 04/17/2026
Time 17:18:22
Page 2

Lot Data		Square-Foot - NBHD 6060 #1	
Lot Size			
Lot Count			
Units Buildable	3		
Non-Ag Acres	3.3662		
Topography			
Street Access			
Utilities			
Amenities	LAND QUALITY	0	
		0	
Method	Square-Foot		
Base Lot Value	146,633.00 x .55 = 80,218		
Factor Value			
Adjustments	1.0000		
Lot Value	80,218		



\\tsclient\C\Users\Randy Necessary\Pictures\101_0614\IMG_0029. 6/14/2022

Residential Data	
Type	1 Single Family Residence
Condition	3 - Average
Quality	3.5 - Average
Architecture	
Style	100% 1 1/2 Story Finished
Exterior Wall	50% Frame, Siding, Vinyl 50% Veneer, Masonry
Base/Total Area	2,050 / 2,670
Style	100% 1 1/2 Story Finished
HVAC	100% Warmed & Cooled Air
Roof Cover	1 Composition Shingle
Area on Slab	2,050
Fixture/RghIn	12 /
Bed/F/H Bath	4 / 2.5 /
Basement Area	
Garage Type	576 Attached Garage - Unfinished
Remodel	
Year/Eff Age	1987 / 29

GRM Approach

GRM Code	
Gross Rent	0.00
Indicated Value	

Multiple Regression

MRA Code	1 Test
Adjusted R	0.8445
Indicated Value	351,610 131.69 Per SqFt

Direct Comparables

Selection Model	1 Res
Adjustment Model	A2 AO Test
Comparables	
Indicated Value	

Value Reconciliation

Selected Approach	Cost Approach
Improvements	229,923
Lot Value	80,218
Indicated Value	310,141 116.16 Per SqFt
Agland Value	
Site Improvements	37,172
Total Value	347,313 130.08 Total Value Per SqFt

Cost Approach		Manual : 01/2025	
Base Cost	96.04	Total Misc Impr	+ 18,705
Roofing Adj	+ 4.11	Garage Cost	+ 22,205
Subfloor Adj	+ -2.61	Total RCN	= 359,254
Heat/Cool Adj	+ 14.47	Depreciation (36%)	- 129,331
Plumbing Adj	+ 7.22	Lump Sums	+ 0
Basement Adj	+ 0.00	RCNLD	= 229,923
Adj Base Cost	= 119.23	Lot Value	+ 80,218
Total Area	x 2,670	Indicated Value	= 310,141
Adjusted Cost	= 318,344	Value Per SqFt	116.16

Miscellaneous Improvements

Code	Description	Sketch ID	Size	Year	Units	Unit Cost	Depr	Value
PRCH	SLAB PORCH - COVERED	16798	14x8		112	29.16		3,266
PRCH	SLAB PORCH - COVERED	16800	317		317	28.42		9,009
FPR1	Fireplace - Residential 1 Story			1	1	6,429.63		6,430



Rogers

Assessment Property Record Card for Tax Year 2026

Data provided by LISA DELOZIER County Assessor

Date 04/17/2026
 Time 17:18:22
 Page 3

Sketch Image

660006948

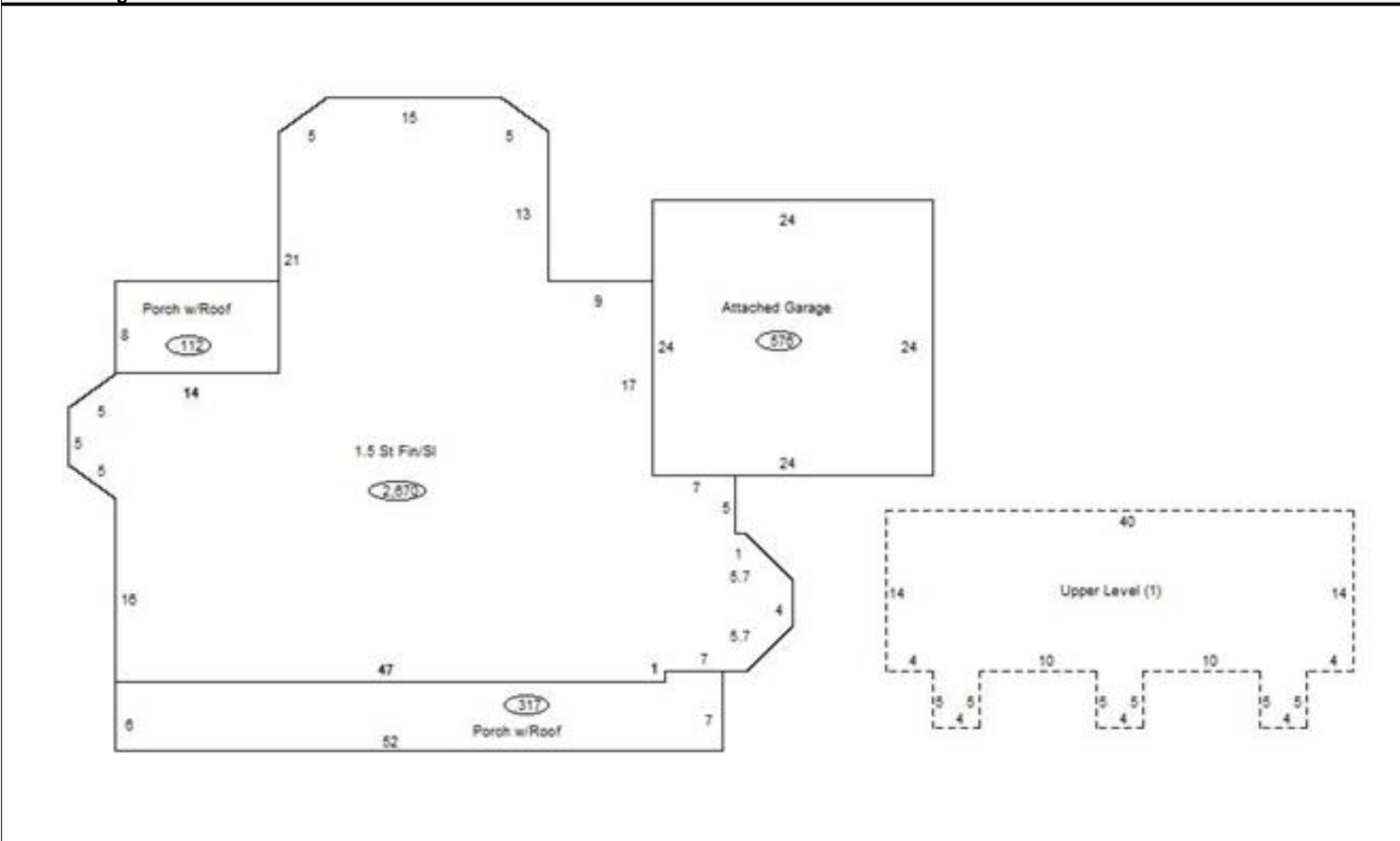

Sketch Vector Information

Sequence	Code	Type	Built Over	Scale	Section Label	Base Area	Multiplier	Total Area
1	R	5	Slab	13	1.5 St Fin/Sl	2,050	1.302	2,670
2	M	PRCH		13	SLBC	112	1.000	112
3	G	1		13	Attached Garage	576	1.000	576
4	M	PRCH		13	SLBC	317	1.000	317
5	U	^UL		13	Upper Level (1)	620	1.000	620
Total Building Area						2,050		2,670



Rogers



Assessment Property Record Card for Tax Year 2026

Data provided by LISA DELOZIER County Assessor

Date 04/17/2026
 Time 17:18:22
 Page 4

660006948

Outbuildings/Site Improvements

Building Image	Code	Description	Dimensions	Floor	Roofing	Total Units
	SG	SWIM-GUNITE	0x0x0			1
	Qual	Cond	Year	12018	Eff Age	
	Valuation Summary		Modifier Total	RCN	Depr (0% Phys/ % Func)	RCNLD
	Base Cost (30,000.00 x 1)	30,000		30,000		30,000
	BARN	BARN	0x0x0			1,080
	Qual	3 Cond	3 Year		Eff Age	
	Valuation Summary		Modifier Total	RCN	Depr (45% Phys/ % Func)	RCNLD
	Base Cost (10.37 x 1,080)	11,200		11,200	5,040	6,160
	LF	LOAFING SHED	0x0x0			528
	Qual	3 Cond	3 Year		Eff Age	
	Valuation Summary		Modifier Total	RCN	Depr (55% Phys/ % Func)	RCNLD
	Base Cost (4.26 x 528)	2,249		2,249	1,237	1,012