



# Rogers

## Assessment Property Record Card for Tax Year 2026

Data provided by LISA DELOZIER County Assessor

Date 04/16/2026  
Time 21:07:03  
Page 1

Assessment Data					Primary Image																																																					
<b>Account</b> 660007293 <b>Parcel ID</b> 000000-00-0-10030-032-0020 <b>Cadastral ID</b> 08-21-16-03560 <b>Property Type</b> REAL - Real Property <b>Property Class</b> URP VI Area 1 <b>Tax Area</b> 17 - CLAREMORE OT <b>Name ID</b> 349483 HEARTLAND HOME BUYERS LLC  414 S MOORE AVE CLAREMORE OK 74017-0000  <b>Parcel Location</b> <b>Situs</b> 00414 S MOORE AVE <b>Subdivision</b> BAYLESS <b>Lot/Block</b> 0020 / 0032 <b>Parcel Size</b> 2.5 - Lots <b>Sec/Twn/Rng</b> 8 / 21 / 16 / 5 <b>Neighborhood</b> 1177 - R-V01-SW CLAREMORE <b>School District</b> S001 - CLAREMORE SCHOOLS																																																										
<b>Legal Description</b> Lat/Long: 36.31324749 -95.62789794																																																										
<b>Building Permits</b>					<table border="1"> <thead> <tr> <th>Number</th> <th>Description</th> <th>Opened</th> <th>Closed</th> <th>Amount</th> </tr> </thead> <tbody> <tr> <td colspan="5"> </td> </tr> </tbody> </table>					Number	Description	Opened	Closed	Amount																																												
Number	Description	Opened	Closed	Amount																																																						
<b>Exemptions</b>					<b>Sale History</b>																																																					
<b>Code</b>	<b>Type</b>	<b>Active</b>	<b>Maximum</b>	<b>Exemption</b>	<b>Bk/Pg</b>	<b>Grantor</b>	<b>Date</b>	<b>Price</b>	<b>Code</b>																																																	
N2 OF LOTS 16 THRU 20 BLOCK 32 BAYLESS					/	JOHNSTON, BILLY B	02/05/2026	0	4																																																	
					/	JOHNSTON, BETTY	02/05/2026	91,000	YES																																																	
					1764/645	STONE, B J & CHAERA	04/10/2006	75,000	YES																																																	
					1539/67	KOONTZ, MICHELE ANASTASIA	10/29/2003	67,500	YES																																																	
					841/561			0	No																																																	
<b>Parcel Valuation</b>					<table border="1"> <thead> <tr> <th>Source</th> <th>REAL</th> <th>Fair Cash</th> <th>Capped</th> <th>Asmnt Level</th> <th>Assessed</th> <th>Levy Rate</th> <th>92.430</th> <th>Current Tax</th> </tr> </thead> <tbody> <tr> <td>Remove Cap</td> <td>2027</td> <td>Land Value</td> <td>26,206</td> <td>26,206</td> <td>11%</td> <td>2,883</td> <td>Assessed</td> <td>9,946</td> <td>919.31</td> </tr> <tr> <td>Year Frozen</td> <td>0</td> <td>Improvements</td> <td>64,208</td> <td>64,208</td> <td></td> <td>7,063</td> <td>Penalty</td> <td>0</td> <td></td> </tr> <tr> <td>Uncapped Value</td> <td>0</td> <td>Mobile Home</td> <td>0</td> <td>0</td> <td></td> <td>0</td> <td>Exemption</td> <td>0</td> <td>0.00</td> </tr> <tr> <td>TIF Project ID</td> <td>0</td> <td>Total Value</td> <td>90,414</td> <td>90,414</td> <td></td> <td>9,946</td> <td>Total Taxable</td> <td>9,946</td> <td>919.00</td> </tr> </tbody> </table>					Source	REAL	Fair Cash	Capped	Asmnt Level	Assessed	Levy Rate	92.430	Current Tax	Remove Cap	2027	Land Value	26,206	26,206	11%	2,883	Assessed	9,946	919.31	Year Frozen	0	Improvements	64,208	64,208		7,063	Penalty	0		Uncapped Value	0	Mobile Home	0	0		0	Exemption	0	0.00	TIF Project ID	0	Total Value	90,414	90,414		9,946	Total Taxable	9,946	919.00
Source	REAL	Fair Cash	Capped	Asmnt Level	Assessed	Levy Rate	92.430	Current Tax																																																		
Remove Cap	2027	Land Value	26,206	26,206	11%	2,883	Assessed	9,946	919.31																																																	
Year Frozen	0	Improvements	64,208	64,208		7,063	Penalty	0																																																		
Uncapped Value	0	Mobile Home	0	0		0	Exemption	0	0.00																																																	
TIF Project ID	0	Total Value	90,414	90,414		9,946	Total Taxable	9,946	919.00																																																	
<b>Assessment History</b>																																																										
Tax Year	Statement Number	Billed Owner	Tax Area	Total Value	Exemptions	Taxable Value	Billed Tax																																																			
2025	2025-660007293	JOHNSTON, BILLY B	17	88,206	0	9,578	885.00																																																			
2024	2024-660007293	JOHNSTON, BILLY B	17	90,207	0	9,122	843.00																																																			
2023	2023-660007293	JOHNSTON, BILLY B	17	86,379	0	8,688	796.00																																																			
2022	2022-660007293	JOHNSTON, BILLY B	17	75,220	0	8,274	766.00																																																			
2021	2021-660007293	JOHNSTON, BILLY B	17	76,867	0	8,455	747.00																																																			
2020	2020-660007293	JOHNSTON, BILLY B	17	75,959	0	8,347	764.00																																																			
2019	2019-660007293	JOHNSTON, BILLY B	17	72,268	0	7,949	736.00																																																			
2018	2018-660007293	JOHNSTON, BILLY B	17	75,456	0	8,300	767.00																																																			
2017	2017-660007293	JOHNSTON, BILLY B	17	74,839	0	8,232	756.00																																																			
2016	2016-660007293	JOHNSTON, BILLY B	17	72,987	0	8,029	754.00																																																			
2015	2015-660007293	JOHNSTON, BILLY B	17	72,483	0	7,973	719.00																																																			
2014	2014-660007293	JOHNSTON, BILLY B	17	73,861	0	8,125	753.00																																																			
2013	2013-660007293	JOHNSTON, BILLY B	17	70,665	0	7,772	711.00																																																			



# Rogers

## Assessment Property Record Card for Tax Year 2026

Data provided by LISA DELOZIER County Assessor

Date 04/16/2026  
 Time 21:07:04  
 Page 2

Lot Data	Square-Foot - NBHD 1177 #1	Primary Image
<b>Lot Size</b> <b>Lot Count</b> <b>Units Buildable</b> 6750 <b>Non-Ag Acres</b> 0.1639 <b>Topography</b> <b>Street Access</b> <b>Utilities</b> <b>Amenities</b> LAND QUALITY  <b>Method</b> Square-Foot <b>Base Lot Value</b> 7,140.00 x 3.67 = 26,206 <b>Factor Value</b> <b>Adjustments</b> <b>Lot Value</b> 26,206		

Residential Data	
<b>Type</b>	1 Single Family Residence
<b>Condition</b>	3 - Average
<b>Quality</b>	2 - Fair
<b>Architecture</b>	R3 Res Nbhd 3
<b>Style</b>	100% One Story
<b>Exterior Wall</b>	80% Veneer, Masonry 20% Frame, Siding, Wood
<b>Base/Total Area</b>	1,008 / 1,008
<b>Style</b>	100% One Story
<b>HVAC</b>	100% Warmed & Cooled Air
<b>Roof Cover</b>	1 Composition Shingle
<b>Area on Slab</b>	1,008
<b>Fixture/RghIn</b>	4 /
<b>Bed/F/H Bath</b>	3 / 1.0 /
<b>Basement Area</b>	
<b>Garage Type</b>	
<b>Remodel</b>	
<b>Year/Eff Age</b>	1974 / 39

\\tsclient\T\LOGAN\LOGAN RESIDENTIAL VI\2023-5-25\IMG\_0001 5/25/2023

GRM Approach	
<b>GRM Code</b>	
<b>Gross Rent</b>	0.00
<b>Indicated Value</b>	

Multiple Regression			
<b>MRA Code</b>	1	Test	
<b>Adusted R</b>	0.8445		
<b>Indicated Value</b>	70,678	70.12	Per SqFt

Direct Comparables			
<b>Selection Model</b>	A	Adam Test	
<b>Adjustment Model</b>	1	2022 Residential	
<b>Comparables</b>	8		
<b>Indicated Value</b>	84,280		Per SqFt

Cost Approach				Manual : 01/2025			
<b>Base Cost</b>	101.30	<b>Total Misc Impr</b>	+ 6,671				
<b>Roofing Adj</b>	+ 4.21	<b>Garage Cost</b>	+ 0				
<b>Subfloor Adj</b>	+ 0.00	<b>Total RCN</b>	= 128,417				
<b>Heat/Cool Adj</b>	+ 10.30	<b>Depreciation ( 50%)</b>	- 64,209				
<b>Plumbing Adj</b>	+ 4.97	<b>Lump Sums</b>	+ 0				
<b>Basement Adj</b>	+ 0.00	<b>RCNLD</b>	= 64,208				
<b>Adj Base Cost</b>	= 120.78	<b>Lot Value</b>	+ 26,206				
<b>Total Area</b>	x 1,008	<b>Indicated Value</b>	= 90,414				
<b>Adjusted Cost</b>	= 121,746	<b>Value Per SqFt</b>	89.70				

Value Reconciliation			
<b>Selected Approach</b>	Cost Approach		
<b>Improvements</b>	64,208		
<b>Lot Value</b>	26,206		
<b>Indicated Value</b>	90,414	89.70	Per SqFt
<b>Agland Value</b>			
<b>Site Improvements</b>			
<b>Total Value</b>	90,414	89.70	Total Value Per SqFt

Miscellaneous Improvements								
Code	Description	Sketch ID	Size	Year	Units	Unit Cost	Depr	Value
PRCH	SLAB PORCH - COVERED	17157	12x5		60	21.11		1,267
PRCH	SLAB PORCH - COVERED	17158	24x11		264	20.47		5,404



# Rogers

## Assessment Property Record Card for Tax Year 2026

Data provided by LISA DELOZIER County Assessor

Date 04/16/2026  
Time 21:07:04  
Page 3

Sketch Image

660007293

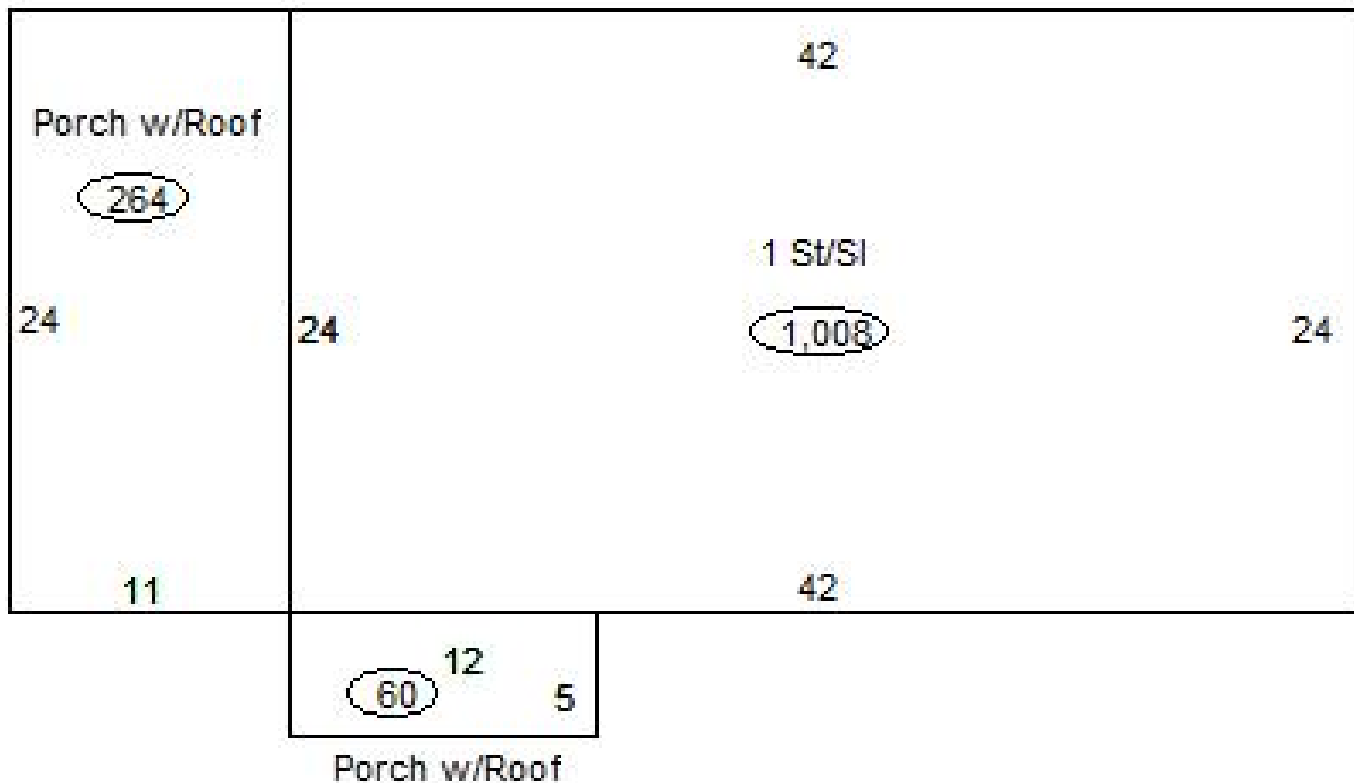

### Sketch Vector Information

Sequence	Code	Type	Built Over	Scale	Section Label	Base Area	Multiplier	Total Area
1	R	1	Slab	13	1 St/SI	1,008	1.000	1,008
2	M	PRCH		13	SLBC	60	1.000	60
3	M	PRCH		13	SLBC	264	1.000	264
<b>Total Building Area</b>						1,008		1,008