



Rogers

Assessment Property Record Card for Tax Year 2026

Data provided by LISA DELOZIER County Assessor

Date 04/18/2026
Time 06:39:38
Page 1

Assessment Data					Primary Image																																																																																																																				
Account 660007789 Parcel ID 000000-00-0-10500-003-0003 Cadastral ID 08-21-16-08480 Property Type REAL - Real Property Property Class URP VI Area 1 Tax Area 17 - CLAREMORE OT Name ID 344318 ANDERSON, STACY 1113 W WILL ROGERS CT CLAREMORE OK 74017-0000 Parcel Location Situs 01113 W WILL ROGERS CT Subdivision WESTGATE MANOR Lot/Block 0003 / 0003 Parcel Size 1 - Lots Sec/Twn/Rng 8 / 21 / 16 / 5 Neighborhood 1177 - R-V01-SW CLAREMORE School District S001 - CLAREMORE SCHOOLS																																																																																																																									
Legal Description Lot/Long: 36.31832561 -95.62230308																																																																																																																									
Legal Description LOT 3 BLOCK 3 WESTGATE MANOR					Building Permits <table border="1"> <thead> <tr> <th>Number</th> <th>Description</th> <th>Opened</th> <th>Closed</th> <th>Amount</th> </tr> </thead> <tbody> <tr> <td colspan="5"> </td> </tr> </tbody> </table>					Number	Description	Opened	Closed	Amount																																																																																																											
Number	Description	Opened	Closed	Amount																																																																																																																					
Exemptions <table border="1"> <thead> <tr> <th>Code</th> <th>Type</th> <th>Active</th> <th>Maximum</th> <th>Exemption</th> </tr> </thead> <tbody> <tr> <td>H</td> <td>Homestead</td> <td>Yes</td> <td>1,000</td> <td>1,000</td> </tr> <tr> <td>A</td> <td>Add-Homestead</td> <td>No</td> <td>1,000</td> <td></td> </tr> </tbody> </table>					Code	Type	Active	Maximum	Exemption	H	Homestead	Yes	1,000	1,000	A	Add-Homestead	No	1,000		Sale History <table border="1"> <thead> <tr> <th>Bk/Pg</th> <th>Grantor</th> <th>Date</th> <th>Price</th> <th>Code</th> </tr> </thead> <tbody> <tr> <td>/</td> <td>BECKLEY, WILLIAM ALLEN &</td> <td>05/10/2024</td> <td>138,000</td> <td>YES</td> </tr> <tr> <td>2155/284</td> <td>TREADWAY, JOE R &</td> <td>01/25/2011</td> <td>82,500</td> <td>YES</td> </tr> <tr> <td>1968/118</td> <td>TREADWAY, JOE R</td> <td>06/12/2008</td> <td>0</td> <td>4</td> </tr> <tr> <td>1931/192</td> <td>TERRY, MADLENE L TRUST</td> <td>02/06/2008</td> <td>0</td> <td>4</td> </tr> </tbody> </table>					Bk/Pg	Grantor	Date	Price	Code	/	BECKLEY, WILLIAM ALLEN &	05/10/2024	138,000	YES	2155/284	TREADWAY, JOE R &	01/25/2011	82,500	YES	1968/118	TREADWAY, JOE R	06/12/2008	0	4	1931/192	TERRY, MADLENE L TRUST	02/06/2008	0	4																																																																								
Code	Type	Active	Maximum	Exemption																																																																																																																					
H	Homestead	Yes	1,000	1,000																																																																																																																					
A	Add-Homestead	No	1,000																																																																																																																						
Bk/Pg	Grantor	Date	Price	Code																																																																																																																					
/	BECKLEY, WILLIAM ALLEN &	05/10/2024	138,000	YES																																																																																																																					
2155/284	TREADWAY, JOE R &	01/25/2011	82,500	YES																																																																																																																					
1968/118	TREADWAY, JOE R	06/12/2008	0	4																																																																																																																					
1931/192	TERRY, MADLENE L TRUST	02/06/2008	0	4																																																																																																																					
Parcel Valuation <table border="1"> <thead> <tr> <th>Source</th> <th>REAL</th> <th>Fair Cash</th> <th>Capped</th> <th>Asmnt Level</th> <th>Assessed</th> <th>Levy Rate</th> <th>92.430</th> <th>Current Tax</th> </tr> </thead> <tbody> <tr> <td>Remove Cap</td> <td>2025</td> <td>Land Value</td> <td>72,862</td> <td>72,862</td> <td>11%</td> <td>8,015</td> <td>Assessed</td> <td>15,422 1,425.46</td> </tr> <tr> <td>Year Frozen</td> <td>2023</td> <td>Improvements</td> <td>67,337</td> <td>67,337</td> <td></td> <td>7,407</td> <td>Penalty</td> <td>0</td> </tr> <tr> <td>Uncapped Value</td> <td>0</td> <td>Mobile Home</td> <td>0</td> <td>0</td> <td></td> <td>0</td> <td>Exemption</td> <td>1,000 -92.00</td> </tr> <tr> <td>TIF Project ID</td> <td>0</td> <td>Total Value</td> <td>140,199</td> <td>140,199</td> <td></td> <td>15,422</td> <td>Total Taxable</td> <td>14,422 1,333.00</td> </tr> </tbody> </table>										Source	REAL	Fair Cash	Capped	Asmnt Level	Assessed	Levy Rate	92.430	Current Tax	Remove Cap	2025	Land Value	72,862	72,862	11%	8,015	Assessed	15,422 1,425.46	Year Frozen	2023	Improvements	67,337	67,337		7,407	Penalty	0	Uncapped Value	0	Mobile Home	0	0		0	Exemption	1,000 -92.00	TIF Project ID	0	Total Value	140,199	140,199		15,422	Total Taxable	14,422 1,333.00																																																																			
Source	REAL	Fair Cash	Capped	Asmnt Level	Assessed	Levy Rate	92.430	Current Tax																																																																																																																	
Remove Cap	2025	Land Value	72,862	72,862	11%	8,015	Assessed	15,422 1,425.46																																																																																																																	
Year Frozen	2023	Improvements	67,337	67,337		7,407	Penalty	0																																																																																																																	
Uncapped Value	0	Mobile Home	0	0		0	Exemption	1,000 -92.00																																																																																																																	
TIF Project ID	0	Total Value	140,199	140,199		15,422	Total Taxable	14,422 1,333.00																																																																																																																	
Assessment History <table border="1"> <thead> <tr> <th>Tax Year</th> <th>Statement Number</th> <th>Billed Owner</th> <th>Tax Area</th> <th>Total Value</th> <th>Exemptions</th> <th>Taxable Value</th> <th>Billed Tax</th> </tr> </thead> <tbody> <tr> <td>2025</td> <td>2025-660007789</td> <td>ANDERSON, STACY</td> <td>17</td> <td>138,000</td> <td>0</td> <td>15,180</td> <td>1,403.00</td> </tr> <tr> <td>2024</td> <td>2024-660007789</td> <td>ANDERSON, STACY</td> <td>17</td> <td>88,183</td> <td>1000</td> <td>7,319</td> <td>676.00</td> </tr> <tr> <td>2023</td> <td>2023-660007789</td> <td>BECKLEY, WILLIAM ALLEN &</td> <td>17</td> <td>75,632</td> <td>1000</td> <td>7,320</td> <td>671.00</td> </tr> <tr> <td>2022</td> <td>2022-660007789</td> <td>BECKLEY, WILLIAM ALLEN &</td> <td>17</td> <td>76,783</td> <td>1000</td> <td>7,446</td> <td>689.00</td> </tr> <tr> <td>2021</td> <td>2021-660007789</td> <td>BECKLEY, WILLIAM ALLEN &</td> <td>17</td> <td>80,157</td> <td>2000</td> <td>6,817</td> <td>602.00</td> </tr> <tr> <td>2020</td> <td>2020-660007789</td> <td>BECKLEY, WILLIAM ALLEN &</td> <td>17</td> <td>78,981</td> <td>1000</td> <td>7,688</td> <td>704.00</td> </tr> <tr> <td>2019</td> <td>2019-660007789</td> <td>BECKLEY, WILLIAM ALLEN &</td> <td>17</td> <td>77,188</td> <td>1000</td> <td>7,491</td> <td>694.00</td> </tr> <tr> <td>2018</td> <td>2018-660007789</td> <td>BECKLEY, WILLIAM ALLEN &</td> <td>17</td> <td>80,355</td> <td>1000</td> <td>7,839</td> <td>724.00</td> </tr> <tr> <td>2017</td> <td>2017-660007789</td> <td>BECKLEY, WILLIAM ALLEN &</td> <td>17</td> <td>79,749</td> <td>1000</td> <td>7,772</td> <td>714.00</td> </tr> <tr> <td>2016</td> <td>2016-660007789</td> <td>BECKLEY, WILLIAM ALLEN &</td> <td>17</td> <td>77,937</td> <td>2000</td> <td>6,573</td> <td>617.00</td> </tr> <tr> <td>2015</td> <td>2015-660007789</td> <td>BECKLEY, WILLIAM ALLEN &</td> <td>17</td> <td>80,616</td> <td>2000</td> <td>6,868</td> <td>619.00</td> </tr> <tr> <td>2014</td> <td>2014-660007789</td> <td>BECKLEY, WILLIAM ALLEN &</td> <td>17</td> <td>82,818</td> <td>2000</td> <td>6,888</td> <td>639.00</td> </tr> <tr> <td>2013</td> <td>2013-660007789</td> <td>BECKLEY, WILLIAM ALLEN &</td> <td>17</td> <td>78,451</td> <td>2000</td> <td>6,630</td> <td>607.00</td> </tr> </tbody> </table>										Tax Year	Statement Number	Billed Owner	Tax Area	Total Value	Exemptions	Taxable Value	Billed Tax	2025	2025-660007789	ANDERSON, STACY	17	138,000	0	15,180	1,403.00	2024	2024-660007789	ANDERSON, STACY	17	88,183	1000	7,319	676.00	2023	2023-660007789	BECKLEY, WILLIAM ALLEN &	17	75,632	1000	7,320	671.00	2022	2022-660007789	BECKLEY, WILLIAM ALLEN &	17	76,783	1000	7,446	689.00	2021	2021-660007789	BECKLEY, WILLIAM ALLEN &	17	80,157	2000	6,817	602.00	2020	2020-660007789	BECKLEY, WILLIAM ALLEN &	17	78,981	1000	7,688	704.00	2019	2019-660007789	BECKLEY, WILLIAM ALLEN &	17	77,188	1000	7,491	694.00	2018	2018-660007789	BECKLEY, WILLIAM ALLEN &	17	80,355	1000	7,839	724.00	2017	2017-660007789	BECKLEY, WILLIAM ALLEN &	17	79,749	1000	7,772	714.00	2016	2016-660007789	BECKLEY, WILLIAM ALLEN &	17	77,937	2000	6,573	617.00	2015	2015-660007789	BECKLEY, WILLIAM ALLEN &	17	80,616	2000	6,868	619.00	2014	2014-660007789	BECKLEY, WILLIAM ALLEN &	17	82,818	2000	6,888	639.00	2013	2013-660007789	BECKLEY, WILLIAM ALLEN &	17	78,451	2000	6,630	607.00
Tax Year	Statement Number	Billed Owner	Tax Area	Total Value	Exemptions	Taxable Value	Billed Tax																																																																																																																		
2025	2025-660007789	ANDERSON, STACY	17	138,000	0	15,180	1,403.00																																																																																																																		
2024	2024-660007789	ANDERSON, STACY	17	88,183	1000	7,319	676.00																																																																																																																		
2023	2023-660007789	BECKLEY, WILLIAM ALLEN &	17	75,632	1000	7,320	671.00																																																																																																																		
2022	2022-660007789	BECKLEY, WILLIAM ALLEN &	17	76,783	1000	7,446	689.00																																																																																																																		
2021	2021-660007789	BECKLEY, WILLIAM ALLEN &	17	80,157	2000	6,817	602.00																																																																																																																		
2020	2020-660007789	BECKLEY, WILLIAM ALLEN &	17	78,981	1000	7,688	704.00																																																																																																																		
2019	2019-660007789	BECKLEY, WILLIAM ALLEN &	17	77,188	1000	7,491	694.00																																																																																																																		
2018	2018-660007789	BECKLEY, WILLIAM ALLEN &	17	80,355	1000	7,839	724.00																																																																																																																		
2017	2017-660007789	BECKLEY, WILLIAM ALLEN &	17	79,749	1000	7,772	714.00																																																																																																																		
2016	2016-660007789	BECKLEY, WILLIAM ALLEN &	17	77,937	2000	6,573	617.00																																																																																																																		
2015	2015-660007789	BECKLEY, WILLIAM ALLEN &	17	80,616	2000	6,868	619.00																																																																																																																		
2014	2014-660007789	BECKLEY, WILLIAM ALLEN &	17	82,818	2000	6,888	639.00																																																																																																																		
2013	2013-660007789	BECKLEY, WILLIAM ALLEN &	17	78,451	2000	6,630	607.00																																																																																																																		



Rogers

Assessment Property Record Card for Tax Year 2026

Data provided by LISA DELOZIER County Assessor

Date 04/18/2026
 Time 06:39:39
 Page 2

Lot Data	Square-Foot - NBHD 1177 #1	Primary Image
Lot Size Lot Count Units Buildable 8578 Non-Ag Acres 0.1622 Topography Street Access Utilities Amenities LAND QUALITY Method Square-Foot Base Lot Value 7,064.00 x 3.68 = 25,986 Factor Value Adjustments 2.8039 Lot Value 72,862		

Residential Data	
Type	1 Single Family Residence
Condition	3 - Average
Quality	2 - Fair
Architecture	R3 Res Nbhd 3
Style	100% One Story
Exterior Wall	100% Veneer, Masonry
Base/Total Area	1,005 / 1,005
Style	100% One Story
HVAC	100% Warmed & Cooled Air
Roof Cover	1 Composition Shingle
Area on Slab	1,005
Fixture/RghIn	4 /
Bed/F/H Bath	3 / 1.0 /
Basement Area	
Garage Type	506 Attached Garage - Unfinished 2 Stalls
Remodel	
Year/Eff Age	1971 / 41

GRM Approach	
GRM Code	
Gross Rent	0.00
Indicated Value	

Multiple Regression			
MRA Code	1	Test	
Adusted R	0.8445		
Indicated Value	113,110	112.55	Per SqFt

Direct Comparables			
Selection Model	A	Adam Test	
Adjustment Model	1	2022 Residential	
Comparables	8		
Indicated Value	119,710		Per SqFt

Cost Approach				Manual : 01/2025			
Base Cost	104.81	Total Misc Impr	+ 636				
Roofing Adj	+ 4.30	Garage Cost	+ 11,775				
Subfloor Adj	+ 0.00	Total RCN	= 137,423				
Heat/Cool Adj	+ 10.30	Depreciation (51%)	- 70,086				
Plumbing Adj	+ 4.98	Lump Sums	+ 0				
Basement Adj	+ 0.00	RCNLD	= 67,337				
Adj Base Cost	= 124.39	Lot Value	+ 72,862				
Total Area	x 1,005	Indicated Value	= 140,199				
Adjusted Cost	= 125,012	Value Per SqFt	139.50				

Value Reconciliation			
Selected Approach	Cost Approach		
Improvements	67,337		
Lot Value	72,862		
Indicated Value	140,199	139.50	Per SqFt
Agland Value			
Site Improvements			
Total Value	140,199	139.50	Total Value Per SqFt

Miscellaneous Improvements							
Code	Description	Sketch ID	Size	Year	Units	Unit Cost	Depr Value
PRCH	SLAB PORCH - COVERED	18367	6x5		30	21.20	636



Rogers

Assessment Property Record Card for Tax Year 2026

Data provided by LISA DELOZIER County Assessor

Date 04/18/2026
 Time 06:39:39
 Page 3

Sketch Image

660007789

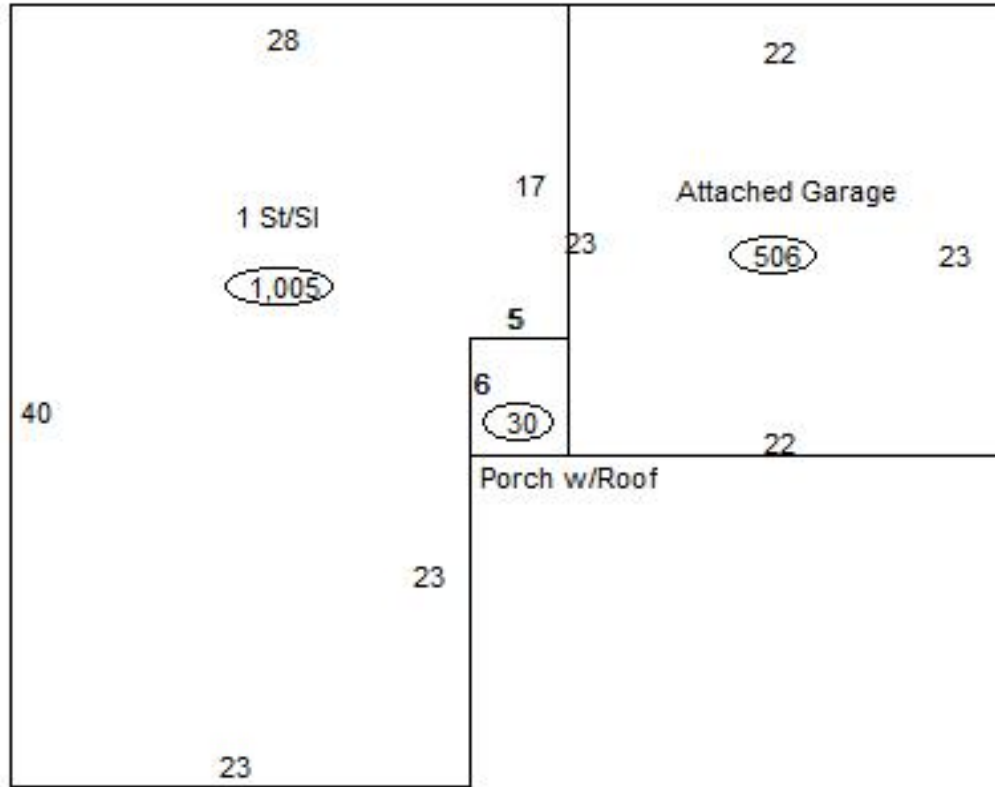

Sketch Vector Information

Sequence	Code	Type	Built Over	Scale	Section Label	Base Area	Multiplier	Total Area
1	R	1	Slab	13	1 St/SI	1,005	1.000	1,005
2	G	1		13	Attached Garage	506	1.000	506
3	M	PRCH		13	SLBC	30	1.000	30
Total Building Area						1,005		1,005