



Rogers

Assessment Property Record Card for Tax Year 2026

Data provided by LISA DELOZIER County Assessor

Date 04/18/2026
 Time 07:46:46
 Page 1

Assessment Data					Primary Image																																																																																																																				
Account 660008025 Parcel ID 21N16E-08-3-00000-000-0000 Cadastral ID 08-21-16-20800 Property Type REAL - Real Property Property Class UC VI Area 1 Tax Area 17 - CLAREMORE OT Name ID 295349 CUSTOMZ AUTO SPECIALTIES LLC MATTHEW BARNES 1201 S CHOCTAW AVE CLAREMORE OK 74017-0000																																																																																																																									
Parcel Location Situs 00721 S CHAMBERS AVE Subdivision Lot/Block / Parcel Size 1.41 - Acres Sec/Twn/Rng 8 / 21 / 16 / 3 Neighborhood 90000 - COMMERCIAL School District S001 - CLAREMORE SCHOOLS																																																																																																																									
Legal Description Lat/Long: 36.30764375 -95.62431103					Building Permits <table border="1"> <thead> <tr> <th>Number</th> <th>Description</th> <th>Opened</th> <th>Closed</th> <th>Amount</th> </tr> </thead> <tbody> <tr> <td>R12</td> <td>PICK UP NEW ADD-ON</td> <td>04/2011</td> <td>01/2012</td> <td></td> </tr> <tr> <td>4120</td> <td>1300 SQ FT SHOP ADDITION</td> <td>01/2011</td> <td>01/2012</td> <td></td> </tr> <tr> <td>295</td> <td>DEMOLITION PERMIT</td> <td>12/2010</td> <td>03/2011</td> <td></td> </tr> </tbody> </table>					Number	Description	Opened	Closed	Amount	R12	PICK UP NEW ADD-ON	04/2011	01/2012		4120	1300 SQ FT SHOP ADDITION	01/2011	01/2012		295	DEMOLITION PERMIT	12/2010	03/2011																																																																																													
Number	Description	Opened	Closed	Amount																																																																																																																					
R12	PICK UP NEW ADD-ON	04/2011	01/2012																																																																																																																						
4120	1300 SQ FT SHOP ADDITION	01/2011	01/2012																																																																																																																						
295	DEMOLITION PERMIT	12/2010	03/2011																																																																																																																						
Exemptions <table border="1"> <thead> <tr> <th>Code</th> <th>Type</th> <th>Active</th> <th>Maximum</th> <th>Exemption</th> </tr> </thead> <tbody> <tr> <td></td> <td></td> <td></td> <td></td> <td></td> </tr> </tbody> </table>					Code	Type	Active	Maximum	Exemption						Sale History <table border="1"> <thead> <tr> <th>Bk/Pg</th> <th>Grantor</th> <th>Date</th> <th>Price</th> <th>Code</th> </tr> </thead> <tbody> <tr> <td>/</td> <td>BARNES, DAVID A & JENNIFER E</td> <td>01/16/2020</td> <td>0</td> <td>4</td> </tr> <tr> <td>2138/909</td> <td>ERWIN'S AFFORDABLE PEST</td> <td>10/29/2010</td> <td>93,000</td> <td>11</td> </tr> <tr> <td>1790/246</td> <td>KING, JERRY W &</td> <td>07/13/2006</td> <td>84,000</td> <td>YES</td> </tr> <tr> <td>1582/830</td> <td>KING, JERRY W</td> <td>04/27/2004</td> <td>0</td> <td>4</td> </tr> </tbody> </table>					Bk/Pg	Grantor	Date	Price	Code	/	BARNES, DAVID A & JENNIFER E	01/16/2020	0	4	2138/909	ERWIN'S AFFORDABLE PEST	10/29/2010	93,000	11	1790/246	KING, JERRY W &	07/13/2006	84,000	YES	1582/830	KING, JERRY W	04/27/2004	0	4																																																																													
Code	Type	Active	Maximum	Exemption																																																																																																																					
Bk/Pg	Grantor	Date	Price	Code																																																																																																																					
/	BARNES, DAVID A & JENNIFER E	01/16/2020	0	4																																																																																																																					
2138/909	ERWIN'S AFFORDABLE PEST	10/29/2010	93,000	11																																																																																																																					
1790/246	KING, JERRY W &	07/13/2006	84,000	YES																																																																																																																					
1582/830	KING, JERRY W	04/27/2004	0	4																																																																																																																					
Parcel Valuation <table border="1"> <thead> <tr> <th>Source</th> <th>REAL</th> <th>Fair Cash</th> <th>Capped</th> <th>Asmnt Level</th> <th>Assessed</th> <th>Levy Rate</th> <th>92.430</th> <th>Current Tax</th> </tr> </thead> <tbody> <tr> <td>Remove Cap</td> <td>2011</td> <td>Land Value 68,785</td> <td>68,785</td> <td>11%</td> <td>7,566</td> <td>Assessed</td> <td>12,537</td> <td>1,158.79</td> </tr> <tr> <td>Year Frozen</td> <td>0</td> <td>Improvements 50,073</td> <td>45,193</td> <td></td> <td>4,971</td> <td>Penalty</td> <td>0</td> <td></td> </tr> <tr> <td>Uncapped Value</td> <td>0</td> <td>Mobile Home 0</td> <td>0</td> <td></td> <td>0</td> <td>Exemption</td> <td>0</td> <td>0.00</td> </tr> <tr> <td>TIF Project ID</td> <td>0</td> <td>Total Value 118,858</td> <td>113,978</td> <td></td> <td>12,537</td> <td>Total Taxable</td> <td>12,537</td> <td>1,159.00</td> </tr> </tbody> </table>										Source	REAL	Fair Cash	Capped	Asmnt Level	Assessed	Levy Rate	92.430	Current Tax	Remove Cap	2011	Land Value 68,785	68,785	11%	7,566	Assessed	12,537	1,158.79	Year Frozen	0	Improvements 50,073	45,193		4,971	Penalty	0		Uncapped Value	0	Mobile Home 0	0		0	Exemption	0	0.00	TIF Project ID	0	Total Value 118,858	113,978		12,537	Total Taxable	12,537	1,159.00																																																																			
Source	REAL	Fair Cash	Capped	Asmnt Level	Assessed	Levy Rate	92.430	Current Tax																																																																																																																	
Remove Cap	2011	Land Value 68,785	68,785	11%	7,566	Assessed	12,537	1,158.79																																																																																																																	
Year Frozen	0	Improvements 50,073	45,193		4,971	Penalty	0																																																																																																																		
Uncapped Value	0	Mobile Home 0	0		0	Exemption	0	0.00																																																																																																																	
TIF Project ID	0	Total Value 118,858	113,978		12,537	Total Taxable	12,537	1,159.00																																																																																																																	
Assessment History <table border="1"> <thead> <tr> <th>Tax Year</th> <th>Statement Number</th> <th>Billed Owner</th> <th>Tax Area</th> <th>Total Value</th> <th>Exemptions</th> <th>Taxable Value</th> <th>Billed Tax</th> </tr> </thead> <tbody> <tr><td>2025</td><td>2025-660008025</td><td>CUSTOMZ AUTO SPECIALTIES LLC</td><td>17</td><td>122,280</td><td>0</td><td>11,940</td><td>1,104.00</td></tr> <tr><td>2024</td><td>2024-660008025</td><td>CUSTOMZ AUTO SPECIALTIES LLC</td><td>17</td><td>103,382</td><td>0</td><td>11,372</td><td>1,051.00</td></tr> <tr><td>2023</td><td>2023-660008025</td><td>CUSTOMZ AUTO SPECIALTIES LLC</td><td>17</td><td>131,811</td><td>0</td><td>12,191</td><td>1,117.00</td></tr> <tr><td>2022</td><td>2022-660008025</td><td>CUSTOMZ AUTO SPECIALTIES LLC</td><td>17</td><td>127,507</td><td>0</td><td>11,611</td><td>1,075.00</td></tr> <tr><td>2021</td><td>2021-660008025</td><td>CUSTOMZ AUTO SPECIALTIES LLC</td><td>17</td><td>100,531</td><td>0</td><td>11,058</td><td>976.00</td></tr> <tr><td>2020</td><td>2020-660008025</td><td>CUSTOMZ AUTO SPECIALTIES LLC</td><td>17</td><td>100,531</td><td>0</td><td>11,058</td><td>1,013.00</td></tr> <tr><td>2019</td><td>2019-660008025</td><td>BARNES, DAVID A & JENNIFER E</td><td>17</td><td>106,700</td><td>0</td><td>11,737</td><td>1,087.00</td></tr> <tr><td>2018</td><td>2018-660008025</td><td>BARNES, DAVID A & JENNIFER E</td><td>17</td><td>103,637</td><td>0</td><td>11,400</td><td>1,053.00</td></tr> <tr><td>2017</td><td>2017-660008025</td><td>BARNES, DAVID A & JENNIFER E</td><td>17</td><td>103,637</td><td>0</td><td>11,400</td><td>1,047.00</td></tr> <tr><td>2016</td><td>2016-660008025</td><td>BARNES, DAVID A & JENNIFER E</td><td>17</td><td>145,176</td><td>0</td><td>15,969</td><td>1,499.00</td></tr> <tr><td>2015</td><td>2015-660008025</td><td>BARNES, DAVID A & JENNIFER E</td><td>17</td><td>145,176</td><td>0</td><td>15,969</td><td>1,440.00</td></tr> <tr><td>2014</td><td>2014-660008025</td><td>BARNES, DAVID A & JENNIFER E</td><td>17</td><td>145,176</td><td>0</td><td>15,969</td><td>1,481.00</td></tr> <tr><td>2013</td><td>2013-660008025</td><td>BARNES, DAVID A & JENNIFER E</td><td>17</td><td>145,176</td><td>0</td><td>15,969</td><td>1,461.00</td></tr> </tbody> </table>										Tax Year	Statement Number	Billed Owner	Tax Area	Total Value	Exemptions	Taxable Value	Billed Tax	2025	2025-660008025	CUSTOMZ AUTO SPECIALTIES LLC	17	122,280	0	11,940	1,104.00	2024	2024-660008025	CUSTOMZ AUTO SPECIALTIES LLC	17	103,382	0	11,372	1,051.00	2023	2023-660008025	CUSTOMZ AUTO SPECIALTIES LLC	17	131,811	0	12,191	1,117.00	2022	2022-660008025	CUSTOMZ AUTO SPECIALTIES LLC	17	127,507	0	11,611	1,075.00	2021	2021-660008025	CUSTOMZ AUTO SPECIALTIES LLC	17	100,531	0	11,058	976.00	2020	2020-660008025	CUSTOMZ AUTO SPECIALTIES LLC	17	100,531	0	11,058	1,013.00	2019	2019-660008025	BARNES, DAVID A & JENNIFER E	17	106,700	0	11,737	1,087.00	2018	2018-660008025	BARNES, DAVID A & JENNIFER E	17	103,637	0	11,400	1,053.00	2017	2017-660008025	BARNES, DAVID A & JENNIFER E	17	103,637	0	11,400	1,047.00	2016	2016-660008025	BARNES, DAVID A & JENNIFER E	17	145,176	0	15,969	1,499.00	2015	2015-660008025	BARNES, DAVID A & JENNIFER E	17	145,176	0	15,969	1,440.00	2014	2014-660008025	BARNES, DAVID A & JENNIFER E	17	145,176	0	15,969	1,481.00	2013	2013-660008025	BARNES, DAVID A & JENNIFER E	17	145,176	0	15,969	1,461.00
Tax Year	Statement Number	Billed Owner	Tax Area	Total Value	Exemptions	Taxable Value	Billed Tax																																																																																																																		
2025	2025-660008025	CUSTOMZ AUTO SPECIALTIES LLC	17	122,280	0	11,940	1,104.00																																																																																																																		
2024	2024-660008025	CUSTOMZ AUTO SPECIALTIES LLC	17	103,382	0	11,372	1,051.00																																																																																																																		
2023	2023-660008025	CUSTOMZ AUTO SPECIALTIES LLC	17	131,811	0	12,191	1,117.00																																																																																																																		
2022	2022-660008025	CUSTOMZ AUTO SPECIALTIES LLC	17	127,507	0	11,611	1,075.00																																																																																																																		
2021	2021-660008025	CUSTOMZ AUTO SPECIALTIES LLC	17	100,531	0	11,058	976.00																																																																																																																		
2020	2020-660008025	CUSTOMZ AUTO SPECIALTIES LLC	17	100,531	0	11,058	1,013.00																																																																																																																		
2019	2019-660008025	BARNES, DAVID A & JENNIFER E	17	106,700	0	11,737	1,087.00																																																																																																																		
2018	2018-660008025	BARNES, DAVID A & JENNIFER E	17	103,637	0	11,400	1,053.00																																																																																																																		
2017	2017-660008025	BARNES, DAVID A & JENNIFER E	17	103,637	0	11,400	1,047.00																																																																																																																		
2016	2016-660008025	BARNES, DAVID A & JENNIFER E	17	145,176	0	15,969	1,499.00																																																																																																																		
2015	2015-660008025	BARNES, DAVID A & JENNIFER E	17	145,176	0	15,969	1,440.00																																																																																																																		
2014	2014-660008025	BARNES, DAVID A & JENNIFER E	17	145,176	0	15,969	1,481.00																																																																																																																		
2013	2013-660008025	BARNES, DAVID A & JENNIFER E	17	145,176	0	15,969	1,461.00																																																																																																																		



Rogers

Assessment Property Record Card for Tax Year 2026

Data provided by LISA DELOZIER County Assessor

Date 04/18/2026
 Time 07:46:47
 Page 2

Lot Data	Primary Image																																						
<table border="0"> <tr><td>Lot Size</td><td>0 x 0</td></tr> <tr><td>Lot Count</td><td>0</td></tr> <tr><td>Units Buildable</td><td>35719</td></tr> <tr><td>Non-Ag Acres</td><td>0</td></tr> <tr><td>Topography</td><td></td></tr> <tr><td>Street Access</td><td></td></tr> <tr><td>Utilities</td><td></td></tr> <tr><td>Amenities</td><td>0</td></tr> <tr><td></td><td>0</td></tr> <tr><td>Value Model</td><td>1482 (UNITS BUILDABLE)</td></tr> <tr><td>Value Method</td><td>Units-Buildable</td></tr> <tr><td>Base Lot Value</td><td>68,785.00 x 1.00 = 68,785</td></tr> <tr><td>Factor Value</td><td>0</td></tr> <tr><td>Adjustments</td><td></td></tr> <tr><td>Lot Value</td><td>68,785</td></tr> </table>	Lot Size	0 x 0	Lot Count	0	Units Buildable	35719	Non-Ag Acres	0	Topography		Street Access		Utilities		Amenities	0		0	Value Model	1482 (UNITS BUILDABLE)	Value Method	Units-Buildable	Base Lot Value	68,785.00 x 1.00 = 68,785	Factor Value	0	Adjustments		Lot Value	68,785									
Lot Size	0 x 0																																						
Lot Count	0																																						
Units Buildable	35719																																						
Non-Ag Acres	0																																						
Topography																																							
Street Access																																							
Utilities																																							
Amenities	0																																						
	0																																						
Value Model	1482 (UNITS BUILDABLE)																																						
Value Method	Units-Buildable																																						
Base Lot Value	68,785.00 x 1.00 = 68,785																																						
Factor Value	0																																						
Adjustments																																							
Lot Value	68,785																																						
Cost Approach	Image Information																																						
<table border="0"> <tr><td>Manual Date</td><td>01/2025</td></tr> <tr><td>Total Building Area</td><td>2,900</td></tr> <tr><td>Total Base Value</td><td>192,589</td></tr> <tr><td>Modifier Value</td><td></td></tr> <tr><td>Misc Improvements</td><td></td></tr> <tr><td>Replacement Cost New</td><td>192,589</td></tr> <tr><td>Phys/Func Depreciation Loss</td><td>()</td></tr> <tr><td>RCN Less Phys/Func</td><td>50,073</td></tr> <tr><td>Economic Depreciation</td><td></td></tr> <tr><td>RCNLD (All Sources)</td><td>50,073</td></tr> <tr><td>Depreciated Improvements</td><td></td></tr> <tr><td>Outbuilding Value</td><td></td></tr> <tr><td>Total Improvement Value</td><td>50,073</td></tr> <tr><td>Land Value</td><td>68,785</td></tr> <tr><td>Cost Approach Value</td><td>118,858 40.99/SqFt</td></tr> </table>	Manual Date	01/2025	Total Building Area	2,900	Total Base Value	192,589	Modifier Value		Misc Improvements		Replacement Cost New	192,589	Phys/Func Depreciation Loss	()	RCN Less Phys/Func	50,073	Economic Depreciation		RCNLD (All Sources)	50,073	Depreciated Improvements		Outbuilding Value		Total Improvement Value	50,073	Land Value	68,785	Cost Approach Value	118,858 40.99/SqFt	<table border="0"> <tr><td>Image ID</td><td>1024301</td></tr> <tr><td>Image Date</td><td>5/18/2023</td></tr> <tr><td>Name</td><td>IMG_0021.JPG</td></tr> <tr><td>Description</td><td>REVAL 2024</td></tr> </table>	Image ID	1024301	Image Date	5/18/2023	Name	IMG_0021.JPG	Description	REVAL 2024
Manual Date	01/2025																																						
Total Building Area	2,900																																						
Total Base Value	192,589																																						
Modifier Value																																							
Misc Improvements																																							
Replacement Cost New	192,589																																						
Phys/Func Depreciation Loss	()																																						
RCN Less Phys/Func	50,073																																						
Economic Depreciation																																							
RCNLD (All Sources)	50,073																																						
Depreciated Improvements																																							
Outbuilding Value																																							
Total Improvement Value	50,073																																						
Land Value	68,785																																						
Cost Approach Value	118,858 40.99/SqFt																																						
Image ID	1024301																																						
Image Date	5/18/2023																																						
Name	IMG_0021.JPG																																						
Description	REVAL 2024																																						
Income Approach	Value Reconciliation																																						
<table border="0"> <tr><td>Potential Gross Income (PGI)</td><td></td></tr> <tr><td>Vacancy & Collection Loss</td><td></td></tr> <tr><td>Miscellaneous Income</td><td></td></tr> <tr><td>Effective Gross Income (EGI)</td><td></td></tr> <tr><td>Total Expenses</td><td></td></tr> <tr><td>Net Operating Income (NOI)</td><td></td></tr> <tr><td>Income Capitalization Rate</td><td></td></tr> <tr><td>Indicated Value</td><td>0.00</td></tr> </table>	Potential Gross Income (PGI)		Vacancy & Collection Loss		Miscellaneous Income		Effective Gross Income (EGI)		Total Expenses		Net Operating Income (NOI)		Income Capitalization Rate		Indicated Value	0.00	<table border="0"> <tr><td>Selected Valuation Method</td><td>Cost Approach</td></tr> <tr><td>Total Improvement Value</td><td></td></tr> <tr><td>Land Value</td><td>68,785</td></tr> <tr><td>Total Appraised Value</td><td>118,858 40.99/SqFt</td></tr> </table>	Selected Valuation Method	Cost Approach	Total Improvement Value		Land Value	68,785	Total Appraised Value	118,858 40.99/SqFt														
Potential Gross Income (PGI)																																							
Vacancy & Collection Loss																																							
Miscellaneous Income																																							
Effective Gross Income (EGI)																																							
Total Expenses																																							
Net Operating Income (NOI)																																							
Income Capitalization Rate																																							
Indicated Value	0.00																																						
Selected Valuation Method	Cost Approach																																						
Total Improvement Value																																							
Land Value	68,785																																						
Total Appraised Value	118,858 40.99/SqFt																																						



Rogers

Assessment Property Record Card for Tax Year 2026

Data provided by LISA DELOZIER County Assessor

Date 04/18/2026
Time 07:46:47
Page 3

Sketch Image

660008025

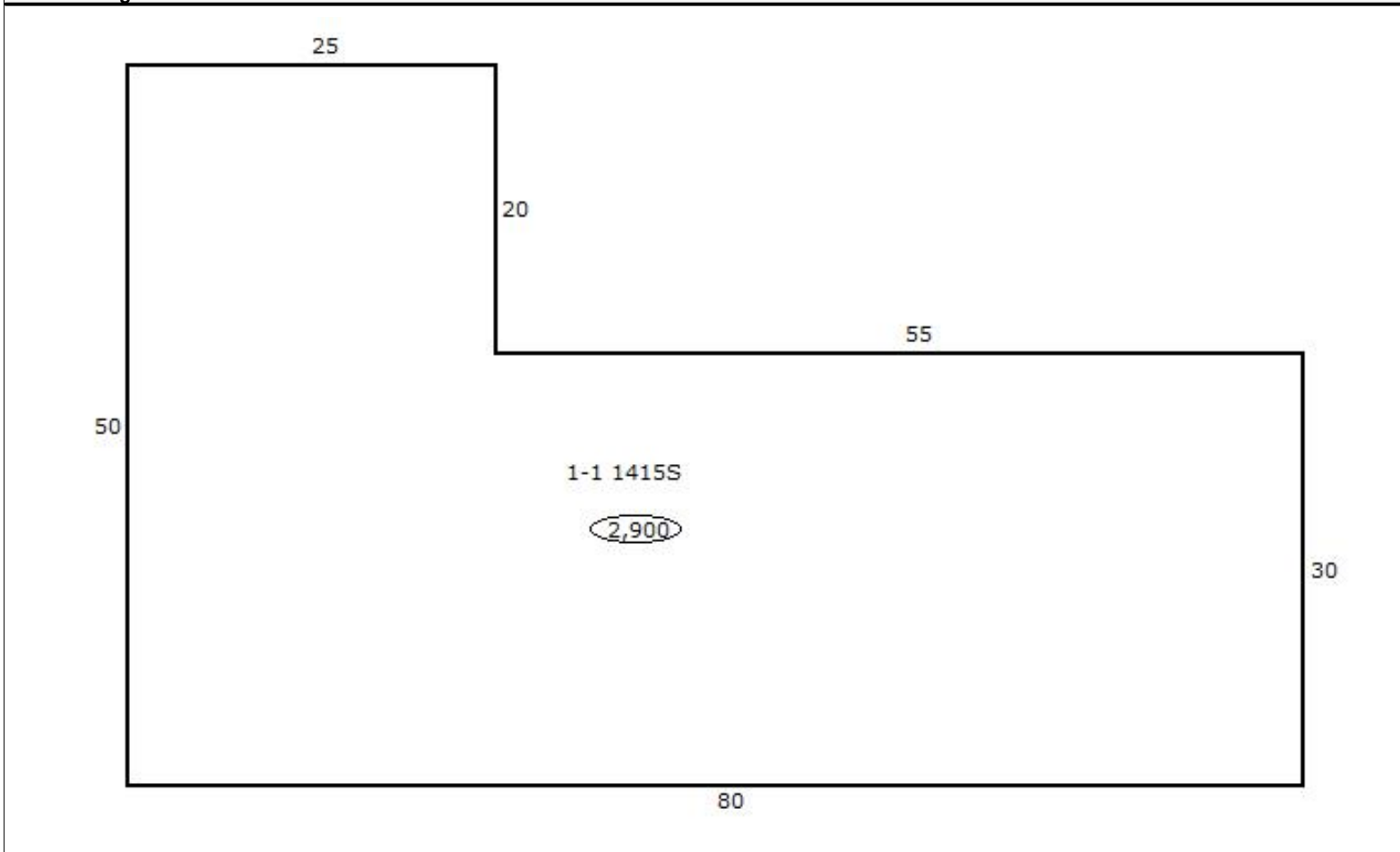

Sketch Vector Information

Sequence	Code	Type	Built Over	Scale	Section Label	Base Area	Multiplier	Total Area
1	C	406		13	1-1 1415S	2,900	1.000	2,900
Total Building Area						2,900		2,900



Rogers

Assessment Property Record Card for Tax Year 2026

Data provided by LISA DELOZIER County Assessor

Date 04/18/2026
Time 07:46:47
Page 4

Account 660008025
Parcel ID 21N16E-08-3-00000-000-0000
Cadastral ID 08-21-16-20800

Tax Area Code 17
Property Class UC
Owners Name CUSTOMZ AUTO SPECIALTIES LLC

Building Data

Building ID 85
Building Sequence 1
Occupancy 1 406 Storage Warehouse 100%
Occupancy 2
Occupancy 3
Total Floor Area 2,900
Average Perimeter 260
Number Of Storys 1.00
Average Wall Ht 14.00
Year Built 1978
Effective Age 31
Construction Class 7 - Pre-Engineered Steel Frame
Quality 2 - Fair
Condition 2 - Fair
Exterior Wall 88 - Stud Metal Siding
Heating/Cooling 15 - No HVAC
Roof Type
Roof Cover
Basement Area
Basement Levels
Basement Finish
Finish Code - 1
Finish Area - 1
Finish Code - 2
Finish Area - 2

Building Image



Image Information

Image Name IMG_0021.JPG
Image Date 5/18/2023
Image Name IMG_0021.JPG
Description REVAL 2024

Cost Calculations

Appraisal Zone 1
Zone Description
Base Cost 42.54
Wall Cost 23.87
HVAC Cost 0.00
Basement Cost 0.00
Total Base Cost 66.41
Total Area 2,900
Base RCN 192,589
Misc Impr Value

Manual Date 01/2025
Base Year 2026
Modifier Value
Total Replacement Cost 192,589
Physical Depreciation 74%
Functional Depreciation
Total Depreciation 74% (142,516)
Total RCNLD 50,073
Lump Sums
Total Building Value 50,073 \$ 17.27 Per SqFt