



Rogers

Assessment Property Record Card for Tax Year 2026

Data provided by LISA DELOZIER County Assessor

Date 04/17/2026
Time 02:59:07
Page 1

Assessment Data					Primary Image																																																																																																																				
Account 660008309 Parcel ID 24N18E-08-2-00000-000-0000 Cadastral ID 08-24-18-00300 Property Type REAL - Real Property Property Class RA VI Area 2 Tax Area 14 - CHELSEA RURAL Name ID 333338 EISENHAUER, DAVID EDWARD & HEIDI ANN 1009 W QUINCY ST PITTSBURG KS 66762-0000 Parcel Location Situs 02251 S 4260 RD Subdivision Lot/Block / Parcel Size 80 - Acres Sec/Twn/Rng 8 / 24 / 18 / 2 Neighborhood 4050 - CHELSEA FOYIL RURAL School District S003 - CHELSEA SCHOOLS					<p>660008309_001.JPG 5/13/2025</p>																																																																																																																				
Legal Description Lat/Long: 36.57728340 -95.41371791																																																																																																																									
S2 NW					Building Permits <table border="1"> <thead> <tr> <th>Number</th> <th>Description</th> <th>Opened</th> <th>Closed</th> <th>Amount</th> </tr> </thead> <tbody> <tr> <td colspan="5"> </td> </tr> </tbody> </table>					Number	Description	Opened	Closed	Amount																																																																																																											
Number	Description	Opened	Closed	Amount																																																																																																																					
Exemptions <table border="1"> <thead> <tr> <th>Code</th> <th>Type</th> <th>Active</th> <th>Maximum</th> <th>Exemption</th> </tr> </thead> <tbody> <tr> <td colspan="5"> </td> </tr> </tbody> </table>					Code	Type	Active	Maximum	Exemption						Sale History <table border="1"> <thead> <tr> <th>Bk/Pg</th> <th>Grantor</th> <th>Date</th> <th>Price</th> <th>Code</th> </tr> </thead> <tbody> <tr> <td>/</td> <td>BROWN, WILLIAM RUSSELL III &</td> <td>08/28/2020</td> <td>125,000</td> <td>4</td> </tr> <tr> <td>2520/853</td> <td>BROWN, WILLIAM RUSSELL III &</td> <td>01/04/2016</td> <td></td> <td>6</td> </tr> <tr> <td>2438/161</td> <td>BATES, LINDA K TRUSTEE</td> <td>11/12/2014</td> <td>0</td> <td>4</td> </tr> <tr> <td>2248/231</td> <td>COPELAND, GENE &</td> <td>06/01/2012</td> <td>0</td> <td>4</td> </tr> <tr> <td>2520/708</td> <td>EISENHAUER-BROWN, KATHY JEAN</td> <td></td> <td></td> <td>4</td> </tr> </tbody> </table>					Bk/Pg	Grantor	Date	Price	Code	/	BROWN, WILLIAM RUSSELL III &	08/28/2020	125,000	4	2520/853	BROWN, WILLIAM RUSSELL III &	01/04/2016		6	2438/161	BATES, LINDA K TRUSTEE	11/12/2014	0	4	2248/231	COPELAND, GENE &	06/01/2012	0	4	2520/708	EISENHAUER-BROWN, KATHY JEAN			4																																																																								
Code	Type	Active	Maximum	Exemption																																																																																																																					
Bk/Pg	Grantor	Date	Price	Code																																																																																																																					
/	BROWN, WILLIAM RUSSELL III &	08/28/2020	125,000	4																																																																																																																					
2520/853	BROWN, WILLIAM RUSSELL III &	01/04/2016		6																																																																																																																					
2438/161	BATES, LINDA K TRUSTEE	11/12/2014	0	4																																																																																																																					
2248/231	COPELAND, GENE &	06/01/2012	0	4																																																																																																																					
2520/708	EISENHAUER-BROWN, KATHY JEAN			4																																																																																																																					
Parcel Valuation <table border="1"> <thead> <tr> <th>Source</th> <th>REAL</th> <th>Fair Cash</th> <th>Capped</th> <th>Asmnt Level</th> <th>Assessed</th> <th>Levy Rate</th> <th>82.750</th> <th>Current Tax</th> </tr> </thead> <tbody> <tr> <td>Remove Cap</td> <td></td> <td>Land Value 10,642</td> <td>10,642</td> <td>11%</td> <td>1,171</td> <td>Assessed</td> <td>14,090</td> <td>1,165.95</td> </tr> <tr> <td>Year Frozen</td> <td></td> <td>Improvements 138,682</td> <td>117,446</td> <td></td> <td>12,919</td> <td>Penalty</td> <td>0</td> <td></td> </tr> <tr> <td>Uncapped Value</td> <td>0</td> <td>Mobile Home 0</td> <td>0</td> <td></td> <td>0</td> <td>Exemption</td> <td>0</td> <td>0.00</td> </tr> <tr> <td>TIF Project ID</td> <td>0</td> <td>Total Value 149,324</td> <td>128,088</td> <td></td> <td>14,090</td> <td>Total Taxable</td> <td>14,090</td> <td>1,166.00</td> </tr> </tbody> </table>										Source	REAL	Fair Cash	Capped	Asmnt Level	Assessed	Levy Rate	82.750	Current Tax	Remove Cap		Land Value 10,642	10,642	11%	1,171	Assessed	14,090	1,165.95	Year Frozen		Improvements 138,682	117,446		12,919	Penalty	0		Uncapped Value	0	Mobile Home 0	0		0	Exemption	0	0.00	TIF Project ID	0	Total Value 149,324	128,088		14,090	Total Taxable	14,090	1,166.00																																																																			
Source	REAL	Fair Cash	Capped	Asmnt Level	Assessed	Levy Rate	82.750	Current Tax																																																																																																																	
Remove Cap		Land Value 10,642	10,642	11%	1,171	Assessed	14,090	1,165.95																																																																																																																	
Year Frozen		Improvements 138,682	117,446		12,919	Penalty	0																																																																																																																		
Uncapped Value	0	Mobile Home 0	0		0	Exemption	0	0.00																																																																																																																	
TIF Project ID	0	Total Value 149,324	128,088		14,090	Total Taxable	14,090	1,166.00																																																																																																																	
Assessment History <table border="1"> <thead> <tr> <th>Tax Year</th> <th>Statement Number</th> <th>Billed Owner</th> <th>Tax Area</th> <th>Total Value</th> <th>Exemptions</th> <th>Taxable Value</th> <th>Billed Tax</th> </tr> </thead> <tbody> <tr><td>2025</td><td>2025-660008309</td><td>EISENHAUER, DAVID EDWARD &</td><td>14</td><td>128,689</td><td>0</td><td>13,680</td><td>1,132.00</td></tr> <tr><td>2024</td><td>2024-660008309</td><td>EISENHAUER, DAVID EDWARD &</td><td>14</td><td>135,650</td><td>0</td><td>13,282</td><td>1,121.00</td></tr> <tr><td>2023</td><td>2023-660008309</td><td>EISENHAUER, DAVID EDWARD &</td><td>14</td><td>117,220</td><td>0</td><td>12,895</td><td>1,099.00</td></tr> <tr><td>2022</td><td>2022-660008309</td><td>EISENHAUER, DAVID EDWARD &</td><td>14</td><td>115,120</td><td>0</td><td>12,622</td><td>1,068.00</td></tr> <tr><td>2021</td><td>2021-660008309</td><td>EISENHAUER, DAVID EDWARD &</td><td>14</td><td>126,357</td><td>0</td><td>12,255</td><td>1,039.00</td></tr> <tr><td>2020</td><td>2020-660008309</td><td>BROWN, WILLIAM RUSSELL III &</td><td>14</td><td>108,158</td><td>0</td><td>11,898</td><td>1,009.00</td></tr> <tr><td>2019</td><td>2019-660008309</td><td>BROWN, WILLIAM RUSSELL III &</td><td>14</td><td>107,803</td><td>0</td><td>11,859</td><td>1,018.00</td></tr> <tr><td>2018</td><td>2018-660008309</td><td>BROWN, WILLIAM RUSSELL III &</td><td>14</td><td>117,538</td><td>0</td><td>11,744</td><td>1,003.00</td></tr> <tr><td>2017</td><td>2017-660008309</td><td>BROWN, WILLIAM RUSSELL III &</td><td>14</td><td>113,042</td><td>0</td><td>11,402</td><td>978.00</td></tr> <tr><td>2016</td><td>2016-660008309</td><td>BROWN, WILLIAM RUSSELL III &</td><td>14</td><td>114,009</td><td>0</td><td>11,070</td><td>965.00</td></tr> <tr><td>2015</td><td>2015-660008309</td><td>BATES, LINDA K TRUSTEE</td><td>14</td><td>127,337</td><td>0</td><td>11,799</td><td>1,016.00</td></tr> <tr><td>2014</td><td>2014-660008309</td><td>BATES, LINDA K TRUSTEE</td><td>14</td><td>128,341</td><td>0</td><td>11,455</td><td>1,020.00</td></tr> <tr><td>2013</td><td>2013-660008309</td><td>BATES, LINDA K TRUSTEE</td><td>14</td><td>127,809</td><td>0</td><td>11,121</td><td>987.00</td></tr> </tbody> </table>										Tax Year	Statement Number	Billed Owner	Tax Area	Total Value	Exemptions	Taxable Value	Billed Tax	2025	2025-660008309	EISENHAUER, DAVID EDWARD &	14	128,689	0	13,680	1,132.00	2024	2024-660008309	EISENHAUER, DAVID EDWARD &	14	135,650	0	13,282	1,121.00	2023	2023-660008309	EISENHAUER, DAVID EDWARD &	14	117,220	0	12,895	1,099.00	2022	2022-660008309	EISENHAUER, DAVID EDWARD &	14	115,120	0	12,622	1,068.00	2021	2021-660008309	EISENHAUER, DAVID EDWARD &	14	126,357	0	12,255	1,039.00	2020	2020-660008309	BROWN, WILLIAM RUSSELL III &	14	108,158	0	11,898	1,009.00	2019	2019-660008309	BROWN, WILLIAM RUSSELL III &	14	107,803	0	11,859	1,018.00	2018	2018-660008309	BROWN, WILLIAM RUSSELL III &	14	117,538	0	11,744	1,003.00	2017	2017-660008309	BROWN, WILLIAM RUSSELL III &	14	113,042	0	11,402	978.00	2016	2016-660008309	BROWN, WILLIAM RUSSELL III &	14	114,009	0	11,070	965.00	2015	2015-660008309	BATES, LINDA K TRUSTEE	14	127,337	0	11,799	1,016.00	2014	2014-660008309	BATES, LINDA K TRUSTEE	14	128,341	0	11,455	1,020.00	2013	2013-660008309	BATES, LINDA K TRUSTEE	14	127,809	0	11,121	987.00
Tax Year	Statement Number	Billed Owner	Tax Area	Total Value	Exemptions	Taxable Value	Billed Tax																																																																																																																		
2025	2025-660008309	EISENHAUER, DAVID EDWARD &	14	128,689	0	13,680	1,132.00																																																																																																																		
2024	2024-660008309	EISENHAUER, DAVID EDWARD &	14	135,650	0	13,282	1,121.00																																																																																																																		
2023	2023-660008309	EISENHAUER, DAVID EDWARD &	14	117,220	0	12,895	1,099.00																																																																																																																		
2022	2022-660008309	EISENHAUER, DAVID EDWARD &	14	115,120	0	12,622	1,068.00																																																																																																																		
2021	2021-660008309	EISENHAUER, DAVID EDWARD &	14	126,357	0	12,255	1,039.00																																																																																																																		
2020	2020-660008309	BROWN, WILLIAM RUSSELL III &	14	108,158	0	11,898	1,009.00																																																																																																																		
2019	2019-660008309	BROWN, WILLIAM RUSSELL III &	14	107,803	0	11,859	1,018.00																																																																																																																		
2018	2018-660008309	BROWN, WILLIAM RUSSELL III &	14	117,538	0	11,744	1,003.00																																																																																																																		
2017	2017-660008309	BROWN, WILLIAM RUSSELL III &	14	113,042	0	11,402	978.00																																																																																																																		
2016	2016-660008309	BROWN, WILLIAM RUSSELL III &	14	114,009	0	11,070	965.00																																																																																																																		
2015	2015-660008309	BATES, LINDA K TRUSTEE	14	127,337	0	11,799	1,016.00																																																																																																																		
2014	2014-660008309	BATES, LINDA K TRUSTEE	14	128,341	0	11,455	1,020.00																																																																																																																		
2013	2013-660008309	BATES, LINDA K TRUSTEE	14	127,809	0	11,121	987.00																																																																																																																		



Rogers

Assessment Property Record Card for Tax Year 2026

Data provided by LISA DELOZIER County Assessor

Date 04/17/2026
 Time 02:59:07
 Page 2

Lot Data	Primary Image
Lot Size Lot Count Units Buildable Non-Ag Acres 0 Topography Street Access Utilities Amenities LAND QUALITY Method Base Lot Value Factor Value Adjustments Lot Value	

Residential Data	
Type	1 Single Family Residence
Condition	3 - Average
Quality	3 - Average
Architecture	
Style	100% One Story
Exterior Wall	100% Veneer, Masonry
Base/Total Area	2,146 / 2,146
Style	100% One Story
HVAC	100% Warmed & Cooled Air
Roof Cover	4 Metal, Preformed
Area on Slab	2,146
Fixture/RghIn	7 /
Bed/F/H Bath	3 / 1.5 /
Basement Area	
Garage Type	580 Carport - Gable Roof
Remodel	
Year/Eff Age	1967 / 44

660008309_001.JPG	5/13/2025
-------------------	-----------

GRM Approach	
GRM Code	
Gross Rent	0.00
Indicated Value	

Multiple Regression	
MRA Code	
Adjusted R	
Indicated Value	

Direct Comparables	
Selection Model	1 Res
Adjustment Model	A2 AO Test
Comparables	
Indicated Value	

Cost Approach				Manual : 01/2025	
Base Cost	97.16	Total Misc Impr	+	10,525	
Roofing Adj	+ 4.97	Garage Cost	+	5,593	
Subfloor Adj	+ -2.11	Total RCN	=	267,286	
Heat/Cool Adj	+ 12.39	Depreciation (49%)	-	130,970	
Plumbing Adj	+ 4.64	Lump Sums	+	0	
Basement Adj	+ 0.00	RCNLD	=	136,316	
Adj Base Cost	= 117.04	Lot Value	+		
Total Area	x 2,146	Indicated Value	=	136,316	
Adjusted Cost	= 251,168	Value Per SqFt		63.52	

Value Reconciliation			
Selected Approach	Cost Approach		
Improvements	136,316		
Lot Value			
Indicated Value	136,316	63.52	Per SqFt
Agland Value	10,642		
Site Improvements	2,366		
Total Value	149,324	69.58	Total Value Per SqFt

Miscellaneous Improvements								
Code	Description	Sketch ID	Size	Year	Units	Unit Cost	Depr	Value
PRCH	SLAB PORCH - COVERED	19476	8x4		32	26.29		841
PRCH	SLAB PORCH - COVERED	19477	32x12		384	25.22		9,684



Rogers

Assessment Property Record Card for Tax Year 2026

Data provided by LISA DELOZIER County Assessor

Date 04/17/2026

Time 02:59:07

Page 3

Sketch Image

660008309

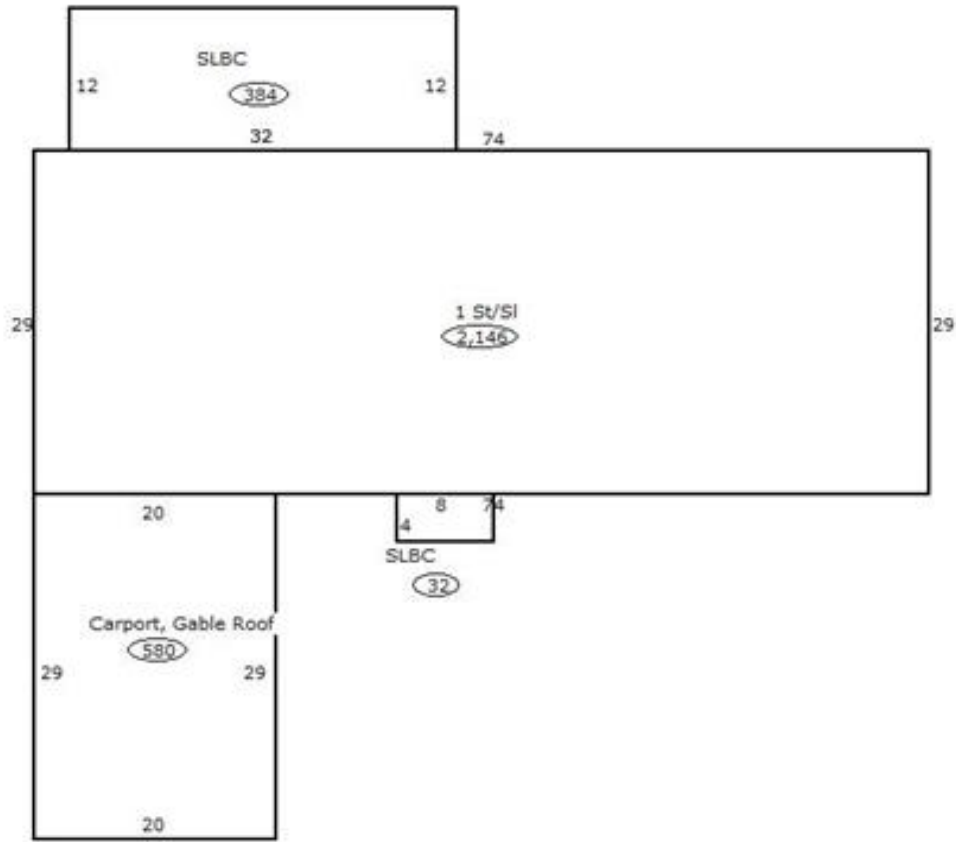

Sketch Vector Information

Sequence	Code	Type	Built Over	Scale	Section Label	Base Area	Multiplier	Total Area
1	M	PRCH		13	SLBC	32	1.000	32
2	M	PRCH		13	SLBC	384	1.000	384
3	G	3		13	Carport, Gable Roof	580	1.000	580
4	R	1	Slab	13	1 St/SI	2,146	1.000	2,146
Total Building Area						2,146		2,146



Rogers

Assessment Property Record Card for Tax Year 2026

Data provided by LISA DELOZIER County Assessor

Date 04/17/2026
Time 02:59:07
Page 4

660008309

Outbuildings/Site Improvements

Building Image	Code	Description	Dimensions	Floor	Roofing	Total Units
	BARN	BARN	0x0x0			1,152
	Qual 3	Cond 3	Year		Eff Age	
Valuation Summary		Modifier Total	RCN	Depr (80% Phys/ % Func)	RCNLD	
Base Cost (10.27 x 1,152)		11,831		11,831	9,465	2,366
	LF	LOAFING SHED	0x0x0			884
	Qual 3	Cond 3	Year		Eff Age	
Valuation Summary		Modifier Total	RCN	Depr (100% Phys/ % Func)	RCNLD	
Base Cost (4.26 x 884)		3,766		3,766	3,766	
	LF	LOAFING SHED	0x0x0			988
	Qual 3	Cond 3	Year		Eff Age	
Valuation Summary		Modifier Total	RCN	Depr (100% Phys/ % Func)	RCNLD	
Base Cost (4.26 x 988)		4,209		4,209	4,209	
	STF	STG FAIR	0x0x0			
	Qual 2	Cond	Year		Eff Age	
Valuation Summary		Modifier Total	RCN	Depr (0% Phys/ % Func)	RCNLD	
Base Cost (4.68 x)						
	STF	STG FAIR	0x0x0			
	Qual 2	Cond	Year		Eff Age	
Valuation Summary		Modifier Total	RCN	Depr (0% Phys/ % Func)	RCNLD	
Base Cost (4.68 x)						
	STF	STG FAIR	0x0x0			
	Qual 2	Cond	Year		Eff Age	
Valuation Summary		Modifier Total	RCN	Depr (0% Phys/ % Func)	RCNLD	
Base Cost (4.68 x)						



Rogers

Assessment Property Record Card for Tax Year 2026

Data provided by LISA DELOZIER County Assessor

Date 04/17/2026
Time 02:59:07
Page 5

Agland Inventory

660008309

Soi	Description	Land Use	LPI	Adj Type	Adj Code	Acres	Use/Acre	Mkt/Acre	Use Value	Market Value
BC	BATES-COLLINSVILLE COMPLE	NTV PST	51			24.000	122	122	2,938	2,938
BR	BREAKS-ALLUVIAL LAND COMP	NTV PST	30			5.000	72	72	360	360
DBC	DENNIS-BATES COMPLEX 2-5%	NTV PST	60			51.000	144	144	7,344	7,344
NTV PST Totals						80.000			10,642	10,642
Total Agland						80.000			10,642	10,642