



Rogers

Assessment Property Record Card for Tax Year 2026

Data provided by LISA DELOZIER County Assessor

Date 04/18/2026
Time 07:24:17
Page 1

Assessment Data					Primary Image				
Account	660008972								
Parcel ID	000000-00-0-10010-056-0003								
Cadastral ID	09-21-16-04350								
Property Type	REAL - Real Property								
Property Class	UCP	VI Area	1						
Tax Area	17 - CLAREMORE OT								
Name ID	337004								
SWMB LANDCO LLC									
PO BOX 743 CLAREMORE OK 74018-0000									
Parcel Location									
Situs	00504 N LYNN RIGGS BLVD								
Subdivision									
Lot/Block	0000 / 0000	Parcel Size	3 - Lots						
Sec/Twn/Rng	9 / 21 / 16 / 5								
Neighborhood	910010 - CLAREMORE OT								
School District	S001 - CLAREMORE SCHOOLS								
Legal Description Lat/Long: 36.31629255 -95.61316731									
Building Permits									
LOT 3, S 100' LOT 4 & ALL LOT 5 BLOCK 56 CLAREMORE O T									
Number	Description	Opened	Closed	Amount					
R12	ROLL NEW SALE	08/2011	11/2013						
Exemptions									
Code	Type	Active	Maximum	Exemption					
Sale History									
Bk/Pg	Grantor	Date	Price	Code					
/	BROWN & WHITE OPERATING GROUF	01/01/2022	0	4					
/	BROWN, BRETT J &	01/01/2022	0	4					
/	WHITE, SHANNON K &	01/01/2022	0	4					
2588/911	FREEMAN, MICHAEL R &	10/19/2016	3,100,000	WG					
2187/83	TNB ENTERPRISES INC	08/01/2011	912,000	YES					
1947/530	JUST2BROTHERS LLC	03/28/2008	0	YES					
Parcel Valuation									
Source	REAL	Fair Cash	Capped	Asmnt Level	Assessed	Levy Rate	92.430	Current Tax	
Remove Cap	2017	Land Value	235,004	235,004	11%	25,850	Assessed	109,227	10,095.85
Year Frozen	0	Improvements	1,141,617	757,965		83,377	Penalty	0	
Uncapped Value	0	Mobile Home	0	0		0	Exemption	0	0.00
TIF Project ID	0	Total Value	1,376,621	992,969		109,227	Total Taxable	109,227	10,096.00
Assessment History									
Tax Year	Statement Number	Billed Owner	Tax Area	Total Value	Exemptions	Taxable Value	Billed Tax		
2025	2025-660008972	SWMB LANDCO LLC	17	1,391,240	0	104,025	9,615.00		
2024	2024-660008972	SWMB LANDCO LLC	17	900,653	0	99,072	9,156.00		
2023	2023-660008972	SWMB LANDCO LLC	17	1,189,180	0	114,973	10,532.00		
2022	2022-660008972	SWMB LANDCO LLC	17	1,189,052	0	109,499	10,136.00		
2021	2021-660008972	BROWN & WHITE OPERATING GROUP LLC	17	948,040	0	104,284	9,208.00		
2020	2020-660008972	BROWN & WHITE OPERATING GROUP LLC	17	948,040	0	104,284	9,549.00		
2019	2019-660008972	BROWN & WHITE OPERATING GROUP LLC	17	948,040	0	104,284	9,659.00		
2018	2018-660008972	BROWN & WHITE OPERATING GROUP LLC	17	928,881	0	102,177	9,441.00		
2017	2017-660008972	BROWN & WHITE OPERATING GROUP LLC	17	928,881	0	102,177	9,384.00		
2016	2016-660008972	FREEMAN, MICHAEL R &	17	913,997	0	100,540	9,437.00		
2015	2015-660008972	FREEMAN, MICHAEL R &	17	913,997	0	100,540	9,068.00		
2014	2014-660008972	FREEMAN, MICHAEL R &	17	913,997	0	100,540	9,323.00		
2013	2013-660008972	FREEMAN, MICHAEL R &	17	913,997	0	100,540	9,200.00		



Rogers

Assessment Property Record Card for Tax Year 2026

Data provided by LISA DELOZIER County Assessor

Date 04/18/2026

Time 07:24:18

Page 3

Sketch Image

660008972

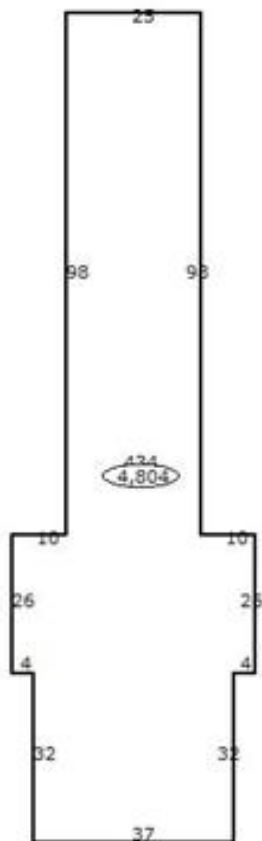

Sketch Vector Information

Sequence	Code	Type	Built Over	Scale	Section Label	Base Area	Multiplier	Total Area
1	C	434		30	434	4,804	1.000	4,804
Total Building Area						4,804		4,804



Rogers

Assessment Property Record Card for Tax Year 2026

Data provided by LISA DELOZIER County Assessor

Date 04/18/2026
Time 07:24:18
Page 4

Account 660008972
Parcel ID 000000-00-0-10010-056-0003
Cadastral ID 09-21-16-04350

Tax Area Code 17
Property Class UCP
Owners Name SWMB LANDCO LLC

Building Data

Building ID 4004
Building Sequence 1
Occupancy 1 434 Car Wash - Self Serve 75%
Occupancy 2 435 Car Wash - Drive Thru 25%
Occupancy 3
Total Floor Area 4,804
Average Perimeter 402
Number Of Storys 1.00
Average Wall Ht 14.00
Year Built 2000
Effective Age 13
Construction Class 3 - Unreinforced Masonry Walls, Wood Joists
Quality 4 - Good
Condition 3 - Average
Exterior Wall 7 - Brick, Solid
Heating/Cooling 15 - No HVAC
Roof Type
Roof Cover Composition Roll

Basement Area
Basement Levels
Basement Finish
Finish Code - 1
Finish Area - 1
Finish Code - 2
Finish Area - 2

Building Image



Image Information

Image Name IMG_0012.JPG
Image Date 4/12/2023
Image Name IMG_0012.JPG
Description REVAL 2024

Cost Calculations

Appraisal Zone 1
Zone Description
Base Cost 72.33
Wall Cost 169.83
HVAC Cost 0.00
Basement Cost 0.00
Total Base Cost 242.16
Total Area 4,804
Base RCN 1,163,337
Misc Impr Value

Manual Date 01/2025
Base Year 2026
Modifier Value
Total Replacement Cost 1,163,337
Physical Depreciation 40%
Functional Depreciation
Total Depreciation 40% (465,335)
Total RCNLD 698,002
Lump Sums
Total Building Value 698,002 \$ 145.30 Per SqFt



Rogers

Assessment Property Record Card for Tax Year 2026

Data provided by LISA DELOZIER County Assessor

Date 04/18/2026

Time 07:24:18

Page 5

660008972

Outbuildings/Site Improvements

Building Image	Code	Description	Dimensions	Floor	Roofing	Total Units
	FLV	ROBOS (2)	0x0x0			120,850
	Qual	Cond	Year	Eff Age		
		Valuation Summary	Modifier Total	RCN	Depr (% Phys/ % Func)	RCNLD
		Base Cost (1.00 x 120,850)		120,850	18,128	102,722
	FLV	BLOWERS (4)	0x0x0			106,600
	Qual	Cond	Year	Eff Age		
		Valuation Summary	Modifier Total	RCN	Depr (% Phys/ % Func)	RCNLD
		Base Cost (1.00 x 106,600)		106,600	15,990	90,610
	FLV	SELF WASH ASSEMBLY (6)	0x0x0			109,200
	Qual	Cond	Year	Eff Age		
		Valuation Summary	Modifier Total	RCN	Depr (% Phys/ % Func)	RCNLD
		Base Cost (1.00 x 109,200)		109,200	16,380	92,820
	FLV	ADD PER BAY (6)	0x0x0			51,000
	Qual	Cond	Year	Eff Age		
		Valuation Summary	Modifier Total	RCN	Depr (% Phys/ % Func)	RCNLD
		Base Cost (1.00 x 51,000)		51,000	7,650	43,350
	FLV	VACUUMS (4)	0x0x0			7,040
	Qual	Cond	Year	Eff Age		
		Valuation Summary	Modifier Total	RCN	Depr (% Phys/ % Func)	RCNLD
		Base Cost (1.00 x 7,040)		7,040	1,056	5,984
	FLV	CHANGE MACHINE (2)	0x0x0			11,000
	Qual	Cond	Year	Eff Age		
		Valuation Summary	Modifier Total	RCN	Depr (% Phys/ % Func)	RCNLD
		Base Cost (1.00 x 11,000)		11,000	1,650	9,350
	FLV	VENDING MACHINE (1)	0x0x0			660
	Qual	Cond	Year	Eff Age		
		Valuation Summary	Modifier Total	RCN	Depr (% Phys/ % Func)	RCNLD
		Base Cost (1.00 x 660)		660	66	594



Rogers

Assessment Property Record Card for Tax Year 2026

Data provided by LISA DELOZIER County Assessor

Date 04/18/2026
Time 07:24:18
Page 6

FLV	SIGN POLE 6" 1@26'		0x0x0			1,924
Qual	Cond	Year	Eff Age			

Valuation Summary	Modifier Total	RCN	Depr (% Phys/ % Func)	RCNLD
Base Cost (1.00 x 1,924)		1,924	192	1,732

FLV	SIGN DFPI-20SF		0x0x0			3,720
Qual	Cond	Year	Eff Age			

Valuation Summary	Modifier Total	RCN	Depr (% Phys/ % Func)	RCNLD
Base Cost (1.00 x 3,720)		3,720	781	2,939

FLV	SIGN DFPI-6SF		0x0x0			1,350
Qual	Cond	Year	Eff Age			

Valuation Summary	Modifier Total	RCN	Depr (% Phys/ % Func)	RCNLD
Base Cost (1.00 x 1,350)		1,350	284	1,066

FLV	CONC PAVING 24774SF		0x0x0			95,628
Qual	Cond	Year	Eff Age			

Valuation Summary	Modifier Total	RCN	Depr (% Phys/ % Func)	RCNLD
Base Cost (1.00 x 95,628)		95,628	4,781	90,847

FLV	WFX6 232'		0x0x0			5,336
Qual	Cond	Year	Eff Age			

Valuation Summary	Modifier Total	RCN	Depr (% Phys/ % Func)	RCNLD
Base Cost (1.00 x 5,336)		5,336	3,735	1,601

Total Site Improvement Value	443,615
-------------------------------------	----------------