



Rogers

Assessment Property Record Card for Tax Year 2026

Data provided by LISA DELOZIER County Assessor

Date 04/18/2026
Time 07:28:02
Page 1

Assessment Data					Primary Image																																																																																																																				
Account 660009068 Parcel ID 000000-00-0-10010-071-0001 Cadastral ID 09-21-16-05360 Property Type REAL - Real Property Property Class URP VI Area 1 Tax Area 17 - CLAREMORE OT Name ID 311289 TOWNSEND, ROBERT & SHERRY 411 E 7TH ST CLAREMORE OK 74017-0000 Parcel Location Situs 00411 E 7TH ST N Subdivision CLAREMORE O T Lot/Block 0001 / 0071 Parcel Size .5 - Lots Sec/Twn/Rng 9 / 21 / 16 / 5 Neighborhood 1177 - R-V01-SW CLAREMORE School District S001 - CLAREMORE SCHOOLS																																																																																																																									
Legal Description Lat/Long: 36.31200179 -95.60419757 E 45' LOT 1 BLOCK 71 CLAREMORE O T																																																																																																																									
Exemptions <table border="1"> <thead> <tr> <th>Code</th> <th>Type</th> <th>Active</th> <th>Maximum</th> <th>Exemption</th> </tr> </thead> <tbody> <tr> <td>H</td> <td>Homestead</td> <td>Yes</td> <td>1,000</td> <td>1,000</td> </tr> </tbody> </table>					Code	Type	Active	Maximum	Exemption	H	Homestead	Yes	1,000	1,000	Building Permits <table border="1"> <thead> <tr> <th>Number</th> <th>Description</th> <th>Opened</th> <th>Closed</th> <th>Amount</th> </tr> </thead> <tbody> <tr> <td></td> <td></td> <td></td> <td></td> <td></td> </tr> </tbody> </table>					Number	Description	Opened	Closed	Amount																																																																																																	
Code	Type	Active	Maximum	Exemption																																																																																																																					
H	Homestead	Yes	1,000	1,000																																																																																																																					
Number	Description	Opened	Closed	Amount																																																																																																																					
Parcel Valuation <table border="1"> <thead> <tr> <th>Source</th> <th>REAL</th> <th>Fair Cash</th> <th>Capped</th> <th>Asmnt Level</th> <th>Assessed</th> <th>Levy Rate</th> <th>92.430</th> <th>Current Tax</th> </tr> </thead> <tbody> <tr> <td>Remove Cap</td> <td>2014</td> <td>Land Value</td> <td>23,286</td> <td>21,530</td> <td>11%</td> <td>2,368</td> <td>Assessed</td> <td>630.74</td> </tr> <tr> <td>Year Frozen</td> <td>0</td> <td>Improvements</td> <td>40,504</td> <td>40,504</td> <td></td> <td>4,456</td> <td>Penalty</td> <td>0</td> </tr> <tr> <td>Uncapped Value</td> <td>0</td> <td>Mobile Home</td> <td>0</td> <td>0</td> <td></td> <td>0</td> <td>Exemption</td> <td>-93.00</td> </tr> <tr> <td>TIF Project ID</td> <td>0</td> <td>Total Value</td> <td>63,790</td> <td>62,034</td> <td></td> <td>6,824</td> <td>Total Taxable</td> <td>538.00</td> </tr> </tbody> </table>					Source	REAL	Fair Cash	Capped	Asmnt Level	Assessed	Levy Rate	92.430	Current Tax	Remove Cap	2014	Land Value	23,286	21,530	11%	2,368	Assessed	630.74	Year Frozen	0	Improvements	40,504	40,504		4,456	Penalty	0	Uncapped Value	0	Mobile Home	0	0		0	Exemption	-93.00	TIF Project ID	0	Total Value	63,790	62,034		6,824	Total Taxable	538.00	Sale History <table border="1"> <thead> <tr> <th>Bk/Pg</th> <th>Grantor</th> <th>Date</th> <th>Price</th> <th>Code</th> </tr> </thead> <tbody> <tr> <td>2373/871</td> <td>DEUTSCHE BANK TRUST CO AMERIC.</td> <td>11/25/2013</td> <td>43,000</td> <td>3</td> </tr> <tr> <td>2353/586</td> <td>ALLISON, JAMES W & MICHELE</td> <td>08/22/2013</td> <td>0</td> <td>10</td> </tr> <tr> <td>2190/674</td> <td>ALLISON, SHARON K</td> <td>08/29/2011</td> <td>0</td> <td>4</td> </tr> <tr> <td>1325/322</td> <td>RUSSELL, ELVIS MARGUERITE</td> <td>10/16/2001</td> <td>45,500</td> <td>YES</td> </tr> <tr> <td>1313/452</td> <td>BRADFIELD, JAMES W &</td> <td>07/30/2001</td> <td>0</td> <td>YES</td> </tr> </tbody> </table>					Bk/Pg	Grantor	Date	Price	Code	2373/871	DEUTSCHE BANK TRUST CO AMERIC.	11/25/2013	43,000	3	2353/586	ALLISON, JAMES W & MICHELE	08/22/2013	0	10	2190/674	ALLISON, SHARON K	08/29/2011	0	4	1325/322	RUSSELL, ELVIS MARGUERITE	10/16/2001	45,500	YES	1313/452	BRADFIELD, JAMES W &	07/30/2001	0	YES																																					
Source	REAL	Fair Cash	Capped	Asmnt Level	Assessed	Levy Rate	92.430	Current Tax																																																																																																																	
Remove Cap	2014	Land Value	23,286	21,530	11%	2,368	Assessed	630.74																																																																																																																	
Year Frozen	0	Improvements	40,504	40,504		4,456	Penalty	0																																																																																																																	
Uncapped Value	0	Mobile Home	0	0		0	Exemption	-93.00																																																																																																																	
TIF Project ID	0	Total Value	63,790	62,034		6,824	Total Taxable	538.00																																																																																																																	
Bk/Pg	Grantor	Date	Price	Code																																																																																																																					
2373/871	DEUTSCHE BANK TRUST CO AMERIC.	11/25/2013	43,000	3																																																																																																																					
2353/586	ALLISON, JAMES W & MICHELE	08/22/2013	0	10																																																																																																																					
2190/674	ALLISON, SHARON K	08/29/2011	0	4																																																																																																																					
1325/322	RUSSELL, ELVIS MARGUERITE	10/16/2001	45,500	YES																																																																																																																					
1313/452	BRADFIELD, JAMES W &	07/30/2001	0	YES																																																																																																																					
Assessment History <table border="1"> <thead> <tr> <th>Tax Year</th> <th>Statement Number</th> <th>Billed Owner</th> <th>Tax Area</th> <th>Total Value</th> <th>Exemptions</th> <th>Taxable Value</th> <th>Billed Tax</th> </tr> </thead> <tbody> <tr> <td>2025</td> <td>2025-660009068</td> <td>TOWNSEND, ROBERT & SHERRY</td> <td>17</td> <td>63,461</td> <td>1000</td> <td>5,626</td> <td>520.00</td> </tr> <tr> <td>2024</td> <td>2024-660009068</td> <td>TOWNSEND, ROBERT & SHERRY</td> <td>17</td> <td>61,996</td> <td>1000</td> <td>5,433</td> <td>502.00</td> </tr> <tr> <td>2023</td> <td>2023-660009068</td> <td>TOWNSEND, ROBERT & SHERRY</td> <td>17</td> <td>61,337</td> <td>1000</td> <td>5,245</td> <td>480.00</td> </tr> <tr> <td>2022</td> <td>2022-660009068</td> <td>TOWNSEND, ROBERT & SHERRY</td> <td>17</td> <td>55,775</td> <td>1000</td> <td>5,063</td> <td>469.00</td> </tr> <tr> <td>2021</td> <td>2021-660009068</td> <td>TOWNSEND, ROBERT & SHERRY</td> <td>17</td> <td>55,867</td> <td>1000</td> <td>4,886</td> <td>431.00</td> </tr> <tr> <td>2020</td> <td>2020-660009068</td> <td>TOWNSEND, ROBERT & SHERRY</td> <td>17</td> <td>51,955</td> <td>1000</td> <td>4,715</td> <td>432.00</td> </tr> <tr> <td>2019</td> <td>2019-660009068</td> <td>TOWNSEND, ROBERT & SHERRY</td> <td>17</td> <td>50,756</td> <td>1000</td> <td>4,583</td> <td>424.00</td> </tr> <tr> <td>2018</td> <td>2018-660009068</td> <td>TOWNSEND, ROBERT & SHERRY</td> <td>17</td> <td>53,575</td> <td>1000</td> <td>4,893</td> <td>452.00</td> </tr> <tr> <td>2017</td> <td>2017-660009068</td> <td>TOWNSEND, ROBERT & SHERRY</td> <td>17</td> <td>53,086</td> <td>1000</td> <td>4,839</td> <td>444.00</td> </tr> <tr> <td>2016</td> <td>2016-660009068</td> <td>TOWNSEND, ROBERT & SHERRY</td> <td>17</td> <td>51,875</td> <td>1000</td> <td>4,706</td> <td>442.00</td> </tr> <tr> <td>2015</td> <td>2015-660009068</td> <td>TOWNSEND, ROBERT & SHERRY</td> <td>17</td> <td>51,304</td> <td>1000</td> <td>4,643</td> <td>419.00</td> </tr> <tr> <td>2014</td> <td>2014-660009068</td> <td>TOWNSEND, ROBERT & SHERRY</td> <td>17</td> <td>51,705</td> <td>1000</td> <td>4,688</td> <td>435.00</td> </tr> <tr> <td>2013</td> <td>2013-660009068</td> <td>DEUTSCHE BANK TRUST CO AMERICAS</td> <td>17</td> <td>50,060</td> <td>0</td> <td>5,334</td> <td>488.00</td> </tr> </tbody> </table>										Tax Year	Statement Number	Billed Owner	Tax Area	Total Value	Exemptions	Taxable Value	Billed Tax	2025	2025-660009068	TOWNSEND, ROBERT & SHERRY	17	63,461	1000	5,626	520.00	2024	2024-660009068	TOWNSEND, ROBERT & SHERRY	17	61,996	1000	5,433	502.00	2023	2023-660009068	TOWNSEND, ROBERT & SHERRY	17	61,337	1000	5,245	480.00	2022	2022-660009068	TOWNSEND, ROBERT & SHERRY	17	55,775	1000	5,063	469.00	2021	2021-660009068	TOWNSEND, ROBERT & SHERRY	17	55,867	1000	4,886	431.00	2020	2020-660009068	TOWNSEND, ROBERT & SHERRY	17	51,955	1000	4,715	432.00	2019	2019-660009068	TOWNSEND, ROBERT & SHERRY	17	50,756	1000	4,583	424.00	2018	2018-660009068	TOWNSEND, ROBERT & SHERRY	17	53,575	1000	4,893	452.00	2017	2017-660009068	TOWNSEND, ROBERT & SHERRY	17	53,086	1000	4,839	444.00	2016	2016-660009068	TOWNSEND, ROBERT & SHERRY	17	51,875	1000	4,706	442.00	2015	2015-660009068	TOWNSEND, ROBERT & SHERRY	17	51,304	1000	4,643	419.00	2014	2014-660009068	TOWNSEND, ROBERT & SHERRY	17	51,705	1000	4,688	435.00	2013	2013-660009068	DEUTSCHE BANK TRUST CO AMERICAS	17	50,060	0	5,334	488.00
Tax Year	Statement Number	Billed Owner	Tax Area	Total Value	Exemptions	Taxable Value	Billed Tax																																																																																																																		
2025	2025-660009068	TOWNSEND, ROBERT & SHERRY	17	63,461	1000	5,626	520.00																																																																																																																		
2024	2024-660009068	TOWNSEND, ROBERT & SHERRY	17	61,996	1000	5,433	502.00																																																																																																																		
2023	2023-660009068	TOWNSEND, ROBERT & SHERRY	17	61,337	1000	5,245	480.00																																																																																																																		
2022	2022-660009068	TOWNSEND, ROBERT & SHERRY	17	55,775	1000	5,063	469.00																																																																																																																		
2021	2021-660009068	TOWNSEND, ROBERT & SHERRY	17	55,867	1000	4,886	431.00																																																																																																																		
2020	2020-660009068	TOWNSEND, ROBERT & SHERRY	17	51,955	1000	4,715	432.00																																																																																																																		
2019	2019-660009068	TOWNSEND, ROBERT & SHERRY	17	50,756	1000	4,583	424.00																																																																																																																		
2018	2018-660009068	TOWNSEND, ROBERT & SHERRY	17	53,575	1000	4,893	452.00																																																																																																																		
2017	2017-660009068	TOWNSEND, ROBERT & SHERRY	17	53,086	1000	4,839	444.00																																																																																																																		
2016	2016-660009068	TOWNSEND, ROBERT & SHERRY	17	51,875	1000	4,706	442.00																																																																																																																		
2015	2015-660009068	TOWNSEND, ROBERT & SHERRY	17	51,304	1000	4,643	419.00																																																																																																																		
2014	2014-660009068	TOWNSEND, ROBERT & SHERRY	17	51,705	1000	4,688	435.00																																																																																																																		
2013	2013-660009068	DEUTSCHE BANK TRUST CO AMERICAS	17	50,060	0	5,334	488.00																																																																																																																		



Rogers

Assessment Property Record Card for Tax Year 2026

Data provided by LISA DELOZIER County Assessor

Date 04/18/2026
Time 07:28:02
Page 2

Lot Data	Square-Foot - NBHD 1177 #1	Primary Image
Lot Size Lot Count Units Buildable 6300 Non-Ag Acres 0.1408 Topography Street Access Utilities Amenities LAND QUALITY Method Square-Foot Base Lot Value 6,133.00 x 3.80 = 23,286 Factor Value Adjustments Lot Value 23,286		

Residential Data	
Type	1 Single Family Residence
Condition	3 - Average
Quality	1.5 - Low
Architecture	R3 Res Nbhd 3
Style	100% One Story
Exterior Wall	100% Frame, Siding, Wood
Base/Total Area	864 / 864
Style	100% One Story
HVAC	100% Wall Furnace
Roof Cover	1 Composition Shingle
Area on Slab	0
Fixture/RghIn	4 /
Bed/F/H Bath	2 / 1.0 /
Basement Area	
Garage Type	
Remodel	
Year/Eff Age	1960 / 50

\\tsclient\T\LOGAN\LOGAN RESIDENTIAL VI\2023-6-6\IMG_0036. 6/6/2023

GRM Approach	
GRM Code	
Gross Rent	0.00
Indicated Value	

Multiple Regression			
MRA Code	1	Test	
Adjusted R	0.8445		
Indicated Value	43,941	50.86	Per SqFt

Direct Comparables			
Selection Model	A	Adam Test	
Adjustment Model	1	2022 Residential	
Comparables	8		
Indicated Value	91,330		Per SqFt

Cost Approach				Manual : 01/2025			
Base Cost	92.39	Total Misc Impr	+	1,135			
Roofing Adj	+ 4.24	Garage Cost	+				
Subfloor Adj	+ 2.52	Total RCN	=	92,235			
Heat/Cool Adj	+ 0.73	Depreciation (59%)	-	54,419			
Plumbing Adj	+ 5.56	Lump Sums	+	0			
Basement Adj	+ 0.00	RCNLD	=	37,816			
Adj Base Cost	= 105.44	Lot Value	+	23,286			
Total Area	x 864	Indicated Value	=	61,102			
Adjusted Cost	= 91,100	Value Per SqFt		70.72			

Value Reconciliation			
Selected Approach	Cost Approach		
Improvements	37,816		
Lot Value	23,286		
Indicated Value	61,102	70.72	Per SqFt
Agland Value			
Site Improvements	2,688		
Total Value	63,790	73.83	Total Value Per SqFt

Miscellaneous Improvements								
Code	Description	Sketch ID	Size	Year	Units	Unit Cost	Depr	Value
PRCH	SLAB PORCH - COVERED	21147	8x6		48	20.41		980
PATO	SLAB PORCH - OPEN	144745	4x4		16	9.69		155



Rogers

Assessment Property Record Card for Tax Year 2026

Data provided by LISA DELOZIER County Assessor

Date 04/18/2026

Time 07:28:02

Page 3

Sketch Image

660009068

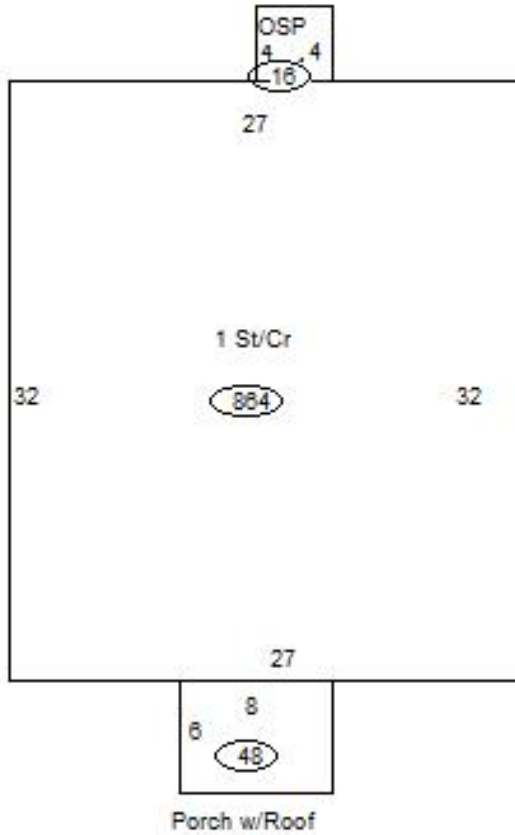

Sketch Vector Information

Sequence	Code	Type	Built Over	Scale	Section Label	Base Area	Multiplier	Total Area
1	R	1	Crawl	13	1 St/Cr	864	1.000	864
2	M	PRCH		13	SLBC	48	1.000	48
3	M	PATO		13	Open Slab	16	1.000	16
Total Building Area						864		864



Rogers

Assessment Property Record Card for Tax Year 2026

Data provided by LISA DELOZIER County Assessor

Date 04/18/2026
Time 07:28:03
Page 4

660009068

Outbuildings/Site Improvements

Building Image	Code	Description	Dimensions	Floor	Roofing	Total Units
	DTGF	DETACHED GARAGE FAIR	0x0x0			480
	Qual 2	Cond 3	Year	Eff Age		
Valuation Summary		Modifier Total	RCN	Depr (65% Phys/ % Func)		RCNLD
Base Cost (16.00 x 480)		7,680		7,680	4,992	2,688