



Rogers

Assessment Property Record Card for Tax Year 2026

Data provided by LISA DELOZIER County Assessor

Date 04/18/2026
Time 06:39:09
Page 1

Assessment Data					Primary Image									
Account	660010826													
Parcel ID	000000-00-0-10210-003-0005													
Cadastral ID	10-21-16-06940													
Property Type	REAL - Real Property													
Property Class	URP	VI Area	1											
Tax Area	17 - CLAREMORE OT													
Name ID	345680													
DIXON, JERROD T														
943 E 11TH ST CLAREMORE OK 74017-0000														
Parcel Location														
Situs	00943 E 11TH ST N													
Subdivision	JEAN ANN													
Lot/Block	0005 / 0003	Parcel Size	1 - Lots											
Sec/Twn/Rng	10 / 21 / 16 / 5													
Neighborhood	1162 - R-V01-SW CLAREMORE													
School District	S001 - CLAREMORE SCHOOLS													
Legal Description Lat/Long: 36.31540047 -95.59371305														
Building Permits														
LOT 5 BLOCK 3 JEAN ANN														
<table border="1"> <thead> <tr> <th>Number</th> <th>Description</th> <th>Opened</th> <th>Closed</th> <th>Amount</th> </tr> </thead> <tbody> <tr> <td></td> <td></td> <td></td> <td></td> <td></td> </tr> </tbody> </table>					Number	Description	Opened	Closed	Amount					
Number	Description	Opened	Closed	Amount										
Exemptions														
Sale History														
Code	Type	Active	Maximum	Exemption	Bk/Pg	Grantor	Date	Price	Code					
					/	DIXON, JOSEPH RAY	10/28/2024	150,000	YES					
					/	GLANZ, JUDY M	10/15/2019	120,000	YES					
					2156/618	KIZER, SANDRA LEE &-CAROLYN	01/31/2011	85,000	YES					
					2154/518	BRASSFIELD, MARION RUTH	01/24/2011	0	4					
					876/663	SELLER	03/18/1992	0	No					
					786/541			47,500	No					
Parcel Valuation														
Source	REAL	Fair Cash	Capped	Asmnt Level	Assessed	Levy Rate	92.430	Current Tax						
Remove Cap	2025	Land Value	55,394	55,394	11%	6,093	Assessed	16,983	1,569.74					
Year Frozen	0	Improvements	99,000	99,000		10,890	Penalty	0						
Uncapped Value	0	Mobile Home	0	0		0	Exemption	0	0.00					
TIF Project ID	0	Total Value	154,394	154,394		16,983	Total Taxable	16,983	1,570.00					
Assessment History														
Tax Year	Statement Number	Billed Owner	Tax Area	Total Value	Exemptions	Taxable Value	Billed Tax							
2025	2025-660010826	DIXON, JERROD T	17	151,308	0	16,644	1,538.00							
2024	2024-660010826	DIXON, JOSEPH RAY	17	128,097	0	14,020	1,296.00							
2023	2023-660010826	DIXON, JOSEPH RAY	17	138,740	0	13,353	1,223.00							
2022	2022-660010826	DIXON, JOSEPH RAY	17	115,611	0	12,717	1,177.00							
2021	2021-660010826	DIXON, JOSEPH RAY	17	122,572	0	13,483	1,191.00							
2020	2020-660010826	DIXON, JOSEPH RAY	17	120,630	0	13,269	1,215.00							
2019	2019-660010826	GLANZ, JUDY M	17	95,198	0	10,472	970.00							
2018	2018-660010826	GLANZ, JUDY M	17	100,710	0	11,078	1,024.00							
2017	2017-660010826	GLANZ, JUDY M	17	99,925	0	10,992	1,010.00							
2016	2016-660010826	GLANZ, JUDY M	17	97,510	0	10,616	996.00							
2015	2015-660010826	GLANZ, JUDY M	17	94,755	0	10,110	912.00							
2014	2014-660010826	GLANZ, JUDY M	17	95,440	0	9,629	893.00							
2013	2013-660010826	GLANZ, JUDY M	17	83,366	0	9,170	839.00							



Rogers

Assessment Property Record Card for Tax Year 2026

Data provided by LISA DELOZIER County Assessor

Date 04/18/2026
Time 06:39:09
Page 2

Lot Data	Square-Foot - NBHD 1162 #1	Primary Image
Lot Size Lot Count 1 Units Buildable 1 Non-Ag Acres 0.2333 Topography Street Access Utilities Amenities LAND QUALITY 0 0 Method Square-Foot Base Lot Value 10,164.00 x 5.45 = 55,394 Factor Value Adjustments 1.0000 Lot Value 55,394		<p style="text-align: right; color: orange;">06/27/2023</p> <p>\\tsclient\T\LOGAN\LOGAN RESIDENTIAL VI\2023-6-27\IMG_001 6/27/2023</p>

Residential Data	
Type	1 Single Family Residence
Condition	3 - Average
Quality	2 - Fair
Architecture	
Style	100% One Story
Exterior Wall	100% Veneer, Masonry
Base/Total Area	1,271 / 1,271
Style	100% One Story
HVAC	100% Warmed & Cooled Air
Roof Cover	1 Composition Shingle
Area on Slab	0
Fixture/RghIn	11 /
Bed/F/H Bath	3 / 1.5 /
Basement Area	
Garage Type	620 Attached Garage - Unfinished 2 Stalls
Remodel	STANDARD -
Year/Eff Age	1963 / 37

Cost Approach		Manual : 01/2025	
Base Cost	101.08	Total Misc Impr	+ 14,150
Roofing Adj	+ 4.12	Garage Cost	+ 13,814
Subfloor Adj	+ 2.34	Total RCN	= 190,385
Heat/Cool Adj	+ 10.30	Depreciation (48%)	- 91,385
Plumbing Adj	+ 9.95	Lump Sums	+ 0
Basement Adj	+ 0.00	RCNLD	= 99,000
Adj Base Cost	= 127.79	Lot Value	+ 55,394
Total Area	x 1,271	Indicated Value	= 154,394
Adjusted Cost	= 162,421	Value Per SqFt	121.47

GRM Approach	
GRM Code	
Gross Rent	0.00
Indicated Value	
Multiple Regression	
MRA Code	1 Test
Adusted R	0.8445
Indicated Value	129,642 102.00 Per SqFt
Direct Comparables	
Selection Model	A Adam Test
Adjustment Model	1 2022 Residential
Comparables	6
Indicated Value	176,360 Per SqFt
Value Reconciliation	
Selected Approach	Cost Approach
Improvements	99,000
Lot Value	55,394
Indicated Value	154,394 121.47 Per SqFt
Agland Value	
Site Improvements	
Total Value	154,394 121.47 Total Value Per SqFt

Miscellaneous Improvements							
Code	Description	Sketch ID	Size	Year	Units	Unit Cost	Depr Value
FPR1	FIREPLACE - RESIDENTIAL 1 STORY	0		1	1	4,576.55	4,577
PRCH	SLAB PORCH - COVERED	25891	14x4		56	21.12	1,183
PRCH	SLAB PORCH - COVERED	25892	19x10		190	20.70	3,933
CPDT	CARPORT - DETACHED	25893	22x20		440	10.13	4,457



Rogers

Assessment Property Record Card for Tax Year 2026

Data provided by LISA DELOZIER County Assessor

Date 04/18/2026
 Time 06:39:09
 Page 3

Sketch Image

660010826

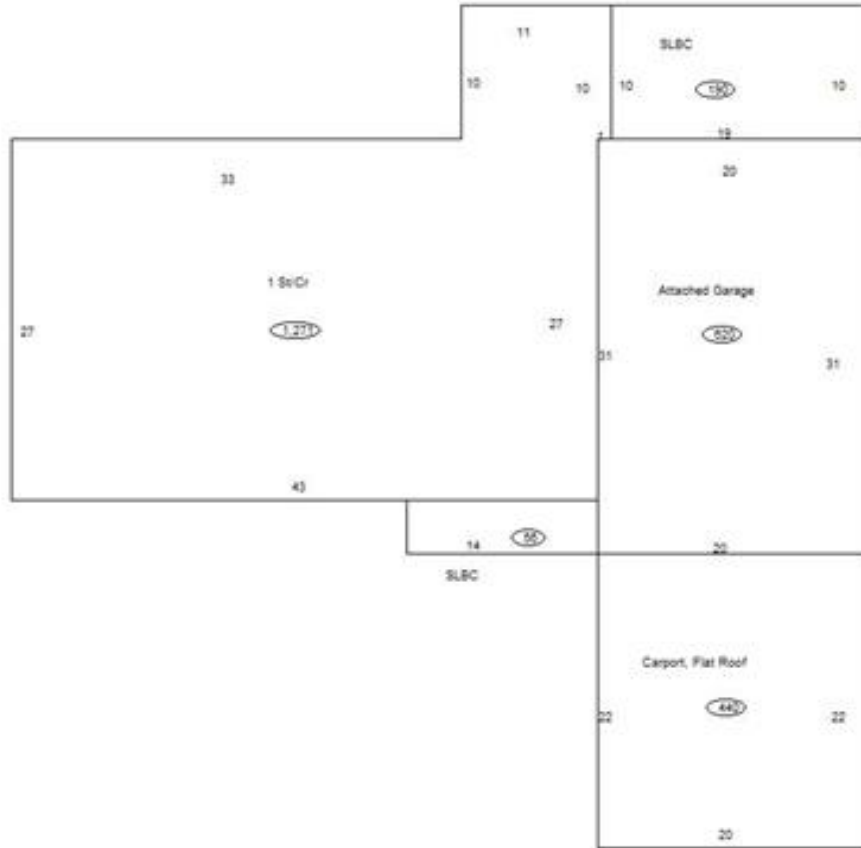

Sketch Vector Information

Sequence	Code	Type	Built Over	Scale	Section Label	Base Area	Multiplier	Total Area
1	R	1	Crawl	10	1 St/Cr	1,271	1.000	1,271
2	G	1		10	Attached Garage	620	1.000	620
3	M	PRCH		10	SLBC	56	1.000	56
4	M	PRCH		10	SLBC	190	1.000	190
5	G	4		10	Carport, Flat Roof	440	1.000	440
Total Building Area						1,271		1,271



Rogers

Assessment Property Record Card for Tax Year 2026

Data provided by LISA DELOZIER County Assessor

Date 04/18/2026
Time 06:39:09
Page 4

660010826

Outbuildings/Site Improvements

Building Image	Code	Description	Dimensions	Floor	Roofing	Total Units
	STF	STG FAIR	0x0x0			
	Qual	2	Cond	Year	2019	Eff Age
Valuation Summary		Modifier Total		RCN	Depr (0% Phys/ % Func)	RCNLD
Base Cost (4.68 x)						