



# Rogers

## Assessment Property Record Card for Tax Year 2026

Data provided by LISA DELOZIER County Assessor

Date 04/16/2026  
Time 23:13:37  
Page 1

Assessment Data					Primary Image																																																																																																																				
<b>Account</b> 660011039 <b>Parcel ID</b> 000000-00-0-00204-001-0005 <b>Cadastral ID</b> 10-21-17-03250 <b>Property Type</b> REAL - Real Property <b>Property Class</b> RRP VI Area 3 <b>Tax Area</b> 94 - SEQUOYAH/TRI-DISTRICT FI <b>Name ID</b> 339270 TPAT PROPERTIES LLC  3153 N LEWIS AVE TULSA OK 74110-0000  <b>Parcel Location</b> <b>Situs</b> 19295 S SHANNON DR <b>Subdivision</b> COUNTRY AIRE ESTATES <b>Lot/Block</b> 0005 / 0001 <b>Parcel Size</b> 1 - Lots <b>Sec/Twn/Rng</b> 10 / 21 / 17 / 5 <b>Neighborhood</b> 1061 - R-V03-SE SEQUOYAH <b>School District</b> S006 - SEQUOYAH SCHOOLS					<p>660011039 12/09/25</p> <p>660011039_001.JPG 12/9/2025</p>																																																																																																																				
<b>Legal Description</b> Lot/Long: 36.30882144 -95.48436726 LOT 5 BLOCK 1 COUNTRY AIRE ESTATES																																																																																																																									
<b>Exemptions</b> <table border="1"> <thead> <tr> <th>Code</th> <th>Type</th> <th>Active</th> <th>Maximum</th> <th>Exemption</th> </tr> </thead> <tbody> <tr> <td></td> <td></td> <td></td> <td></td> <td></td> </tr> </tbody> </table>					Code	Type	Active	Maximum	Exemption						<b>Building Permits</b> <table border="1"> <thead> <tr> <th>Number</th> <th>Description</th> <th>Opened</th> <th>Closed</th> <th>Amount</th> </tr> </thead> <tbody> <tr> <td></td> <td></td> <td></td> <td></td> <td></td> </tr> </tbody> </table>					Number	Description	Opened	Closed	Amount																																																																																																	
Code	Type	Active	Maximum	Exemption																																																																																																																					
Number	Description	Opened	Closed	Amount																																																																																																																					
<b>Parcel Valuation</b> <table border="1"> <thead> <tr> <th>Source</th> <th>REAL</th> <th>Fair Cash</th> <th>Capped</th> <th>Asmnt Level</th> <th>Assessed</th> <th>Levy Rate</th> <th>98.320</th> <th>Current Tax</th> </tr> </thead> <tbody> <tr> <td>Remove Cap</td> <td>2023</td> <td>Land Value 45,808</td> <td>44,945</td> <td>11%</td> <td>4,944</td> <td>Assessed</td> <td>22,644</td> <td>2,226.36</td> </tr> <tr> <td>Year Frozen</td> <td>0</td> <td>Improvements 166,961</td> <td>160,909</td> <td></td> <td>17,700</td> <td>Penalty</td> <td>0</td> <td></td> </tr> <tr> <td>Uncapped Value</td> <td>0</td> <td>Mobile Home 0</td> <td>0</td> <td></td> <td>0</td> <td>Exemption</td> <td>0</td> <td>0.00</td> </tr> <tr> <td>TIF Project ID</td> <td>0</td> <td>Total Value 212,769</td> <td>205,854</td> <td></td> <td>22,644</td> <td>Total Taxable</td> <td>22,644</td> <td>2,226.00</td> </tr> </tbody> </table>					Source	REAL	Fair Cash	Capped	Asmnt Level	Assessed	Levy Rate	98.320	Current Tax	Remove Cap	2023	Land Value 45,808	44,945	11%	4,944	Assessed	22,644	2,226.36	Year Frozen	0	Improvements 166,961	160,909		17,700	Penalty	0		Uncapped Value	0	Mobile Home 0	0		0	Exemption	0	0.00	TIF Project ID	0	Total Value 212,769	205,854		22,644	Total Taxable	22,644	2,226.00	<b>Sale History</b> <table border="1"> <thead> <tr> <th>Bk/Pg</th> <th>Grantor</th> <th>Date</th> <th>Price</th> <th>Code</th> </tr> </thead> <tbody> <tr> <td>/</td> <td>WILMINGTON SAVINGS FUND SOCIET</td> <td>08/02/2022</td> <td>211,000</td> <td>3</td> </tr> <tr> <td>/</td> <td>LAW, STEVEN</td> <td>02/10/2022</td> <td>0</td> <td>10</td> </tr> <tr> <td>2165/212</td> <td>SNYDER, IVAN W &amp;</td> <td>03/24/2011</td> <td>155,000</td> <td>YES</td> </tr> <tr> <td>973/314</td> <td>BERG, ERNEST C &amp;</td> <td>11/04/1994</td> <td>77,000</td> <td>No</td> </tr> <tr> <td>821/797</td> <td></td> <td></td> <td>69,000</td> <td>No</td> </tr> </tbody> </table>					Bk/Pg	Grantor	Date	Price	Code	/	WILMINGTON SAVINGS FUND SOCIET	08/02/2022	211,000	3	/	LAW, STEVEN	02/10/2022	0	10	2165/212	SNYDER, IVAN W &	03/24/2011	155,000	YES	973/314	BERG, ERNEST C &	11/04/1994	77,000	No	821/797			69,000	No																																					
Source	REAL	Fair Cash	Capped	Asmnt Level	Assessed	Levy Rate	98.320	Current Tax																																																																																																																	
Remove Cap	2023	Land Value 45,808	44,945	11%	4,944	Assessed	22,644	2,226.36																																																																																																																	
Year Frozen	0	Improvements 166,961	160,909		17,700	Penalty	0																																																																																																																		
Uncapped Value	0	Mobile Home 0	0		0	Exemption	0	0.00																																																																																																																	
TIF Project ID	0	Total Value 212,769	205,854		22,644	Total Taxable	22,644	2,226.00																																																																																																																	
Bk/Pg	Grantor	Date	Price	Code																																																																																																																					
/	WILMINGTON SAVINGS FUND SOCIET	08/02/2022	211,000	3																																																																																																																					
/	LAW, STEVEN	02/10/2022	0	10																																																																																																																					
2165/212	SNYDER, IVAN W &	03/24/2011	155,000	YES																																																																																																																					
973/314	BERG, ERNEST C &	11/04/1994	77,000	No																																																																																																																					
821/797			69,000	No																																																																																																																					
<b>Assessment History</b> <table border="1"> <thead> <tr> <th>Tax Year</th> <th>Statement Number</th> <th>Billed Owner</th> <th>Tax Area</th> <th>Total Value</th> <th>Exemptions</th> <th>Taxable Value</th> <th>Billed Tax</th> </tr> </thead> <tbody> <tr><td>2025</td><td>2025-660011039</td><td>TPAT PROPERTIES LLC</td><td>94</td><td>199,055</td><td>0</td><td>21,566</td><td>2,121.00</td></tr> <tr><td>2024</td><td>2024-660011039</td><td>TPAT PROPERTIES LLC</td><td>94</td><td>191,457</td><td>0</td><td>20,538</td><td>2,151.00</td></tr> <tr><td>2023</td><td>2023-660011039</td><td>TPAT PROPERTIES LLC</td><td>94</td><td>177,826</td><td>0</td><td>19,561</td><td>2,089.00</td></tr> <tr><td>2022</td><td>2022-660011039</td><td>TPAT PROPERTIES LLC</td><td>94</td><td>174,286</td><td>0</td><td>19,171</td><td>2,067.00</td></tr> <tr><td>2021</td><td>2021-660011039</td><td>LAW, STEVEN</td><td>94</td><td>181,184</td><td>0</td><td>19,930</td><td>2,077.00</td></tr> <tr><td>2020</td><td>2020-660011039</td><td>LAW, STEVEN</td><td>94</td><td>182,117</td><td>0</td><td>20,033</td><td>2,084.00</td></tr> <tr><td>2019</td><td>2019-660011039</td><td>LAW, STEVEN</td><td>94</td><td>173,677</td><td>0</td><td>19,104</td><td>1,959.00</td></tr> <tr><td>2018</td><td>2018-660011039</td><td>LAW, STEVEN</td><td>94</td><td>180,318</td><td>0</td><td>19,835</td><td>2,056.00</td></tr> <tr><td>2017</td><td>2017-660011039</td><td>LAW, STEVEN</td><td>94</td><td>179,308</td><td>0</td><td>19,724</td><td>2,017.00</td></tr> <tr><td>2016</td><td>2016-660011039</td><td>LAW, STEVEN</td><td>94</td><td>174,946</td><td>0</td><td>19,244</td><td>1,960.00</td></tr> <tr><td>2015</td><td>2015-660011039</td><td>LAW, STEVEN</td><td>94</td><td>172,848</td><td>0</td><td>19,013</td><td>1,977.00</td></tr> <tr><td>2014</td><td>2014-660011039</td><td>LAW, STEVEN</td><td>94</td><td>175,937</td><td>0</td><td>18,362</td><td>1,878.00</td></tr> <tr><td>2013</td><td>2013-660011039</td><td>LAW, STEVEN</td><td>94</td><td>158,980</td><td>0</td><td>17,488</td><td>1,762.00</td></tr> </tbody> </table>										Tax Year	Statement Number	Billed Owner	Tax Area	Total Value	Exemptions	Taxable Value	Billed Tax	2025	2025-660011039	TPAT PROPERTIES LLC	94	199,055	0	21,566	2,121.00	2024	2024-660011039	TPAT PROPERTIES LLC	94	191,457	0	20,538	2,151.00	2023	2023-660011039	TPAT PROPERTIES LLC	94	177,826	0	19,561	2,089.00	2022	2022-660011039	TPAT PROPERTIES LLC	94	174,286	0	19,171	2,067.00	2021	2021-660011039	LAW, STEVEN	94	181,184	0	19,930	2,077.00	2020	2020-660011039	LAW, STEVEN	94	182,117	0	20,033	2,084.00	2019	2019-660011039	LAW, STEVEN	94	173,677	0	19,104	1,959.00	2018	2018-660011039	LAW, STEVEN	94	180,318	0	19,835	2,056.00	2017	2017-660011039	LAW, STEVEN	94	179,308	0	19,724	2,017.00	2016	2016-660011039	LAW, STEVEN	94	174,946	0	19,244	1,960.00	2015	2015-660011039	LAW, STEVEN	94	172,848	0	19,013	1,977.00	2014	2014-660011039	LAW, STEVEN	94	175,937	0	18,362	1,878.00	2013	2013-660011039	LAW, STEVEN	94	158,980	0	17,488	1,762.00
Tax Year	Statement Number	Billed Owner	Tax Area	Total Value	Exemptions	Taxable Value	Billed Tax																																																																																																																		
2025	2025-660011039	TPAT PROPERTIES LLC	94	199,055	0	21,566	2,121.00																																																																																																																		
2024	2024-660011039	TPAT PROPERTIES LLC	94	191,457	0	20,538	2,151.00																																																																																																																		
2023	2023-660011039	TPAT PROPERTIES LLC	94	177,826	0	19,561	2,089.00																																																																																																																		
2022	2022-660011039	TPAT PROPERTIES LLC	94	174,286	0	19,171	2,067.00																																																																																																																		
2021	2021-660011039	LAW, STEVEN	94	181,184	0	19,930	2,077.00																																																																																																																		
2020	2020-660011039	LAW, STEVEN	94	182,117	0	20,033	2,084.00																																																																																																																		
2019	2019-660011039	LAW, STEVEN	94	173,677	0	19,104	1,959.00																																																																																																																		
2018	2018-660011039	LAW, STEVEN	94	180,318	0	19,835	2,056.00																																																																																																																		
2017	2017-660011039	LAW, STEVEN	94	179,308	0	19,724	2,017.00																																																																																																																		
2016	2016-660011039	LAW, STEVEN	94	174,946	0	19,244	1,960.00																																																																																																																		
2015	2015-660011039	LAW, STEVEN	94	172,848	0	19,013	1,977.00																																																																																																																		
2014	2014-660011039	LAW, STEVEN	94	175,937	0	18,362	1,878.00																																																																																																																		
2013	2013-660011039	LAW, STEVEN	94	158,980	0	17,488	1,762.00																																																																																																																		



# Rogers

## Assessment Property Record Card for Tax Year 2026

Data provided by LISA DELOZIER County Assessor

Date 04/16/2026  
Time 23:13:37  
Page 2

Lot Data		Square-Foot - NBHD 1061 #1		Primary Image					
Lot Size						660011039		12/09/25	
Lot Count						660011039_001.JPG		12/9/2025	
Units Buildable	1					<b>GRM Approach</b>			
Non-Ag Acres	2.758					<b>GRM Code</b>			
Topography						<b>Gross Rent</b>		0.00	
Street Access						<b>Indicated Value</b>			
Utilities						<b>Multiple Regression</b>			
Amenities	LAND QUALITY					<b>MRA Code</b>		1 Test	
Method	Square-Foot					<b>Adusted R</b>		0.8445	
Base Lot Value	120,138.00 x .38 = 45,808					<b>Indicated Value</b>		252,264 108.45 Per SqFt	
Factor Value		<b>Direct Comparables</b>							
Adjustments		<b>Selection Model</b>		A Adam Test					
Lot Value	45,808	<b>Adjustment Model</b>		1 2022 Residential					
<b>Residential Data</b>		<b>Comparables</b>		1					
Type	1 Single Family Residence	<b>Indicated Value</b>		216,170 Per SqFt					
Condition	2.5 - Fair	<b>Value Reconciliation</b>							
Quality	2.5 - Fair	<b>Selected Approach</b>		Cost Approach					
Architecture		<b>Improvements</b>		145,065					
Style	100% Two Story	<b>Lot Value</b>		45,808					
Exterior Wall	20% Veneer, Masonry 80% Frame, Siding, Vinyl	<b>Indicated Value</b>		190,873 82.06 Per SqFt					
Base/Total Area	1,163 / 2,326	<b>Agland Value</b>							
Style	100% Two Story	<b>Site Improvements</b>		21,896					
HVAC	100% Warmed & Cooled Air	<b>Total Value</b>		212,769 91.47 Total Value Per SqFt					
Roof Cover	1 Composition Shingle								
Area on Slab	1,163								
Fixture/RghIn	11 /								
Bed/F/H Bath	3 / 2.0 /								
Basement Area									
Garage Type	616 Attached Garage - Unfinished								
Remodel									
Year/Eff Age	1986 / 35								
<b>Cost Approach</b>		<b>Manual : 01/2025</b>							
Base Cost	78.86	<b>Total Misc Impr</b>	+	14,566					
Roofing Adj	+ 2.40	<b>Garage Cost</b>	+	16,158					
Subfloor Adj	+ -0.62	<b>Total RCN</b>	=	259,044					
Heat/Cool Adj	+ 11.47	<b>Depreciation ( 44%)</b>	-	113,979					
Plumbing Adj	+ 6.05	<b>Lump Sums</b>	+	0					
Basement Adj	+ 0.00	<b>RCNLD</b>	=	145,065					
Adj Base Cost	= 98.16	<b>Lot Value</b>	+	45,808					
Total Area	x 2,326	<b>Indicated Value</b>	=	190,873					
Adjusted Cost	= 228,320	<b>Value Per SqFt</b>		82.06					
<b>Miscellaneous Improvements</b>									
Code	Description	Sketch ID	Size	Year	Units	Unit Cost	Depr	Value	
FPR1	FIREPLACE - RESIDENTIAL 1 STORY	0		1	1	5,095.98		5,096	
PRCH	SLAB PORCH - COVERED	26495	14x12		168	23.69		3,980	
PRCH	SLAB PORCH - COVERED	26496	234		234	23.46		5,490	



# Rogers

## Assessment Property Record Card for Tax Year 2026

Data provided by LISA DELOZIER County Assessor

Date 04/16/2026  
 Time 23:13:37  
 Page 3

### Sketch Image

660011039

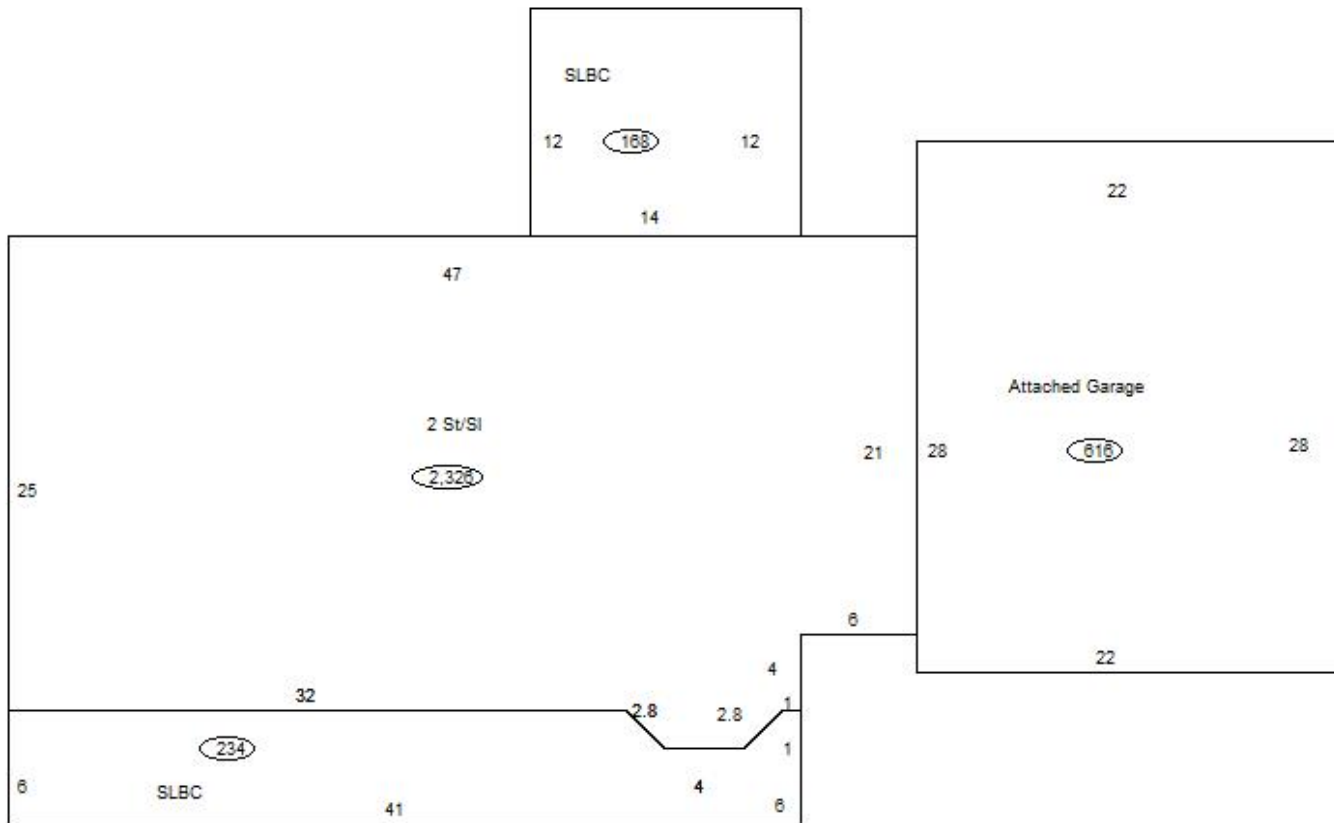

### Sketch Vector Information

Sequence	Code	Type	Built Over	Scale	Section Label	Base Area	Multiplier	Total Area
1	R	2	Slab	10	2 St/SI	1,163	2.000	2,326
2	G	1		10	Attached Garage	616	1.000	616
3	M	PRCH		10	SLBC	168	1.000	168
4	M	PRCH		10	SLBC	234	1.000	234
<b>Total Building Area</b>						1,163		2,326



# Rogers

## Assessment Property Record Card for Tax Year 2026

Data provided by LISA DELOZIER County Assessor

Date 04/16/2026  
Time 23:13:37  
Page 4

660011039

### Outbuildings/Site Improvements

Building Image	Code	Description	Dimensions	Floor	Roofing	Total Units
	UTIL	SHOP BUILDING	0x0x0			1,000
	Qual 2	Cond 3	Year	Eff Age		
		<b>Valuation Summary</b>	<b>Modifier Total</b>	<b>RCN</b>	<b>Depr (30% Phys/ % Func)</b>	<b>RCNLD</b>
		Base Cost (31.28 x 1,000)	31,280	31,280	9,384	21,896