



# Rogers

## Assessment Property Record Card for Tax Year 2026

Data provided by LISA DELOZIER County Assessor

Date 04/16/2026  
 Time 23:09:10  
 Page 1

Assessment Data					Primary Image																																																																																																																				
<b>Account</b> 660011064 <b>Parcel ID</b> 000000-00-0-00459-003-0002 <b>Cadastral ID</b> 10-21-17-03500 <b>Property Type</b> REAL - Real Property <b>Property Class</b> RRP VI Area 3 <b>Tax Area</b> 94 - SEQUOYAH/TRI-DISTRICT FI <b>Name ID</b> 49654 HANES, DOTTIE ANN  TRUSTEE 20406 S LITTLE FOX DR CLAREMORE OK 74019-0000  <b>Parcel Location</b> <b>Situs</b> 20406 S LITTLE FOX DR <b>Subdivision</b> LITTLE FOX ESTATES <b>Lot/Block</b> 0002 / 0003 <b>Parcel Size</b> 1 - Lots <b>Sec/Twn/Rng</b> 10 / 21 / 17 / 5 <b>Neighborhood</b> 1061 - R-V03-SE SEQUOYAH <b>School District</b> S006 - SEQUOYAH SCHOOLS					<p>660011064 12/04/25</p> <p>660011064_002.JPG 12/9/2025</p>																																																																																																																				
<b>Legal Description</b> Lat/Long: 36.31689402 -95.48429236 LOT 2 BLOCK 3 LITTLE FOX ESTATES																																																																																																																									
<b>Exemptions</b> <table border="1"> <thead> <tr> <th>Code</th> <th>Type</th> <th>Active</th> <th>Maximum</th> <th>Exemption</th> </tr> </thead> <tbody> <tr> <td>H</td> <td>Homestead</td> <td>Yes</td> <td>1,000</td> <td>1,000</td> </tr> <tr> <td>PD</td> <td>Add-Homestead</td> <td>Yes</td> <td>1,000</td> <td>1,000</td> </tr> </tbody> </table>					Code	Type	Active	Maximum	Exemption	H	Homestead	Yes	1,000	1,000	PD	Add-Homestead	Yes	1,000	1,000	<b>Building Permits</b> <table border="1"> <thead> <tr> <th>Number</th> <th>Description</th> <th>Opened</th> <th>Closed</th> <th>Amount</th> </tr> </thead> <tbody> <tr> <td>R13</td> <td>R13-NEW SFR PER RANDY</td> <td>07/2012</td> <td>12/2012</td> <td></td> </tr> </tbody> </table>					Number	Description	Opened	Closed	Amount	R13	R13-NEW SFR PER RANDY	07/2012	12/2012																																																																																								
Code	Type	Active	Maximum	Exemption																																																																																																																					
H	Homestead	Yes	1,000	1,000																																																																																																																					
PD	Add-Homestead	Yes	1,000	1,000																																																																																																																					
Number	Description	Opened	Closed	Amount																																																																																																																					
R13	R13-NEW SFR PER RANDY	07/2012	12/2012																																																																																																																						
<b>Parcel Valuation</b> <table border="1"> <thead> <tr> <th>Source</th> <th>REAL</th> <th>Fair Cash</th> <th>Capped</th> <th>Asmnt Level</th> <th>Assessed</th> <th>Levy Rate</th> <th>98.320</th> <th>Current Tax</th> </tr> </thead> <tbody> <tr> <td>Remove Cap</td> <td>0</td> <td>Land Value 42,334</td> <td>35,670</td> <td>11%</td> <td>3,924</td> <td>Assessed</td> <td>13,762</td> <td>1,353.08</td> </tr> <tr> <td>Year Frozen</td> <td>2025</td> <td>Improvements 106,145</td> <td>89,437</td> <td></td> <td>9,838</td> <td>Penalty</td> <td>0</td> <td></td> </tr> <tr> <td>Uncapped Value</td> <td>0</td> <td>Mobile Home 0</td> <td>0</td> <td></td> <td>0</td> <td>Exemption</td> <td>2,000</td> <td>-177.00</td> </tr> <tr> <td>TIF Project ID</td> <td>0</td> <td>Total Value 148,479</td> <td>125,107</td> <td></td> <td>13,762</td> <td>Total Taxable</td> <td>11,762</td> <td>1,176.00</td> </tr> </tbody> </table>					Source	REAL	Fair Cash	Capped	Asmnt Level	Assessed	Levy Rate	98.320	Current Tax	Remove Cap	0	Land Value 42,334	35,670	11%	3,924	Assessed	13,762	1,353.08	Year Frozen	2025	Improvements 106,145	89,437		9,838	Penalty	0		Uncapped Value	0	Mobile Home 0	0		0	Exemption	2,000	-177.00	TIF Project ID	0	Total Value 148,479	125,107		13,762	Total Taxable	11,762	1,176.00	<b>Sale History</b> <table border="1"> <thead> <tr> <th>Bk/Pg</th> <th>Grantor</th> <th>Date</th> <th>Price</th> <th>Code</th> </tr> </thead> <tbody> </tbody> </table>					Bk/Pg	Grantor	Date	Price	Code																																																														
Source	REAL	Fair Cash	Capped	Asmnt Level	Assessed	Levy Rate	98.320	Current Tax																																																																																																																	
Remove Cap	0	Land Value 42,334	35,670	11%	3,924	Assessed	13,762	1,353.08																																																																																																																	
Year Frozen	2025	Improvements 106,145	89,437		9,838	Penalty	0																																																																																																																		
Uncapped Value	0	Mobile Home 0	0		0	Exemption	2,000	-177.00																																																																																																																	
TIF Project ID	0	Total Value 148,479	125,107		13,762	Total Taxable	11,762	1,176.00																																																																																																																	
Bk/Pg	Grantor	Date	Price	Code																																																																																																																					
<b>Assessment History</b> <table border="1"> <thead> <tr> <th>Tax Year</th> <th>Statement Number</th> <th>Billed Owner</th> <th>Tax Area</th> <th>Total Value</th> <th>Exemptions</th> <th>Taxable Value</th> <th>Billed Tax</th> </tr> </thead> <tbody> <tr><td>2025</td><td>2025-660011064</td><td>HANES, DOTTIE ANN</td><td>94</td><td>146,754</td><td>2000</td><td>11,762</td><td>1,177.00</td></tr> <tr><td>2024</td><td>2024-660011064</td><td>HANES, DOTTIE ANN</td><td>94</td><td>132,778</td><td>1000</td><td>12,361</td><td>1,310.00</td></tr> <tr><td>2023</td><td>2023-660011064</td><td>HANES, DOTTIE ANN</td><td>94</td><td>118,200</td><td>1000</td><td>11,972</td><td>1,295.00</td></tr> <tr><td>2022</td><td>2022-660011064</td><td>HANES, DOTTIE ANN</td><td>94</td><td>120,380</td><td>1000</td><td>11,594</td><td>1,266.00</td></tr> <tr><td>2021</td><td>2021-660011064</td><td>HANES, DOTTIE ANN</td><td>94</td><td>111,159</td><td>1000</td><td>11,227</td><td>1,186.00</td></tr> <tr><td>2020</td><td>2020-660011064</td><td>HANES, DOTTIE ANN</td><td>94</td><td>110,418</td><td>1000</td><td>10,946</td><td>1,152.00</td></tr> <tr><td>2019</td><td>2019-660011064</td><td>HANES, DOTTIE ANN</td><td>94</td><td>105,437</td><td>1000</td><td>10,598</td><td>1,100.00</td></tr> <tr><td>2018</td><td>2018-660011064</td><td>HANES, DOTTIE ANN</td><td>94</td><td>108,841</td><td>1000</td><td>10,410</td><td>1,091.00</td></tr> <tr><td>2017</td><td>2017-660011064</td><td>HANES, DOTTIE ANN</td><td>94</td><td>108,006</td><td>1000</td><td>10,078</td><td>1,044.00</td></tr> <tr><td>2016</td><td>2016-660011064</td><td>HANES, DOTTIE ANN</td><td>94</td><td>105,513</td><td>1000</td><td>9,755</td><td>1,007.00</td></tr> <tr><td>2015</td><td>2015-660011064</td><td>HANES, DOTTIE ANN</td><td>94</td><td>103,365</td><td>1000</td><td>9,442</td><td>995.00</td></tr> <tr><td>2014</td><td>2014-660011064</td><td>HANES, DOTTIE ANN</td><td>94</td><td>105,312</td><td>1000</td><td>9,138</td><td>944.00</td></tr> <tr><td>2013</td><td>2013-660011064</td><td>HANES, DOTTIE ANN</td><td>94</td><td>99,565</td><td>1000</td><td>8,843</td><td>900.00</td></tr> </tbody> </table>										Tax Year	Statement Number	Billed Owner	Tax Area	Total Value	Exemptions	Taxable Value	Billed Tax	2025	2025-660011064	HANES, DOTTIE ANN	94	146,754	2000	11,762	1,177.00	2024	2024-660011064	HANES, DOTTIE ANN	94	132,778	1000	12,361	1,310.00	2023	2023-660011064	HANES, DOTTIE ANN	94	118,200	1000	11,972	1,295.00	2022	2022-660011064	HANES, DOTTIE ANN	94	120,380	1000	11,594	1,266.00	2021	2021-660011064	HANES, DOTTIE ANN	94	111,159	1000	11,227	1,186.00	2020	2020-660011064	HANES, DOTTIE ANN	94	110,418	1000	10,946	1,152.00	2019	2019-660011064	HANES, DOTTIE ANN	94	105,437	1000	10,598	1,100.00	2018	2018-660011064	HANES, DOTTIE ANN	94	108,841	1000	10,410	1,091.00	2017	2017-660011064	HANES, DOTTIE ANN	94	108,006	1000	10,078	1,044.00	2016	2016-660011064	HANES, DOTTIE ANN	94	105,513	1000	9,755	1,007.00	2015	2015-660011064	HANES, DOTTIE ANN	94	103,365	1000	9,442	995.00	2014	2014-660011064	HANES, DOTTIE ANN	94	105,312	1000	9,138	944.00	2013	2013-660011064	HANES, DOTTIE ANN	94	99,565	1000	8,843	900.00
Tax Year	Statement Number	Billed Owner	Tax Area	Total Value	Exemptions	Taxable Value	Billed Tax																																																																																																																		
2025	2025-660011064	HANES, DOTTIE ANN	94	146,754	2000	11,762	1,177.00																																																																																																																		
2024	2024-660011064	HANES, DOTTIE ANN	94	132,778	1000	12,361	1,310.00																																																																																																																		
2023	2023-660011064	HANES, DOTTIE ANN	94	118,200	1000	11,972	1,295.00																																																																																																																		
2022	2022-660011064	HANES, DOTTIE ANN	94	120,380	1000	11,594	1,266.00																																																																																																																		
2021	2021-660011064	HANES, DOTTIE ANN	94	111,159	1000	11,227	1,186.00																																																																																																																		
2020	2020-660011064	HANES, DOTTIE ANN	94	110,418	1000	10,946	1,152.00																																																																																																																		
2019	2019-660011064	HANES, DOTTIE ANN	94	105,437	1000	10,598	1,100.00																																																																																																																		
2018	2018-660011064	HANES, DOTTIE ANN	94	108,841	1000	10,410	1,091.00																																																																																																																		
2017	2017-660011064	HANES, DOTTIE ANN	94	108,006	1000	10,078	1,044.00																																																																																																																		
2016	2016-660011064	HANES, DOTTIE ANN	94	105,513	1000	9,755	1,007.00																																																																																																																		
2015	2015-660011064	HANES, DOTTIE ANN	94	103,365	1000	9,442	995.00																																																																																																																		
2014	2014-660011064	HANES, DOTTIE ANN	94	105,312	1000	9,138	944.00																																																																																																																		
2013	2013-660011064	HANES, DOTTIE ANN	94	99,565	1000	8,843	900.00																																																																																																																		



# Rogers

## Assessment Property Record Card for Tax Year 2026

Data provided by LISA DELOZIER County Assessor

Date 04/16/2026  
Time 23:09:10  
Page 2

Lot Data	Square-Foot - NBHD 1061 #1	Primary Image
<b>Lot Size</b> <b>Lot Count</b> <b>Units Buildable</b> 1 <b>Non-Ag Acres</b> 2.3593 <b>Topography</b> <b>Street Access</b> <b>Utilities</b> <b>Amenities</b> LAND QUALITY  <b>Method</b> Square-Foot <b>Base Lot Value</b> 102,771.00 x .41 = 42,334 <b>Factor Value</b> <b>Adjustments</b> <b>Lot Value</b> 42,334		

Residential Data	
<b>Type</b>	1 Single Family Residence
<b>Condition</b>	2 - Fair
<b>Quality</b>	2 - Fair
<b>Architecture</b>	DMH LOWER VALUED MH
<b>Style</b>	100% One Story
<b>Exterior Wall</b>	100% Frame, Siding, Metal
<b>Base/Total Area</b>	1,236 / 1,236
<b>Style</b>	100% One Story
<b>HVAC</b>	100% Warmed & Cooled Air
<b>Roof Cover</b>	4 Metal, Preformed
<b>Area on Slab</b>	1,236
<b>Fixture/RghIn</b>	11 /
<b>Bed/F/H Bath</b>	2 / 2.0 /
<b>Basement Area</b>	
<b>Garage Type</b>	264 Attached Garage - Unfinished
<b>Remodel</b>	
<b>Year/Eff Age</b>	2012 / 14

660011064	12/04/25
660011064_002.JPG	12/9/2025

GRM Approach	
<b>GRM Code</b>	
<b>Gross Rent</b>	0.00
<b>Indicated Value</b>	

Multiple Regression			
<b>MRA Code</b>	1	Test	
<b>Adusted R</b>	0.8445		
<b>Indicated Value</b>	150,423	121.70	Per SqFt

Direct Comparables	
<b>Selection Model</b>	A Adam Test
<b>Adjustment Model</b>	1 2022 Residential
<b>Comparables</b>	
<b>Indicated Value</b>	

Cost Approach				Manual : 01/2025			
<b>Base Cost</b>	63.56	<b>Total Misc Impr</b>	+ 11,838				
<b>Roofing Adj</b>	+ 4.78	<b>Garage Cost</b>	+ 7,408				
<b>Subfloor Adj</b>	+ 0.00	<b>Total RCN</b>	= 129,102				
<b>Heat/Cool Adj</b>	+ 10.30	<b>Depreciation ( 18%)</b>	- 23,238				
<b>Plumbing Adj</b>	+ 10.24	<b>Lump Sums</b>	+ 0				
<b>Basement Adj</b>	+ 0.00	<b>RCNLD</b>	= 105,864				
<b>Adj Base Cost</b>	= 88.88	<b>Lot Value</b>	+ 42,334				
<b>Total Area</b>	x 1,236	<b>Indicated Value</b>	= 148,198				
<b>Adjusted Cost</b>	= 109,856	<b>Value Per SqFt</b>	119.90				

Value Reconciliation			
<b>Selected Approach</b>	Cost Approach		
<b>Improvements</b>	105,864		
<b>Lot Value</b>	42,334		
<b>Indicated Value</b>	148,198	119.90	Per SqFt
<b>Agland Value</b>			
<b>Site Improvements</b>	281		
<b>Total Value</b>	148,479	120.13	Total Value Per SqFt

Miscellaneous Improvements								
Code	Description	Sketch ID	Size	Year	Units	Unit Cost	Depr	Value
PRCH	SLAB PORCH - COVERED	116589	50x12		600	19.73		11,838



**Rogers**  
**Assessment Property Record Card for Tax Year 2026**

Data provided by LISA DELOZIER County Assessor

Date 04/16/2026  
 Time 23:09:10  
 Page 3

Sketch Image

660011064

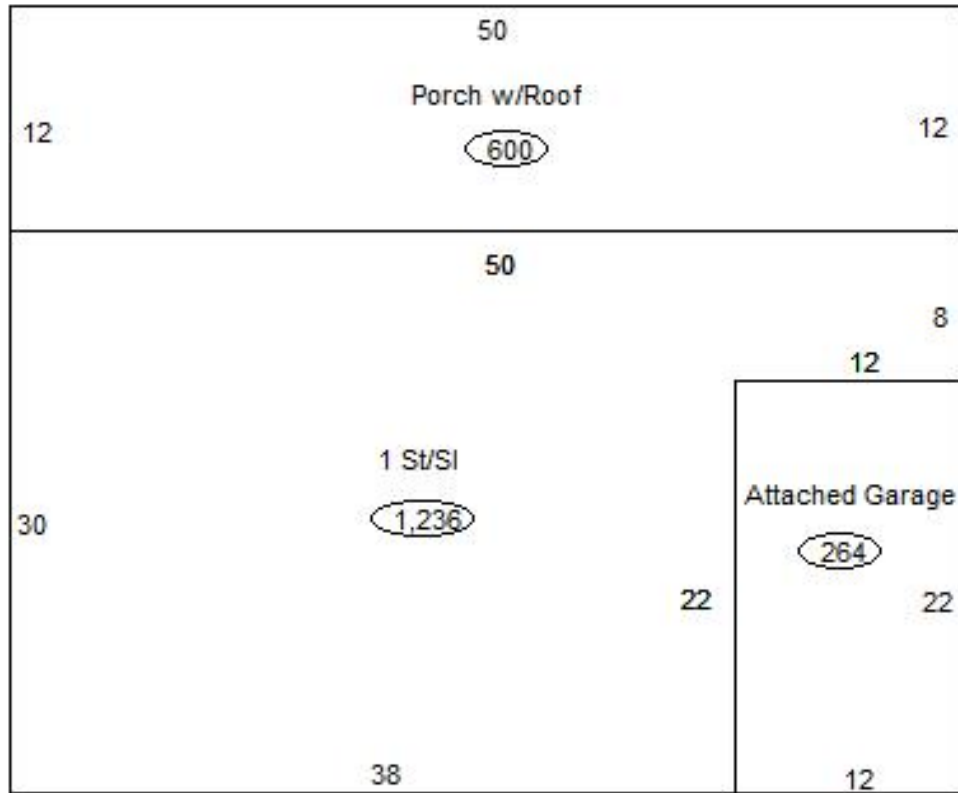

**Sketch Vector Information**

Sequence	Code	Type	Built Over	Scale	Section Label	Base Area	Multiplier	Total Area
1	R	1	Slab	13	1 St/SI	1,236	1.000	1,236
2	G	1		13	Attached Garage	264	1.000	264
3	M	PRCH		13	SLBC	600	1.000	600
<b>Total Building Area</b>						1,236		1,236



# Rogers



## Assessment Property Record Card for Tax Year 2026

Data provided by LISA DELOZIER County Assessor

Date 04/16/2026  
Time 23:09:11  
Page 4

660011064

### Outbuildings/Site Improvements

Building Image	Code	Description	Dimensions	Floor	Roofing	Total Units	
	STF	STG FAIR	12x10x0			120	
	Qual	2	Cond	Year	2021	Eff Age	
	<b>Valuation Summary</b>		<b>Modifier Total</b>		<b>RCN</b>	<b>Depr (50% Phys/ % Func)</b>	<b>RCNLD</b>
Base Cost (4.68 x 120)		562			562	281	281
	BARN	BARN	0x0x0				
	Qual		Cond	Year		Eff Age	
	<b>Valuation Summary</b>		<b>Modifier Total</b>		<b>RCN</b>	<b>Depr (100% Phys/ % Func)</b>	<b>RCNLD</b>
Base Cost (11.51 x )							