



# Rogers

## Assessment Property Record Card for Tax Year 2026

Data provided by LISA DELOZIER County Assessor

Date 04/17/2026  
Time 07:54:16  
Page 1

Assessment Data					Primary Image				
Account	660011096								
Parcel ID	22N15E-10-4-00000-000-0000								
Cadastral ID	10-22-15-00900								
Property Type	REAL - Real Property								
Property Class	RR	VI Area 4							
Tax Area	10 - OOLOGAH RURAL/NW FIRE								
Name ID	340281								
FAUGHT, GARY WAYNE									
7811 E 430 RD CLAREMORE OK 74017-0000									
Parcel Location									
Situs	07811 E 430 RD								
Subdivision									
Lot/Block	/	Parcel Size 5 - Acres							
Sec/Twn/Rng	10 / 22 / 15 / 4								
Neighborhood	6020 - UNPLATTED								
School District	S004 - OOLOGAH SCHOOLS								
Legal Description Lat/Long: 36.39482364 -95.69004341									
Building Permits									
S2 SW SE SE									
Exemptions									
Code	Type	Active	Maximum	Exemption	Bk/Pg	Grantor	Date	Price	Code
H	Homestead	No	1,000		/	FAUGHT, AUBREY LEE &	10/30/2022	0	4
Parcel Valuation									
Source	REAL	Fair Cash	Capped	Asmnt Level	Assessed	Levy Rate	108.182	Current Tax	
Remove Cap	0	Land Value	58,810	25,078	11%	2,759	Assessed	7,576	819.58
Year Frozen	2005	Improvements	81,670	43,792		4,817	Penalty	0	
Uncapped Value	0	Mobile Home	0	0		0	Exemption	0	0.00
TIF Project ID	0	Total Value	140,480	68,870		7,576	Total Taxable	7,576	820.00
Assessment History									
Tax Year	Statement Number	Billed Owner			Tax Area	Total Value	Exemptions	Taxable Value	Billed Tax
2025	2025-660011096	FAUGHT, GARY WAYNE			10	139,881	0	7,214	780.00
2024	2024-660011096	FAUGHT, GARY WAYNE			10	145,448	0	6,872	719.00
2023	2023-660011096	FAUGHT, GARY WAYNE			10	112,202	0	6,544	681.00
2022	2022-660011096	FAUGHT, AUBREY LEE &			10	110,788	1000	5,232	555.00
2021	2021-660011096	FAUGHT, AUBREY LEE &			10	110,050	1000	5,232	559.00
2020	2020-660011096	FAUGHT, AUBREY LEE &			10	108,726	1000	5,233	568.00
2019	2019-660011096	FAUGHT, AUBREY LEE &			10	108,366	1000	5,233	557.00
2018	2018-660011096	FAUGHT, AUBREY LEE &			10	113,521	1000	5,233	576.00
2017	2017-660011096	FAUGHT, AUBREY LEE &			10	112,666	1000	5,233	609.00
2016	2016-660011096	FAUGHT, AUBREY LEE &			10	110,650	1000	5,233	556.00
2015	2015-660011096	FAUGHT, AUBREY LEE &			10	111,176	1000	5,232	525.00
2014	2014-660011096	FAUGHT, AUBREY LEE &			10	111,915	1000	5,233	523.00
2013	2013-660011096	FAUGHT, AUBREY LEE &			10	105,460	1000	5,233	507.00



# Rogers

## Assessment Property Record Card for Tax Year 2026

Data provided by LISA DELOZIER County Assessor

Date 04/17/2026  
Time 07:54:16  
Page 2

Lot Data	Square-Foot - NBHD 6020 #1	Primary Image
<b>Lot Size</b> <b>Lot Count</b> <b>Units Buildable</b> 5 <b>Non-Ag Acres</b> 5.0005 <b>Topography</b> <b>Street Access</b> <b>Utilities</b> <b>Amenities</b> LAND QUALITY 0 0 <b>Method</b> Square-Foot <b>Base Lot Value</b> 217,821.00 x .27 = 58,810 <b>Factor Value</b> <b>Adjustments</b> 1.0000 <b>Lot Value</b> 58,810		
<b>Residential Data</b> <b>Type</b> 1 Single Family Residence <b>Condition</b> 3 - Average <b>Quality</b> 2.5 - Fair <b>Architecture</b> <b>Style</b> 100% One Story <b>Exterior Wall</b> 100% Veneer, Masonry <b>Base/Total Area</b> 1,186 / 1,186 <b>Style</b> 100% One Story <b>HVAC</b> 100% Warmed & Cooled Air <b>Roof Cover</b> 1 Composition Shingle <b>Area on Slab</b> 1,186 <b>Fixture/RghIn</b> 4 / <b>Bed/F/H Bath</b> 3 / 1.0 / <b>Basement Area</b> <b>Garage Type</b> 504 Attached Garage - Unfinished <b>Remodel</b> <b>Year/Eff Age</b> 1961 / 49		

\\tsclient\T\TOMMY DUNLAP\New folder (63)\IMG\_0013.JPG 5/11/2022

Residential Data	
<b>Type</b>	1 Single Family Residence
<b>Condition</b>	3 - Average
<b>Quality</b>	2.5 - Fair
<b>Architecture</b>	
<b>Style</b>	100% One Story
<b>Exterior Wall</b>	100% Veneer, Masonry
<b>Base/Total Area</b>	1,186 / 1,186
<b>Style</b>	100% One Story
<b>HVAC</b>	100% Warmed & Cooled Air
<b>Roof Cover</b>	1 Composition Shingle
<b>Area on Slab</b>	1,186
<b>Fixture/RghIn</b>	4 /
<b>Bed/F/H Bath</b>	3 / 1.0 /
<b>Basement Area</b>	
<b>Garage Type</b>	504 Attached Garage - Unfinished
<b>Remodel</b>	
<b>Year/Eff Age</b>	1961 / 49

### GRM Approach

<b>GRM Code</b>	
<b>Gross Rent</b>	0.00
<b>Indicated Value</b>	

### Multiple Regression

<b>MRA Code</b>	1 Test
<b>Adusted R</b>	0.8445
<b>Indicated Value</b>	132,422 111.65 Per SqFt

### Direct Comparables

<b>Selection Model</b>	1 Res
<b>Adjustment Model</b>	A2 AO Test
<b>Comparables</b>	
<b>Indicated Value</b>	

### Value Reconciliation

<b>Selected Approach</b>	Cost Approach
<b>Improvements</b>	77,293
<b>Lot Value</b>	58,810
<b>Indicated Value</b>	136,103 114.76 Per SqFt
<b>Agland Value</b>	
<b>Site Improvements</b>	4,377
<b>Total Value</b>	140,480 118.45 Total Value Per SqFt

Cost Approach		Manual : 01/2025	
<b>Base Cost</b>	110.66	<b>Total Misc Impr</b>	+ 7,343
<b>Roofing Adj</b>	+ 4.67	<b>Garage Cost</b>	+ 13,810
<b>Subfloor Adj</b>	+ -1.22	<b>Total RCN</b>	= 175,665
<b>Heat/Cool Adj</b>	+ 11.47	<b>Depreciation ( 56%)</b>	- 98,372
<b>Plumbing Adj</b>	+ 4.70	<b>Lump Sums</b>	+ 0
<b>Basement Adj</b>	+ 0.00	<b>RCNLD</b>	= 77,293
<b>Adj Base Cost</b>	= 130.28	<b>Lot Value</b>	+ 58,810
<b>Total Area</b> x 1,186		<b>Indicated Value</b>	= 136,103
<b>Adjusted Cost</b>	= 154,512	<b>Value Per SqFt</b>	114.76

### Miscellaneous Improvements

Code	Description	Sketch ID	Size	Year	Units	Unit Cost	Depr	Value
FPR1	FIREPLACE - RESIDENTIAL 1 STORY	0		1	1	5,095.98		5,096
PRCH	SLAB PORCH - COVERED	26589		26	26	24.18		629
PATO	SLAB PORCH - OPEN	26590	13x12		156	10.37		1,618



# Rogers

## Assessment Property Record Card for Tax Year 2026

Data provided by LISA DELOZIER County Assessor

Date 04/17/2026  
 Time 07:54:16  
 Page 3

### Sketch Image

660011096

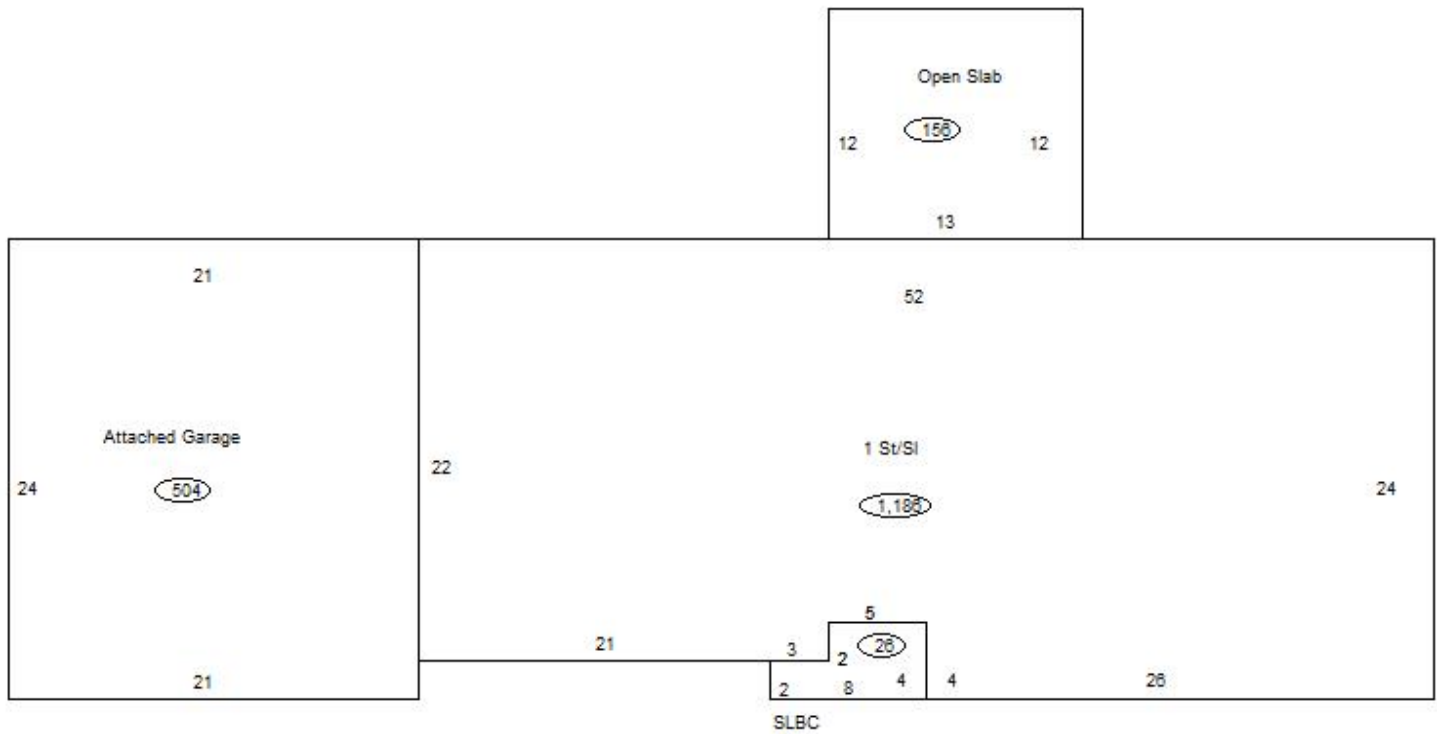

### Sketch Vector Information

Sequence	Code	Type	Built Over	Scale	Section Label	Base Area	Multiplier	Total Area
1	R	1	Slab	10	1 St/SI	1,186	1.000	1,186
2	G	1		10	Attached Garage	504	1.000	504
3	M	PRCH		10	SLBC	26	1.000	26
4	M	PATO		10	Open Slab	156	1.000	156
<b>Total Building Area</b>						1,186		1,186



# Rogers

## Assessment Property Record Card for Tax Year 2026

Data provided by LISA DELOZIER County Assessor

Date 04/17/2026  
 Time 07:54:16  
 Page 4

660011096

### Outbuildings/Site Improvements

Building Image	Code	Description	Dimensions	Floor	Roofing	Total Units
	LF	LOAFING SHED	0x0x0			180
	Qual	3	Cond 3	Year	Eff Age	
	<b>Valuation Summary</b> Base Cost (4.26 x 180) 767		<b>Modifier Total</b>	<b>RCN</b>	<b>Depr (50% Phys/ % Func)</b> 767 384	<b>RCNLD</b> 383
	DTGF	DETACHED GARAGE FAIR	0x0x0			384
	Qual	2	Cond 3	Year	Eff Age	
	<b>Valuation Summary</b> Base Cost (16.00 x 384) 6,144		<b>Modifier Total</b>	<b>RCN</b>	<b>Depr (35% Phys/ % Func)</b> 6,144 2,150	<b>RCNLD</b> 3,994