



Rogers

Assessment Property Record Card for Tax Year 2026

Data provided by LISA DELOZIER County Assessor

Date 04/16/2026
Time 21:23:31
Page 1

Assessment Data					Primary Image																																																																																																																				
Account 660011546 Parcel ID 000000-00-0-00096-001-0006 Cadastral ID 11-21-14-03650 Property Type REAL - Real Property Property Class RRP VI Area 4 Tax Area 3 - OWASSO RURAL/NO FIRE Name ID 288868 DENTON, DEAN & LISA D PO BOX 587 OWASSO OK 74055-0000 Parcel Location Situs 16333 E 112TH ST N Subdivision BUSHLAND ESTATES Lot/Block 0006 / 0001 Parcel Size 1 - Lots Sec/Twn/Rng 11 / 21 / 14 / 5 Neighborhood 1047 - R-V04-SW OWASSO School District S021 - OWASSO SCHOOLS																																																																																																																									
Legal Description Lot/Long: 36.31800366 -95.79020972																																																																																																																									
Legal Description LOT 6 BLOCK 1 BUSHLAND ESTATES					Building Permits <table border="1"> <thead> <tr> <th>Number</th> <th>Description</th> <th>Opened</th> <th>Closed</th> <th>Amount</th> </tr> </thead> <tbody> <tr> <td></td> <td></td> <td></td> <td></td> <td></td> </tr> </tbody> </table>					Number	Description	Opened	Closed	Amount																																																																																																											
Number	Description	Opened	Closed	Amount																																																																																																																					
Exemptions <table border="1"> <thead> <tr> <th>Code</th> <th>Type</th> <th>Active</th> <th>Maximum</th> <th>Exemption</th> </tr> </thead> <tbody> <tr> <td>H</td> <td>Homestead</td> <td>Yes</td> <td>1,000</td> <td>1,000</td> </tr> </tbody> </table>					Code	Type	Active	Maximum	Exemption	H	Homestead	Yes	1,000	1,000	Sale History <table border="1"> <thead> <tr> <th>Bk/Pg</th> <th>Grantor</th> <th>Date</th> <th>Price</th> <th>Code</th> </tr> </thead> <tbody> <tr> <td>1683/383</td> <td>TALLEY, MICHAEL E & SARA A</td> <td>05/26/2005</td> <td>132,000</td> <td>YES</td> </tr> <tr> <td>1021/439</td> <td>BURKHALTER, OTTWAY &</td> <td>03/28/1996</td> <td>90,000</td> <td>Yes</td> </tr> <tr> <td>952/184</td> <td>SELLER</td> <td>03/28/1994</td> <td>0</td> <td>No</td> </tr> </tbody> </table>					Bk/Pg	Grantor	Date	Price	Code	1683/383	TALLEY, MICHAEL E & SARA A	05/26/2005	132,000	YES	1021/439	BURKHALTER, OTTWAY &	03/28/1996	90,000	Yes	952/184	SELLER	03/28/1994	0	No																																																																																		
Code	Type	Active	Maximum	Exemption																																																																																																																					
H	Homestead	Yes	1,000	1,000																																																																																																																					
Bk/Pg	Grantor	Date	Price	Code																																																																																																																					
1683/383	TALLEY, MICHAEL E & SARA A	05/26/2005	132,000	YES																																																																																																																					
1021/439	BURKHALTER, OTTWAY &	03/28/1996	90,000	Yes																																																																																																																					
952/184	SELLER	03/28/1994	0	No																																																																																																																					
Parcel Valuation <table border="1"> <thead> <tr> <th>Source</th> <th>REAL</th> <th>Fair Cash</th> <th>Capped</th> <th>Asmnt Level</th> <th>Assessed</th> <th>Levy Rate</th> <th>97.960</th> <th>Current Tax</th> </tr> </thead> <tbody> <tr> <td>Remove Cap</td> <td>2006</td> <td>Land Value 93,248</td> <td>52,654</td> <td>11%</td> <td>5,792</td> <td>Assessed</td> <td>21,428</td> <td>2,099.09</td> </tr> <tr> <td>Year Frozen</td> <td>0</td> <td>Improvements 152,262</td> <td>142,143</td> <td></td> <td>15,636</td> <td>Penalty</td> <td>0</td> <td></td> </tr> <tr> <td>Uncapped Value</td> <td>0</td> <td>Mobile Home 0</td> <td>0</td> <td></td> <td>0</td> <td>Exemption</td> <td>1,000</td> <td>-98.00</td> </tr> <tr> <td>TIF Project ID</td> <td>0</td> <td>Total Value 245,510</td> <td>194,797</td> <td></td> <td>21,428</td> <td>Total Taxable</td> <td>20,428</td> <td>2,001.00</td> </tr> </tbody> </table>										Source	REAL	Fair Cash	Capped	Asmnt Level	Assessed	Levy Rate	97.960	Current Tax	Remove Cap	2006	Land Value 93,248	52,654	11%	5,792	Assessed	21,428	2,099.09	Year Frozen	0	Improvements 152,262	142,143		15,636	Penalty	0		Uncapped Value	0	Mobile Home 0	0		0	Exemption	1,000	-98.00	TIF Project ID	0	Total Value 245,510	194,797		21,428	Total Taxable	20,428	2,001.00																																																																			
Source	REAL	Fair Cash	Capped	Asmnt Level	Assessed	Levy Rate	97.960	Current Tax																																																																																																																	
Remove Cap	2006	Land Value 93,248	52,654	11%	5,792	Assessed	21,428	2,099.09																																																																																																																	
Year Frozen	0	Improvements 152,262	142,143		15,636	Penalty	0																																																																																																																		
Uncapped Value	0	Mobile Home 0	0		0	Exemption	1,000	-98.00																																																																																																																	
TIF Project ID	0	Total Value 245,510	194,797		21,428	Total Taxable	20,428	2,001.00																																																																																																																	
Assessment History <table border="1"> <thead> <tr> <th>Tax Year</th> <th>Statement Number</th> <th>Billed Owner</th> <th>Tax Area</th> <th>Total Value</th> <th>Exemptions</th> <th>Taxable Value</th> <th>Billed Tax</th> </tr> </thead> <tbody> <tr><td>2025</td><td>2025-660011546</td><td>DENTON, DEAN &</td><td>3</td><td>240,237</td><td>1000</td><td>19,803</td><td>1,940.00</td></tr> <tr><td>2024</td><td>2024-660011546</td><td>DENTON, DEAN &</td><td>3</td><td>264,084</td><td>1000</td><td>19,197</td><td>1,844.00</td></tr> <tr><td>2023</td><td>2023-660011546</td><td>DENTON, DEAN &</td><td>3</td><td>197,535</td><td>1000</td><td>18,610</td><td>1,744.00</td></tr> <tr><td>2022</td><td>2022-660011546</td><td>DENTON, DEAN &</td><td>3</td><td>174,902</td><td>1000</td><td>18,038</td><td>1,767.00</td></tr> <tr><td>2021</td><td>2021-660011546</td><td>DENTON, DEAN &</td><td>3</td><td>168,035</td><td>1000</td><td>17,484</td><td>1,691.00</td></tr> <tr><td>2020</td><td>2020-660011546</td><td>DENTON, DEAN &</td><td>3</td><td>169,110</td><td>1000</td><td>17,248</td><td>1,666.00</td></tr> <tr><td>2019</td><td>2019-660011546</td><td>DENTON, DEAN &</td><td>3</td><td>161,056</td><td>1000</td><td>16,716</td><td>1,616.00</td></tr> <tr><td>2018</td><td>2018-660011546</td><td>DENTON, DEAN &</td><td>3</td><td>165,733</td><td>1000</td><td>17,231</td><td>1,604.00</td></tr> <tr><td>2017</td><td>2017-660011546</td><td>DENTON, DEAN &</td><td>3</td><td>164,424</td><td>1000</td><td>17,087</td><td>1,607.00</td></tr> <tr><td>2016</td><td>2016-660011546</td><td>DENTON, DEAN &</td><td>3</td><td>160,421</td><td>1000</td><td>16,646</td><td>1,567.00</td></tr> <tr><td>2015</td><td>2015-660011546</td><td>DENTON, DEAN &</td><td>3</td><td>160,750</td><td>1000</td><td>16,224</td><td>1,539.00</td></tr> <tr><td>2014</td><td>2014-660011546</td><td>DENTON, DEAN &</td><td>3</td><td>163,549</td><td>1000</td><td>15,722</td><td>1,505.00</td></tr> <tr><td>2013</td><td>2013-660011546</td><td>DENTON, DEAN &</td><td>3</td><td>147,592</td><td>1000</td><td>15,235</td><td>1,427.00</td></tr> </tbody> </table>										Tax Year	Statement Number	Billed Owner	Tax Area	Total Value	Exemptions	Taxable Value	Billed Tax	2025	2025-660011546	DENTON, DEAN &	3	240,237	1000	19,803	1,940.00	2024	2024-660011546	DENTON, DEAN &	3	264,084	1000	19,197	1,844.00	2023	2023-660011546	DENTON, DEAN &	3	197,535	1000	18,610	1,744.00	2022	2022-660011546	DENTON, DEAN &	3	174,902	1000	18,038	1,767.00	2021	2021-660011546	DENTON, DEAN &	3	168,035	1000	17,484	1,691.00	2020	2020-660011546	DENTON, DEAN &	3	169,110	1000	17,248	1,666.00	2019	2019-660011546	DENTON, DEAN &	3	161,056	1000	16,716	1,616.00	2018	2018-660011546	DENTON, DEAN &	3	165,733	1000	17,231	1,604.00	2017	2017-660011546	DENTON, DEAN &	3	164,424	1000	17,087	1,607.00	2016	2016-660011546	DENTON, DEAN &	3	160,421	1000	16,646	1,567.00	2015	2015-660011546	DENTON, DEAN &	3	160,750	1000	16,224	1,539.00	2014	2014-660011546	DENTON, DEAN &	3	163,549	1000	15,722	1,505.00	2013	2013-660011546	DENTON, DEAN &	3	147,592	1000	15,235	1,427.00
Tax Year	Statement Number	Billed Owner	Tax Area	Total Value	Exemptions	Taxable Value	Billed Tax																																																																																																																		
2025	2025-660011546	DENTON, DEAN &	3	240,237	1000	19,803	1,940.00																																																																																																																		
2024	2024-660011546	DENTON, DEAN &	3	264,084	1000	19,197	1,844.00																																																																																																																		
2023	2023-660011546	DENTON, DEAN &	3	197,535	1000	18,610	1,744.00																																																																																																																		
2022	2022-660011546	DENTON, DEAN &	3	174,902	1000	18,038	1,767.00																																																																																																																		
2021	2021-660011546	DENTON, DEAN &	3	168,035	1000	17,484	1,691.00																																																																																																																		
2020	2020-660011546	DENTON, DEAN &	3	169,110	1000	17,248	1,666.00																																																																																																																		
2019	2019-660011546	DENTON, DEAN &	3	161,056	1000	16,716	1,616.00																																																																																																																		
2018	2018-660011546	DENTON, DEAN &	3	165,733	1000	17,231	1,604.00																																																																																																																		
2017	2017-660011546	DENTON, DEAN &	3	164,424	1000	17,087	1,607.00																																																																																																																		
2016	2016-660011546	DENTON, DEAN &	3	160,421	1000	16,646	1,567.00																																																																																																																		
2015	2015-660011546	DENTON, DEAN &	3	160,750	1000	16,224	1,539.00																																																																																																																		
2014	2014-660011546	DENTON, DEAN &	3	163,549	1000	15,722	1,505.00																																																																																																																		
2013	2013-660011546	DENTON, DEAN &	3	147,592	1000	15,235	1,427.00																																																																																																																		



Rogers

Assessment Property Record Card for Tax Year 2026

Data provided by LISA DELOZIER County Assessor

Date 04/16/2026
Time 21:23:31
Page 2

Lot Data	Square-Foot - NBHD 1047 #1	Primary Image
Lot Size		
Lot Count	1	
Units Buildable	1	
Non-Ag Acres	1.2749	
Topography		
Street Access		
Utilities		
Amenities	0	
	0	
Method	Square-Foot	
Base Lot Value	55,535.00 x 1.68 = 93,248	
Factor Value		
Adjustments	1.0000	
Lot Value	93,248	

Residential Data	
Type	1 Single Family Residence
Condition	3 - Average
Quality	3 - Average
Architecture	
Style	100% One Story
Exterior Wall	100% Veneer, Stone
Base/Total Area	1,692 / 1,692
Style	100% One Story
HVAC	100% Warmed & Cooled Air
Roof Cover	1 Composition Shingle
Area on Slab	1,692
Fixture/RghIn	8 /
Bed/F/H Bath	3 / 2.0 /
Basement Area	
Garage Type	1,014 Attached Garage - Unfinished
Remodel	
Year/Eff Age	1974 / 39

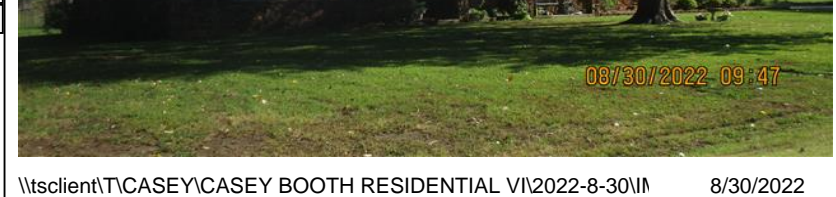

\\tsclient\TCASEY\CASEY BOOTH RESIDENTIAL VI\2022-8-30\ 8/30/2022

GRM Approach	
GRM Code	
Gross Rent	0.00
Indicated Value	

Multiple Regression			
MRA Code	1	Test	
Adjusted R	0.8445		
Indicated Value	236,385	139.71	Per SqFt

Direct Comparables	
Selection Model	A Adam Test
Adjustment Model	1 2022 Residential
Comparables	6
Indicated Value	273,260 Per SqFt

Value Reconciliation			
Selected Approach	Cost Approach		
Improvements	152,262		
Lot Value	93,248		
Indicated Value	245,510	145.10	Per SqFt
Agland Value			
Site Improvements			
Total Value	245,510	145.10	Total Value Per SqFt

Cost Approach				Manual : 01/2025			
Base Cost	117.08	Total Misc Impr	+	16,469			
Roofing Adj	+ 4.86	Garage Cost	+	30,207			
Subfloor Adj	+ -2.31	Total RCN	=	281,966			
Heat/Cool Adj	+ 12.64	Depreciation (46%)	-	129,704			
Plumbing Adj	+ 6.79	Lump Sums	+	0			
Basement Adj	+ 0.00	RCNLD	=	152,262			
Adj Base Cost	= 139.06	Lot Value	+	93,248			
Total Area	x 1,692	Indicated Value	=	245,510			
Adjusted Cost	= 235,290	Value Per SqFt		145.10			

Miscellaneous Improvements								
Code	Description	Sketch ID	Size	Year	Units	Unit Cost	Depr	Value
FPR1	FIREPLACE - RESIDENTIAL 1 STORY	0		1	1	5,615.40		5,615
PRCH	SLAB PORCH - COVERED	27224		96	96	26.63		2,556
PRCH	SLAB PORCH - COVERED	27225	20x16		320	25.93		8,298



Rogers

Assessment Property Record Card for Tax Year 2026

Data provided by LISA DELOZIER County Assessor

Date 04/16/2026
 Time 21:23:31
 Page 3

Sketch Image

660011546

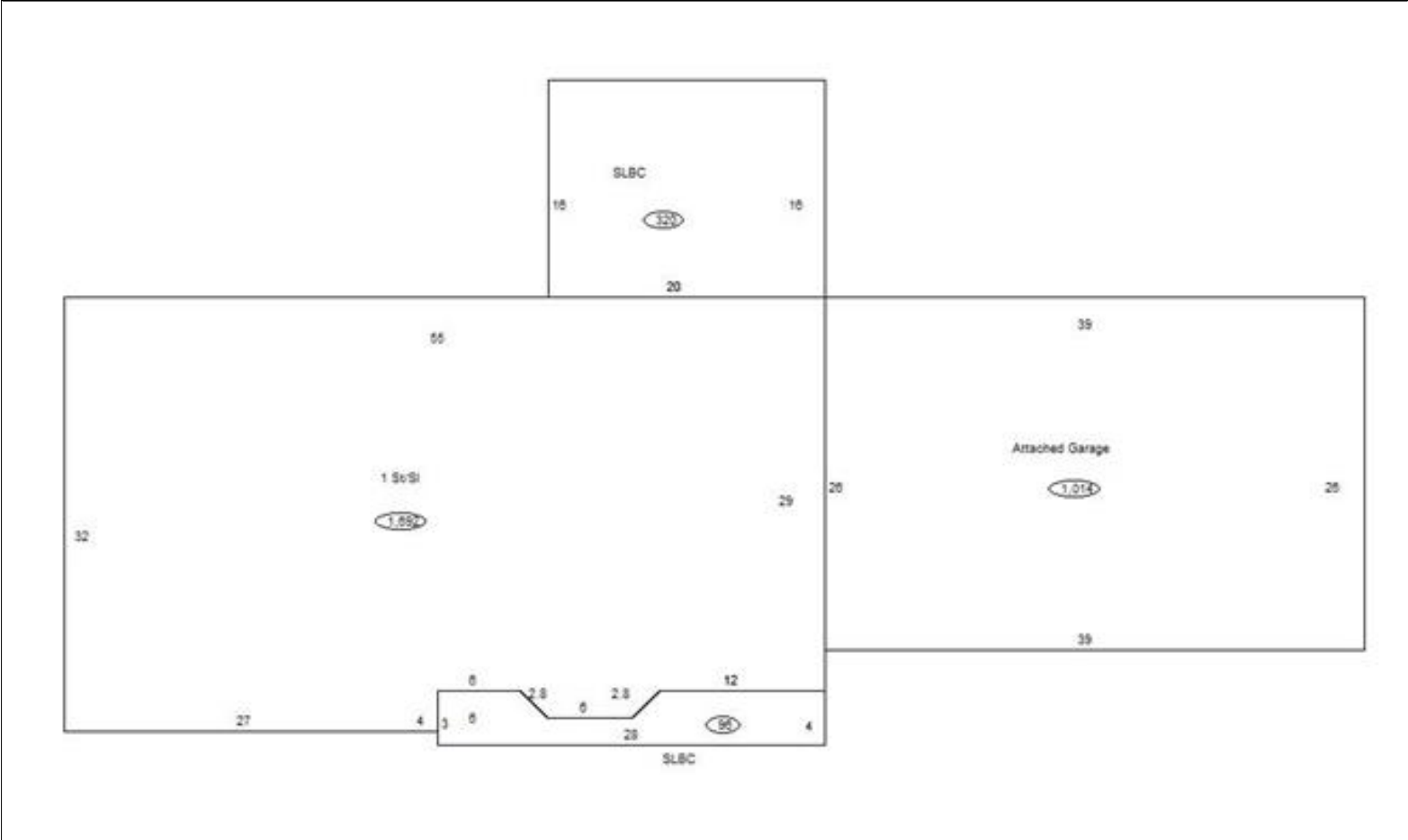

Sketch Vector Information

Sequence	Code	Type	Built Over	Scale	Section Label	Base Area	Multiplier	Total Area
1	R	1	Slab	10	1 St/SI	1,692	1.000	1,692
2	G	1		10	Attached Garage	1,014	1.000	1,014
3	M	PRCH		10	SLBC	96	1.000	96
4	M	PRCH		10	SLBC	320	1.000	320
Total Building Area						1,692		1,692