



Rogers

Assessment Property Record Card for Tax Year 2026

Data provided by LISA DELOZIER County Assessor

Date 04/16/2026
Time 21:24:38
Page 1

Assessment Data					Primary Image																																																																																																																				
Account 660011666 Parcel ID 000000-00-0-00801-002-0006 Cadastral ID 11-21-14-04850 Property Type REAL - Real Property Property Class RRP VI Area 4 Tax Area 3 - OWASSO RURAL/NO FIRE Name ID 272846 BOGGS, JINA E & HANS-PETER REVOCABLE LIVING TRUST 10917 N 173 E AVE OWASSO OK 74055-0000 Parcel Location Situs 10917 N 173RD E AVE Subdivision SUNRISE ESTATES Lot/Block 0006 / 0002 Parcel Size 1 - Lots Sec/Twn/Rng 11 / 21 / 14 / 5 Neighborhood 1047 - R-V04-SW OWASSO School District S021 - OWASSO SCHOOLS																																																																																																																									
Legal Description Lot/Long: 36.31257929 -95.77922079																																																																																																																									
Building Permits					\\tsclient\TCASEY\CASEY BOOTH RESIDENTIAL VI\2022-9-2\IM 9/6/2022																																																																																																																				
Exemptions					Sale History																																																																																																																				
<table border="1"> <thead> <tr> <th>Code</th> <th>Type</th> <th>Active</th> <th>Maximum</th> <th>Exemption</th> </tr> </thead> <tbody> <tr> <td>H</td> <td>Homestead</td> <td>Yes</td> <td>1,000</td> <td>1,000</td> </tr> </tbody> </table>					Code	Type	Active	Maximum	Exemption	H	Homestead	Yes	1,000	1,000	<table border="1"> <thead> <tr> <th>Number</th> <th>Description</th> <th>Opened</th> <th>Closed</th> <th>Amount</th> </tr> </thead> <tbody> <tr> <td>1205/850</td> <td>LANSFORD, RICHARD S</td> <td>09/07/1999</td> <td></td> <td>115,000</td> </tr> </tbody> </table>					Number	Description	Opened	Closed	Amount	1205/850	LANSFORD, RICHARD S	09/07/1999		115,000																																																																																												
Code	Type	Active	Maximum	Exemption																																																																																																																					
H	Homestead	Yes	1,000	1,000																																																																																																																					
Number	Description	Opened	Closed	Amount																																																																																																																					
1205/850	LANSFORD, RICHARD S	09/07/1999		115,000																																																																																																																					
Parcel Valuation					<table border="1"> <thead> <tr> <th>Source</th> <th>REAL</th> <th>Fair Cash</th> <th>Capped</th> <th>Asmnt Level</th> <th>Assessed</th> <th>Levy Rate</th> <th>97.960</th> <th>Current Tax</th> </tr> </thead> <tbody> <tr> <td>Remove Cap</td> <td>2000</td> <td>Land Value 84,332</td> <td>46,826</td> <td>11%</td> <td>5,151</td> <td>Assessed</td> <td>20,882</td> <td>2,045.60</td> </tr> <tr> <td>Year Frozen</td> <td>0</td> <td>Improvements 152,814</td> <td>143,011</td> <td></td> <td>15,731</td> <td>Penalty</td> <td>0</td> <td></td> </tr> <tr> <td>Uncapped Value</td> <td>0</td> <td>Mobile Home 0</td> <td>0</td> <td></td> <td>0</td> <td>Exemption</td> <td>1,000</td> <td>-98.00</td> </tr> <tr> <td>TIF Project ID</td> <td>0</td> <td>Total Value 237,146</td> <td>189,837</td> <td></td> <td>20,882</td> <td>Total Taxable</td> <td>19,882</td> <td>1,948.00</td> </tr> </tbody> </table>					Source	REAL	Fair Cash	Capped	Asmnt Level	Assessed	Levy Rate	97.960	Current Tax	Remove Cap	2000	Land Value 84,332	46,826	11%	5,151	Assessed	20,882	2,045.60	Year Frozen	0	Improvements 152,814	143,011		15,731	Penalty	0		Uncapped Value	0	Mobile Home 0	0		0	Exemption	1,000	-98.00	TIF Project ID	0	Total Value 237,146	189,837		20,882	Total Taxable	19,882	1,948.00																																																																			
Source	REAL	Fair Cash	Capped	Asmnt Level	Assessed	Levy Rate	97.960	Current Tax																																																																																																																	
Remove Cap	2000	Land Value 84,332	46,826	11%	5,151	Assessed	20,882	2,045.60																																																																																																																	
Year Frozen	0	Improvements 152,814	143,011		15,731	Penalty	0																																																																																																																		
Uncapped Value	0	Mobile Home 0	0		0	Exemption	1,000	-98.00																																																																																																																	
TIF Project ID	0	Total Value 237,146	189,837		20,882	Total Taxable	19,882	1,948.00																																																																																																																	
Assessment History					<table border="1"> <thead> <tr> <th>Tax Year</th> <th>Statement Number</th> <th>Billed Owner</th> <th>Tax Area</th> <th>Total Value</th> <th>Exemptions</th> <th>Taxable Value</th> <th>Billed Tax</th> </tr> </thead> <tbody> <tr><td>2025</td><td>2025-660011666</td><td>BOGGS, JINA E & HANS-PETER</td><td>3</td><td>232,172</td><td>1000</td><td>19,274</td><td>1,888.00</td></tr> <tr><td>2024</td><td>2024-660011666</td><td>BOGGS, HANS-PETER &</td><td>3</td><td>255,563</td><td>1000</td><td>18,684</td><td>1,795.00</td></tr> <tr><td>2023</td><td>2023-660011666</td><td>BOGGS, HANS-PETER &</td><td>3</td><td>198,347</td><td>1000</td><td>18,110</td><td>1,697.00</td></tr> <tr><td>2022</td><td>2022-660011666</td><td>BOGGS, HANS-PETER &</td><td>3</td><td>168,669</td><td>1000</td><td>17,554</td><td>1,720.00</td></tr> <tr><td>2021</td><td>2021-660011666</td><td>BOGGS, HANS-PETER &</td><td>3</td><td>181,711</td><td>1000</td><td>17,895</td><td>1,731.00</td></tr> <tr><td>2020</td><td>2020-660011666</td><td>BOGGS, HANS-PETER &</td><td>3</td><td>170,016</td><td>1000</td><td>17,345</td><td>1,676.00</td></tr> <tr><td>2019</td><td>2019-660011666</td><td>BOGGS, HANS-PETER &</td><td>3</td><td>161,916</td><td>1000</td><td>16,811</td><td>1,625.00</td></tr> <tr><td>2018</td><td>2018-660011666</td><td>BOGGS, HANS-PETER &</td><td>3</td><td>168,395</td><td>1000</td><td>17,489</td><td>1,628.00</td></tr> <tr><td>2017</td><td>2017-660011666</td><td>BOGGS, HANS-PETER &</td><td>3</td><td>166,928</td><td>1000</td><td>16,952</td><td>1,595.00</td></tr> <tr><td>2016</td><td>2016-660011666</td><td>BOGGS, HANS-PETER &</td><td>3</td><td>162,669</td><td>1000</td><td>16,428</td><td>1,547.00</td></tr> <tr><td>2015</td><td>2015-660011666</td><td>BOGGS, HANS-PETER &</td><td>3</td><td>158,746</td><td>1000</td><td>15,920</td><td>1,510.00</td></tr> <tr><td>2014</td><td>2014-660011666</td><td>BOGGS, HANS-PETER &</td><td>3</td><td>168,899</td><td>1000</td><td>15,428</td><td>1,477.00</td></tr> <tr><td>2013</td><td>2013-660011666</td><td>BOGGS, HANS-PETER &</td><td>3</td><td>154,769</td><td>1000</td><td>14,950</td><td>1,401.00</td></tr> </tbody> </table>					Tax Year	Statement Number	Billed Owner	Tax Area	Total Value	Exemptions	Taxable Value	Billed Tax	2025	2025-660011666	BOGGS, JINA E & HANS-PETER	3	232,172	1000	19,274	1,888.00	2024	2024-660011666	BOGGS, HANS-PETER &	3	255,563	1000	18,684	1,795.00	2023	2023-660011666	BOGGS, HANS-PETER &	3	198,347	1000	18,110	1,697.00	2022	2022-660011666	BOGGS, HANS-PETER &	3	168,669	1000	17,554	1,720.00	2021	2021-660011666	BOGGS, HANS-PETER &	3	181,711	1000	17,895	1,731.00	2020	2020-660011666	BOGGS, HANS-PETER &	3	170,016	1000	17,345	1,676.00	2019	2019-660011666	BOGGS, HANS-PETER &	3	161,916	1000	16,811	1,625.00	2018	2018-660011666	BOGGS, HANS-PETER &	3	168,395	1000	17,489	1,628.00	2017	2017-660011666	BOGGS, HANS-PETER &	3	166,928	1000	16,952	1,595.00	2016	2016-660011666	BOGGS, HANS-PETER &	3	162,669	1000	16,428	1,547.00	2015	2015-660011666	BOGGS, HANS-PETER &	3	158,746	1000	15,920	1,510.00	2014	2014-660011666	BOGGS, HANS-PETER &	3	168,899	1000	15,428	1,477.00	2013	2013-660011666	BOGGS, HANS-PETER &	3	154,769	1000	14,950	1,401.00
Tax Year	Statement Number	Billed Owner	Tax Area	Total Value	Exemptions	Taxable Value	Billed Tax																																																																																																																		
2025	2025-660011666	BOGGS, JINA E & HANS-PETER	3	232,172	1000	19,274	1,888.00																																																																																																																		
2024	2024-660011666	BOGGS, HANS-PETER &	3	255,563	1000	18,684	1,795.00																																																																																																																		
2023	2023-660011666	BOGGS, HANS-PETER &	3	198,347	1000	18,110	1,697.00																																																																																																																		
2022	2022-660011666	BOGGS, HANS-PETER &	3	168,669	1000	17,554	1,720.00																																																																																																																		
2021	2021-660011666	BOGGS, HANS-PETER &	3	181,711	1000	17,895	1,731.00																																																																																																																		
2020	2020-660011666	BOGGS, HANS-PETER &	3	170,016	1000	17,345	1,676.00																																																																																																																		
2019	2019-660011666	BOGGS, HANS-PETER &	3	161,916	1000	16,811	1,625.00																																																																																																																		
2018	2018-660011666	BOGGS, HANS-PETER &	3	168,395	1000	17,489	1,628.00																																																																																																																		
2017	2017-660011666	BOGGS, HANS-PETER &	3	166,928	1000	16,952	1,595.00																																																																																																																		
2016	2016-660011666	BOGGS, HANS-PETER &	3	162,669	1000	16,428	1,547.00																																																																																																																		
2015	2015-660011666	BOGGS, HANS-PETER &	3	158,746	1000	15,920	1,510.00																																																																																																																		
2014	2014-660011666	BOGGS, HANS-PETER &	3	168,899	1000	15,428	1,477.00																																																																																																																		
2013	2013-660011666	BOGGS, HANS-PETER &	3	154,769	1000	14,950	1,401.00																																																																																																																		



Rogers

Assessment Property Record Card for Tax Year 2026

Data provided by LISA DELOZIER County Assessor

Date 04/16/2026
Time 21:24:38
Page 2

Lot Data	Square-Foot - NBHD 1047 #1	Primary Image
Lot Size		
Lot Count	1	
Units Buildable	1	
Non-Ag Acres	1.0854	
Topography		
Street Access		
Utilities		
Amenities	0	
	0	
Method	Square-Foot	
Base Lot Value	47,280.00 x 1.78 = 84,332	
Factor Value		
Adjustments	1.0000	
Lot Value	84,332	

Residential Data	
Type	1 Single Family Residence
Condition	2.5 - Fair
Quality	3 - Average
Architecture	
Style	100% 1 1/2 Story Finished
Exterior Wall	20% Veneer, Masonry 80% Frame, Siding, Wood
Base/Total Area	1,684 / 2,164
Style	100% 1 1/2 Story Finished
HVAC	100% Warmed & Cooled Air
Roof Cover	1 Composition Shingle
Area on Slab	1,684
Fixture/RghIn	11 /
Bed/F/H Bath	3 / 2.0 /
Basement Area	
Garage Type	552 Attached Garage - Unfinished
Remodel	
Year/Eff Age	1984 / 37



\\tsclient\TCASEY\CASEY BOOTH RESIDENTIAL VI\2022-9-2\IM 9/6/2022

GRM Approach	
GRM Code	
Gross Rent	0.00
Indicated Value	

Multiple Regression			
MRA Code	1	Test	
Adusted R	0.8445		
Indicated Value	241,178	111.45	Per SqFt

Direct Comparables	
Selection Model	A Adam Test
Adjustment Model	1 2022 Residential
Comparables	6
Indicated Value	286,480 Per SqFt

Value Reconciliation			
Selected Approach	Cost Approach		
Improvements	150,885		
Lot Value	84,332		
Indicated Value	235,217	108.70	Per SqFt
Agland Value			
Site Improvements	1,929		
Total Value	237,146	109.59	Total Value Per SqFt

Cost Approach				Manual : 01/2025			
Base Cost	87.17	Total Misc Impr	+ 16,783				
Roofing Adj	+ 3.62	Garage Cost	+ 17,211				
Subfloor Adj	+ -1.80	Total RCN	= 269,437				
Heat/Cool Adj	+ 12.64	Depreciation (44%)	- 118,552				
Plumbing Adj	+ 7.17	Lump Sums	+ 0				
Basement Adj	+ 0.00	RCNLD	= 150,885				
Adj Base Cost	= 108.80	Lot Value	+ 84,332				
Total Area	x 2,164	Indicated Value	= 235,217				
Adjusted Cost	= 235,443	Value Per SqFt	108.70				

Miscellaneous Improvements								
Code	Description	Sketch ID	Size	Year	Units	Unit Cost	Depr	Value
FPR1	FIREPLACE - RESIDENTIAL 1 STORY	0		1	1	5,615.40		5,615
PRCH	SLAB PORCH - COVERED	27597	44x8		352	25.83		9,092
PATO	SLAB PORCH - OPEN	27598	14x14		196	10.59		2,076



Rogers

Assessment Property Record Card for Tax Year 2026

Data provided by LISA DELOZIER County Assessor

Date 04/16/2026

Time 21:24:38

Page 3

Sketch Image

660011666

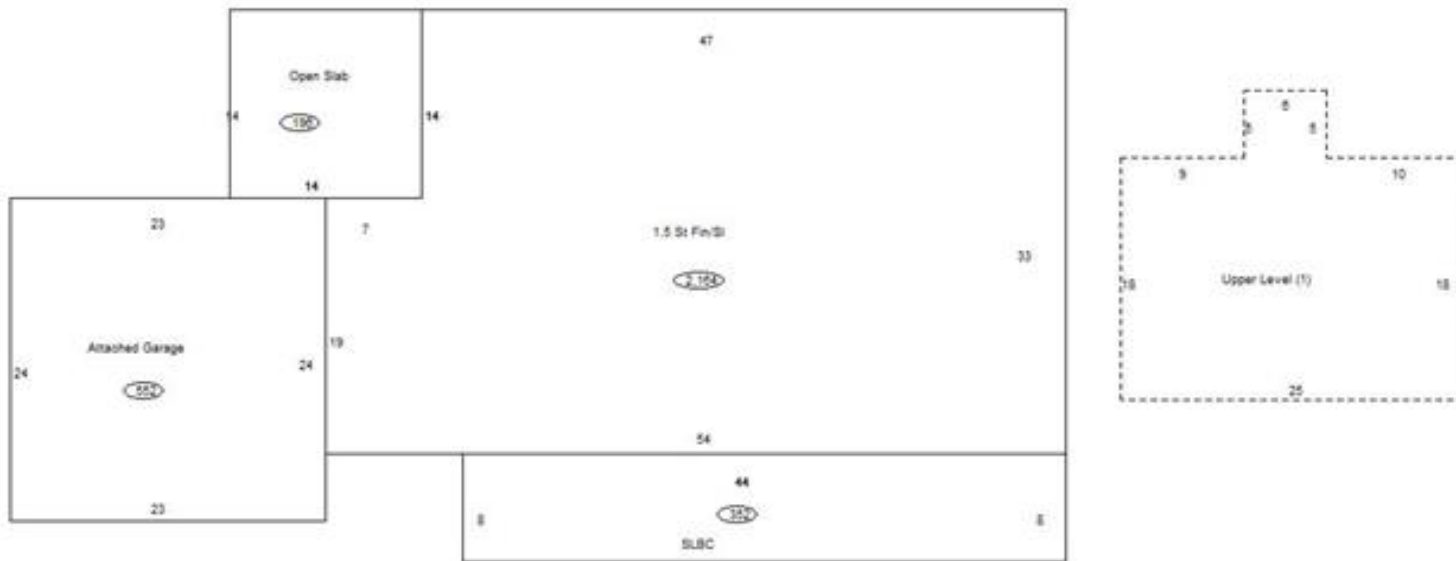

Sketch Vector Information

Sequence	Code	Type	Built Over	Scale	Section Label	Base Area	Multiplier	Total Area
1	R	5	Slab	10	1.5 St Fin/SI	1,684	1.285	2,164
2	G	1		10	Attached Garage	552	1.000	552
3	M	PRCH		10	SLBC	352	1.000	352
4	M	PATO		10	Open Slab	196	1.000	196
5	U	^UL		10	Upper Level (1)	480	1.000	480
Total Building Area						1,684		2,164



Rogers

Assessment Property Record Card for Tax Year 2026

Data provided by LISA DELOZIER County Assessor

Date 04/16/2026
Time 21:24:38
Page 4

660011666

Outbuildings/Site Improvements

Building Image	Code	Description	Dimensions	Floor	Roofing	Total Units
	STF	STG FAIR	0x0x0			448
	Qual 2	Cond 3	Year	Eff Age		

Valuation Summary	Modifier Total	RCN	Depr (8% Phys/ % Func)	RCNLD
Base Cost (4.68 x 448) 2,097			2,097 168	1,929



STF	STG FAIR	10x12x0			120
Qual 2	Cond 2	Year	Eff Age 2026		

Valuation Summary	Modifier Total	RCN	Depr (100% Phys/ % Func)	RCNLD
Base Cost (4.68 x 120) 562			562 562	