



Rogers

Assessment Property Record Card for Tax Year 2026

Data provided by LISA DELOZIER County Assessor

Date 04/16/2026
Time 23:38:39
Page 1

Assessment Data					Primary Image																																																																																																																				
Account 660011700 Parcel ID 000000-00-0-00873-002-0005 Cadastral ID 11-21-14-05190 Property Type REAL - Real Property Property Class RRP VI Area 4 Tax Area 3 - OWASSO RURAL/NO FIRE Name ID 313871 LAY, TYLER 10629 N 166TH E AVE OWASSO OK 74055-0000 Parcel Location Situs 10629 N 166TH E AVE Subdivision VILLAGE Lot/Block 0005 / 0002 Parcel Size 1 - Lots Sec/Twn/Rng 11 / 21 / 14 / 5 Neighborhood 1047 - R-V04-SW OWASSO School District S021 - OWASSO SCHOOLS																																																																																																																									
Legal Description Lot/Long: 36.30959135 -95.78795191																																																																																																																									
Building Permits					<table border="1"> <thead> <tr> <th>Number</th> <th>Description</th> <th>Opened</th> <th>Closed</th> <th>Amount</th> </tr> </thead> <tbody> <tr> <td colspan="5"> </td> </tr> </tbody> </table>					Number	Description	Opened	Closed	Amount																																																																																																											
Number	Description	Opened	Closed	Amount																																																																																																																					
Exemptions					Sale History																																																																																																																				
<table border="1"> <thead> <tr> <th>Code</th> <th>Type</th> <th>Active</th> <th>Maximum</th> <th>Exemption</th> </tr> </thead> <tbody> <tr> <td>H</td> <td>Homestead</td> <td>No</td> <td>1,000</td> <td></td> </tr> </tbody> </table>					Code	Type	Active	Maximum	Exemption	H	Homestead	No	1,000		<table border="1"> <thead> <tr> <th>Bk/Pg</th> <th>Grantor</th> <th>Date</th> <th>Price</th> <th>Code</th> </tr> </thead> <tbody> <tr> <td>2439/464</td> <td>FEDERAL NATIONAL MORTGAGE ASS</td> <td>11/14/2014</td> <td>107,000</td> <td>15</td> </tr> <tr> <td>2416/436</td> <td>MORRIS, JOANNE K</td> <td>07/23/2014</td> <td>0</td> <td>10</td> </tr> <tr> <td>1413/153</td> <td>RUSK, BRIAN & JUDY</td> <td>10/04/2002</td> <td>123,000</td> <td>YES</td> </tr> <tr> <td>1042/70</td> <td>MATHERS, WILLIAM B</td> <td>08/22/1996</td> <td>85,500</td> <td>Yes</td> </tr> <tr> <td>985/888</td> <td>HEROD, TROY M &</td> <td>03/31/1995</td> <td>80,000</td> <td>Yes</td> </tr> <tr> <td>935/384</td> <td>SMITH, ROBERT E</td> <td>10/22/1993</td> <td>79,000</td> <td>Yes</td> </tr> </tbody> </table>					Bk/Pg	Grantor	Date	Price	Code	2439/464	FEDERAL NATIONAL MORTGAGE ASS	11/14/2014	107,000	15	2416/436	MORRIS, JOANNE K	07/23/2014	0	10	1413/153	RUSK, BRIAN & JUDY	10/04/2002	123,000	YES	1042/70	MATHERS, WILLIAM B	08/22/1996	85,500	Yes	985/888	HEROD, TROY M &	03/31/1995	80,000	Yes	935/384	SMITH, ROBERT E	10/22/1993	79,000	Yes																																																																			
Code	Type	Active	Maximum	Exemption																																																																																																																					
H	Homestead	No	1,000																																																																																																																						
Bk/Pg	Grantor	Date	Price	Code																																																																																																																					
2439/464	FEDERAL NATIONAL MORTGAGE ASS	11/14/2014	107,000	15																																																																																																																					
2416/436	MORRIS, JOANNE K	07/23/2014	0	10																																																																																																																					
1413/153	RUSK, BRIAN & JUDY	10/04/2002	123,000	YES																																																																																																																					
1042/70	MATHERS, WILLIAM B	08/22/1996	85,500	Yes																																																																																																																					
985/888	HEROD, TROY M &	03/31/1995	80,000	Yes																																																																																																																					
935/384	SMITH, ROBERT E	10/22/1993	79,000	Yes																																																																																																																					
Parcel Valuation																																																																																																																									
<table border="1"> <thead> <tr> <th>Source</th> <th>REAL</th> </tr> </thead> <tbody> <tr> <td>Remove Cap</td> <td>2015</td> </tr> <tr> <td>Year Frozen</td> <td>0</td> </tr> <tr> <td>Uncapped Value</td> <td>0</td> </tr> <tr> <td>TIF Project ID</td> <td>0</td> </tr> </tbody> </table>		Source	REAL	Remove Cap	2015	Year Frozen	0	Uncapped Value	0	TIF Project ID	0	<table border="1"> <thead> <tr> <th>Fair Cash</th> <th>Capped</th> <th>Asmnt Level</th> <th>Assessed</th> </tr> </thead> <tbody> <tr> <td>Land Value</td> <td>92,267</td> <td>38,996</td> <td>11%</td> <td>4,290</td> </tr> <tr> <td>Improvements</td> <td>127,301</td> <td>121,658</td> <td>13,382</td> <td></td> </tr> <tr> <td>Mobile Home</td> <td>0</td> <td>0</td> <td>0</td> <td></td> </tr> <tr> <td>Total Value</td> <td>219,568</td> <td>160,654</td> <td>17,672</td> <td></td> </tr> </tbody> </table>			Fair Cash	Capped	Asmnt Level	Assessed	Land Value	92,267	38,996	11%	4,290	Improvements	127,301	121,658	13,382		Mobile Home	0	0	0		Total Value	219,568	160,654	17,672		<table border="1"> <thead> <tr> <th>Levy Rate</th> <th>Current Tax</th> </tr> </thead> <tbody> <tr> <td>97.960</td> <td></td> </tr> <tr> <td>Assessed</td> <td>17,672</td> </tr> <tr> <td>Penalty</td> <td>0</td> </tr> <tr> <td>Exemption</td> <td>0</td> </tr> <tr> <td>Total Taxable</td> <td>17,672</td> </tr> </tbody> </table>		Levy Rate	Current Tax	97.960		Assessed	17,672	Penalty	0	Exemption	0	Total Taxable	17,672																																																																					
Source	REAL																																																																																																																								
Remove Cap	2015																																																																																																																								
Year Frozen	0																																																																																																																								
Uncapped Value	0																																																																																																																								
TIF Project ID	0																																																																																																																								
Fair Cash	Capped	Asmnt Level	Assessed																																																																																																																						
Land Value	92,267	38,996	11%	4,290																																																																																																																					
Improvements	127,301	121,658	13,382																																																																																																																						
Mobile Home	0	0	0																																																																																																																						
Total Value	219,568	160,654	17,672																																																																																																																						
Levy Rate	Current Tax																																																																																																																								
97.960																																																																																																																									
Assessed	17,672																																																																																																																								
Penalty	0																																																																																																																								
Exemption	0																																																																																																																								
Total Taxable	17,672																																																																																																																								
Assessment History																																																																																																																									
<table border="1"> <thead> <tr> <th>Tax Year</th> <th>Statement Number</th> <th>Billed Owner</th> <th>Tax Area</th> <th>Total Value</th> <th>Exemptions</th> <th>Taxable Value</th> <th>Billed Tax</th> </tr> </thead> <tbody> <tr><td>2025</td><td>2025-660011700</td><td>LAY, TYLER</td><td>3</td><td>213,070</td><td>0</td><td>16,830</td><td>1,649.00</td></tr> <tr><td>2024</td><td>2024-660011700</td><td>LAY, TYLER</td><td>3</td><td>234,960</td><td>0</td><td>16,029</td><td>1,540.00</td></tr> <tr><td>2023</td><td>2023-660011700</td><td>LAY, TYLER</td><td>3</td><td>139,089</td><td>0</td><td>15,265</td><td>1,430.00</td></tr> <tr><td>2022</td><td>2022-660011700</td><td>LAY, TYLER</td><td>3</td><td>132,172</td><td>0</td><td>14,539</td><td>1,424.00</td></tr> <tr><td>2021</td><td>2021-660011700</td><td>LAY, TYLER</td><td>3</td><td>142,977</td><td>0</td><td>15,727</td><td>1,521.00</td></tr> <tr><td>2020</td><td>2020-660011700</td><td>LAY, TYLER</td><td>3</td><td>140,743</td><td>0</td><td>15,482</td><td>1,496.00</td></tr> <tr><td>2019</td><td>2019-660011700</td><td>LAY, TYLER</td><td>3</td><td>135,549</td><td>0</td><td>14,910</td><td>1,441.00</td></tr> <tr><td>2018</td><td>2018-660011700</td><td>LAY, TYLER</td><td>3</td><td>140,926</td><td>0</td><td>15,502</td><td>1,443.00</td></tr> <tr><td>2017</td><td>2017-660011700</td><td>LAY, TYLER</td><td>3</td><td>139,794</td><td>0</td><td>15,377</td><td>1,446.00</td></tr> <tr><td>2016</td><td>2016-660011700</td><td>LAY, TYLER</td><td>3</td><td>136,400</td><td>0</td><td>15,004</td><td>1,413.00</td></tr> <tr><td>2015</td><td>2015-660011700</td><td>LAY, TYLER</td><td>3</td><td>133,727</td><td>0</td><td>14,710</td><td>1,395.00</td></tr> <tr><td>2014</td><td>2014-660011700</td><td>FEDERAL NATIONAL MORTGAGE ASSOC</td><td>3</td><td>134,786</td><td>1000</td><td>12,776</td><td>1,223.00</td></tr> <tr><td>2013</td><td>2013-660011700</td><td>MORRIS, JOANNE K</td><td>3</td><td>121,585</td><td>1000</td><td>12,374</td><td>1,159.00</td></tr> </tbody> </table>										Tax Year	Statement Number	Billed Owner	Tax Area	Total Value	Exemptions	Taxable Value	Billed Tax	2025	2025-660011700	LAY, TYLER	3	213,070	0	16,830	1,649.00	2024	2024-660011700	LAY, TYLER	3	234,960	0	16,029	1,540.00	2023	2023-660011700	LAY, TYLER	3	139,089	0	15,265	1,430.00	2022	2022-660011700	LAY, TYLER	3	132,172	0	14,539	1,424.00	2021	2021-660011700	LAY, TYLER	3	142,977	0	15,727	1,521.00	2020	2020-660011700	LAY, TYLER	3	140,743	0	15,482	1,496.00	2019	2019-660011700	LAY, TYLER	3	135,549	0	14,910	1,441.00	2018	2018-660011700	LAY, TYLER	3	140,926	0	15,502	1,443.00	2017	2017-660011700	LAY, TYLER	3	139,794	0	15,377	1,446.00	2016	2016-660011700	LAY, TYLER	3	136,400	0	15,004	1,413.00	2015	2015-660011700	LAY, TYLER	3	133,727	0	14,710	1,395.00	2014	2014-660011700	FEDERAL NATIONAL MORTGAGE ASSOC	3	134,786	1000	12,776	1,223.00	2013	2013-660011700	MORRIS, JOANNE K	3	121,585	1000	12,374	1,159.00
Tax Year	Statement Number	Billed Owner	Tax Area	Total Value	Exemptions	Taxable Value	Billed Tax																																																																																																																		
2025	2025-660011700	LAY, TYLER	3	213,070	0	16,830	1,649.00																																																																																																																		
2024	2024-660011700	LAY, TYLER	3	234,960	0	16,029	1,540.00																																																																																																																		
2023	2023-660011700	LAY, TYLER	3	139,089	0	15,265	1,430.00																																																																																																																		
2022	2022-660011700	LAY, TYLER	3	132,172	0	14,539	1,424.00																																																																																																																		
2021	2021-660011700	LAY, TYLER	3	142,977	0	15,727	1,521.00																																																																																																																		
2020	2020-660011700	LAY, TYLER	3	140,743	0	15,482	1,496.00																																																																																																																		
2019	2019-660011700	LAY, TYLER	3	135,549	0	14,910	1,441.00																																																																																																																		
2018	2018-660011700	LAY, TYLER	3	140,926	0	15,502	1,443.00																																																																																																																		
2017	2017-660011700	LAY, TYLER	3	139,794	0	15,377	1,446.00																																																																																																																		
2016	2016-660011700	LAY, TYLER	3	136,400	0	15,004	1,413.00																																																																																																																		
2015	2015-660011700	LAY, TYLER	3	133,727	0	14,710	1,395.00																																																																																																																		
2014	2014-660011700	FEDERAL NATIONAL MORTGAGE ASSOC	3	134,786	1000	12,776	1,223.00																																																																																																																		
2013	2013-660011700	MORRIS, JOANNE K	3	121,585	1000	12,374	1,159.00																																																																																																																		



Rogers

Assessment Property Record Card for Tax Year 2026

Data provided by LISA DELOZIER County Assessor

Date 04/16/2026
Time 23:38:39
Page 2

Lot Data	Square-Foot - NBHD 1047 #1	Primary Image
Lot Size		
Lot Count	1	
Units Buildable	1	
Non-Ag Acres	1.2541	
Topography		
Street Access		
Utilities		
Amenities	0	
	0	
Method	Square-Foot	
Base Lot Value	54,627.00 x 1.69 = 92,267	
Factor Value		
Adjustments	1.0000	
Lot Value	92,267	

Residential Data	
Type	1 Single Family Residence
Condition	3 - Average
Quality	2.5 - Fair
Architecture	
Style	100% One Story
Exterior Wall	100% Veneer, Masonry
Base/Total Area	1,574 / 1,574
Style	100% One Story
HVAC	100% Warmed & Cooled Air
Roof Cover	1 Composition Shingle
Area on Slab	1,574
Fixture/RghIn	11 /
Bed/F/H Bath	3 / 2.0 /
Basement Area	
Garage Type	625 Attached Garage - Unfinished
Remodel	
Year/Eff Age	1979 / 35

\\tsclient\TCASEY\CASEY BOOTH RESIDENTIAL VI\2022-8-30\ 8/31/2022

GRM Approach	
GRM Code	
Gross Rent	0.00
Indicated Value	

Multiple Regression			
MRA Code	1	Test	
Adjusted R	0.8445		
Indicated Value	178,200	113.21	Per SqFt

Direct Comparables			
Selection Model	A	Adam Test	
Adjustment Model	1	2022 Residential	
Comparables	6		
Indicated Value	199,740		Per SqFt

Cost Approach				Manual : 01/2025			
Base Cost	100.90	Total Misc Impr	+	15,107			
Roofing Adj	+ 4.28	Garage Cost	+	16,363			
Subfloor Adj	+ -1.17	Total RCN	=	227,323			
Heat/Cool Adj	+ 11.47	Depreciation (44%)	-	100,022			
Plumbing Adj	+ 8.95	Lump Sums	+	0			
Basement Adj	+ 0.00	RCNLD	=	127,301			
Adj Base Cost	= 124.43	Lot Value	+	92,267			
Total Area	x 1,574	Indicated Value	=	219,568			
Adjusted Cost	= 195,853	Value Per SqFt		139.50			

Value Reconciliation			
Selected Approach	Cost Approach		
Improvements	127,301		
Lot Value	92,267		
Indicated Value	219,568	139.50	Per SqFt
Agland Value			
Site Improvements			
Total Value	219,568	139.50	Total Value Per SqFt

Miscellaneous Improvements								
Code	Description	Sketch ID	Size	Year	Units	Unit Cost	Depr	Value
FPR1	FIREPLACE - RESIDENTIAL 1 STORY	0		1	1	5,095.98		5,096
PRCH	SLAB PORCH - COVERED	27756	14x5		70	24.05		1,684
PRCH	SLAB PORCH - COVERED	27757	24x15		360	23.13		8,327



Rogers

Assessment Property Record Card for Tax Year 2026

Data provided by LISA DELOZIER County Assessor

Date 04/16/2026

Time 23:38:39

Page 3

Sketch Image

660011700

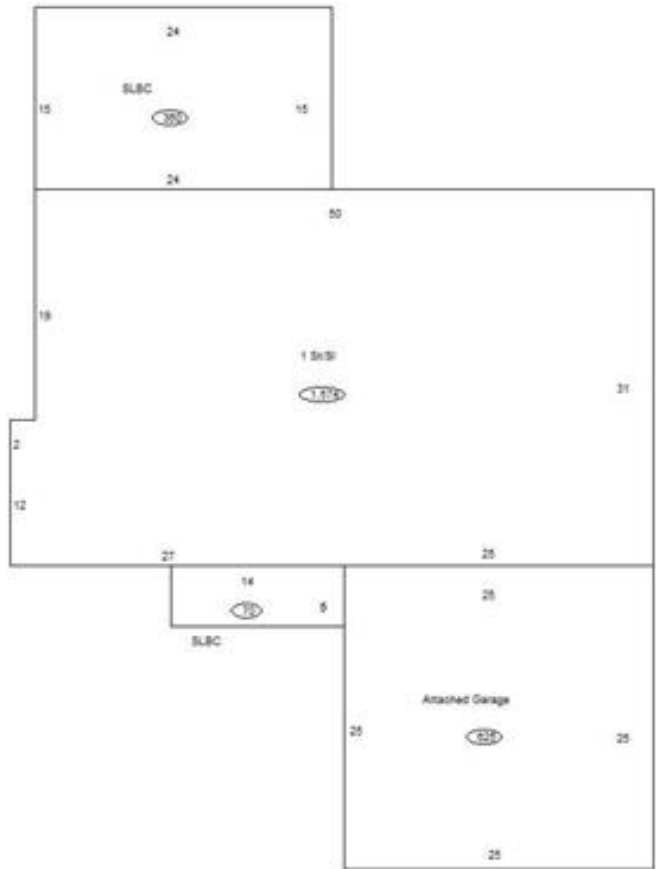

Sketch Vector Information

Sequence	Code	Type	Built Over	Scale	Section Label	Base Area	Multiplier	Total Area
1	R	1	Slab	10	1 St/SI	1,574	1.000	1,574
2	G	1		10	Attached Garage	625	1.000	625
3	M	PRCH		10	SLBC	70	1.000	70
4	M	PRCH		10	SLBC	360	1.000	360
Total Building Area						1,574		1,574



Rogers

Assessment Property Record Card for Tax Year 2026

Data provided by LISA DELOZIER County Assessor

Date 04/16/2026
Time 23:38:39
Page 4

660011700

Outbuildings/Site Improvements

Building Image	Code	Description	Dimensions	Floor	Roofing	Total Units
	STF	STG FAIR	10x16x0			160
	Qual	2	Cond 2	Year	Eff Age 2026	
Valuation Summary		Modifier Total		RCN	Depr (100% Phys/ % Func)	RCNLD
Base Cost (4.68 x 160)		749		749	749	