



# Rogers

## Assessment Property Record Card for Tax Year 2026

Data provided by LISA DELOZIER County Assessor

Date 04/16/2026  
Time 22:37:38  
Page 1

Assessment Data					Primary Image				
Account	660011746								
Parcel ID	000000-00-0-00876-001-0007								
Cadastral ID	11-21-14-05650								
Property Type	REAL - Real Property								
Property Class	RRP	VI Area 4							
Tax Area	3 - OWASSO RURAL/NO FIRE								
Name ID	316812								
LAUGHERY, PETER PAUL & DEBRA KAY-TRUSTEES									
17601 E 111TH ST N OWASSO OK 74055-0000									
Parcel Location									
Situs	16911 E 110TH ST N								
Subdivision	VILLAGE SECOND								
Lot/Block	0007 / 0001	Parcel Size 1 - Lots							
Sec/Twn/Rng	11 / 21 / 14 / 5								
Neighborhood	1047 - R-V04-SW OWASSO								
School District	S021 - OWASSO SCHOOLS								
Legal Description	Lat/Long: 36.31441103 -95.78428106				Building Permits Number Description Opened Closed Amount (Table with 5 columns: Number, Description, Opened, Closed, Amount)				
LOT 7 BLOCK 1 VILLAGE SECOND									
Exemptions					Sale History				
Code	Type	Active	Maximum	Exemption	Bk/Pg	Grantor	Date	Price	Code
H	Homestead	Yes	1,000	1,000	2633/39	LAUGHERY, PETER P &	04/25/2017	0	4
					941/557	SPRINGS, RANDY T &	12/22/1993	86,000	Yes
					899/352	SPRINGS, RANDY T &	11/12/1992	0	No
Parcel Valuation					Assessment History				
Source	REAL	Fair Cash	Capped	Asmnt Level	Assessed	Levy Rate	97.960	Current Tax	
Remove Cap	0	Land Value	81,687	32,115	11%	3,533	Assessed	16,512	1,617.52
Year Frozen	0	Improvements	150,965	117,984		12,979	Penalty	0	
Uncapped Value	0	Mobile Home	0	0	0	0	Exemption	1,000	-98.00
TIF Project ID	0	Total Value	232,652	150,099	16,512	Total Taxable	15,512	1,520.00	
Tax Year	Statement Number	Billed Owner			Tax Area	Total Value	Exemptions	Taxable Value	Billed Tax
2025	2025-660011746	LAUGHERY, PETER PAUL &			3	227,747	1000	15,031	1,472.00
2024	2024-660011746	LAUGHERY, PETER PAUL &			3	251,101	1000	14,564	1,399.00
2023	2023-660011746	LAUGHERY, PETER PAUL &			3	197,346	1000	14,110	1,322.00
2022	2022-660011746	LAUGHERY, PETER PAUL &			3	169,491	1000	13,670	1,339.00
2021	2021-660011746	LAUGHERY, PETER PAUL &			3	176,441	1000	13,243	1,281.00
2020	2020-660011746	LAUGHERY, PETER PAUL &			3	173,801	1000	12,828	1,239.00
2019	2019-660011746	LAUGHERY, PETER PAUL &			3	167,472	1000	12,425	1,201.00
2018	2018-660011746	LAUGHERY, PETER PAUL &			3	172,635	1000	12,035	1,120.00
2017	2017-660011746	LAUGHERY, PETER PAUL &			3	171,078	1000	11,655	1,096.00
2016	2016-660011746	LAUGHERY, PETER P &			3	167,236	1000	11,286	1,063.00
2015	2015-660011746	LAUGHERY, PETER P &			3	162,579	1000	10,929	1,036.00
2014	2014-660011746	LAUGHERY, PETER P &			3	162,922	1000	10,581	1,013.00
2013	2013-660011746	LAUGHERY, PETER P &			3	149,132	1000	10,244	960.00



# Rogers

## Assessment Property Record Card for Tax Year 2026

Data provided by LISA DELOZIER County Assessor

Date 04/16/2026  
Time 22:37:38  
Page 2

Lot Data	Square-Foot - NBHD 1047 #1	Primary Image
Lot Size		
Lot Count	1	
Units Buildable	1	
Non-Ag Acres	1.0292	
Topography		
Street Access		
Utilities		
Amenities	0	
	0	
Method	Square-Foot	
Base Lot Value	44,831.00 x 1.82 = 81,687	
Factor Value		
Adjustments	1.0000	
Lot Value	81,687	

Residential Data	
Type	1 Single Family Residence
Condition	3 - Average
Quality	3 - Average
Architecture	
Style	100% One Story
Exterior Wall	100% Veneer, Stone
Base/Total Area	1,557 / 1,557
Style	100% One Story
HVAC	100% Warmed & Cooled Air
Roof Cover	1 Composition Shingle
Area on Slab	1,557
Fixture/RghIn	11 /
Bed/F/H Bath	3 / 2.0 /
Basement Area	
Garage Type	520 Attached Garage - Unfinished
Remodel	
Year/Eff Age	1979 / 35



\\tsclient\TCASEY\CASEY BOOTH RESIDENTIAL VI\2022-8-31\ 8/31/2022

GRM Approach	
GRM Code	
Gross Rent	0.00
Indicated Value	

Multiple Regression			
MRA Code	1	Test	
Adusted R	0.8445		
Indicated Value	194,358	124.83	Per SqFt

Direct Comparables	
Selection Model	A Adam Test
Adjustment Model	1 2022 Residential
Comparables	6
Indicated Value	226,510 Per SqFt

Cost Approach				Manual : 01/2025			
Base Cost	116.32	Total Misc Impr	+ 15,068				
Roofing Adj	+ 4.83	Garage Cost	+ 16,437				
Subfloor Adj	+ -2.31	Total RCN	= 251,727				
Heat/Cool Adj	+ 12.64	Depreciation ( 43%)	- 108,243				
Plumbing Adj	+ 9.96	Lump Sums	+ 0				
Basement Adj	+ 0.00	RCNLD	= 143,484				
Adj Base Cost	= 141.44	Lot Value	+ 81,687				
Total Area	x 1,557	Indicated Value	= 225,171				
Adjusted Cost	= 220,222	Value Per SqFt	144.62				

Value Reconciliation			
Selected Approach	Cost Approach		
Improvements	143,484		
Lot Value	81,687		
Indicated Value	225,171	144.62	Per SqFt
Agland Value			
Site Improvements	7,481		
Total Value	232,652	149.42	Total Value Per SqFt

Miscellaneous Improvements								
Code	Description	Sketch ID	Size	Year	Units	Unit Cost	Depr	Value
FPR1	FIREPLACE - RESIDENTIAL 1 STORY	0		1	1	5,615.40		5,615
PRCH	SLAB PORCH - COVERED	27956	28x10		280	26.05		7,294
PRCH	SLAB PORCH - COVERED	27957	42		42	26.80		1,126
PATO	SLAB PORCH - OPEN	27958	18x5		90	11.48		1,033



# Rogers

## Assessment Property Record Card for Tax Year 2026

Data provided by LISA DELOZIER County Assessor

Date 04/16/2026  
 Time 22:37:38  
 Page 3

### Sketch Image

660011746

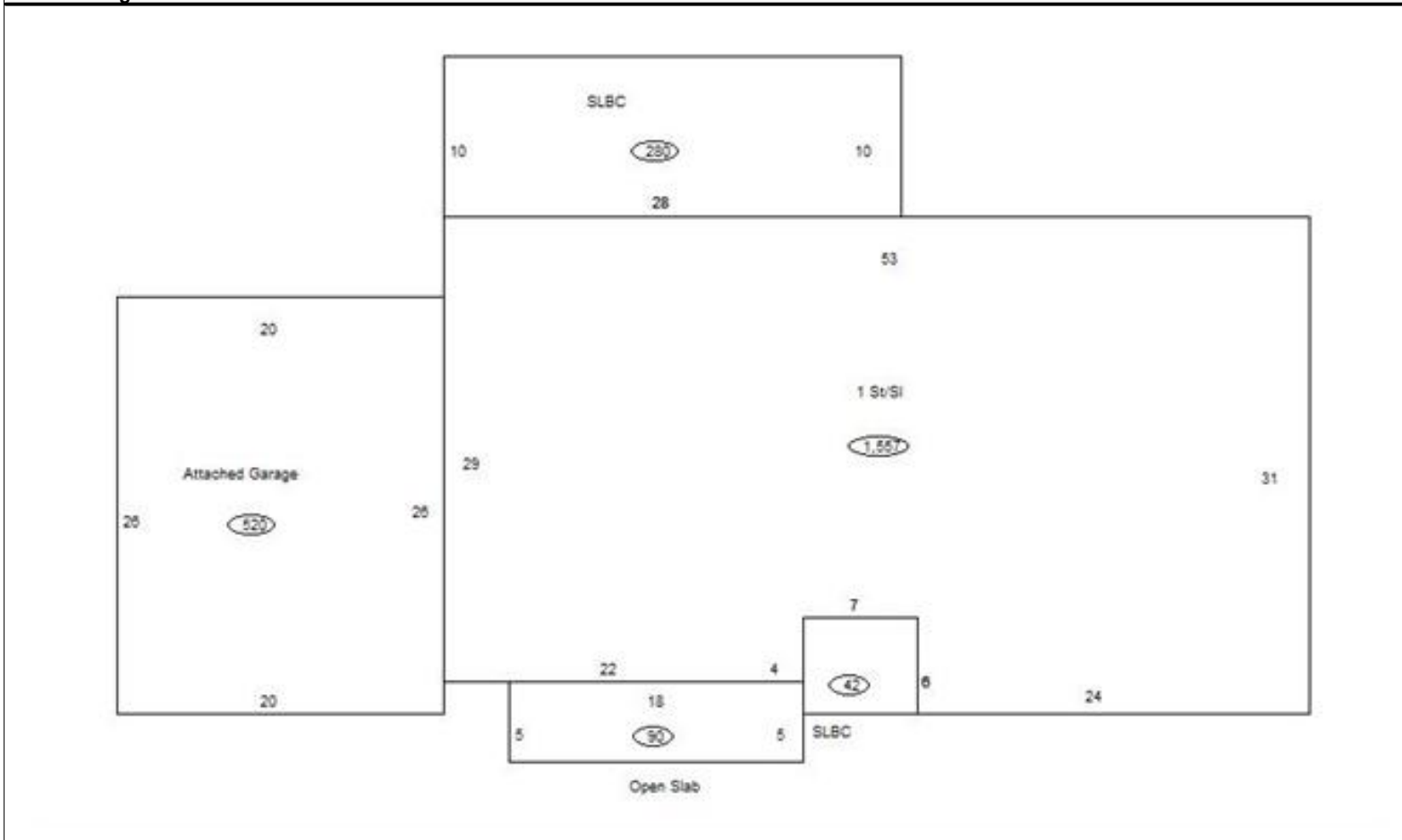

### Sketch Vector Information

Sequence	Code	Type	Built Over	Scale	Section Label	Base Area	Multiplier	Total Area
1	R	1	Slab	10	1 St/SI	1,557	1.000	1,557
2	G	1		10	Attached Garage	520	1.000	520
3	M	PRCH		10	SLBC	280	1.000	280
4	M	PRCH		10	SLBC	42	1.000	42
5	M	PATO		10	Open Slab	90	1.000	90
<b>Total Building Area</b>						1,557		1,557



# Rogers

## Assessment Property Record Card for Tax Year 2026

Data provided by LISA DELOZIER County Assessor

Date 04/16/2026  
 Time 22:37:38  
 Page 4

660011746

### Outbuildings/Site Improvements

Building Image	Code	Description	Dimensions	Floor	Roofing	Total Units	
	DTGF	DETACHED GARAGE FAIR	20x24x0			480	
	Qual	2	Cond 3	Year	Eff Age		
	<b>Valuation Summary</b>		<b>Modifier Total</b>		<b>RCN</b>	<b>Depr (15% Phys/ % Func)</b>	<b>RCNLD</b>
	Base Cost (16.00 x 480)		7,680		7,680	1,152	6,528
	LT	LEAN-TO	16x24x0			384	
	Qual	3	Cond 3	Year	Eff Age		
	<b>Valuation Summary</b>		<b>Modifier Total</b>		<b>RCN</b>	<b>Depr (15% Phys/ % Func)</b>	<b>RCNLD</b>
	Base Cost (2.92 x 384)		1,121		1,121	168	953