



Rogers

Assessment Property Record Card for Tax Year 2026

Data provided by LISA DELOZIER County Assessor

Date 04/16/2026
Time 21:26:23
Page 1

Assessment Data					Primary Image																																																	
Account 660011751 Parcel ID 000000-00-0-00876-001-0012 Cadastral ID 11-21-14-05700 Property Type REAL - Real Property Property Class RRP VI Area 4 Tax Area 3 - OWASSO RURAL/NO FIRE Name ID 122034 PLUMLEE, SUSAN REVOC TRUST SHANNAN PITTSER-SUCC TRUSTEE 16917 E 109TH ST N OWASSO OK 74055-0000																																																						
Parcel Location Situs 16917 E 109TH ST N Subdivision VILLAGE SECOND Lot/Block 0012 / 0001 Parcel Size 1 - Lots Sec/Twn/Rng 11 / 21 / 14 / 5 Neighborhood 1047 - R-V04-SW OWASSO School District S021 - OWASSO SCHOOLS																																																						
Legal Description Lat/Long: 36.31247593 -95.78486683					Building Permits																																																	
LOT 12 BLOCK 1 VILLAGE SECOND					<table border="1"> <thead> <tr> <th>Number</th> <th>Description</th> <th>Opened</th> <th>Closed</th> <th>Amount</th> </tr> </thead> <tbody> <tr> <td> </td> <td> </td> <td> </td> <td> </td> <td> </td> </tr> </tbody> </table>					Number	Description	Opened	Closed	Amount																																								
Number	Description	Opened	Closed	Amount																																																		
Exemptions					Sale History																																																	
Code	Type	Active	Maximum	Exemption	Bk/Pg	Grantor	Date	Price	Code																																													
H	Homestead	No	1,000		/	PLUMLEE, SUSAN	09/06/2023	0	4																																													
					/	PLUMLEE, SUSAN-TRUSTEE	03/29/2023	0	4																																													
					/	PLUMLEE, SUSAN	11/29/2018	0	4																																													
Parcel Valuation					<table border="1"> <thead> <tr> <th>Source</th> <th>REAL</th> <th>Fair Cash</th> <th>Capped</th> <th>Asmnt Level</th> <th>Assessed</th> <th>Levy Rate</th> <th>97.960</th> <th>Current Tax</th> </tr> </thead> <tbody> <tr> <td>Remove Cap</td> <td>0</td> <td>Land Value 92,507</td> <td>39,464</td> <td>11%</td> <td>4,341</td> <td>Assessed</td> <td>13,586</td> <td>1,330.88</td> </tr> <tr> <td>Year Frozen</td> <td>2012</td> <td>Improvements 168,645</td> <td>84,051</td> <td></td> <td>9,245</td> <td>Penalty</td> <td>0</td> <td></td> </tr> <tr> <td>Uncapped Value</td> <td>0</td> <td>Mobile Home 0</td> <td>0</td> <td></td> <td>0</td> <td>Exemption</td> <td>0</td> <td>0.00</td> </tr> <tr> <td>TIF Project ID</td> <td>0</td> <td>Total Value 261,152</td> <td>123,515</td> <td></td> <td>13,586</td> <td>Total Taxable</td> <td>13,586</td> <td>1,331.00</td> </tr> </tbody> </table>					Source	REAL	Fair Cash	Capped	Asmnt Level	Assessed	Levy Rate	97.960	Current Tax	Remove Cap	0	Land Value 92,507	39,464	11%	4,341	Assessed	13,586	1,330.88	Year Frozen	2012	Improvements 168,645	84,051		9,245	Penalty	0		Uncapped Value	0	Mobile Home 0	0		0	Exemption	0	0.00	TIF Project ID	0	Total Value 261,152	123,515		13,586	Total Taxable	13,586	1,331.00
Source	REAL	Fair Cash	Capped	Asmnt Level	Assessed	Levy Rate	97.960	Current Tax																																														
Remove Cap	0	Land Value 92,507	39,464	11%	4,341	Assessed	13,586	1,330.88																																														
Year Frozen	2012	Improvements 168,645	84,051		9,245	Penalty	0																																															
Uncapped Value	0	Mobile Home 0	0		0	Exemption	0	0.00																																														
TIF Project ID	0	Total Value 261,152	123,515		13,586	Total Taxable	13,586	1,331.00																																														
Assessment History																																																						
Tax Year	Statement Number	Billed Owner	Tax Area	Total Value	Exemptions	Taxable Value	Billed Tax																																															
2025	2025-660011751	PLUMLEE, SUSAN	3	251,032	0	12,939	1,268.00																																															
2024	2024-660011751	PLUMLEE, SUSAN	3	274,807	0	12,324	1,184.00																																															
2023	2023-660011751	PLUMLEE, SUSAN-TRUSTEE	3	207,376	1000	10,737	1,006.00																																															
2022	2022-660011751	PLUMLEE, SUSAN-TRUSTEE	3	179,765	1000	10,737	1,052.00																																															
2021	2021-660011751	PLUMLEE, SUSAN-TRUSTEE	3	186,557	1000	10,737	1,039.00																																															
2020	2020-660011751	PLUMLEE, SUSAN-TRUSTEE	3	185,606	1000	10,737	1,037.00																																															
2019	2019-660011751	PLUMLEE, SUSAN-TRUSTEE	3	176,913	1000	10,737	1,038.00																																															
2018	2018-660011751	PLUMLEE, SUSAN	3	178,756	1000	10,737	999.00																																															
2017	2017-660011751	PLUMLEE, SUSAN	3	177,390	1000	10,737	1,010.00																																															
2016	2016-660011751	PLUMLEE, SUSAN	3	173,138	1000	10,737	1,011.00																																															
2015	2015-660011751	PLUMLEE, SUSAN	3	168,112	1000	10,737	1,018.00																																															
2014	2014-660011751	PLUMLEE, SUSAN	3	171,035	1000	10,737	1,028.00																																															
2013	2013-660011751	PLUMLEE, SUSAN	3	156,019	1000	10,737	1,006.00																																															



Rogers

Assessment Property Record Card for Tax Year 2026

Data provided by LISA DELOZIER County Assessor

Date 04/16/2026
Time 21:26:23
Page 2

Lot Data	Square-Foot - NBHD 1047 #1	Primary Image
Lot Size		
Lot Count	1	
Units Buildable	1	
Non-Ag Acres	1.2591	
Topography		
Street Access		
Utilities		
Amenities	0	
	0	
Method	Square-Foot	
Base Lot Value	54,849.00 x 1.69 = 92,507	
Factor Value		
Adjustments	1.0000	
Lot Value	92,507	

Residential Data	
Type	1 Single Family Residence
Condition	3 - Average
Quality	3 - Average
Architecture	
Style	100% One Story
Exterior Wall	100% Veneer, Masonry
Base/Total Area	1,920 / 1,920
Style	100% One Story
HVAC	100% Warmed & Cooled Air
Roof Cover	1 Composition Shingle
Area on Slab	1,920
Fixture/RghIn	11 /
Bed/F/H Bath	3 / 2.0 /
Basement Area	
Garage Type	504 Attached Garage - Unfinished
Remodel	
Year/Eff Age	1978 / 36

Cost Approach		Manual : 01/2025	
Base Cost	108.43	Total Misc Impr	+ 16,029
Roofing Adj	+ 4.74	Garage Cost	+ 16,032
Subfloor Adj	+ -2.23	Total RCN	= 284,848
Heat/Cool Adj	+ 12.64	Depreciation (43%)	- 122,485
Plumbing Adj	+ 8.08	Lump Sums	+ 0
Basement Adj	+ 0.00	RCNLD	= 162,363
Adj Base Cost	= 131.66	Lot Value	+ 92,507
Total Area	x 1,920	Indicated Value	= 254,870
Adjusted Cost	= 252,787	Value Per SqFt	132.74

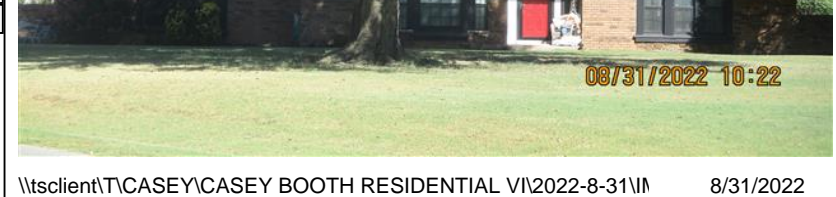

\\tsclient\TCASEY\CASEY BOOTH RESIDENTIAL VI\2022-8-31\ 8/31/2022

GRM Approach	
GRM Code	
Gross Rent	0.00
Indicated Value	

Multiple Regression			
MRA Code	1	Test	
Adusted R	0.8445		
Indicated Value	217,517	113.29	Per SqFt

Direct Comparables			
Selection Model	A	Adam Test	
Adjustment Model	1	2022 Residential	
Comparables	6		
Indicated Value	254,900		Per SqFt

Value Reconciliation			
Selected Approach	Cost Approach		
Improvements	162,363		
Lot Value	92,507		
Indicated Value	254,870	132.74	Per SqFt
Agland Value			
Site Improvements	6,282		
Total Value	261,152	136.02	Total Value Per SqFt

Miscellaneous Improvements								
Code	Description	Sketch ID	Size	Year	Units	Unit Cost	Depr	Value
FPR1	FIREPLACE - RESIDENTIAL 1 STORY	0		1	1	5,615.40		5,615
PRCH	SLAB PORCH - COVERED	27978	30x12		360	25.80		9,288
PRCH	SLAB PORCH - COVERED	27979	42		42	26.80		1,126



Rogers

Assessment Property Record Card for Tax Year 2026

Data provided by LISA DELOZIER County Assessor

Date 04/16/2026
 Time 21:26:23
 Page 3

Sketch Image

660011751

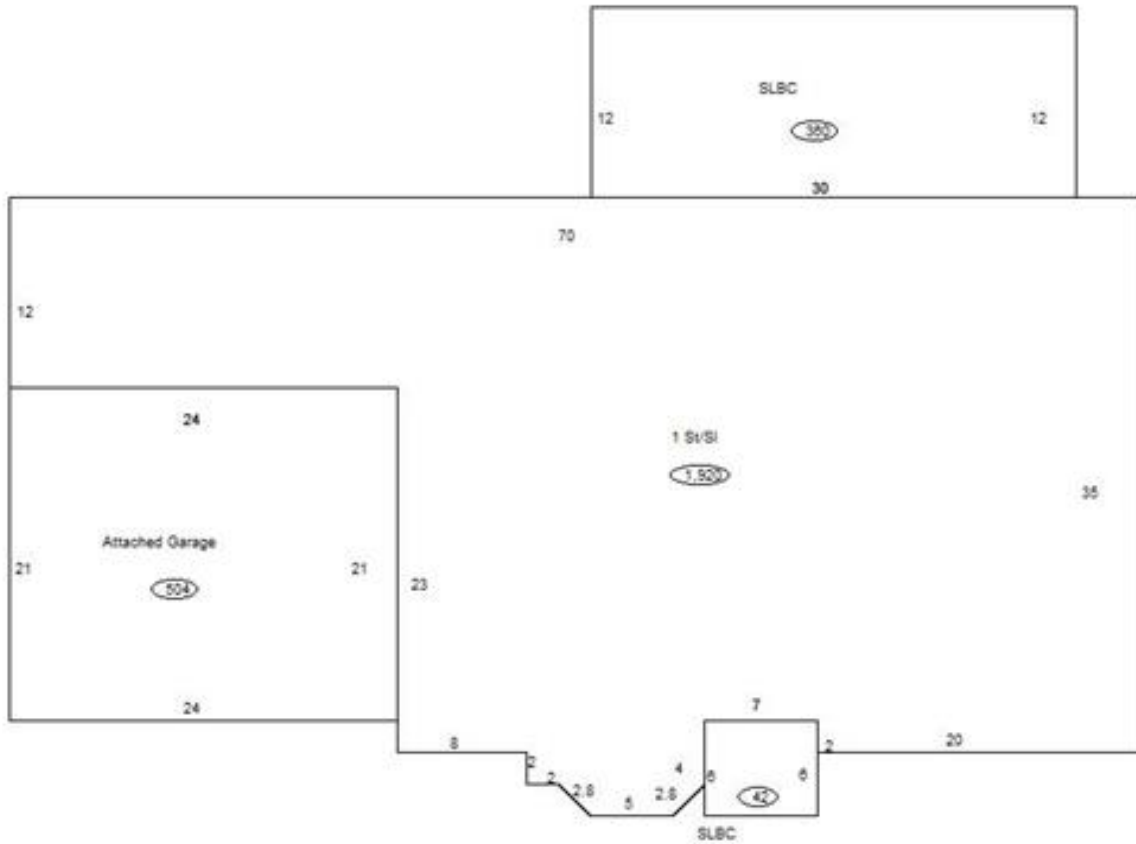

Sketch Vector Information

Sequence	Code	Type	Built Over	Scale	Section Label	Base Area	Multiplier	Total Area
1	R	1	Slab	10	1 St/SI	1,920	1.000	1,920
2	G	1		10	Attached Garage	504	1.000	504
3	M	PRCH		10	SLBC	360	1.000	360
4	M	PRCH		10	SLBC	42	1.000	42
Total Building Area						1,920		1,920



Rogers

Assessment Property Record Card for Tax Year 2026

Data provided by LISA DELOZIER County Assessor

Date 04/16/2026
Time 21:26:23
Page 4

660011751

Outbuildings/Site Improvements

Building Image	Code	Description	Dimensions	Floor	Roofing	Total Units
	UTIL	SHOP BUILDING	24x24x0			576
	Qual 3	Cond 3	Year	Eff Age	1520	
		Valuation Summary	Modifier Total	RCN	Depr (65% Phys/ % Func)	RCNLD
		Base Cost (31.16 x 576)	17,948	17,948	11,666	6,282