



Rogers

Assessment Property Record Card for Tax Year 2026

Data provided by LISA DELOZIER County Assessor

Date 04/16/2026
Time 21:26:43
Page 1

Assessment Data					Primary Image														
Account 660011772 Parcel ID 000000-00-0-00876-003-0015 Cadastral ID 11-21-14-05910 Property Type REAL - Real Property Property Class RRP VI Area 4 Tax Area 3 - OWASSO RURAL/NO FIRE Name ID 122294 PALMER, MICHAEL ALLEN & BARBARA DOYLE REVOCABLE FAMILY TRUST 10896 N 172ND E AVE OWASSO OK 74055-0000																			
Parcel Location Situs 10896 N 172ND E AVE Subdivision VILLAGE SECOND Lot/Block 0015 / 0003 Parcel Size 1 - Lots Sec/Twn/Rng 11 / 21 / 14 / 5 Neighborhood 1047 - R-V04-SW OWASSO School District S021 - OWASSO SCHOOLS																			
Legal Description Lat/Long: 36.31178504 -95.78252477					Building Permits														
LOT 15 BLOCK 3 VILLAGE SECOND					<table border="1"> <thead> <tr> <th>Number</th> <th>Description</th> <th>Opened</th> <th>Closed</th> <th>Amount</th> </tr> </thead> <tbody> <tr> <td> </td> <td> </td> <td> </td> <td> </td> <td> </td> </tr> </tbody> </table>					Number	Description	Opened	Closed	Amount					
Number	Description	Opened	Closed	Amount															
Exemptions					Sale History														
Code	Type	Active	Maximum	Exemption	Bk/Pg	Grantor	Date	Price	Code										
H	Homestead	Yes	1,000	1,000															
Parcel Valuation																			
Source	REAL		Fair Cash	Capped	Asmnt Level	Assessed	Levy Rate	97.960	Current Tax										
Remove Cap	0		Land Value 84,606	39,138	11%	4,305	Assessed	13,701	1,342.15										
Year Frozen	2016		Improvements 184,644	85,415		9,396	Penalty	0											
Uncapped Value	0		Mobile Home 0	0		0	Exemption	1,000	-98.00										
TIF Project ID	0		Total Value 269,250	124,553		13,701	Total Taxable	12,701	1,244.00										
Assessment History																			
Tax Year	Statement Number	Billed Owner			Tax Area	Total Value	Exemptions	Taxable Value	Billed Tax										
2025	2025-660011772	PALMER, MICHAEL ALLEN			3	259,551	1000	12,701	1,244.00										
2024	2024-660011772	PALMER, MICHAEL ALLEN			3	292,521	1000	12,701	1,220.00										
2023	2023-660011772	PALMER, MICHAEL ALLEN			3	248,508	1000	12,701	1,190.00										
2022	2022-660011772	PALMER, MICHAEL ALLEN			3	213,604	1000	12,701	1,244.00										
2021	2021-660011772	PALMER, MICHAEL ALLEN			3	200,273	1000	12,700	1,229.00										
2020	2020-660011772	PALMER, MICHAEL ALLEN			3	198,967	1000	12,701	1,227.00										
2019	2019-660011772	PALMER, MICHAEL ALLEN			3	189,781	1000	12,701	1,228.00										
2018	2018-660011772	PALMER, MICHAEL ALLEN			3	191,133	1000	12,132	1,129.00										
2017	2017-660011772	PALMER, MICHAEL ALLEN			3	189,396	1000	12,132	1,141.00										
2016	2016-660011772	PALMER, MICHAEL ALLEN			3	185,008	1000	12,132	1,142.00										
2015	2015-660011772	PALMER, MICHAEL ALLEN			3	179,950	1000	11,750	1,114.00										
2014	2014-660011772	PALMER, MICHAEL ALLEN			3	172,388	1000	11,378	1,089.00										
2013	2013-660011772	PALMER, MICHAEL ALLEN			3	153,935	1000	11,018	1,032.00										



Rogers

Assessment Property Record Card for Tax Year 2026

Data provided by LISA DELOZIER County Assessor

Date 04/16/2026
Time 21:26:44
Page 2

Lot Data	Square-Foot - NBHD 1047 #1	Primary Image
Lot Size		
Lot Count	1	
Units Buildable	1	
Non-Ag Acres	1.0912	
Topography		
Street Access		
Utilities		
Amenities	0	
	0	
Method	Square-Foot	
Base Lot Value	47,533.00 x 1.78 = 84,606	
Factor Value		
Adjustments	1.0000	
Lot Value	84,606	

Residential Data	
Type	1 Single Family Residence
Condition	3 - Average
Quality	3 - Average
Architecture	
Style	100% One Story
Exterior Wall	100% Veneer, Stone
Base/Total Area	1,650 / 1,650
Style	100% One Story
HVAC	100% Warmed & Cooled Air
Roof Cover	1 Composition Shingle
Area on Slab	1,650
Fixture/RghIn	11 /
Bed/F/H Bath	3 / 2.0 /
Basement Area	
Garage Type	460 Attached Garage - Unfinished
Remodel	
Year/Eff Age	1979 / 35



\\tsclient\TCASEY\CASEY BOOTH RESIDENTIAL VI\2022-8-31\ 8/31/2022

GRM Approach	
GRM Code	
Gross Rent	0.00
Indicated Value	

Multiple Regression			
MRA Code	1	Test	
Adjusted R	0.8445		
Indicated Value	216,692	131.33	Per SqFt

Direct Comparables			
Selection Model	A	Adam Test	
Adjustment Model	1	2022 Residential	
Comparables	6		
Indicated Value	241,240		Per SqFt

Cost Approach				Manual : 01/2025			
Base Cost	117.61	Total Misc Impr	+	24,585			
Roofing Adj	+ 4.89	Garage Cost	+	14,968			
Subfloor Adj	+ -2.31	Total RCN	=	274,233			
Heat/Cool Adj	+ 12.64	Depreciation (43%)	-	117,920			
Plumbing Adj	+ 9.40	Lump Sums	+	0			
Basement Adj	+ 0.00	RCNLD	=	156,313			
Adj Base Cost	= 142.23	Lot Value	+	84,606			
Total Area	x 1,650	Indicated Value	=	240,919			
Adjusted Cost	= 234,680	Value Per SqFt		146.01			

Value Reconciliation			
Selected Approach	Cost Approach		
Improvements	156,313		
Lot Value	84,606		
Indicated Value	240,919	146.01	Per SqFt
Agland Value			
Site Improvements	28,331		
Total Value	269,250	163.18	Total Value Per SqFt

Miscellaneous Improvements								
Code	Description	Sketch ID	Size	Year	Units	Unit Cost	Depr	Value
FPR1	FIREPLACE - RESIDENTIAL 1 STORY	0		1	1	5,615.40		5,615
PRCH	SLAB PORCH - COVERED	28054	23x4		92	26.64		2,451
EPSW	ENCLOSED PORCH - SOLID WALL	28055	20x12		240	68.83		16,519



Rogers
Assessment Property Record Card for Tax Year 2026

Data provided by LISA DELOZIER County Assessor

Date 04/16/2026
 Time 21:26:44
 Page 3

Sketch Image

660011772

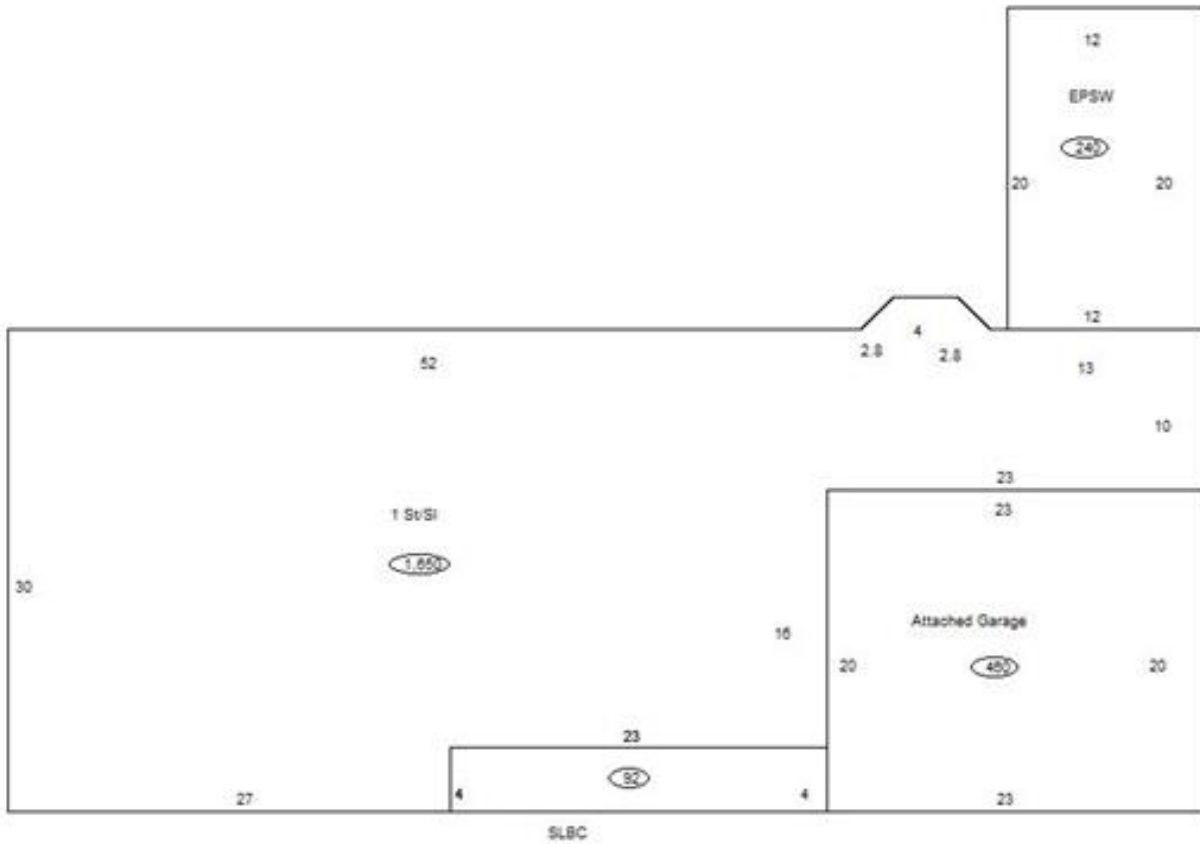

Sketch Vector Information

Sequence	Code	Type	Built Over	Scale	Section Label	Base Area	Multiplier	Total Area
1	R	1	Slab	10	1 St/Sl	1,650	1.000	1,650
2	G	1		10	Attached Garage	460	1.000	460
3	M	PRCH		10	SLBC	92	1.000	92
4	M	EPSW		10	EPSW	240	1.000	240
Total Building Area						1,650		1,650



Rogers



Assessment Property Record Card for Tax Year 2026

Data provided by LISA DELOZIER County Assessor

Date 04/16/2026
 Time 21:26:44
 Page 4

660011772

Outbuildings/Site Improvements

Building Image	Code	Description	Dimensions	Floor	Roofing	Total Units
	UTIL	SHOP BUILDING	20x30x0			600
	Qual	2	Cond 3	Year 2018	Eff Age 6	
	Valuation Summary		Modifier Total	RCN	Depr (11% Phys/ % Func)	RCNLD
	Base Cost (29.97 x 600)		17,982	17,982	1,978	16,004
	LT	LEAN-TO	8x14x0			112
	Qual	2	Cond 3	Year 2018	Eff Age	
	Valuation Summary		Modifier Total	RCN	Depr (0% Phys/ % Func)	RCNLD
	Base Cost (2.92 x 112)		327	327		327
	SG	SWIM-GUNITE	0x0x0			1
	Qual	3	Cond 3	Year	Eff Age	
	Valuation Summary		Modifier Total	RCN	Depr (60% Phys/ % Func)	RCNLD
	Base Cost (30,000.00 x 1)		30,000	30,000	18,000	12,000