



# Rogers

## Assessment Property Record Card for Tax Year 2026

Data provided by LISA DELOZIER County Assessor

Date 04/16/2026  
 Time 21:27:04  
 Page 1

Assessment Data					Primary Image				
<b>Account</b> 660011790 <b>Parcel ID</b> 000000-00-0-00876-004-0014 <b>Cadastral ID</b> 11-21-14-06090 <b>Property Type</b> REAL - Real Property <b>Property Class</b> RRP VI Area 4 <b>Tax Area</b> 3 - OWASSO RURAL/NO FIRE <b>Name ID</b> 122554 WILBER, STANLEY HOWARD JR REVOCABLE TRUST  17569 E 107TH PL N OWASSO OK 74055-0000  <b>Parcel Location</b> <b>Situs</b> 17569 E 107TH PL N <b>Subdivision</b> VILLAGE SECOND <b>Lot/Block</b> 0014 / 0004 <b>Parcel Size</b> 1 - Lots <b>Sec/Twn/Rng</b> 11 / 21 / 14 / 5 <b>Neighborhood</b> 1047 - R-V04-SW OWASSO <b>School District</b> S021 - OWASSO SCHOOLS									
<b>Legal Description</b> Lat/Long: 36.31065050 -95.77777471									
<b>Building Permits</b>					\\tsclient\TCASEY\CASEY BOOTH RESIDENTIAL VI\2022-8-31\ 8/31/2022				
<b>Exemptions</b>					<b>Sale History</b>				
<b>Code</b> <b>Type</b> <b>Active</b> <b>Maximum</b> <b>Exemption</b>					<b>Number</b> <b>Description</b> <b>Opened</b> <b>Closed</b> <b>Amount</b>				
HV    Veteran      Yes      999,999      10,977 H    Homestead      Yes      1,000					LOT 14 BLOCK 4 VILLAGE SECOND				
<b>Parcel Valuation</b>									
<b>Source</b>	<b>REAL</b>		<b>Fair Cash</b>	<b>Capped</b>	<b>Asmnt Level</b>	<b>Assessed</b>	<b>Levy Rate</b>	97.960	<b>Current Tax</b>
Remove Cap	0	<b>Land Value</b>	86,666	39,772	11%	4,375	<b>Assessed</b>	10,977	1,075.31
Year Frozen	2014	<b>Improvements</b>	130,780	60,017		6,602	<b>Penalty</b>	0	
Uncapped Value	0	<b>Mobile Home</b>	0	0		0	<b>Exemption</b>	10,977	-1,075.00
TIF Project ID	0	<b>Total Value</b>	217,446	99,789		10,977	<b>Total Taxable</b>	0	0.00
<b>Assessment History</b>									
<b>Tax Year</b>	<b>Statement Number</b>	<b>Billed Owner</b>			<b>Tax Area</b>	<b>Total Value</b>	<b>Exemptions</b>	<b>Taxable Value</b>	<b>Billed Tax</b>
2025	2025-660011790	WILBER, STANLEY HOWARD JR			3	213,185	10976		.00
2024	2024-660011790	WILBER, STANLEY H			3	99,789	1000		.00
2023	2023-660011790	WILBER, STANLEY H			3	176,993	1000	9,977	935.00
2022	2022-660011790	WILBER, STANLEY H			3	149,104	1000	9,977	977.00
2021	2021-660011790	WILBER, STANLEY H			3	157,956	1000	9,977	965.00
2020	2020-660011790	WILBER, STANLEY H			3	155,647	1000	9,977	964.00
2019	2019-660011790	WILBER, STANLEY H			3	151,925	1000	9,977	964.00
2018	2018-660011790	WILBER, STANLEY H			3	160,537	1000	9,977	929.00
2017	2017-660011790	WILBER, STANLEY H			3	159,325	1000	9,976	938.00
2016	2016-660011790	WILBER, STANLEY H			3	155,622	1000	9,977	939.00
2015	2015-660011790	WILBER, STANLEY H			3	151,251	1000	9,977	946.00
2014	2014-660011790	WILBER, STANLEY H			3	152,324	1000	9,977	955.00
2013	2013-660011790	WILBER, STANLEY H			3	141,850	1000	9,657	905.00



# Rogers

## Assessment Property Record Card for Tax Year 2026

Data provided by LISA DELOZIER County Assessor

Date 04/16/2026  
Time 21:27:04  
Page 2

Lot Data	Square-Foot - NBHD 1047 #1	Primary Image
Lot Size		
Lot Count	1	
Units Buildable	1	
Non-Ag Acres	1.135	
Topography		
Street Access		
Utilities		
Amenities	0	
	0	
Method	Square-Foot	
Base Lot Value	49,441.00 x 1.75 = 86,666	
Factor Value		
Adjustments	1.0000	
Lot Value	86,666	

Residential Data	
Type	1 Single Family Residence
Condition	2.5 - Fair
Quality	3 - Average
Architecture	
Style	100% One Story
Exterior Wall	100% Veneer, Stone
Base/Total Area	1,621 / 1,621
Style	100% One Story
HVAC	100% Warmed & Cooled Air
Roof Cover	1 Composition Shingle
Area on Slab	1,621
Fixture/RghIn	7 /
Bed/F/H Bath	3 / 1.5 /
Basement Area	
Garage Type	528 Attached Garage - Unfinished
Remodel	
Year/Eff Age	1979 / 41



\\tsclient\TCASEY\CASEY BOOTH RESIDENTIAL VI\2022-8-31\ 8/31/2022

GRM Approach	
GRM Code	
Gross Rent	0.00
Indicated Value	

Multiple Regression			
MRA Code	1	Test	
Adusted R	0.8445		
Indicated Value	192,303	118.63	Per SqFt

Direct Comparables			
Selection Model	A	Adam Test	
Adjustment Model	1	2022 Residential	
Comparables	6		
Indicated Value	228,970		Per SqFt

Value Reconciliation			
Selected Approach	Cost Approach		
Improvements	130,780		
Lot Value	86,666		
Indicated Value	217,446	134.14	Per SqFt
Agland Value			
Site Improvements			
Total Value	217,446	134.14	Total Value Per SqFt

Cost Approach				Manual : 01/2025			
Base Cost	115.45	Total Misc Impr	+	8,309			
Roofing Adj	+ 4.79	Garage Cost	+	16,627			
Subfloor Adj	+ -2.31	Total RCN	=	246,754			
Heat/Cool Adj	+ 12.64	Depreciation ( 47%)	-	115,974			
Plumbing Adj	+ 6.27	Lump Sums	+	0			
Basement Adj	+ 0.00	RCNLD	=	130,780			
Adj Base Cost	= 136.84	Lot Value	+	86,666			
Total Area	x 1,621	Indicated Value	=	217,446			
Adjusted Cost	= 221,818	Value Per SqFt		134.14			

Miscellaneous Improvements								
Code	Description	Sketch ID	Size	Year	Units	Unit Cost	Depr	Value
FPR1	FIREPLACE - RESIDENTIAL 1 STORY	0		1	1	5,615.40		5,615
SHLT	STORM SHELTER	0		1	2014	0.00		
PRCH	SLAB PORCH - COVERED	28129	50		50	26.77		1,339
PATO	SLAB PORCH - OPEN	28130	12x10		120	11.29		1,355



**Rogers**  
**Assessment Property Record Card for Tax Year 2026**

Data provided by LISA DELOZIER County Assessor

Date 04/16/2026  
 Time 21:27:04  
 Page 3

Sketch Image

660011790

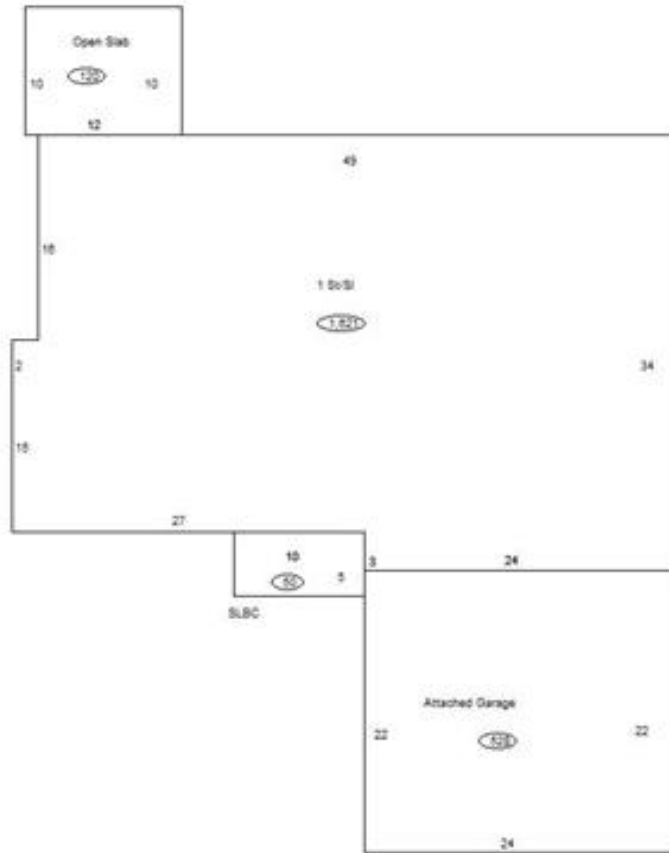

**Sketch Vector Information**

Sequence	Code	Type	Built Over	Scale	Section Label	Base Area	Multiplier	Total Area
1	R	1	Slab	10	1 St/SI	1,621	1.000	1,621
2	G	1		10	Attached Garage	528	1.000	528
3	M	PRCH		10	SLBC	50	1.000	50
4	M	PATO		10	Open Slab	120	1.000	120
<b>Total Building Area</b>						1,621		1,621



# Rogers

## Assessment Property Record Card for Tax Year 2026

Data provided by LISA DELOZIER County Assessor

Date 04/16/2026  
Time 21:27:04  
Page 4

660011790

### Outbuildings/Site Improvements

Building Image	Code	Description	Dimensions	Floor	Roofing	Total Units
	STF	STG FAIR	10x14x0			140
	Qual	2	Cond 2	Year	Eff Age 2026	
<b>Valuation Summary</b>		<b>Modifier Total</b>	<b>RCN</b>	<b>Depr (100% Phys/ % Func)</b>		<b>RCNLD</b>
Base Cost (4.68 x 140)		655		655		655