



Rogers

Assessment Property Record Card for Tax Year 2026

Data provided by LISA DELOZIER County Assessor

Date 04/16/2026
Time 22:16:16
Page 1

Assessment Data					Primary Image									
Account	660011890													
Parcel ID	000000-00-0-10102-001-0003													
Cadastral ID	11-21-15-03520													
Property Type	REAL - Real Property													
Property Class	RRP	VI Area 4												
Tax Area	8 - CLAREMORE/ NW FIRE													
Name ID	303879													
CROSBY, KEITH E														
8885 E HAMPTON RD CLAREMORE OK 74019-0000														
Parcel Location														
Situs	08885 E HAMPTON RD													
Subdivision	CAMBRIDGE ESTATES													
Lot/Block	0003 / 0001	Parcel Size 1 - Lots												
Sec/Twn/Rng	11 / 21 / 15 / 5													
Neighborhood	1013 - R-V03-SE INOLA													
School District	S001 - CLAREMORE SCHOOLS													
Legal Description Lat/Long: 36.31433115 -95.67058852														
Building Permits														
LOT 3 BLOCK 1 CAMBRIDGE ESTATES														
<table border="1"> <thead> <tr> <th>Number</th> <th>Description</th> <th>Opened</th> <th>Closed</th> <th>Amount</th> </tr> </thead> <tbody> <tr> <td></td> <td></td> <td></td> <td></td> <td></td> </tr> </tbody> </table>					Number	Description	Opened	Closed	Amount					
Number	Description	Opened	Closed	Amount										
Exemptions														
Code	Type	Active	Maximum	Exemption	Sale History									
H	Homestead	Yes		1,000	Bk/Pg	Grantor	Date	Price	Code					
					2138/801	SEC OF HUD	11/03/2010	0	1					
					2115/215	DAVIDSON, WILLIAM JOSEPH	03/24/2010	0	10					
					793/136			67,500	No					
Parcel Valuation														
Source	REAL		Fair Cash	Capped	Asmnt Level	Assessed	Levy Rate	106.442	Current Tax					
Remove Cap	2011		Land Value	22,225	22,225	11%	2,445	Assessed	20,120	2,141.60				
Year Frozen	0		Improvements	163,481	160,679		17,675	Penalty	0					
Uncapped Value	0		Mobile Home	0	0		0	Exemption	1,000	-93.00				
TIF Project ID	0		Total Value	185,706	182,904		20,120	Total Taxable	19,120	2,049.00				
Assessment History														
Tax Year	Statement Number	Billed Owner			Tax Area	Total Value	Exemptions	Taxable Value	Billed Tax					
2025	2025-660011890	CROSBY, KEITH E			8	180,103	1000	18,534	1,987.00					
2024	2024-660011890	CROSBY, KEITH E			8	190,886	1000	17,965	1,926.00					
2023	2023-660011890	CROSBY, KEITH E			8	167,384	1000	17,412	1,853.00					
2022	2022-660011890	CROSBY, KEITH E			8	171,776	1000	17,895	1,916.00					
2021	2021-660011890	CROSBY, KEITH E			8	167,377	1000	17,411	1,787.00					
2020	2020-660011890	CROSBY, KEITH E			8	164,707	1000	16,948	1,804.00					
2019	2019-660011890	CROSBY, KEITH E			8	158,415	1000	16,426	1,767.00					
2018	2018-660011890	CROSBY, KEITH E			8	163,238	1000	16,583	1,781.00					
2017	2017-660011890	CROSBY, KEITH E			8	161,916	1000	16,071	1,697.00					
2016	2016-660011890	CROSBY, KEITH E			8	157,798	1000	15,573	1,693.00					
2015	2015-660011890	CROSBY, KEITH E			8	154,260	1000	15,091	1,566.00					
2014	2014-660011890	CROSBY, KEITH E			8	155,462	1000	14,623	1,540.00					
2013	2013-660011890	CROSBY, KEITH E			8	140,962	1000	14,167	1,470.00					



Rogers

Assessment Property Record Card for Tax Year 2026

Data provided by LISA DELOZIER County Assessor

Date 04/16/2026
Time 22:16:17
Page 2

Lot Data	Square-Foot - NBHD 1013 #1	Primary Image
Lot Size		
Lot Count		
Units Buildable	11000	
Non-Ag Acres	1.0408	
Topography		
Street Access		
Utilities		
Amenities	LAND QUALITY 0	
	0	
Method	Square-Foot	
Base Lot Value	45,338.00 x .49 = 22,225	
Factor Value		
Adjustments	1.0000	
Lot Value	22,225	

Residential Data	
Type	1 Single Family Residence
Condition	3 - Average
Quality	3 - Average
Architecture	
Style	100% One Story
Exterior Wall	15% Veneer, Masonry 85% Frame, Siding, Metal
Base/Total Area	1,747 / 1,747
Style	100% One Story
HVAC	100% Warmed & Cooled Air
Roof Cover	1 Composition Shingle
Area on Slab	1,747
Fixture/RghIn	14 /
Bed/F/H Bath	3 / 2.5 /
Basement Area	
Garage Type	576 Attached Garage - Unfinished
Remodel	
Year/Eff Age	1987 / 29



\\tsclient\C\Users\Randy Necessary\Pictures\101_0720\IMG_0064. 7/21/2022

GRM Approach	
GRM Code	
Gross Rent	0.00
Indicated Value	

Multiple Regression			
MRA Code	1	Test	
Adusted R	0.8445		
Indicated Value	213,733	122.34	Per SqFt

Direct Comparables			
Selection Model	A	Adam Test	
Adjustment Model	1	2022 Residential	
Comparables	3		
Indicated Value	272,740		Per SqFt

Cost Approach				Manual : 01/2025			
Base Cost	103.38	Total Misc Impr	+ 11,043				
Roofing Adj	+ 4.83	Garage Cost	+ 17,775				
Subfloor Adj	+ -2.31	Total RCN	= 255,439				
Heat/Cool Adj	+ 12.64	Depreciation (36%)	- 91,958				
Plumbing Adj	+ 11.18	Lump Sums	+ 0				
Basement Adj	+ 0.00	RCNLD	= 163,481				
Adj Base Cost	= 129.72	Lot Value	+ 22,225				
Total Area	x 1,747	Indicated Value	= 185,706				
Adjusted Cost	= 226,621	Value Per SqFt	106.30				

Value Reconciliation			
Selected Approach	Cost Approach		
Improvements	163,481		
Lot Value	22,225		
Indicated Value	185,706	106.30	Per SqFt
Agland Value			
Site Improvements			
Total Value	185,706	106.30	Total Value Per SqFt

Miscellaneous Improvements								
Code	Description	Sketch ID	Size	Year	Units	Unit Cost	Depr	Value
FPR1	FIREPLACE - RESIDENTIAL 1 STORY	0		1	1	5,615.40		5,615
PRCH	SLAB PORCH - COVERED	28479	15x4		60	26.74		1,604
PRCH	SLAB PORCH - COVERED	28480	12x5		60	26.74		1,604
PATO	SLAB PORCH - OPEN	28481	18x12		216	10.28		2,220



Rogers

Assessment Property Record Card for Tax Year 2026

Data provided by LISA DELOZIER County Assessor

Date 04/16/2026

Time 22:16:17

Page 3

Sketch Image

660011890

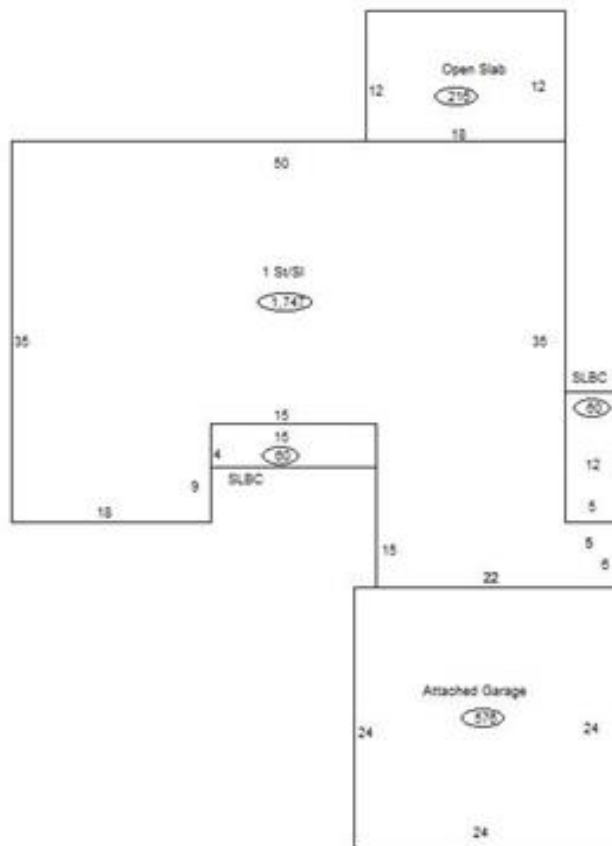

Sketch Vector Information

Sequence	Code	Type	Built Over	Scale	Section Label	Base Area	Multiplier	Total Area
1	R	1	Slab	13	1 St/Sl	1,747	1.000	1,747
2	G	1		13	Attached Garage	576	1.000	576
3	M	PRCH		13	SLBC	60	1.000	60
4	M	PRCH		13	SLBC	60	1.000	60
5	M	PATO		13	Open Slab	216	1.000	216
Total Building Area						1,747		1,747