



# Rogers

## Assessment Property Record Card for Tax Year 2026

Data provided by LISA DELOZIER County Assessor

Date 04/16/2026  
Time 23:10:46  
Page 1

Assessment Data					Primary Image																																																																																																																				
<b>Account</b> 660012019 <b>Parcel ID</b> 21N17E-11-1-00000-000-0000 <b>Cadastral ID</b> 11-21-17-00100 <b>Property Type</b> REAL - Real Property <b>Property Class</b> RA VI Area 3 <b>Tax Area</b> 94 - SEQUOYAH/TRI-DISTRICT FI <b>Name ID</b> 297001 DEWEESE, MARK E &  LIANA S TRUSTEES 20702 E 480 RD CLAREMORE OK 74019-0000																																																																																																																									
<b>Parcel Location</b> <b>Situs</b> 20702 E 480 RD <b>Subdivision</b> <b>Lot/Block</b> / <b>Parcel Size</b> 60 - Acres <b>Sec/Twn/Rng</b> 11 / 21 / 17 / 1 <b>Neighborhood</b> 2117 - UNPLATTED <b>School District</b> S006 - SEQUOYAH SCHOOLS																																																																																																																									
<b>Legal Description</b> Lat/Long: 36.31888438 -95.45603107 W2 SE NE & NE NE					<b>Building Permits</b> <table border="1"> <thead> <tr> <th>Number</th> <th>Description</th> <th>Opened</th> <th>Closed</th> <th>Amount</th> </tr> </thead> <tbody> <tr> <td colspan="5"> </td> </tr> </tbody> </table>					Number	Description	Opened	Closed	Amount																																																																																																											
Number	Description	Opened	Closed	Amount																																																																																																																					
<b>Exemptions</b> <table border="1"> <thead> <tr> <th>Code</th> <th>Type</th> <th>Active</th> <th>Maximum</th> <th>Exemption</th> </tr> </thead> <tbody> <tr> <td>H</td> <td>Homestead</td> <td>Yes</td> <td>1,000</td> <td>1,000</td> </tr> </tbody> </table>					Code	Type	Active	Maximum	Exemption	H	Homestead	Yes	1,000	1,000	<b>Sale History</b> <table border="1"> <thead> <tr> <th>Bk/Pg</th> <th>Grantor</th> <th>Date</th> <th>Price</th> <th>Code</th> </tr> </thead> <tbody> <tr> <td>1924/756</td> <td>DEWEESE, MARK E &amp;</td> <td>12/14/2007</td> <td>0</td> <td>4</td> </tr> <tr> <td>1080/426</td> <td>BISHOP, PEARL (BALDRIDGE)</td> <td>09/03/1997</td> <td>90,000</td> <td>No</td> </tr> </tbody> </table>					Bk/Pg	Grantor	Date	Price	Code	1924/756	DEWEESE, MARK E &	12/14/2007	0	4	1080/426	BISHOP, PEARL (BALDRIDGE)	09/03/1997	90,000	No																																																																																							
Code	Type	Active	Maximum	Exemption																																																																																																																					
H	Homestead	Yes	1,000	1,000																																																																																																																					
Bk/Pg	Grantor	Date	Price	Code																																																																																																																					
1924/756	DEWEESE, MARK E &	12/14/2007	0	4																																																																																																																					
1080/426	BISHOP, PEARL (BALDRIDGE)	09/03/1997	90,000	No																																																																																																																					
<b>Parcel Valuation</b> <table border="1"> <thead> <tr> <th>Source</th> <th>REAL</th> <th>Fair Cash</th> <th>Capped</th> <th>Asmnt Level</th> <th>Assessed</th> <th>Levy Rate</th> <th>98.320</th> <th>Current Tax</th> </tr> </thead> <tbody> <tr> <td>Remove Cap</td> <td>1998</td> <td>Land Value 6,996</td> <td>6,996</td> <td>11%</td> <td>770</td> <td>Assessed</td> <td>28,846</td> <td>2,836.14</td> </tr> <tr> <td>Year Frozen</td> <td>0</td> <td>Improvements 257,349</td> <td>255,228</td> <td></td> <td>28,076</td> <td>Penalty</td> <td>0</td> <td></td> </tr> <tr> <td>Uncapped Value</td> <td>0</td> <td>Mobile Home 0</td> <td>0</td> <td></td> <td>0</td> <td>Exemption</td> <td>1,000</td> <td>-88.00</td> </tr> <tr> <td>TIF Project ID</td> <td>0</td> <td>Total Value 264,345</td> <td>262,224</td> <td></td> <td>28,846</td> <td>Total Taxable</td> <td>27,846</td> <td>2,748.00</td> </tr> </tbody> </table>										Source	REAL	Fair Cash	Capped	Asmnt Level	Assessed	Levy Rate	98.320	Current Tax	Remove Cap	1998	Land Value 6,996	6,996	11%	770	Assessed	28,846	2,836.14	Year Frozen	0	Improvements 257,349	255,228		28,076	Penalty	0		Uncapped Value	0	Mobile Home 0	0		0	Exemption	1,000	-88.00	TIF Project ID	0	Total Value 264,345	262,224		28,846	Total Taxable	27,846	2,748.00																																																																			
Source	REAL	Fair Cash	Capped	Asmnt Level	Assessed	Levy Rate	98.320	Current Tax																																																																																																																	
Remove Cap	1998	Land Value 6,996	6,996	11%	770	Assessed	28,846	2,836.14																																																																																																																	
Year Frozen	0	Improvements 257,349	255,228		28,076	Penalty	0																																																																																																																		
Uncapped Value	0	Mobile Home 0	0		0	Exemption	1,000	-88.00																																																																																																																	
TIF Project ID	0	Total Value 264,345	262,224		28,846	Total Taxable	27,846	2,748.00																																																																																																																	
<b>Assessment History</b> <table border="1"> <thead> <tr> <th>Tax Year</th> <th>Statement Number</th> <th>Billed Owner</th> <th>Tax Area</th> <th>Total Value</th> <th>Exemptions</th> <th>Taxable Value</th> <th>Billed Tax</th> </tr> </thead> <tbody> <tr><td>2025</td><td>2025-660012019</td><td>DEWEESE, MARK E &amp;</td><td>94</td><td>259,597</td><td>1000</td><td>27,004</td><td>2,665.00</td></tr> <tr><td>2024</td><td>2024-660012019</td><td>DEWEESE, MARK E &amp;</td><td>94</td><td>266,214</td><td>1000</td><td>26,189</td><td>2,758.00</td></tr> <tr><td>2023</td><td>2023-660012019</td><td>DEWEESE, MARK E &amp;</td><td>94</td><td>243,498</td><td>1000</td><td>25,397</td><td>2,728.00</td></tr> <tr><td>2022</td><td>2022-660012019</td><td>DEWEESE, MARK E &amp;</td><td>94</td><td>241,633</td><td>1000</td><td>24,628</td><td>2,671.00</td></tr> <tr><td>2021</td><td>2021-660012019</td><td>DEWEESE, MARK E &amp;</td><td>94</td><td>228,476</td><td>1000</td><td>23,882</td><td>2,504.00</td></tr> <tr><td>2020</td><td>2020-660012019</td><td>DEWEESE, MARK E &amp;</td><td>94</td><td>224,257</td><td>1000</td><td>23,157</td><td>2,422.00</td></tr> <tr><td>2019</td><td>2019-660012019</td><td>DEWEESE, MARK E &amp;</td><td>94</td><td>213,215</td><td>1000</td><td>22,454</td><td>2,316.00</td></tr> <tr><td>2018</td><td>2018-660012019</td><td>DEWEESE, MARK E &amp;</td><td>94</td><td>223,669</td><td>1000</td><td>22,722</td><td>2,367.00</td></tr> <tr><td>2017</td><td>2017-660012019</td><td>DEWEESE, MARK E &amp;</td><td>94</td><td>188,780</td><td>1000</td><td>18,654</td><td>1,921.00</td></tr> <tr><td>2016</td><td>2016-660012019</td><td>DEWEESE, MARK E &amp;</td><td>94</td><td>184,806</td><td>1000</td><td>18,082</td><td>1,855.00</td></tr> <tr><td>2015</td><td>2015-660012019</td><td>DEWEESE, MARK E &amp;</td><td>94</td><td>180,611</td><td>1000</td><td>17,526</td><td>1,836.00</td></tr> <tr><td>2014</td><td>2014-660012019</td><td>DEWEESE, MARK E &amp;</td><td>94</td><td>182,776</td><td>1000</td><td>16,987</td><td>1,747.00</td></tr> <tr><td>2013</td><td>2013-660012019</td><td>DEWEESE, MARK E &amp;</td><td>94</td><td>155,569</td><td>1000</td><td>16,006</td><td>1,622.00</td></tr> </tbody> </table>										Tax Year	Statement Number	Billed Owner	Tax Area	Total Value	Exemptions	Taxable Value	Billed Tax	2025	2025-660012019	DEWEESE, MARK E &	94	259,597	1000	27,004	2,665.00	2024	2024-660012019	DEWEESE, MARK E &	94	266,214	1000	26,189	2,758.00	2023	2023-660012019	DEWEESE, MARK E &	94	243,498	1000	25,397	2,728.00	2022	2022-660012019	DEWEESE, MARK E &	94	241,633	1000	24,628	2,671.00	2021	2021-660012019	DEWEESE, MARK E &	94	228,476	1000	23,882	2,504.00	2020	2020-660012019	DEWEESE, MARK E &	94	224,257	1000	23,157	2,422.00	2019	2019-660012019	DEWEESE, MARK E &	94	213,215	1000	22,454	2,316.00	2018	2018-660012019	DEWEESE, MARK E &	94	223,669	1000	22,722	2,367.00	2017	2017-660012019	DEWEESE, MARK E &	94	188,780	1000	18,654	1,921.00	2016	2016-660012019	DEWEESE, MARK E &	94	184,806	1000	18,082	1,855.00	2015	2015-660012019	DEWEESE, MARK E &	94	180,611	1000	17,526	1,836.00	2014	2014-660012019	DEWEESE, MARK E &	94	182,776	1000	16,987	1,747.00	2013	2013-660012019	DEWEESE, MARK E &	94	155,569	1000	16,006	1,622.00
Tax Year	Statement Number	Billed Owner	Tax Area	Total Value	Exemptions	Taxable Value	Billed Tax																																																																																																																		
2025	2025-660012019	DEWEESE, MARK E &	94	259,597	1000	27,004	2,665.00																																																																																																																		
2024	2024-660012019	DEWEESE, MARK E &	94	266,214	1000	26,189	2,758.00																																																																																																																		
2023	2023-660012019	DEWEESE, MARK E &	94	243,498	1000	25,397	2,728.00																																																																																																																		
2022	2022-660012019	DEWEESE, MARK E &	94	241,633	1000	24,628	2,671.00																																																																																																																		
2021	2021-660012019	DEWEESE, MARK E &	94	228,476	1000	23,882	2,504.00																																																																																																																		
2020	2020-660012019	DEWEESE, MARK E &	94	224,257	1000	23,157	2,422.00																																																																																																																		
2019	2019-660012019	DEWEESE, MARK E &	94	213,215	1000	22,454	2,316.00																																																																																																																		
2018	2018-660012019	DEWEESE, MARK E &	94	223,669	1000	22,722	2,367.00																																																																																																																		
2017	2017-660012019	DEWEESE, MARK E &	94	188,780	1000	18,654	1,921.00																																																																																																																		
2016	2016-660012019	DEWEESE, MARK E &	94	184,806	1000	18,082	1,855.00																																																																																																																		
2015	2015-660012019	DEWEESE, MARK E &	94	180,611	1000	17,526	1,836.00																																																																																																																		
2014	2014-660012019	DEWEESE, MARK E &	94	182,776	1000	16,987	1,747.00																																																																																																																		
2013	2013-660012019	DEWEESE, MARK E &	94	155,569	1000	16,006	1,622.00																																																																																																																		



# Rogers

## Assessment Property Record Card for Tax Year 2026

Data provided by LISA DELOZIER County Assessor

Date 04/16/2026  
 Time 23:10:47  
 Page 2

Lot Data	Units-Buildable - UNPLATTED (UNITS BUILDABLE)	Primary Image
Lot Size		
Lot Count		
Units Buildable		
Non-Ag Acres	0	
Topography		
Street Access		
Utilities		
Amenities	LAND QUALITY	
Method	Units-Buildable	
Base Lot Value		
Factor Value		
Adjustments		
Lot Value		

Residential Data	
Type	1 Single Family Residence
Condition	3 - Average
Quality	2.5 - Fair
Architecture	
Style	100% One Story
Exterior Wall	100% Frame, Siding, Vinyl
Base/Total Area	1,800 / 1,800
Style	100% One Story
HVAC	100% Warmed & Cooled Air
Roof Cover	4 Metal, Preformed
Area on Slab	1,800
Fixture/RghIn	11 /
Bed/F/H Bath	3 / 2.0 /
Basement Area	
Garage Type	528 Attached Garage - Unfinished
Remodel	
Year/Eff Age	1999 / 20

\\tsclient\T\JAYSON\JAYSON RESIDENTIAL VI\2021-5-7\IMG\_001 5/7/2021

GRM Approach	
GRM Code	
Gross Rent	0.00
Indicated Value	

Multiple Regression	
MRA Code	
Adjusted R	
Indicated Value	

Direct Comparables	
Selection Model	1 Res
Adjustment Model	A2 AO Test
Comparables	
Indicated Value	

Cost Approach				Manual : 01/2025			
Base Cost	87.29	Total Misc Impr	+ 8,780				
Roofing Adj	+ 4.76	Garage Cost	+ 14,325				
Subfloor Adj	+ -1.09	Total RCN	= 221,537				
Heat/Cool Adj	+ 11.47	Depreciation ( 25%)	- 55,384				
Plumbing Adj	+ 7.81	Lump Sums	+ 0				
Basement Adj	+ 0.00	RCNLD	= 166,153				
Adj Base Cost	= 110.24	Lot Value	+ 166,153				
Total Area	x 1,800	Indicated Value	= 166,153				
Adjusted Cost	= 198,432	Value Per SqFt	92.31				

Value Reconciliation			
Selected Approach	Cost Approach		
Improvements	166,153		
Lot Value			
Indicated Value	166,153	92.31	Per SqFt
Agland Value	6,996		
Site Improvements	91,196		
Total Value	430,498	239.17	Total Value Per SqFt

Miscellaneous Improvements								
Code	Description	Sketch ID	Size	Year	Units	Unit Cost	Depr	Value
PRCH	SLAB PORCH - COVERED	28880	18x12		216	23.51		5,078
PRCH	SLAB PORCH - COVERED	28881	26x6		156	23.73		3,702



# Rogers

## Assessment Property Record Card for Tax Year 2026

Data provided by LISA DELOZIER County Assessor

Date 04/16/2026  
 Time 23:10:47  
 Page 3

### Sketch Image

660012019

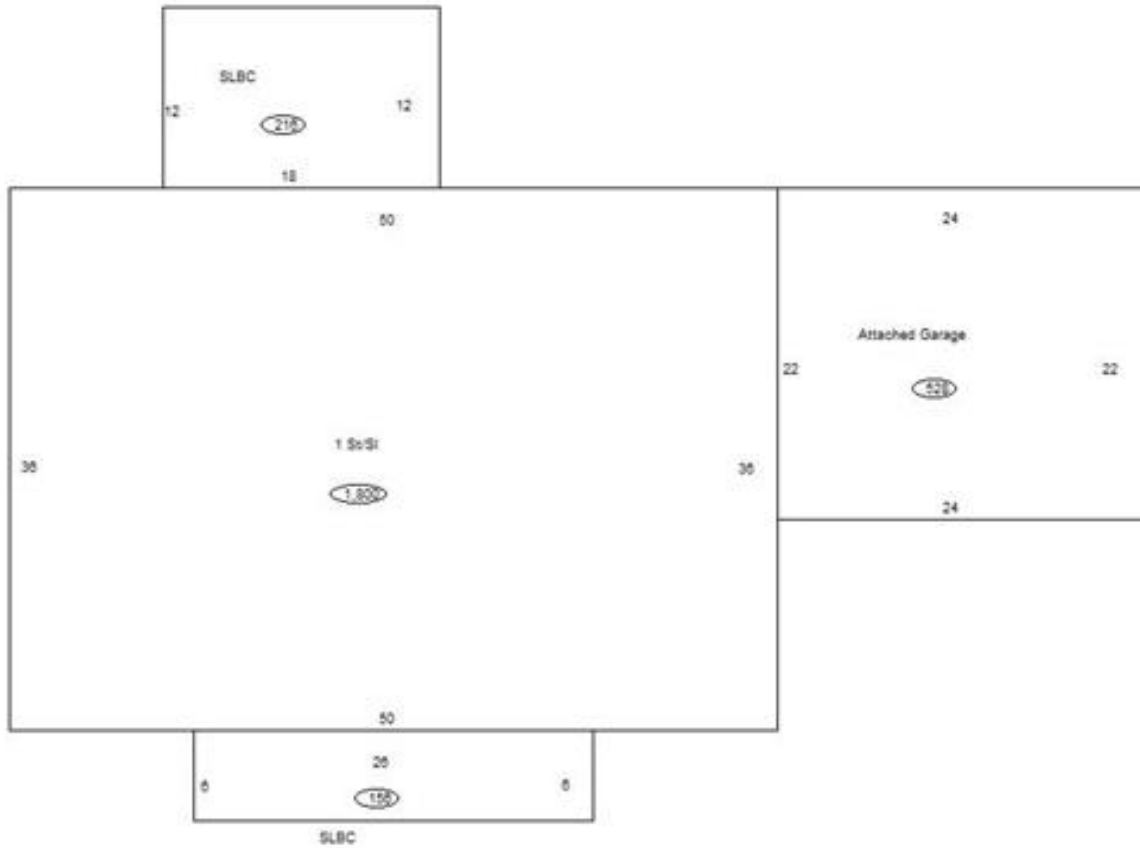

### Sketch Vector Information

Sequence	Code	Type	Built Over	Scale	Section Label	Base Area	Multiplier	Total Area
1	R	1	Slab	10	1 St/SI	1,800	1.000	1,800
2	G	1		10	Attached Garage	528	1.000	528
3	M	PRCH		10	SLBC	216	1.000	216
4	M	PRCH		10	SLBC	156	1.000	156
<b>Total Building Area</b>						<b>1,800</b>		<b>1,800</b>



# Rogers

## Assessment Property Record Card for Tax Year 2026

Data provided by LISA DELOZIER County Assessor

Date 04/16/2026  
 Time 23:10:47  
 Page 4

660012019

### Outbuildings/Site Improvements

Building Image	Code	Description	Dimensions	Floor	Roofing	Total Units		
	LF	LOAFING SHED	24x12x0			288		
	Qual	Cond	Year	2021	Eff Age			
	<b>Valuation Summary</b>		<b>Modifier Total</b>		<b>RCN</b>	<b>Depr (30% Phys/ % Func)</b>	<b>RCNLD</b>	
		Base Cost (4.26 x 288)	1,227		1,227	368	859	
	LF	LOAFING SHED	24x12x0			288		
	Qual	Cond	Year	2021	Eff Age			
	<b>Valuation Summary</b>		<b>Modifier Total</b>		<b>RCN</b>	<b>Depr (30% Phys/ % Func)</b>	<b>RCNLD</b>	
		Base Cost (4.26 x 288)	1,227		1,227	368	859	
	BARN	BARN	80x80x0			6,400		
	Qual	3	Cond	3	Year	2017	Eff Age	7
	<b>Valuation Summary</b>		<b>Modifier Total</b>		<b>RCN</b>	<b>Depr (28% Phys/ % Func)</b>	<b>RCNLD</b>	
		Base Cost (8.95 x 6,400)	57,280		57,280	16,038	41,242	
	BARN	BARN	30x30x0			900		
	Qual	3	Cond	3	Year	2013	Eff Age	10
	<b>Valuation Summary</b>		<b>Modifier Total</b>		<b>RCN</b>	<b>Depr (10% Phys/ % Func)</b>	<b>RCNLD</b>	
		Base Cost (12.32 x 900)	11,088		11,088	1,109	9,979	
	BARN	BARN	0x0x0			1,500		
	Qual	3	Cond	3	Year	2009	Eff Age	13
	<b>Valuation Summary</b>		<b>Modifier Total</b>		<b>RCN</b>	<b>Depr (57% Phys/ % Func)</b>	<b>RCNLD</b>	
		Base Cost (9.80 x 1,500)	14,700		14,700	8,379	6,321	
	HS	HAY SHED	60x60x0			3,600		
	Qual	3	Cond	3	Year	2009	Eff Age	
	<b>Valuation Summary</b>		<b>Modifier Total</b>		<b>RCN</b>	<b>Depr (30% Phys/ % Func)</b>	<b>RCNLD</b>	
		Base Cost (4.68 x 3,600)	16,848		16,848	5,054	11,794	
	BARN	BARN	0x0x0			2,160		
	Qual	3	Cond	3	Year		Eff Age	
	<b>Valuation Summary</b>		<b>Modifier Total</b>		<b>RCN</b>	<b>Depr (30% Phys/ % Func)</b>	<b>RCNLD</b>	
		Base Cost (9.02 x 2,160)	19,483		19,483	5,845	13,638	



# Rogers







## Assessment Property Record Card for Tax Year 2026

Data provided by LISA DELOZIER County Assessor

Date 04/16/2026  
Time 23:10:47  
Page 5

660012019

### Outbuildings/Site Improvements

Building Image	Code	Description	Dimensions	Floor	Roofing	Total Units	
	LT	LEAN-TO				720	
	Qual	3	Cond 3	Year	Eff Age		
	<b>Valuation Summary</b>		<b>Modifier Total</b>		<b>RCN</b>	<b>Depr (30% Phys/ % Func)</b>	<b>RCNLD</b>
		Base Cost (2.92 x 720)	2,102		2,102	631	1,471
	LT	LEAN-TO				720	
	Qual	3	Cond 3	Year	Eff Age		
	<b>Valuation Summary</b>		<b>Modifier Total</b>		<b>RCN</b>	<b>Depr (30% Phys/ % Func)</b>	<b>RCNLD</b>
		Base Cost (2.92 x 720)	2,102		2,102	631	1,471
	LF	LOAFING SHED				160	
	Qual	3	Cond 3	Year	Eff Age		
	<b>Valuation Summary</b>		<b>Modifier Total</b>		<b>RCN</b>	<b>Depr (30% Phys/ % Func)</b>	<b>RCNLD</b>
		Base Cost (4.26 x 160)	682		682	205	477
	LF	LOAFING SHED				160	
	Qual	3	Cond 3	Year	Eff Age		
	<b>Valuation Summary</b>		<b>Modifier Total</b>		<b>RCN</b>	<b>Depr (30% Phys/ % Func)</b>	<b>RCNLD</b>
		Base Cost (4.26 x 160)	682		682	205	477
	LF	LOAFING SHED				360	
	Qual	3	Cond 3	Year	Eff Age		
	<b>Valuation Summary</b>		<b>Modifier Total</b>		<b>RCN</b>	<b>Depr (30% Phys/ % Func)</b>	<b>RCNLD</b>
		Base Cost (4.26 x 360)	1,534		1,534	460	1,074
	LF	LOAFING SHED				360	
	Qual	3	Cond 3	Year	Eff Age		
	<b>Valuation Summary</b>		<b>Modifier Total</b>		<b>RCN</b>	<b>Depr (0% Phys/ % Func)</b>	<b>RCNLD</b>
		Base Cost (4.26 x 360)	1,534		1,534		1,534



# Rogers

## Assessment Property Record Card for Tax Year 2026

Data provided by LISA DELOZIER County Assessor

Date 04/16/2026  
Time 23:10:47  
Page 6

### Agland Inventory

660012019

Soi	Description	Land Use	LPI	Adj Type	Adj Code	Acres	Use/Acre	Mkt/Acre	Use Value	Market Value
BC	BATES-COLLINSVILLE COMPLE	NTV PST	51			48.882	122	122	5,983	5,983
BR	BREAKS-ALLUVIAL LAND COMP	TMBR	30			8.127	54	54	439	439
DNB	DENNIS SILT LOAM 1-3% SLO	NTV PST	80			2.991	192	192	574	574
<b>NTV PST Totals</b>						60.000			6,996	6,996
<b>Total Agland</b>						60.000			6,996	6,996