



# Rogers

## Assessment Property Record Card for Tax Year 2026

Data provided by LISA DELOZIER County Assessor

Date 04/16/2026  
Time 23:09:06  
Page 1

Assessment Data					Primary Image																																																																																																																				
<b>Account</b> 660012054 <b>Parcel ID</b> 000000-00-0-00090-001-0011 <b>Cadastral ID</b> 11-21-17-02910 <b>Property Type</b> REAL - Real Property <b>Property Class</b> RRP VI Area 3 <b>Tax Area</b> 94 - SEQUOYAH/TRI-DISTRICT FI <b>Name ID</b> 282653 ARMSTRONG, SHAWN W & JILL D  20613 S BRYANWOOD DR CLAREMORE OK 74019-0000  <b>Parcel Location</b> <b>Situs</b> 20613 S BRYANWOOD DR <b>Subdivision</b> BRYANWOOD ESTATES <b>Lot/Block</b> 0011 / 0001 <b>Parcel Size</b> 1 - Lots <b>Sec/Twn/Rng</b> 11 / 21 / 17 / 5 <b>Neighborhood</b> 1061 - R-V03-SE SEQUOYAH <b>School District</b> S006 - SEQUOYAH SCHOOLS																																																																																																																									
<b>Legal Description</b> Lot/Long: 36.31234545 -95.45895262										<b>Building Permits</b> <table border="1"> <thead> <tr> <th>Number</th> <th>Description</th> <th>Opened</th> <th>Closed</th> <th>Amount</th> </tr> </thead> <tbody> <tr> <td>660012054_004.JPG</td> <td></td> <td></td> <td></td> <td>12/18/2025</td> </tr> </tbody> </table>					Number	Description	Opened	Closed	Amount	660012054_004.JPG				12/18/2025																																																																																																	
Number	Description	Opened	Closed	Amount																																																																																																																					
660012054_004.JPG				12/18/2025																																																																																																																					
<b>Exemptions</b> <table border="1"> <thead> <tr> <th>Code</th> <th>Type</th> <th>Active</th> <th>Maximum</th> <th>Exemption</th> </tr> </thead> <tbody> <tr> <td></td> <td></td> <td></td> <td></td> <td></td> </tr> </tbody> </table>					Code	Type	Active	Maximum	Exemption						<b>Sale History</b> <table border="1"> <thead> <tr> <th>Bk/Pg</th> <th>Grantor</th> <th>Date</th> <th>Price</th> <th>Code</th> </tr> </thead> <tbody> <tr> <td>1481/527</td> <td>PHILLIPS, CHARLOTTE ELAINE</td> <td>05/16/2003</td> <td>104,000</td> <td>YES</td> </tr> <tr> <td>1246/699</td> <td>FERGUSON, LLOYD W TRUSTEE</td> <td>08/15/2000</td> <td>89,500</td> <td>No</td> </tr> </tbody> </table>					Bk/Pg	Grantor	Date	Price	Code	1481/527	PHILLIPS, CHARLOTTE ELAINE	05/16/2003	104,000	YES	1246/699	FERGUSON, LLOYD W TRUSTEE	08/15/2000	89,500	No																																																																																							
Code	Type	Active	Maximum	Exemption																																																																																																																					
Bk/Pg	Grantor	Date	Price	Code																																																																																																																					
1481/527	PHILLIPS, CHARLOTTE ELAINE	05/16/2003	104,000	YES																																																																																																																					
1246/699	FERGUSON, LLOYD W TRUSTEE	08/15/2000	89,500	No																																																																																																																					
<b>Parcel Valuation</b> <table border="1"> <thead> <tr> <th>Source</th> <th>REAL</th> <th>Fair Cash</th> <th>Capped</th> <th>Asmnt Level</th> <th>Assessed</th> <th>Levy Rate</th> <th>98.320</th> <th>Current Tax</th> </tr> </thead> <tbody> <tr> <td>Remove Cap</td> <td>2004</td> <td>Land Value 63,684</td> <td>33,247</td> <td>11%</td> <td>3,657</td> <td>Assessed</td> <td>15,360</td> <td>1,510.20</td> </tr> <tr> <td>Year Frozen</td> <td>0</td> <td>Improvements 110,394</td> <td>106,390</td> <td></td> <td>11,703</td> <td>Penalty</td> <td>0</td> <td></td> </tr> <tr> <td>Uncapped Value</td> <td>0</td> <td>Mobile Home 0</td> <td>0</td> <td></td> <td>0</td> <td>Exemption</td> <td>0</td> <td>0.00</td> </tr> <tr> <td>TIF Project ID</td> <td>0</td> <td>Total Value 174,078</td> <td>139,637</td> <td></td> <td>15,360</td> <td>Total Taxable</td> <td>15,360</td> <td>1,510.00</td> </tr> </tbody> </table>										Source	REAL	Fair Cash	Capped	Asmnt Level	Assessed	Levy Rate	98.320	Current Tax	Remove Cap	2004	Land Value 63,684	33,247	11%	3,657	Assessed	15,360	1,510.20	Year Frozen	0	Improvements 110,394	106,390		11,703	Penalty	0		Uncapped Value	0	Mobile Home 0	0		0	Exemption	0	0.00	TIF Project ID	0	Total Value 174,078	139,637		15,360	Total Taxable	15,360	1,510.00																																																																			
Source	REAL	Fair Cash	Capped	Asmnt Level	Assessed	Levy Rate	98.320	Current Tax																																																																																																																	
Remove Cap	2004	Land Value 63,684	33,247	11%	3,657	Assessed	15,360	1,510.20																																																																																																																	
Year Frozen	0	Improvements 110,394	106,390		11,703	Penalty	0																																																																																																																		
Uncapped Value	0	Mobile Home 0	0		0	Exemption	0	0.00																																																																																																																	
TIF Project ID	0	Total Value 174,078	139,637		15,360	Total Taxable	15,360	1,510.00																																																																																																																	
<b>Assessment History</b> <table border="1"> <thead> <tr> <th>Tax Year</th> <th>Statement Number</th> <th>Billed Owner</th> <th>Tax Area</th> <th>Total Value</th> <th>Exemptions</th> <th>Taxable Value</th> <th>Billed Tax</th> </tr> </thead> <tbody> <tr><td>2025</td><td>2025-660012054</td><td>ARMSTRONG, SHAWN W &amp; JILL D</td><td>94</td><td>169,854</td><td>0</td><td>14,629</td><td>1,438.00</td></tr> <tr><td>2024</td><td>2024-660012054</td><td>ARMSTRONG, SHAWN W &amp; JILL D</td><td>94</td><td>226,566</td><td>0</td><td>13,932</td><td>1,459.00</td></tr> <tr><td>2023</td><td>2023-660012054</td><td>ARMSTRONG, SHAWN W &amp; JILL D</td><td>94</td><td>120,625</td><td>0</td><td>13,269</td><td>1,417.00</td></tr> <tr><td>2022</td><td>2022-660012054</td><td>ARMSTRONG, SHAWN W &amp; JILL D</td><td>94</td><td>119,046</td><td>0</td><td>13,095</td><td>1,412.00</td></tr> <tr><td>2021</td><td>2021-660012054</td><td>ARMSTRONG, SHAWN W &amp; JILL D</td><td>94</td><td>120,375</td><td>0</td><td>13,241</td><td>1,380.00</td></tr> <tr><td>2020</td><td>2020-660012054</td><td>ARMSTRONG, SHAWN W &amp; JILL D</td><td>94</td><td>118,572</td><td>0</td><td>13,043</td><td>1,357.00</td></tr> <tr><td>2019</td><td>2019-660012054</td><td>ARMSTRONG, SHAWN W &amp; JILL D</td><td>94</td><td>115,472</td><td>0</td><td>12,702</td><td>1,303.00</td></tr> <tr><td>2018</td><td>2018-660012054</td><td>ARMSTRONG, SHAWN W &amp; JILL D</td><td>94</td><td>119,821</td><td>0</td><td>13,180</td><td>1,366.00</td></tr> <tr><td>2017</td><td>2017-660012054</td><td>ARMSTRONG, SHAWN W &amp; JILL D</td><td>94</td><td>119,003</td><td>0</td><td>13,090</td><td>1,339.00</td></tr> <tr><td>2016</td><td>2016-660012054</td><td>ARMSTRONG, SHAWN W &amp; JILL D</td><td>94</td><td>116,239</td><td>0</td><td>12,786</td><td>1,302.00</td></tr> <tr><td>2015</td><td>2015-660012054</td><td>ARMSTRONG, SHAWN W &amp; JILL D</td><td>94</td><td>114,005</td><td>0</td><td>12,423</td><td>1,292.00</td></tr> <tr><td>2014</td><td>2014-660012054</td><td>ARMSTRONG, SHAWN W &amp; JILL D</td><td>94</td><td>114,857</td><td>0</td><td>11,831</td><td>1,209.00</td></tr> <tr><td>2013</td><td>2013-660012054</td><td>ARMSTRONG, SHAWN W &amp; JILL D</td><td>94</td><td>102,434</td><td>0</td><td>11,268</td><td>1,135.00</td></tr> </tbody> </table>										Tax Year	Statement Number	Billed Owner	Tax Area	Total Value	Exemptions	Taxable Value	Billed Tax	2025	2025-660012054	ARMSTRONG, SHAWN W & JILL D	94	169,854	0	14,629	1,438.00	2024	2024-660012054	ARMSTRONG, SHAWN W & JILL D	94	226,566	0	13,932	1,459.00	2023	2023-660012054	ARMSTRONG, SHAWN W & JILL D	94	120,625	0	13,269	1,417.00	2022	2022-660012054	ARMSTRONG, SHAWN W & JILL D	94	119,046	0	13,095	1,412.00	2021	2021-660012054	ARMSTRONG, SHAWN W & JILL D	94	120,375	0	13,241	1,380.00	2020	2020-660012054	ARMSTRONG, SHAWN W & JILL D	94	118,572	0	13,043	1,357.00	2019	2019-660012054	ARMSTRONG, SHAWN W & JILL D	94	115,472	0	12,702	1,303.00	2018	2018-660012054	ARMSTRONG, SHAWN W & JILL D	94	119,821	0	13,180	1,366.00	2017	2017-660012054	ARMSTRONG, SHAWN W & JILL D	94	119,003	0	13,090	1,339.00	2016	2016-660012054	ARMSTRONG, SHAWN W & JILL D	94	116,239	0	12,786	1,302.00	2015	2015-660012054	ARMSTRONG, SHAWN W & JILL D	94	114,005	0	12,423	1,292.00	2014	2014-660012054	ARMSTRONG, SHAWN W & JILL D	94	114,857	0	11,831	1,209.00	2013	2013-660012054	ARMSTRONG, SHAWN W & JILL D	94	102,434	0	11,268	1,135.00
Tax Year	Statement Number	Billed Owner	Tax Area	Total Value	Exemptions	Taxable Value	Billed Tax																																																																																																																		
2025	2025-660012054	ARMSTRONG, SHAWN W & JILL D	94	169,854	0	14,629	1,438.00																																																																																																																		
2024	2024-660012054	ARMSTRONG, SHAWN W & JILL D	94	226,566	0	13,932	1,459.00																																																																																																																		
2023	2023-660012054	ARMSTRONG, SHAWN W & JILL D	94	120,625	0	13,269	1,417.00																																																																																																																		
2022	2022-660012054	ARMSTRONG, SHAWN W & JILL D	94	119,046	0	13,095	1,412.00																																																																																																																		
2021	2021-660012054	ARMSTRONG, SHAWN W & JILL D	94	120,375	0	13,241	1,380.00																																																																																																																		
2020	2020-660012054	ARMSTRONG, SHAWN W & JILL D	94	118,572	0	13,043	1,357.00																																																																																																																		
2019	2019-660012054	ARMSTRONG, SHAWN W & JILL D	94	115,472	0	12,702	1,303.00																																																																																																																		
2018	2018-660012054	ARMSTRONG, SHAWN W & JILL D	94	119,821	0	13,180	1,366.00																																																																																																																		
2017	2017-660012054	ARMSTRONG, SHAWN W & JILL D	94	119,003	0	13,090	1,339.00																																																																																																																		
2016	2016-660012054	ARMSTRONG, SHAWN W & JILL D	94	116,239	0	12,786	1,302.00																																																																																																																		
2015	2015-660012054	ARMSTRONG, SHAWN W & JILL D	94	114,005	0	12,423	1,292.00																																																																																																																		
2014	2014-660012054	ARMSTRONG, SHAWN W & JILL D	94	114,857	0	11,831	1,209.00																																																																																																																		
2013	2013-660012054	ARMSTRONG, SHAWN W & JILL D	94	102,434	0	11,268	1,135.00																																																																																																																		



# Rogers

## Assessment Property Record Card for Tax Year 2026

Data provided by LISA DELOZIER County Assessor

Date 04/16/2026  
 Time 23:09:07  
 Page 2

Lot Data		Square-Foot - NBHD 1061 #1		Primary Image				
Lot Size				<p>660012054 12/18/25</p> <p>660012054_004.JPG 12/18/2025</p>				
Lot Count								
Units Buildable	1							
Non-Ag Acres	4.8099							
Topography								
Street Access								
Utilities								
Amenities	LAND QUALITY	0	0					
Method	Square-Foot							
Base Lot Value	209,518.00 x .30 = 63,684							
Factor Value								
Adjustments								
Lot Value	63,684							
Residential Data								
Type	1 Single Family Residence							
Condition	3 - Average							
Quality	2.5 - Fair							
Architecture								
Style	100% One Story							
Exterior Wall	100% Veneer, Masonry							
Base/Total Area	1,214 / 1,214							
Style	100% One Story							
HVAC	100% Warmed & Cooled Air							
Roof Cover	1 Composition Shingle							
Area on Slab	1,214							
Fixture/RghIn	7 /							
Bed/F/H Bath	3 / 1.5 /							
Basement Area								
Garage Type	260 Attached Garage - Unfinished							
Remodel								
Year/Eff Age	1983 / 32							
Cost Approach		Manual : 01/2025						
Base Cost	112.34	Total Misc Impr	+	15,479				
Roofing Adj	+ 4.74	Garage Cost	+	8,650				
Subfloor Adj	+ -1.21	Total RCN	=	187,946				
Heat/Cool Adj	+ 11.47	Depreciation ( 42%)	-	78,937				
Plumbing Adj	+ 7.60	Lump Sums	+	0				
Basement Adj	+ 0.00	RCNLD	=	109,009				
Adj Base Cost	= 134.94	Lot Value	+	63,684				
Total Area	x 1,214	Indicated Value	=	172,693				
Adjusted Cost	= 163,817	Value Per SqFt		142.25				
Value Reconciliation								
Selected Approach		Cost Approach						
Improvements	109,009							
Lot Value	63,684							
Indicated Value	172,693	142.25	Per SqFt					
Agland Value								
Site Improvements	1,385							
Total Value	174,078	143.39	Total Value Per SqFt					
Miscellaneous Improvements								
Code	Description	Sketch ID	Size	Year	Units	Unit Cost	Depr	Value
PRCH	SLAB PORCH - COVERED	28958	696		696	22.24		15,479



**Rogers**  
**Assessment Property Record Card for Tax Year 2026**

Data provided by LISA DELOZIER County Assessor

Date 04/16/2026  
 Time 23:09:07  
 Page 3

**Sketch Image**

660012054

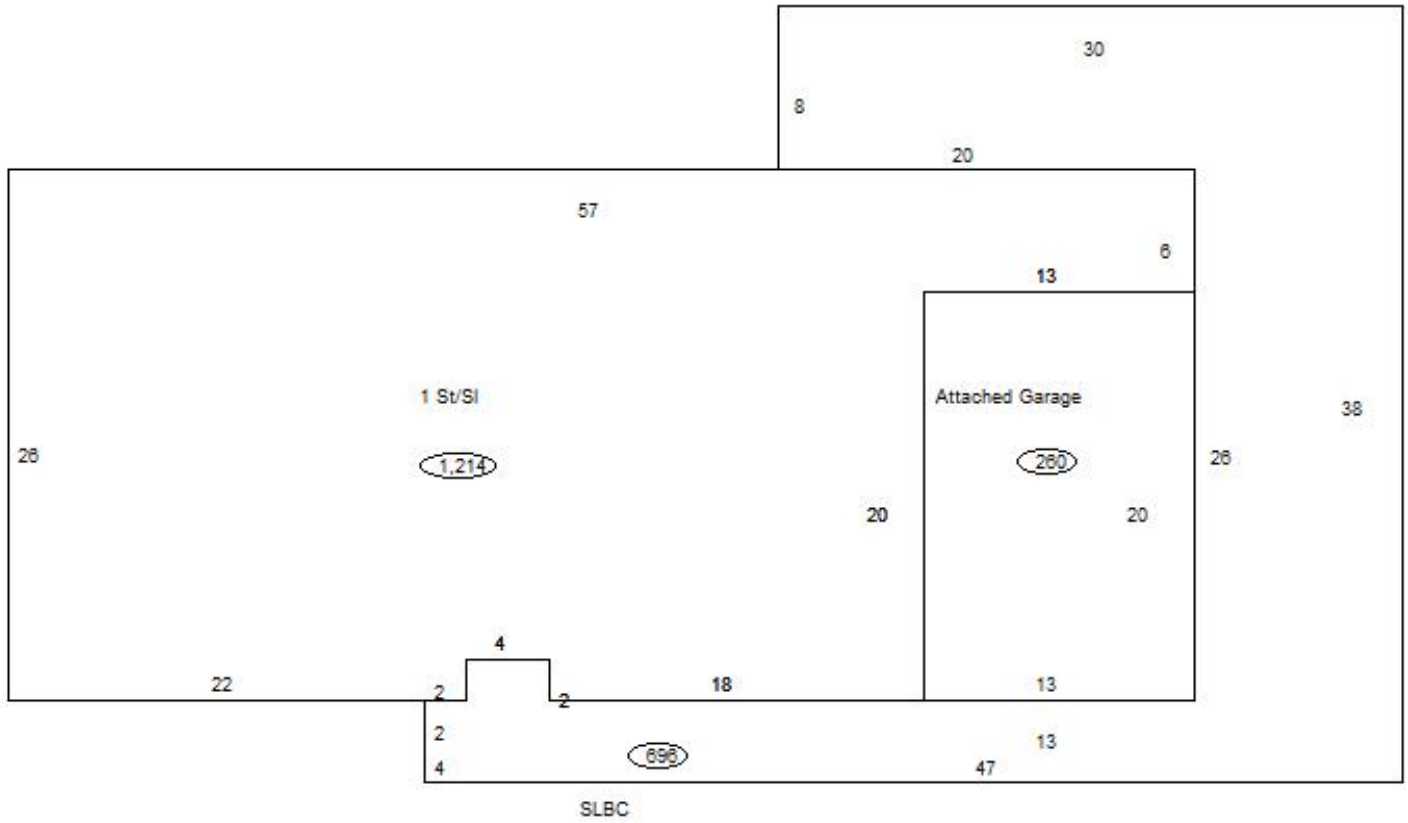

**Sketch Vector Information**

Sequence	Code	Type	Built Over	Scale	Section Label	Base Area	Multiplier	Total Area
1	R	1	Slab	10	1 St/SI	1,214	1.000	1,214
2	G	1		10	Attached Garage	260	1.000	260
3	M	PRCH		10	SLBC	696	1.000	696
<b>Total Building Area</b>						1,214		1,214



# Rogers



## Assessment Property Record Card for Tax Year 2026

Data provided by LISA DELOZIER County Assessor

Date 04/16/2026  
 Time 23:09:07  
 Page 4

660012054

### Outbuildings/Site Improvements

Building Image	Code	Description	Dimensions	Floor	Roofing	Total Units
	BARN	BARN	0x0x0			540
	Qual 2	Cond 3	Year	Eff Age		
	<b>Valuation Summary</b>		<b>Modifier Total</b>	<b>RCN</b>	<b>Depr (75% Phys/ % Func)</b>	<b>RCNLD</b>
Base Cost (10.26 x 540)		5,540		5,540	4,155	1,385
	STF	STG FAIR	0x0x0			
	Qual 2	Cond	Year	Eff Age		
	<b>Valuation Summary</b>		<b>Modifier Total</b>	<b>RCN</b>	<b>Depr (100% Phys/ % Func)</b>	<b>RCNLD</b>
Base Cost (4.68 x )						
	STF	STG FAIR	0x0x0			
	Qual 2	Cond	Year	Eff Age		
	<b>Valuation Summary</b>		<b>Modifier Total</b>	<b>RCN</b>	<b>Depr (0% Phys/ % Func)</b>	<b>RCNLD</b>
Base Cost (4.68 x )						