



Rogers

Assessment Property Record Card for Tax Year 2026

Data provided by LISA DELOZIER County Assessor

Date 04/17/2026
Time 04:21:29
Page 1

Assessment Data					Primary Image				
Account	660012224				No Image On File				
Parcel ID	23N16E-11-3-00000-000-0000								
Cadastral ID	11-23-16-00900								
Property Type	REAL - Real Property								
Property Class	RA	VI Area 2							
Tax Area	71 - CHELSEA RURAL/FOYIL FIRE								
Name ID	25924								
EAGLEBURGER, WILLIAM H									
8621 S 4170 RD CLAREMORE OK 74017-0000									
Parcel Location									
Situs	08621 S 4170 RD								
Subdivision									
Lot/Block	/	Parcel Size	30 - Acres						
Sec/Twn/Rng	11 / 23 / 16 / 3								
Neighborhood	4050 - CHELSEA FOYIL RURAL								
School District	S003 - CHELSEA SCHOOLS								
C:\Users\RLN\Pictures\2016-09-01 09-01-16\09-01-16 020.JPG 9/2/2016									
Legal Description Lat/Long: 36.48595229 -95.57580167									
Building Permits									
S2 NW SW & SW NE SW					Number	Description	Opened	Closed	Amount
Exemptions					Sale History				
Code	Type	Active	Maximum	Exemption	Bk/Pg	Grantor	Date	Price	Code
H	Homestead	Yes	1,000	1,000					
Parcel Valuation									
Source	REAL	Fair Cash	Capped	Asmnt Level	Assessed	Levy Rate	95.740	Current Tax	
Remove Cap	0	Land Value	4,368	4,368	11%	480	Assessed	4,974	476.21
Year Frozen	0	Improvements	73,539	26,113		2,872	Penalty	0	
Uncapped Value	0	Mobile Home	19,502	14,741		1,622	Exemption	1,000	-83.00
TIF Project ID	0	Total Value	97,409	45,222		4,974	Total Taxable	3,974	393.00
Assessment History									
Tax Year	Statement Number	Billed Owner	Tax Area	Total Value	Exemptions	Taxable Value	Billed Tax		
2025	2025-660012224	EAGLEBURGER, WILLIAM H	71	82,898	1000	3,829	380.00		
2024	2024-660012224	EAGLEBURGER, WILLIAM H	71	75,568	1000	3,689	373.00		
2023	2023-660012224	EAGLEBURGER, WILLIAM H	71	63,701	1000	3,552	364.00		
2022	2022-660012224	EAGLEBURGER, WILLIAM H	71	59,389	1000	3,419	353.00		
2021	2021-660012224	EAGLEBURGER, WILLIAM H	71	43,663	1000	3,291	344.00		
2020	2020-660012224	EAGLEBURGER, WILLIAM H	71	42,173	1000	3,166	336.00		
2019	2019-660012224	EAGLEBURGER, WILLIAM H	71	41,474	1000	3,045	329.00		
2018	2018-660012224	EAGLEBURGER, WILLIAM H	71	43,656	1000	2,926	313.00		
2017	2017-660012224	EAGLEBURGER, WILLIAM H	71	43,408	1000	2,813	305.00		
2016	2016-660012224	EAGLEBURGER, WILLIAM H	71	32,168	1000	2,204	246.00		
2015	2015-660012224	EAGLEBURGER, WILLIAM H	71	28,281	1000	2,111	234.00		
2014	2014-660012224	EAGLEBURGER, WILLIAM H	71	29,053	1000	2,196	250.00		
2013	2013-660012224	EAGLEBURGER, WILLIAM H	71	32,450	1000	2,569	285.00		



Rogers

Assessment Property Record Card for Tax Year 2026

Data provided by LISA DELOZIER County Assessor

Date 04/17/2026
 Time 04:21:29
 Page 2

Lot Data		Units Buildable - CHELSEA FOYIL RURAL (UNITS BUILDABLE)		Primary Image				
Lot Size								
Lot Count								
Units Buildable								
Non-Ag Acres	0							
Topography								
Street Access								
Utilities								
Amenities	LAND QUALITY							
Method	Units-Buildable							
Base Lot Value								
Factor Value								
Adjustments								
Lot Value								
Residential Data				C:\Users\RLN\Pictures\2016-09-01 09-01-16\09-01-16 020.JPG 9/2/2016				
Type				GRM Approach				
Condition	-			GRM Code				
Quality	-			Gross Rent	0.00			
Architecture				Indicated Value				
Style				Multiple Regression				
Exterior Wall				MRA Code				
Base/Total Area /				Adusted R				
Style				Indicated Value				
HVAC				Direct Comparables				
Roof Cover				Selection Model	1 Res			
Area on Slab				Adjustment Model	A2 AO Test			
Fixture/RghIn /				Comparables				
Bed/F/H Bath / /				Indicated Value				
Basement Area				Value Reconciliation				
Garage Type				Selected Approach	Cost Approach			
Remodel				Improvements				
Year/Eff Age /				Lot Value				
Cost Approach Manual : 01/2025				Indicated Value	0.00 Per SqFt			
Base Cost	0.00	Total Misc Impr	+ 0	Agland Value	4,368			
Roofing Adj	+ 0.00	Garage Cost	+ 0	Site Improvements	64,891			
Subfloor Adj	+ 0.00	Total RCN	= 0	Total Value	69,259 0.00 Total Value Per SqFt			
Heat/Cool Adj	+ 0.00	Depreciation (0%)	- 0					
Plumbing Adj	+ 0.00	Lump Sums	+ 0					
Basement Adj	+ 0.00	RCNLD	= 0					
Adj Base Cost	= 0.00	Lot Value	+ 0					
Total Area	x	Indicated Value	= 0					
Adjusted Cost	= 0	Value Per SqFt	0.00					
Miscellaneous Improvements								
Code	Description	Sketch ID	Size	Year	Units	Unit Cost	Depr	Value



Rogers



Assessment Property Record Card for Tax Year 2026

Data provided by LISA DELOZIER County Assessor

Date 04/17/2026
 Time 04:21:29
 Page 3

660012224

Outbuildings/Site Improvements

Building Image	Code	Description	Dimensions	Floor	Roofing	Total Units
	UTIL	SHOP BUILDING	24x30x10	Concrete	Formed Metal	720
	Qual	3	Cond 3	Year 2016	Eff Age 8	
	Valuation Summary		Modifier Total	RCN	Depr (15% Phys/ % Func)	RCNLD
	Base Cost (31.86 x 720)		22,939	22,939	3,441	19,498
	UTIL	SHOP BUILDING	30x60x12	Concrete	Formed Metal	1,800
	Qual	3	Cond 3	Year 2010	Eff Age 12	
	Valuation Summary		Modifier Total	RCN	Depr (25% Phys/ % Func)	RCNLD
	Base Cost (29.96 x 1,800)		53,928	53,928	13,482	40,446
	LNTL	Lean To - Attached	16x16x8	Dirt	Formed Metal	256
	Qual	2	Cond 3	Year 2000	Eff Age 20	
	Valuation Summary		Modifier Total	RCN	Depr (69% Phys/ % Func)	RCNLD
	Base Cost (8.52 x 256)		2,181	2,181	1,505	676
	BNGP	Barn - General Purpose	16x27x10	Dirt	Formed Metal	432
	Qual	2	Cond 3	Year 1990	Eff Age 27	
	Valuation Summary		Modifier Total	RCN	Depr (55% Phys/ % Func)	RCNLD
	Base Cost (21.97 x 432)		9,491	9,491	5,220	4,271



Rogers

Assessment Property Record Card for Tax Year 2026

Data provided by LISA DELOZIER County Assessor

Date 04/17/2026
 Time 04:21:30
 Page 4

Lot Data	Primary Image
Lot Size Lot Count Units Buildable Non-Ag Acres Topography Street Access Utilities Amenities LAND QUALITY Method Base Lot Value Factor Value Adjustments Lot Value	

Residential Data	
Type	6 Mobile Home 52 x 24
Condition	3 - Average
Quality	3 - Average
Architecture	6 MS ADJ
Style	100% Double Wide
Exterior Wall	100% Lap
Base/Total Area	1,248 / 1,248
Style	100% Double Wide
HVAC	100% Warmed & Cooled Air
Roof Cover	1 Composition Shingle
Area on Slab	0
Fixture/RghIn	/
Bed/F/H Bath	3 / 2.0 /
Basement Area	
Garage Type	
Remodel	
Year/Eff Age	1980 / 35

GRM Approach	
GRM Code	
Gross Rent	0.00
Indicated Value	

Multiple Regression	
MRA Code	
Adusted R	
Indicated Value	

Direct Comparables	
Selection Model	1 Res
Adjustment Model	A2 AO Test
Comparables	
Indicated Value	

Cost Approach				Manual : 01/2025			
Base Cost	35.17	Total Misc Impr	+ 13,120	Roofing Adj	+ 2.66	Garage Cost	+ 0.00
Subfloor Adj	+ 0.00	Total RCN	= 75,008	Heat/Cool Adj	+ 3.40	Depreciation (74%)	- 55,506
Plumbing Adj	+ 8.36	Lump Sums	+ 8,648	Basement Adj	+ 0.00	RCNLD	= 28,150
Adj Base Cost	= 49.59	Lot Value	+ 28,150	Total Area	x 1,248	Indicated Value	= 28,150
		Value Per SqFt	22.56	Adjusted Cost	= 61,888		

Value Reconciliation			
Selected Approach	Cost Approach		
Improvements	28,150		
Lot Value			
Indicated Value	28,150	22.56	Per SqFt
Agland Value			
Site Improvements			
Total Value	28,150	22.56	Total Value Per SqFt

Miscellaneous Improvements								
Code	Description	Sketch ID	Size	Year	Units	Unit Cost	Depr	Value
WODC	WOOD DECK - COVERED	132704	52x5		260	33.26		8,648
EPSW	ENCLOSED PORCH - SOLID WALL	132705	32x10		320	41.00		13,120



Rogers
Assessment Property Record Card for Tax Year 2026

Data provided by LISA DELOZIER County Assessor

Date 04/17/2026
 Time 04:21:30
 Page 5

Sketch Image

660012224

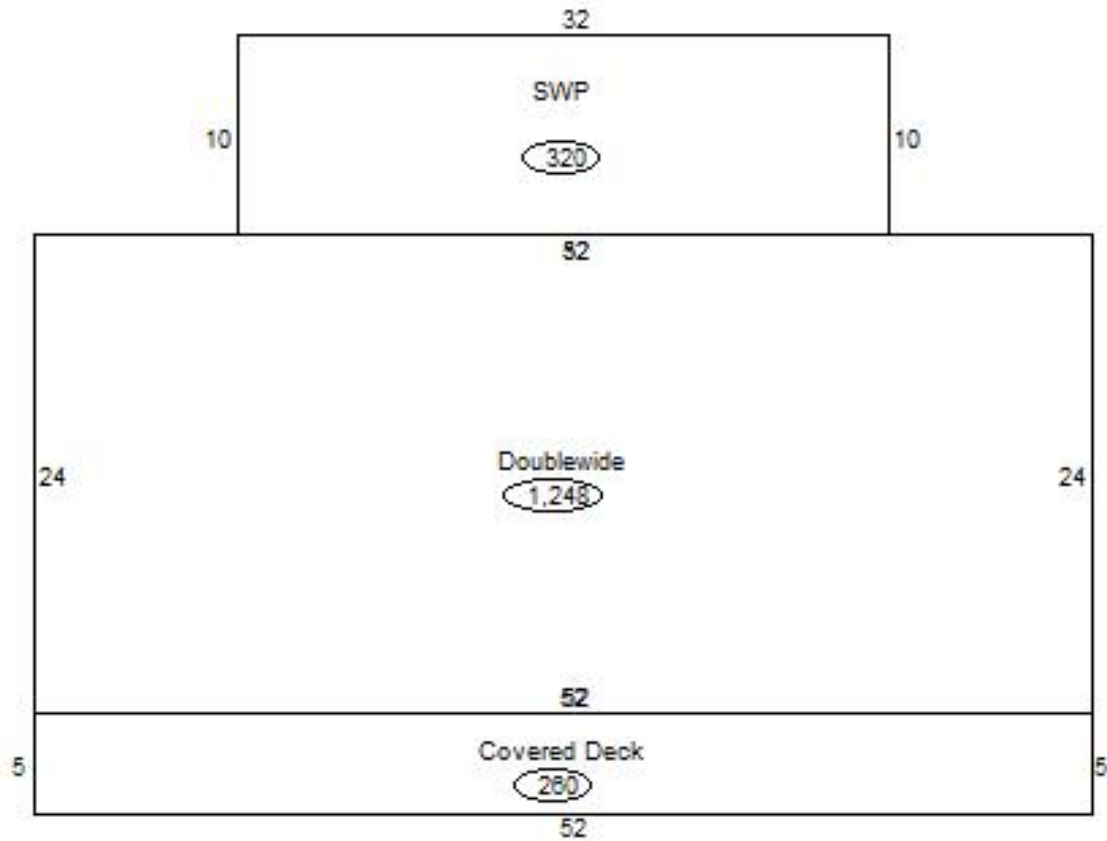

Sketch Vector Information

Sequence	Code	Type	Built Over	Scale	Section Label	Base Area	Multiplier	Total Area
1	R	14		13	Doublewide	1,248	1.000	1,248
2	M	WODC		13	WODC	260	1.000	260
3	M	EPSW		13	EPSW	320	1.000	320
Total Building Area						1,248		1,248



Rogers

Assessment Property Record Card for Tax Year 2026

Data provided by LISA DELOZIER County Assessor

Date 04/17/2026
Time 04:21:30
Page 6

Agland Inventory

660012224

Soi	Description	Land Use	LPI	Adj Type	Adj Code	Acres	Use/Acre	Mkt/Acre	Use Value	Market Value
CMB	CLAREMORE SILT LOAM 0-3%	IMP PST	45		0	24.000	126	126	3,024	3,024
NAB	NEWTONIA SILT LOAM 1-3% S	IMP PST	80		0	6.000	224	224	1,344	1,344
IMP PST Totals						30.000			4,368	4,368
Total Agland						30.000			4,368	4,368