



Rogers

Assessment Property Record Card for Tax Year 2026

Data provided by LISA DELOZIER County Assessor

Date 04/18/2026
 Time 08:15:58
 Page 1

Assessment Data					Primary Image																																																																																																																				
Account 660012430 Parcel ID 000000-00-0-00696-008-0006 Cadastral ID 12-21-14-02630 Property Type REAL - Real Property Property Class RRP VI Area 4 Tax Area 7 - OWASSO/LIMESTONE FIRE Name ID 344394 GREENHAW, MARK STEPHEN & SAREVA LOUISE REVOCABLE TRUST 18750 E 108TH ST N OWASSO OK 74055-0000 Parcel Location Situs 18750 E 108TH ST N Subdivision ROLLING MEADOWS Lot/Block 0006 / 0008 Parcel Size .5 - Lots Sec/Twn/Rng 12 / 21 / 14 / 5 Neighborhood 1106 - R-V01,4-SW CLAREMORE School District S021 - OWASSO SCHOOLS					 <p>\\tsclient\T\TOMMY DUNLAP\New folder (102)\IMG_0071.JPG 8/25/2022</p>																																																																																																																				
Legal Description Lat/Long: 36.31012655 -95.76481980 W 165' N 50' LOT 6 & W 202' S 265' N 315' OF N2 LOT 6 & W 136' S2 LOT 6 BLOCK 8 ROLLING MEADOWS.																																																																																																																									
Exemptions <table border="1"> <thead> <tr> <th>Code</th> <th>Type</th> <th>Active</th> <th>Maximum</th> <th>Exemption</th> </tr> </thead> <tbody> <tr> <td>H</td> <td>Homestead</td> <td>Yes</td> <td>1,000</td> <td>1,000</td> </tr> </tbody> </table>					Code	Type	Active	Maximum	Exemption	H	Homestead	Yes	1,000	1,000	Building Permits <table border="1"> <thead> <tr> <th>Number</th> <th>Description</th> <th>Opened</th> <th>Closed</th> <th>Amount</th> </tr> </thead> <tbody> <tr> <td colspan="5"> </td> </tr> </tbody> </table>					Number	Description	Opened	Closed	Amount																																																																																																	
Code	Type	Active	Maximum	Exemption																																																																																																																					
H	Homestead	Yes	1,000	1,000																																																																																																																					
Number	Description	Opened	Closed	Amount																																																																																																																					
Parcel Valuation <table border="1"> <thead> <tr> <th>Source</th> <th>REAL</th> <th>Fair Cash</th> <th>Capped</th> <th>Asmnt Level</th> <th>Assessed</th> <th>Levy Rate</th> <th>108.538</th> <th>Current Tax</th> </tr> </thead> <tbody> <tr> <td>Remove Cap</td> <td></td> <td>Land Value 98,379</td> <td>23,403</td> <td>11%</td> <td>2,574</td> <td>Assessed</td> <td>14,348</td> <td>1,557.30</td> </tr> <tr> <td>Year Frozen</td> <td>2005</td> <td>Improvements 197,983</td> <td>107,043</td> <td></td> <td>11,774</td> <td>Penalty</td> <td>0</td> <td></td> </tr> <tr> <td>Uncapped Value</td> <td>0</td> <td>Mobile Home 0</td> <td>0</td> <td></td> <td>0</td> <td>Exemption</td> <td>1,000</td> <td>-97.00</td> </tr> <tr> <td>TIF Project ID</td> <td>0</td> <td>Total Value 296,362</td> <td>130,446</td> <td></td> <td>14,348</td> <td>Total Taxable</td> <td>13,348</td> <td>1,460.00</td> </tr> </tbody> </table>					Source	REAL	Fair Cash	Capped	Asmnt Level	Assessed	Levy Rate	108.538	Current Tax	Remove Cap		Land Value 98,379	23,403	11%	2,574	Assessed	14,348	1,557.30	Year Frozen	2005	Improvements 197,983	107,043		11,774	Penalty	0		Uncapped Value	0	Mobile Home 0	0		0	Exemption	1,000	-97.00	TIF Project ID	0	Total Value 296,362	130,446		14,348	Total Taxable	13,348	1,460.00	Sale History <table border="1"> <thead> <tr> <th>Bk/Pg</th> <th>Grantor</th> <th>Date</th> <th>Price</th> <th>Code</th> </tr> </thead> <tbody> <tr> <td>/</td> <td>GREENHAW, MARK S & SAREVA</td> <td>05/21/2024</td> <td>0</td> <td>WB</td> </tr> <tr> <td>2663/475</td> <td>GREENHAW, LINDA-TRUSTEE</td> <td>09/27/2017</td> <td>113,000</td> <td>4</td> </tr> <tr> <td>2647/460</td> <td>GREENHAW, B J &</td> <td>03/06/2017</td> <td>0</td> <td>4</td> </tr> <tr> <td>2465/603</td> <td>GREENHAW, B J &</td> <td>04/03/2015</td> <td>0</td> <td>4</td> </tr> </tbody> </table>					Bk/Pg	Grantor	Date	Price	Code	/	GREENHAW, MARK S & SAREVA	05/21/2024	0	WB	2663/475	GREENHAW, LINDA-TRUSTEE	09/27/2017	113,000	4	2647/460	GREENHAW, B J &	03/06/2017	0	4	2465/603	GREENHAW, B J &	04/03/2015	0	4																																										
Source	REAL	Fair Cash	Capped	Asmnt Level	Assessed	Levy Rate	108.538	Current Tax																																																																																																																	
Remove Cap		Land Value 98,379	23,403	11%	2,574	Assessed	14,348	1,557.30																																																																																																																	
Year Frozen	2005	Improvements 197,983	107,043		11,774	Penalty	0																																																																																																																		
Uncapped Value	0	Mobile Home 0	0		0	Exemption	1,000	-97.00																																																																																																																	
TIF Project ID	0	Total Value 296,362	130,446		14,348	Total Taxable	13,348	1,460.00																																																																																																																	
Bk/Pg	Grantor	Date	Price	Code																																																																																																																					
/	GREENHAW, MARK S & SAREVA	05/21/2024	0	WB																																																																																																																					
2663/475	GREENHAW, LINDA-TRUSTEE	09/27/2017	113,000	4																																																																																																																					
2647/460	GREENHAW, B J &	03/06/2017	0	4																																																																																																																					
2465/603	GREENHAW, B J &	04/03/2015	0	4																																																																																																																					
Assessment History <table border="1"> <thead> <tr> <th>Tax Year</th> <th>Statement Number</th> <th>Billed Owner</th> <th>Tax Area</th> <th>Total Value</th> <th>Exemptions</th> <th>Taxable Value</th> <th>Billed Tax</th> </tr> </thead> <tbody> <tr><td>2025</td><td>2025-660012430</td><td>GREENHAW, MARK STEPHEN &</td><td>7</td><td>279,052</td><td>1000</td><td>12,931</td><td>1,414.00</td></tr> <tr><td>2024</td><td>2024-660012430</td><td>GREENHAW, MARK STEPHEN &</td><td>7</td><td>288,867</td><td>1000</td><td>12,525</td><td>1,396.00</td></tr> <tr><td>2023</td><td>2023-660012430</td><td>GREENHAW, MARK S &</td><td>7</td><td>197,231</td><td>1000</td><td>12,131</td><td>1,325.00</td></tr> <tr><td>2022</td><td>2022-660012430</td><td>GREENHAW, MARK S &</td><td>7</td><td>188,128</td><td>1000</td><td>11,750</td><td>1,333.00</td></tr> <tr><td>2021</td><td>2021-660012430</td><td>GREENHAW, MARK S &</td><td>7</td><td>185,890</td><td>1000</td><td>11,378</td><td>1,278.00</td></tr> <tr><td>2020</td><td>2020-660012430</td><td>GREENHAW, MARK S &</td><td>7</td><td>187,490</td><td>1000</td><td>11,018</td><td>1,236.00</td></tr> <tr><td>2019</td><td>2019-660012430</td><td>GREENHAW, MARK S &</td><td>7</td><td>179,742</td><td>0</td><td>11,667</td><td>1,295.00</td></tr> <tr><td>2018</td><td>2018-660012430</td><td>GREENHAW, MARK S &</td><td>7</td><td>185,588</td><td>0</td><td>11,111</td><td>1,193.00</td></tr> <tr><td>2017</td><td>2017-660012430</td><td>GREENHAW, MARK S &</td><td>7</td><td>183,864</td><td>1000</td><td>9,583</td><td>1,052.00</td></tr> <tr><td>2016</td><td>2016-660012430</td><td>GREENHAW, B J &</td><td>7</td><td>179,772</td><td>1000</td><td>9,583</td><td>1,053.00</td></tr> <tr><td>2015</td><td>2015-660012430</td><td>GREENHAW, B J &</td><td>7</td><td>180,244</td><td>1000</td><td>9,582</td><td>1,060.00</td></tr> <tr><td>2014</td><td>2014-660012430</td><td>GREENHAW, B J &</td><td>7</td><td>182,493</td><td>1000</td><td>9,583</td><td>1,068.00</td></tr> <tr><td>2013</td><td>2013-660012430</td><td>GREENHAW, B J &</td><td>7</td><td>170,075</td><td>1000</td><td>9,583</td><td>1,049.00</td></tr> </tbody> </table>										Tax Year	Statement Number	Billed Owner	Tax Area	Total Value	Exemptions	Taxable Value	Billed Tax	2025	2025-660012430	GREENHAW, MARK STEPHEN &	7	279,052	1000	12,931	1,414.00	2024	2024-660012430	GREENHAW, MARK STEPHEN &	7	288,867	1000	12,525	1,396.00	2023	2023-660012430	GREENHAW, MARK S &	7	197,231	1000	12,131	1,325.00	2022	2022-660012430	GREENHAW, MARK S &	7	188,128	1000	11,750	1,333.00	2021	2021-660012430	GREENHAW, MARK S &	7	185,890	1000	11,378	1,278.00	2020	2020-660012430	GREENHAW, MARK S &	7	187,490	1000	11,018	1,236.00	2019	2019-660012430	GREENHAW, MARK S &	7	179,742	0	11,667	1,295.00	2018	2018-660012430	GREENHAW, MARK S &	7	185,588	0	11,111	1,193.00	2017	2017-660012430	GREENHAW, MARK S &	7	183,864	1000	9,583	1,052.00	2016	2016-660012430	GREENHAW, B J &	7	179,772	1000	9,583	1,053.00	2015	2015-660012430	GREENHAW, B J &	7	180,244	1000	9,582	1,060.00	2014	2014-660012430	GREENHAW, B J &	7	182,493	1000	9,583	1,068.00	2013	2013-660012430	GREENHAW, B J &	7	170,075	1000	9,583	1,049.00
Tax Year	Statement Number	Billed Owner	Tax Area	Total Value	Exemptions	Taxable Value	Billed Tax																																																																																																																		
2025	2025-660012430	GREENHAW, MARK STEPHEN &	7	279,052	1000	12,931	1,414.00																																																																																																																		
2024	2024-660012430	GREENHAW, MARK STEPHEN &	7	288,867	1000	12,525	1,396.00																																																																																																																		
2023	2023-660012430	GREENHAW, MARK S &	7	197,231	1000	12,131	1,325.00																																																																																																																		
2022	2022-660012430	GREENHAW, MARK S &	7	188,128	1000	11,750	1,333.00																																																																																																																		
2021	2021-660012430	GREENHAW, MARK S &	7	185,890	1000	11,378	1,278.00																																																																																																																		
2020	2020-660012430	GREENHAW, MARK S &	7	187,490	1000	11,018	1,236.00																																																																																																																		
2019	2019-660012430	GREENHAW, MARK S &	7	179,742	0	11,667	1,295.00																																																																																																																		
2018	2018-660012430	GREENHAW, MARK S &	7	185,588	0	11,111	1,193.00																																																																																																																		
2017	2017-660012430	GREENHAW, MARK S &	7	183,864	1000	9,583	1,052.00																																																																																																																		
2016	2016-660012430	GREENHAW, B J &	7	179,772	1000	9,583	1,053.00																																																																																																																		
2015	2015-660012430	GREENHAW, B J &	7	180,244	1000	9,582	1,060.00																																																																																																																		
2014	2014-660012430	GREENHAW, B J &	7	182,493	1000	9,583	1,068.00																																																																																																																		
2013	2013-660012430	GREENHAW, B J &	7	170,075	1000	9,583	1,049.00																																																																																																																		



Rogers

Assessment Property Record Card for Tax Year 2026

Data provided by LISA DELOZIER County Assessor

Date 04/18/2026
 Time 08:15:58
 Page 2

Lot Data		Square-Foot - NBHD 1106 #1	
Lot Size			
Lot Count			
Units Buildable	0.5		
Non-Ag Acres	2.3957		
Topography			
Street Access			
Utilities			
Amenities		0	
		0	
Method	Square-Foot		
Base Lot Value	104,355.00 x .94 = 98,379		
Factor Value			
Adjustments	1.0000		
Lot Value	98,379		



\\tsclient\T\TOMMY DUNLAP\New folder (102)\IMG_0071.JPG 8/25/2022

Residential Data	
Type	1 Single Family Residence
Condition	3 - Average
Quality	2.5 - Fair
Architecture	
Style	100% One Story
Exterior Wall	100% Veneer, Masonry
Base/Total Area	2,394 / 2,394
Style	100% One Story
HVAC	100% Warmed & Cooled Air
Roof Cover	4 Metal, Preformed
Area on Slab	0
Fixture/RghIn	8 /
Bed/F/H Bath	3 / 2.0 /
Basement Area	
Garage Type	792 Attached Garage - Unfinished
Remodel	
Year/Eff Age	1966 / 45

GRM Approach

GRM Code	
Gross Rent	0.00
Indicated Value	

Multiple Regression

MRA Code	1 Test
Adusted R	0.8445
Indicated Value	277,761 116.02 Per SqFt

Direct Comparables

Selection Model	A Adam Test
Adjustment Model	1 2022 Residential
Comparables	5
Indicated Value	372,050 Per SqFt

Value Reconciliation

Selected Approach	Cost Approach
Improvements	152,184
Lot Value	98,379
Indicated Value	250,563 104.66 Per SqFt
Agland Value	
Site Improvements	45,799
Total Value	296,362 123.79 Total Value Per SqFt

Cost Approach Manual : 01/2025

Base Cost	97.28	Total Misc Impr	+	11,696
Roofing Adj	+ 4.86	Garage Cost	+	20,323
Subfloor Adj	+ 1.09	Total RCN	=	317,049
Heat/Cool Adj	+ 11.47	Depreciation (52%)	-	164,865
Plumbing Adj	+ 4.36	Lump Sums	+	0
Basement Adj	+ 0.00	RCNLD	=	152,184
Adj Base Cost	= 119.06	Lot Value	+	98,379
Total Area	x 2,394	Indicated Value	=	250,563
Adjusted Cost	= 285,030	Value Per SqFt		104.66

Miscellaneous Improvements

Code	Description	Sketch ID	Size	Year	Units	Unit Cost	Depr	Value
FPR1	FIREPLACE - RESIDENTIAL 1 STORY	0		1	1	5,095.98		5,096
PRCH	SLAB PORCH - COVERED	29665	15x12		180	23.64		4,255
PATO	SLAB PORCH - OPEN	29666	20x13		260	9.02		2,345



Rogers

Assessment Property Record Card for Tax Year 2026

Data provided by LISA DELOZIER County Assessor

Date 04/18/2026

Time 08:15:58

Page 3

Sketch Image

660012430

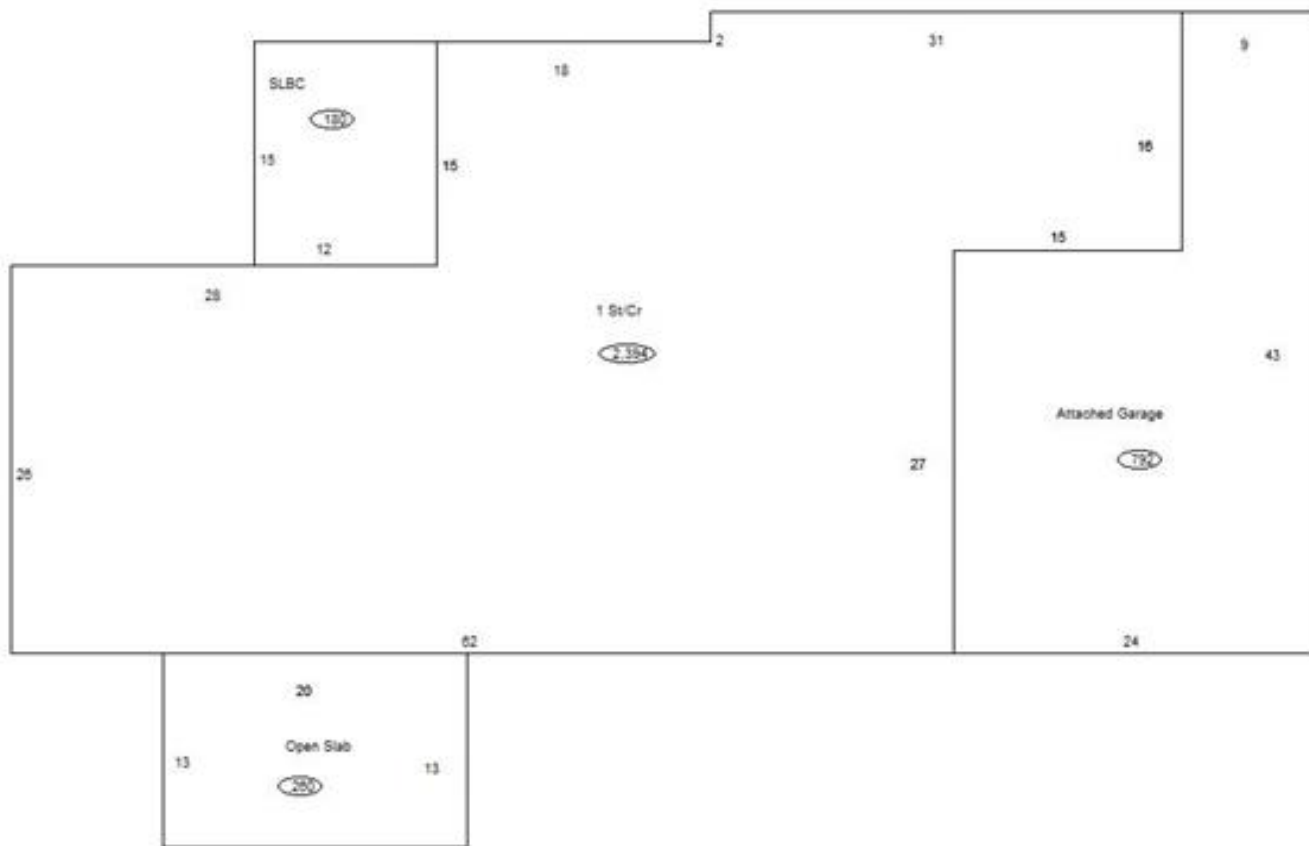

Sketch Vector Information

Sequence	Code	Type	Built Over	Scale	Section Label	Base Area	Multiplier	Total Area
1	R	1	Crawl	10	1 St/Cr	2,394	1.000	2,394
2	G	1		10	Attached Garage	792	1.000	792
3	M	PRCH		10	SLBC	180	1.000	180
4	M	PATO		10	Open Slab	260	1.000	260
Total Building Area						2,394		2,394



Rogers







Assessment Property Record Card for Tax Year 2026

Data provided by LISA DELOZIER County Assessor

Date 04/18/2026
Time 08:15:58
Page 4

660012430

Outbuildings/Site Improvements

Building Image	Code	Description	Dimensions	Floor	Roofing	Total Units
	UTIL	SHOP BUILDING	0x0x0			1,500
	Qual	2	Cond 3	Year	Eff Age	
	Valuation Summary		Modifier Total	RCN	Depr (25% Phys/ % Func)	RCNLD
	Base Cost (28.71 x 1,500)		43,065		43,065	10,766
	BARN	BARN	0x0x0			408
	Qual	3	Cond 3	Year	Eff Age	
	Valuation Summary		Modifier Total	RCN	Depr (100% Phys/ % Func)	RCNLD
	Base Cost (10.48 x 408)		4,276		4,276	4,276
	SG	SWIM-GUNITE	0x0x0			1
	Qual	3	Cond 3	Year	Eff Age	
	Valuation Summary		Modifier Total	RCN	Depr (55% Phys/ % Func)	RCNLD
	Base Cost (30,000.00 x 1)		30,000		30,000	16,500
	CP	CARPORT DIRT	21x18x0			378
	Qual	1	Cond 1	Year	Eff Age	
	Valuation Summary		Modifier Total	RCN	Depr (100% Phys/ % Func)	RCNLD
	Base Cost (3.50 x 378)		1,323		1,323	1,323
	CP	CARPORT DIRT	21x18x0			378
	Qual	1	Cond 3	Year	Eff Age	
	Valuation Summary		Modifier Total	RCN	Depr (100% Phys/ % Func)	RCNLD
	Base Cost (3.50 x 378)		1,323		1,323	1,323
	STF	STG FAIR	12x16x0			192
	Qual	2	Cond 2	Year	Eff Age 2026	
	Valuation Summary		Modifier Total	RCN	Depr (100% Phys/ % Func)	RCNLD
	Base Cost (4.68 x 192)		899		899	899