



Rogers

Assessment Property Record Card for Tax Year 2026

Data provided by LISA DELOZIER County Assessor

Date 04/16/2026
 Time 22:34:41
 Page 1

Assessment Data					Primary Image																																																																																																																				
Account 660012475 Parcel ID 000000-00-0-10140-001-0011 Cadastral ID 12-21-15-01290 Property Type REAL - Real Property Property Class URP VI Area 4 Tax Area 17 - CLAREMORE OT Name ID 334046 MOODY, KAYLEE & JORDAN N GOOCH 3326 EAGLE COURT CLAREMORE OK 74019-0000 Parcel Location Situs 03326 EAGLE CT Subdivision HERITAGE HILLS SUB Lot/Block 0011 / 0001 Parcel Size 1 - Lots Sec/Twn/Rng 12 / 21 / 15 / 5 Neighborhood 1167 - R-V01-SW CLAREMORE School District S001 - CLAREMORE SCHOOLS																																																																																																																									
Legal Description Lot/Long: 36.32040419 -95.65465257																																																																																																																									
Building Permits					<table border="1"> <thead> <tr> <th>Number</th> <th>Description</th> <th>Opened</th> <th>Closed</th> <th>Amount</th> </tr> </thead> <tbody> <tr> <td colspan="5" style="height: 100px;"> </td> </tr> </tbody> </table>					Number	Description	Opened	Closed	Amount																																																																																																											
Number	Description	Opened	Closed	Amount																																																																																																																					
Exemptions					Sale History																																																																																																																				
<table border="1"> <thead> <tr> <th>Code</th> <th>Type</th> <th>Active</th> <th>Maximum</th> <th>Exemption</th> </tr> </thead> <tbody> <tr> <td>H</td> <td>Homestead</td> <td>Yes</td> <td>1,000</td> <td>1,000</td> </tr> </tbody> </table>					Code	Type	Active	Maximum	Exemption	H	Homestead	Yes	1,000	1,000	<table border="1"> <thead> <tr> <th>Bk/Pg</th> <th>Grantor</th> <th>Date</th> <th>Price</th> <th>Code</th> </tr> </thead> <tbody> <tr> <td>/</td> <td>HUDSON, DELANA L</td> <td>04/08/2021</td> <td>195,500</td> <td>YES</td> </tr> <tr> <td>2107/120</td> <td>HUDSON, CECIL WAYNE &</td> <td>05/28/2010</td> <td>140,000</td> <td>4</td> </tr> <tr> <td>1629/757</td> <td>BENEFICIAL OKLAHOMA INC</td> <td>10/14/2004</td> <td>132,000</td> <td>YES</td> </tr> <tr> <td>1543/74</td> <td>ROSS, DONALD G &</td> <td>10/17/2003</td> <td>0</td> <td>8</td> </tr> <tr> <td>1161/599</td> <td>BEAUREGARD, NORMAND P &</td> <td>03/12/1999</td> <td>136,500</td> <td>Yes</td> </tr> <tr> <td>966/32</td> <td>PIRTLE, HOWARD D &</td> <td>08/15/1994</td> <td>117,000</td> <td>Yes</td> </tr> </tbody> </table>					Bk/Pg	Grantor	Date	Price	Code	/	HUDSON, DELANA L	04/08/2021	195,500	YES	2107/120	HUDSON, CECIL WAYNE &	05/28/2010	140,000	4	1629/757	BENEFICIAL OKLAHOMA INC	10/14/2004	132,000	YES	1543/74	ROSS, DONALD G &	10/17/2003	0	8	1161/599	BEAUREGARD, NORMAND P &	03/12/1999	136,500	Yes	966/32	PIRTLE, HOWARD D &	08/15/1994	117,000	Yes																																																																			
Code	Type	Active	Maximum	Exemption																																																																																																																					
H	Homestead	Yes	1,000	1,000																																																																																																																					
Bk/Pg	Grantor	Date	Price	Code																																																																																																																					
/	HUDSON, DELANA L	04/08/2021	195,500	YES																																																																																																																					
2107/120	HUDSON, CECIL WAYNE &	05/28/2010	140,000	4																																																																																																																					
1629/757	BENEFICIAL OKLAHOMA INC	10/14/2004	132,000	YES																																																																																																																					
1543/74	ROSS, DONALD G &	10/17/2003	0	8																																																																																																																					
1161/599	BEAUREGARD, NORMAND P &	03/12/1999	136,500	Yes																																																																																																																					
966/32	PIRTLE, HOWARD D &	08/15/1994	117,000	Yes																																																																																																																					
Parcel Valuation																																																																																																																									
<table border="1"> <thead> <tr> <th>Source</th> <th>REAL</th> </tr> </thead> <tbody> <tr> <td>Remove Cap</td> <td>2022</td> </tr> <tr> <td>Year Frozen</td> <td>0</td> </tr> <tr> <td>Uncapped Value</td> <td>0</td> </tr> <tr> <td>TIF Project ID</td> <td>0</td> </tr> </tbody> </table>		Source	REAL	Remove Cap	2022	Year Frozen	0	Uncapped Value	0	TIF Project ID	0	<table border="1"> <thead> <tr> <th>Fair Cash</th> <th>Capped</th> <th>Asmnt Level</th> <th>Assessed</th> </tr> </thead> <tbody> <tr> <td>62,096</td> <td>62,096</td> <td>11%</td> <td>6,831</td> </tr> <tr> <td>141,229</td> <td>141,229</td> <td></td> <td>15,535</td> </tr> <tr> <td>0</td> <td>0</td> <td></td> <td>0</td> </tr> <tr> <td>203,325</td> <td>203,325</td> <td></td> <td>22,366</td> </tr> </tbody> </table>			Fair Cash	Capped	Asmnt Level	Assessed	62,096	62,096	11%	6,831	141,229	141,229		15,535	0	0		0	203,325	203,325		22,366	<table border="1"> <thead> <tr> <th>Levy Rate</th> <th>Current Tax</th> </tr> </thead> <tbody> <tr> <td>92.430</td> <td>2,067.29</td> </tr> <tr> <td>Assessed</td> <td>22,366</td> </tr> <tr> <td>Penalty</td> <td>0</td> </tr> <tr> <td>Exemption</td> <td>1,000</td> </tr> <tr> <td>Total Taxable</td> <td>21,366</td> </tr> </tbody> </table>		Levy Rate	Current Tax	92.430	2,067.29	Assessed	22,366	Penalty	0	Exemption	1,000	Total Taxable	21,366																																																																									
Source	REAL																																																																																																																								
Remove Cap	2022																																																																																																																								
Year Frozen	0																																																																																																																								
Uncapped Value	0																																																																																																																								
TIF Project ID	0																																																																																																																								
Fair Cash	Capped	Asmnt Level	Assessed																																																																																																																						
62,096	62,096	11%	6,831																																																																																																																						
141,229	141,229		15,535																																																																																																																						
0	0		0																																																																																																																						
203,325	203,325		22,366																																																																																																																						
Levy Rate	Current Tax																																																																																																																								
92.430	2,067.29																																																																																																																								
Assessed	22,366																																																																																																																								
Penalty	0																																																																																																																								
Exemption	1,000																																																																																																																								
Total Taxable	21,366																																																																																																																								
Assessment History																																																																																																																									
<table border="1"> <thead> <tr> <th>Tax Year</th> <th>Statement Number</th> <th>Billed Owner</th> <th>Tax Area</th> <th>Total Value</th> <th>Exemptions</th> <th>Taxable Value</th> <th>Billed Tax</th> </tr> </thead> <tbody> <tr><td>2025</td><td>2025-660012475</td><td>MOODY, KAYLEE &</td><td>17</td><td>198,604</td><td>1000</td><td>20,847</td><td>1,927.00</td></tr> <tr><td>2024</td><td>2024-660012475</td><td>MOODY, KAYLEE &</td><td>17</td><td>203,937</td><td>1000</td><td>21,150</td><td>1,955.00</td></tr> <tr><td>2023</td><td>2023-660012475</td><td>MOODY, KAYLEE &</td><td>17</td><td>195,500</td><td>1000</td><td>20,505</td><td>1,878.00</td></tr> <tr><td>2022</td><td>2022-660012475</td><td>MOODY, KAYLEE &</td><td>17</td><td>195,500</td><td>0</td><td>21,505</td><td>1,991.00</td></tr> <tr><td>2021</td><td>2021-660012475</td><td>MOODY, KAYLEE &</td><td>17</td><td>151,775</td><td>1000</td><td>15,695</td><td>1,386.00</td></tr> <tr><td>2020</td><td>2020-660012475</td><td>HUDSON, DELANA L</td><td>17</td><td>149,466</td><td>1000</td><td>15,311</td><td>1,402.00</td></tr> <tr><td>2019</td><td>2019-660012475</td><td>HUDSON, DELANA L</td><td>17</td><td>143,967</td><td>1000</td><td>14,836</td><td>1,374.00</td></tr> <tr><td>2018</td><td>2018-660012475</td><td>HUDSON, DELANA L</td><td>17</td><td>149,352</td><td>1000</td><td>15,429</td><td>1,426.00</td></tr> <tr><td>2017</td><td>2017-660012475</td><td>HUDSON, DELANA L</td><td>17</td><td>148,188</td><td>1000</td><td>14,966</td><td>1,374.00</td></tr> <tr><td>2016</td><td>2016-660012475</td><td>HUDSON, DELANA L</td><td>17</td><td>144,656</td><td>1000</td><td>14,501</td><td>1,361.00</td></tr> <tr><td>2015</td><td>2015-660012475</td><td>HUDSON, DELANA L</td><td>17</td><td>141,802</td><td>1000</td><td>14,050</td><td>1,267.00</td></tr> <tr><td>2014</td><td>2014-660012475</td><td>HUDSON, DELANA L</td><td>17</td><td>142,906</td><td>1000</td><td>13,612</td><td>1,262.00</td></tr> <tr><td>2013</td><td>2013-660012475</td><td>HUDSON, DELANA L</td><td>17</td><td>128,965</td><td>1000</td><td>13,186</td><td>1,207.00</td></tr> </tbody> </table>										Tax Year	Statement Number	Billed Owner	Tax Area	Total Value	Exemptions	Taxable Value	Billed Tax	2025	2025-660012475	MOODY, KAYLEE &	17	198,604	1000	20,847	1,927.00	2024	2024-660012475	MOODY, KAYLEE &	17	203,937	1000	21,150	1,955.00	2023	2023-660012475	MOODY, KAYLEE &	17	195,500	1000	20,505	1,878.00	2022	2022-660012475	MOODY, KAYLEE &	17	195,500	0	21,505	1,991.00	2021	2021-660012475	MOODY, KAYLEE &	17	151,775	1000	15,695	1,386.00	2020	2020-660012475	HUDSON, DELANA L	17	149,466	1000	15,311	1,402.00	2019	2019-660012475	HUDSON, DELANA L	17	143,967	1000	14,836	1,374.00	2018	2018-660012475	HUDSON, DELANA L	17	149,352	1000	15,429	1,426.00	2017	2017-660012475	HUDSON, DELANA L	17	148,188	1000	14,966	1,374.00	2016	2016-660012475	HUDSON, DELANA L	17	144,656	1000	14,501	1,361.00	2015	2015-660012475	HUDSON, DELANA L	17	141,802	1000	14,050	1,267.00	2014	2014-660012475	HUDSON, DELANA L	17	142,906	1000	13,612	1,262.00	2013	2013-660012475	HUDSON, DELANA L	17	128,965	1000	13,186	1,207.00
Tax Year	Statement Number	Billed Owner	Tax Area	Total Value	Exemptions	Taxable Value	Billed Tax																																																																																																																		
2025	2025-660012475	MOODY, KAYLEE &	17	198,604	1000	20,847	1,927.00																																																																																																																		
2024	2024-660012475	MOODY, KAYLEE &	17	203,937	1000	21,150	1,955.00																																																																																																																		
2023	2023-660012475	MOODY, KAYLEE &	17	195,500	1000	20,505	1,878.00																																																																																																																		
2022	2022-660012475	MOODY, KAYLEE &	17	195,500	0	21,505	1,991.00																																																																																																																		
2021	2021-660012475	MOODY, KAYLEE &	17	151,775	1000	15,695	1,386.00																																																																																																																		
2020	2020-660012475	HUDSON, DELANA L	17	149,466	1000	15,311	1,402.00																																																																																																																		
2019	2019-660012475	HUDSON, DELANA L	17	143,967	1000	14,836	1,374.00																																																																																																																		
2018	2018-660012475	HUDSON, DELANA L	17	149,352	1000	15,429	1,426.00																																																																																																																		
2017	2017-660012475	HUDSON, DELANA L	17	148,188	1000	14,966	1,374.00																																																																																																																		
2016	2016-660012475	HUDSON, DELANA L	17	144,656	1000	14,501	1,361.00																																																																																																																		
2015	2015-660012475	HUDSON, DELANA L	17	141,802	1000	14,050	1,267.00																																																																																																																		
2014	2014-660012475	HUDSON, DELANA L	17	142,906	1000	13,612	1,262.00																																																																																																																		
2013	2013-660012475	HUDSON, DELANA L	17	128,965	1000	13,186	1,207.00																																																																																																																		



Rogers

Assessment Property Record Card for Tax Year 2026

Data provided by LISA DELOZIER County Assessor

Date 04/16/2026
Time 22:34:42
Page 2

Lot Data	Square-Foot - NBHD 1167 #1	Primary Image
Lot Size		
Lot Count	1	
Units Buildable	1	
Non-Ag Acres	0.3863	
Topography		
Street Access		
Utilities		
Amenities	LAND QUALITY	
	0	
	0	
Method	Square-Foot	
Base Lot Value	16,828.00 x 3.69 = 62,096	
Factor Value		
Adjustments	1.0000	
Lot Value	62,096	

Residential Data	
Type	1 Single Family Residence
Condition	3 - Average
Quality	2.5 - Fair
Architecture	
Style	100% One Story
Exterior Wall	100% Veneer, Masonry
Base/Total Area	1,609 / 1,609
Style	100% One Story
HVAC	100% Warmed & Cooled Air
Roof Cover	1 Composition Shingle
Area on Slab	1,609
Fixture/RghIn	11 /
Bed/F/H Bath	3 / 2.0 /
Basement Area	
Garage Type	528 Attached Garage - Unfinished
Remodel	
Year/Eff Age	1987 / 29



\\tsclient\C\Users\Randy Necessary\Pictures\101_0714\IMG_0019. 7/14/2022

GRM Approach	
GRM Code	
Gross Rent	0.00
Indicated Value	

Multiple Regression			
MRA Code	1	Test	
Adjusted R	0.8445		
Indicated Value	179,543	111.59	Per SqFt

Direct Comparables	
Selection Model	A Adam Test
Adjustment Model	1 2022 Residential
Comparables	6
Indicated Value	205,150 Per SqFt

Cost Approach				Manual : 01/2025	
Base Cost	105.38	Total Misc Impr	+	9,766	
Roofing Adj	+ 4.46	Garage Cost	+	14,325	
Subfloor Adj	+ -1.15	Total RCN	=	231,523	
Heat/Cool Adj	+ 11.47	Depreciation (39%)	-	90,294	
Plumbing Adj	+ 8.76	Lump Sums	+	0	
Basement Adj	+ 0.00	RCNLD	=	141,229	
Adj Base Cost	= 128.92	Lot Value	+	62,096	
Total Area	x 1,609	Indicated Value	=	203,325	
Adjusted Cost	= 207,432	Value Per SqFt		126.37	

Value Reconciliation			
Selected Approach	Cost Approach		
Improvements	141,229		
Lot Value	62,096		
Indicated Value	203,325	126.37	Per SqFt
Agland Value			
Site Improvements			
Total Value	203,325	126.37	Total Value Per SqFt

Miscellaneous Improvements								
Code	Description	Sketch ID	Size	Year	Units	Unit Cost	Depr	Value
FPR1	FIREPLACE - RESIDENTIAL 1 STORY	0		1	1	5,095.98		5,096
PRCH	SLAB PORCH - COVERED	29819		36	36	24.16		870
SUN	Sunroom	29820	19x10		190	20.00		3,800



Rogers

Assessment Property Record Card for Tax Year 2026

Data provided by LISA DELOZIER County Assessor

Date 04/16/2026
 Time 22:34:42
 Page 3

Sketch Image

660012475

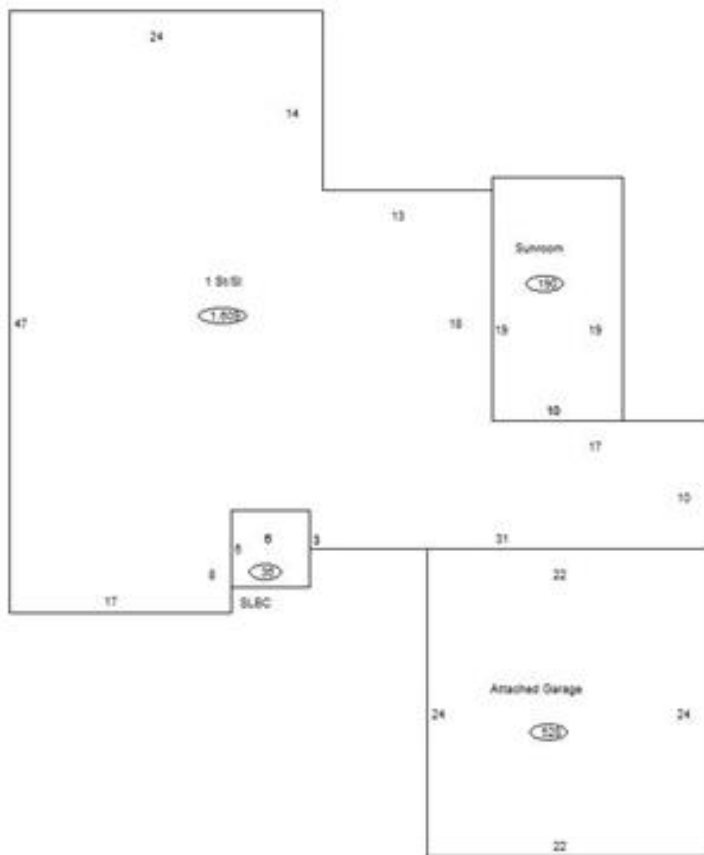

Sketch Vector Information

Sequence	Code	Type	Built Over	Scale	Section Label	Base Area	Multiplier	Total Area
1	R	1	Slab	10	1 St/SI	1,609	1.000	1,609
2	G	1		10	Attached Garage	528	1.000	528
3	M	PRCH		10	SLBC	36	1.000	36
4	M	SUN		10	Sunroom	190	1.000	190
Total Building Area						1,609		1,609



Rogers

Assessment Property Record Card for Tax Year 2026

Data provided by LISA DELOZIER County Assessor

Date 04/16/2026
Time 22:34:42
Page 4

660012475

Outbuildings/Site Improvements

Building Image	Code	Description	Dimensions	Floor	Roofing	Total Units
	STF	STG FAIR	0x0x0			
	Qual	2	Cond 2	Year	Eff Age	2026
Valuation Summary		Modifier Total		RCN	Depr (100% Phys/ % Func)	RCNLD
Base Cost (4.68 x)						