



Rogers

Assessment Property Record Card for Tax Year 2026

Data provided by LISA DELOZIER County Assessor

Date 04/16/2026
Time 22:34:43
Page 1

Assessment Data					Primary Image																																																																																																																				
Account 660012478 Parcel ID 000000-00-0-10140-001-0014 Cadastral ID 12-21-15-01320 Property Type REAL - Real Property Property Class URP VI Area 4 Tax Area 17 - CLAREMORE OT Name ID 336608 POLSON, WILLIAM M & LINDA L 3320 EAGLE CT CLAREMORE OK 74019-0000 Parcel Location Situs 03320 EAGLE CT Subdivision HERITAGE HILLS SUB Lot/Block 0014 / 0001 Parcel Size 1 - Lots Sec/Twn/Rng 12 / 21 / 15 / 5 Neighborhood 1167 - R-V01-SW CLAREMORE School District S001 - CLAREMORE SCHOOLS																																																																																																																									
Legal Description Lot/Long: 36.32059885 -95.65369073																																																																																																																									
Building Permits					<table border="1"> <thead> <tr> <th>Number</th> <th>Description</th> <th>Opened</th> <th>Closed</th> <th>Amount</th> </tr> </thead> <tbody> <tr> <td colspan="5" style="height: 100px;"> </td> </tr> </tbody> </table>					Number	Description	Opened	Closed	Amount																																																																																																											
Number	Description	Opened	Closed	Amount																																																																																																																					
Exemptions					Sale History																																																																																																																				
<table border="1"> <thead> <tr> <th>Code</th> <th>Type</th> <th>Active</th> <th>Maximum</th> <th>Exemption</th> </tr> </thead> <tbody> <tr> <td>H</td> <td>Homestead</td> <td>Yes</td> <td>1,000</td> <td>1,000</td> </tr> <tr> <td>H</td> <td>Homestead</td> <td>No</td> <td>1,000</td> <td></td> </tr> </tbody> </table>					Code	Type	Active	Maximum	Exemption	H	Homestead	Yes	1,000	1,000	H	Homestead	No	1,000		<table border="1"> <thead> <tr> <th>Bk/Pg</th> <th>Grantor</th> <th>Date</th> <th>Price</th> <th>Code</th> </tr> </thead> <tbody> <tr> <td>/</td> <td>WEST, BEATRICE M</td> <td>11/23/2021</td> <td>296,500</td> <td>YES</td> </tr> <tr> <td>2512/401</td> <td>WEST, GENE W &</td> <td>11/17/2015</td> <td>0</td> <td>4</td> </tr> <tr> <td>920/750</td> <td>HERITAGE HILLS DEV CORP</td> <td>06/23/1993</td> <td>17,500</td> <td>Yes</td> </tr> </tbody> </table>					Bk/Pg	Grantor	Date	Price	Code	/	WEST, BEATRICE M	11/23/2021	296,500	YES	2512/401	WEST, GENE W &	11/17/2015	0	4	920/750	HERITAGE HILLS DEV CORP	06/23/1993	17,500	Yes																																																																													
Code	Type	Active	Maximum	Exemption																																																																																																																					
H	Homestead	Yes	1,000	1,000																																																																																																																					
H	Homestead	No	1,000																																																																																																																						
Bk/Pg	Grantor	Date	Price	Code																																																																																																																					
/	WEST, BEATRICE M	11/23/2021	296,500	YES																																																																																																																					
2512/401	WEST, GENE W &	11/17/2015	0	4																																																																																																																					
920/750	HERITAGE HILLS DEV CORP	06/23/1993	17,500	Yes																																																																																																																					
Parcel Valuation																																																																																																																									
<table border="1"> <thead> <tr> <th>Source</th> <th>REAL</th> <th>Fair Cash</th> <th>Capped</th> <th>Asmnt Level</th> <th>Assessed</th> <th>Levy Rate</th> <th>92.430</th> <th>Current Tax</th> </tr> </thead> <tbody> <tr> <td>Remove Cap</td> <td>2022</td> <td>Land Value</td> <td>66,012</td> <td>63,479</td> <td>11%</td> <td>6,983</td> <td>Assessed</td> <td>35,639 3,294.11</td> </tr> <tr> <td>Year Frozen</td> <td>2005</td> <td>Improvements</td> <td>261,790</td> <td>260,513</td> <td></td> <td>28,656</td> <td>Penalty</td> <td>0</td> </tr> <tr> <td>Uncapped Value</td> <td>0</td> <td>Mobile Home</td> <td>0</td> <td>0</td> <td></td> <td>0</td> <td>Exemption</td> <td>1,000 -92.00</td> </tr> <tr> <td>TIF Project ID</td> <td>0</td> <td>Total Value</td> <td>327,802</td> <td>323,992</td> <td></td> <td>35,639</td> <td>Total Taxable</td> <td>34,639 3,202.00</td> </tr> </tbody> </table>		Source	REAL	Fair Cash	Capped	Asmnt Level	Assessed	Levy Rate	92.430	Current Tax	Remove Cap	2022	Land Value	66,012	63,479	11%	6,983	Assessed	35,639 3,294.11	Year Frozen	2005	Improvements	261,790	260,513		28,656	Penalty	0	Uncapped Value	0	Mobile Home	0	0		0	Exemption	1,000 -92.00	TIF Project ID	0	Total Value	327,802	323,992		35,639	Total Taxable	34,639 3,202.00																																																																											
Source	REAL	Fair Cash	Capped	Asmnt Level	Assessed	Levy Rate	92.430	Current Tax																																																																																																																	
Remove Cap	2022	Land Value	66,012	63,479	11%	6,983	Assessed	35,639 3,294.11																																																																																																																	
Year Frozen	2005	Improvements	261,790	260,513		28,656	Penalty	0																																																																																																																	
Uncapped Value	0	Mobile Home	0	0		0	Exemption	1,000 -92.00																																																																																																																	
TIF Project ID	0	Total Value	327,802	323,992		35,639	Total Taxable	34,639 3,202.00																																																																																																																	
Assessment History																																																																																																																									
<table border="1"> <thead> <tr> <th>Tax Year</th> <th>Statement Number</th> <th>Billed Owner</th> <th>Tax Area</th> <th>Total Value</th> <th>Exemptions</th> <th>Taxable Value</th> <th>Billed Tax</th> </tr> </thead> <tbody> <tr><td>2025</td><td>2025-660012478</td><td>POLSON, WILLIAM M &</td><td>17</td><td>318,938</td><td>1000</td><td>33,601</td><td>3,106.00</td></tr> <tr><td>2024</td><td>2024-660012478</td><td>POLSON, WILLIAM M &</td><td>17</td><td>333,999</td><td>1000</td><td>32,594</td><td>3,012.00</td></tr> <tr><td>2023</td><td>2023-660012478</td><td>POLSON, WILLIAM M &</td><td>17</td><td>296,500</td><td>1000</td><td>31,615</td><td>2,896.00</td></tr> <tr><td>2022</td><td>2022-660012478</td><td>POLSON, WILLIAM M &</td><td>17</td><td>296,500</td><td>1000</td><td>31,615</td><td>2,927.00</td></tr> <tr><td>2021</td><td>2021-660012478</td><td>WEST, BEATRICE M</td><td>17</td><td>226,842</td><td>1000</td><td>12,854</td><td>1,135.00</td></tr> <tr><td>2020</td><td>2020-660012478</td><td>WEST, BEATRICE M</td><td>17</td><td>225,124</td><td>1000</td><td>12,854</td><td>1,177.00</td></tr> <tr><td>2019</td><td>2019-660012478</td><td>WEST, BEATRICE M</td><td>17</td><td>213,644</td><td>1000</td><td>12,854</td><td>1,191.00</td></tr> <tr><td>2018</td><td>2018-660012478</td><td>WEST, BEATRICE M</td><td>17</td><td>219,402</td><td>1000</td><td>12,855</td><td>1,188.00</td></tr> <tr><td>2017</td><td>2017-660012478</td><td>WEST, BEATRICE M</td><td>17</td><td>217,601</td><td>1000</td><td>12,854</td><td>1,181.00</td></tr> <tr><td>2016</td><td>2016-660012478</td><td>WEST, BEATRICE M</td><td>17</td><td>209,720</td><td>1000</td><td>12,855</td><td>1,207.00</td></tr> <tr><td>2015</td><td>2015-660012478</td><td>WEST, GENE W &</td><td>17</td><td>205,144</td><td>1000</td><td>12,854</td><td>1,159.00</td></tr> <tr><td>2014</td><td>2014-660012478</td><td>WEST, GENE W &</td><td>17</td><td>208,690</td><td>1000</td><td>12,854</td><td>1,192.00</td></tr> <tr><td>2013</td><td>2013-660012478</td><td>WEST, GENE W &</td><td>17</td><td>178,020</td><td>1000</td><td>12,854</td><td>1,176.00</td></tr> </tbody> </table>										Tax Year	Statement Number	Billed Owner	Tax Area	Total Value	Exemptions	Taxable Value	Billed Tax	2025	2025-660012478	POLSON, WILLIAM M &	17	318,938	1000	33,601	3,106.00	2024	2024-660012478	POLSON, WILLIAM M &	17	333,999	1000	32,594	3,012.00	2023	2023-660012478	POLSON, WILLIAM M &	17	296,500	1000	31,615	2,896.00	2022	2022-660012478	POLSON, WILLIAM M &	17	296,500	1000	31,615	2,927.00	2021	2021-660012478	WEST, BEATRICE M	17	226,842	1000	12,854	1,135.00	2020	2020-660012478	WEST, BEATRICE M	17	225,124	1000	12,854	1,177.00	2019	2019-660012478	WEST, BEATRICE M	17	213,644	1000	12,854	1,191.00	2018	2018-660012478	WEST, BEATRICE M	17	219,402	1000	12,855	1,188.00	2017	2017-660012478	WEST, BEATRICE M	17	217,601	1000	12,854	1,181.00	2016	2016-660012478	WEST, BEATRICE M	17	209,720	1000	12,855	1,207.00	2015	2015-660012478	WEST, GENE W &	17	205,144	1000	12,854	1,159.00	2014	2014-660012478	WEST, GENE W &	17	208,690	1000	12,854	1,192.00	2013	2013-660012478	WEST, GENE W &	17	178,020	1000	12,854	1,176.00
Tax Year	Statement Number	Billed Owner	Tax Area	Total Value	Exemptions	Taxable Value	Billed Tax																																																																																																																		
2025	2025-660012478	POLSON, WILLIAM M &	17	318,938	1000	33,601	3,106.00																																																																																																																		
2024	2024-660012478	POLSON, WILLIAM M &	17	333,999	1000	32,594	3,012.00																																																																																																																		
2023	2023-660012478	POLSON, WILLIAM M &	17	296,500	1000	31,615	2,896.00																																																																																																																		
2022	2022-660012478	POLSON, WILLIAM M &	17	296,500	1000	31,615	2,927.00																																																																																																																		
2021	2021-660012478	WEST, BEATRICE M	17	226,842	1000	12,854	1,135.00																																																																																																																		
2020	2020-660012478	WEST, BEATRICE M	17	225,124	1000	12,854	1,177.00																																																																																																																		
2019	2019-660012478	WEST, BEATRICE M	17	213,644	1000	12,854	1,191.00																																																																																																																		
2018	2018-660012478	WEST, BEATRICE M	17	219,402	1000	12,855	1,188.00																																																																																																																		
2017	2017-660012478	WEST, BEATRICE M	17	217,601	1000	12,854	1,181.00																																																																																																																		
2016	2016-660012478	WEST, BEATRICE M	17	209,720	1000	12,855	1,207.00																																																																																																																		
2015	2015-660012478	WEST, GENE W &	17	205,144	1000	12,854	1,159.00																																																																																																																		
2014	2014-660012478	WEST, GENE W &	17	208,690	1000	12,854	1,192.00																																																																																																																		
2013	2013-660012478	WEST, GENE W &	17	178,020	1000	12,854	1,176.00																																																																																																																		



Rogers

Assessment Property Record Card for Tax Year 2026

Data provided by LISA DELOZIER County Assessor

Date 04/16/2026
Time 22:34:43
Page 2

Lot Data	Square-Foot - NBHD 1167 #1	Primary Image
Lot Size		
Lot Count	1	
Units Buildable	1	
Non-Ag Acres	0.4313	
Topography		
Street Access		
Utilities		
Amenities	LAND QUALITY	
	0	
	0	
Method	Square-Foot	
Base Lot Value	18,786.00 x 3.51 = 66,012	
Factor Value		
Adjustments	1.0000	
Lot Value	66,012	

Residential Data	
Type	1 Single Family Residence
Condition	3 - Average
Quality	3.5 - Average
Architecture	
Style	100% 1 1/2 Story Finished
Exterior Wall	90% Veneer, Masonry 10% Frame, Siding, Wood
Base/Total Area	2,237 / 2,397
Style	100% 1 1/2 Story Finished
HVAC	100% Warmed & Cooled Air
Roof Cover	1 Composition Shingle
Area on Slab	0
Fixture/RghIn	14 /
Bed/F/H Bath	3 / 2.5 /
Basement Area	
Garage Type	462 Attached Garage - Unfinished
Remodel	
Year/Eff Age	1994 / 24

Cost Approach		Manual : 01/2025	
Base Cost	101.75	Total Misc Impr	+ 9,062
Roofing Adj	+ 4.89	Garage Cost	+ 18,753
Subfloor Adj	+ 0.00	Total RCN	= 340,456
Heat/Cool Adj	+ 14.47	Depreciation (29%)	- 98,732
Plumbing Adj	+ 9.32	Lump Sums	+ 20,066
Basement Adj	+ 0.00	RCNLD	= 261,790
Adj Base Cost	= 130.43	Lot Value	+ 66,012
Total Area	x 2,397	Indicated Value	= 327,802
Adjusted Cost	= 312,641	Value Per SqFt	136.76



\\tsclient\C\Users\Randy Necessary\Pictures\101_0714\IMG_0022. 7/14/2022

GRM Approach	
GRM Code	
Gross Rent	0.00
Indicated Value	

Multiple Regression			
MRA Code	1	Test	
Adusted R	0.8445		
Indicated Value	288,378	120.31	Per SqFt

Direct Comparables	
Selection Model	A Adam Test
Adjustment Model	1 2022 Residential
Comparables	6
Indicated Value	272,990 Per SqFt

Value Reconciliation			
Selected Approach	Cost Approach		
Improvements	261,790		
Lot Value	66,012		
Indicated Value	327,802	136.76	Per SqFt
Agland Value			
Site Improvements			
Total Value	327,802	136.76	Total Value Per SqFt

Miscellaneous Improvements								
Code	Description	Sketch ID	Size	Year	Units	Unit Cost	Depr	Value
FPR1	FIREPLACE - RESIDENTIAL 1 STORY	0		1	1	6,429.63		6,430
@N24.5	BASEMENT MIN FIN	0		500	500	24.50	6%	11,515
PRCH	SLAB PORCH - COVERED	29833	15x6		90	29.24		2,632
WODO	WOOD DECK - OPEN	29834	476		476	19.11	6%	8,551



Rogers
Assessment Property Record Card for Tax Year 2026
 Data provided by LISA DELOZIER County Assessor

Date 04/16/2026
 Time 22:34:44
 Page 3

Sketch Image

660012478

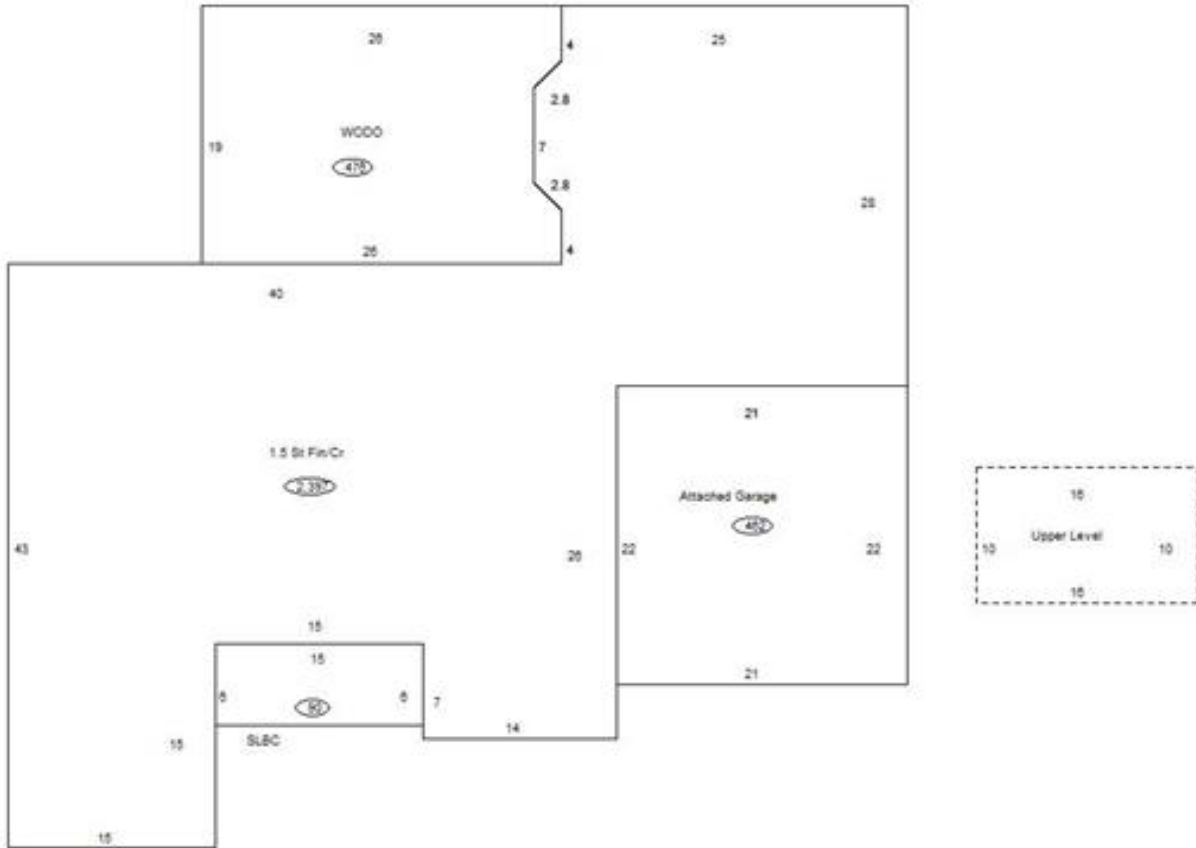

Sketch Vector Information

Sequence	Code	Type	Built Over	Scale	Section Label	Base Area	Multiplier	Total Area
1	R	5	Crawl	10	1.5 St Fin/Cr	2,237	1.072	2,397
2	G	1		10	Attached Garage	462	1.000	462
3	M	PRCH		10	SLBC	90	1.000	90
4	M	WODO		10	WODO	476	1.000	476
5	U	^UL	Overhang	10	Upper Level	160	1.000	160
Total Building Area						2,237		2,397