



# Rogers

## Assessment Property Record Card for Tax Year 2026

Data provided by LISA DELOZIER County Assessor

Date 04/16/2026  
 Time 22:34:59  
 Page 1

Assessment Data					Primary Image																																																																																																																				
<b>Account</b> 660012493 <b>Parcel ID</b> 000000-00-0-10140-001-0029 <b>Cadastral ID</b> 12-21-15-01470 <b>Property Type</b> REAL - Real Property <b>Property Class</b> URP VI Area 4 <b>Tax Area</b> 17 - CLAREMORE OT <b>Name ID</b> 321878 MOORE, CARL & GAYLE SHEEHAN & JUDY STANDRIDGE 3200 CLUB ST CLAREMORE OK 74019-0000																																																																																																																									
<b>Parcel Location</b> <b>Situs</b> 03200 CLUB ST <b>Subdivision</b> HERITAGE HILLS SUB <b>Lot/Block</b> 0029 / 0001 <b>Parcel Size</b> 1 - Lots <b>Sec/Twn/Rng</b> 12 / 21 / 15 / 5 <b>Neighborhood</b> 1167 - R-V01-SW CLAREMORE <b>School District</b> S001 - CLAREMORE SCHOOLS																																																																																																																									
<b>Legal Description</b> Lot/Long: 36.31776197 -95.65312134					<b>Building Permits</b> <table border="1"> <thead> <tr> <th>Number</th> <th>Description</th> <th>Opened</th> <th>Closed</th> <th>Amount</th> </tr> </thead> <tbody> <tr> <td colspan="5" style="height: 100px;"> </td> </tr> </tbody> </table>					Number	Description	Opened	Closed	Amount																																																																																																											
Number	Description	Opened	Closed	Amount																																																																																																																					
<b>Exemptions</b> <table border="1"> <thead> <tr> <th>Code</th> <th>Type</th> <th>Active</th> <th>Maximum</th> <th>Exemption</th> </tr> </thead> <tbody> <tr> <td>H</td> <td>Homestead</td> <td>Yes</td> <td>1,000</td> <td>1,000</td> </tr> </tbody> </table>					Code	Type	Active	Maximum	Exemption	H	Homestead	Yes	1,000	1,000	<b>Sale History</b> <table border="1"> <thead> <tr> <th>Bk/Pg</th> <th>Grantor</th> <th>Date</th> <th>Price</th> <th>Code</th> </tr> </thead> <tbody> <tr> <td>2645/662</td> <td>VICTORY, TIMOTHY C</td> <td>07/10/2017</td> <td>175,000</td> <td>YES</td> </tr> <tr> <td>2412/23</td> <td>DUNLAP, BRENNY D</td> <td>07/10/2014</td> <td>177,000</td> <td>YES</td> </tr> <tr> <td>1120/97</td> <td>HERITAGE HILLS DEV CORP</td> <td>07/02/1998</td> <td>25,000</td> <td>Yes</td> </tr> </tbody> </table>					Bk/Pg	Grantor	Date	Price	Code	2645/662	VICTORY, TIMOTHY C	07/10/2017	175,000	YES	2412/23	DUNLAP, BRENNY D	07/10/2014	177,000	YES	1120/97	HERITAGE HILLS DEV CORP	07/02/1998	25,000	Yes																																																																																		
Code	Type	Active	Maximum	Exemption																																																																																																																					
H	Homestead	Yes	1,000	1,000																																																																																																																					
Bk/Pg	Grantor	Date	Price	Code																																																																																																																					
2645/662	VICTORY, TIMOTHY C	07/10/2017	175,000	YES																																																																																																																					
2412/23	DUNLAP, BRENNY D	07/10/2014	177,000	YES																																																																																																																					
1120/97	HERITAGE HILLS DEV CORP	07/02/1998	25,000	Yes																																																																																																																					
<b>Parcel Valuation</b> <table border="1"> <thead> <tr> <th>Source</th> <th>REAL</th> <th>Fair Cash</th> <th>Capped</th> <th>Asmnt Level</th> <th>Assessed</th> <th>Levy Rate</th> <th>92.430</th> <th>Current Tax</th> </tr> </thead> <tbody> <tr> <td>Remove Cap</td> <td>2018</td> <td>Land Value 52,620</td> <td>34,599</td> <td>11%</td> <td>3,806</td> <td>Assessed</td> <td>19,887</td> <td>1,838.16</td> </tr> <tr> <td>Year Frozen</td> <td>2021</td> <td>Improvements 222,333</td> <td>146,188</td> <td></td> <td>16,081</td> <td>Penalty</td> <td>0</td> <td></td> </tr> <tr> <td>Uncapped Value</td> <td>0</td> <td>Mobile Home 0</td> <td>0</td> <td></td> <td>0</td> <td>Exemption</td> <td>1,000</td> <td>-92.00</td> </tr> <tr> <td>TIF Project ID</td> <td>0</td> <td>Total Value 274,953</td> <td>180,787</td> <td></td> <td>19,887</td> <td>Total Taxable</td> <td>18,887</td> <td>1,746.00</td> </tr> </tbody> </table>										Source	REAL	Fair Cash	Capped	Asmnt Level	Assessed	Levy Rate	92.430	Current Tax	Remove Cap	2018	Land Value 52,620	34,599	11%	3,806	Assessed	19,887	1,838.16	Year Frozen	2021	Improvements 222,333	146,188		16,081	Penalty	0		Uncapped Value	0	Mobile Home 0	0		0	Exemption	1,000	-92.00	TIF Project ID	0	Total Value 274,953	180,787		19,887	Total Taxable	18,887	1,746.00																																																																			
Source	REAL	Fair Cash	Capped	Asmnt Level	Assessed	Levy Rate	92.430	Current Tax																																																																																																																	
Remove Cap	2018	Land Value 52,620	34,599	11%	3,806	Assessed	19,887	1,838.16																																																																																																																	
Year Frozen	2021	Improvements 222,333	146,188		16,081	Penalty	0																																																																																																																		
Uncapped Value	0	Mobile Home 0	0		0	Exemption	1,000	-92.00																																																																																																																	
TIF Project ID	0	Total Value 274,953	180,787		19,887	Total Taxable	18,887	1,746.00																																																																																																																	
<b>Assessment History</b> <table border="1"> <thead> <tr> <th>Tax Year</th> <th>Statement Number</th> <th>Billed Owner</th> <th>Tax Area</th> <th>Total Value</th> <th>Exemptions</th> <th>Taxable Value</th> <th>Billed Tax</th> </tr> </thead> <tbody> <tr><td>2025</td><td>2025-660012493</td><td>MOORE, CARL &amp;</td><td>17</td><td>271,687</td><td>1000</td><td>18,887</td><td>1,746.00</td></tr> <tr><td>2024</td><td>2024-660012493</td><td>MOORE, CARL &amp;</td><td>17</td><td>275,439</td><td>1000</td><td>18,886</td><td>1,745.00</td></tr> <tr><td>2023</td><td>2023-660012493</td><td>MOORE, CARL &amp;</td><td>17</td><td>214,509</td><td>1000</td><td>18,887</td><td>1,730.00</td></tr> <tr><td>2022</td><td>2022-660012493</td><td>MOORE, CARL &amp;</td><td>17</td><td>192,982</td><td>1000</td><td>18,886</td><td>1,748.00</td></tr> <tr><td>2021</td><td>2021-660012493</td><td>MOORE, CARL &amp;</td><td>17</td><td>180,787</td><td>1000</td><td>18,887</td><td>1,668.00</td></tr> <tr><td>2020</td><td>2020-660012493</td><td>MOORE, CARL &amp;</td><td>17</td><td>179,665</td><td>0</td><td>19,742</td><td>1,808.00</td></tr> <tr><td>2019</td><td>2019-660012493</td><td>MOORE, CARL &amp;</td><td>17</td><td>170,928</td><td>0</td><td>18,802</td><td>1,741.00</td></tr> <tr><td>2018</td><td>2018-660012493</td><td>MOORE, CARL &amp;</td><td>17</td><td>175,674</td><td>0</td><td>19,324</td><td>1,786.00</td></tr> <tr><td>2017</td><td>2017-660012493</td><td>MOORE, CARL &amp;</td><td>17</td><td>188,625</td><td>1000</td><td>19,749</td><td>1,814.00</td></tr> <tr><td>2016</td><td>2016-660012493</td><td>VICTORY, TIMOTHY C</td><td>17</td><td>184,031</td><td>1000</td><td>19,235</td><td>1,805.00</td></tr> <tr><td>2015</td><td>2015-660012493</td><td>VICTORY, TIMOTHY C</td><td>17</td><td>178,600</td><td>0</td><td>19,646</td><td>1,772.00</td></tr> <tr><td>2014</td><td>2014-660012493</td><td>VICTORY, TIMOTHY C</td><td>17</td><td>194,319</td><td>1000</td><td>18,737</td><td>1,737.00</td></tr> <tr><td>2013</td><td>2013-660012493</td><td>DUNLAP, BRENNY D</td><td>17</td><td>178,621</td><td>1000</td><td>18,162</td><td>1,662.00</td></tr> </tbody> </table>										Tax Year	Statement Number	Billed Owner	Tax Area	Total Value	Exemptions	Taxable Value	Billed Tax	2025	2025-660012493	MOORE, CARL &	17	271,687	1000	18,887	1,746.00	2024	2024-660012493	MOORE, CARL &	17	275,439	1000	18,886	1,745.00	2023	2023-660012493	MOORE, CARL &	17	214,509	1000	18,887	1,730.00	2022	2022-660012493	MOORE, CARL &	17	192,982	1000	18,886	1,748.00	2021	2021-660012493	MOORE, CARL &	17	180,787	1000	18,887	1,668.00	2020	2020-660012493	MOORE, CARL &	17	179,665	0	19,742	1,808.00	2019	2019-660012493	MOORE, CARL &	17	170,928	0	18,802	1,741.00	2018	2018-660012493	MOORE, CARL &	17	175,674	0	19,324	1,786.00	2017	2017-660012493	MOORE, CARL &	17	188,625	1000	19,749	1,814.00	2016	2016-660012493	VICTORY, TIMOTHY C	17	184,031	1000	19,235	1,805.00	2015	2015-660012493	VICTORY, TIMOTHY C	17	178,600	0	19,646	1,772.00	2014	2014-660012493	VICTORY, TIMOTHY C	17	194,319	1000	18,737	1,737.00	2013	2013-660012493	DUNLAP, BRENNY D	17	178,621	1000	18,162	1,662.00
Tax Year	Statement Number	Billed Owner	Tax Area	Total Value	Exemptions	Taxable Value	Billed Tax																																																																																																																		
2025	2025-660012493	MOORE, CARL &	17	271,687	1000	18,887	1,746.00																																																																																																																		
2024	2024-660012493	MOORE, CARL &	17	275,439	1000	18,886	1,745.00																																																																																																																		
2023	2023-660012493	MOORE, CARL &	17	214,509	1000	18,887	1,730.00																																																																																																																		
2022	2022-660012493	MOORE, CARL &	17	192,982	1000	18,886	1,748.00																																																																																																																		
2021	2021-660012493	MOORE, CARL &	17	180,787	1000	18,887	1,668.00																																																																																																																		
2020	2020-660012493	MOORE, CARL &	17	179,665	0	19,742	1,808.00																																																																																																																		
2019	2019-660012493	MOORE, CARL &	17	170,928	0	18,802	1,741.00																																																																																																																		
2018	2018-660012493	MOORE, CARL &	17	175,674	0	19,324	1,786.00																																																																																																																		
2017	2017-660012493	MOORE, CARL &	17	188,625	1000	19,749	1,814.00																																																																																																																		
2016	2016-660012493	VICTORY, TIMOTHY C	17	184,031	1000	19,235	1,805.00																																																																																																																		
2015	2015-660012493	VICTORY, TIMOTHY C	17	178,600	0	19,646	1,772.00																																																																																																																		
2014	2014-660012493	VICTORY, TIMOTHY C	17	194,319	1000	18,737	1,737.00																																																																																																																		
2013	2013-660012493	DUNLAP, BRENNY D	17	178,621	1000	18,162	1,662.00																																																																																																																		



# Rogers

## Assessment Property Record Card for Tax Year 2026

Data provided by LISA DELOZIER County Assessor

Date 04/16/2026  
Time 22:34:59  
Page 2

Lot Data	Square-Foot - NBHD 1167 #1	Primary Image
<b>Lot Size</b> <b>Lot Count</b> 1 <b>Units Buildable</b> 1 <b>Non-Ag Acres</b> 0.2775 <b>Topography</b> <b>Street Access</b> <b>Utilities</b> <b>Amenities</b> LAND QUALITY 0 0 <b>Method</b> Square-Foot <b>Base Lot Value</b> 12,090.00 x 4.35 = 52,620 <b>Factor Value</b> <b>Adjustments</b> 1.0000 <b>Lot Value</b> 52,620		 <p>\\tsclient\C\Users\Randy Necessary\Pictures\101_0714\IMG_0037. 7/15/2022</p>

Residential Data	
<b>Type</b>	1 Single Family Residence
<b>Condition</b>	3 - Average
<b>Quality</b>	3 - Average
<b>Architecture</b>	
<b>Style</b>	100% One Story
<b>Exterior Wall</b>	100% Veneer, Masonry
<b>Base/Total Area</b>	1,941 / 1,941
<b>Style</b>	100% One Story
<b>HVAC</b>	100% Warmed & Cooled Air
<b>Roof Cover</b>	1 Composition Shingle
<b>Area on Slab</b>	1,941
<b>Fixture/RghIn</b>	11 /
<b>Bed/F/H Bath</b>	3 / 2.0 /
<b>Basement Area</b>	
<b>Garage Type</b>	873 Attached Garage - Unfinished
<b>Remodel</b>	
<b>Year/Eff Age</b>	2000 / 20

Cost Approach		Manual : 01/2025	
<b>Base Cost</b>	108.18	<b>Total Misc Impr</b>	+ 7,845
<b>Roofing Adj</b>	+ 4.73	<b>Garage Cost</b>	+ 26,007
<b>Subfloor Adj</b>	+ -2.22	<b>Total RCN</b>	= 288,744
<b>Heat/Cool Adj</b>	+ 12.64	<b>Depreciation ( 23%)</b>	- 66,411
<b>Plumbing Adj</b>	+ 7.99	<b>Lump Sums</b>	+ 0
<b>Basement Adj</b>	+ 0.00	<b>RCNLD</b>	= 222,333
<b>Adj Base Cost</b>	= 131.32	<b>Lot Value</b>	+ 52,620
<b>Total Area</b>	x 1,941	<b>Indicated Value</b>	= 274,953
<b>Adjusted Cost</b>	= 254,892	<b>Value Per SqFt</b>	141.66

GRM Approach	
<b>GRM Code</b>	
<b>Gross Rent</b>	0.00
<b>Indicated Value</b>	

Multiple Regression			
<b>MRA Code</b>	1	Test	
<b>Adusted R</b>	0.8445		
<b>Indicated Value</b>	269,315	138.75	Per SqFt

Direct Comparables			
<b>Selection Model</b>	A	Adam Test	
<b>Adjustment Model</b>	1	2022 Residential	
<b>Comparables</b>	6		
<b>Indicated Value</b>	247,580		Per SqFt

Value Reconciliation			
<b>Selected Approach</b>	Cost Approach		
<b>Improvements</b>	222,333		
<b>Lot Value</b>	52,620		
<b>Indicated Value</b>	274,953	141.66	Per SqFt
<b>Agland Value</b>			
<b>Site Improvements</b>			
<b>Total Value</b>	274,953	141.66	Total Value Per SqFt

Miscellaneous Improvements								
Code	Description	Sketch ID	Size	Year	Units	Unit Cost	Depr	Value
PRCH	SLAB PORCH - COVERED	29889	9x7		63	26.73		1,684
PRCH	SLAB PORCH - COVERED	29890	30x7		210	26.27		5,517
PRCH	SLAB PORCH - COVERED	29891	6x4		24	26.85		644



**Rogers**  
**Assessment Property Record Card for Tax Year 2026**

Data provided by LISA DELOZIER County Assessor

Date 04/16/2026  
 Time 22:34:59  
 Page 3

Sketch Image

660012493

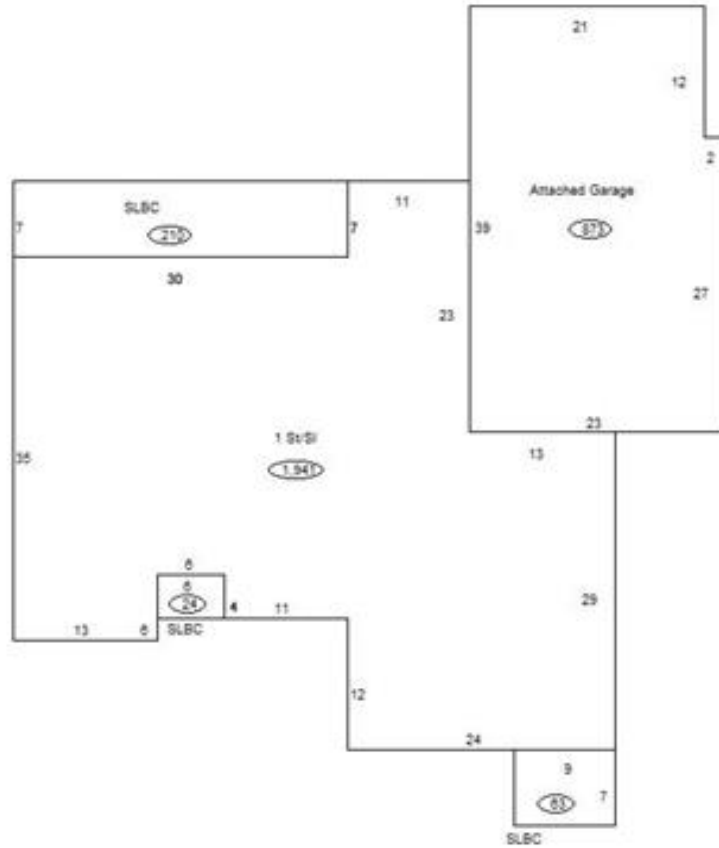

**Sketch Vector Information**

Sequence	Code	Type	Built Over	Scale	Section Label	Base Area	Multiplier	Total Area
1	R	1	Slab	13	1 St/SI	1,941	1.000	1,941
2	G	1		13	Attached Garage	873	1.000	873
3	M	PRCH		13	SLBC	63	1.000	63
4	M	PRCH		13	SLBC	210	1.000	210
5	M	PRCH		13	SLBC	24	1.000	24
<b>Total Building Area</b>						1,941		1,941