



# Rogers

## Assessment Property Record Card for Tax Year 2026

Data provided by LISA DELOZIER County Assessor

Date 04/16/2026  
Time 22:35:08  
Page 1

Assessment Data					Primary Image																																																																																																																				
<b>Account</b> 660012507 <b>Parcel ID</b> 000000-00-0-10140-002-0014 <b>Cadastral ID</b> 12-21-15-01610 <b>Property Type</b> REAL - Real Property <b>Property Class</b> URP VI Area 4 <b>Tax Area</b> 17 - CLAREMORE OT <b>Name ID</b> 331190 MILLER, KEITH BURDETT & HOLLY  3308 BUNKER ST CLAREMORE OK 74019-0000  <b>Parcel Location</b> <b>Situs</b> 03308 BUNKER ST <b>Subdivision</b> HERITAGE HILLS SUB <b>Lot/Block</b> 0014 / 0002 <b>Parcel Size</b> 1 - Lots <b>Sec/Twn/Rng</b> 12 / 21 / 15 / 5 <b>Neighborhood</b> 1167 - R-V01-SW CLAREMORE <b>School District</b> S001 - CLAREMORE SCHOOLS																																																																																																																									
<b>Legal Description</b> Lot/Long: 36.31916772 -95.65514845																																																																																																																									
<b>Building Permits</b>					<table border="1"> <thead> <tr> <th>Number</th> <th>Description</th> <th>Opened</th> <th>Closed</th> <th>Amount</th> </tr> </thead> <tbody> <tr> <td colspan="5" style="height: 100px;"> </td> </tr> </tbody> </table>					Number	Description	Opened	Closed	Amount																																																																																																											
Number	Description	Opened	Closed	Amount																																																																																																																					
<b>Exemptions</b>					<b>Sale History</b>																																																																																																																				
<table border="1"> <thead> <tr> <th>Code</th> <th>Type</th> <th>Active</th> <th>Maximum</th> <th>Exemption</th> </tr> </thead> <tbody> <tr> <td>H</td> <td>Homestead</td> <td>Yes</td> <td>1,000</td> <td>1,000</td> </tr> </tbody> </table>					Code	Type	Active	Maximum	Exemption	H	Homestead	Yes	1,000	1,000	<table border="1"> <thead> <tr> <th>Bk/Pg</th> <th>Grantor</th> <th>Date</th> <th>Price</th> <th>Code</th> </tr> </thead> <tbody> <tr> <td>/</td> <td>MILLER, JOHN H &amp; NANCY A</td> <td>09/16/2019</td> <td>0</td> <td>4</td> </tr> <tr> <td>1221/678</td> <td>HERITAGE HILLS DEV CORP</td> <td>03/10/2000</td> <td>147,000</td> <td>Yes</td> </tr> </tbody> </table>					Bk/Pg	Grantor	Date	Price	Code	/	MILLER, JOHN H & NANCY A	09/16/2019	0	4	1221/678	HERITAGE HILLS DEV CORP	03/10/2000	147,000	Yes																																																																																							
Code	Type	Active	Maximum	Exemption																																																																																																																					
H	Homestead	Yes	1,000	1,000																																																																																																																					
Bk/Pg	Grantor	Date	Price	Code																																																																																																																					
/	MILLER, JOHN H & NANCY A	09/16/2019	0	4																																																																																																																					
1221/678	HERITAGE HILLS DEV CORP	03/10/2000	147,000	Yes																																																																																																																					
<b>Parcel Valuation</b>																																																																																																																									
<table border="1"> <thead> <tr> <th>Source</th> <th>REAL</th> <th>Fair Cash</th> <th>Capped</th> <th>Asmnt Level</th> <th>Assessed</th> <th>Levy Rate</th> <th>92.430</th> <th>Current Tax</th> </tr> </thead> <tbody> <tr> <td>Remove Cap</td> <td>2001</td> <td>Land Value 48,677</td> <td>29,375</td> <td>11%</td> <td>3,231</td> <td>Assessed</td> <td>17,919</td> <td>1,656.25</td> </tr> <tr> <td>Year Frozen</td> <td>2010</td> <td>Improvements 221,271</td> <td>133,528</td> <td></td> <td>14,688</td> <td>Penalty</td> <td>0</td> <td></td> </tr> <tr> <td>Uncapped Value</td> <td>0</td> <td>Mobile Home 0</td> <td>0</td> <td></td> <td>0</td> <td>Exemption</td> <td>1,000</td> <td>-92.00</td> </tr> <tr> <td>TIF Project ID</td> <td>0</td> <td>Total Value 269,948</td> <td>162,903</td> <td></td> <td>17,919</td> <td>Total Taxable</td> <td>16,919</td> <td>1,564.00</td> </tr> </tbody> </table>		Source	REAL	Fair Cash	Capped	Asmnt Level	Assessed	Levy Rate	92.430	Current Tax	Remove Cap	2001	Land Value 48,677	29,375	11%	3,231	Assessed	17,919	1,656.25	Year Frozen	2010	Improvements 221,271	133,528		14,688	Penalty	0		Uncapped Value	0	Mobile Home 0	0		0	Exemption	1,000	-92.00	TIF Project ID	0	Total Value 269,948	162,903		17,919	Total Taxable	16,919	1,564.00																																																																											
Source	REAL	Fair Cash	Capped	Asmnt Level	Assessed	Levy Rate	92.430	Current Tax																																																																																																																	
Remove Cap	2001	Land Value 48,677	29,375	11%	3,231	Assessed	17,919	1,656.25																																																																																																																	
Year Frozen	2010	Improvements 221,271	133,528		14,688	Penalty	0																																																																																																																		
Uncapped Value	0	Mobile Home 0	0		0	Exemption	1,000	-92.00																																																																																																																	
TIF Project ID	0	Total Value 269,948	162,903		17,919	Total Taxable	16,919	1,564.00																																																																																																																	
<b>Assessment History</b>																																																																																																																									
<table border="1"> <thead> <tr> <th>Tax Year</th> <th>Statement Number</th> <th>Billed Owner</th> <th>Tax Area</th> <th>Total Value</th> <th>Exemptions</th> <th>Taxable Value</th> <th>Billed Tax</th> </tr> </thead> <tbody> <tr><td>2025</td><td>2025-660012507</td><td>MILLER, KEITH BURDETT &amp;</td><td>17</td><td>266,780</td><td>1000</td><td>16,920</td><td>1,564.00</td></tr> <tr><td>2024</td><td>2024-660012507</td><td>MILLER, KEITH BURDETT &amp;</td><td>17</td><td>271,566</td><td>1000</td><td>16,919</td><td>1,564.00</td></tr> <tr><td>2023</td><td>2023-660012507</td><td>MILLER, KEITH BURDETT &amp;</td><td>17</td><td>240,746</td><td>1000</td><td>16,920</td><td>1,550.00</td></tr> <tr><td>2022</td><td>2022-660012507</td><td>MILLER, KEITH BURDETT &amp;</td><td>17</td><td>221,737</td><td>1000</td><td>16,919</td><td>1,566.00</td></tr> <tr><td>2021</td><td>2021-660012507</td><td>MILLER, KEITH BURDETT &amp;</td><td>17</td><td>201,005</td><td>1000</td><td>16,919</td><td>1,494.00</td></tr> <tr><td>2020</td><td>2020-660012507</td><td>MILLER, KEITH BURDETT &amp;</td><td>17</td><td>199,661</td><td>1000</td><td>16,919</td><td>1,549.00</td></tr> <tr><td>2019</td><td>2019-660012507</td><td>MILLER, JOHN H &amp; NANCY A</td><td>17</td><td>189,629</td><td>1000</td><td>16,919</td><td>1,567.00</td></tr> <tr><td>2018</td><td>2018-660012507</td><td>MILLER, JOHN H &amp; NANCY A</td><td>17</td><td>195,078</td><td>1000</td><td>16,919</td><td>1,563.00</td></tr> <tr><td>2017</td><td>2017-660012507</td><td>MILLER, JOHN H &amp; NANCY A</td><td>17</td><td>193,472</td><td>1000</td><td>16,919</td><td>1,554.00</td></tr> <tr><td>2016</td><td>2016-660012507</td><td>MILLER, JOHN H &amp; NANCY A</td><td>17</td><td>188,467</td><td>1000</td><td>16,919</td><td>1,588.00</td></tr> <tr><td>2015</td><td>2015-660012507</td><td>MILLER, JOHN H &amp; NANCY A</td><td>17</td><td>182,531</td><td>1000</td><td>16,919</td><td>1,526.00</td></tr> <tr><td>2014</td><td>2014-660012507</td><td>MILLER, JOHN H &amp; NANCY A</td><td>17</td><td>185,691</td><td>1000</td><td>16,919</td><td>1,569.00</td></tr> <tr><td>2013</td><td>2013-660012507</td><td>MILLER, JOHN H &amp; NANCY A</td><td>17</td><td>170,975</td><td>1000</td><td>16,919</td><td>1,548.00</td></tr> </tbody> </table>										Tax Year	Statement Number	Billed Owner	Tax Area	Total Value	Exemptions	Taxable Value	Billed Tax	2025	2025-660012507	MILLER, KEITH BURDETT &	17	266,780	1000	16,920	1,564.00	2024	2024-660012507	MILLER, KEITH BURDETT &	17	271,566	1000	16,919	1,564.00	2023	2023-660012507	MILLER, KEITH BURDETT &	17	240,746	1000	16,920	1,550.00	2022	2022-660012507	MILLER, KEITH BURDETT &	17	221,737	1000	16,919	1,566.00	2021	2021-660012507	MILLER, KEITH BURDETT &	17	201,005	1000	16,919	1,494.00	2020	2020-660012507	MILLER, KEITH BURDETT &	17	199,661	1000	16,919	1,549.00	2019	2019-660012507	MILLER, JOHN H & NANCY A	17	189,629	1000	16,919	1,567.00	2018	2018-660012507	MILLER, JOHN H & NANCY A	17	195,078	1000	16,919	1,563.00	2017	2017-660012507	MILLER, JOHN H & NANCY A	17	193,472	1000	16,919	1,554.00	2016	2016-660012507	MILLER, JOHN H & NANCY A	17	188,467	1000	16,919	1,588.00	2015	2015-660012507	MILLER, JOHN H & NANCY A	17	182,531	1000	16,919	1,526.00	2014	2014-660012507	MILLER, JOHN H & NANCY A	17	185,691	1000	16,919	1,569.00	2013	2013-660012507	MILLER, JOHN H & NANCY A	17	170,975	1000	16,919	1,548.00
Tax Year	Statement Number	Billed Owner	Tax Area	Total Value	Exemptions	Taxable Value	Billed Tax																																																																																																																		
2025	2025-660012507	MILLER, KEITH BURDETT &	17	266,780	1000	16,920	1,564.00																																																																																																																		
2024	2024-660012507	MILLER, KEITH BURDETT &	17	271,566	1000	16,919	1,564.00																																																																																																																		
2023	2023-660012507	MILLER, KEITH BURDETT &	17	240,746	1000	16,920	1,550.00																																																																																																																		
2022	2022-660012507	MILLER, KEITH BURDETT &	17	221,737	1000	16,919	1,566.00																																																																																																																		
2021	2021-660012507	MILLER, KEITH BURDETT &	17	201,005	1000	16,919	1,494.00																																																																																																																		
2020	2020-660012507	MILLER, KEITH BURDETT &	17	199,661	1000	16,919	1,549.00																																																																																																																		
2019	2019-660012507	MILLER, JOHN H & NANCY A	17	189,629	1000	16,919	1,567.00																																																																																																																		
2018	2018-660012507	MILLER, JOHN H & NANCY A	17	195,078	1000	16,919	1,563.00																																																																																																																		
2017	2017-660012507	MILLER, JOHN H & NANCY A	17	193,472	1000	16,919	1,554.00																																																																																																																		
2016	2016-660012507	MILLER, JOHN H & NANCY A	17	188,467	1000	16,919	1,588.00																																																																																																																		
2015	2015-660012507	MILLER, JOHN H & NANCY A	17	182,531	1000	16,919	1,526.00																																																																																																																		
2014	2014-660012507	MILLER, JOHN H & NANCY A	17	185,691	1000	16,919	1,569.00																																																																																																																		
2013	2013-660012507	MILLER, JOHN H & NANCY A	17	170,975	1000	16,919	1,548.00																																																																																																																		



# Rogers

## Assessment Property Record Card for Tax Year 2026

Data provided by LISA DELOZIER County Assessor

Date 04/16/2026  
Time 22:35:08  
Page 2

Lot Data	Square-Foot - NBHD 1167 #1	Primary Image
Lot Size		
Lot Count	1	
Units Buildable	1	
Non-Ag Acres	0.2557	
Topography		
Street Access		
Utilities		
Amenities	LAND QUALITY	
	0	
	0	
Method	Square-Foot	
Base Lot Value	11,139.00 x 4.37 = 48,677	
Factor Value		
Adjustments	1.0000	
Lot Value	48,677	

Residential Data	
Type	1 Single Family Residence
Condition	3 - Average
Quality	3 - Average
Architecture	
Style	100% One Story
Exterior Wall	100% Veneer, Masonry
Base/Total Area	2,033 / 2,033
Style	100% One Story
HVAC	100% Warmed & Cooled Air
Roof Cover	1 Composition Shingle
Area on Slab	2,033
Fixture/RghIn	11 /
Bed/F/H Bath	3 / 2.0 /
Basement Area	
Garage Type	552 Attached Garage - Unfinished
Remodel	
Year/Eff Age	2000 / 20



\\tsclient\C\Users\Randy Necessary\Pictures\101\_0714\IMG\_0045. 7/15/2022

GRM Approach	
GRM Code	
Gross Rent	0.00
Indicated Value	

Multiple Regression			
MRA Code	1	Test	
Adjusted R	0.8445		
Indicated Value	247,401	121.69	Per SqFt

Direct Comparables			
Selection Model	A	Adam Test	
Adjustment Model	1	2022 Residential	
Comparables	6		
Indicated Value	276,970		Per SqFt

Value Reconciliation			
Selected Approach	Cost Approach		
Improvements	221,271		
Lot Value	48,677		
Indicated Value	269,948	132.78	Per SqFt
Agland Value			
Site Improvements			
Total Value	269,948	132.78	Total Value Per SqFt

Cost Approach				Manual : 01/2025			
Base Cost	107.09	Total Misc Impr	+	6,169			
Roofing Adj	+ 4.68	Garage Cost	+	17,211			
Subfloor Adj	+ -2.19	Total RCN	=	287,365			
Heat/Cool Adj	+ 12.64	Depreciation ( 23%)	-	66,094			
Plumbing Adj	+ 7.63	Lump Sums	+	0			
Basement Adj	+ 0.00	RCNLD	=	221,271			
Adj Base Cost	= 129.85	Lot Value	+	48,677			
Total Area	x 2,033	Indicated Value	=	269,948			
Adjusted Cost	= 263,985	Value Per SqFt		132.78			

Miscellaneous Improvements								
Code	Description	Sketch ID	Size	Year	Units	Unit Cost	Depr	Value
PRCH	SLAB PORCH - COVERED	29938	10x6		60	26.74		1,604
PRCH	SLAB PORCH - COVERED	29939	173		173	26.39		4,565



**Rogers**  
**Assessment Property Record Card for Tax Year 2026**

Data provided by LISA DELOZIER County Assessor

Date 04/16/2026  
 Time 22:35:08  
 Page 3

Sketch Image

660012507

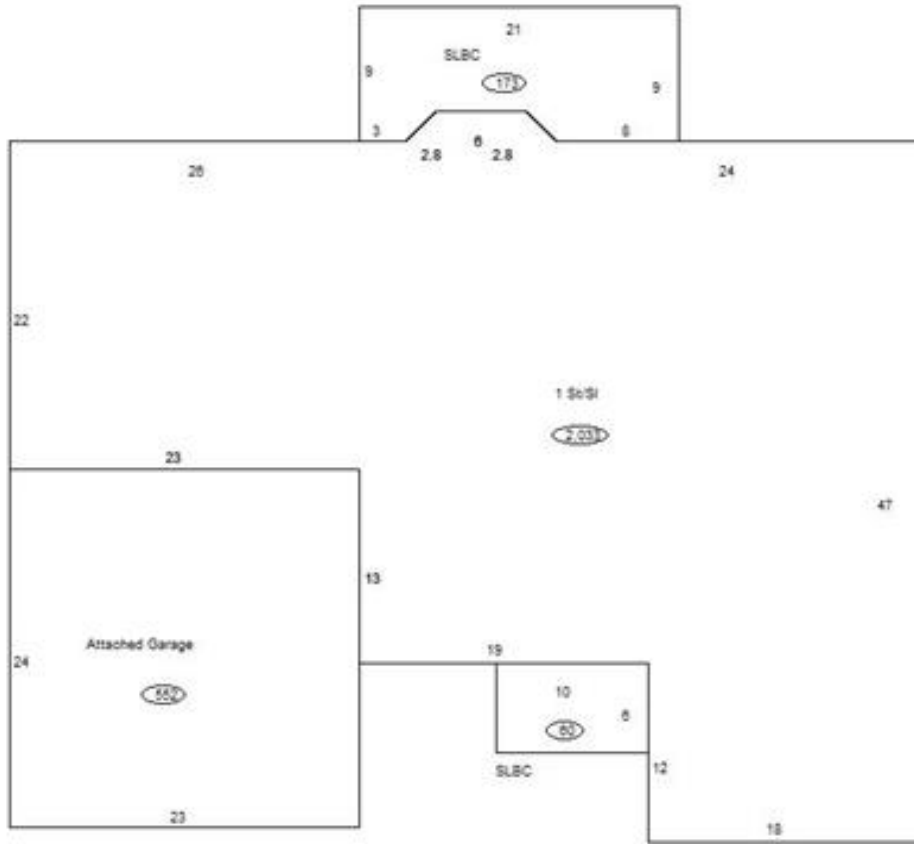

**Sketch Vector Information**

Sequence	Code	Type	Built Over	Scale	Section Label	Base Area	Multiplier	Total Area
1	R	1	Slab	10	1 St/SI	2,033	1.000	2,033
2	G	1		10	Attached Garage	552	1.000	552
3	M	PRCH		10	SLBC	60	1.000	60
4	M	PRCH		10	SLBC	173	1.000	173
<b>Total Building Area</b>						<b>2,033</b>		<b>2,033</b>