



Rogers

Assessment Property Record Card for Tax Year 2026

Data provided by LISA DELOZIER County Assessor

Date 04/16/2026
Time 22:35:50
Page 1

Assessment Data					Primary Image																																																																																																																				
Account 660012553 Parcel ID 000000-00-0-10140-004-0001 Cadastral ID 12-21-15-02070 Property Type REAL - Real Property Property Class URP VI Area 4 Tax Area 17 - CLAREMORE OT Name ID 348904 GREENLEE, ROBERTA L 3217 CLUB ST CLAREMORE OK 74019-0000 Parcel Location Situs 03217 CLUB ST Subdivision HERITAGE HILLS SUB Lot/Block 0001 / 0004 Parcel Size 1 - Lots Sec/Twn/Rng 12 / 21 / 15 / 5 Neighborhood 1167 - R-V01-SW CLAREMORE School District S001 - CLAREMORE SCHOOLS																																																																																																																									
Legal Description Lot/Long: 36.31801225 -95.65488152																																																																																																																									
Legal Description LOT 1 BLOCK 4 HERITAGE HILLS SUB					Building Permits <table border="1"> <thead> <tr> <th>Number</th> <th>Description</th> <th>Opened</th> <th>Closed</th> <th>Amount</th> </tr> </thead> <tbody> <tr> <td></td> <td></td> <td></td> <td></td> <td></td> </tr> </tbody> </table>					Number	Description	Opened	Closed	Amount																																																																																																											
Number	Description	Opened	Closed	Amount																																																																																																																					
Exemptions <table border="1"> <thead> <tr> <th>Code</th> <th>Type</th> <th>Active</th> <th>Maximum</th> <th>Exemption</th> </tr> </thead> <tbody> <tr> <td>H</td> <td>Homestead</td> <td>Yes</td> <td>1,000</td> <td>1,000</td> </tr> <tr> <td>HVS</td> <td>Veteran</td> <td>No</td> <td>999,999</td> <td></td> </tr> </tbody> </table>					Code	Type	Active	Maximum	Exemption	H	Homestead	Yes	1,000	1,000	HVS	Veteran	No	999,999		Sale History <table border="1"> <thead> <tr> <th>Bk/Pg</th> <th>Grantor</th> <th>Date</th> <th>Price</th> <th>Code</th> </tr> </thead> <tbody> <tr> <td>/</td> <td>MAPES, LORETTA FAYE</td> <td>12/02/2025</td> <td>295,000</td> <td>YES</td> </tr> <tr> <td>/</td> <td>FRANKLIN, DONNA M</td> <td>02/21/2020</td> <td>193,500</td> <td>YES</td> </tr> <tr> <td>2546/928</td> <td>FRANKLIN, KENNETH L & DONNA M</td> <td>05/04/2016</td> <td>0</td> <td>4</td> </tr> <tr> <td>1256/40</td> <td>S D F BUILDERS INC</td> <td>11/02/2000</td> <td>156,500</td> <td>Yes</td> </tr> <tr> <td>1228/89</td> <td>HERITAGE HILLS DEV CORP</td> <td>05/15/2000</td> <td>51,000</td> <td>No</td> </tr> <tr> <td>865/208</td> <td></td> <td>10/16/1991</td> <td>34,000</td> <td>No</td> </tr> </tbody> </table>					Bk/Pg	Grantor	Date	Price	Code	/	MAPES, LORETTA FAYE	12/02/2025	295,000	YES	/	FRANKLIN, DONNA M	02/21/2020	193,500	YES	2546/928	FRANKLIN, KENNETH L & DONNA M	05/04/2016	0	4	1256/40	S D F BUILDERS INC	11/02/2000	156,500	Yes	1228/89	HERITAGE HILLS DEV CORP	05/15/2000	51,000	No	865/208		10/16/1991	34,000	No																																																														
Code	Type	Active	Maximum	Exemption																																																																																																																					
H	Homestead	Yes	1,000	1,000																																																																																																																					
HVS	Veteran	No	999,999																																																																																																																						
Bk/Pg	Grantor	Date	Price	Code																																																																																																																					
/	MAPES, LORETTA FAYE	12/02/2025	295,000	YES																																																																																																																					
/	FRANKLIN, DONNA M	02/21/2020	193,500	YES																																																																																																																					
2546/928	FRANKLIN, KENNETH L & DONNA M	05/04/2016	0	4																																																																																																																					
1256/40	S D F BUILDERS INC	11/02/2000	156,500	Yes																																																																																																																					
1228/89	HERITAGE HILLS DEV CORP	05/15/2000	51,000	No																																																																																																																					
865/208		10/16/1991	34,000	No																																																																																																																					
Parcel Valuation <table border="1"> <thead> <tr> <th>Source</th> <th>REAL</th> <th>Fair Cash</th> <th>Capped</th> <th>Asmnt Level</th> <th>Assessed</th> <th>Levy Rate</th> <th>92.430</th> <th>Current Tax</th> </tr> </thead> <tbody> <tr> <td>Remove Cap</td> <td>2026</td> <td>Land Value 80,125</td> <td>80,125</td> <td>11%</td> <td>8,814</td> <td>Assessed</td> <td>32,450</td> <td>2,999.35</td> </tr> <tr> <td>Year Frozen</td> <td>0</td> <td>Improvements 214,878</td> <td>214,878</td> <td></td> <td>23,636</td> <td>Penalty</td> <td>0</td> <td></td> </tr> <tr> <td>Uncapped Value</td> <td>0</td> <td>Mobile Home 0</td> <td>0</td> <td></td> <td>0</td> <td>Exemption</td> <td>1,000</td> <td>-92.00</td> </tr> <tr> <td>TIF Project ID</td> <td>0</td> <td>Total Value 295,003</td> <td>295,003</td> <td></td> <td>32,450</td> <td>Total Taxable</td> <td>31,450</td> <td>2,907.00</td> </tr> </tbody> </table>										Source	REAL	Fair Cash	Capped	Asmnt Level	Assessed	Levy Rate	92.430	Current Tax	Remove Cap	2026	Land Value 80,125	80,125	11%	8,814	Assessed	32,450	2,999.35	Year Frozen	0	Improvements 214,878	214,878		23,636	Penalty	0		Uncapped Value	0	Mobile Home 0	0		0	Exemption	1,000	-92.00	TIF Project ID	0	Total Value 295,003	295,003		32,450	Total Taxable	31,450	2,907.00																																																																			
Source	REAL	Fair Cash	Capped	Asmnt Level	Assessed	Levy Rate	92.430	Current Tax																																																																																																																	
Remove Cap	2026	Land Value 80,125	80,125	11%	8,814	Assessed	32,450	2,999.35																																																																																																																	
Year Frozen	0	Improvements 214,878	214,878		23,636	Penalty	0																																																																																																																		
Uncapped Value	0	Mobile Home 0	0		0	Exemption	1,000	-92.00																																																																																																																	
TIF Project ID	0	Total Value 295,003	295,003		32,450	Total Taxable	31,450	2,907.00																																																																																																																	
Assessment History <table border="1"> <thead> <tr> <th>Tax Year</th> <th>Statement Number</th> <th>Billed Owner</th> <th>Tax Area</th> <th>Total Value</th> <th>Exemptions</th> <th>Taxable Value</th> <th>Billed Tax</th> </tr> </thead> <tbody> <tr><td>2025</td><td>2025-660012553</td><td>MAPES, LORETTA FAYE</td><td>17</td><td>265,407</td><td>24422</td><td></td><td>.00</td></tr> <tr><td>2024</td><td>2024-660012553</td><td>MAPES, LARRY G &</td><td>17</td><td>269,899</td><td>23711</td><td></td><td>.00</td></tr> <tr><td>2023</td><td>2023-660012553</td><td>MAPES, LARRY G &</td><td>17</td><td>234,889</td><td>23020</td><td></td><td>.00</td></tr> <tr><td>2022</td><td>2022-660012553</td><td>MAPES, LARRY G &</td><td>17</td><td>217,885</td><td>22350</td><td></td><td>.00</td></tr> <tr><td>2021</td><td>2021-660012553</td><td>MAPES, LARRY G &</td><td>17</td><td>197,268</td><td>21699</td><td></td><td>.00</td></tr> <tr><td>2020</td><td>2020-660012553</td><td>MAPES, LARRY G &</td><td>17</td><td>198,285</td><td>21353</td><td></td><td>.00</td></tr> <tr><td>2019</td><td>2019-660012553</td><td>FRANKLIN, DONNA M</td><td>17</td><td>188,468</td><td>1000</td><td>19,731</td><td>1,827.00</td></tr> <tr><td>2018</td><td>2018-660012553</td><td>FRANKLIN, DONNA M</td><td>17</td><td>192,989</td><td>1000</td><td>20,229</td><td>1,869.00</td></tr> <tr><td>2017</td><td>2017-660012553</td><td>FRANKLIN, DONNA M</td><td>17</td><td>191,424</td><td>1000</td><td>20,021</td><td>1,839.00</td></tr> <tr><td>2016</td><td>2016-660012553</td><td>FRANKLIN, DONNA M</td><td>17</td><td>186,485</td><td>1000</td><td>19,408</td><td>1,822.00</td></tr> <tr><td>2015</td><td>2015-660012553</td><td>FRANKLIN, KENNETH L & DONNA M</td><td>17</td><td>180,977</td><td>1000</td><td>18,814</td><td>1,697.00</td></tr> <tr><td>2014</td><td>2014-660012553</td><td>FRANKLIN, KENNETH L & DONNA M</td><td>17</td><td>184,113</td><td>1000</td><td>18,237</td><td>1,691.00</td></tr> <tr><td>2013</td><td>2013-660012553</td><td>FRANKLIN, KENNETH L & DONNA M</td><td>17</td><td>169,789</td><td>1000</td><td>17,677</td><td>1,618.00</td></tr> </tbody> </table>										Tax Year	Statement Number	Billed Owner	Tax Area	Total Value	Exemptions	Taxable Value	Billed Tax	2025	2025-660012553	MAPES, LORETTA FAYE	17	265,407	24422		.00	2024	2024-660012553	MAPES, LARRY G &	17	269,899	23711		.00	2023	2023-660012553	MAPES, LARRY G &	17	234,889	23020		.00	2022	2022-660012553	MAPES, LARRY G &	17	217,885	22350		.00	2021	2021-660012553	MAPES, LARRY G &	17	197,268	21699		.00	2020	2020-660012553	MAPES, LARRY G &	17	198,285	21353		.00	2019	2019-660012553	FRANKLIN, DONNA M	17	188,468	1000	19,731	1,827.00	2018	2018-660012553	FRANKLIN, DONNA M	17	192,989	1000	20,229	1,869.00	2017	2017-660012553	FRANKLIN, DONNA M	17	191,424	1000	20,021	1,839.00	2016	2016-660012553	FRANKLIN, DONNA M	17	186,485	1000	19,408	1,822.00	2015	2015-660012553	FRANKLIN, KENNETH L & DONNA M	17	180,977	1000	18,814	1,697.00	2014	2014-660012553	FRANKLIN, KENNETH L & DONNA M	17	184,113	1000	18,237	1,691.00	2013	2013-660012553	FRANKLIN, KENNETH L & DONNA M	17	169,789	1000	17,677	1,618.00
Tax Year	Statement Number	Billed Owner	Tax Area	Total Value	Exemptions	Taxable Value	Billed Tax																																																																																																																		
2025	2025-660012553	MAPES, LORETTA FAYE	17	265,407	24422		.00																																																																																																																		
2024	2024-660012553	MAPES, LARRY G &	17	269,899	23711		.00																																																																																																																		
2023	2023-660012553	MAPES, LARRY G &	17	234,889	23020		.00																																																																																																																		
2022	2022-660012553	MAPES, LARRY G &	17	217,885	22350		.00																																																																																																																		
2021	2021-660012553	MAPES, LARRY G &	17	197,268	21699		.00																																																																																																																		
2020	2020-660012553	MAPES, LARRY G &	17	198,285	21353		.00																																																																																																																		
2019	2019-660012553	FRANKLIN, DONNA M	17	188,468	1000	19,731	1,827.00																																																																																																																		
2018	2018-660012553	FRANKLIN, DONNA M	17	192,989	1000	20,229	1,869.00																																																																																																																		
2017	2017-660012553	FRANKLIN, DONNA M	17	191,424	1000	20,021	1,839.00																																																																																																																		
2016	2016-660012553	FRANKLIN, DONNA M	17	186,485	1000	19,408	1,822.00																																																																																																																		
2015	2015-660012553	FRANKLIN, KENNETH L & DONNA M	17	180,977	1000	18,814	1,697.00																																																																																																																		
2014	2014-660012553	FRANKLIN, KENNETH L & DONNA M	17	184,113	1000	18,237	1,691.00																																																																																																																		
2013	2013-660012553	FRANKLIN, KENNETH L & DONNA M	17	169,789	1000	17,677	1,618.00																																																																																																																		



Rogers

Assessment Property Record Card for Tax Year 2026

Data provided by LISA DELOZIER County Assessor

Date 04/16/2026
Time 22:35:50
Page 2

Lot Data	Square-Foot - NBHD 1167 #1	Primary Image
Lot Size		
Lot Count	1	
Units Buildable	1	
Non-Ag Acres	0.2901	
Topography		
Street Access		
Utilities		
Amenities	LAND QUALITY	
	0	
	0	
Method	Square-Foot	
Base Lot Value	12,637.00 x 4.25 = 53,714	
Factor Value		
Adjustments	1.4917	
Lot Value	80,125	

Residential Data	
Type	1 Single Family Residence
Condition	3 - Average
Quality	3 - Average
Architecture	
Style	100% One Story
Exterior Wall	90% Veneer, Masonry 10% Frame, Siding, Vinyl
Base/Total Area	1,932 / 1,932
Style	100% One Story
HVAC	100% Warmed & Cooled Air
Roof Cover	1 Composition Shingle
Area on Slab	1,932
Fixture/RghIn	9 /
Bed/F/H Bath	3 / 2.0 /
Basement Area	
Garage Type	772 Attached Garage - Unfinished
Remodel	
Year/Eff Age	2000 / 20



\\tsclient\C\Users\Randy Necessary\Pictures\101_0715\IMG_0032. 7/15/2022

GRM Approach	
GRM Code	
Gross Rent	0.00
Indicated Value	

Multiple Regression			
MRA Code	1	Test	
Adjusted R	0.8445		
Indicated Value	260,095	134.62	Per SqFt

Direct Comparables			
Selection Model	A	Adam Test	
Adjustment Model	1	2022 Residential	
Comparables	6		
Indicated Value	290,630		Per SqFt

Value Reconciliation			
Selected Approach	Cost Approach		
Improvements	214,410		
Lot Value	80,125		
Indicated Value	294,535	152.45	Per SqFt
Agland Value			
Site Improvements	468		
Total Value	295,003	152.69	Total Value Per SqFt

Cost Approach				Manual : 01/2025			
Base Cost	107.41	Total Misc Impr	+	5,862			
Roofing Adj	+ 4.73	Garage Cost	+	22,998			
Subfloor Adj	+ -2.23	Total RCN	=	278,455			
Heat/Cool Adj	+ 12.64	Depreciation (23%)	-	64,045			
Plumbing Adj	+ 6.64	Lump Sums	+	0			
Basement Adj	+ 0.00	RCNLD	=	214,410			
Adj Base Cost	= 129.19	Lot Value	+	80,125			
Total Area	x 1,932	Indicated Value	=	294,535			
Adjusted Cost	= 249,595	Value Per SqFt		152.45			

Miscellaneous Improvements								
Code	Description	Sketch ID	Size	Year	Units	Unit Cost	Depr	Value
SHLT	STORM SHELTER	0		1	2014	1	0.00	
PRCH	SLAB PORCH - COVERED	30131	8x4			32	26.83	859
PRCH	SLAB PORCH - COVERED	30132	19x10			190	26.33	5,003



Rogers

Assessment Property Record Card for Tax Year 2026

Data provided by LISA DELOZIER County Assessor

Date 04/16/2026
 Time 22:35:50
 Page 3

Sketch Image

660012553

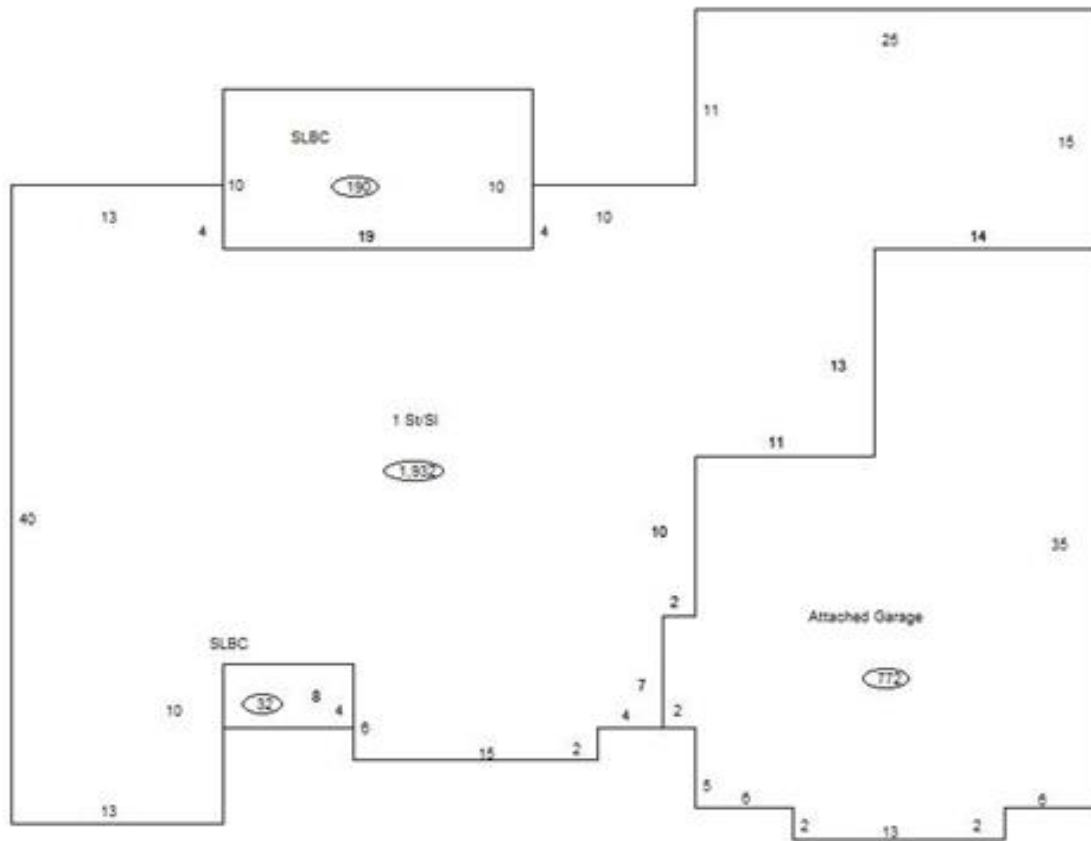

Sketch Vector Information

Sequence	Code	Type	Built Over	Scale	Section Label	Base Area	Multiplier	Total Area
1	R	1	Slab	10	1 St/Sl	1,932	1.000	1,932
2	G	1		10	Attached Garage	772	1.000	772
3	M	PRCH		10	SLBC	32	1.000	32
4	M	PRCH		10	SLBC	190	1.000	190
Total Building Area						1,932		1,932



Rogers

Assessment Property Record Card for Tax Year 2026

Data provided by LISA DELOZIER County Assessor

Date 04/16/2026
Time 22:35:51
Page 4

660012553

Outbuildings/Site Improvements

Building Image	Code	Description	Dimensions	Floor	Roofing	Total Units
	STF	STG FAIR	10x10x0			100
	Qual	2	Cond 3	Year	Eff Age 1520	
Valuation Summary		Modifier Total		RCN	Depr (0% Phys/ % Func)	RCNLD
Base Cost (4.68 x 100)		468			468	468