



Rogers

Assessment Property Record Card for Tax Year 2026

Data provided by LISA DELOZIER County Assessor

Date 04/17/2026
Time 08:54:21
Page 1

Assessment Data					Primary Image																																																																																																																				
Account 660012682 Parcel ID 000000-00-0-00174-008-0001 Cadastral ID 12-21-15-03370 Property Type REAL - Real Property Property Class RRP VI Area 4 Tax Area 8 - CLAREMORE/ NW FIRE Name ID 292974 BIGGAM, MICHAEL & PHYLLIS 9705 MARBLEHEAD DR CLAREMORE OK 74017-0000																																																																																																																									
Parcel Location Situs 09705 MARBLEHEAD DR Subdivision COLONIAL ESTATES 2 Lot/Block 0001 / 0008 Parcel Size 1 - Lots Sec/Twn/Rng 12 / 21 / 15 / 5 Neighborhood 1209 - R-V03,3-SW CLAREMORE School District S001 - CLAREMORE SCHOOLS																																																																																																																									
Legal Description Lot/Long: 36.31030931 -95.65921730					Building Permits <table border="1"> <thead> <tr> <th>Number</th> <th>Description</th> <th>Opened</th> <th>Closed</th> <th>Amount</th> </tr> </thead> <tbody> <tr> <td colspan="5"> </td> </tr> </tbody> </table>					Number	Description	Opened	Closed	Amount																																																																																																											
Number	Description	Opened	Closed	Amount																																																																																																																					
Exemptions <table border="1"> <thead> <tr> <th>Code</th> <th>Type</th> <th>Active</th> <th>Maximum</th> <th>Exemption</th> </tr> </thead> <tbody> <tr> <td>H</td> <td>Homestead</td> <td>Yes</td> <td>1,000</td> <td>1,000</td> </tr> </tbody> </table>					Code	Type	Active	Maximum	Exemption	H	Homestead	Yes	1,000	1,000	Sale History <table border="1"> <thead> <tr> <th>Bk/Pg</th> <th>Grantor</th> <th>Date</th> <th>Price</th> <th>Code</th> </tr> </thead> <tbody> <tr> <td>1801/22</td> <td>TREVINO, DELIA</td> <td>08/22/2006</td> <td>150,000</td> <td>YES</td> </tr> <tr> <td>1346/116</td> <td>CUMMINS, SUZANNE ELIZABETH</td> <td>12/28/2001</td> <td>0</td> <td>16</td> </tr> <tr> <td>1356/851</td> <td>MCDRUMMOND, SUZANNE & PHIL</td> <td>12/18/2001</td> <td>120,000</td> <td>YES</td> </tr> <tr> <td>920/874</td> <td>ROLAND & ASSOCIATES</td> <td>06/25/1993</td> <td>91,780</td> <td>Yes</td> </tr> <tr> <td>910/476</td> <td>PROBST, STEVEN C &</td> <td>04/02/1993</td> <td>9,500</td> <td>Yes</td> </tr> <tr> <td>897/516</td> <td>DOHRER, ROGER P &</td> <td>10/30/1992</td> <td>11,500</td> <td>Yes</td> </tr> </tbody> </table>					Bk/Pg	Grantor	Date	Price	Code	1801/22	TREVINO, DELIA	08/22/2006	150,000	YES	1346/116	CUMMINS, SUZANNE ELIZABETH	12/28/2001	0	16	1356/851	MCDRUMMOND, SUZANNE & PHIL	12/18/2001	120,000	YES	920/874	ROLAND & ASSOCIATES	06/25/1993	91,780	Yes	910/476	PROBST, STEVEN C &	04/02/1993	9,500	Yes	897/516	DOHRER, ROGER P &	10/30/1992	11,500	Yes																																																																			
Code	Type	Active	Maximum	Exemption																																																																																																																					
H	Homestead	Yes	1,000	1,000																																																																																																																					
Bk/Pg	Grantor	Date	Price	Code																																																																																																																					
1801/22	TREVINO, DELIA	08/22/2006	150,000	YES																																																																																																																					
1346/116	CUMMINS, SUZANNE ELIZABETH	12/28/2001	0	16																																																																																																																					
1356/851	MCDRUMMOND, SUZANNE & PHIL	12/18/2001	120,000	YES																																																																																																																					
920/874	ROLAND & ASSOCIATES	06/25/1993	91,780	Yes																																																																																																																					
910/476	PROBST, STEVEN C &	04/02/1993	9,500	Yes																																																																																																																					
897/516	DOHRER, ROGER P &	10/30/1992	11,500	Yes																																																																																																																					
Parcel Valuation <table border="1"> <thead> <tr> <th>Source</th> <th>REAL</th> <th>Fair Cash</th> <th>Capped</th> <th>Asmnt Level</th> <th>Assessed</th> <th>Levy Rate</th> <th>106.442</th> <th>Current Tax</th> </tr> </thead> <tbody> <tr> <td>Remove Cap</td> <td>2007</td> <td>Land Value 85,997</td> <td>30,325</td> <td>11%</td> <td>3,336</td> <td>Assessed</td> <td>22,064</td> <td>2,348.53</td> </tr> <tr> <td>Year Frozen</td> <td>0</td> <td>Improvements 197,482</td> <td>170,251</td> <td></td> <td>18,728</td> <td>Penalty</td> <td>0</td> <td></td> </tr> <tr> <td>Uncapped Value</td> <td>0</td> <td>Mobile Home 0</td> <td>0</td> <td></td> <td>0</td> <td>Exemption</td> <td>1,000</td> <td>-93.00</td> </tr> <tr> <td>TIF Project ID</td> <td>0</td> <td>Total Value 283,479</td> <td>200,576</td> <td></td> <td>22,064</td> <td>Total Taxable</td> <td>21,064</td> <td>2,256.00</td> </tr> </tbody> </table>										Source	REAL	Fair Cash	Capped	Asmnt Level	Assessed	Levy Rate	106.442	Current Tax	Remove Cap	2007	Land Value 85,997	30,325	11%	3,336	Assessed	22,064	2,348.53	Year Frozen	0	Improvements 197,482	170,251		18,728	Penalty	0		Uncapped Value	0	Mobile Home 0	0		0	Exemption	1,000	-93.00	TIF Project ID	0	Total Value 283,479	200,576		22,064	Total Taxable	21,064	2,256.00																																																																			
Source	REAL	Fair Cash	Capped	Asmnt Level	Assessed	Levy Rate	106.442	Current Tax																																																																																																																	
Remove Cap	2007	Land Value 85,997	30,325	11%	3,336	Assessed	22,064	2,348.53																																																																																																																	
Year Frozen	0	Improvements 197,482	170,251		18,728	Penalty	0																																																																																																																		
Uncapped Value	0	Mobile Home 0	0		0	Exemption	1,000	-93.00																																																																																																																	
TIF Project ID	0	Total Value 283,479	200,576		22,064	Total Taxable	21,064	2,256.00																																																																																																																	
Assessment History <table border="1"> <thead> <tr> <th>Tax Year</th> <th>Statement Number</th> <th>Billed Owner</th> <th>Tax Area</th> <th>Total Value</th> <th>Exemptions</th> <th>Taxable Value</th> <th>Billed Tax</th> </tr> </thead> <tbody> <tr><td>2025</td><td>2025-660012682</td><td>BIGGAM, MICHAEL &</td><td>8</td><td>280,895</td><td>1000</td><td>20,421</td><td>2,188.00</td></tr> <tr><td>2024</td><td>2024-660012682</td><td>BIGGAM, MICHAEL &</td><td>8</td><td>277,270</td><td>1000</td><td>19,797</td><td>2,121.00</td></tr> <tr><td>2023</td><td>2023-660012682</td><td>BIGGAM, MICHAEL &</td><td>8</td><td>183,557</td><td>1000</td><td>19,191</td><td>2,041.00</td></tr> <tr><td>2022</td><td>2022-660012682</td><td>BIGGAM, MICHAEL &</td><td>8</td><td>187,824</td><td>1000</td><td>19,661</td><td>2,103.00</td></tr> <tr><td>2021</td><td>2021-660012682</td><td>BIGGAM, MICHAEL &</td><td>8</td><td>184,639</td><td>1000</td><td>19,310</td><td>1,981.00</td></tr> <tr><td>2020</td><td>2020-660012682</td><td>BIGGAM, MICHAEL &</td><td>8</td><td>181,623</td><td>1000</td><td>18,740</td><td>1,993.00</td></tr> <tr><td>2019</td><td>2019-660012682</td><td>BIGGAM, MICHAEL &</td><td>8</td><td>174,228</td><td>1000</td><td>18,165</td><td>1,952.00</td></tr> <tr><td>2018</td><td>2018-660012682</td><td>BIGGAM, MICHAEL &</td><td>8</td><td>175,076</td><td>1000</td><td>18,258</td><td>1,959.00</td></tr> <tr><td>2017</td><td>2017-660012682</td><td>BIGGAM, MICHAEL &</td><td>8</td><td>173,667</td><td>1000</td><td>18,103</td><td>1,911.00</td></tr> <tr><td>2016</td><td>2016-660012682</td><td>BIGGAM, MICHAEL &</td><td>8</td><td>169,080</td><td>1000</td><td>17,599</td><td>1,912.00</td></tr> <tr><td>2015</td><td>2015-660012682</td><td>BIGGAM, MICHAEL &</td><td>8</td><td>165,138</td><td>1000</td><td>17,165</td><td>1,779.00</td></tr> <tr><td>2014</td><td>2014-660012682</td><td>BIGGAM, MICHAEL &</td><td>8</td><td>166,495</td><td>1000</td><td>16,775</td><td>1,765.00</td></tr> <tr><td>2013</td><td>2013-660012682</td><td>BIGGAM, MICHAEL &</td><td>8</td><td>156,885</td><td>1000</td><td>16,257</td><td>1,686.00</td></tr> </tbody> </table>										Tax Year	Statement Number	Billed Owner	Tax Area	Total Value	Exemptions	Taxable Value	Billed Tax	2025	2025-660012682	BIGGAM, MICHAEL &	8	280,895	1000	20,421	2,188.00	2024	2024-660012682	BIGGAM, MICHAEL &	8	277,270	1000	19,797	2,121.00	2023	2023-660012682	BIGGAM, MICHAEL &	8	183,557	1000	19,191	2,041.00	2022	2022-660012682	BIGGAM, MICHAEL &	8	187,824	1000	19,661	2,103.00	2021	2021-660012682	BIGGAM, MICHAEL &	8	184,639	1000	19,310	1,981.00	2020	2020-660012682	BIGGAM, MICHAEL &	8	181,623	1000	18,740	1,993.00	2019	2019-660012682	BIGGAM, MICHAEL &	8	174,228	1000	18,165	1,952.00	2018	2018-660012682	BIGGAM, MICHAEL &	8	175,076	1000	18,258	1,959.00	2017	2017-660012682	BIGGAM, MICHAEL &	8	173,667	1000	18,103	1,911.00	2016	2016-660012682	BIGGAM, MICHAEL &	8	169,080	1000	17,599	1,912.00	2015	2015-660012682	BIGGAM, MICHAEL &	8	165,138	1000	17,165	1,779.00	2014	2014-660012682	BIGGAM, MICHAEL &	8	166,495	1000	16,775	1,765.00	2013	2013-660012682	BIGGAM, MICHAEL &	8	156,885	1000	16,257	1,686.00
Tax Year	Statement Number	Billed Owner	Tax Area	Total Value	Exemptions	Taxable Value	Billed Tax																																																																																																																		
2025	2025-660012682	BIGGAM, MICHAEL &	8	280,895	1000	20,421	2,188.00																																																																																																																		
2024	2024-660012682	BIGGAM, MICHAEL &	8	277,270	1000	19,797	2,121.00																																																																																																																		
2023	2023-660012682	BIGGAM, MICHAEL &	8	183,557	1000	19,191	2,041.00																																																																																																																		
2022	2022-660012682	BIGGAM, MICHAEL &	8	187,824	1000	19,661	2,103.00																																																																																																																		
2021	2021-660012682	BIGGAM, MICHAEL &	8	184,639	1000	19,310	1,981.00																																																																																																																		
2020	2020-660012682	BIGGAM, MICHAEL &	8	181,623	1000	18,740	1,993.00																																																																																																																		
2019	2019-660012682	BIGGAM, MICHAEL &	8	174,228	1000	18,165	1,952.00																																																																																																																		
2018	2018-660012682	BIGGAM, MICHAEL &	8	175,076	1000	18,258	1,959.00																																																																																																																		
2017	2017-660012682	BIGGAM, MICHAEL &	8	173,667	1000	18,103	1,911.00																																																																																																																		
2016	2016-660012682	BIGGAM, MICHAEL &	8	169,080	1000	17,599	1,912.00																																																																																																																		
2015	2015-660012682	BIGGAM, MICHAEL &	8	165,138	1000	17,165	1,779.00																																																																																																																		
2014	2014-660012682	BIGGAM, MICHAEL &	8	166,495	1000	16,775	1,765.00																																																																																																																		
2013	2013-660012682	BIGGAM, MICHAEL &	8	156,885	1000	16,257	1,686.00																																																																																																																		



Rogers

Assessment Property Record Card for Tax Year 2026

Data provided by LISA DELOZIER County Assessor

Date 04/17/2026
 Time 08:54:22
 Page 2

Lot Data	Square-Foot - NBHD 1209 #1	Primary Image
Lot Size		
Lot Count		
Units Buildable	1	
Non-Ag Acres	1.2491	
Topography		
Street Access		
Utilities		
Amenities	LAND QUALITY	
	0	
	0	
Method	Square-Foot	
Base Lot Value	54,409.00 x 1.58 = 85,997	
Factor Value		
Adjustments	1.0000	
Lot Value	85,997	

Residential Data	
Type	1 Single Family Residence
Condition	3 - Average
Quality	3.5 - Average
Architecture	
Style	100% 1 1/2 Story Finished
Exterior Wall	100% Frame, Siding, Vinyl
Base/Total Area	1,182 / 2,256
Style	100% 1 1/2 Story Finished
HVAC	100% Forced Air Furnace
Roof Cover	1 Composition Shingle
Area on Slab	1,182
Fixture/RghIn	11 /
Bed/F/H Bath	3 / 2.0 /
Basement Area	
Garage Type	440 Attached Garage - Unfinished
Remodel	
Year/Eff Age	1993 / 25

\\tsclient\C\Users\Randy Necessary\Pictures\101_0719\IMG_0022. 7/20/2022

GRM Approach	
GRM Code	
Gross Rent	0.00
Indicated Value	

Multiple Regression			
MRA Code	1	Test	
Adjusted R	0.8445		
Indicated Value	273,173	121.09	Per SqFt

Direct Comparables	
Selection Model	A Adam Test
Adjustment Model	1 2022 Residential
Comparables	6
Indicated Value	253,760 Per SqFt

Cost Approach				Manual : 01/2025			
Base Cost	93.22	Total Misc Impr	+	11,628			
Roofing Adj	+ 3.16	Garage Cost	+	18,106			
Subfloor Adj	+ -2.02	Total RCN	=	276,225			
Heat/Cool Adj	+ 7.03	Depreciation (31%)	-	85,630			
Plumbing Adj	+ 7.87	Lump Sums	+	6,887			
Basement Adj	+ 0.00	RCNLD	=	197,482			
Adj Base Cost	= 109.26	Lot Value	+	85,997			
Total Area	x 2,256	Indicated Value	=	283,479			
Adjusted Cost	= 246,491	Value Per SqFt		125.66			

Value Reconciliation			
Selected Approach	Cost Approach		
Improvements	197,482		
Lot Value	85,997		
Indicated Value	283,479	125.66	Per SqFt
Agland Value			
Site Improvements			
Total Value	283,479	125.66	Total Value Per SqFt

Miscellaneous Improvements								
Code	Description	Sketch ID	Size	Year	Units	Unit Cost	Depr	Value
FPR1	FIREPLACE - RESIDENTIAL 1 STORY	0		1	1	6,429.63		6,430
PRCH	SLAB PORCH - COVERED	30700		180	180	28.88		5,198
WODO	WOOD DECK - OPEN	139825	20x18		360	19.13		6,887



Rogers

Assessment Property Record Card for Tax Year 2026

Data provided by LISA DELOZIER County Assessor

Date 04/17/2026
 Time 08:54:22
 Page 3

Sketch Image

660012682

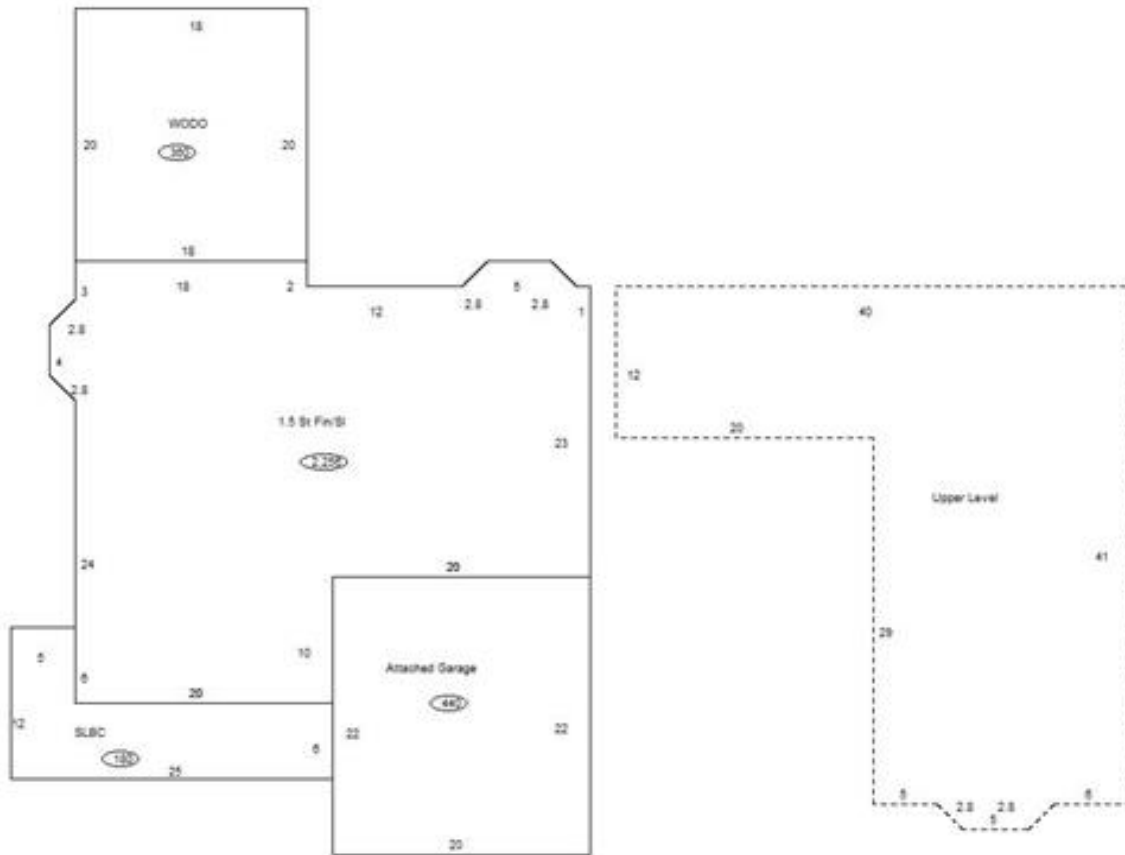

Sketch Vector Information

Sequence	Code	Type	Built Over	Scale	Section Label	Base Area	Multiplier	Total Area
1	R	5	Slab	10	1.5 St Fin/SI	1,182	1.909	2,256
2	G	1		10	Attached Garage	440	1.000	440
3	M	PRCH		10	SLBC	180	1.000	180
4	U	^UL	Overhang	10	Upper Level	1,074	1.000	1,074
5	M	WODO		10	WODO	360	1.000	360
Total Building Area						1,182		2,256



Rogers



Assessment Property Record Card for Tax Year 2026

Data provided by LISA DELOZIER County Assessor

Date 04/17/2026
Time 08:54:22
Page 4

660012682

Outbuildings/Site Improvements

Building Image	Code	Description	Dimensions	Floor	Roofing	Total Units
	STF	STG FAIR	0x0x0			
	Qual 2	Cond 1	Year	Eff Age	2836	
	Valuation Summary		Modifier Total	RCN	Depr (100% Phys/ % Func)	RCNLD
	Base Cost (4.68 x)					
	STF	STG FAIR	0x0x0			
	Qual 2	Cond 3	Year	Eff Age	1520	
	Valuation Summary		Modifier Total	RCN	Depr (100% Phys/ % Func)	RCNLD
	Base Cost (4.68 x)					