



# Rogers

## Assessment Property Record Card for Tax Year 2026

Data provided by LISA DELOZIER County Assessor

Date 04/16/2026  
Time 23:11:10  
Page 1

Assessment Data					Primary Image																																																																																																																				
<b>Account</b> 660012773 <b>Parcel ID</b> 000000-00-0-00159-001-0025 <b>Cadastral ID</b> 12-21-17-02140 <b>Property Type</b> REAL - Real Property <b>Property Class</b> RRP VI Area 3 <b>Tax Area</b> 94 - SEQUOYAH/TRI-DISTRICT FI <b>Name ID</b> 309532 KUHLENSCHMIDT, ROY F & LAVENA L  21052 E ROBIN WAY CLAREMORE OK 74019-0000  <b>Parcel Location</b> <b>Situs</b> 20805 S 4240 RD <b>Subdivision</b> CIRCLE H RANCH <b>Lot/Block</b> 0025 / 0001 <b>Parcel Size</b> 1 - Lots <b>Sec/Twn/Rng</b> 12 / 21 / 17 / 5 <b>Neighborhood</b> 1215 - R-V03-SE SEQUOYAH <b>School District</b> S006 - SEQUOYAH SCHOOLS					<p>660012773_001.JPG 1/18/2026</p>																																																																																																																				
<b>Legal Description</b> Lot/Long: 36.31046929 -95.45278603																																																																																																																									
<b>Building Permits</b>					<table border="1"> <thead> <tr> <th>Number</th> <th>Description</th> <th>Opened</th> <th>Closed</th> <th>Amount</th> </tr> </thead> <tbody> <tr> <td colspan="5"> </td> </tr> </tbody> </table>					Number	Description	Opened	Closed	Amount																																																																																																											
Number	Description	Opened	Closed	Amount																																																																																																																					
<b>Exemptions</b>					<b>Sale History</b>																																																																																																																				
<table border="1"> <thead> <tr> <th>Code</th> <th>Type</th> <th>Active</th> <th>Maximum</th> <th>Exemption</th> </tr> </thead> <tbody> <tr> <td>H</td> <td>Homestead</td> <td>No</td> <td>1,000</td> <td></td> </tr> </tbody> </table>					Code	Type	Active	Maximum	Exemption	H	Homestead	No	1,000		<table border="1"> <thead> <tr> <th>Bk/Pg</th> <th>Grantor</th> <th>Date</th> <th>Price</th> <th>Code</th> </tr> </thead> <tbody> <tr> <td>/</td> <td>HIXSON, SHEILA A</td> <td>01/07/2022</td> <td>15,000</td> <td>YES</td> </tr> <tr> <td>996/126</td> <td>HIXSON, MICHAEL T &amp;</td> <td>07/20/1995</td> <td>33,000</td> <td>No</td> </tr> <tr> <td>879/139</td> <td>ALEXANDER, W OWEN</td> <td>04/13/1992</td> <td>33,000</td> <td>No</td> </tr> </tbody> </table>					Bk/Pg	Grantor	Date	Price	Code	/	HIXSON, SHEILA A	01/07/2022	15,000	YES	996/126	HIXSON, MICHAEL T &	07/20/1995	33,000	No	879/139	ALEXANDER, W OWEN	04/13/1992	33,000	No																																																																																		
Code	Type	Active	Maximum	Exemption																																																																																																																					
H	Homestead	No	1,000																																																																																																																						
Bk/Pg	Grantor	Date	Price	Code																																																																																																																					
/	HIXSON, SHEILA A	01/07/2022	15,000	YES																																																																																																																					
996/126	HIXSON, MICHAEL T &	07/20/1995	33,000	No																																																																																																																					
879/139	ALEXANDER, W OWEN	04/13/1992	33,000	No																																																																																																																					
<b>Parcel Valuation</b>																																																																																																																									
<table border="1"> <thead> <tr> <th>Source</th> <th>REAL</th> <th>Fair Cash</th> <th>Capped</th> <th>Asmnt Level</th> <th>Assessed</th> <th>Levy Rate</th> <th>98.320</th> <th>Current Tax</th> </tr> </thead> <tbody> <tr> <td>Remove Cap</td> <td>2023</td> <td>Land Value 16,108</td> <td>16,108</td> <td>11%</td> <td>1,772</td> <td>Assessed</td> <td>1,772</td> <td>174.22</td> </tr> <tr> <td>Year Frozen</td> <td>0</td> <td>Improvements 0</td> <td>0</td> <td></td> <td>0</td> <td>Penalty</td> <td>0</td> <td></td> </tr> <tr> <td>Uncapped Value</td> <td>0</td> <td>Mobile Home 0</td> <td>0</td> <td></td> <td>0</td> <td>Exemption</td> <td>0</td> <td>0.00</td> </tr> <tr> <td>TIF Project ID</td> <td>0</td> <td>Total Value 16,108</td> <td>16,108</td> <td></td> <td>1,772</td> <td>Total Taxable</td> <td>1,772</td> <td>174.00</td> </tr> </tbody> </table>		Source	REAL	Fair Cash	Capped	Asmnt Level	Assessed	Levy Rate	98.320	Current Tax	Remove Cap	2023	Land Value 16,108	16,108	11%	1,772	Assessed	1,772	174.22	Year Frozen	0	Improvements 0	0		0	Penalty	0		Uncapped Value	0	Mobile Home 0	0		0	Exemption	0	0.00	TIF Project ID	0	Total Value 16,108	16,108		1,772	Total Taxable	1,772	174.00																																																																											
Source	REAL	Fair Cash	Capped	Asmnt Level	Assessed	Levy Rate	98.320	Current Tax																																																																																																																	
Remove Cap	2023	Land Value 16,108	16,108	11%	1,772	Assessed	1,772	174.22																																																																																																																	
Year Frozen	0	Improvements 0	0		0	Penalty	0																																																																																																																		
Uncapped Value	0	Mobile Home 0	0		0	Exemption	0	0.00																																																																																																																	
TIF Project ID	0	Total Value 16,108	16,108		1,772	Total Taxable	1,772	174.00																																																																																																																	
<b>Assessment History</b>																																																																																																																									
<table border="1"> <thead> <tr> <th>Tax Year</th> <th>Statement Number</th> <th>Billed Owner</th> <th>Tax Area</th> <th>Total Value</th> <th>Exemptions</th> <th>Taxable Value</th> <th>Billed Tax</th> </tr> </thead> <tbody> <tr><td>2025</td><td>2025-660012773</td><td>KUHLENSCHMIDT, ROY F &amp;</td><td>94</td><td>16,108</td><td>0</td><td>1,772</td><td>175.00</td></tr> <tr><td>2024</td><td>2024-660012773</td><td>KUHLENSCHMIDT, ROY F &amp;</td><td>94</td><td>29,987</td><td>0</td><td>1,732</td><td>182.00</td></tr> <tr><td>2023</td><td>2023-660012773</td><td>KUHLENSCHMIDT, ROY F &amp;</td><td>94</td><td>15,000</td><td>0</td><td>1,650</td><td>176.00</td></tr> <tr><td>2022</td><td>2022-660012773</td><td>KUHLENSCHMIDT, ROY F &amp;</td><td>94</td><td>39,543</td><td>1000</td><td>3,214</td><td>362.00</td></tr> <tr><td>2021</td><td>2021-660012773</td><td>HIXSON, SHEILA A</td><td>94</td><td>42,839</td><td>1000</td><td>3,091</td><td>338.00</td></tr> <tr><td>2020</td><td>2020-660012773</td><td>HIXSON, SHEILA A</td><td>94</td><td>42,313</td><td>1000</td><td>2,972</td><td>323.00</td></tr> <tr><td>2019</td><td>2019-660012773</td><td>HIXSON, SHEILA A</td><td>94</td><td>40,739</td><td>1000</td><td>2,856</td><td>306.00</td></tr> <tr><td>2018</td><td>2018-660012773</td><td>HIXSON, SHEILA A</td><td>94</td><td>40,983</td><td>1000</td><td>2,744</td><td>298.00</td></tr> <tr><td>2017</td><td>2017-660012773</td><td>HIXSON, SHEILA A</td><td>94</td><td>40,735</td><td>1000</td><td>2,635</td><td>282.00</td></tr> <tr><td>2016</td><td>2016-660012773</td><td>HIXSON, SHEILA A</td><td>94</td><td>39,950</td><td>1000</td><td>2,529</td><td>271.00</td></tr> <tr><td>2015</td><td>2015-660012773</td><td>HIXSON, SHEILA A</td><td>94</td><td>39,288</td><td>1000</td><td>2,426</td><td>266.00</td></tr> <tr><td>2014</td><td>2014-660012773</td><td>HIXSON, SHEILA A</td><td>94</td><td>39,516</td><td>1000</td><td>2,327</td><td>248.00</td></tr> <tr><td>2013</td><td>2013-660012773</td><td>HIXSON, SHEILA A</td><td>94</td><td>38,395</td><td>1000</td><td>2,230</td><td>234.00</td></tr> </tbody> </table>										Tax Year	Statement Number	Billed Owner	Tax Area	Total Value	Exemptions	Taxable Value	Billed Tax	2025	2025-660012773	KUHLENSCHMIDT, ROY F &	94	16,108	0	1,772	175.00	2024	2024-660012773	KUHLENSCHMIDT, ROY F &	94	29,987	0	1,732	182.00	2023	2023-660012773	KUHLENSCHMIDT, ROY F &	94	15,000	0	1,650	176.00	2022	2022-660012773	KUHLENSCHMIDT, ROY F &	94	39,543	1000	3,214	362.00	2021	2021-660012773	HIXSON, SHEILA A	94	42,839	1000	3,091	338.00	2020	2020-660012773	HIXSON, SHEILA A	94	42,313	1000	2,972	323.00	2019	2019-660012773	HIXSON, SHEILA A	94	40,739	1000	2,856	306.00	2018	2018-660012773	HIXSON, SHEILA A	94	40,983	1000	2,744	298.00	2017	2017-660012773	HIXSON, SHEILA A	94	40,735	1000	2,635	282.00	2016	2016-660012773	HIXSON, SHEILA A	94	39,950	1000	2,529	271.00	2015	2015-660012773	HIXSON, SHEILA A	94	39,288	1000	2,426	266.00	2014	2014-660012773	HIXSON, SHEILA A	94	39,516	1000	2,327	248.00	2013	2013-660012773	HIXSON, SHEILA A	94	38,395	1000	2,230	234.00
Tax Year	Statement Number	Billed Owner	Tax Area	Total Value	Exemptions	Taxable Value	Billed Tax																																																																																																																		
2025	2025-660012773	KUHLENSCHMIDT, ROY F &	94	16,108	0	1,772	175.00																																																																																																																		
2024	2024-660012773	KUHLENSCHMIDT, ROY F &	94	29,987	0	1,732	182.00																																																																																																																		
2023	2023-660012773	KUHLENSCHMIDT, ROY F &	94	15,000	0	1,650	176.00																																																																																																																		
2022	2022-660012773	KUHLENSCHMIDT, ROY F &	94	39,543	1000	3,214	362.00																																																																																																																		
2021	2021-660012773	HIXSON, SHEILA A	94	42,839	1000	3,091	338.00																																																																																																																		
2020	2020-660012773	HIXSON, SHEILA A	94	42,313	1000	2,972	323.00																																																																																																																		
2019	2019-660012773	HIXSON, SHEILA A	94	40,739	1000	2,856	306.00																																																																																																																		
2018	2018-660012773	HIXSON, SHEILA A	94	40,983	1000	2,744	298.00																																																																																																																		
2017	2017-660012773	HIXSON, SHEILA A	94	40,735	1000	2,635	282.00																																																																																																																		
2016	2016-660012773	HIXSON, SHEILA A	94	39,950	1000	2,529	271.00																																																																																																																		
2015	2015-660012773	HIXSON, SHEILA A	94	39,288	1000	2,426	266.00																																																																																																																		
2014	2014-660012773	HIXSON, SHEILA A	94	39,516	1000	2,327	248.00																																																																																																																		
2013	2013-660012773	HIXSON, SHEILA A	94	38,395	1000	2,230	234.00																																																																																																																		



# Rogers

## Assessment Property Record Card for Tax Year 2026

Data provided by LISA DELOZIER County Assessor

Date 04/16/2026  
Time 23:11:10  
Page 2

Lot Data	Square-Foot - NBHD 1215 #1	Primary Image
<b>Lot Size</b> <b>Lot Count</b> <b>Units Buildable</b> 1 <b>Non-Ag Acres</b> 2.1649 <b>Topography</b> <b>Street Access</b> <b>Utilities</b> <b>Amenities</b> HYW FRONTAGE 0 0 <b>Method</b> Square-Foot <b>Base Lot Value</b> 94,304.00 x .17 = 16,108 <b>Factor Value</b> <b>Adjustments</b> 1.0000 <b>Lot Value</b> 16,108		

Residential Data	
<b>Type</b>	1 Single Family Residence
<b>Condition</b>	3 - Average
<b>Quality</b>	1 - Low
<b>Architecture</b>	TRAD TRADITIONAL
<b>Style</b>	100% One Story
<b>Exterior Wall</b>	100% Veneer, Masonry
<b>Base/Total Area</b>	1,180 / 1,180
<b>Style</b>	100% One Story
<b>HVAC</b>	100% Warmed & Cooled Air
<b>Roof Cover</b>	1 Composition Shingle
<b>Area on Slab</b>	0
<b>Fixture/RghIn</b>	7 /
<b>Bed/F/H Bath</b>	2 / 1.0 /
<b>Basement Area</b>	
<b>Garage Type</b>	
<b>Remodel</b>	
<b>Year/Eff Age</b>	1950 / 101

660012773	12/17/25
660012773_001.JPG	1/18/2026

GRM Approach	
<b>GRM Code</b>	
<b>Gross Rent</b>	0.00
<b>Indicated Value</b>	

Multiple Regression			
<b>MRA Code</b>	1	Test	
<b>Adusted R</b>	0.8445		
<b>Indicated Value</b>	30,759	26.07	Per SqFt

Direct Comparables			
<b>Selection Model</b>	A	Adam Test	
<b>Adjustment Model</b>	1	2022 Residential	
<b>Comparables</b>	1		
<b>Indicated Value</b>	15,890		Per SqFt

Value Reconciliation			
<b>Selected Approach</b>	Cost Approach		
<b>Improvements</b>			
<b>Lot Value</b>	16,108		
<b>Indicated Value</b>	16,108	13.65	Per SqFt
<b>Agland Value</b>			
<b>Site Improvements</b>			
<b>Total Value</b>	16,108	13.65	Total Value Per SqFt

Cost Approach				Manual : 01/2025			
<b>Base Cost</b>	92.93	<b>Total Misc Impr</b>	+	14,759			
<b>Roofing Adj</b>	+ 3.95	<b>Garage Cost</b>	+				
<b>Subfloor Adj</b>	+ 2.45	<b>Total RCN</b>	=	150,789			
<b>Heat/Cool Adj</b>	+ 9.48	<b>Depreciation ( 100%)</b>	-	150,789			
<b>Plumbing Adj</b>	+ 6.47	<b>Lump Sums</b>	+	0			
<b>Basement Adj</b>	+ 0.00	<b>RCNLD</b>	=				
<b>Adj Base Cost</b>	= 115.28	<b>Lot Value</b>	+	16,108			
<b>Total Area</b>	x 1,180	<b>Indicated Value</b>	=	16,108			
<b>Adjusted Cost</b>	= 136,030	<b>Value Per SqFt</b>		13.65			

Miscellaneous Improvements								
Code	Description	Sketch ID	Size	Year	Units	Unit Cost	Depr	Value
PRCH	SLAB PORCH - COVERED	30915	11x7		77	18.21		1,402
EPSW	ENCLOSED PORCH - SOLID WALL	30916	24x12		288	46.38		13,357



# Rogers

## Assessment Property Record Card for Tax Year 2026

Data provided by LISA DELOZIER County Assessor

Date 04/16/2026  
 Time 23:11:10  
 Page 3

Sketch Image

660012773

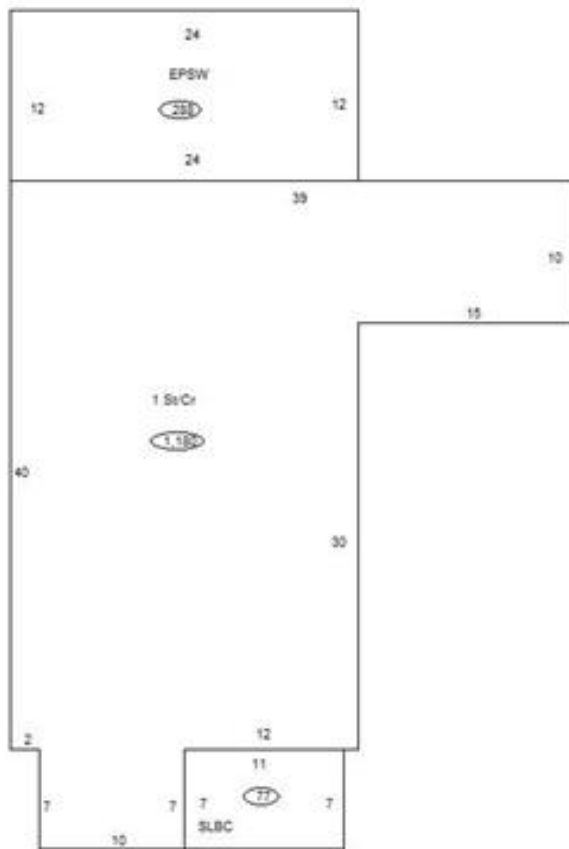

### Sketch Vector Information

Sequence	Code	Type	Built Over	Scale	Section Label	Base Area	Multiplier	Total Area
1	R	1	Crawl	10	1 St/Cr	1,180	1.000	1,180
2	M	PRCH		10	SLBC	77	1.000	77
3	M	EPSW		10	EPSW	288	1.000	288
<b>Total Building Area</b>						<b>1,180</b>		<b>1,180</b>



# Rogers

## Assessment Property Record Card for Tax Year 2026

Data provided by LISA DELOZIER County Assessor

Date 04/16/2026  
Time 23:11:10  
Page 4

660012773

### Outbuildings/Site Improvements

Building Image	Code	Description	Dimensions	Floor	Roofing	Total Units
	BNV	CARPORT - DETACHED	15x26x0			390
	Qual 2	Cond 1	Year 2000	Eff Age		
<b>Valuation Summary</b>		<b>Modifier Total</b>	<b>RCN</b>	<b>Depr (100% Phys/ % Func)</b>	<b>RCNLD</b>	
Base Cost (0.00 x 390)						