



Rogers

Assessment Property Record Card for Tax Year 2026

Data provided by LISA DELOZIER County Assessor

Date 04/16/2026
Time 21:28:02
Page 1

Assessment Data					Primary Image																																																																																																																				
Account 660013102 Parcel ID 000000-00-0-00783-001-0004 Cadastral ID 13-21-14-01440 Property Type REAL - Real Property Property Class RRP VI Area 4 Tax Area 7 - OWASSO/LIMESTONE FIRE Name ID 344520 SHADE, JUDY A & KAREN SHADE-LANIER & JIMMY LANIER 10402 ASHFORD CIR OWASSO OK 74055-0000																																																																																																																									
Parcel Location Situs 10402 ASHFORD CIR Subdivision STONEBRIDGE ESTATES II Lot/Block 0004 / 0001 Parcel Size 1 - Lots Sec/Twn/Rng 13 / 21 / 14 / 5 Neighborhood 1027 - R-V04-SW OWASSO School District S021 - OWASSO SCHOOLS																																																																																																																									
Legal Description Lot/Long: 36.30642954 -95.76716565 LOT 4 BLOCK 1 STONEBRIDGE EST 2					Building Permits <table border="1"> <thead> <tr> <th>Number</th> <th>Description</th> <th>Opened</th> <th>Closed</th> <th>Amount</th> </tr> </thead> <tbody> <tr> <td>R2013 09 18</td> <td>R14-NEW 768 SQ FT DETACH GARAGI</td> <td>09/2013</td> <td>12/2013</td> <td>20,000</td> </tr> </tbody> </table>					Number	Description	Opened	Closed	Amount	R2013 09 18	R14-NEW 768 SQ FT DETACH GARAGI	09/2013	12/2013	20,000																																																																																																						
Number	Description	Opened	Closed	Amount																																																																																																																					
R2013 09 18	R14-NEW 768 SQ FT DETACH GARAGI	09/2013	12/2013	20,000																																																																																																																					
Exemptions <table border="1"> <thead> <tr> <th>Code</th> <th>Type</th> <th>Active</th> <th>Maximum</th> <th>Exemption</th> </tr> </thead> <tbody> <tr> <td>HV</td> <td>Veteran</td> <td>No</td> <td>999,999</td> <td></td> </tr> </tbody> </table>					Code	Type	Active	Maximum	Exemption	HV	Veteran	No	999,999		Sale History <table border="1"> <thead> <tr> <th>Bk/Pg</th> <th>Grantor</th> <th>Date</th> <th>Price</th> <th>Code</th> </tr> </thead> <tbody> <tr> <td>/</td> <td>BLACKBURN, RODNEY S</td> <td>06/05/2024</td> <td>385,000</td> <td>YES</td> </tr> <tr> <td>/</td> <td>BRYANT, JOHN</td> <td>07/27/2018</td> <td>255,000</td> <td>YES</td> </tr> <tr> <td>2336/941</td> <td>THURMAN, JOHN DEWITT &</td> <td>06/26/2013</td> <td>175,330</td> <td>17</td> </tr> <tr> <td>881/282</td> <td>BURKS, BRAD D &</td> <td>05/07/1992</td> <td>115,000</td> <td>Yes</td> </tr> </tbody> </table>					Bk/Pg	Grantor	Date	Price	Code	/	BLACKBURN, RODNEY S	06/05/2024	385,000	YES	/	BRYANT, JOHN	07/27/2018	255,000	YES	2336/941	THURMAN, JOHN DEWITT &	06/26/2013	175,330	17	881/282	BURKS, BRAD D &	05/07/1992	115,000	Yes																																																																													
Code	Type	Active	Maximum	Exemption																																																																																																																					
HV	Veteran	No	999,999																																																																																																																						
Bk/Pg	Grantor	Date	Price	Code																																																																																																																					
/	BLACKBURN, RODNEY S	06/05/2024	385,000	YES																																																																																																																					
/	BRYANT, JOHN	07/27/2018	255,000	YES																																																																																																																					
2336/941	THURMAN, JOHN DEWITT &	06/26/2013	175,330	17																																																																																																																					
881/282	BURKS, BRAD D &	05/07/1992	115,000	Yes																																																																																																																					
Parcel Valuation <table border="1"> <thead> <tr> <th>Source</th> <th>REAL</th> <th>Fair Cash</th> <th>Capped</th> <th>Asmnt Level</th> <th>Assessed</th> <th>Levy Rate</th> <th>108.538</th> <th>Current Tax</th> </tr> </thead> <tbody> <tr> <td>Remove Cap</td> <td>2025</td> <td>Land Value</td> <td>131,532</td> <td>131,532</td> <td>11%</td> <td>14,469</td> <td>Assessed</td> <td>42,805</td> <td>4,645.97</td> </tr> <tr> <td>Year Frozen</td> <td>0</td> <td>Improvements</td> <td>257,600</td> <td>257,600</td> <td></td> <td>28,336</td> <td>Penalty</td> <td>0</td> <td></td> </tr> <tr> <td>Uncapped Value</td> <td>0</td> <td>Mobile Home</td> <td>0</td> <td>0</td> <td></td> <td>0</td> <td>Exemption</td> <td>0</td> <td>0.00</td> </tr> <tr> <td>TIF Project ID</td> <td>0</td> <td>Total Value</td> <td>389,132</td> <td>389,132</td> <td></td> <td>42,805</td> <td>Total Taxable</td> <td>42,805</td> <td>4,646.00</td> </tr> </tbody> </table>										Source	REAL	Fair Cash	Capped	Asmnt Level	Assessed	Levy Rate	108.538	Current Tax	Remove Cap	2025	Land Value	131,532	131,532	11%	14,469	Assessed	42,805	4,645.97	Year Frozen	0	Improvements	257,600	257,600		28,336	Penalty	0		Uncapped Value	0	Mobile Home	0	0		0	Exemption	0	0.00	TIF Project ID	0	Total Value	389,132	389,132		42,805	Total Taxable	42,805	4,646.00																																																															
Source	REAL	Fair Cash	Capped	Asmnt Level	Assessed	Levy Rate	108.538	Current Tax																																																																																																																	
Remove Cap	2025	Land Value	131,532	131,532	11%	14,469	Assessed	42,805	4,645.97																																																																																																																
Year Frozen	0	Improvements	257,600	257,600		28,336	Penalty	0																																																																																																																	
Uncapped Value	0	Mobile Home	0	0		0	Exemption	0	0.00																																																																																																																
TIF Project ID	0	Total Value	389,132	389,132		42,805	Total Taxable	42,805	4,646.00																																																																																																																
Assessment History <table border="1"> <thead> <tr> <th>Tax Year</th> <th>Statement Number</th> <th>Billed Owner</th> <th>Tax Area</th> <th>Total Value</th> <th>Exemptions</th> <th>Taxable Value</th> <th>Billed Tax</th> </tr> </thead> <tbody> <tr><td>2025</td><td>2025-660013102</td><td>SHADE, JUDY A &</td><td>7</td><td>385,869</td><td>0</td><td>42,446</td><td>4,607.00</td></tr> <tr><td>2024</td><td>2024-660013102</td><td>SHADE, JUDY A &</td><td>7</td><td>393,061</td><td>32396</td><td></td><td>463.00</td></tr> <tr><td>2023</td><td>2023-660013102</td><td>BLACKBURN, RODNEY S</td><td>7</td><td>304,673</td><td>31452</td><td></td><td>449.00</td></tr> <tr><td>2022</td><td>2022-660013102</td><td>BLACKBURN, RODNEY S</td><td>7</td><td>287,364</td><td>1000</td><td>29,536</td><td>3,330.00</td></tr> <tr><td>2021</td><td>2021-660013102</td><td>BLACKBURN, RODNEY S</td><td>7</td><td>269,517</td><td>1000</td><td>28,647</td><td>3,194.00</td></tr> <tr><td>2020</td><td>2020-660013102</td><td>BLACKBURN, RODNEY S</td><td>7</td><td>267,342</td><td>1000</td><td>28,017</td><td>3,120.00</td></tr> <tr><td>2019</td><td>2019-660013102</td><td>BLACKBURN, RODNEY S</td><td>7</td><td>256,111</td><td>1000</td><td>27,172</td><td>3,029.00</td></tr> <tr><td>2018</td><td>2018-660013102</td><td>BLACKBURN, RODNEY S</td><td>7</td><td>222,343</td><td>1000</td><td>23,458</td><td>2,532.00</td></tr> <tr><td>2017</td><td>2017-660013102</td><td>BRYANT, JOHN & DELPHA</td><td>7</td><td>219,939</td><td>1000</td><td>23,193</td><td>2,527.00</td></tr> <tr><td>2016</td><td>2016-660013102</td><td>BRYANT, JOHN & DELPHA</td><td>7</td><td>215,003</td><td>1000</td><td>22,650</td><td>2,470.00</td></tr> <tr><td>2015</td><td>2015-660013102</td><td>BRYANT, JOHN & DELPHA</td><td>7</td><td>209,173</td><td>1000</td><td>22,009</td><td>2,416.00</td></tr> <tr><td>2014</td><td>2014-660013102</td><td>BRYANT, JOHN & DELPHA</td><td>7</td><td>212,811</td><td>1000</td><td>22,409</td><td>2,479.00</td></tr> <tr><td>2013</td><td>2013-660013102</td><td>BRYANT, JOHN & DELPHA</td><td>7</td><td>180,912</td><td>1000</td><td>18,327</td><td>1,993.00</td></tr> </tbody> </table>										Tax Year	Statement Number	Billed Owner	Tax Area	Total Value	Exemptions	Taxable Value	Billed Tax	2025	2025-660013102	SHADE, JUDY A &	7	385,869	0	42,446	4,607.00	2024	2024-660013102	SHADE, JUDY A &	7	393,061	32396		463.00	2023	2023-660013102	BLACKBURN, RODNEY S	7	304,673	31452		449.00	2022	2022-660013102	BLACKBURN, RODNEY S	7	287,364	1000	29,536	3,330.00	2021	2021-660013102	BLACKBURN, RODNEY S	7	269,517	1000	28,647	3,194.00	2020	2020-660013102	BLACKBURN, RODNEY S	7	267,342	1000	28,017	3,120.00	2019	2019-660013102	BLACKBURN, RODNEY S	7	256,111	1000	27,172	3,029.00	2018	2018-660013102	BLACKBURN, RODNEY S	7	222,343	1000	23,458	2,532.00	2017	2017-660013102	BRYANT, JOHN & DELPHA	7	219,939	1000	23,193	2,527.00	2016	2016-660013102	BRYANT, JOHN & DELPHA	7	215,003	1000	22,650	2,470.00	2015	2015-660013102	BRYANT, JOHN & DELPHA	7	209,173	1000	22,009	2,416.00	2014	2014-660013102	BRYANT, JOHN & DELPHA	7	212,811	1000	22,409	2,479.00	2013	2013-660013102	BRYANT, JOHN & DELPHA	7	180,912	1000	18,327	1,993.00
Tax Year	Statement Number	Billed Owner	Tax Area	Total Value	Exemptions	Taxable Value	Billed Tax																																																																																																																		
2025	2025-660013102	SHADE, JUDY A &	7	385,869	0	42,446	4,607.00																																																																																																																		
2024	2024-660013102	SHADE, JUDY A &	7	393,061	32396		463.00																																																																																																																		
2023	2023-660013102	BLACKBURN, RODNEY S	7	304,673	31452		449.00																																																																																																																		
2022	2022-660013102	BLACKBURN, RODNEY S	7	287,364	1000	29,536	3,330.00																																																																																																																		
2021	2021-660013102	BLACKBURN, RODNEY S	7	269,517	1000	28,647	3,194.00																																																																																																																		
2020	2020-660013102	BLACKBURN, RODNEY S	7	267,342	1000	28,017	3,120.00																																																																																																																		
2019	2019-660013102	BLACKBURN, RODNEY S	7	256,111	1000	27,172	3,029.00																																																																																																																		
2018	2018-660013102	BLACKBURN, RODNEY S	7	222,343	1000	23,458	2,532.00																																																																																																																		
2017	2017-660013102	BRYANT, JOHN & DELPHA	7	219,939	1000	23,193	2,527.00																																																																																																																		
2016	2016-660013102	BRYANT, JOHN & DELPHA	7	215,003	1000	22,650	2,470.00																																																																																																																		
2015	2015-660013102	BRYANT, JOHN & DELPHA	7	209,173	1000	22,009	2,416.00																																																																																																																		
2014	2014-660013102	BRYANT, JOHN & DELPHA	7	212,811	1000	22,409	2,479.00																																																																																																																		
2013	2013-660013102	BRYANT, JOHN & DELPHA	7	180,912	1000	18,327	1,993.00																																																																																																																		



Rogers

Assessment Property Record Card for Tax Year 2026

Data provided by LISA DELOZIER County Assessor

Date 04/16/2026
 Time 21:28:02
 Page 2

Lot Data		Square-Foot - NBHD 1027 #1	
Lot Size			
Lot Count	1		
Units Buildable	1		
Non-Ag Acres	1.2956		
Topography			
Street Access			
Utilities			
Amenities	LAND QUALITY		0
	LAKE LOT		0
Method	Square-Foot		
Base Lot Value	56,438.00 x 2.33 = 131,532		
Factor Value			
Adjustments	1.0000		
Lot Value	131,532		



\\tsclient\C\TOMS PC PICS\2018-05-22 05-22-2018\05-22-2018 04 5/23/2018

Residential Data	
Type	1 Single Family Residence
Condition	3 - Average
Quality	3 - Average
Architecture	
Style	100% One Story
Exterior Wall	80% Veneer, Masonry 20% Frame, Siding, Wood
Base/Total Area	2,100 / 2,100
Style	100% One Story
HVAC	100% Warmed & Cooled Air
Roof Cover	1 Composition Shingle
Area on Slab	2,100
Fixture/RghIn	11 /
Bed/F/H Bath	3 / 2.0 /
Basement Area	
Garage Type	624 Attached Garage - Unfinished
Remodel	RMA -
Year/Eff Age	1988 / 19

GRM Approach	
GRM Code	
Gross Rent	0.00
Indicated Value	

Multiple Regression			
MRA Code	1	Test	
Adusted R	0.8445		
Indicated Value	268,368	127.79	Per SqFt

Direct Comparables			
Selection Model	A	Adam Test	
Adjustment Model	1	2022 Residential	
Comparables	6		
Indicated Value	332,840		Per SqFt

Cost Approach		Manual : 01/2025	
Base Cost	104.65	Total Misc Impr	+ 14,421
Roofing Adj	+ 4.64	Garage Cost	+ 18,963
Subfloor Adj	+ -2.19	Total RCN	= 300,357
Heat/Cool Adj	+ 12.64	Depreciation (22%)	- 66,079
Plumbing Adj	+ 7.39	Lump Sums	+ 0
Basement Adj	+ 0.00	RCNLD	= 234,278
Adj Base Cost	= 127.13	Lot Value	+ 131,532
Total Area	x 2,100	Indicated Value	= 365,810
Adjusted Cost	= 266,973	Value Per SqFt	174.20

Value Reconciliation			
Selected Approach	Cost Approach		
Improvements	234,278		
Lot Value	131,532		
Indicated Value	365,810	174.20	Per SqFt
Agland Value			
Site Improvements	23,322		
Total Value	389,132	185.30	Total Value Per SqFt

Miscellaneous Improvements							
Code	Description	Sketch ID	Size	Year	Units	Unit Cost	Depr Value
FPR1	FIREPLACE - RESIDENTIAL 1 STORY	0		1	1	5,615.40	5,615
PRCH	SLAB PORCH - COVERED	31265		214	214	26.26	5,620
PRCH	SLAB PORCH - COVERED	31266		120	120	26.55	3,186



Rogers

Assessment Property Record Card for Tax Year 2026

Data provided by LISA DELOZIER County Assessor

Date 04/16/2026

Time 21:28:02

Page 3

Sketch Image

660013102

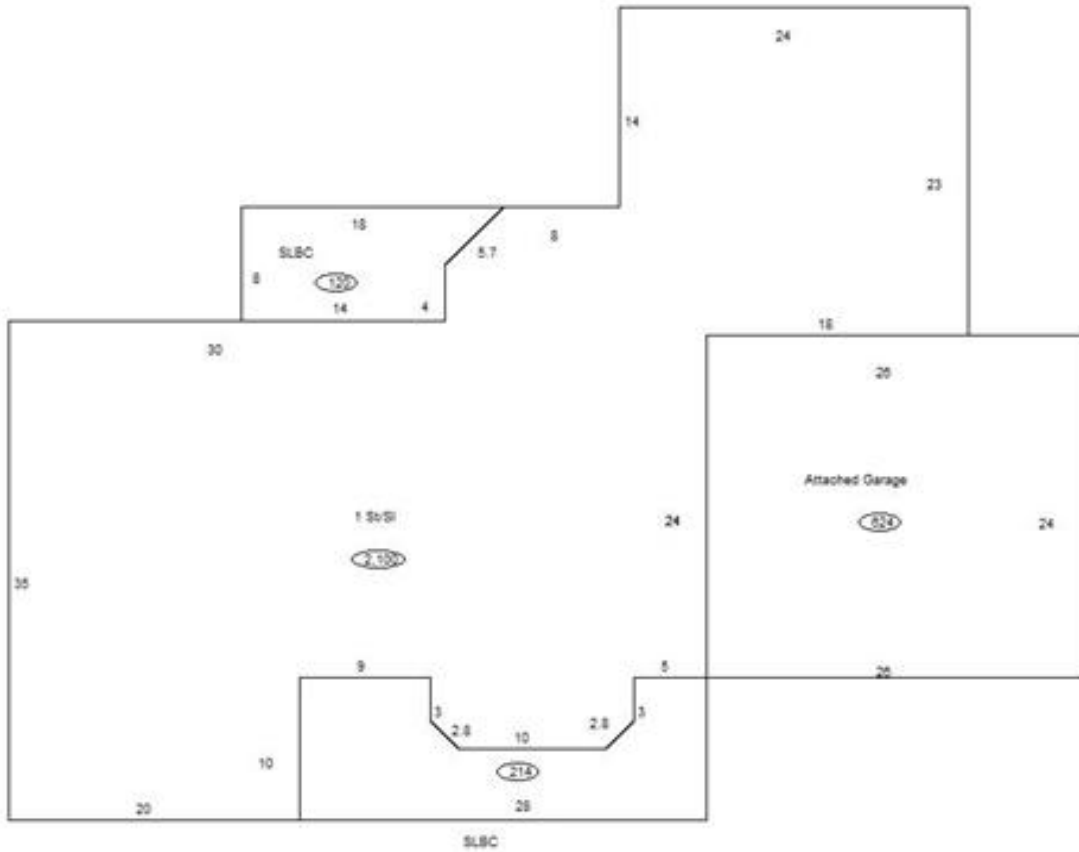

Sketch Vector Information

Sequence	Code	Type	Built Over	Scale	Section Label	Base Area	Multiplier	Total Area
1	R	1	Slab	10	1 St/SI	2,100	1.000	2,100
2	G	1		10	Attached Garage	624	1.000	624
3	M	PRCH		10	SLBC	214	1.000	214
4	M	PRCH		10	SLBC	120	1.000	120
Total Building Area						2,100		2,100



Rogers

Assessment Property Record Card for Tax Year 2026

Data provided by LISA DELOZIER County Assessor

Date 04/16/2026
Time 21:28:02
Page 4

660013102

Outbuildings/Site Improvements

Building Image	Code	Description	Dimensions	Floor	Roofing	Total Units
	GRDT	GARAGE - DETACHED	32x24x0			768
	Qual 4	Cond 3	Year 2013	Eff Age 10		
		Valuation Summary	Modifier Total	RCN	Depr (20% Phys/ % Func)	RCNLD
		Base Cost (37.96 x 768)	29,153	29,153	5,831	23,322