



# Rogers

## Assessment Property Record Card for Tax Year 2026

Data provided by LISA DELOZIER County Assessor

Date 04/16/2026  
Time 21:28:42  
Page 1

Assessment Data					Primary Image																																																	
<b>Account</b> 660013143 <b>Parcel ID</b> 000000-00-0-00783-003-0031 <b>Cadastral ID</b> 13-21-14-01850 <b>Property Type</b> REAL - Real Property <b>Property Class</b> RRP VI Area 4 <b>Tax Area</b> 7 - OWASSO/LIMESTONE FIRE <b>Name ID</b> 117364 CASPER, RICHARD D &  CAROLYN L-CO-TRUSTEES 18808 STONEBRIDGE DR OWASSO OK 74055-0000																																																						
<b>Parcel Location</b> <b>Situs</b> 18808 STONEBRIDGE DR <b>Subdivision</b> STONEBRIDGE ESTATES II <b>Lot/Block</b> 0031 / 0003 <b>Parcel Size</b> 2 - Lots <b>Sec/Twn/Rng</b> 13 / 21 / 14 / 5 <b>Neighborhood</b> 1027 - R-V04-SW OWASSO <b>School District</b> S021 - OWASSO SCHOOLS																																																						
<b>Legal Description</b> Lat/Long: 36.30547966 -95.76386833					<b>Building Permits</b>																																																	
LOTS 30 & 31 BLOCK 3 STONEBRIDGE EST 2					<table border="1"> <thead> <tr> <th>Number</th> <th>Description</th> <th>Opened</th> <th>Closed</th> <th>Amount</th> </tr> </thead> <tbody> <tr> <td> </td> <td> </td> <td> </td> <td> </td> <td> </td> </tr> </tbody> </table>					Number	Description	Opened	Closed	Amount																																								
Number	Description	Opened	Closed	Amount																																																		
<b>Exemptions</b>					<b>Sale History</b>																																																	
<b>Code</b>	<b>Type</b>	<b>Active</b>	<b>Maximum</b>	<b>Exemption</b>	<b>Bk/Pg</b>	<b>Grantor</b>	<b>Date</b>	<b>Price</b>	<b>Code</b>																																													
H	Homestead	Yes	1,000	1,000	839/673			21,000	No																																													
					850/380			176,000	No																																													
<b>Parcel Valuation</b>					<table border="1"> <thead> <tr> <th>Source</th> <th>REAL</th> <th>Fair Cash</th> <th>Capped</th> <th>Asmnt Level</th> <th>Assessed</th> <th>Levy Rate</th> <th>108.538</th> <th>Current Tax</th> </tr> </thead> <tbody> <tr> <td>Remove Cap</td> <td>0</td> <td>Land Value 171,940</td> <td>73,712</td> <td>11%</td> <td>8,108</td> <td>Assessed</td> <td>41,852</td> <td>4,542.53</td> </tr> <tr> <td>Year Frozen</td> <td>0</td> <td>Improvements 306,764</td> <td>306,764</td> <td> </td> <td>33,744</td> <td>Penalty</td> <td>0</td> <td> </td> </tr> <tr> <td>Uncapped Value</td> <td>0</td> <td>Mobile Home 0</td> <td>0</td> <td> </td> <td>0</td> <td>Exemption</td> <td>1,000</td> <td>-98.00</td> </tr> <tr> <td>TIF Project ID</td> <td>0</td> <td>Total Value 478,704</td> <td>380,476</td> <td> </td> <td>41,852</td> <td>Total Taxable</td> <td>40,852</td> <td>4,445.00</td> </tr> </tbody> </table>					Source	REAL	Fair Cash	Capped	Asmnt Level	Assessed	Levy Rate	108.538	Current Tax	Remove Cap	0	Land Value 171,940	73,712	11%	8,108	Assessed	41,852	4,542.53	Year Frozen	0	Improvements 306,764	306,764		33,744	Penalty	0		Uncapped Value	0	Mobile Home 0	0		0	Exemption	1,000	-98.00	TIF Project ID	0	Total Value 478,704	380,476		41,852	Total Taxable	40,852	4,445.00
Source	REAL	Fair Cash	Capped	Asmnt Level	Assessed	Levy Rate	108.538	Current Tax																																														
Remove Cap	0	Land Value 171,940	73,712	11%	8,108	Assessed	41,852	4,542.53																																														
Year Frozen	0	Improvements 306,764	306,764		33,744	Penalty	0																																															
Uncapped Value	0	Mobile Home 0	0		0	Exemption	1,000	-98.00																																														
TIF Project ID	0	Total Value 478,704	380,476		41,852	Total Taxable	40,852	4,445.00																																														
<b>Assessment History</b>																																																						
Tax Year	Statement Number	Billed Owner	Tax Area	Total Value	Exemptions	Taxable Value	Billed Tax																																															
2025	2025-660013143	CASPER, RICHARD D &	7	472,198	1000	39,633	4,312.00																																															
2024	2024-660013143	CASPER, RICHARD D &	7	424,867	1000	38,450	4,257.00																																															
2023	2023-660013143	CASPER, RICHARD D &	7	355,275	1000	37,301	4,042.00																																															
2022	2022-660013143	CASPER, RICHARD D &	7	345,211	1000	36,186	4,076.00																																															
2021	2021-660013143	CASPER, RICHARD D &	7	328,328	1000	35,102	3,912.00																																															
2020	2020-660013143	CASPER, RICHARD D &	7	326,110	1000	34,051	3,790.00																																															
2019	2019-660013143	CASPER, RICHARD D &	7	309,365	1000	33,030	3,679.00																																															
2018	2018-660013143	CASPER, RICHARD D &	7	321,166	1000	34,319	3,698.00																																															
2017	2017-660013143	CASPER, RICHARD D &	7	318,479	1000	33,291	3,621.00																																															
2016	2016-660013143	CASPER, RICHARD D &	7	309,880	1000	32,292	3,515.00																																															
2015	2015-660013143	CASPER, RICHARD D &	7	299,909	1000	31,322	3,432.00																																															
2014	2014-660013143	CASPER, RICHARD D &	7	307,205	1000	30,381	3,356.00																																															
2013	2013-660013143	CASPER, RICHARD D &	7	288,119	1000	29,467	3,195.00																																															



# Rogers

## Assessment Property Record Card for Tax Year 2026

Data provided by LISA DELOZIER County Assessor

Date 04/16/2026  
Time 21:28:43  
Page 2

Lot Data		Square-Foot - NBHD 1027 #1
Lot Size		
Lot Count	1	
Units Buildable	1	
Non-Ag Acres	2.0472	
Topography		
Street Access		
Utilities		
Amenities	LAND QUALITY	0
	LAKE LOT	0
Method	Square-Foot	
Base Lot Value	89,176.00 x 1.93 = 171,940	
Factor Value		
Adjustments	1.0000	
Lot Value	171,940	



\\tsclient\T\LOGAN\LOGAN RESIDENTIAL VI\2022-9-1\IMG\_0029. 9/1/2022

Residential Data	
Type	1 Single Family Residence
Condition	3 - Average
Quality	3.5 - Average
Architecture	
Style	100% 1 1/2 Story Finished
Exterior Wall	100% Veneer, Masonry
Base/Total Area	2,114 / 3,395
Style	100% 1 1/2 Story Finished
HVAC	100% Warmed & Cooled Air
Roof Cover	1 Composition Shingle
Area on Slab	0
Fixture/RghIn	14 /
Bed/F/H Bath	5 / 3.0 /
Basement Area	
Garage Type	917 Attached Garage - Unfinished
Remodel	
Year/Eff Age	1990 / 27

GRM Approach	
GRM Code	
Gross Rent	0.00
Indicated Value	

Multiple Regression			
MRA Code	1	Test	
Adusted R	0.8445		
Indicated Value	410,335	120.86	Per SqFt

Direct Comparables			
Selection Model	A	Adam Test	
Adjustment Model	1	2022 Residential	
Comparables	1		
Indicated Value	252,310		Per SqFt

Cost Approach		Manual : 01/2025	
Base Cost	95.54	Total Misc Impr	+ 7,372
Roofing Adj	+ 3.31	Garage Cost	+ 34,122
Subfloor Adj	+ 0.00	Total RCN	= 448,555
Heat/Cool Adj	+ 14.47	Depreciation ( 34%)	- 152,509
Plumbing Adj	+ 6.58	Lump Sums	+ 10,718
Basement Adj	+ 0.00	RCNLD	= 306,764
Adj Base Cost	= 119.90	Lot Value	+ 171,940
Total Area	x 3,395	Indicated Value	= 478,704
Adjusted Cost	= 407,061	Value Per SqFt	141.00

Value Reconciliation			
Selected Approach	Cost Approach		
Improvements	306,764		
Lot Value	171,940		
Indicated Value	478,704	141.00	Per SqFt
Agland Value			
Site Improvements			
Total Value	478,704	141.00	Total Value Per SqFt

Miscellaneous Improvements								
Code	Description	Sketch ID	Size	Year	Units	Unit Cost	Depr	Value
FPR1	FIREPLACE - RESIDENTIAL 1 STORY	0		1	1	6,429.63		6,430
SHLT	STORM SHELTER	0		1	2016	0.00		
PRCH	SLAB PORCH - COVERED	31443	8x4		32	29.43		942
WODO	WOOD DECK - OPEN	31445	722		722	19.06	45%	7,569
WODO	WOOD DECK - OPEN	31446	293		293	19.54	45%	3,149



# Rogers

## Assessment Property Record Card for Tax Year 2026

Data provided by LISA DELOZIER County Assessor

Date 04/16/2026

Time 21:28:43

Page 3

### Sketch Image

660013143

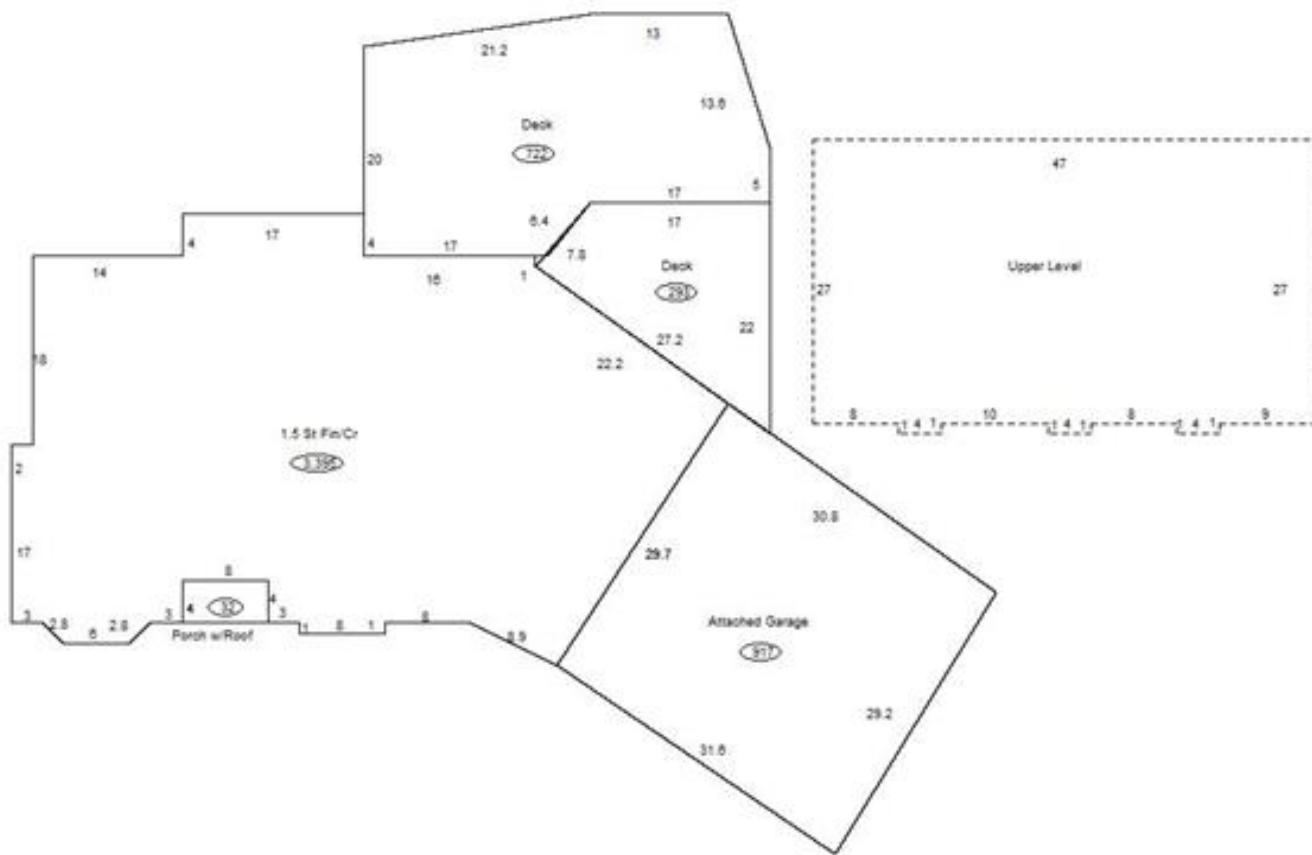

### Sketch Vector Information

Sequence	Code	Type	Built Over	Scale	Section Label	Base Area	Multiplier	Total Area
1	R	5	Crawl	13	1.5 St Fin/Cr	2,114	1.606	3,395
2	G	1		13	Attached Garage	917	1.000	917
3	M	PRCH		13	SLBC	32	1.000	32
4	U	^UL	Overhang	13	Upper Level	1,281	1.000	1,281
5	M	WODO		13	WODO	722	1.000	722
6	M	WODO		13	WODO	293	1.000	293
<b>Total Building Area</b>						<b>2,114</b>		<b>3,395</b>



# Rogers

## Assessment Property Record Card for Tax Year 2026

Data provided by LISA DELOZIER County Assessor

Date 04/16/2026  
Time 21:28:43  
Page 4

660013143

### Outbuildings/Site Improvements

Building Image	Code	Description	Dimensions	Floor	Roofing	Total Units
	STF	STG FAIR	12x16x0			192
	Qual	2	Cond 3	Year	Eff Age 1520	
<b>Valuation Summary</b>		<b>Modifier Total</b>		<b>RCN</b>	<b>Depr (100% Phys/ % Func)</b>	<b>RCNLD</b>
Base Cost (4.68 x 192)		899		899	899	