



Rogers

Assessment Property Record Card for Tax Year 2026

Data provided by LISA DELOZIER County Assessor

Date 04/16/2026
Time 21:28:44
Page 1

Assessment Data					Primary Image																																																																																																																				
Account 660013144 Parcel ID 000000-00-0-00783-003-0032 Cadastral ID 13-21-14-01870 Property Type REAL - Real Property Property Class RRP VI Area 4 Tax Area 7 - OWASSO/LIMESTONE FIRE Name ID 263936 BOLLINGER, WAYNE A & DEBRA A 18816 STONBRIDGE DR OWASSO OK 74055-0000 Parcel Location Situs 18816 STONEBRIDGE DR Subdivision STONEBRIDGE ESTATES II Lot/Block 0032 / 0003 Parcel Size 1 - Lots Sec/Twn/Rng 13 / 21 / 14 / 5 Neighborhood 1027 - R-V04-SW OWASSO School District S021 - OWASSO SCHOOLS																																																																																																																									
Legal Description Lat/Long: 36.30574193 -95.76308641																																																																																																																									
Legal Description LOT 32 BLOCK 3 STONEBRIDGE EST 2					Building Permits <table border="1"> <thead> <tr> <th>Number</th> <th>Description</th> <th>Opened</th> <th>Closed</th> <th>Amount</th> </tr> </thead> <tbody> <tr><td> </td><td> </td><td> </td><td> </td><td> </td></tr> <tr><td> </td><td> </td><td> </td><td> </td><td> </td></tr> <tr><td> </td><td> </td><td> </td><td> </td><td> </td></tr> <tr><td> </td><td> </td><td> </td><td> </td><td> </td></tr> <tr><td> </td><td> </td><td> </td><td> </td><td> </td></tr> <tr><td> </td><td> </td><td> </td><td> </td><td> </td></tr> <tr><td> </td><td> </td><td> </td><td> </td><td> </td></tr> <tr><td> </td><td> </td><td> </td><td> </td><td> </td></tr> <tr><td> </td><td> </td><td> </td><td> </td><td> </td></tr> <tr><td> </td><td> </td><td> </td><td> </td><td> </td></tr> </tbody> </table>					Number	Description	Opened	Closed	Amount																																																																																																											
Number	Description	Opened	Closed	Amount																																																																																																																					
Exemptions <table border="1"> <thead> <tr> <th>Code</th> <th>Type</th> <th>Active</th> <th>Maximum</th> <th>Exemption</th> </tr> </thead> <tbody> <tr> <td>H</td> <td>Homestead</td> <td>Yes</td> <td>1,000</td> <td>1,000</td> </tr> </tbody> </table>					Code	Type	Active	Maximum	Exemption	H	Homestead	Yes	1,000	1,000	Sale History <table border="1"> <thead> <tr> <th>Bk/Pg</th> <th>Grantor</th> <th>Date</th> <th>Price</th> <th>Code</th> </tr> </thead> <tbody> <tr> <td>1037/96</td> <td>WYLIE, GREG</td> <td>08/23/1996</td> <td>134,000</td> <td>Yes</td> </tr> <tr> <td>1022/689</td> <td>HUNTER, LYLE R & JEAN O</td> <td>04/19/1996</td> <td>16,000</td> <td>No</td> </tr> <tr> <td>917/542</td> <td>PARKER, JAMES SCHUYLER &</td> <td>05/17/1993</td> <td>0</td> <td>No</td> </tr> <tr> <td>922/589</td> <td>RON KELLEY HOMES INC</td> <td>05/17/1993</td> <td>15,000</td> <td>Yes</td> </tr> <tr> <td>911/227</td> <td>KELLEY, RONALD G &</td> <td>04/08/1993</td> <td>30,000</td> <td>No</td> </tr> <tr> <td>856/519</td> <td> </td> <td> </td> <td>195,000</td> <td>No</td> </tr> </tbody> </table>					Bk/Pg	Grantor	Date	Price	Code	1037/96	WYLIE, GREG	08/23/1996	134,000	Yes	1022/689	HUNTER, LYLE R & JEAN O	04/19/1996	16,000	No	917/542	PARKER, JAMES SCHUYLER &	05/17/1993	0	No	922/589	RON KELLEY HOMES INC	05/17/1993	15,000	Yes	911/227	KELLEY, RONALD G &	04/08/1993	30,000	No	856/519			195,000	No																																																																			
Code	Type	Active	Maximum	Exemption																																																																																																																					
H	Homestead	Yes	1,000	1,000																																																																																																																					
Bk/Pg	Grantor	Date	Price	Code																																																																																																																					
1037/96	WYLIE, GREG	08/23/1996	134,000	Yes																																																																																																																					
1022/689	HUNTER, LYLE R & JEAN O	04/19/1996	16,000	No																																																																																																																					
917/542	PARKER, JAMES SCHUYLER &	05/17/1993	0	No																																																																																																																					
922/589	RON KELLEY HOMES INC	05/17/1993	15,000	Yes																																																																																																																					
911/227	KELLEY, RONALD G &	04/08/1993	30,000	No																																																																																																																					
856/519			195,000	No																																																																																																																					
Parcel Valuation <table border="1"> <thead> <tr> <th>Source</th> <th>REAL</th> <th>Fair Cash</th> <th>Capped</th> <th>Asmnt Level</th> <th>Assessed</th> <th>Levy Rate</th> <th>108.538</th> <th>Current Tax</th> </tr> </thead> <tbody> <tr> <td>Remove Cap</td> <td>0</td> <td>Land Value 112,275</td> <td>96,059</td> <td>11%</td> <td>10,566</td> <td>Assessed</td> <td>30,561</td> <td>3,317.03</td> </tr> <tr> <td>Year Frozen</td> <td>2024</td> <td>Improvements 212,459</td> <td>181,774</td> <td> </td> <td>19,995</td> <td>Penalty</td> <td>0</td> <td> </td> </tr> <tr> <td>Uncapped Value</td> <td>0</td> <td>Mobile Home 0</td> <td>0</td> <td> </td> <td>0</td> <td>Exemption</td> <td>1,000</td> <td>-98.00</td> </tr> <tr> <td>TIF Project ID</td> <td>0</td> <td>Total Value 324,734</td> <td>277,833</td> <td> </td> <td>30,561</td> <td>Total Taxable</td> <td>29,561</td> <td>3,219.00</td> </tr> </tbody> </table>										Source	REAL	Fair Cash	Capped	Asmnt Level	Assessed	Levy Rate	108.538	Current Tax	Remove Cap	0	Land Value 112,275	96,059	11%	10,566	Assessed	30,561	3,317.03	Year Frozen	2024	Improvements 212,459	181,774		19,995	Penalty	0		Uncapped Value	0	Mobile Home 0	0		0	Exemption	1,000	-98.00	TIF Project ID	0	Total Value 324,734	277,833		30,561	Total Taxable	29,561	3,219.00																																																																			
Source	REAL	Fair Cash	Capped	Asmnt Level	Assessed	Levy Rate	108.538	Current Tax																																																																																																																	
Remove Cap	0	Land Value 112,275	96,059	11%	10,566	Assessed	30,561	3,317.03																																																																																																																	
Year Frozen	2024	Improvements 212,459	181,774		19,995	Penalty	0																																																																																																																		
Uncapped Value	0	Mobile Home 0	0		0	Exemption	1,000	-98.00																																																																																																																	
TIF Project ID	0	Total Value 324,734	277,833		30,561	Total Taxable	29,561	3,219.00																																																																																																																	
Assessment History <table border="1"> <thead> <tr> <th>Tax Year</th> <th>Statement Number</th> <th>Billed Owner</th> <th>Tax Area</th> <th>Total Value</th> <th>Exemptions</th> <th>Taxable Value</th> <th>Billed Tax</th> </tr> </thead> <tbody> <tr><td>2025</td><td>2025-660013144</td><td>BOLLINGER, WAYNE A & DEBRA A</td><td>7</td><td>322,458</td><td>1000</td><td>29,562</td><td>3,219.00</td></tr> <tr><td>2024</td><td>2024-660013144</td><td>BOLLINGER, WAYNE A & DEBRA A</td><td>7</td><td>321,224</td><td>1000</td><td>29,561</td><td>3,276.00</td></tr> <tr><td>2023</td><td>2023-660013144</td><td>BOLLINGER, WAYNE A & DEBRA A</td><td>7</td><td>281,899</td><td>1000</td><td>28,672</td><td>3,111.00</td></tr> <tr><td>2022</td><td>2022-660013144</td><td>BOLLINGER, WAYNE A & DEBRA A</td><td>7</td><td>261,885</td><td>1000</td><td>27,807</td><td>3,135.00</td></tr> <tr><td>2021</td><td>2021-660013144</td><td>BOLLINGER, WAYNE A & DEBRA A</td><td>7</td><td>257,207</td><td>1000</td><td>27,293</td><td>3,044.00</td></tr> <tr><td>2020</td><td>2020-660013144</td><td>BOLLINGER, WAYNE A & DEBRA A</td><td>7</td><td>255,467</td><td>1000</td><td>26,504</td><td>2,953.00</td></tr> <tr><td>2019</td><td>2019-660013144</td><td>BOLLINGER, WAYNE A & DEBRA A</td><td>7</td><td>242,757</td><td>1000</td><td>25,703</td><td>2,866.00</td></tr> <tr><td>2018</td><td>2018-660013144</td><td>BOLLINGER, WAYNE A & DEBRA A</td><td>7</td><td>249,223</td><td>1000</td><td>25,286</td><td>2,729.00</td></tr> <tr><td>2017</td><td>2017-660013144</td><td>BOLLINGER, WAYNE A & DEBRA A</td><td>7</td><td>247,224</td><td>1000</td><td>24,521</td><td>2,670.00</td></tr> <tr><td>2016</td><td>2016-660013144</td><td>BOLLINGER, WAYNE A & DEBRA A</td><td>7</td><td>240,829</td><td>1000</td><td>23,777</td><td>2,593.00</td></tr> <tr><td>2015</td><td>2015-660013144</td><td>BOLLINGER, WAYNE A & DEBRA A</td><td>7</td><td>233,644</td><td>1000</td><td>23,056</td><td>2,530.00</td></tr> <tr><td>2014</td><td>2014-660013144</td><td>BOLLINGER, WAYNE A & DEBRA A</td><td>7</td><td>234,626</td><td>1000</td><td>22,025</td><td>2,437.00</td></tr> <tr><td>2013</td><td>2013-660013144</td><td>BOLLINGER, WAYNE A & DEBRA A</td><td>7</td><td>220,764</td><td>1000</td><td>21,354</td><td>2,319.00</td></tr> </tbody> </table>										Tax Year	Statement Number	Billed Owner	Tax Area	Total Value	Exemptions	Taxable Value	Billed Tax	2025	2025-660013144	BOLLINGER, WAYNE A & DEBRA A	7	322,458	1000	29,562	3,219.00	2024	2024-660013144	BOLLINGER, WAYNE A & DEBRA A	7	321,224	1000	29,561	3,276.00	2023	2023-660013144	BOLLINGER, WAYNE A & DEBRA A	7	281,899	1000	28,672	3,111.00	2022	2022-660013144	BOLLINGER, WAYNE A & DEBRA A	7	261,885	1000	27,807	3,135.00	2021	2021-660013144	BOLLINGER, WAYNE A & DEBRA A	7	257,207	1000	27,293	3,044.00	2020	2020-660013144	BOLLINGER, WAYNE A & DEBRA A	7	255,467	1000	26,504	2,953.00	2019	2019-660013144	BOLLINGER, WAYNE A & DEBRA A	7	242,757	1000	25,703	2,866.00	2018	2018-660013144	BOLLINGER, WAYNE A & DEBRA A	7	249,223	1000	25,286	2,729.00	2017	2017-660013144	BOLLINGER, WAYNE A & DEBRA A	7	247,224	1000	24,521	2,670.00	2016	2016-660013144	BOLLINGER, WAYNE A & DEBRA A	7	240,829	1000	23,777	2,593.00	2015	2015-660013144	BOLLINGER, WAYNE A & DEBRA A	7	233,644	1000	23,056	2,530.00	2014	2014-660013144	BOLLINGER, WAYNE A & DEBRA A	7	234,626	1000	22,025	2,437.00	2013	2013-660013144	BOLLINGER, WAYNE A & DEBRA A	7	220,764	1000	21,354	2,319.00
Tax Year	Statement Number	Billed Owner	Tax Area	Total Value	Exemptions	Taxable Value	Billed Tax																																																																																																																		
2025	2025-660013144	BOLLINGER, WAYNE A & DEBRA A	7	322,458	1000	29,562	3,219.00																																																																																																																		
2024	2024-660013144	BOLLINGER, WAYNE A & DEBRA A	7	321,224	1000	29,561	3,276.00																																																																																																																		
2023	2023-660013144	BOLLINGER, WAYNE A & DEBRA A	7	281,899	1000	28,672	3,111.00																																																																																																																		
2022	2022-660013144	BOLLINGER, WAYNE A & DEBRA A	7	261,885	1000	27,807	3,135.00																																																																																																																		
2021	2021-660013144	BOLLINGER, WAYNE A & DEBRA A	7	257,207	1000	27,293	3,044.00																																																																																																																		
2020	2020-660013144	BOLLINGER, WAYNE A & DEBRA A	7	255,467	1000	26,504	2,953.00																																																																																																																		
2019	2019-660013144	BOLLINGER, WAYNE A & DEBRA A	7	242,757	1000	25,703	2,866.00																																																																																																																		
2018	2018-660013144	BOLLINGER, WAYNE A & DEBRA A	7	249,223	1000	25,286	2,729.00																																																																																																																		
2017	2017-660013144	BOLLINGER, WAYNE A & DEBRA A	7	247,224	1000	24,521	2,670.00																																																																																																																		
2016	2016-660013144	BOLLINGER, WAYNE A & DEBRA A	7	240,829	1000	23,777	2,593.00																																																																																																																		
2015	2015-660013144	BOLLINGER, WAYNE A & DEBRA A	7	233,644	1000	23,056	2,530.00																																																																																																																		
2014	2014-660013144	BOLLINGER, WAYNE A & DEBRA A	7	234,626	1000	22,025	2,437.00																																																																																																																		
2013	2013-660013144	BOLLINGER, WAYNE A & DEBRA A	7	220,764	1000	21,354	2,319.00																																																																																																																		



Rogers

Assessment Property Record Card for Tax Year 2026

Data provided by LISA DELOZIER County Assessor

Date 04/16/2026
Time 21:28:45
Page 2

Lot Data	Square-Foot - NBHD 1027 #1	Primary Image
Lot Size		
Lot Count	1	
Units Buildable	1	
Non-Ag Acres	0.9726	
Topography		
Street Access		
Utilities		
Amenities	LAND QUALITY 0 LAKE LOT 0	
Method	Square-Foot	
Base Lot Value	42,368.00 x 2.65 = 112,275	
Factor Value		
Adjustments	1.0000	
Lot Value	112,275	

Residential Data	
Type	1 Single Family Residence
Condition	3 - Average
Quality	2.5 - Fair
Architecture	
Style	100% One Story
Exterior Wall	90% Veneer, Masonry 10% Frame, Siding, Wood
Base/Total Area	2,303 / 2,303
Style	100% One Story
HVAC	100% Warmed & Cooled Air
Roof Cover	1 Composition Shingle
Area on Slab	2,303
Fixture/RghIn	11 /
Bed/F/H Bath	3 / 2.0 /
Basement Area	
Garage Type	595 Attached Garage - Unfinished
Remodel	
Year/Eff Age	1996 / 23

GRM Approach	
GRM Code	
Gross Rent	0.00
Indicated Value	

Multiple Regression	
MRA Code	1 Test
Adjusted R	0.8445
Indicated Value	237,993 103.34 Per SqFt

Direct Comparables	
Selection Model	A Adam Test
Adjustment Model	1 2022 Residential
Comparables	6
Indicated Value	309,920 Per SqFt

Cost Approach		Manual : 01/2025	
Base Cost	97.01	Total Misc Impr	+ 16,875
Roofing Adj	+ 4.14	Garage Cost	+ 15,690
Subfloor Adj	+ -1.09	Total RCN	= 303,513
Heat/Cool Adj	+ 11.47	Depreciation (30%)	- 91,054
Plumbing Adj	+ 6.12	Lump Sums	+ 0
Basement Adj	+ 0.00	RCNLD	= 212,459
Adj Base Cost	= 117.65	Lot Value	+ 112,275
Total Area	x 2,303	Indicated Value	= 324,734
Adjusted Cost	= 270,948	Value Per SqFt	141.00

Value Reconciliation	
Selected Approach	Cost Approach
Improvements	212,459
Lot Value	112,275
Indicated Value	324,734 141.00 Per SqFt
Agland Value	
Site Improvements	
Total Value	324,734 141.00 Total Value Per SqFt

Miscellaneous Improvements								
Code	Description	Sketch ID	Size	Year	Units	Unit Cost	Depr	Value
FPR1	FIREPLACE - RESIDENTIAL 1 STORY	0		1	1	5,095.98		5,096
PRCH	SLAB PORCH - COVERED	31449		204	204	23.55		4,804
PRCH	SLAB PORCH - COVERED	31450		20x15	300	23.25		6,975



Rogers
Assessment Property Record Card for Tax Year 2026

Data provided by LISA DELOZIER County Assessor

Date 04/16/2026
 Time 21:28:45
 Page 3

Sketch Image

660013144

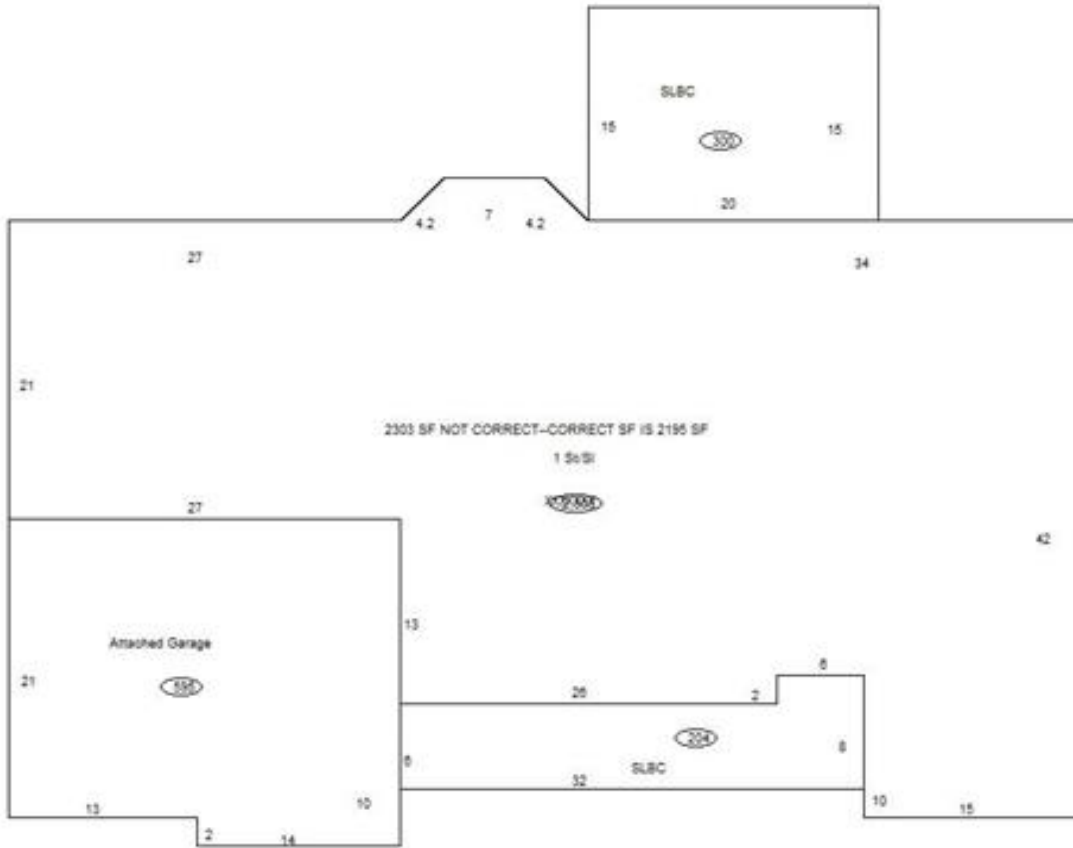

Sketch Vector Information

Sequence	Code	Type	Built Over	Scale	Section Label	Base Area	Multiplier	Total Area
1	R	1	Slab	10	1 St/SI	2,303	1.000	2,303
2	G	1		10	Attached Garage	595	1.000	595
3	M	PRCH		10	SLBC	204	1.000	204
4	M	PRCH		10	SLBC	300	1.000	300
5	N	0		10	2303 SF NOT CORRECT--CORRECT SF IS 2195 SF		0.000	
6	N	0		10	XXXXXX		0.000	
Total Building Area						2,303		2,303



Rogers

Assessment Property Record Card for Tax Year 2026

Data provided by LISA DELOZIER County Assessor

Date 04/16/2026
Time 21:28:45
Page 4

660013144

Outbuildings/Site Improvements

Building Image	Code	Description	Dimensions	Floor	Roofing	Total Units
	STF	STG FAIR	22x16x0			352
	Qual	2	Cond 3	Year	Eff Age 1520	
		Valuation Summary	Modifier Total	RCN	Depr (100% Phys/ % Func)	RCNLD
		Base Cost (4.68 x 352)	1,647		1,647	1,647