



Rogers

Assessment Property Record Card for Tax Year 2026

Data provided by LISA DELOZIER County Assessor

Date 04/16/2026
Time 23:29:50
Page 1

Assessment Data					Primary Image																																																																																																																				
Account 660013230 Parcel ID 000000-00-0-00784-001-0001 Cadastral ID 13-21-14-03160 Property Type REAL - Real Property Property Class RRP VI Area 4 Tax Area 7 - OWASSO/LIMESTONE FIRE Name ID 195404 KLAHR, GLEN A & LAVON L 18907 STONEBRIDGE DR OWASSO OK 74055-0000																																																																																																																									
Parcel Location Situs 18907 STONEBRIDGE DR Subdivision STONEBRIDGE EST 2 EX Lot/Block 0001 / 0001 Parcel Size 1 - Lots Sec/Twn/Rng 13 / 21 / 14 / 5 Neighborhood 1027 - R-V04-SW OWASSO School District S021 - OWASSO SCHOOLS																																																																																																																									
Legal Description Lat/Long: 36.30697150 -95.76168051 LOT 1 BLOCK 1 STONEBRIDGE EST 2 EX					Building Permits <table border="1"> <thead> <tr> <th>Number</th> <th>Description</th> <th>Opened</th> <th>Closed</th> <th>Amount</th> </tr> </thead> <tbody> <tr> <td></td> <td></td> <td></td> <td></td> <td></td> </tr> </tbody> </table>					Number	Description	Opened	Closed	Amount																																																																																																											
Number	Description	Opened	Closed	Amount																																																																																																																					
Exemptions <table border="1"> <thead> <tr> <th>Code</th> <th>Type</th> <th>Active</th> <th>Maximum</th> <th>Exemption</th> </tr> </thead> <tbody> <tr> <td>H</td> <td>Homestead</td> <td>Yes</td> <td>1,000</td> <td>1,000</td> </tr> </tbody> </table>					Code	Type	Active	Maximum	Exemption	H	Homestead	Yes	1,000	1,000	Sale History <table border="1"> <thead> <tr> <th>Bk/Pg</th> <th>Grantor</th> <th>Date</th> <th>Price</th> <th>Code</th> </tr> </thead> <tbody> <tr> <td>861/364</td> <td>SELLER</td> <td>08/22/1991</td> <td>114,500</td> <td>No</td> </tr> <tr> <td>855/62</td> <td>MCDORMAN, WESLEY V</td> <td>05/28/1991</td> <td>14,500</td> <td>No</td> </tr> </tbody> </table>					Bk/Pg	Grantor	Date	Price	Code	861/364	SELLER	08/22/1991	114,500	No	855/62	MCDORMAN, WESLEY V	05/28/1991	14,500	No																																																																																							
Code	Type	Active	Maximum	Exemption																																																																																																																					
H	Homestead	Yes	1,000	1,000																																																																																																																					
Bk/Pg	Grantor	Date	Price	Code																																																																																																																					
861/364	SELLER	08/22/1991	114,500	No																																																																																																																					
855/62	MCDORMAN, WESLEY V	05/28/1991	14,500	No																																																																																																																					
Parcel Valuation <table border="1"> <thead> <tr> <th>Source</th> <th>REAL</th> <th>Fair Cash</th> <th>Capped</th> <th>Asmnt Level</th> <th>Assessed</th> <th>Levy Rate</th> <th>108.538</th> <th>Current Tax</th> </tr> </thead> <tbody> <tr> <td>Remove Cap</td> <td>0</td> <td>Land Value 121,864</td> <td>34,337</td> <td>11%</td> <td>3,777</td> <td>Assessed</td> <td>31,798</td> <td>3,451.29</td> </tr> <tr> <td>Year Frozen</td> <td>0</td> <td>Improvements 262,689</td> <td>254,738</td> <td></td> <td>28,021</td> <td>Penalty</td> <td>0</td> <td></td> </tr> <tr> <td>Uncapped Value</td> <td>0</td> <td>Mobile Home 0</td> <td>0</td> <td></td> <td>0</td> <td>Exemption</td> <td>1,000</td> <td>-97.00</td> </tr> <tr> <td>TIF Project ID</td> <td>0</td> <td>Total Value 384,553</td> <td>289,075</td> <td></td> <td>31,798</td> <td>Total Taxable</td> <td>30,798</td> <td>3,354.00</td> </tr> </tbody> </table>										Source	REAL	Fair Cash	Capped	Asmnt Level	Assessed	Levy Rate	108.538	Current Tax	Remove Cap	0	Land Value 121,864	34,337	11%	3,777	Assessed	31,798	3,451.29	Year Frozen	0	Improvements 262,689	254,738		28,021	Penalty	0		Uncapped Value	0	Mobile Home 0	0		0	Exemption	1,000	-97.00	TIF Project ID	0	Total Value 384,553	289,075		31,798	Total Taxable	30,798	3,354.00																																																																			
Source	REAL	Fair Cash	Capped	Asmnt Level	Assessed	Levy Rate	108.538	Current Tax																																																																																																																	
Remove Cap	0	Land Value 121,864	34,337	11%	3,777	Assessed	31,798	3,451.29																																																																																																																	
Year Frozen	0	Improvements 262,689	254,738		28,021	Penalty	0																																																																																																																		
Uncapped Value	0	Mobile Home 0	0		0	Exemption	1,000	-97.00																																																																																																																	
TIF Project ID	0	Total Value 384,553	289,075		31,798	Total Taxable	30,798	3,354.00																																																																																																																	
Assessment History <table border="1"> <thead> <tr> <th>Tax Year</th> <th>Statement Number</th> <th>Billed Owner</th> <th>Tax Area</th> <th>Total Value</th> <th>Exemptions</th> <th>Taxable Value</th> <th>Billed Tax</th> </tr> </thead> <tbody> <tr><td>2025</td><td>2025-660013230</td><td>KLAHR, GLEN A &</td><td>7</td><td>376,294</td><td>1000</td><td>29,872</td><td>3,253.00</td></tr> <tr><td>2024</td><td>2024-660013230</td><td>KLAHR, GLEN A &</td><td>7</td><td>380,706</td><td>1000</td><td>28,972</td><td>3,211.00</td></tr> <tr><td>2023</td><td>2023-660013230</td><td>KLAHR, GLEN A &</td><td>7</td><td>318,577</td><td>1000</td><td>28,100</td><td>3,049.00</td></tr> <tr><td>2022</td><td>2022-660013230</td><td>KLAHR, GLEN A &</td><td>7</td><td>312,751</td><td>1000</td><td>27,253</td><td>3,073.00</td></tr> <tr><td>2021</td><td>2021-660013230</td><td>KLAHR, GLEN A &</td><td>7</td><td>298,735</td><td>1000</td><td>26,429</td><td>2,949.00</td></tr> <tr><td>2020</td><td>2020-660013230</td><td>KLAHR, GLEN A &</td><td>7</td><td>293,621</td><td>1000</td><td>25,631</td><td>2,856.00</td></tr> <tr><td>2019</td><td>2019-660013230</td><td>KLAHR, GLEN A &</td><td>7</td><td>283,968</td><td>1000</td><td>24,855</td><td>2,772.00</td></tr> <tr><td>2018</td><td>2018-660013230</td><td>KLAHR, GLEN A &</td><td>7</td><td>292,451</td><td>1000</td><td>24,102</td><td>2,601.00</td></tr> <tr><td>2017</td><td>2017-660013230</td><td>KLAHR, GLEN A &</td><td>7</td><td>289,654</td><td>1000</td><td>23,371</td><td>2,546.00</td></tr> <tr><td>2016</td><td>2016-660013230</td><td>KLAHR, GLEN A &</td><td>7</td><td>282,209</td><td>1000</td><td>22,661</td><td>2,472.00</td></tr> <tr><td>2015</td><td>2015-660013230</td><td>KLAHR, GLEN A &</td><td>7</td><td>273,197</td><td>1000</td><td>21,972</td><td>2,412.00</td></tr> <tr><td>2014</td><td>2014-660013230</td><td>KLAHR, GLEN A &</td><td>7</td><td>278,586</td><td>1000</td><td>21,303</td><td>2,357.00</td></tr> <tr><td>2013</td><td>2013-660013230</td><td>KLAHR, GLEN A &</td><td>7</td><td>262,359</td><td>1000</td><td>20,654</td><td>2,244.00</td></tr> </tbody> </table>										Tax Year	Statement Number	Billed Owner	Tax Area	Total Value	Exemptions	Taxable Value	Billed Tax	2025	2025-660013230	KLAHR, GLEN A &	7	376,294	1000	29,872	3,253.00	2024	2024-660013230	KLAHR, GLEN A &	7	380,706	1000	28,972	3,211.00	2023	2023-660013230	KLAHR, GLEN A &	7	318,577	1000	28,100	3,049.00	2022	2022-660013230	KLAHR, GLEN A &	7	312,751	1000	27,253	3,073.00	2021	2021-660013230	KLAHR, GLEN A &	7	298,735	1000	26,429	2,949.00	2020	2020-660013230	KLAHR, GLEN A &	7	293,621	1000	25,631	2,856.00	2019	2019-660013230	KLAHR, GLEN A &	7	283,968	1000	24,855	2,772.00	2018	2018-660013230	KLAHR, GLEN A &	7	292,451	1000	24,102	2,601.00	2017	2017-660013230	KLAHR, GLEN A &	7	289,654	1000	23,371	2,546.00	2016	2016-660013230	KLAHR, GLEN A &	7	282,209	1000	22,661	2,472.00	2015	2015-660013230	KLAHR, GLEN A &	7	273,197	1000	21,972	2,412.00	2014	2014-660013230	KLAHR, GLEN A &	7	278,586	1000	21,303	2,357.00	2013	2013-660013230	KLAHR, GLEN A &	7	262,359	1000	20,654	2,244.00
Tax Year	Statement Number	Billed Owner	Tax Area	Total Value	Exemptions	Taxable Value	Billed Tax																																																																																																																		
2025	2025-660013230	KLAHR, GLEN A &	7	376,294	1000	29,872	3,253.00																																																																																																																		
2024	2024-660013230	KLAHR, GLEN A &	7	380,706	1000	28,972	3,211.00																																																																																																																		
2023	2023-660013230	KLAHR, GLEN A &	7	318,577	1000	28,100	3,049.00																																																																																																																		
2022	2022-660013230	KLAHR, GLEN A &	7	312,751	1000	27,253	3,073.00																																																																																																																		
2021	2021-660013230	KLAHR, GLEN A &	7	298,735	1000	26,429	2,949.00																																																																																																																		
2020	2020-660013230	KLAHR, GLEN A &	7	293,621	1000	25,631	2,856.00																																																																																																																		
2019	2019-660013230	KLAHR, GLEN A &	7	283,968	1000	24,855	2,772.00																																																																																																																		
2018	2018-660013230	KLAHR, GLEN A &	7	292,451	1000	24,102	2,601.00																																																																																																																		
2017	2017-660013230	KLAHR, GLEN A &	7	289,654	1000	23,371	2,546.00																																																																																																																		
2016	2016-660013230	KLAHR, GLEN A &	7	282,209	1000	22,661	2,472.00																																																																																																																		
2015	2015-660013230	KLAHR, GLEN A &	7	273,197	1000	21,972	2,412.00																																																																																																																		
2014	2014-660013230	KLAHR, GLEN A &	7	278,586	1000	21,303	2,357.00																																																																																																																		
2013	2013-660013230	KLAHR, GLEN A &	7	262,359	1000	20,654	2,244.00																																																																																																																		



Rogers

Assessment Property Record Card for Tax Year 2026

Data provided by LISA DELOZIER County Assessor

Date 04/16/2026
 Time 23:29:50
 Page 2

Lot Data	Square-Foot - NBHD 1027 #1	Primary Image
Lot Size		
Lot Count		
Units Buildable	1	
Non-Ag Acres	1.1181	
Topography		
Street Access		
Utilities		
Amenities	LAND QUALITY 0 LAKE LOT 0	
Method	Square-Foot	
Base Lot Value	48,704.00 x 2.50 = 121,864	
Factor Value		
Adjustments	1.0000	
Lot Value	121,864	

Residential Data	
Type	1 Single Family Residence
Condition	3 - Average
Quality	3 - Average
Architecture	
Style	100% 1 1/2 Story Finished
Exterior Wall	100% Veneer, Masonry
Base/Total Area	1,870 / 3,046
Style	100% 1 1/2 Story Finished
HVAC	100% Warmed & Cooled Air
Roof Cover	1 Composition Shingle
Area on Slab	1,870
Fixture/RghIn	14 /
Bed/F/H Bath	4 / 2.5 /
Basement Area	
Garage Type	630 Attached Garage - Unfinished
Remodel	
Year/Eff Age	1991 / 26



\\tsclient\T\LOGAN\LOGAN RESIDENTIAL VI\2022-8-31\IMG_004 9/2/2022

GRM Approach	
GRM Code	
Gross Rent	0.00
Indicated Value	

Multiple Regression			
MRA Code	1	Test	
Adjusted R	0.8445		
Indicated Value	329,171	108.07	Per SqFt

Direct Comparables	
Selection Model	A Adam Test
Adjustment Model	1 2022 Residential
Comparables	6
Indicated Value	376,390 Per SqFt

Cost Approach				Manual : 01/2025			
Base Cost	91.25	Total Misc Impr	+ 10,713				
Roofing Adj	+ 2.93	Garage Cost	+ 19,121				
Subfloor Adj	+ -1.39	Total RCN	= 370,499				
Heat/Cool Adj	+ 12.64	Depreciation (32%)	- 118,560				
Plumbing Adj	+ 6.41	Lump Sums	+ 0				
Basement Adj	+ 0.00	RCNLD	= 251,939				
Adj Base Cost	= 111.84	Lot Value	+ 121,864				
Total Area	x 3,046	Indicated Value	= 373,803				
Adjusted Cost	= 340,665	Value Per SqFt	122.72				

Value Reconciliation			
Selected Approach	Cost Approach		
Improvements	251,939		
Lot Value	121,864		
Indicated Value	373,803	122.72	Per SqFt
Agland Value			
Site Improvements	10,750		
Total Value	384,553	126.25	Total Value Per SqFt

Miscellaneous Improvements								
Code	Description	Sketch ID	Size	Year	Units	Unit Cost	Depr	Value
FPR1	FIREPLACE - RESIDENTIAL 1 STORY	0		1	1	5,615.40		5,615
PRCH	SLAB PORCH - COVERED	31816		48	48	26.78		1,285
PRCH	SLAB PORCH - COVERED	31817	12x12		144	26.48		3,813



Rogers
Assessment Property Record Card for Tax Year 2026

Data provided by LISA DELOZIER County Assessor

Date 04/16/2026
 Time 23:29:50
 Page 3

Sketch Image

660013230

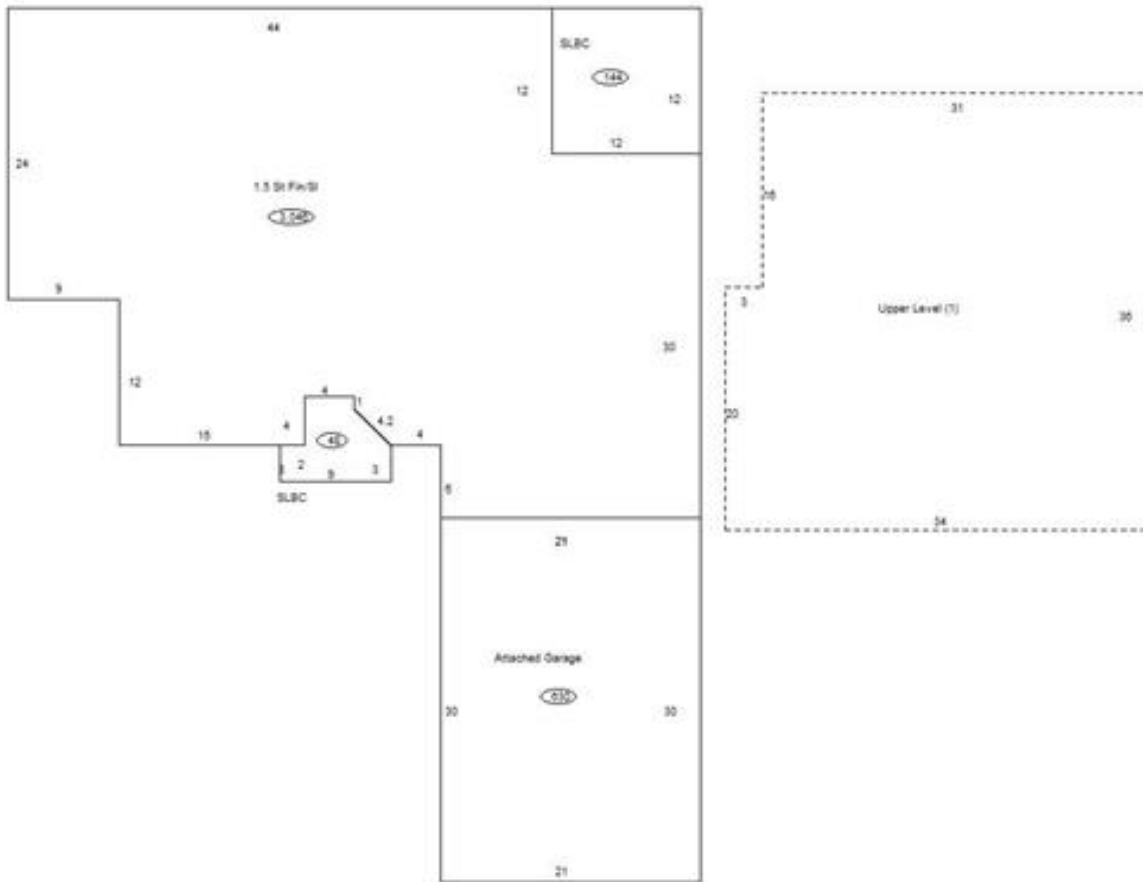

Sketch Vector Information

Sequence	Code	Type	Built Over	Scale	Section Label	Base Area	Multiplier	Total Area
1	R	5	Slab	10	1.5 St Fin/SI	1,870	1.629	3,046
2	G	1		10	Attached Garage	630	1.000	630
3	M	PRCH		10	SLBC	48	1.000	48
4	M	PRCH		10	SLBC	144	1.000	144
5	U	^UL		10	Upper Level (1)	1,176	1.000	1,176
Total Building Area						1,870		3,046



Rogers

Assessment Property Record Card for Tax Year 2026

Data provided by LISA DELOZIER County Assessor

Date 04/16/2026
Time 23:29:50
Page 4

660013230

Outbuildings/Site Improvements

Building Image	Code	Description	Dimensions	Floor	Roofing	Total Units
	SV	SWIM VINYL	0x0x0			1
	Qual 3	Cond 3	Year 2008	Eff Age 14		
		Valuation Summary	Modifier Total	RCN	Depr (57% Phys/ % Func)	RCNLD
		Base Cost (25,000.00 x 1)	25,000	25,000	14,250	10,750