



Rogers

Assessment Property Record Card for Tax Year 2026

Data provided by LISA DELOZIER County Assessor

Date 04/16/2026
Time 22:59:24
Page 1

Assessment Data					Primary Image																																																																																																																				
Account 660013394 Parcel ID 22N16E-13-4-00000-000-0000 Cadastral ID 13-22-16-01200 Property Type REAL - Real Property Property Class RR VI Area 1 Tax Area 75 - SEQUOYAH/FOYIL FD Name ID 264687 SISCO, PHILLIP & GLENDA S 15791 E 440 RD CLAREMORE OK 74017-0000 Parcel Location Situs 15791 E 440 RD Subdivision Lot/Block / Parcel Size 1 - Acres Sec/Twn/Rng 13 / 22 / 16 / 4 Neighborhood 6050 - UNPLATTED School District S006 - SEQUOYAH SCHOOLS																																																																																																																									
Legal Description Lat/Long: 36.38012547 -95.54354913																																																																																																																									
Building Permits					\\tsclient\T\LOGAN\LOGAN RESIDENTIAL VI\2022-11-18\IMG_00: 11/21/2022																																																																																																																				
1 SQ AC IN SE SE SE					<table border="1"> <thead> <tr> <th>Number</th> <th>Description</th> <th>Opened</th> <th>Closed</th> <th>Amount</th> </tr> </thead> <tbody> <tr> <td> </td> <td> </td> <td> </td> <td> </td> <td> </td> </tr> </tbody> </table>					Number	Description	Opened	Closed	Amount																																																																																																											
Number	Description	Opened	Closed	Amount																																																																																																																					
Exemptions					Sale History																																																																																																																				
<table border="1"> <thead> <tr> <th>Code</th> <th>Type</th> <th>Active</th> <th>Maximum</th> <th>Exemption</th> </tr> </thead> <tbody> <tr> <td>HV</td> <td>Veteran</td> <td>Yes</td> <td>999,999</td> <td>6,676</td> </tr> </tbody> </table>					Code	Type	Active	Maximum	Exemption	HV	Veteran	Yes	999,999	6,676	<table border="1"> <thead> <tr> <th>Bk/Pg</th> <th>Grantor</th> <th>Date</th> <th>Price</th> <th>Code</th> </tr> </thead> <tbody> <tr> <td>1050/430</td> <td>HOUSING AUTHORITY OF</td> <td>12/19/1996</td> <td>0</td> <td>No</td> </tr> </tbody> </table>					Bk/Pg	Grantor	Date	Price	Code	1050/430	HOUSING AUTHORITY OF	12/19/1996	0	No																																																																																												
Code	Type	Active	Maximum	Exemption																																																																																																																					
HV	Veteran	Yes	999,999	6,676																																																																																																																					
Bk/Pg	Grantor	Date	Price	Code																																																																																																																					
1050/430	HOUSING AUTHORITY OF	12/19/1996	0	No																																																																																																																					
Parcel Valuation																																																																																																																									
<table border="1"> <thead> <tr> <th>Source</th> <th>REAL</th> <th>Fair Cash</th> <th>Capped</th> <th>Asmnt Level</th> <th>Assessed</th> <th>Levy Rate</th> <th>101.310</th> <th>Current Tax</th> </tr> </thead> <tbody> <tr> <td>Remove Cap</td> <td>0</td> <td>Land Value 33,088</td> <td>18,379</td> <td>11%</td> <td>2,022</td> <td>Assessed</td> <td>6,676</td> <td>676.35</td> </tr> <tr> <td>Year Frozen</td> <td>2018</td> <td>Improvements 76,165</td> <td>42,307</td> <td></td> <td>4,654</td> <td>Penalty</td> <td>0</td> <td></td> </tr> <tr> <td>Uncapped Value</td> <td>0</td> <td>Mobile Home 0</td> <td>0</td> <td></td> <td>0</td> <td>Exemption</td> <td>6,676</td> <td>-589.00</td> </tr> <tr> <td>TIF Project ID</td> <td>0</td> <td>Total Value 109,253</td> <td>60,686</td> <td></td> <td>6,676</td> <td>Total Taxable</td> <td>0</td> <td>87.00</td> </tr> </tbody> </table>		Source	REAL	Fair Cash	Capped	Asmnt Level	Assessed	Levy Rate	101.310	Current Tax	Remove Cap	0	Land Value 33,088	18,379	11%	2,022	Assessed	6,676	676.35	Year Frozen	2018	Improvements 76,165	42,307		4,654	Penalty	0		Uncapped Value	0	Mobile Home 0	0		0	Exemption	6,676	-589.00	TIF Project ID	0	Total Value 109,253	60,686		6,676	Total Taxable	0	87.00																																																																											
Source	REAL	Fair Cash	Capped	Asmnt Level	Assessed	Levy Rate	101.310	Current Tax																																																																																																																	
Remove Cap	0	Land Value 33,088	18,379	11%	2,022	Assessed	6,676	676.35																																																																																																																	
Year Frozen	2018	Improvements 76,165	42,307		4,654	Penalty	0																																																																																																																		
Uncapped Value	0	Mobile Home 0	0		0	Exemption	6,676	-589.00																																																																																																																	
TIF Project ID	0	Total Value 109,253	60,686		6,676	Total Taxable	0	87.00																																																																																																																	
Assessment History																																																																																																																									
<table border="1"> <thead> <tr> <th>Tax Year</th> <th>Statement Number</th> <th>Billed Owner</th> <th>Tax Area</th> <th>Total Value</th> <th>Exemptions</th> <th>Taxable Value</th> <th>Billed Tax</th> </tr> </thead> <tbody> <tr><td>2025</td><td>2025-660013394</td><td>SISCO, PHILLIP & GLENDA S</td><td>75</td><td>116,100</td><td>6675</td><td></td><td>87.00</td></tr> <tr><td>2024</td><td>2024-660013394</td><td>SISCO, PHILLIP & GLENDA S</td><td>75</td><td>123,520</td><td>6675</td><td></td><td>88.00</td></tr> <tr><td>2023</td><td>2023-660013394</td><td>SISCO, PHILLIP & GLENDA S</td><td>75</td><td>101,639</td><td>6675</td><td></td><td>89.00</td></tr> <tr><td>2022</td><td>2022-660013394</td><td>SISCO, PHILLIP & GLENDA S</td><td>75</td><td>99,354</td><td>6676</td><td></td><td>97.00</td></tr> <tr><td>2021</td><td>2021-660013394</td><td>SISCO, PHILLIP & GLENDA S</td><td>75</td><td>102,070</td><td>6675</td><td></td><td>101.00</td></tr> <tr><td>2020</td><td>2020-660013394</td><td>SISCO, PHILLIP & GLENDA S</td><td>75</td><td>100,631</td><td>6676</td><td></td><td>107.00</td></tr> <tr><td>2019</td><td>2019-660013394</td><td>SISCO, PHILLIP & GLENDA S</td><td>75</td><td>86,563</td><td>6675</td><td></td><td>111.00</td></tr> <tr><td>2018</td><td>2018-660013394</td><td>SISCO, PHILLIP & GLENDA S</td><td>75</td><td>90,002</td><td>6675</td><td></td><td>107.00</td></tr> <tr><td>2017</td><td>2017-660013394</td><td>SISCO, PHILLIP & GLENDA S</td><td>75</td><td>89,266</td><td>6481</td><td></td><td>108.00</td></tr> <tr><td>2016</td><td>2016-660013394</td><td>SISCO, PHILLIP & GLENDA S</td><td>75</td><td>87,027</td><td>6293</td><td></td><td>106.00</td></tr> <tr><td>2015</td><td>2015-660013394</td><td>SISCO, PHILLIP & GLENDA S</td><td>75</td><td>84,737</td><td>6109</td><td></td><td>102.00</td></tr> <tr><td>2014</td><td>2014-660013394</td><td>SISCO, PHILLIP & GLENDA S</td><td>75</td><td>85,418</td><td>5931</td><td></td><td>101.00</td></tr> <tr><td>2013</td><td>2013-660013394</td><td>SISCO, PHILLIP & GLENDA S</td><td>75</td><td>80,633</td><td>5759</td><td></td><td>92.00</td></tr> </tbody> </table>										Tax Year	Statement Number	Billed Owner	Tax Area	Total Value	Exemptions	Taxable Value	Billed Tax	2025	2025-660013394	SISCO, PHILLIP & GLENDA S	75	116,100	6675		87.00	2024	2024-660013394	SISCO, PHILLIP & GLENDA S	75	123,520	6675		88.00	2023	2023-660013394	SISCO, PHILLIP & GLENDA S	75	101,639	6675		89.00	2022	2022-660013394	SISCO, PHILLIP & GLENDA S	75	99,354	6676		97.00	2021	2021-660013394	SISCO, PHILLIP & GLENDA S	75	102,070	6675		101.00	2020	2020-660013394	SISCO, PHILLIP & GLENDA S	75	100,631	6676		107.00	2019	2019-660013394	SISCO, PHILLIP & GLENDA S	75	86,563	6675		111.00	2018	2018-660013394	SISCO, PHILLIP & GLENDA S	75	90,002	6675		107.00	2017	2017-660013394	SISCO, PHILLIP & GLENDA S	75	89,266	6481		108.00	2016	2016-660013394	SISCO, PHILLIP & GLENDA S	75	87,027	6293		106.00	2015	2015-660013394	SISCO, PHILLIP & GLENDA S	75	84,737	6109		102.00	2014	2014-660013394	SISCO, PHILLIP & GLENDA S	75	85,418	5931		101.00	2013	2013-660013394	SISCO, PHILLIP & GLENDA S	75	80,633	5759		92.00
Tax Year	Statement Number	Billed Owner	Tax Area	Total Value	Exemptions	Taxable Value	Billed Tax																																																																																																																		
2025	2025-660013394	SISCO, PHILLIP & GLENDA S	75	116,100	6675		87.00																																																																																																																		
2024	2024-660013394	SISCO, PHILLIP & GLENDA S	75	123,520	6675		88.00																																																																																																																		
2023	2023-660013394	SISCO, PHILLIP & GLENDA S	75	101,639	6675		89.00																																																																																																																		
2022	2022-660013394	SISCO, PHILLIP & GLENDA S	75	99,354	6676		97.00																																																																																																																		
2021	2021-660013394	SISCO, PHILLIP & GLENDA S	75	102,070	6675		101.00																																																																																																																		
2020	2020-660013394	SISCO, PHILLIP & GLENDA S	75	100,631	6676		107.00																																																																																																																		
2019	2019-660013394	SISCO, PHILLIP & GLENDA S	75	86,563	6675		111.00																																																																																																																		
2018	2018-660013394	SISCO, PHILLIP & GLENDA S	75	90,002	6675		107.00																																																																																																																		
2017	2017-660013394	SISCO, PHILLIP & GLENDA S	75	89,266	6481		108.00																																																																																																																		
2016	2016-660013394	SISCO, PHILLIP & GLENDA S	75	87,027	6293		106.00																																																																																																																		
2015	2015-660013394	SISCO, PHILLIP & GLENDA S	75	84,737	6109		102.00																																																																																																																		
2014	2014-660013394	SISCO, PHILLIP & GLENDA S	75	85,418	5931		101.00																																																																																																																		
2013	2013-660013394	SISCO, PHILLIP & GLENDA S	75	80,633	5759		92.00																																																																																																																		



Rogers

Assessment Property Record Card for Tax Year 2026

Data provided by LISA DELOZIER County Assessor

Date 04/16/2026
Time 22:59:25
Page 2

Lot Data	Square-Foot - NBHD 6050 #1	Primary Image
Lot Size Lot Count Units Buildable 1 Non-Ag Acres 1.1703 Topography Street Access Utilities Amenities LAND QUALITY 0 0 Method Square-Foot Base Lot Value 50,977.00 x .65 = 33,088 Factor Value Adjustments 1.0000 Lot Value 33,088		

Residential Data	
Type	1 Single Family Residence
Condition	3 - Average
Quality	2 - Fair
Architecture	
Style	100% One Story
Exterior Wall	100% Veneer, Masonry
Base/Total Area	1,040 / 1,040
Style	100% One Story
HVAC	100% Warmed & Cooled Air
Roof Cover	1 Composition Shingle
Area on Slab	0
Fixture/RghIn	4 /
Bed/F/H Bath	3 / 1.0 /
Basement Area	
Garage Type	
Remodel	
Year/Eff Age	1985 / 31



\\tsclient\T\LOGAN\LOGAN RESIDENTIAL VI\2022-11-18\IMG_00; 11/21/2022

GRM Approach	
GRM Code	
Gross Rent	0.00
Indicated Value	

Multiple Regression			
MRA Code	1	Test	
Adusted R	0.8445		
Indicated Value	82,654	79.48	Per SqFt

Direct Comparables	
Selection Model	1 Res
Adjustment Model	A2 AO Test
Comparables	
Indicated Value	

Cost Approach				Manual : 01/2025	
Base Cost	102.24	Total Misc Impr	+	4,683	
Roofing Adj	+ 4.19	Garage Cost	+		
Subfloor Adj	+ 2.43	Total RCN	=	133,622	
Heat/Cool Adj	+ 10.30	Depreciation (43%)	-	57,457	
Plumbing Adj	+ 4.82	Lump Sums	+	0	
Basement Adj	+ 0.00	RCNLD	=	76,165	
Adj Base Cost	= 123.98	Lot Value	+	33,088	
Total Area	x 1,040	Indicated Value	=	109,253	
Adjusted Cost	= 128,939	Value Per SqFt		105.05	

Value Reconciliation			
Selected Approach	Cost Approach		
Improvements	76,165		
Lot Value	33,088		
Indicated Value	109,253	105.05	Per SqFt
Agland Value			
Site Improvements			
Total Value	109,253	105.05	Total Value Per SqFt

Miscellaneous Improvements							
Code	Description	Sketch ID	Size	Year	Units	Unit Cost	Depr Value
PRCH	SLAB PORCH - COVERED	32219	16x6		96	20.99	2,015
EPSW	ENCLOSED PORCH - SOLID WALL	32220	8x6		48	55.59	2,668



Rogers

Assessment Property Record Card for Tax Year 2026

Data provided by LISA DELOZIER County Assessor

Date 04/16/2026
Time 22:59:25
Page 3

Sketch Image

660013394

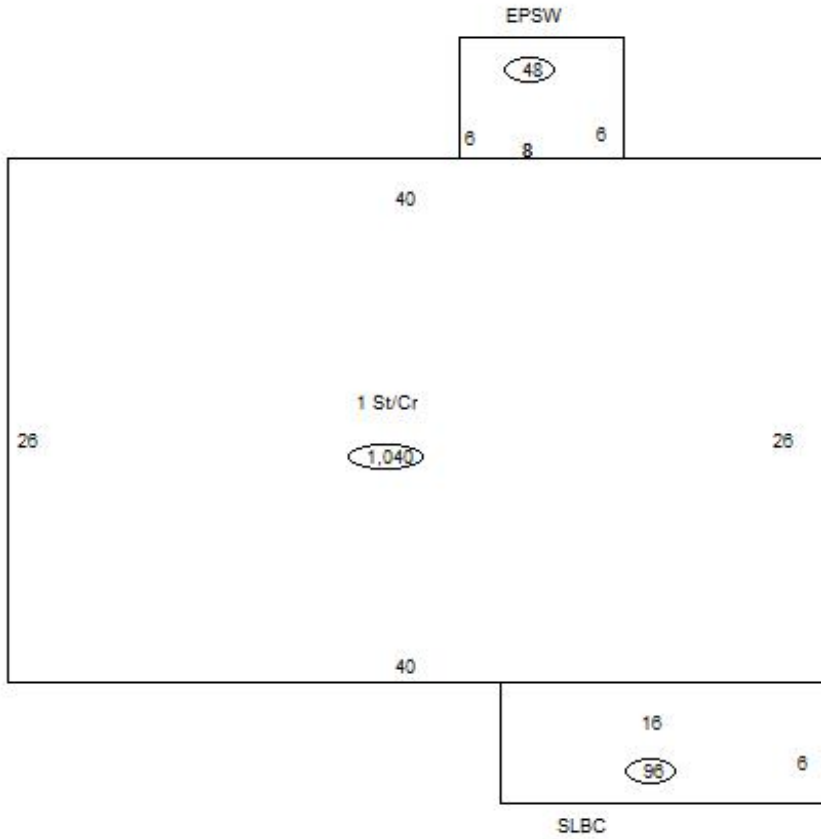

Sketch Vector Information

Sequence	Code	Type	Built Over	Scale	Section Label	Base Area	Multiplier	Total Area
1	R	1	Crawl	10	1 St/Cr	1,040	1.000	1,040
2	M	PRCH		10	SLBC	96	1.000	96
3	M	EPSW		10	EPSW	48	1.000	48
Total Building Area						1,040		1,040



Rogers

Assessment Property Record Card for Tax Year 2026

Data provided by LISA DELOZIER County Assessor

Date 04/16/2026
Time 22:59:25
Page 4

660013394

Outbuildings/Site Improvements

Building Image	Code	Description	Dimensions	Floor	Roofing	Total Units
	STF	STG FAIR	0x0x0			
	Qual	2	Cond	Year	Eff Age	
	Valuation Summary		Modifier Total	RCN	Depr (100% Phys/ % Func)	RCNLD
	Base Cost (4.68 x)					
	STF	STG FAIR	0x0x0			
	Qual	2	Cond	Year	Eff Age	
	Valuation Summary		Modifier Total	RCN	Depr (100% Phys/ % Func)	RCNLD
	Base Cost (4.68 x)					
	STF	STG FAIR	0x0x0			
	Qual	2	Cond	Year	Eff Age	
	Valuation Summary		Modifier Total	RCN	Depr (100% Phys/ % Func)	RCNLD
	Base Cost (4.68 x)					
	STF	STG FAIR	0x0x0			
	Qual	2	Cond	Year	Eff Age	
	Valuation Summary		Modifier Total	RCN	Depr (100% Phys/ % Func)	RCNLD
	Base Cost (4.68 x)					